



R70-20 R70-25 R70-30 R70-35 R70-40 R70-45

Treibgas-Gabelstapler
LPG Fork Truck
Chariot élévateur au GPL

Diesel-Gabelstapler
Diesel Fork Truck
Chariot élévateur Diesel

STILL
ELECTRONIC
DOCUMENTATION
SYSTEM

STEDS



**Werk-
statt-
handbuch**

**Work-
shop
manual**

**Manuel
d'Atelier**

DFG R7032-R7034 R7048-R7050
TFG R7038-40

Ident-Nr.164537 (en)



STILLGmbH

Chassis Frame and Counterweight

Chassis Frame

The chassis frame is constructed of electrically welded steel plate.

Detachable fuel and hydraulic oil tanks are mounted inside left-hand and right-hand frame sections respectively for extra protection.

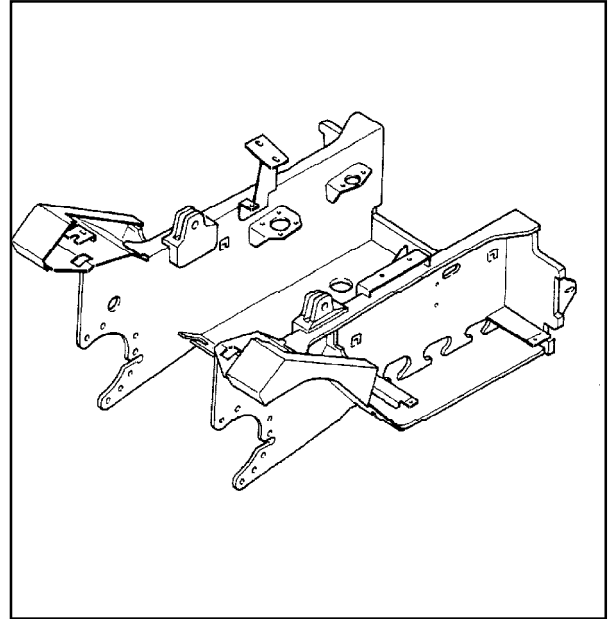

Counterweight

The removable rear counterweight is secured to the frame weldment by 4 bolts.

1 = hex hd bolt M24x130, 8.8 DIN 933

Torque loading: 710 Nm

2 = lock ring

3 = spherical washer C 25 DIN 6319

4 = ball cup D 28 DIN 6319

Weight of the counterweight

7032/7038 = 1,170 kg

7033/7039 = 1,514 kg

7034/7040 = 1,915 kg

7048 = 1,985 kg

7049 = 2,395 kg

7050 = 2,715 kg

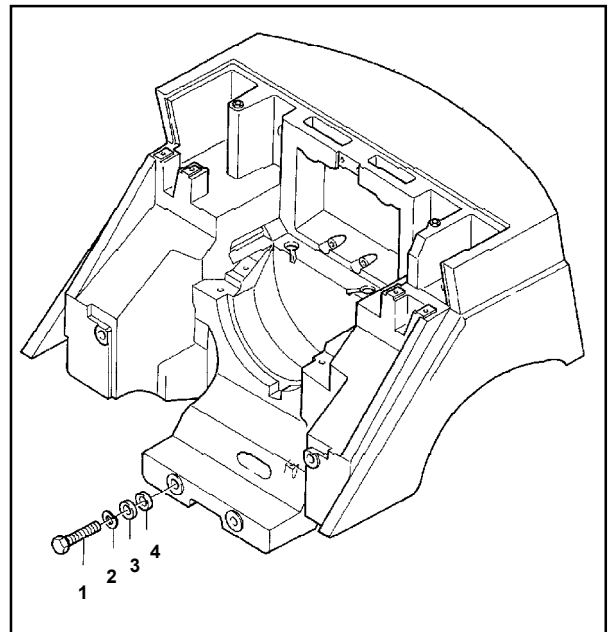

Driver's cab

Bolted to the frame at the front end and to the counterweight at the rear, the cab is mounted at 4 points on rubber type anti-vibration mounts.

Removal

- Remove panel from front cowl
- Remove floor plate
- Remove upswept type exhaust pipe (if fitted)
- Remove cover plates left and right of inspection plate, giving access to the rear rubber mounts (above counterweight)
- Disconnect the 3 connectors at the steering column (Fig. 1, page 3)
- Disconnect the wiring harness from the steering column
- Remove the screws which secure steering column to hand pump (steering wheel operated pump) - Fig. 1, page 3)
- Disconnect the connections on warning horn, brake fluid reservoir and master cylinder, located in the front cowl (Fig. 2, page 3)

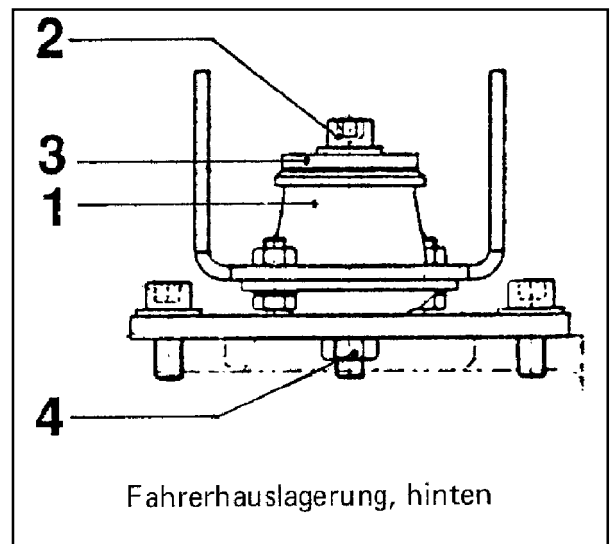
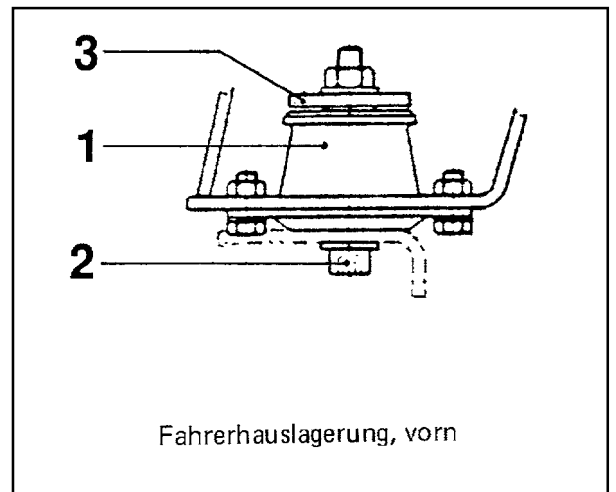
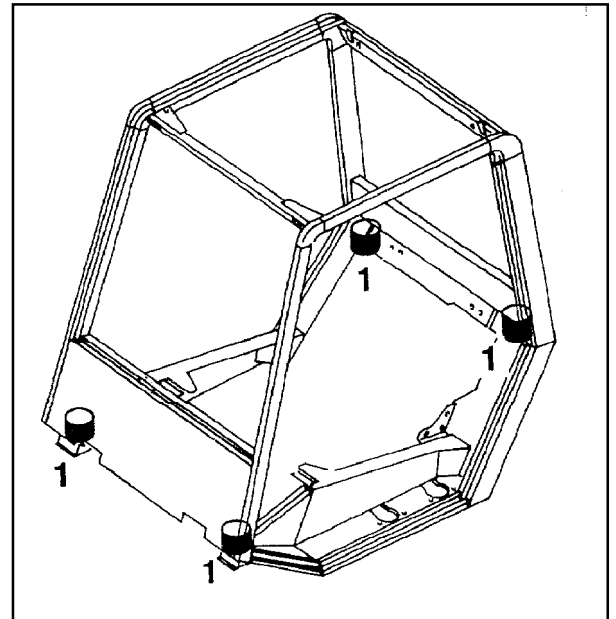

- 1 = rubber type anti-vibration mount
- 2 = allen screw M10 x 80, 8.8
- 3 = washer
- 4 = hex nut; welded to the support

Driver's cab

Driver's cab (removal)

Detach earthing or ground connection

Remove panel to which is mounted the electronic control unit inside front cowl

Disconnect brake line at master cylinder (Figure 2). Refit fluid passage bolt to prevent brake fluid from flowing out

Remove M10 x 80 allen screws front and rear

Slig cab using an overhead hoist or remove cab with the aid of a second lift truck

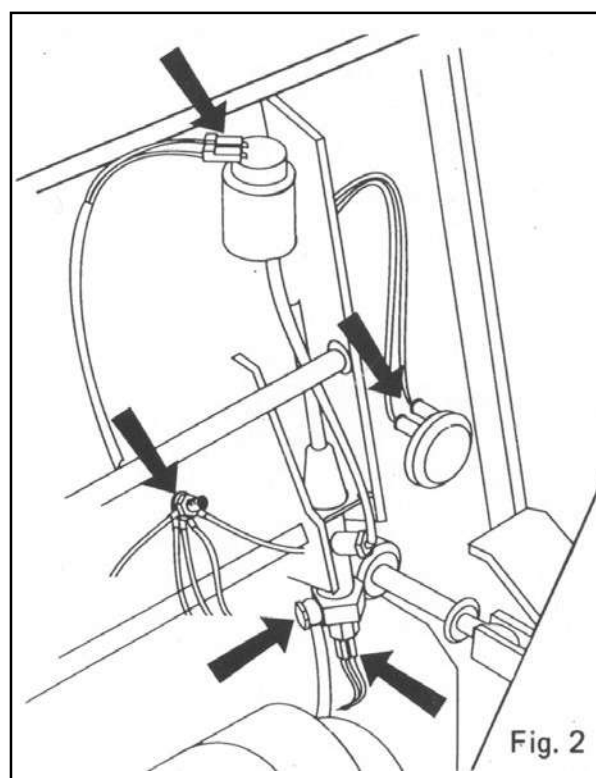
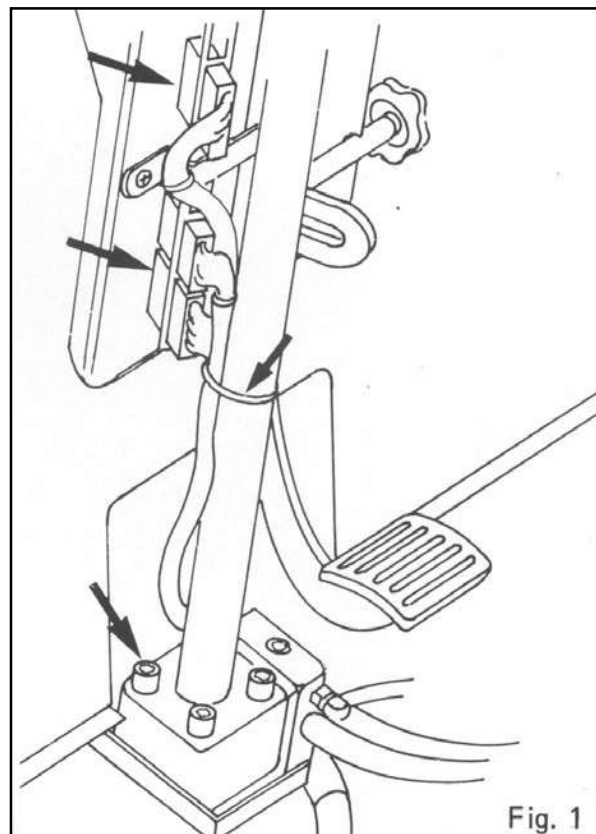

Thanks for your reading.

Please click here to download complete manual instantly.

And can also choose other manuals.

Feel free --->write to me with any questions.

Our service email:

manuals007@hotmail.com