

Form No.
907506

860/865

(860 After SN9300
and All 865's)

Forage Harvesters

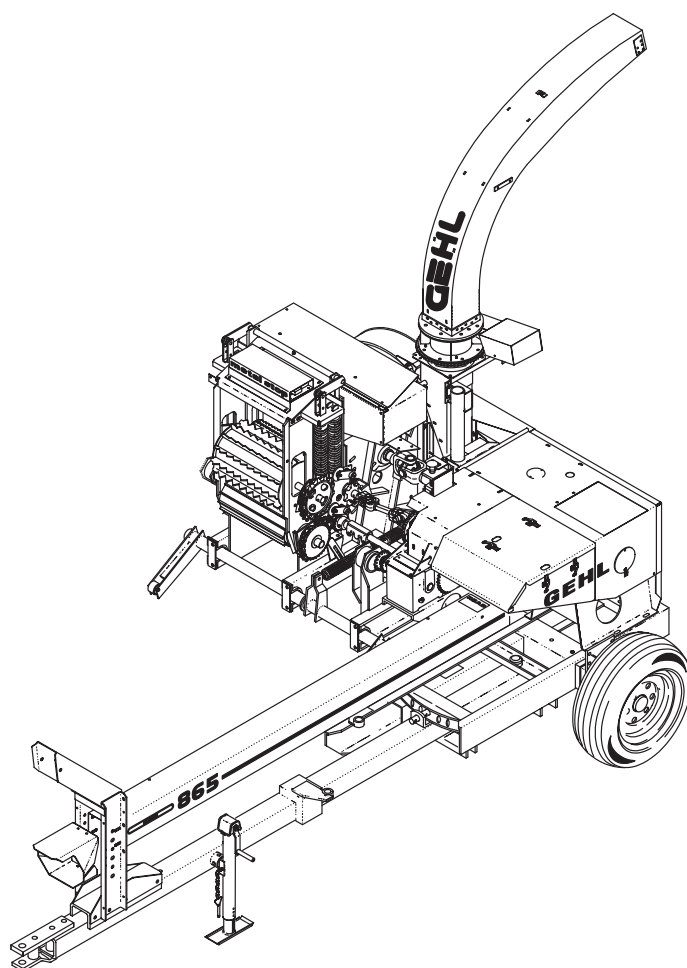

PARTS MANUAL

GEHL® AGRICULTURE

Introduction

When ordering service parts, specify the correct part number, full description, quantity required, the unit model number and serial number.

The model and serial number for this unit is on a plate located on the right side of the Main Frame adjacent to the Cylinder Shaft Bearing.

“Right” and “Left” are determined from a position standing behind the unit and facing the direction of travel. From this position the Bevel Gearbox and Main Drive Shaft are on the “Left” side.

GEHL® Company reserves the right to make changes or improvements in the design or construction of any part of the unit without incurring the obligation to install such changes on any previously delivered units.

NOTE: *On original tire replacement, company policy prohibits the sale of replacement tires for all GEHL machinery. Replacement Wheel Sets are available and tire size information is called out with the Wheel Sets to facilitate replacement tire selection. ALL REPLACEMENT TIRES MUST BE PURCHASED LOCALLY.*

Refer to the abbreviations table located on this page for the various fastener descriptions. Standard attaching hardware torque values are also provided on the inside back cover.

In the exploded view parts list, Reference Numbers may have additional information following the Reference Number.

A Tear Drop symbol will indicate an application of a “wet” product such as oil, and the number inside the Tear Drop will correspond to the description in the Parts List.

Also, a number inside a hexagon will be the torque value required, in foot pounds, on the associated Reference Number. Items shown in the parts list that do not have Reference Numbers are shown for reference purposes only and are NOT available for purchase.

Unless otherwise specified, all Cap Screws or Bolts are Grade 5, zinc plated; Hexagon Nuts for Grade 5 Screws or Bolts are Grade B; Hexagon Nuts for other Screws or Bolts are Grade A.

NOTE: *The following abbreviations may be used herein:*

| | |
|---|-----------------------------------|
| AR | – As Required |
| ASSD | – Assembled |
| ASSY | – Assembly |
| CB | – Carriage Bolt |
| CCW | – Counterclockwise |
| CP | – Cotter Pin |
| CS | – Cap Screw (Hexagon Head) |
| CTR | – Center |
| CW | – Clockwise |
| DEG | – Degree |
| DIA | – Diameter |
| FCS | – Flanged Cap Screw |
| FHMS | – Flat Head Machine Screw |
| FL | – Flanged |
| FLN | – Flanged Lock Nut (Hexagon) |
| FLS | – Flanged Lock Screw (Hexagon) |
| FW | – Flat Washer |
| GA | – Gauge |
| GR | – Grade |
| HD | – Hard or Head |
| HN | – Hex Nut |
| INCL | – Includes |
| JT | – Joint |
| LG | – Large |
| LH | – Left Hand |
| LN | – Lock Nut |
| LW | – Lock Washer |
| M | – Metric |
| MM/mm | – Millimeter |
| NF | – National Fine |
| PB | – Plow Bolt |
| PTO | – Power Take Off |
| RH | – Right Hand |
| RHMS | – Round Head Machine Screw |
| RPM | – Revolutions Per Minute |
| RHTFS | – Round Head Thread-forming Screw |
| RT | – Right |
| SERR | – Serrated |
| SHCS | – Socket Head Cap Screw |
| SHSS | – Socket Head Set Screw |
| SN | – Serial Number or Slotted Nut |
| SQ | – Square |
| T | – Tooth or Teeth |
| TFS | – Thread Forming Screw |
| THMS | – Truss Head Machine Screw |
| THRD | – Thread |
| WLDMT | – Weldment |
| # | – Number |
|  | – Torque Required in foot pounds |
|  | – Indicates a Fluid Application |

TABLE OF CONTENTS

| | |
|---|--------------------|
| Introduction | Inside Front Cover |
| Table of Contents | 1 |
| Decal Locations | 2-9 |
| Frame & Attachment Lift | 10-11 |
| Tongue & Driveline | 12-13 |
| Cylinder & Cutting Mechanism | 14-17 |
| Knife Sharpener | 18-21 |
| Implement Drive | 22-23 |
| Shifter Transmission Controls (Standard) | 24-25 |
| Shifter Transmission Controls (Metal Detector) | 26-27 |
| Electric Clutch (Metal Detector) | 28-29 |
| Feed Roll & Drive (Standard & Metal Detector) - Upper Rollers | 30-31 |
| Feed Roll & Drive (Standard) - Lower Rollers | 32-33 |
| Feed Roll & Drive (Metal Detector) - Lower Rollers | 34-35 |
| Roll Arm Assemblies | 36 |
| Overrunning Clutch | 37 |
| Blower & Drive | 38-41 |
| Deflector & Cap | 42-45 |
| Shields & Covers | 46-47 |
| Hydraulics | 48-49 |
| Control Box (Mounting, Wiring & Components) | 50-55 |
| Metal Stop Amplifier Box | 56 |
| Lower Front Detector Roll | 57 |
| Shifter Transmission | 58-59 |
| Bevel Transmission | 60 |
| Hitchjack | 61 |
| Hydraulic Components | 62 |
| Universal Drives | 63-65 |
| Optional Single Axles & Wheels | 66 |
| Optional Tandem Axles & Wheels | 67 |
| Optional Flotation Axles & Wheels | 68 |
| Accessories | 69-74 |
| Hydraulic Hitch Control | 69 |
| 1-Ft. Vertical Extension | 69 |
| 2-Ft. Vertical Extension | 69 |
| 6" Vertical Extension | 69 |
| 3-1/2-Ft. Horizontal Deflector Extension | 70 |
| Deflector Tripod Kit | 71 |
| Selector Valve Kit | 72 |
| Lift Cylinder & Hose Kit | 73 |
| Safety Chain | 73 |
| Transport Lighting Package | 73 |
| Screen Mounting Kit | 74 |
| Square-hole Screens | 74 |
| Service Kits - Electrical Connectors | 75 |
| Alphabetical Index | 76 |
| Numerical Index | 77-84 |
| Standard Hardware Torque Specifications | Inside Back Cover |

Thanks for your reading.

Please click here to download complete manual instantly.

And can also choose other manuals.

Feel free --->write to me with any questions.

Our service email:

manuals007@hotmail.com