

GEHL®

Form No.
918035
Revision E
May 2009

Model 153

Compact Excavator

Beginning Serial Number: AB00440



Parts Manual

INTRODUCTION

When ordering service parts, specify the correct part number, full description, quantity required, the unit model number and serial number. For your safety and continued proper operation, use only genuine GEHL service parts.

The model and serial number for this unit are on a tag located on a panel on the front of the cab.

"Right" and "left" are determined from a position sitting on the operator's seat and facing forward.

GEHL Company reserves the right to make changes or improvements in the design or construction of any part of the unit without incurring the obligation to install such changes on any previously delivered units.

Refer to the abbreviations table located on this page for special parts descriptions. Standard attaching hardware torque values are also provided near the back of this manual. Metric torque values shown in the illustrations are in Newton-meters and are converted to foot-pounds by multiplying by 0.738.

Specific reference numbers, indicating a complete assembly, are circled in some illustrations. A small bag, pictured in some illustrations, indicates a seal kit (seals, o-rings, etc.). In the exploded view parts list, additional information may follow the Reference Number.

Serial number breaks are indicated as follows:

- (SN 999 and before) - indicates serial numbers up to and including 999.
- (SN 1000 - 2000) - indicates serial numbers between 1000 and 2000.
- (SN 999 and up) - indicates serial numbers including 999 and after.

Serial number exceptions and inclusion are indicated as follows:

- (SN 999 and before except 997) - indicates serial numbers up to and including 999, EXCEPT 997.
- (SN 1000 - 2000 except 1996 including 997) - indicates serial numbers between 1000 and 2000, INCLUDING 997 EXCEPT 1996.

- (SN 2001 and up including 1996) - indicates serial numbers including 2001 and after, INCLUDING 1996.

Unless otherwise specified, all cap screws nuts, and bolts are Grade 8.8, cadmium or zinc plated.

NOTE: *The following abbreviations may be used herein:*

ASSD.....	Assembled
ASY.....	Assembly
ASSY.....	Assembly
AR.....	As Required
CB.....	Carriage Bolt
CP.....	Cotter Pin
CS.....	Cap Screw (Hexagon Head)
CYL.....	Cylinder
DIA.....	Diameter
FHCS.....	Flat Head Cap Screw
GR.....	Grade
HB.....	Hex Bolt
HLN.....	Hex Lock Nut
HN.....	Hex Nut
HP.....	High Pressure
HYD.....	Hydraulic
INS.....	Insert
LH.....	Left Hand
LN.....	Lock Nut
LT.....	Left
LW.....	Lock Washer
M.....	Meter or Meters
MM/mm.....	Millimeter
NPT.....	National Pipe Thread
NSS.....	Not Sold Separately
RH.....	Right Hand
RT.....	Right
SHCS.....	Socket Head Cap Screw
SLTD.....	Slotted
SN.....	Serial Number or Slotted Nut
SQ.....	Square
W/.....	With

TABLE OF CONTENTS

Introduction.....	Inside Front Cover	Lubrication	
Decal Locations	5	(SN AE00001 and up)	40
Filters, Gaskets and Seals	9	(SN AC00304-AD04191)	41
Diesel Engine		(SN AC00303 and before)	42
(SN AE00001 and up)	10	Cooling System	
(SN AC00304-AD04191)	11	(SN AE00001 and up)	43
(SN AC00303 and before)	12	(SN AC00304-AD04191)	44
Seal Kit		(SN AC00303 and before)	45
(SN AC00304-AD04191).....	13	Fuel Injection System	
(SN AC00303 and before).....	14	(SN AE00001 and up)	46
Engine Mounts		(SN AC00304-AD04191)	47
(SN AE00001 and up)	15	(SN AC00303 and before).....	48
(SN AC00304-AD04191)	16	Fuel Injection Pump	
(SN AC00303 and before)	17	(SN AD04191 and before).....	49
Cylinder Head, Valve Cover		Air Intake System	
(SN AE00001 and up)	18	(SN AE00001 and up)	50
(SN AC00304-AD04191)	19	(SN AC00454-AD04191).....	51
(SN AC00303 and before)	20	(SN AC00304-AD00453).....	52
Intake Manifold		(SN AC00303 and before).....	53
(SN AC00304-AD04191).....	21	Exhaust System	
(SN AC00303 and before).....	22	(SN AE00001 and up)	54
Exhaust Manifold		(SN AC00304-AD04191).....	55
(SN AC00304-AD04191).....	23	(SN AC00303 and before).....	56
(SN AC00303 and before).....	24	Diesel Tank	
Cylinder Block		(SN AE00001 and up)	57
(SN AE00001 and up)	25	(SN AD01243-AD04191).....	58
(SN AC00304-AD04191)	26	(SN AC01611-AD01242).....	59
(SN AC00303 and before)	27	(SN AC01610 and before).....	60
Seal, Crankshaft		Fuel System	
(SN AE00001 and up)	28	(SN AE00001 and up)	61
(SN AC00304-AD04191).....	29	(SN AD04191 and before).....	62
(SN AC00303 and before)	30	Throttle Lever	
Oil Pan		(SN AE00001 and up)	63
(SN AE00001 and up)	31	(SN AD04191 and before).....	64
(SN AC00304-AD04191).....	32	Hydraulic Pump Drive	
(SN AC00303 and before)	33	(SN AF03764 and up).....	65
Camshaft		(SN AE00001-AF03763).....	66
(SN AE00001 and up)	34	(SN AC00304-AD04191).....	67
(SN AC00304-AD04191)	35	(SN AC00303 and before).....	68
(SN AC00303 and before)	36	Radiator	
Crankshaft, Piston		(SN AE00001 and up)	69
(SN AE00001 and up)	37	(SN AC00615-AD04191).....	70
(SN AC00304-AD04191)	38	(SN AC00304-AC00614).....	71
(SN AC00303 and before)	39	(SN AC00303 and before).....	72
		Oil Cooler	
		(SN AC01884 and up)	73
		(SN AC01883 and before).....	74

TABLE OF CONTENTS

Oil Cooler Installation		Travel Valve Installation	
(SN AC01884 and up)	75	(SN AD00454 and up)	108
(SN AC01883 and before)	76	(SN AD00453 and before)	109
Turntable Drive Unit Installation		Dozer Blade Valve (double)	110
(SN AD00454 and up)	77	Dozer Blade Valve (double)	
(SN AD00453 and before)	78	Disassembled	111
Turntable Drive Unit	79	Hydraulic Block	
Travel Gear Installation		(SN AD00453 and before)	112
(SN AD00454 and up)	80	Boom Cylinder Installation	
(SN AD00453 and before)	81	(SN AD00454 and up)	113
Drive Motor		Boom Cylinder	114
(SN AE00001 and up)	82	Dipper Arm Cylinder Installation	
(SN AD04191 and before)	83	(SN AD00454 and up)	115
Hydraulic Tank		Boom Hyd. Installation-Short Dipper Arm	
(SN AF01067 and up)	84	(SN AD00453 and before)	116
(SN AD00454-AF01066)	85	Dipper Arm Cylinder	117
(SN AD00453 and before)	86	Boom Hyd. Installation-Long Dipper Arm	
Hydraulic Pump		(option) (SN AD00453 and before)	118
(SN AD00454 and up)	87	Bucket Cylinder Installation	
(SN AD00453 and before)	88	(SN AD00454 and up)	119
Control Valve 1		Bucket Cylinder	120
(SN AD00454 and up)	89	Boom Offset Cylinder Installation	
(SN AD00453 and before)	90	(SN AD00454 and up)	121
Control Valve 2	91	(SN AC01881-AD00453)	122
Swivel Joint	92	(SN AC01799 and before)	123
Joystick		Boom Offset Cylinder	
(SN AF00798 and up)	93	(SN AD00454 and up)	124
(SN AE00001-AF00797)	94	(SN AC01800-AD00453)	125
(SN AD00454-AD04191)	95	(SN AC01799 and before)	126
(SN AD00453 and before)	96	Dozer Blade Cylinder Installation	127
Pilot Valve, Travel		Blade Cylinder	128
(SN AD00454 and up)	97	Telescopic Cylinder Installation	129
(SN AC01499-AD00453)	98	Telescopic Cylinder	130
(SN AC01498 and before)	99	Auxiliary Hydraulics	
Reversing Valve	100	(SN AD00454 and up)	131
ISO/SAE Valve		(SN AD00453 and before)	132
(SN AD00454 and up)	101	Auxiliary Function Installation	
(SN AD00453 and before)	102	(SN AD00454 and up)	133
Hydraulic Pump Installation		Battery	
(SN AD00454 and up)	103	(SN AE00001 and up)	134
(SN AD00453 and before)	104	(SN AD00454-AD04191)	135
Joystick Hydraulics Installation, Left		(SN AD00453 and before)	136
(SN AD004564 and up)	105	Dashboard	
Joystick Hydraulics Installation, Right		(SN AE00001 and up)	137
(SN AD00454 and up)	106	(SN AC01876-AD04191)	138
Joystick Hydraulic Installation		(SN AC01875 and before)	139
(SN AD00453 and before)	107	Radio (option)	140

TABLE OF CONTENTS

Relay Box		Side Panels/Seat Console/Console Covers	
(SN AE00001 and up)	141	(SN AC01477-AD00453).....	176
(SN AD04191 and before).....	142	(SN AC01476 and before).....	178
Horn	143	Seat Console	
Work Light.....	144	(SN AD00454 and up)	180
Cab Work Light (option)	145	Isolation Mats	
Chassis Wire Harness		(SN AF00152 and up).....	181
(SN AC01876 and up)	146	(SN AC01477-AF00151).....	182
(SN AC01875 and before).....	147	(SN AC01476 and before).....	183
Engine Wire Harness		Chassis Cover	
(SN AE00001 and up)	148	(SN AE00001 and up)	184
(SN AC01876-AD04191).....	149	(SN AD04191 and before).....	185
(SN AC01875 and before).....	150	Seat Console Cover	
Armrest Wire Harness		(SN AD00454 and up)	186
(SN AE00001 and up)	151	Lifting Boom	187
(SN AC01876 and up)	152	Dipper Arm Short	
(SN AC01875 and before).....	153	(SN AD00454 and up)	188
Rubber Track		(SN AD00453 and before).....	189
(SN AE00001 and up)	154	Dipper Arm Long (option)	
Undercarriage, Rubber Track		(SN AD00454 and up)	190
(SN AE00001 and up)	155	(SN AD00453 and before).....	191
Undercarriage and Rubber Track		Connecting Link	192
(SN AD00454-AD04191).....	156	Cabin Frame	
(SN AD00453 and before).....	157	(SN AD00454 and up)	193
Track Tension, Rubber Track.....	158	(SN AD00453 and before; cab SN	
Dozer Blade		42289 and up)	194
(SN AD00454 and up).....	159	(SN AD00453 and before; cab SN	
(SN AD00453 and before).....	160	42288 and before).....	195
Dozer Blade Extensions.....	161	Canopy Frame	
Chassis		(SN AD00454 and up)	196
(SN AE00001 and up)	162	(SN AD00453 and before).....	197
(SN AD00454-AD04191).....	163	Covers	
(SN AD00453 and before).....	164	(SN AD00454 and up)	198
Lubrication		(SN AD00453 and before; cab SN	
(SN AD00454 and up).....	165	42289 and up)	199
(SN AD00453 and before).....	166	(SN AD00453 and before; cab SN	
Counterweight		42288 and before).....	200
(SN AF00243 and up).....	167	Cabin Harnesses.....	201
(SN AE00001-AF00242).....	168	Front Window	
(SN AD00454-AD04191).....	169	(SN AE00001 and up)	202
(SN AD00453 and before).....	170	(SN AD04191 and before).....	203
Hood		Cabin Windows	204
(SN AD00454 and up).....	171	Cabin Doors	
(SN AD00453 and before).....	172	(SN AD00454 and up)	205
Side Panels		(SN AD00453 and before; cab SN	
(SN AF00152 and up).....	174	42289 and up)	206
(SN AD00454-AF00151)	175	(SN AD00453 and before; cab SN	
		42288 and before).....	207

TABLE OF CONTENTS

Rotating Beacon (option).....	208
Mirror (option).....	209
Operator's Seat	
(SN AE00001 and up)	210
(SN AD04010-AD04191).....	212
(SN AD00454-AD04009).....	214
(SN AC01876-AD00453).....	216
(SN AC01875 and before).....	217
Heater	
(SN AE00001 and up)	218
(SN AD00454-AD04191).....	219
(SN AC00304-AD00453).....	220
(SN AC00303 and before).....	221
Tool Kit.....	222
Index	223
Numerical Index	225

DECAL LOCATIONS

GENERAL INFORMATION

Decal location information is provided to assist in the proper selection and application of new decals, in the event the original decals become damaged or the machine is repainted. The listing includes decal illustration reference number, part number, description and quantity information. Refer to the illustrations for appropriate replacement locations.

To ensure proper selection of the correct replacement decals, compare all of the various closeup location drawings to the machine before starting to refinish the unit. Then circle each decal shown (applicable to the machine) while checking off its part number in the listing. After verifying all the decals needed for replacement, place any extra unnecessary decals aside for disposal.

NOTE: Refer to the SAFETY chapter of the Operator's Manual for the specific information provided on all of the various safety decals furnished in the decal kit(s).

NEW DECAL APPLICATION

If there is a decal on a part that is to be replaced, be sure that the decal is applied to the replacement part. Surfaces MUST be free from dirt, dust, grease and other foreign material before applying the new decal. To apply, remove the smaller portion of the decal backing paper and apply this part of the exposed adhesive backing to the clean surface while maintaining proper position and alignment. Peel the other portion of the backing paper off slowly while applying hand pressure to smooth out the decal surface.



CAUTION

ALWAYS follow safety precautions on decals. Replace the decals if they are damaged, or if the unit is repainted. If repainting, BE SURE all applicable decals are affixed to the machine.

PAINT NOTICE

Use this list to order paint for refinishing:

167788	4 qts. Construction Yellow (GEHL)
167780	4 qts. Light Gray (GEHL)
167774	4 qts. Dark Gray (GEHL)
167789	6 (12.8 oz. Spray Cans) Yellow (GEHL)
167775	6 (12.8 oz. Spray Cans) Dark Gray (GEHL)
167781	6 (12.8 oz. Spray Cans) Light Gray (GEHL)

The decal kit for the model 153 Compact Excavator is listed below:

Ref. No.	Part No.	Description & Quantity
	165991	Kit/Decal GE153
1	161965	Decal/Diesel Fuel
2	161966	Decal/Hydraulic Oil
3	161967	Decal/Lubrication
4	161969	Decal/Warning Hyd Reservoir
5	161970	Decal/Arrow (2 places)
6	161981	Decal/Lift Point (4 places)
7	161982	Decal/Tiedown Point (4 places)
8	161985	Decal/Warning Keep Away (2 places)
9	161986	Decal/Warning Read Manual
10	161987	Decal/Warning Rotating Fan
11	162449	Decal/Dozer Blade Up-Down
12	162450	Decal/Travel Left
13	162451	Decal/Travel Right
14	162452	Decal/Joystick Control Right
15	162453	Decal/Joystick Control Left
16	203793	Decal/Lifting Capacity
17	163973	Decal/Warning Mandatory Shutdown
18	163974	Decal/Throttle Speed
19	163975	Decal/Warning Avoid Injury (2 places)
20	163976	Decal/Warning Avoid Injury
21	163977	Decal/Warning Entanglement Hazard
22	163978	Decal/Warning Hot Surface
24	164854	Decal/Warning Avoid Injury
25	9705282G	Decal/Track Spread
26	9705366G	Decal/Heater (SN AD00453 and Before)
27	9705488G	Decal/Swing Lock
28	9705489G	Decal/Return Flow Control
29	9705501G	Decal/ISO-SAE Valve
30	9705502G	Decal/ROPS-FOPS
31	9705523G	Decal/Cabin Support
32	183935	Decal/Gehl 5.50 x 23.34
33	183963	Decal/Gehl 3.75 x 15.92
34	170176	Decal/153 (2 places)
35	104833	Decal/ Gehl 2.00 x 8.49 (white)
36	206032	Decal/Reflector (2 places)
37	164853	Decal/Engine Compartment Latch (SN AD00453 and Before)

DECAL LOCATIONS

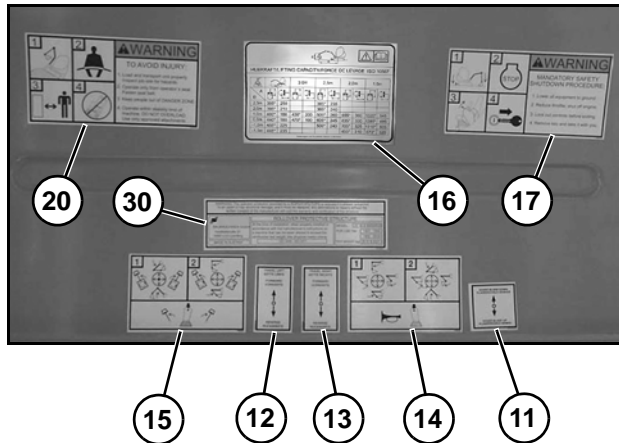
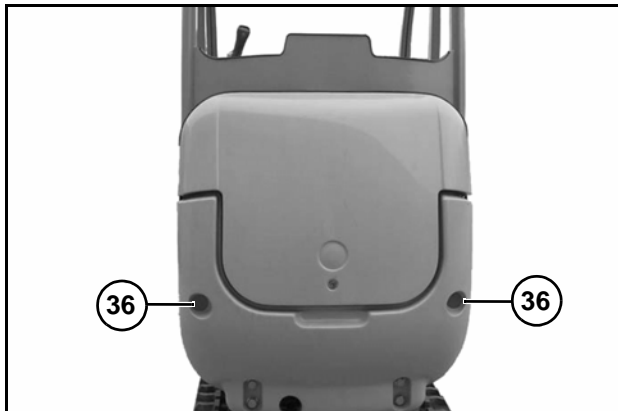
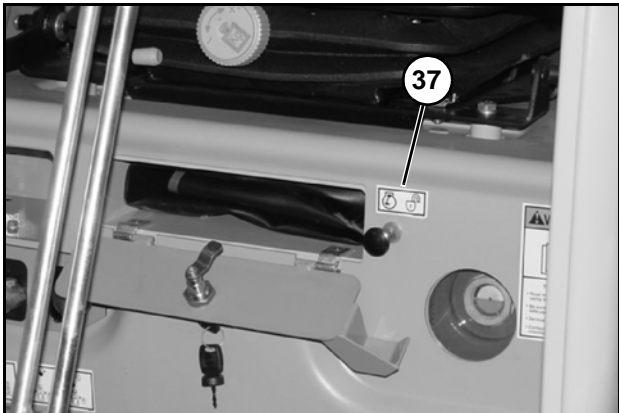
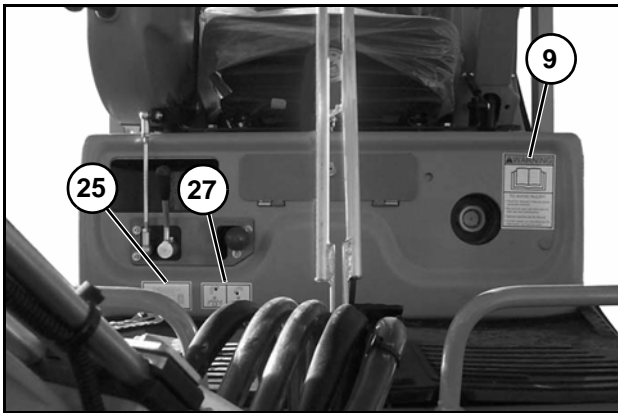
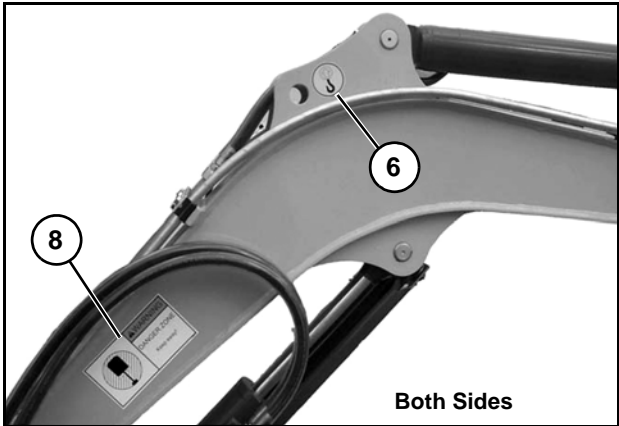
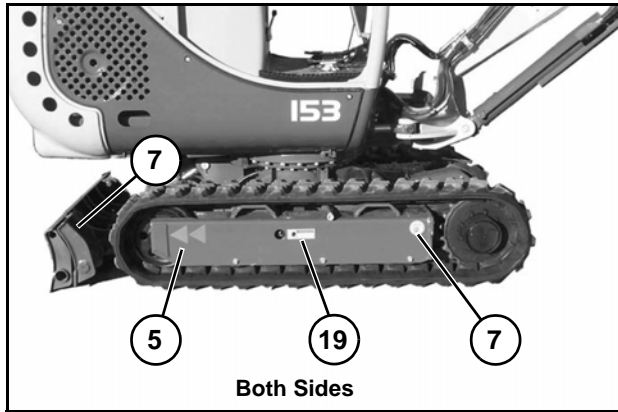
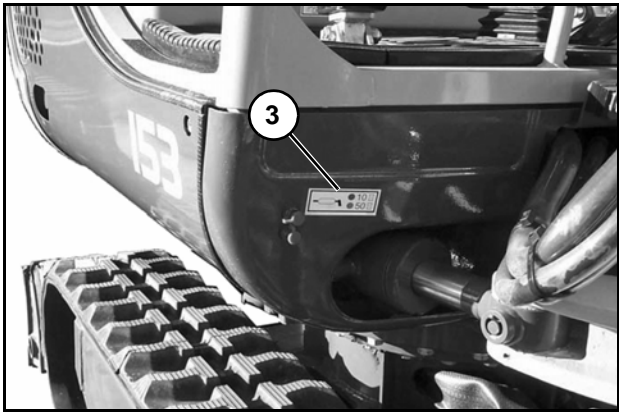
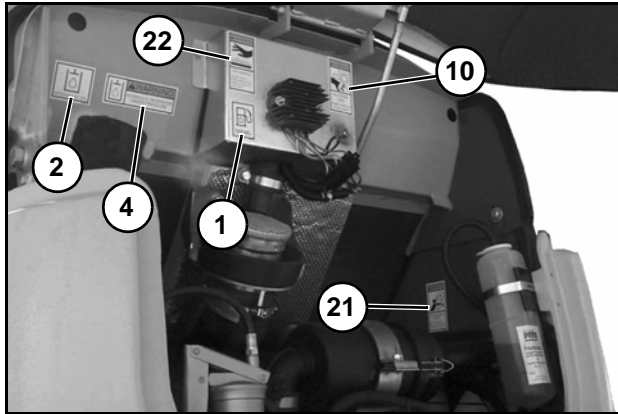

DECAL LOCATIONS

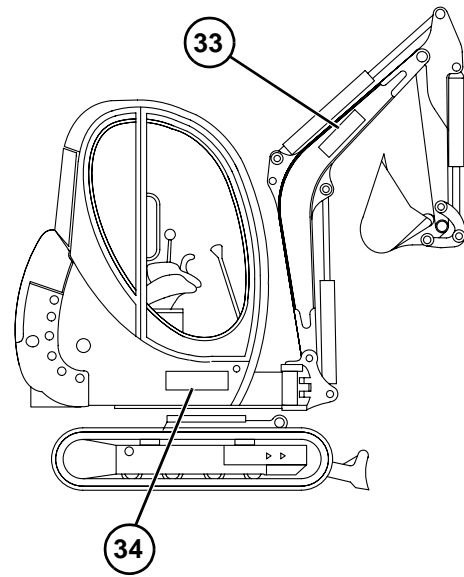
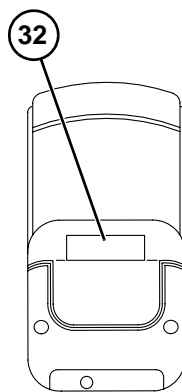
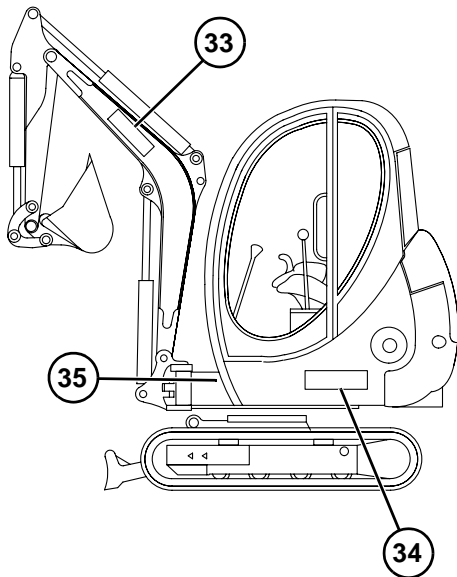
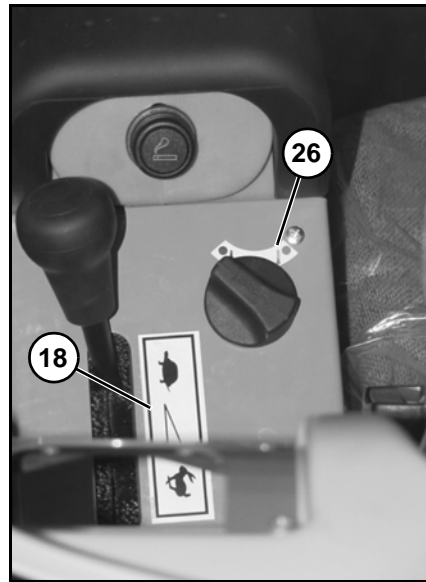
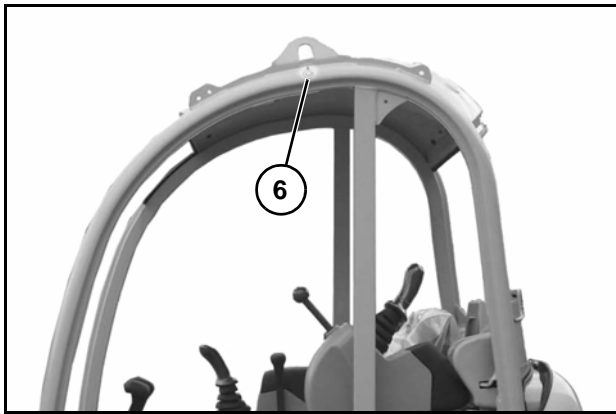
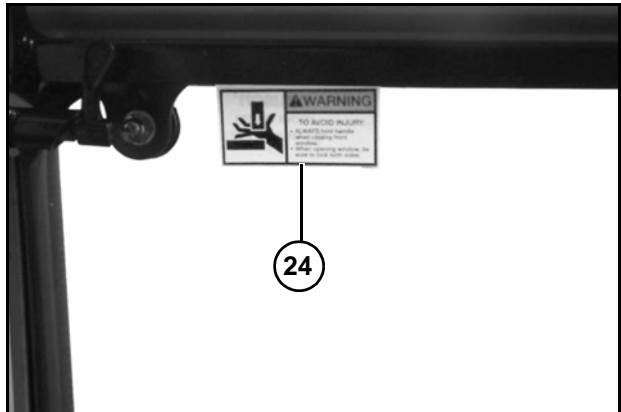
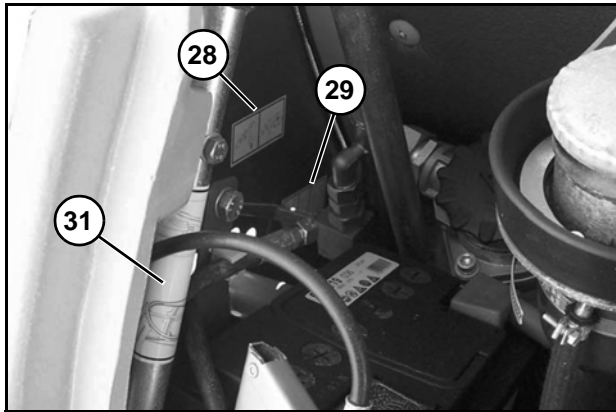

NOTES

Thanks for your reading.

Please click here to download complete manual instantly.

And can also choose other manuals.

Feel free --->write to me with any questions.

Our service email:

manuals007@hotmail.com