

HL 2800 LOADER

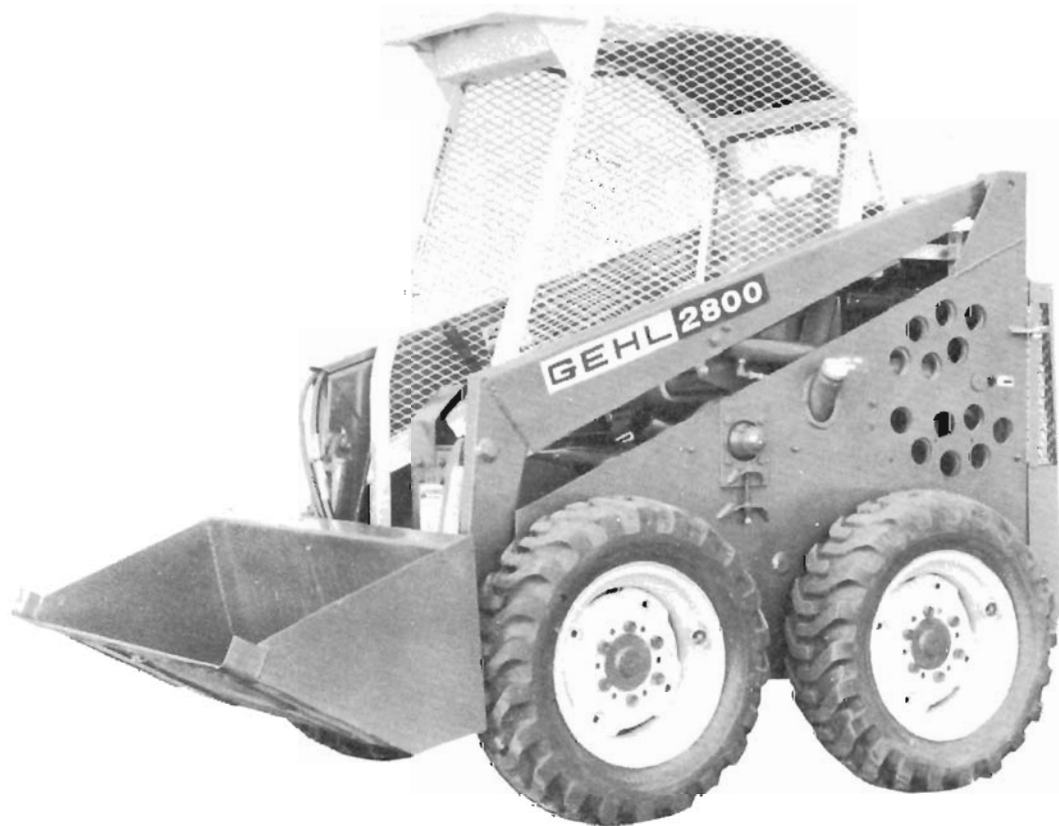

SERVICE PARTS MANUAL

Form No.
902407

GEHL[®] COMPANY

Mr. Operator:

Your decision to purchase Gehl equipment is a wise one. You have made a sound and lasting investment. Gehl Company has been building quality equipment for well over a century. Our entire manufacturing and marketing philosophy is built upon quality. The quality built into Gehl products assure you the performance and reliability you need to make a profit. Your authorized Gehl Skid Steer Loader dealer is equipped to service your Gehl equipment. They maintain genuine Gehl service parts.

This manual was written for the operator so that he can find the information which he needs to know to correctly prepare, adjust, service and understand this unit.

The operator should read this manual thoroughly so that the important facts about this unit and the contents of the manual are known. The safety of the operator and the reliability and performance of this unit will be determined by the knowledge of the contents of this manual.

Each section of this manual is clearly identified and is divided into smaller sections. The Table of Contents and Index can be used to find the information that is needed.

All service parts should be obtained from or ordered through your Gehl dealer. Give complete information when ordering service parts. The model number and serial number should always be given. Record numbers in the space provided as a handy record for quick reference.

Numbers for this unit are stamped on a plate which is located on the right front surface of the Frame Cross Member.

Gehl Company reserves the right to make changes or improvements in the design or construction of any part without incurring the obligation to install such changes on any unit previously delivered.

“Right” and “Left” are determined from a position sitting on the seat and looking forward. From this position, the Traction T-bar is the left-hand Control and the Lift/Tilt T-bar is the right-hand Control.

IMPORTANT HARDWARE NOTICE

All Cap Screws or Bolts called-out in the Parts Lists are Grade 5 cadmium plated unless otherwise specified.

Hexagon Nuts for Grade 5 Cap Screws or Bolts are Grade “B”. Hexagon Nuts for other Cap Screws or Bolts are Grade “A” unless otherwise specified.

The following abbreviations are used in the Parts Lists:

HHCS	- Hexagon Head Cap Screw
SHCS	- Socket Head Cap Screw
SHSS	- Socket Head Set Screw
HN	- Hexagon Nut
HJN	- Hexagon Jam Nut
HLN	- Hexagon Lock Nut
SN	- Slotted Nut
WN	- Wing Nut
PW	- Plain Washer
LW	- Lock Washer
HLW	- Hexagon Lock Washer
L.H.	- Left-Hand Thread
NF	- National Fine Thread

TABLE OF CONTENTS

	Page	Page
Introduction	3	
Decal Location	4-5	
Main Frame	6-7	
Engine	8-9	
Axle and Drive	10-11	
Reversing Drive	12	
Console and Controls	13	
Transmission	14	
Load Arm	15	
Hydraulics	16-17	
Mechanical Brake	18	
Electrical System	19	
Lift and Tilt Drive	20	
Gear Pump	21	
Hydraulic Cylinders	22-23	
Hydrostatic Transmission		24
Accessories		26-30
Utility Bucket - 50" Wide		26
Utility Bucket - 54" Wide		26
Light Material Bucket		26
Fertilizer Bucket		26
Produce Bucket		26
Manure Fork		27
Pallet Fork		27
Drawbar		27
Bucket Tooth		27
Grapple Fork		28
Light Kit		29
Front Hydraulics Kit		30
Numerical Index		31-33

HL2800 - DECAL LOCATION

Decal Locations are shown to assist in application of new decals in the event of damage to the Decal or refinishing of the machine. Check listing for information and the illustrations for their location.

Surfaces **MUST** be free from dirt, dust, grease and other foreign material before applying the new Decal. To apply, remove the smaller portion of the decal backing paper and apply this part of the exposed adhesive backing to the clean surface while maintaining proper position and alignment. Peel the other portion of the backing paper off slowly while applying hand pressure to smooth out Decal surface.

NOTE: Always order Decals by set number. **DO NOT** order Decals separately.

WARNING: ALWAYS observe Safety Rules shown on the Decals. If Decals become damaged, or if unit is repainted, replace Decals.

NOTICE

Order paint for refinishing machines from this list:

- | | |
|--------|-----------------------------------|
| 901225 | One Gallon Blaze Paint |
| 901226 | One Gallon Maize Paint |
| 610239 | 6 (12 oz.) Cans Blaze Spray Paint |
| 610240 | 6 (12 oz.) Cans Maize Spray Paint |

The Decal Set Number for the HL2800 is 068918. The set includes the following:

- 1 - 057008 Decal - Diesel Fuel
- 2 - 061187 Decal - Grease Fitting (Two Places)
- 3 - 061201 GEHL 3" x 16" (Two Places)
- 4 - 065988 2800 (Two Places)
- 5 - 068425 Decal - WARNING (Two Places)
- 6 - 068487 Decal - Carry Load Low
- 7 - 061312 WARNING - Lift Arm Lock
- 8 - 061268 WARNING - Electrical
- 9 - 060144 WARNING - Read Operator's Manual
- 10 - 061310 WARNING - Fasten Seat Belt
- 11 - 061328 WARNING - DO NOT ENTER
- 12 - 061327 Decal - Slow-Fast (Turtle-Rabbit)
- 13 - 068483 Decal - Brake
- 14 - 063435 Decal - T-bar Control Operation
- 15 - 067518 Decal - Instrument Panel
- 16 - 067914 Decal - Hydraulic Oil Filter Indicator
- 17 - 063074 Decal - Bucket Densities
- 18 - 061313 WARNING - General
- 19 - 068320 GEHL 3" x 17"
- 20 - Decal - Cooling System - NOT Replaceable
- 21 - 055635 Decal - Coolant Under Pressure Symbol
- 22 - 055634 Decal - Engine Oil Symbol (Two Places)
- 23 - 054953 Decal - Hydraulic Oil
- 24 - 068434 WARNING - Replace Guard (Six Places) - Four NOT Shown
- 25 - 061311 WARNING - Carry Load Low

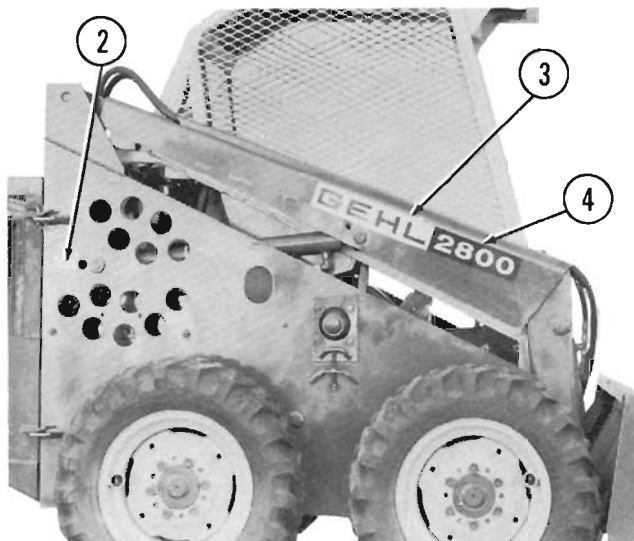
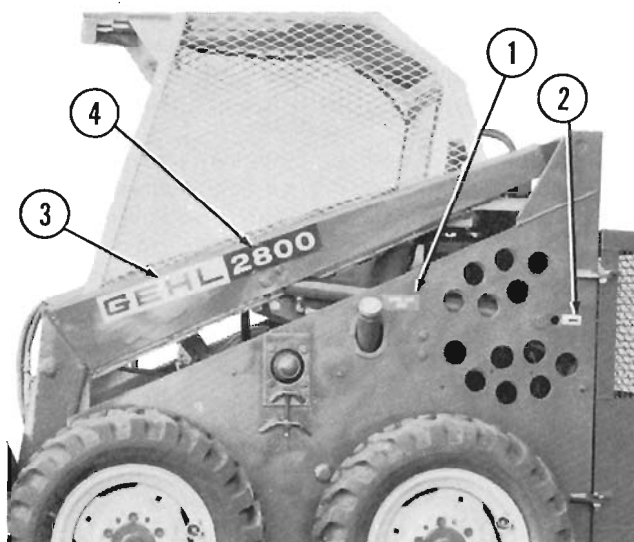
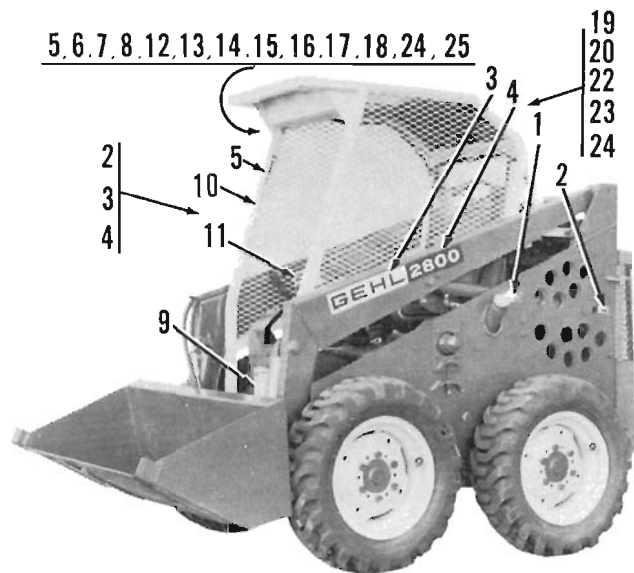

Thanks for your reading.

Please click here to download complete manual instantly.

And can also choose other manuals.

Feel free --->write to me with any questions.

Our service email:

manuals007@hotmail.com