

Parts Manual



See "General Information"
for New Parts Manual
Features.

CB-434D, CB-434DXW Vibratory Compactor

CNH1-Up (Machine)
CRS1-Up (Engine)

Powered By 3054C Engine
This Parts Manual is also available in .pdf Format on Compact Disc
(CD-ROM) - Caterpillar Form No. KERP0245.

Product and Dealer Information

Note: For product identification plate locations, see the section "Product Identification Information" in the Operation and Maintenance Manual.

Delivery Date: _____

Product Information

Model: _____

Product Identification Number: _____

Engine Serial Number: _____

Transmission Serial Number: _____

Generator Serial Number: _____

Attachment Serial Numbers: _____

Attachment Information: _____

Customer Equipment Number: _____

Dealer Equipment Number: _____

Dealer Information

Name: _____ Branch: _____

Address: _____

Dealer Contact

Phone Number

Hours

Sales: _____

Parts: _____

Service: _____

MEMORANDA

TABLE OF CONTENTS

Name	Page	Name	Page
GENERAL INFORMATION	A4	AIR INLET AND EXHAUST SYSTEM	75
REPAIR ALTERNATIVES	A7	AIR CLEANER GP	75
SUPPLEMENTAL COOLANT ADDITIVES	A8	CONNECTION GP-INLET	79
MAINTENANCE PARTS	A9	MANIFOLD GP-EXHAUST	80
INDEX	A14	MUFFLER GP	81
MACHINE ARRANGEMENT	1	FUEL SYSTEM	83
CHASSIS AR	1	CAP GP-FUEL FILLER	83
COMMON AR	1	CONTROL GP-GOVERNOR	84
CONVERSION AR-CERTIFICATION	2	LINES GP-FUEL	86
ENGINE ARRANGEMENT	3	PUMP GP-FUEL INJECTION	87
ENGINE AR	3	PUMP GP-FUEL PRM & PRIM FILTER	93
ENGINE AR-PRIMARY	8	TANK & MTG GP-FUEL	100
INSTALLATION AR-ENGINE	13	TANK GP-FUEL	101
BASIC ENGINE	14	ELECTRICAL AND STARTING SYSTEM	105
CAMSHAFT GP	14	ALTERNATOR GP-CHARGING	105
COVER GP-VALVE MECHANISM	15	BATTERY & WIRING GP	110
CRANKSHAFT GP	21	ELECTRICAL AR	112
CYLINDER BLOCK GP	24	GLOW PLUG GP	113
CYLINDER HEAD GP	27	LAMP GP-DOME	115
DRAIN GP-ENGINE OIL	29	LAMP GP-FLOOD	116
DRIVE GP-ACCESSORY	31	LAMP GP-HEAD	119
DRIVE GP-PUMP	33	LAMP GP-PANEL ILLUMINATION	120
FLYWHEEL GP	34	LAMP GP-ROADING	121
GUARD GP-BELT	35	LAMP GP-WARNING BEACON	122
HOUSING GP-FLYWHEEL	36	LIGHTING GP-CAB	123
HOUSING GP-FRONT	37	LIGHTING GP-FLOOD	124
LIFTING GP-ENGINE	41	LIGHTING GP-ROADING	131
MOUNTING GP-ENGINE	42	LIGHTING GP-WARNING BEACON	132
PAN GP-OIL	44	STARTING MOTOR GP-ELECTRIC	135
PISTON & ROD GP	45	SWITCH GP-DISCONNECT	138
PLUG GP-ENGINE	47	SWITCH GP-POSITION	139
PULLEY GP-CRANKSHAFT	50	WARNING GP-BACKUP	140
VALVE MECHANISM GP	51	WIRING GP-CONSOLE	141
LUBRICATION SYSTEM	52	WIRING GP-ENGINE	148
FILTER GP-ENGINE OIL	52	WIRING GP-MACHINE	150
PUMP GP-ENGINE OIL	53	WIRING GP-PLATFORM	161
VALVE GP-FLUID SAMPLING	54	WIRING GP-REAR	170
COOLING SYSTEM	55	POWER TRAIN	171
CONNECTION GP-WATER	55	DRUM GP-COMPACTOR	171
COOLER GP-FLTR BASE & ENG OIL	56	DRUM GP-SMOOTH	172
LINES GP-COOLANT	60	HYDRAULIC AR-PROPEL	173
MOUNTING GP-RAD & OIL COOLER	63	INSTALLATION GP-DRUM	174
PUMP GP-WATER	65	KIT-REPAIR	175
RADIATOR & HYD OIL COOLER GP	67	LINES GP-PROPEL	176
RECOVERY GP-COOLANT	73	MOTOR & MTG GP-PROPEL	186
		POWER TRAIN AR	188
		PUMP & MTG GP-PROPEL	191
		SHAFT GP-DRIVE	203
		SUPPORT GP-MOTOR	206
		FRAME AND BODY	210
		BUMPER GP	210

TABLE OF CONTENTS

Name	Page	Name	Page
COVER GP	211	VALVE GP-CONTROL	345
COVER GP-SOUND SUPPRESSION	215	VALVE GP-FLUSHING	346
ENCLOSURE GP	216	VALVE GP-PUMP CONTROL	347
ENCLOSURE GP-ENGINE	220	VALVE GP-RELIEF	354
FRAME GP	222	VALVE GP-SIDECUTTER	356
GUARD GP-BOTTOM	226	VALVE GP-SOLENOID	357
GUARD GP-LINES	228		
HANDRAIL GP	229	IMPLEMENTS	360
HITCH AR	231	SIDECUTTER AR	360
HITCH GP-ARTICULATING	232	SIDECUTTER GP	361
HOOD GP	235		
PANEL GP-ENCLOSURE	238	VIBRATORY SYSTEM	382
SCRAPER GP-DRUM	240	HOUSING GP-ECCENTRIC WEIGHT	382
SUPPORT GP-HOOD	247	HYDRAULIC AR-VIBRATORY	388
SUPPRESSION GP-SOUND	249	LINES GP-VIBRATORY	389
		MOTOR & MTG GP-VIBRATORY	397
BRAKING SYSTEM	250	PUMP & MTG GP-VIBRATORY	398
LINES GP-BRAKE & SHIFT	250	SHAFT GP-ECCENTRIC WEIGHT	403
		VALVE & MTG GP-VIBRATORY	404
STEERING SYSTEM	257	VALVE GP-VIBRATORY	408
CONTROL GP-STEERING	257	WEIGHT GP-ECCENTRIC	409
CYLINDER & MTG GP-STEERING	258		
KNOB GP-STEERING	263	WATER SYSTEM	422
LINES GP-STEERING	264	BAR GP-SPRAY	422
PUMP & MTG GP-STEERING	275	FILTER GP-WATER	426
PUMP GP-METERING	279	GAUGE GP-WATER LEVEL	428
STEERING COLUMN GP	280	LINES GP-WATER SPRAY	429
STEERING WHEEL GP	281	MAT & MTG GP-WATER	453
		NOZZLE GP-WATER	457
HYDRAULIC SYSTEM	282	PUMP GP-WATER SPRAY	462
CYLINDER & MTG GP-OFFSET	282	SPRAY AR-WATER	467
CYLINDER GP-HYDRAULIC	284	TANK GP-WATER	468
FILTER & MTG GP-HYDRAULIC	287		
FILTER GP-OIL	289	OPERATOR STATION	471
HEAD GP-PUMP	290	AIR CONDITIONER GP	471
HYDRAULIC AR	294	ARM GP-WINDOW WIPER	472
HYDRAULIC AR-AUXILIARY	294	CAB AR	474
LINES GP-AUXILIARY HYDRAULIC	295	CAB GP	475
LINES GP-FILTER	297	CONSOLE GP-INSTRUMENT	482
LINES GP-HYDRAULIC OIL COOLER	298	CONSOLE GP-OPERATOR	500
MOTOR GP-GEAR	300	CONTROL GP-DIRECTION & SPEED	508
MOTOR GP-PISTON	302	CONTROL GP-HANDLE	515
PUMP GP-GEAR	307	CONTROL GP-SPEED	522
PUMP GP-PISTON	309	FLOOR MAT GP	525
ROTATING GP-MOTOR	323	FLOOR MAT GP-CAB	526
ROTATING GP-PUMP	324	GAUGE GP-VIBRATORY	527
TANK & MTG GP-HYDRAULIC	328	GUARD GP-VANDALISM	529
TANK GP-HYDRAULIC	330	LINES GP-CAB HEATER	530
VALVE & MTG GP-AUXILIARY	334	LOCK GP-ROTATION	532
VALVE & MTG GP-BYPASS	335	MIRROR GP-REAR VIEW	533
VALVE & MTG GP-CONTROL	337	MODULE GP-SPEED & VIBRATORY	535
VALVE & MTG GP-RELIEF	340	MODULE GP-WARNING INDICATOR	539
VALVE & MTG GP-SIDECUTTER	341	MOTOR GP-WINDOW WIPER	541
VALVE & MTG GP-SOLENOID	343	MOUNTING GP-CAB	544
VALVE GP-BYPASS	344	MOUNTING GP-PLATFORM	546

TABLE OF CONTENTS

Name	Page	Name	Page
OPERATOR AR	548		
OPERATOR AR-OPEN ROPS	550		
PANEL GP-CONTROL	551		
PLATFORM GP-OPERATOR	553		
PLATFORM GP-SLIDE	561		
ROPS GP	565		
SEAT GP-SUSPENSION	566		
SPEEDOMETER GP	578		
TANK GP-WINDOW WASHER	580		
VISOR GP-CAB	581		
SERVICE EQUIPMENT AND SUPPLIES	582		
FILM GP	582		
PLATE & FILM GP	590		
PART NUMBER INDEX	B1		

GENERAL INFORMATION

1. MACHINE IDENTIFICATION

Caterpillar machines are identified by Product Identification Numbers (PIN). Some components included in a machine may be identified by Serial Numbers (S/N). Typical components that will be serialized include engines, transmissions, bulldozers, and rippers. The machine and engine are further identified by arrangement numbers and in some cases modification numbers. These numbers are shown on the product identification plate(s) and on the master plate in the operator's compartment.

Caterpillar dealers need all of these numbers to determine accurate parts identification.

New Feature

Effective First Quarter 2001 the Caterpillar Product Identification Number (PIN) changed from 8 to 17 characters. In an effort to provide uniform equipment identification, Caterpillar and other construction equipment manufacturers are moving to comply with the latest version of the product identification numbering standard. Non-road machine PINs are defined by ISO 10261. The new PIN format will apply to all Caterpillar machines and generator sets. The PIN plates and frame marking will display the 17 character PIN. The new format will look like the following:

CAT 0789BG 6SL12345

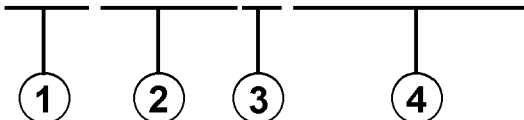

The diagram shows the PIN format: *CAT 0789BG 6SL12345*. Below the first four characters (C, A, T, 0), there are four vertical lines leading to circles containing the numbers 1, 2, 3, and 4 respectively.

Where:

1. Caterpillar's World Manufacturing Code (characters 1-3)
2. Machine Descriptor (characters 4-8)
3. Check Character (character 9)
4. Machine Indicator Section (MIS) or Product Sequence Number (characters 10-17). These were previously referred to as the Serial Number.

Machines and generator sets produced before First Quarter 2001 will maintain their 8 character PIN format.

Components such as engines, transmissions, axles, etc. and work tools will continue to use an 8 character Serial Number (S/N).

2. ORDERING PARTS

WARNING

When replacement parts are required for this product Caterpillar recommends using Caterpillar replacement parts or parts with equivalent specifications including, but not limited to, physical dimensions, type, strength and material.

Failure to heed this warning can lead to premature failures, product damage, personal injury or death.

Quality Caterpillar replacement parts are available from Caterpillar dealers throughout the world. Their parts inventories are up to date and include all parts normally required to protect your investment in Caterpillar machines. Dealers may offer repair kits or remanufactured parts to allow selection of the most effective repair alternative for a particular situation. When ordering parts, your order should specify the quantity, part number, part name, and the serial number/product identification number of the machine for which the parts are needed.

3. PARTS MANUAL ORGANIZATION

Product information in this manual is presented as "information elements" that represent all of the components for the specific model. Engine Arrangement and Seat Group are examples of information elements. The information elements are organized alphabetically by part name and secondarily by part number within each major section of the manual.

4. TABLE OF CONTENTS

A table of contents (TOC) is found at the beginning of the manual. The TOC lists each section of the manual with a complete list of all information elements organized as they appear in the manual. Page numbers are provided for quick reference to detailed parts identification illustrations and serviceable consist lists.

5. MAINTENANCE PARTS INDEX

The Maintenance Parts Index, located near the beginning of the manual, references most frequently used maintenance part numbers, providing description, quantity, usage and page number. This information is organized alphabetically by part description.

GENERAL INFORMATION

6. INDEX

The index located near the front of the manual is an alphabetical listing of all information elements included in the manual. Page numbers are provided for quick reference to detailed parts identification illustrations and serviceable consist lists.

7. PART NUMBER INDEX

A numerical index listing all part numbers and the corresponding page number(s) appears at the back of the manual.

8. CAPTIONS

Captions located at the beginning of each information element identify the part number and part name along with additional descriptive information. PIN and S/N information found in each caption should be used to select correct information for a specific machine. Field replacement options, identification of optional attachment components, and where used ("part of") information is also provided.

The first line of a caption is shown in larger type font to indicate the beginning of an information element. Captions for additional pages that may be required to illustrate an information element will be shown in standard type font and will include the term (*contd.*) .

9. NON-SERVICED PARTS

In some instances it is necessary to display non-serviced parts that are a link to a lower level serviceable consist lists. These non-serviced part numbers are shown in *italic* type indicating that they are not available.

10. PARTS LIST REFERENCE NUMBERS

Numbers shown in the Ref No column correspond to numbers used in the associated graphic(s). An alphabetic suffix may be added to a reference number to identify lower level consist items. Numbers shown in the Graphic Ref column refer to the graphic number identifier displayed in the lower left corner of each illustration. The Graphic Ref number may be used in combination with the item Ref No to determine the correct part number. There may be intentional omission of a Ref No in a consist list as information is updated to reflect the latest serviceable part numbers.

11. INDENTED PART NAMES

When a part name is indented in a parts list, it is part of (included in) the group or assembly under which it is indented.

12. ILLUSTRATION REFERENCE LETTERS

When necessary, illustrations contain reference letters (A, B, C etc.) that are intended to track lines and harnesses from one point to another. They are also used to show where to reconnect illustrations that have been separated.

13. ABBREVIATIONS AND SYMBOLS

O.D. – Outside Diameter
I.D. – Inside Diameter
A – Not Part Of This Group
B – Use As Required
C – Change From Previous Type
D – Order By The Meter
E – Order By The Centimeter
F – Not Shown
G – Order By The Inch
I – Refer To Hydraulic Information System
M – Metric Part
R – Remfg Part May Be Available
Y – Separate Illustration
Z – Not Serviced Separately

 **New Feature**

14. DESCRIPTION OF TYPE CHANGES

Type - A type is defined as any configuration change that requires an additional Information Element for an Arrangement, Group, or Assembly. If serial number breaks for types are not available, a type # (Type 1, Type 2, etc.) will be displayed in the caption. These "type" changes are identified with a "C" note (change from previous type) in the Parts List. Only the "types" that apply to this Parts Manual will be included. Additional types may exist causing "C" notes to appear on an Information Element when no other types are shown.

15.<END>

This symbol indicates the end of an information element.

NOTE:

Continuing improvement and advancement of product design may cause changes to your machine which may not be included in this publication. Whenever a question arises regarding your caterpillar product or this publication, please consult your caterpillar dealer for the latest available information.

GENERAL INFORMATION

8 FRAME AND BODY					
BE-3299 PLATFORM GP-CAB					
PIN 3841-99999					
					100090751
NOTE	REF NO	GRAPHIC REF	PART NUMBER	QTY	PART NAME & PRODUCT LEVEL
			31-2982	1	PLATE AS
			68-2092	25	BOLT (1/4-18X.750IN)
			68-1078	41	WASHER-HARD (3MM THK)
			68-1444	2	SUPPORT AS-FOOT
			77-2229	19	BOLT (1/2-13X1IN)
			77-2229	19	WASHER-HARD (4MM THK)
			68-8126	1	COVER AS-LH
			68-8278	6	NUT-WELD (3/8-16 THD)
			17-8189	1	CLIP
			78-2411	4	COVER
			64-0486	18	SCREW-HEAD (3/8-16X.875IN)
			77-0774	1	COVER
			68-0972	1	GASKET
			68-2468	1	WASHER
			68-2890	1	GASKET
			31-3492	1	HANDHOLD
			68-8278	1	COVER AS
			68-8278	8	NUT-WELD (3/8-16 THD)
			68-8278	1	GASKET
			77-0131	1	FLOORPLATE AS
			17-0742	4	NUT-WELD (1/2-13 THD)
			77-8087	1	PLUG-BUTTON
			77-0136	1	PLATE AS
			68-8278	5	NUT-WELD (3/8-16 THD)
			77-8089	1	COVER
			77-0770	1	GASKET
			31-2981	1	PLATE AS
			81-8484	4	BOLT (1/4-20X.825IN)
			81-8484	4	WASHER-HARD (2MM THK)
			61-8484	1	FLOOR MAT
			68-8484	1	MODULE AS-OPERATOR
			31-3534	1	HANDHOLD
			68-8271	2	PLUG
			81-8384	4	BOLT (1/4-20X.825IN)
			81-8384	4	WASHER-HARD (2MM THK)
			68-8282	17	BOLT (3/8-16X.750IN)
			68-1078	21	WASHER-HARD (3MM THK)
			77-0136	1	SEAL
			78-0278	2	BOLT (3/4-10X5IN)
			78-0282	2	WASHER-HARD (3MM THK)
			31-3482	2	PLATE
			31-6380	1	PLATE AS
			78-0282	8	SPACER
			31-5281	1	SEAL
			78-8817	1	GASKET
			78-8816	1	COVER AS
			28-8278	2	WASHER
			68-8228	2	SCREW-KNURLED
			68-3428	1	COVER
			68-8887	1	COVER
			68-2091	8	SCREW-ROCKET HEAD
			68-3142	8	MOUNTING
			68-0287	2	PLATE
			78-0289	2	BOLT (1/2-8X5IN)
			78-0272	2	WASHER-HARD
			41-8484	4	BOLT (3/8-18X1.02IN)
			31-6783	1	COVER

FRAME AND BODY					
BE-3299 PLATFORM GP-CAB (contd.)					
					100090751
NOTE	REF NO	GRAPHIC REF	PART NUMBER	QTY	PART NAME & PRODUCT LEVEL
	41	2	68-8816	1	COVER
	42	2	77-8124	1	PLATE
	43	2	77-8128	1	GASKET
	44	2	78-8724	1	GASKET
	45	2	78-8728	1	COVER
	48	2	68-1069	2	PLUG-BUTTON

M-METRIC PART

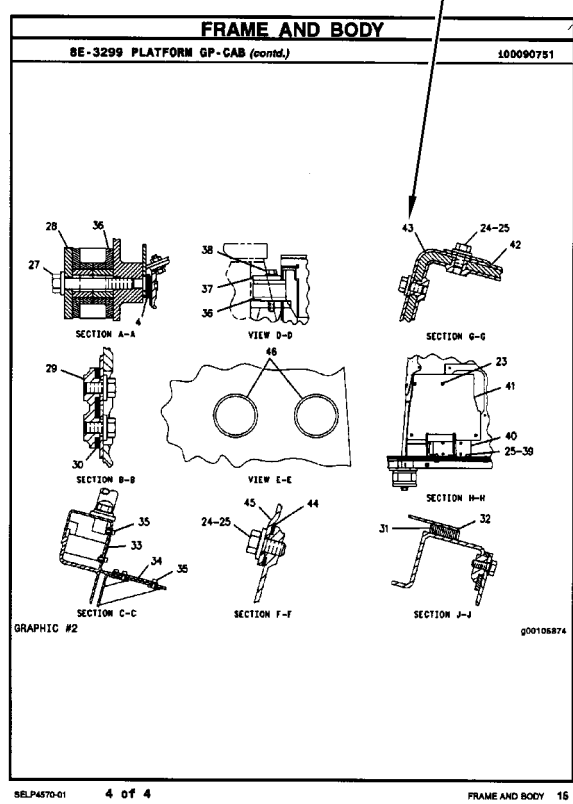
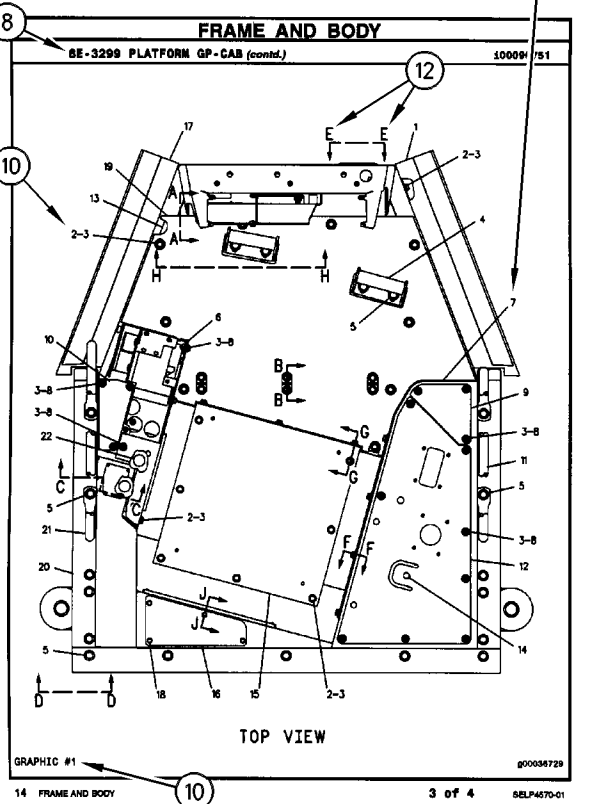

REPAIR ALTERNATIVES

REMANUFACTURED COMPONENTS

As an option when making repairs consider Caterpillar Remanufactured Components. Components that are available through the Caterpillar Remanufactured Program are identified three ways in the parts book:

- with the letter R in the note field of the parts list
- with an R* at the beginning of the first line of the caption
- with an *R at the end of the first line of the caption

Typical components included in the Remanufacturing Program include:

ALTERNATORS
CONNECTING RODS
CRANKSHAFTS - UNDERSIZE
CRANKSHAFTS - UPGRADE TO NEW
CYLINDER HEADS
ELECTRONIC CONTROL MODULES (ECM)
ELECTRONIC SENSORS
FUEL INJECTORS
FUEL NOZZLES
FUEL PUMPS
GOVERNORS
OIL PUMPS
PISTONS
SHORT BLOCKS
STARTERS
TURBOCHARGERS - COMPLETE
TURBOCHARGER CARTRIDGES
WATER PUMPS

Caterpillar Remanufactured engines for many engine arrangements are also available.

SUPPLEMENTAL COOLANT ADDITIVES

CUSTOMER BENEFITS:

Protects against cavitation, foam, erosion, corrosion, and scale buildup in cooling systems.

- Provides measured coolant conditioner.

DESCRIPTION:

Additives deplete from the coolant with normal operation. For this reason, Supplemental Coolant Additives (SCA) must be added to all heavy duty coolants at regular intervals. In addition, when not using a fully formulated, pre-charged antifreeze, like Caterpillar's DEAC, an initial charge of SCA must be added to the cooling system. The amount of SCA added to the system is dependent on the capacity of the system.

The SCA for initial fill is provided as a liquid. SCA's for maintenance intervals are available in liquid form and as a spin-on element. (No Spin-on available for 3600 Family of Engines)

NOTE:

The amount of SCA added at initial fill is not the same as the amount added at maintenance intervals.

The coolant additive elements can be used with any ethylene or propylene glycol type antifreeze which meets ASTM D4985 or ASTM D5345 Specifications.

NOTE:

For use with standard heavy duty coolant only, not for use with Extended Life Coolant.

PARTS NEEDED:

Cooling System Capacity		Liquid SCA at Initial Fill	Liquid SCA at Maintenance*	Spin-on SCA Maintenance Element*
Liters	Gallons			
22-30	(6-8)	3P-2044 (1)	6V-3542 (1)	111-2370 (1)
30-38	(8-10)	3P-2044 (1) 6V-3542 (1)	111-2372 (1)	111-2369 (1)
38-49	(10-13)	3P-2044 (1) 8T-1589 (1)	111-2372 (1)	111-2369 (1)
49-64	(13-17)	3P-2044 (2)	8T-1589 (1)	9N-3368 (1)
64-83	(17-22)	3P-2044 (2) 8T-1589 (1)	111-2372 (1) 6V-3542 (1)	111-2371 (1)
83-114	(22-30)	3P-2044 (3) 8T-1589 (1)	3P-2044 (1)	9N-3718 (1)
114-163	(30-43)	3P-2044 (5)	3P-2044 (1) 6V-3542 (1)	111-2371 (2)
163-242	(43-64)	3P-2044 (8)	3P-2044 (2)	9N-3718 (2)

* Normal maintenance period is 250 hrs. See your Operation and Maintenance Manual for complete coolant maintenance instructions.

() Indicates quantity required.

MAINTENANCE PARTS

DESCRIPTION	PART NUMBER	QTY	WHERE USED	PAGE
AIR INLET AND EXHAUST SYSTEM				
FILTER ELEMENT AS-AIR (PRIMARY)	110-6326	1	AIR CLEANER GP	75
FILTER ELEMENT AS-AIR (SECONDARY)	110-6331	1	AIR CLEANER GP	75
BASIC ENGINE				
CAP-OIL FILLER (ENGINE)	130-9888	1	COVER GP-VALVE MECHANISM	15
		1	COVER GP-VALVE MECHANISM	17
		1	COVER GP-VALVE MECHANISM	19
GASKET (VALVE COVER)	225-6451	1	COVER GP-VALVE MECHANISM	15
		1	COVER GP-VALVE MECHANISM	17
		1	COVER GP-VALVE MECHANISM	19
PLUG-DRAIN (ENGINE OIL)	7C-0351	2	PAN GP-OIL	44
COOLING SYSTEM				
CAP (COOLANT TANK)	115-2186	1	LINES GP-COOLANT	60
		1	LINES GP-COOLANT	61
		1	LINES GP-COOLANT	62
CAP AS-RADIATOR	036-1865	1	RADIATOR & HYD OIL COOLER GP	67
		1	RADIATOR & HYD OIL COOLER GP	69
		1	RADIATOR & HYD OIL COOLER GP	71
CAP-VENTED (COOLANT RECOVERY)	147-9611	1	RECOVERY GP-COOLANT	73
		1	RECOVERY GP-COOLANT	74
HOSE-RADIATOR (LOWER)	190-5055	1	MOUNTING GP-RAD & OIL COOLER	63
HOSE-RADIATOR (UPPER)	190-5054	1	MOUNTING GP-RAD & OIL COOLER	63
REGULATOR AS-WATER TEMPERATURE (CONNECTOR INCLUDED)	254-2268	1	CONNECTION GP-WATER	55
ELECTRICAL AND STARTING SYSTEM				
BATTERY GP (12-VOLT, 950-CCA)	115-2422	1	BATTERY & WIRING GP	110
BELT-DRIVE (WARNING BEACON)	9X-8139	1	LAMP GP-WARNING BEACON	122
		1	LIGHTING GP-WARNING BEACON	132
		1	LIGHTING GP-WARNING BEACON	133
		1	LIGHTING GP-WARNING BEACON	134
CAP AS-FILLER (BATTERY)	123-1373	6	BATTERY & WIRING GP	110
CIRCUIT BREAKER AS (20-AMPERE) (THROTTLE)	6T-3644	1	WIRING GP-ENGINE	148
CIRCUIT BREAKER AS (50-AMPERE) (STARTING AID)	171-2206	1	WIRING GP-ENGINE	148
CIRCUIT BREAKER AS (80-AMPERE) (ALTERNATOR)	171-2210	1	WIRING GP-ENGINE	148
CIRCUIT BREAKER AS (80-AMPERE) (MAIN)	171-2210	1	WIRING GP-ENGINE	148
FLASHER AS (12-VOLT)	7T-4848	1	LIGHTING GP-ROADING	131
FUSE (10-AMPERE)	113-8490	7	WIRING GP-PLATFORM	161
		7	WIRING GP-PLATFORM	163
		7	WIRING GP-PLATFORM	165
		7	WIRING GP-PLATFORM	167
		7	WIRING GP-PLATFORM	168
FUSE (15-AMPERE)	113-8491	5	WIRING GP-PLATFORM	161
		5	WIRING GP-PLATFORM	163
		5	WIRING GP-PLATFORM	165
		5	WIRING GP-PLATFORM	167

MAINTENANCE PARTS

DESCRIPTION	PART NUMBER	QTY	WHERE USED	PAGE
FUSE (20-AMPERE)	113-8492	5	WIRING GP-PLATFORM	168
		4	WIRING GP-PLATFORM	161
		4	WIRING GP-PLATFORM	163
		4	WIRING GP-PLATFORM	165
		4	WIRING GP-PLATFORM	167
GLOW PLUG (12-VOLT)	232-6662	4	WIRING GP-PLATFORM	168
		4	GLOW PLUG GP	113
		4	GLOW PLUG GP	114
		1	SWITCH GP-DISCONNECT	138
		1	LIGHTING GP-ROADING	131
KEY (BATTERY DISCONNECT) LAMP (12-VOLT)	8H-5306	1	SWITCH GP-DISCONNECT	138
	118-6650	1	LIGHTING GP-ROADING	131
	118-9024	1	LIGHTING GP-ROADING	131
	127-1559	1	LIGHTING GP-ROADING	131
	127-1560	1	LIGHTING GP-ROADING	131
LAMP (12-VOLT) (DOME) LAMP (12-VOLT, 15-WATT) LAMP (12-VOLT, 5-WATT)	189-3610	2	LAMP GP-PANEL ILLUMINATION	120
	7M-9957	1	LAMP GP-DOME	115
	081-2751	4	LIGHTING GP-ROADING	131
	108-7605	1	LAMP GP-ROADING	121
		4	LIGHTING GP-ROADING	131
LAMP (12-VOLT, 55-WATT) (FLOODLIGHT)	9W-0607	1	LAMP GP-FLOOD	116
		1	LAMP GP-FLOOD	117
LAMP (12-VOLT, 55-WATT) (WARNING BEACON)	9X-8118	1	LAMP GP-WARNING BEACON	122
		1	LIGHTING GP-WARNING BEACON	132
		1	LIGHTING GP-WARNING BEACON	133
		1	LIGHTING GP-WARNING BEACON	134
		1	LAMP GP-HEAD	119
LAMP (12-VOLT, 55-WATT, HID) (HEAD LAMP)	172-3924	1	LAMP GP-HEAD	119
LAMP-HALOGEN (24-VOLT, 35-WATT) (FLOOD LAMP)	209-6638	1	LAMP GP-FLOOD	118
LENS (AMBER, WARNING BEACON)	9X-8121	1	LIGHTING GP-WARNING BEACON	133
		1	LIGHTING GP-WARNING BEACON	134
LENS (FLOOD LAMP)	211-1382	1	LAMP GP-FLOOD	118
V-BELT (ALTERNATOR)	1N-3743	1	ALTERNATOR GP-CHARGING	107
		1	ALTERNATOR GP-CHARGING	108
FUEL SYSTEM				
CAP GP-FUEL FILLER (EXTREME SERVICE, LOCKABLE)	164-4858	1	TANK GP-FUEL	101
		1	TANK GP-FUEL	103
CAP-FUEL FILLER (LOCKABLE)	276-1243	1	TANK GP-FUEL	103
COVER AS-FILTER (FUEL CAP)	190-9775	1	CAP GP-FUEL FILLER	83
FILTER ELEMENT-BREATHING (FUEL CAP)	279-9876	1	TANK GP-FUEL	103
		1	TANK GP-FUEL	103
FILTER ELEMENT-WTR SEP & FUEL	1R-1804	1	PUMP GP-FUEL PRM & PRIM FILTER	93
		1	PUMP GP-FUEL PRM & PRIM FILTER	95
		1	PUMP GP-FUEL PRM & PRIM FILTER	99
SEAL (FUEL FILTER)	207-2757	1	PUMP GP-FUEL PRM & PRIM FILTER	99
SEAL (WATER SEPARATOR)	207-2757	1	PUMP GP-FUEL PRM & PRIM FILTER	95
STRAINER-FUEL	9P-7121	1	TANK GP-FUEL	101
		1	TANK GP-FUEL	103

MAINTENANCE PARTS

DESCRIPTION	PART NUMBER	QTY	WHERE USED	PAGE
HYDRAULIC SYSTEM				
BREATHER (HYDRAULIC TANK)	171 - 5286	1	TANK & MTG GP-HYDRAULIC	328
		1	TANK & MTG GP-HYDRAULIC	329
CAP AS-FILLER (HYDRAULIC TANK)	142 - 8937	1	TANK GP-HYDRAULIC	330
		1	TANK GP-HYDRAULIC	332
FILTER-OIL (ADVANCED EFFICIENCY) (VIBRATORY)	1G - 8878	1	FILTER GP-OIL	289
SCREEN-FILTER	236 - 5157	1	VALVE GP-PUMP CONTROL	350
SCREEN-SUCTION (HYDRAULIC OIL)	145 - 0878	1	TANK GP-HYDRAULIC	330
		1	TANK GP-HYDRAULIC	332
LUBRICATION SYSTEM				
FILTER AS-ENGINE OIL	7W - 2326	1	FILTER GP-ENGINE OIL	52
OPERATOR STATION				
BLADE AS-WIPER (500-MM) (REAR)	161 - 7524	1	CAB GP	476
BLADE AS-WIPER (900-MM) (FRONT)	248 - 7990	1	CAB GP	475
CAP-VENTED (WINDOW WASHER)	8E - 8292	1	TANK GP-WINDOW WASHER	580
CIRCUIT BREAKER AS (15-AMPERE) (PARKING LIGHT)	6T - 3643	1	CONSOLE GP-OPERATOR	506
CIRCUIT BREAKER AS (15-AMPERE) (PARKING LIGHTS)	6T - 3643	1	CONSOLE GP-OPERATOR	500
		1	CONSOLE GP-OPERATOR	502
		1	CONSOLE GP-OPERATOR	504
CIRCUIT BREAKER AS (20-AMPERE) (WORKING LIGHTS)	6T - 3644	1	CONSOLE GP-OPERATOR	500
		1	CONSOLE GP-OPERATOR	502
		1	CONSOLE GP-OPERATOR	504
		1	CONSOLE GP-OPERATOR	506
FILTER ELEMENT-CAB AIR (AIR CONDITIONER)	250 - 6795	1	AIR CONDITIONER GP	471
FUSE (10-AMPERE)	113 - 8490	1	MODULE GP-SPEED & VIBRATORY	535
		1	MODULE GP-SPEED & VIBRATORY	537
FUSE (10-AMPERE) (RADIO)	113 - 8490	1	CAB GP	476
FUSE (10-AMPERE) (RECORDING MODULE)	113 - 8490	1	CAB GP	476
FUSE (15-AMPERE) (FRONT FAN)	113 - 8491	1	CAB GP	476
FUSE (15-AMPERE) (FRONT WASHER/WIPER)	113 - 8491	1	CAB GP	477
FUSE (15-AMPERE) (HEATER)	113 - 8491	1	CAB GP	477
FUSE (15-AMPERE) (REAR WASHER/WIPER)	113 - 8491	1	CAB GP	477
LAMP (12-VOLT)	8L - 9801	1	GAUGE GP-VIBRATORY	527
LAMP (12-VOLT) (DOME)	7M - 9957	1	CAB GP	476
LAMP (12-VOLT) (FUEL LEVEL INDICATOR)	7X - 9065	1	CONSOLE GP-INSTRUMENT	482
		1	CONSOLE GP-INSTRUMENT	484
		1	CONSOLE GP-INSTRUMENT	486
		1	CONSOLE GP-INSTRUMENT	488
		1	CONSOLE GP-INSTRUMENT	490
		1	CONSOLE GP-INSTRUMENT	492
		1	CONSOLE GP-INSTRUMENT	494
		1	CONSOLE GP-INSTRUMENT	496
		1	CONSOLE GP-INSTRUMENT	498

MAINTENANCE PARTS

DESCRIPTION	PART NUMBER	QTY	WHERE USED	PAGE
LAMP (12-VOLT) (SPEED AND VIBRATORY MODULE)	8L - 9801	1	MODULE GP-SPEED & VIBRATORY	535
		1	MODULE GP-SPEED & VIBRATORY	537
LAMP (12-VOLT) (WATER LEVEL INDICATOR)	7X - 9065	1	PLATFORM GP-OPERATOR	554
		1	PLATFORM GP-OPERATOR	556
		1	PLATFORM GP-OPERATOR	558
LAMP (24-VOLT, 3-WATT)	115 - 1748	1	SPEEDOMETER GP	578
		1	SPEEDOMETER GP	579
LAMP GP-PANEL ILLUMINATION (PARKING BRAKE/NEUTRAL)	223 - 6540	1	CONSOLE GP-INSTRUMENT	488
		1	CONSOLE GP-INSTRUMENT	490
		1	CONSOLE GP-INSTRUMENT	492
		1	CONSOLE GP-INSTRUMENT	494
		1	CONSOLE GP-INSTRUMENT	496
		1	CONSOLE GP-INSTRUMENT	498
LAMP GP-PANEL ILLUMINATION (TURN SIGNAL, LH)	223 - 6540	1	CONSOLE GP-INSTRUMENT	488
		1	CONSOLE GP-INSTRUMENT	490
		1	CONSOLE GP-INSTRUMENT	492
		1	CONSOLE GP-INSTRUMENT	494
		1	CONSOLE GP-INSTRUMENT	496
		1	CONSOLE GP-INSTRUMENT	498
LAMP GP-PANEL ILLUMINATION (TURN SIGNAL, RH)	223 - 6540	1	CONSOLE GP-INSTRUMENT	488
		1	CONSOLE GP-INSTRUMENT	490
		1	CONSOLE GP-INSTRUMENT	492
		1	CONSOLE GP-INSTRUMENT	494
		1	CONSOLE GP-INSTRUMENT	496
		1	CONSOLE GP-INSTRUMENT	498
LAMP GP-PANEL ILLUMINATION (WATER SPRAY)	223 - 6540	1	CONSOLE GP-INSTRUMENT	488
		1	CONSOLE GP-INSTRUMENT	490
		1	CONSOLE GP-INSTRUMENT	492
		1	CONSOLE GP-INSTRUMENT	494
		1	CONSOLE GP-INSTRUMENT	496
		1	CONSOLE GP-INSTRUMENT	498
SCREEN-FILTER (WINDOW WASHER)	8T - 5913	2	TANK GP-WINDOW WASHER	580
SEAT BELT GP (CLOTH)	230 - 6367	1	SEAT GP-SUSPENSION	572
		1	SEAT GP-SUSPENSION	573
SEAT BELT GP (VINYL)	230 - 6367	1	SEAT GP-SUSPENSION	568
		1	SEAT GP-SUSPENSION	569
SERVICE EQUIPMENT AND SUPPLIES				
KEY	5P - 8500	1	PLATE & FILM GP	605
		1	PLATE & FILM GP	607
LAMP (12-VOLT, 15-WATT) (ROADING LIGHTS)	081 - 2751	2	PLATE & FILM GP	599
		2	PLATE & FILM GP	601

MAINTENANCE PARTS

DESCRIPTION	PART NUMBER	QTY	WHERE USED	PAGE
VIBRATORY SYSTEM				
KEY (DRIVE)	215-4229	1	WEIGHT GP-ECCENTRIC	414
		1	WEIGHT GP-ECCENTRIC	416
PLUG-MAGNETIC	5P-4484	1	WEIGHT GP-ECCENTRIC	409
		1	WEIGHT GP-ECCENTRIC	411
		1	WEIGHT GP-ECCENTRIC	419
PLUG-MAGNETIC (ECCENTRIC WEIGHT)	5P-4484	1	WEIGHT GP-ECCENTRIC	414
		1	WEIGHT GP-ECCENTRIC	416
WATER SYSTEM				
CAP (COOLANT TANK)	115-2186	1	LINES GP-WATER SPRAY	433
		1	LINES GP-WATER SPRAY	435
		1	LINES GP-WATER SPRAY	437
		1	LINES GP-WATER SPRAY	438
		1	LINES GP-WATER SPRAY	440
		1	LINES GP-WATER SPRAY	442
		1	LINES GP-WATER SPRAY	449
		1	LINES GP-WATER SPRAY	451
CAP (WATER TANK FILL)	194-3403	1	TANK GP-WATER	468
CAP-FILLER (WATER TANK)	6G-9333	1	TANK GP-WATER	469
STRAINER	219-0349	1	TANK GP-WATER	469
STRAINER (WATER SPRAY NOZZLE)	140-3138	7	BAR GP-SPRAY	422
		7	BAR GP-SPRAY	423
		9	BAR GP-SPRAY	424
STRAINER (WATER SPRAY)	251-7580	1	FILTER GP-WATER	426

INDEX

Name	Page	Name	Page
A			
AIR CLEANER GP-INLET, EXHAUST	75	CAP GP-FUEL FILLER (EXTREME SERVICE, LOCKABLE)	101
AIR CLEANER GP-INSTALLATION	76	CAP GP-FUEL FILLER (LOCKABLE, WITH BOOT)	103
	77	CAP GP-FUEL FILLER- EXTREME SERVICE, LOCKABLE	83
AIR CONDITIONER GP-CAB	471	CAP-FILLER (WATER TANK)	469
ALTERNATOR GP-CHARGING	105	CAP-FUEL FILLER (LOCKABLE)	103
ALTERNATOR GP-CHARGING-ENGINE	107	CAP-OIL FILLER (ENGINE)	15
	108		17
ARM GP-WINDOW WIPER (FRONT)	475		19
ARM GP-WINDOW WIPER (REAR)	476	CAP-VENTED (COOLANT RECOVERY)	73
ARM GP-WINDOW WIPER-FRONT	473		74
ARM GP-WINDOW WIPER-REAR	472	CAP-VENTED (WINDOW WASHER)	580
B			
BAR GP-SPRAY	422	CHASSIS AR	1
	423	CIRCUIT BREAKER AS (15-AMPERE) (PARKING LIGHT)	506
BAR GP-SPRAY-EXTRA WIDE	424	CIRCUIT BREAKER AS (15-AMPERE) (PARKING LIGHTS)	500
BATTERY & WIRING GP	110		502
BATTERY GP (12-VOLT, 950-CCA)	110		504
BELT-DRIVE (WARNING BEACON)	122	CIRCUIT BREAKER AS (20-AMPERE) (THROTTLE)	148
	132	CIRCUIT BREAKER AS (20-AMPERE) (WORKING LIGHTS)	500
	133		502
	134		504
BLADE AS-WIPER (500-MM) (REAR)	476		506
BLADE AS-WIPER (900-MM) (FRONT)	475	CIRCUIT BREAKER AS (50-AMPERE) (STARTING AID)	148
BREATHER (HYDRAULIC TANK)	328	CIRCUIT BREAKER AS (80-AMPERE) (ALTERNATOR)	148
	329	CIRCUIT BREAKER AS (80-AMPERE) (MAIN)	148
BUMPER GP-EXTRA WIDE	210	COMMON AR	1
C			
CAB AR	474		2
CAB GP	475	CONNECTION GP-INLET	79
CAMSHAFT GP	14	CONNECTION GP-WATER	55
CAP (COOLANT TANK)	60	CONSOLE GP-INSTRUMENT	482
	61		484
	62		486
	433		488
	435		490
	437		492
	438		494
	440		496
	442		498
	449	CONSOLE GP-OPERATOR-SIDE	500
	451		502
CAP (WATER TANK FILL)	468		504
CAP AS-FILLER (BATTERY)	110		506
CAP AS-FILLER (HYDRAULIC TANK)	330	CONTROL GP-DIRECTION & SPEED	511
	332		512
CAP AS-RADIATOR	67		513
	69		514
	71		

INDEX

Name	Page	Name	Page
D			
CONTROL GP-DIRECTION & SPEED- ELECTRONIC	508 509 510	DIAPHRAGM (CRANKCASE PRESSURE CONTACTOR) ...	15 17
CONTROL GP-ELECTRONIC (DIRECTION, SPEED)	508 509 513 514	DRAIN AS (FUEL FILTER)	95 99
CONTROL GP-ELECTRONIC FILTER (SERVICE METER)	482	DRAIN GP-ENGINE OIL	29 30
CONTROL GP-GOVERNOR	84 85	DRIVE GP-ACCESSORY	31
CONTROL GP-HANDLE	515 519	DRIVE GP-PUMP	33
CONTROL GP-HANDLE- DIRECTION, SPEED	517 520	DRUM GP-COMPACTOR-EXTRA WIDE	171
CONTROL GP-SPEED	524	DRUM GP-SMOOTH	172
CONTROL GP-SPEED-DIRECTION	522 523	E	
CONTROL GP-STEERING	257	ELECTRICAL AR	112
CONVERSION AR-CERTIFICATION	2	ELECTRONICS GP-MACHINE (DIRECTION, SPEED)	512
COOLANT HEATER LINES	530	ELECTRONICS GP-MACHINE (VIBRATORY) (DIRECTION, SPEED)	511
COOLER GP-FLTR BASE & ENG OIL	56 58	ENCLOSURE GP	216 218
CORE AS-HEATER	471	ENCLOSURE GP-ENGINE	220
COVER AS-FILTER (FUEL CAP)	83	ENGINE AR	3 4 5 6 7
COVER GP	211 212 214	ENGINE AR-PRIMARY	8 9
COVER GP-SOUND SUPPRESSION	215		10 11 12
COVER GP-VALVE MECHANISM	15 17 19	F	
CRANKSHAFT GP	21 23	FASTENER GP-SEAT (CLOTH)	572 573
CYLINDER & MTG GP-OFFSET	282 283	FASTENER GP-SEAT (VINYL)	568 569
CYLINDER & MTG GP-STEERING	258 260 262	FILLER GP-ENGINE OIL	15 17
CYLINDER BLOCK GP	24 26	FILM (DIRECTION AND SPEED CONTROL) ...	508 509
CYLINDER GP-HYDRAULIC	260	FILM (DIRECTION, SPEED CONTROL)	510 511 512 513 514
CYLINDER GP-HYDRAULIC (STEERING)	286	FILM (EXTERIOR SOUND, 106-DB)	598
CYLINDER GP-HYDRAULIC-STEERING	284 285 286	FILM (EXTERIOR)	597
CYLINDER HEAD GP	27 28	FILM (VARIABLE SPEED CONTROL)	587
		FILM (WATER SPRAY CONTROL)	482 484

INDEX

Name	Page	Name	Page
	486	FILTER & MTG GP-HYDRAULIC	287
	488	FILTER AS-ENGINE OIL	52
	490	FILTER BASE & ENG OIL COOLER	56
	492		58
	494	FILTER ELEMENT AS-AIR (PRIMARY)	75
	496	FILTER ELEMENT AS-AIR (SECONDARY)	75
	498	FILTER ELEMENT-BREATHER (FUEL CAP)	103
FILM GP	548	FILTER ELEMENT-CAB AIR (AIR CONDITIONER)	471
	550		93
	585	FILTER ELEMENT-WTR SEP & FUEL	95
	586		99
	587		52
FILM GP (CAB)	474	FILTER GP-ENGINE OIL	289
FILM GP-CAB	588	FILTER GP-OIL-HYDRAULIC	426
FILM GP-CB-434D	583	FILTER GP-WATER-WATER SPRAY	427
	584	FILTER-OIL (ADVANCED EFFICIENCY) (VIBRATORY)	289
FILM GP-ROUND RED REFLECTIVE	582	FLASHER AS (12-VOLT)	131
FILM-IDENTIFICATION (12-VOLT)	590	FLOOR MAT GP	525
	605	FLOOR MAT GP-CAB	526
	607	FLYWHEEL GP	34
FILM-IDENTIFICATION (CIRCUIT PANEL)	148	FRAME GP	222
FILM-IDENTIFICATION (POWER RECEPTACLE, 12-VOLT)	587		223
	592		224
FILM-INFORMATION (OPERATOR CONTROLS)	482	FUSE (10-AMPERE)	161
	484		163
	486		165
	488		167
	490		168
	492		535
	494	FUSE (10-AMPERE) (RADIO)	537
	496	FUSE (10-AMPERE) (RECORDING MODULE)	476
	498	FUSE (15-AMPERE)	476
FILM-INFORMATION (ROPS, FOPS, READ OMM)	565		161
FILM-INFORMATION (ROPS, READ OMM)	560		163
FILM-INSTRUCTION (ENGINE START)	500		165
	502	FUSE (15-AMPERE) (FRONT FAN)	168
	504	FUSE (15-AMPERE) (FRONT WASHER/WIPER)	476
	506	FUSE (15-AMPERE) (HEATER)	477
FILM-INSTRUCTION (SIGHT GAUGE) (HYDRAULIC OIL LEVEL)	330	FUSE (15-AMPERE) (REAR WASHER/WIPER)	477
	332	FUSE (20-AMPERE)	161
FILM-STRIFE	590		163
FILM-STRIFE (117-CM EACH)	605		165
	607		167
FILM-TRANSMISSION	605		168
	607		
	609		
FILM-WARNING (NO WELD, NO DRILL, READ OMM)	560		
	565		

G

GASKET (VALVE COVER)	15
----------------------------	----

INDEX

Name	Page	Name	Page
	498		117
INDICATOR AS (WATER LEVEL).....	554	LAMP (12-VOLT, 55-WATT) (WARNING BEACON).....	122
	556		132
	558		133
INDICATOR-AIR FILTER SERVICE.....	76		134
	77		119
INDICATOR-BLADE.....	204	LAMP (12-VOLT, 55-WATT, HID) (HEAD LAMP)...	578
	205	LAMP (24-VOLT, 3-WATT).....	579
	382		476
	383	LAMP GP-DOME (WITH SWITCH).....	115
INSTALLATION AR-ENGINE.....	13	LAMP GP-DOME-WITH SWITCH.....	118
INSTALLATION GP-DRUM.....	174	LAMP GP-FLOOD-FRONT CAB.....	116
		LAMP GP-FLOOD-ROADING LIGHTS.....	117
			119
		LAMP GP-HEAD.....	119
		LAMP GP-PANEL ILLUMINATION (PARKING BRAKE/NEUTRAL).....	482
K			484
KEY.....	605		486
	607		488
KEY (BATTERY DISCONNECT).....	138		490
KEY (DRIVE).....	414		492
	416		494
KIT-RECEPTACLE (2-PIN).....	443		496
	445		498
KIT-REPAIR.....	175		482
KNOB GP-STEERING.....	263	LAMP GP-PANEL ILLUMINATION (TURN SIGNAL, LH).....	484
			486
			488
			490
			492
			494
			496
			498
			490
			492
			494
			496
			498
			490
			492
			494
			496
			498
			490
			492
			494
			496
			498
			482
			484
			486
			488
			490
			492
			494
			496
			498
			482
			484
			486
			488
			490
			492
			494
			496
			498
			482
			484
			486
			488
			490
			492
			494
			496
			498
			482
			484
			486
			488
			490
			492
			494
			496
			498
			482
			484
			486
			488
			490
			492
			494
			496
			498
			482
			484
			486
			488
			490
			492
			494
			496
			498
			482
			484
			486
			488
			490
			492
			494
			496
			498

INDEX

Name	Page	Name	Page
N			
NOZZLE GP-WATER	459	PLATE-WARNING (OPERATOR INSTRUCTION)	601
	460	PLATFORM GP-OPERATOR	553
	461	PLATFORM GP-OPERATOR-CAB	560
NOZZLE GP-WATER-BRASS	457	PLATFORM GP-OPERATOR-STEERING	554
NOZZLE GP-WATER-PLASTIC	458		556
O			
OPERATOR AR-BASIC	548	PLATFORM GP-SLIDE	561
OPERATOR AR-ITALIAN ROADING	549		563
	550	PLUG GP-ENGINE	47
OPERATOR AR-OPEN	548		48
OPERATOR AR-OPEN ROPS	550		49
P			
PADLOCK GP	529	PLUG-DRAIN (ENGINE OIL)	44
	554	PLUG-MAGNETIC	409
	556		411
	558		419
	590	PLUG-MAGNETIC (ECCENTRIC WEIGHT)	414
	605		416
	607	POTENTIOMETER AS	482
	609		484
PAN GP-OIL-ENGINE	44		486
PANEL GP-CONTROL-SIDECUTTER	551		488
PANEL GP-ENCLOSURE	238		490
	239		492
PISTON & ROD GP	45		494
PLATE & FILM GP-BODY	605		496
	607		498
	609		498
PAN GP-OIL-ENGINE	44		523
PANEL GP-CONTROL-SIDECUTTER	551		524
PANEL GP-ENCLOSURE	238	POWER TRAIN AR	188
	239		189
PISTON & ROD GP	45		190
PLATE & FILM GP-BODY	605	POWER TRAIN AR-EXTRA WIDE	189
	607	PULLEY GP-CRANKSHAFT	50
	609	PUMP & MTG GP-PROPEL	191
PLATE & FILM GP-CERTIFICATION	597		193
	598		195
PLATE & FILM GP-CHASSIS	590		197
PLATE & FILM GP-ENGLISH	591		199
	592		201
PLATE & FILM GP-FRENCH	593	PUMP & MTG GP-STEERING-AUXILIARY	275
PLATE & FILM GP-GERMAN	594		277
PLATE & FILM GP-ITALIAN	599	PUMP & MTG GP-VIBRATORY	398
	601		400
PLATE & FILM GP-PORTUGUESE	595		401
PLATE & FILM GP-SPANISH	596		402
PLATE-IDENTIFICATION (ECCENTRIC WEIGHT)	409	PUMP GP-ENGINE OIL	53
	411	PUMP GP-FUEL INJECTION	87
	414		88
	416		91
	419	PUMP GP-FUEL PRM & PRIM FILTER	93
PLATE-WARNING (DUMP BODY PROP)	601		95
PLATE-WARNING (NO CLEARANCE, ITALIAN)	601		97
			99
		PUMP GP-GEAR-STEERING	307

INDEX

Name	Page	Name	Page
SEAT GP-SUSPENSION-VINYL	566	STRAINER (WATER SPRAY NOZZLE)	422
	576		423
SEAT GP-SUSPENSION-VINYL- LITERATURE LANYARD	568		424
	569	STRAINER (WATER SPRAY)	426
SENDER AS-FUEL LEVEL	101	STRAINER-FUEL	101
	103		103
SENSOR (VOLTAGE THRESHOLD)	535	SUN VISOR	581
	537	SUPPORT GP-HOOD	247
SENSOR AS	519	SUPPORT GP-MOTOR	209
SENSOR AS (NEUTRAL POSITION)	520	SUPPORT GP-MOTOR-EXTRA WIDE	208
SENSOR AS-SPEED (LOW OUTPUT)	527	SUPPORT GP-MOTOR-PROPEL	206
SENSOR GP-POSITION	520	SUPPORT GP-MOTOR-VIBRATORY	207
SENSOR GP-POSITION (DIRECTION, SPEED)	517	SUPPRESSION GP-SOUND	249
	520	SWITCH (AIR CONDITIONER CONTROL)	471
SENSOR GP-SPEED	158	SWITCH (OFFSET CYLINDER)	139
SENSOR GP-SPEED (DRUM)	150	SWITCH AS (DRUM SELECT)	482
	154		484
SHAFT GP-DRIVE	203		486
	204		488
	205		490
SHAFT GP-ECCENTRIC WEIGHT	403		492
	409		494
	411		496
	419	SWITCH AS (HAZARD)	498
SIDECUTTER AR-EDGE	360	SWITCH AS (WARNING BEACON)	131
SIDECUTTER GP	361		132
	363		133
	365		134
SIDECUTTER GP-OFFSET	367	SWITCH AS (WATER SPRAY)	551
	370	SWITCH AS (WORK LIGHTS)	482
	373		484
	376		486
	379		488
SOLENOID (12 VDC)	347		490
	350		494
	352		496
SOLENOID (PUMP CONTROL)	349	SWITCH AS-MAGNETIC (HIGH INTENSITY LIGHTING)	498
	359		123
SOLENOID AS (VIBRATORY VALVE)	408		124
SOLENOID GP	84		126
	85		129
SPEEDOMETER GP	578	SWITCH AS-MAGNETIC (PROPEL SENSOR)	130
	579		500
SPRAY AR-WATER	467		502
SPRING AS (STEERING COLUMN)	280		504
SPRING AS-GAS (STEERING COLUMN)	554		506
	556	SWITCH AS-PRESSURE (ENGINE OIL)	148
STARTING MOTOR GP-ELECTRIC	135	SWITCH AS-PRESSURE (HYDRAULIC OIL)	287
	136		289
	137	SWITCH AS-PUSH BUTTON (PARKING BRAKE)	500
STEERING COLUMN GP	280		502
STEERING WHEEL GP	281		504
STRAINER	469		506

INDEX

Name	Page	Name	Page
SWITCH AS-ROCKER (HEADLIGHTS)	496		490
	498		492
SWITCH AS-ROCKER (HEADLIGHTS) (MASTER)	482		494
	484		496
	486	SWITCH GP-DISCONNECT-BATTERY	138
	488	SWITCH GP-MAGNETIC (GLOW PLUG RELAY)	148
	490	SWITCH GP-MAGNETIC (STARTER RELAY)	148
SWITCH AS-ROCKER (HIGH INTENSITY LIGHTING)	123	SWITCH GP-POSITION-OFFSET CYLINDER	139
	124	SWITCH GP-START (KEY)	500
	126		502
	129		504
	130		506
SWITCH AS-ROCKER (ROADING LIGHTS)	492	SWITCH GP-TEMPERATURE (HYDRAULIC OIL)	330
	494		332
SWITCH AS-ROCKER (SIDECUTTER)	551	SWITCH-TEMPERATURE (FUEL)	91
SWITCH AS-ROCKER (THROTTLE CONTROL)	500	SWITCH-TEMPERATURE (TIMING ADVANCE)	88
	502		
	504		
	506		
SWITCH AS-ROCKER (TURN SIGNAL)	131		
SWITCH AS-ROCKER (VIBRATORY AMPLITUDE)	401		
	402		
SWITCH AS-ROCKER (VIBRATORY AMPLITUDE) (VIBRATING HIGH/LOW)	398		
SWITCH AS-ROCKER (WATER PUMP SELECT)	482		
	484		
	486		
	488		
	490		
	492		
	494		
	496		
	498		
SWITCH AS-ROTARY (24-VOLT) (FAN CONTROL)	475		
SWITCH AS-ROTARY (FAN SPEED)	471		
SWITCH AS-ROTARY (WIPER, WASHER) (FRONT WIPER)	475		
SWITCH AS-ROTARY (WIPER, WASHER) (REAR WIPER)	475		
SWITCH AS-TEMPERATURE (ENGINE COOLANT)	148		
SWITCH AS-TOGGLE (2-SPEED)	599		
	601		
SWITCH AS-TOGGLE (VIBRATORY CONTROL)	482		
	484		
	486		
	488		
		T	
		TANK & MTG GP-FUEL	100
		TANK & MTG GP-HYDRAULIC	328
			329
		TANK GP-COOLANT	60
			61
			62
			433
			435
			437
			438
			440
			442
			449
			451
		TANK GP-FUEL	101
			103
		TANK GP-HYDRAULIC-CHASSIS	330
			332
		TANK GP-WATER	469
		TANK GP-WATER-BASIC	468
		TANK GP-WINDOW WASHER	580
		TIMER (SERVICE HOUR INDICATOR)	500
		V	
		V-BELT (ALTERNATOR)	107
			108
		VALVE & MTG GP-AUXILIARY	334
		VALVE & MTG GP-BYPASS- HYDRAULIC OIL COOLER	335
		VALVE & MTG GP-CONTROL	338
		VALVE & MTG GP-CONTROL-BRAKE	337

INDEX

Name	Page	Name	Page
VALVE & MTG GP-RELIEF-SIDECUTTER	340	WIRING GP-CONSOLE	141
VALVE & MTG GP-SIDECUTTER	341		143
VALVE & MTG GP-SOLENOID (AUXILIARY)	334		145
VALVE & MTG GP-SOLENOID-AUXILIARY	343		146
VALVE & MTG GP-VIBRATORY	404	WIRING GP-ENGINE	148
	406	WIRING GP-MACHINE	150
VALVE AS-SOLENOID			154
(WATER SPRAY CONTROL)	443		158
	445	WIRING GP-PLATFORM	165
	447		167
VALVE GP-BYPASS-			168
HYDRAULIC OIL COOLER	344	WIRING GP-PLATFORM-CONSOLE	161
VALVE GP-CHECK & RELIEF (SIDECUTTER)	340		163
VALVE GP-CONTROL-OFFSET DRUM	345	WIRING GP-REAR	170
VALVE GP-FLUID SAMPLING	54		
	63		
VALVE GP-FLUSHING-PROPEL PUMP	346		
VALVE GP-PUMP CONTROL-PISTON	350		
VALVE GP-PUMP CONTROL-PRESSURE-			
VIBRATORY	349		
VALVE GP-PUMP CONTROL-PROPEL	347		
	352		
VALVE GP-RELIEF	290		
	293		
VALVE GP-RELIEF (MULTIFUNCTION)	290		
VALVE GP-RELIEF-PISTON	355		
VALVE GP-RELIEF-PRESSURE OVERRIDE	354		
VALVE GP-SIDECUTTER	356		
VALVE GP-SOLENOID (12-VOLT)			
(FUEL SHUTOFF)	87		
VALVE GP-SOLENOID (AUXILIARY)	343		
VALVE GP-SOLENOID (BASIC)	317		
VALVE GP-SOLENOID-AUXILIARY	358		
VALVE GP-SOLENOID-BASIC	359		
VALVE GP-SOLENOID-SOLENOID VALVE	357		
VALVE GP-VIBRATORY			
(HYDRAULIC CONTROL)	404		
	406		
VALVE GP-VIBRATORY-			
HYDRAULIC CONTROL	408		
VALVE MECHANISM GP	51		
VISOR GP-CAB	581		

W

WARNING GP-BACKUP	140
WEIGHT GP-ECCENTRIC	409
	411
	414
	416
	419
	421
WEIGHT GP-ECCENTRIC-2-AMPERE	413
	418
WEIGHT GP-ECCENTRIC-5-AMPERE	418

MACHINE ARRANGEMENT

183-4753 CHASSIS AR

S/N: CNH1-506

PART OF 183-4752 COMMON AR

SMCS-7000

i03473260

NOTE	PART NUMBER	QTY	PART NAME						SEE PAGE
			1	2	3	4	5	6 (PRODUCT LEVEL)	
Y	219-4198	2	COVER GP						211
Y	190-6066	1	ENCLOSURE GP-ENGINE						220
Y	231-3811	1	FILM GP (ROUND RED REFLECTIVE)						582
Y	184-3492	1	FRAME GP						222
Y	217-6444	1	HITCH GP-ARTICULATING (CHASSIS)						232
Y	192-8835	1	PLATE & FILM GP (CHASSIS)						590
Y	219-4475	2	SCRAPER GP-DRUM						240
Y	195-5010	1	TANK & MTG GP-FUEL						100
Y	195-5012	1	TANK & MTG GP-HYDRAULIC						328

Y-SEPARATE ILLUSTRATION

<END>

270-4432 CHASSIS AR

S/N: CNH507-UP

PART OF 272-6511, 318-4329 COMMON AR

SMCS-7000

i02420157

NOTE	PART NUMBER	QTY	PART NAME						SEE PAGE
			1	2	3	4	5	6 (PRODUCT LEVEL)	
Y	231-3811	1	FILM GP (ROUND RED REFLECTIVE)						582
Y	184-3492	1	FRAME GP						222
Y	217-6444	1	HITCH GP-ARTICULATING (CHASSIS)						232
Y	270-4233	1	PLATE & FILM GP (BODY)						605
Y	195-5010	1	TANK & MTG GP-FUEL						100
Y	195-5012	1	TANK & MTG GP-HYDRAULIC						328

Y-SEPARATE ILLUSTRATION

<END>

183-4752 COMMON AR

S/N: CNH1-506

SMCS-7000

i02407264

NOTE	PART NUMBER	QTY	PART NAME						SEE PAGE
			1	2	3	4	5	6 (PRODUCT LEVEL)	
Y	183-4753	1	CHASSIS AR						1
Y	183-4754	1	ELECTRICAL AR						112
Y	179-1789	1	ENGINE AR-PRIMARY						8
Y	183-4757	1	HYDRAULIC AR-AUXILIARY						294
Y	183-4756	1	HYDRAULIC AR-PROPEL						173
Y	183-4758	1	HYDRAULIC AR-VIBRATORY						388
Y	183-4759	1	INSTALLATION AR-ENGINE						13
Y	185-3497	1	POWER TRAIN AR						188
Y	183-4763	1	SPRAY AR-WATER						467

Y-SEPARATE ILLUSTRATION

<END>

MACHINE ARRANGEMENT

272-6511 COMMON AR

S/N: CNH507-823

SMCS-7000

i02462452

NOTE	PART NUMBER	QTY	PART NAME						SEE PAGE
			1	2	3	4	5	6 (PRODUCT LEVEL)	
Y	270-4432	1	CHASSIS AR						1
Y	183-4754	1	ELECTRICAL AR						112
Y	179-1789	1	ENGINE AR-PRIMARY						8
Y	183-4757	1	HYDRAULIC AR-AUXILIARY						294
Y	275-0487	1	HYDRAULIC AR-VIBRATORY						388
Y	183-4759	1	INSTALLATION AR-ENGINE						13
Y	270-4454	1	SPRAY AR-WATER						467

Y-SEPARATE ILLUSTRATION

<END>

318-4329 COMMON AR

S/N: CNH824-UP

SMCS-7000

i02995869

NOTE	PART NUMBER	QTY	PART NAME						SEE PAGE
			1	2	3	4	5	6 (PRODUCT LEVEL)	
Y	270-4432	1	CHASSIS AR						1
Y	183-4754	1	ELECTRICAL AR						112
Y	183-4757	1	HYDRAULIC AR-AUXILIARY						294
Y	275-0487	1	HYDRAULIC AR-VIBRATORY						388
Y	270-4454	1	SPRAY AR-WATER						467

Y-SEPARATE ILLUSTRATION

<END>

254-3869 CONVERSION AR-CERTIFICATION

S/N: CNH1-UP
AN ATTACHMENT

SMCS-7000

i02541427

NOTE	PART NUMBER	QTY	PART NAME						SEE PAGE
			1	2	3	4	5	6 (PRODUCT LEVEL)	
Y	290-9934	1	COVER GP-SOUND SUPPRESSION						215
Y	263-4988	1	ENCLOSURE GP						216
Y	239-7180	1	PLATE & FILM GP (CERTIFICATION)						597
Y	254-3787	1	SUPPRESSION GP-SOUND						249

Y-SEPARATE ILLUSTRATION

<END>

ENGINE ARRANGEMENT

318-4346 ENGINE AR

S/N: CNH1-UP
AN ATTACHMENT

SMCS - 1000

i02995990

NOTE	PART NUMBER	QTY	PART NAME						SEE PAGE
			1	2	3	4	5	6 (PRODUCT LEVEL)	
Y	179-1789	1	ENGINE AR-PRIMARY						8
Y	183-4759	1	INSTALLATION AR-ENGINE						13
Y-SEPARATE ILLUSTRATION									

ENGINE ARRANGEMENT

318-4347 ENGINE AR

S/N: CNH1-UP
AN ATTACHMENT

SMCS - 1000

i02995984

NOTE	PART NUMBER	QTY	PART NAME						SEE PAGE
			1	2	3	4	5	6 (PRODUCT LEVEL)	
Y	297-4049	1	ENGINE AR-PRIMARY						9
Y	183-4759	1	INSTALLATION AR-ENGINE						13
Y-SEPARATE ILLUSTRATION									

ENGINE ARRANGEMENT

318-4348 ENGINE AR

S/N: CNH1-UP
AN ATTACHMENT

SMCS - 1000

i02995987

NOTE	PART NUMBER	QTY	PART NAME						SEE PAGE
			1	2	3	4	5	6 (PRODUCT LEVEL)	
Y	309-0737	1	ENGINE AR-PRIMARY						11
Y	183-4759	1	INSTALLATION AR-ENGINE						13
Y-SEPARATE ILLUSTRATION									

ENGINE ARRANGEMENT

318-4349 ENGINE AR

S/N: CNH1-UP
AN ATTACHMENT

SMCS - 1000

i02995989

NOTE	PART NUMBER	QTY	PART NAME						SEE PAGE
			1	2	3	4	5	6 (PRODUCT LEVEL)	
Y	309-0730	1	ENGINE AR-PRIMARY						10
Y	183-4759	1	INSTALLATION AR-ENGINE						13
Y-SEPARATE ILLUSTRATION									

ENGINE ARRANGEMENT

331-0141 ENGINE AR

S/N: CNH1-UP
AN ATTACHMENT

SMCS - 1000

i03534720

NOTE	PART NUMBER	QTY	PART NAME						SEE PAGE
			1	2	3	4	5	6 (PRODUCT LEVEL)	
Y	329-2196	1	ENGINE AR-PRIMARY						12
Y	183-4759	1	INSTALLATION AR-ENGINE						13
Y-SEPARATE ILLUSTRATION									

ENGINE ARRANGEMENT

179-1789 ENGINE AR-PRIMARY

S/N: CRS1-UP

61 BRAKE KW (82 BHP) AT 2200 RPM

PART OF 183-4752, 272-6511 COMMON AR, 318-4346 ENGINE AR
ALSO AN ATTACHMENT

SMCS-1000

i03091599

NOTE	PART NUMBER	QTY	PART NAME						SEE PAGE
			1	2	3	4	5	6 (PRODUCT LEVEL)	
Y	233-7236	1	CAMSHAFT GP						14
Y	244-3501	1	CONNECTION GP-INLET						79
Y	230-8086	1	CONNECTION GP-WATER						55
Y	253-2472	1	COOLER GP-FLTR BASE & ENG OIL						56
Y	230-9151	1	COVER GP-VALVE MECHANISM						15
Y	233-7027	1	CRANKSHAFT GP						23
Y	233-7007	1	CYLINDER BLOCK GP						26
Y	233-7234	1	CYLINDER HEAD GP						28
Y	231-0055	1	DRIVE GP-ACCESSORY						31
Y	232-7378	1	FILTER GP-ENGINE OIL						52
Y	230-7286	1	FLYWHEEL GP						34
Y	232-6661	1	GLOW PLUG GP						113
Y	223-7825	1	HOUSING GP-FLYWHEEL						36
Y	232-6179	1	HOUSING GP-FRONT						37
Y	233-7432	1	LIFTING GP-ENGINE						41
Y	231-0292	1	MANIFOLD GP-EXHAUST						80
Y	232-6206	1	MOUNTING GP-ENGINE						43
Y	230-8144	1	PAN GP-OIL (ENGINE)						44
Y	233-7233	1	PISTON & ROD GP						45
Y	225-4317	1	PLUG GP-ENGINE						47
Y	253-2479	1	PLUG GP-ENGINE						49
Y	232-6204	1	PLUG GP-ENGINE						48
Y	230-7353	1	PULLEY GP-CRANKSHAFT						50
Y	230-7578	1	PUMP GP-ENGINE OIL						53
Y	267-9413	1	PUMP GP-FUEL INJECTION						88
Y	233-7425	1	PUMP GP-FUEL PRM & PRIM FILTER						93
Y	230-7355	1	PUMP GP-WATER						65
Y	328-6009	1	STARTING MOTOR GP-ELECTRIC						137
Y	233-7235	1	VALVE MECHANISM GP						51
AVAILABLE GASKET KIT(S):									
	276-3420	1	KIT-GASKET (TOP)						
	272-0494	1	KIT-GASKET (BOTTOM)						

Y-SEPARATE ILLUSTRATION

ENGINE ARRANGEMENT

297-4049 ENGINE AR-PRIMARY

S/N: CRS1-UP

62 BRAKE KW (83 BHP) AT 2200 RPM

PART OF 318-4347 ENGINE AR

AN ATTACHMENT

SMCS-1000

i03099759

NOTE	PART NUMBER	QTY	PART NAME						SEE PAGE
			1	2	3	4	5	6 (PRODUCT LEVEL)	
Y	233-7236	1	CAMSHAFT GP						14
Y	244-3501	1	CONNECTION GP-INLET						79
Y	230-8086	1	CONNECTION GP-WATER						55
Y	253-2472	1	COOLER GP-FLTR BASE & ENG OIL						56
Y	230-9151	1	COVER GP-VALVE MECHANISM						15
Y	233-7027	1	CRANKSHAFT GP						23
Y	233-7007	1	CYLINDER BLOCK GP						26
Y	233-7234	1	CYLINDER HEAD GP						28
Y	231-0055	1	DRIVE GP-ACCESSORY						31
Y	232-7378	1	FILTER GP-ENGINE OIL						52
Y	230-7286	1	FLYWHEEL GP						34
Y	232-6661	1	GLOW PLUG GP						113
Y	223-7825	1	HOUSING GP-FLYWHEEL						36
Y	232-6179	1	HOUSING GP-FRONT						37
Y	233-7432	1	LIFTING GP-ENGINE						41
Y	231-0292	1	MANIFOLD GP-EXHAUST						80
Y	232-6206	1	MOUNTING GP-ENGINE						43
Y	230-8144	1	PAN GP-OIL (ENGINE)						44
Y	233-7233	1	PISTON & ROD GP						45
Y	225-4317	1	PLUG GP-ENGINE						47
Y	232-6204	1	PLUG GP-ENGINE						48
Y	253-2479	1	PLUG GP-ENGINE						49
Y	230-7353	1	PULLEY GP-CRANKSHAFT						50
Y	230-7578	1	PUMP GP-ENGINE OIL						53
Y	267-9413	1	PUMP GP-FUEL INJECTION						88
Y	233-7425	1	PUMP GP-FUEL PRM & PRIM FILTER						93
Y	230-7355	1	PUMP GP-WATER						65
Y	234-9666	1	STARTING MOTOR GP-ELECTRIC						135
Y	233-7235	1	VALVE MECHANISM GP						51
	267-5367	1	CYLINDER BLOCK GP-SHORT						
			AVAILABLE GASKET KIT(S):						
	272-0494	1	KIT-GASKET (BOTTOM)						
	277-2992	1	KIT-GASKET (TOP)						
Y-SEPARATE ILLUSTRATION									

ENGINE ARRANGEMENT

309-0730 ENGINE AR-PRIMARY

S/N: CRS1-UP

61 BRAKE KW (82 BHP) AT 2200 RPM

PART OF 318-4349 ENGINE AR

AN ATTACHMENT

SMCS-1000

i03099764

NOTE	PART NUMBER	QTY	PART NAME						SEE PAGE
			1	2	3	4	5	6 (PRODUCT LEVEL)	
Y	233-7236	1	CAMSHAFT GP						14
Y	244-3501	1	CONNECTION GP-INLET						79
Y	230-8086	1	CONNECTION GP-WATER						55
Y	253-2472	1	COOLER GP-FLTR BASE & ENG OIL						56
Y	230-9151	1	COVER GP-VALVE MECHANISM						15
Y	233-7027	1	CRANKSHAFT GP						23
Y	233-7007	1	CYLINDER BLOCK GP						26
Y	233-7234	1	CYLINDER HEAD GP						28
Y	231-0055	1	DRIVE GP-ACCESSORY						31
Y	232-7378	1	FILTER GP-ENGINE OIL						52
Y	230-7286	1	FLYWHEEL GP						34
Y	232-6661	1	GLOW PLUG GP						113
Y	223-7825	1	HOUSING GP-FLYWHEEL						36
Y	232-6179	1	HOUSING GP-FRONT						37
Y	233-7432	1	LIFTING GP-ENGINE						41
Y	231-0292	1	MANIFOLD GP-EXHAUST						80
Y	232-6206	1	MOUNTING GP-ENGINE						43
Y	230-8144	1	PAN GP-OIL (ENGINE)						44
Y	233-7233	1	PISTON & ROD GP						45
Y	225-4317	1	PLUG GP-ENGINE						47
Y	232-6204	1	PLUG GP-ENGINE						48
Y	253-2479	1	PLUG GP-ENGINE						49
Y	230-7353	1	PULLEY GP-CRANKSHAFT						50
Y	230-7578	1	PUMP GP-ENGINE OIL						53
Y	267-9413	1	PUMP GP-FUEL INJECTION						88
Y	233-7425	1	PUMP GP-FUEL PRM & PRIM FILTER						93
Y	230-7355	1	PUMP GP-WATER						65
Y	328-6009	1	STARTING MOTOR GP-ELECTRIC						137
Y	233-7235	1	VALVE MECHANISM GP						51
	267-5367	1	CYLINDER BLOCK GP-SHORT						
			AVAILABLE GASKET KIT(S):						
	272-0494	1	KIT-GASKET (BOTTOM)						
	277-5156	1	KIT-GASKET (TOP)						
Y-SEPARATE ILLUSTRATION									

ENGINE ARRANGEMENT

309-0737 ENGINE AR-PRIMARY

S/N: CRS1-UP

61 BRAKE KW (82 BHP) AT 2200 RPM

PART OF 318-4348 ENGINE AR

AN ATTACHMENT

SMCS-1000

i03472473

NOTE	PART NUMBER	QTY	PART NAME						SEE PAGE
			1	2	3	4	5	6 (PRODUCT LEVEL)	
Y	233-7236	1	CAMSHAFT GP						14
Y	244-3501	1	CONNECTION GP-INLET						79
Y	230-8086	1	CONNECTION GP-WATER						55
Y	253-2472	1	COOLER GP-FLTR BASE & ENG OIL						56
Y	230-9151	1	COVER GP-VALVE MECHANISM						15
Y	233-7027	1	CRANKSHAFT GP						23
Y	233-7007	1	CYLINDER BLOCK GP						26
Y	233-7234	1	CYLINDER HEAD GP						28
Y	231-0055	1	DRIVE GP-ACCESSORY						31
Y	232-7378	1	FILTER GP-ENGINE OIL						52
Y	230-7286	1	FLYWHEEL GP						34
Y	232-6661	1	GLOW PLUG GP						113
Y	223-7825	1	HOUSING GP-FLYWHEEL						36
Y	232-6179	1	HOUSING GP-FRONT						37
Y	233-7432	1	LIFTING GP-ENGINE						41
Y	231-0292	1	MANIFOLD GP-EXHAUST						80
Y	232-6206	1	MOUNTING GP-ENGINE						43
Y	230-8144	1	PAN GP-OIL (ENGINE)						44
Y	233-7233	1	PISTON & ROD GP						45
Y	225-4317	1	PLUG GP-ENGINE						47
Y	232-6204	1	PLUG GP-ENGINE						48
Y	253-2479	1	PLUG GP-ENGINE						49
Y	230-7353	1	PULLEY GP-CRANKSHAFT						50
Y	230-7578	1	PUMP GP-ENGINE OIL						53
Y	267-9413	1	PUMP GP-FUEL INJECTION						88
Y	233-7425	1	PUMP GP-FUEL PRM & PRIM FILTER						93
Y	230-7355	1	PUMP GP-WATER						65
Y	328-6009	1	STARTING MOTOR GP-ELECTRIC						137
Y	233-7235	1	VALVE MECHANISM GP						51
	267-5367	1	CYLINDER BLOCK GP-SHORT						
			AVAILABLE GASKET KIT(S):						
	272-0494	1	KIT-GASKET (BOTTOM)						
	277-5156	1	KIT-GASKET (TOP)						

Y-SEPARATE ILLUSTRATION

ENGINE ARRANGEMENT

329-2196 ENGINE AR-PRIMARY

S/N: CRS1-UP

62 BRAKE KW (83 BHP) AT 2200 RPM. NATURALLY ASPIRATED

PART OF 331-0141 ENGINE AR

AN ATTACHMENT

SMCS-1000

i03539622

NOTE	PART NUMBER	QTY	PART NAME						SEE PAGE
			1	2	3	4	5	6 (PRODUCT LEVEL)	
Y	233-7236	1	CAMSHAFT GP						14
Y	244-3501	1	CONNECTION GP-INLET						79
Y	230-8086	1	CONNECTION GP-WATER						55
Y	253-2472	1	COOLER GP-FLTR BASE & ENG OIL						56
Y	230-9151	1	COVER GP-VALVE MECHANISM						15
Y	233-7027	1	CRANKSHAFT GP						23
Y	233-7007	1	CYLINDER BLOCK GP						26
Y	233-7234	1	CYLINDER HEAD GP						28
Y	231-0055	1	DRIVE GP-ACCESSORY						31
Y	232-7378	1	FILTER GP-ENGINE OIL						52
Y	230-7286	1	FLYWHEEL GP						34
Y	232-6661	1	GLOW PLUG GP						113
Y	223-7825	1	HOUSING GP-FLYWHEEL						36
Y	232-6179	1	HOUSING GP-FRONT						37
Y	233-7432	1	LIFTING GP-ENGINE						41
Y	231-0292	1	MANIFOLD GP-EXHAUST						80
Y	232-6206	1	MOUNTING GP-ENGINE						43
Y	230-8144	1	PAN GP-OIL (ENGINE)						44
Y	233-7233	1	PISTON & ROD GP						45
Y	225-4317	1	PLUG GP-ENGINE (FRONT HOUSING, CYLINDER HEAD)						47
Y	232-6204	1	PLUG GP-ENGINE (CYLINDER HEAD)						48
Y	253-2479	1	PLUG GP-ENGINE						49
Y	230-7353	1	PULLEY GP-CRANKSHAFT						50
Y	230-7578	1	PUMP GP-ENGINE OIL						53
Y	345-3701	1	PUMP GP-FUEL INJECTION						91
Y	233-7425	1	PUMP GP-FUEL PRM & PRIM FILTER						93
Y	230-7355	1	PUMP GP-WATER						65
Y	323-6678	1	STARTING MOTOR GP-ELECTRIC						136
Y	233-7235	1	VALVE MECHANISM GP						51
	267-5367	1	CYLINDER BLOCK GP-SHORT						

Y-SEPARATE ILLUSTRATION

Thanks for your reading.

Please click here to download complete manual instantly.

And can also choose other manuals.

Feel free --->write to me with any questions.

Our service email:

manuals007@hotmail.com