



Parts Manual

950H Wheel Loader

JLX1-Up (Machine)
KHX1-Up (Engine)
TX71-Up (Engine)
BYY1-Up (Transmission)
BYZ1-Up (Transmission)
KYM1-Up (Transmission)
KYN1-Up (Transmission)
W2W1-Up
(Transmission)
W2X1-Up (Transmission)
4AT1-Up (Torque
Converter)

Product and Dealer Information

Note: For product identification plate locations, see the section "Product Identification Information" in the Operation and Maintenance Manual.

Delivery Date: _____

Product Information

Model: _____

Product Identification Number: _____

Engine Serial Number: _____

Transmission Serial Number: _____

Generator Serial Number: _____

Attachment Serial Numbers: _____

Attachment Information: _____

Customer Equipment Number: _____

Dealer Equipment Number: _____

Dealer Information

Name: _____ Branch: _____

Address: _____

Dealer Contact

Phone Number

Hours

Sales: _____

Parts: _____

Service: _____

MEMORANDA

TABLE OF CONTENTS

NAME	PAGE	NAME	PAGE
GENERAL INFORMATION	A6	LIFTING GP-ENGINE.....	57
REPAIR ALTERNATIVES	A9	MOUNTING GP-ALTERNATOR.....	58
SUPPLEMENTAL COOLANT		MOUNTING GP-ENGINE & XMSN	59
ADDITIVES	A10	MOUNTING GP-STARTING MOTOR	60
MAINTENANCE PARTS	A11	PAN GP-OIL	61
INDEX	A16	PISTON & ROD GP	62
MACHINE ARRANGEMENT	1	PLUG GP-CYLINDER BLOCK	63
CHASSIS AR.....	1	PLUG GP-ENGINE.....	64
COMMON AR	2	PULLEY GP-IDLER	65
CONFIGURATION AR.....	2	ROCKER ARM GP	67
CONVERSION AR-MACHINE	4	SEAL GP-CRANKSHAFT	69
DISTRIBUTION AR	7	VALVE MECHANISM GP.....	70
OPTION AR-CAB	8	LUBRICATION SYSTEM	75
OPTION AR-COLD WEATHER.....	8	ADAPTER GP-OIL LINE.....	75
OPTION AR-LIGHTING	9	BREATHER GP.....	76
OPTION AR-PRECLEANER.....	9	FILLER GP-ENGINE OIL	77
OPTION AR-REGIONAL	10	FILTER GP-ENGINE OIL.....	78
ENGINE ARRANGEMENT	11	FUMES DISPOSAL GP	79
ENGINE AR.....	11	LINES GP-ENGINE OIL	81
ENGINE AR-COMPLETE	12	LINES GP-ENGINE OIL DRAIN.....	82
ENGINE AR-CORE	16	LINES GP-TURBOCHARGER OIL.....	83
INSTALLATION AR-ENGINE	17	PUMP GP-ENGINE OIL	85
BASIC ENGINE	18	COOLING SYSTEM	87
CAMSHAFT GP	18	COOLER GP-ENGINE OIL.....	87
CARRIER GP-SEAL.....	19	COOLING AR-HIGH AMBIENT TEMP	88
COVER GP-CYLINDER BLOCK.....	20	COOLING GP-SUPPLEMENTAL.....	94
COVER GP-FRONT HOUSING.....	22	ELBOW GP-WATER	96
COVER GP-VALVE MECHANISM.....	24	FRAME GP-RADIATOR	97
CRANKSHAFT GP	25	GUARD GP-FAN.....	98
CYLINDER BLOCK GP.....	27	LINES GP-WATER.....	99
CYLINDER HEAD AS.....	31	PUMP GP-WATER.....	112
CYLINDER HEAD GP.....	33	RADIATOR & FAN GP.....	115
DAMPER & PULLEY GP.....	39	AIR INLET AND EXHAUST SYSTEM	118
DRAIN GP-ENGINE OIL.....	40	AIR CLEANER GP.....	118
DRIVE GP-ACCESSORY	41	COVER GP-AIR INLET.....	120
FASTENER GP-CYLINDER HEAD	42	ELBOW GP-AIR INLET.....	122
FASTENER GP-DAMPER & PULLEY.....	43	FASTENER GP-INLET MANIFOLD	124
FASTENER GP-FRONT COVER	44	LINES GP-AFTERCOOLER AIR.....	125
FASTENER GP-FRONT HOUSING	45	LINES GP-AIR.....	127
FLYWHEEL GP.....	47	MANIFOLD GP-EXHAUST	129
GEAR GP-FRONT	48	MOUNTING GP-MUFFLER.....	130
HOUSING GP-FLYWHEEL.....	49	MUFFLER GP	132
HOUSING GP-FRONT.....	50	PRECLEANER GP.....	135
IDLER GP-BELT	51	TURBOCHARGER GP	137
KIT-CYLINDER HEAD GASKET.....	52	FUEL SYSTEM	139
KIT-ENGINE GASKET.....	53	BASE GP-FUEL FILTER	139
KIT-FRONT COVER GASKET.....	54	FILTER & LINES GP-FUEL.....	140
KIT-REAR COVER GASKET.....	55	FILTER GP-FUEL.....	143
LIFTER GP-VALVE	56	FILTER GP-WATER SEP & FUEL	145
		INJECTOR GP-FUEL.....	146
		KIT-FUEL SYSTEM GASKET	149
		LINES GP-FUEL.....	150

TABLE OF CONTENTS

NAME	PAGE	NAME	PAGE
LINES GP-FUEL DRAIN.....	154	LAMP GP-HEAD & SIGNAL.....	237
LINES GP-INJECTOR HYD PUMP.....	155	LAMP GP-STOP & TAIL.....	244
PUMP & MTG GP-UNIT INJ HYD.....	157	LIGHTING GP-FLOOD.....	246
PUMP GP-FUEL INJECTION.....	159	LIGHTING GP-ROADING.....	257
PUMP GP-FUEL PRM & PRIM FILTER.....	162	LIGHTING GP-WARNING BEACON.....	261
PUMP GP-FUEL PRM & WATER SEP.....	165	PANEL GP-CIRCUIT BREAKER.....	263
PUMP GP-FUEL TRANSFER.....	166	PROTECTION GP-WIRING.....	269
PUMP GP-UNIT INJECTOR HYD.....	167	RADIO GP-COMMUNICATION.....	270
REGULATOR GP-FUEL PRESSURE.....	169	RELAY GP.....	271
TANK & MTG GP-FUEL.....	170	SENSOR & MTG GP-LIFT POSITION.....	272
TANK GP-FUEL.....	171	SENSOR & MTG GP-PRESSURE.....	275
ELECTRICAL AND STARTING		SENSOR & MTG GP-TILT POSITION.....	276
SYSTEM.....	173	SENSOR GP-ENGINE.....	278
ALARM GP.....	173	SENSOR GP-POSITION.....	282
ALTERNATOR GP-CHARGING.....	175	SENSOR GP-PRESSURE.....	284
BATTERY & WIRING GP.....	177	SENSOR GP-SPEED.....	291
BLOCK GP-JUNCTION.....	180	SENSOR GP-TEMPERATURE.....	294
CAMERA AR.....	181	STARTING AID AR-ETHER.....	297
CIRCUIT BREAKER GP.....	184	STARTING AID GP.....	298
CONTROL & MTG GP-ENGINE ELEK.....	185	STARTING AID GP-ETHER.....	299
CONTROL AR-AUTODIG.....	187	STARTING MOTOR GP-ELECTRIC.....	301
CONTROL GP-AUTODIG.....	190	SWITCH GP-DISCONNECT.....	306
CONTROL GP-ENGINE ELECTRONIC.....	191	SWITCH GP-MAGNETIC.....	307
CONTROL GP-UNPROGRAMMED.....	192	SWITCH GP-PRESSURE.....	311
COVER GP-STARTING MOTOR.....	194	SWITCH GP-QUICK COUPLER.....	313
ELECTRICAL AR.....	195	SWITCH GP-RIDE CONTROL.....	314
ELECTRONICS GP- COMMUNICATION.....	195	SWITCH GP-ROCKER.....	315
ELECTRONICS GP-IMPLEMENT.....	196	SWITCH GP-ROTARY.....	316
ELECTRONICS GP-MONITOR.....	196	SWITCH GP-SECONDARY STEERING.....	317
ELECTRONICS GP-POWER TRAIN.....	197	SWITCH GP-SIGNAL.....	318
FASTENER GP-WIRING HARNESS.....	198	SWITCH GP-WIPER.....	322
GUARD GP-ALTERNATOR.....	199	VALVE GP-ETHER STARTING.....	323
HARNESS AS-CAB.....	200	WARNING GP-BACKUP.....	324
HARNESS AS-CHASSIS.....	202	WIRING GP-AUTOLUBE CONTROL.....	325
HARNESS AS-CONTROL.....	206	WIRING GP-AXLE TEMPERATURE.....	327
HARNESS AS-ENGINE.....	207	WIRING GP-CAB.....	329
HARNESS AS-FRONT.....	210	WIRING GP-CHASSIS.....	338
HARNESS AS-LIGHTING.....	210	WIRING GP-CONTROL.....	348
HARNESS AS-RADIO.....	212	WIRING GP-ELECTRIC CLUTCH.....	354
HARNESS AS-SOLENOID.....	213	WIRING GP-ELECTROHYDRAULIC.....	355
HARNESS AS-SWITCH.....	214	WIRING GP-ELECTRONIC CONTROL.....	356
HARNESS AS-WIRING.....	214	WIRING GP-ENGINE.....	357
HEATER GP-JACKET WATER.....	216	WIRING GP-ETHER STARTING AID.....	367
INSTALLATION AR- COMMUNICATION.....	218	WIRING GP-FRONT.....	368
INSTALLATION AR-SECURITY.....	219	WIRING GP-LIGHTING.....	370
INSTALLATION GP- COMMUNICATION.....	220	WIRING GP-MONITOR.....	372
INSTALLATION GP-SECURITY.....	226	WIRING GP-PROTECTION.....	374
LAMP GP-DOME.....	228	WIRING GP-SECONDARY STEERING.....	376
LAMP GP-FLOOD.....	229	WIRING GP-SENSOR.....	379
		WIRING GP-STEERING.....	383
		POWER TRAIN.....	384

TABLE OF CONTENTS

NAME	PAGE	NAME	PAGE
AXLE AR-FIXED	384	COUNTERWEIGHT & MOUNTING	
AXLE AR-FIXED & OSCILLATING	386	GP	509
AXLE AR-OSCILLATING	389	COUNTERWEIGHT GP	510
BRAKE & PLANETARY GP	392	DEFLECTOR GP-FENDER	514
CONTROL GP-TRANSMISSION		DOOR GP-ACCESS	515
HYD	396	ENCLOSURE AS-HYDRAULIC	
COOLER & MTG GP-		TANK	517
TRANSMISSION	398	ENCLOSURE GP-SERVICE	
COOLER AR-AXLE OIL	399	CENTER	518
DIFFERENTIAL GP	401	EXTENSION GP-FENDER	519
DIFFERENTIAL GP-LIMITED SLIP	402	FASTENER GP-COVER	521
DRAIN GP-ECOLOGY	404	FENDER AR-ROADING	525
FILLER GP-POWER TRAIN OIL	406	FENDER GP	526
FILTER & LINES GP-		FENDER GP-ROADING	531
TRANSMISSION	410	FRAME AS-LOADER	535
FILTER GP-OIL	411	FRAME AS-REAR	539
GAUGE GP-OIL LEVEL (DIPSTICK)	412	GRILL GP-RADIATOR	541
GEAR GP-BEVEL & PINION	414	GUARD GP-AXLE	543
GEAR GP-OUTPUT TRANSFER	420	GUARD GP-AXLE OIL COOLER	544
HOUSING GP-AXLE	429	GUARD GP-FRONT	545
HOUSING GP-FIXED AXLE	443	GUARD GP-POWER TRAIN	547
HOUSING GP-OSCILLATING AXLE	445	HANDRAIL GP	549
LINES GP-AXLE OIL COOLER	447	HARDWARE GP-LOADER FRAME	550
LINES GP-TORQUE CONV		HARDWARE GP-REAR FRAME	552
COOLER	455	HINGE GP-ROADING FENDER	555
MOTOR GP-GEAR	458	HITCH GP-ARTICULATING	557
MOUNTING GP-AXLE	459	HOOD & GUARD GP	559
MOUNTING GP-AXLE OIL COOLER	460	LADDER GP	563
MOUNTING GP-RIM	461	LINES GP-CENTRAL LUBRICATION	569
PLANETARY GP-TRANSMISSION	462	LINES GP-FRONT LUBRICATION	572
POWER TRAIN AR	469	LINES GP-GREASE	581
PUMP & MTG GP-AXLE OIL		LINES GP-REAR LUBRICATION	585
COOLER	470	LINK GP-STEERING FRAME LOCK	590
PUMP GP-TRANSMISSION	472	LUBRICATION AR-AUTOMATIC	591
RIM AR	475	MOUNTING GP-BRACKET	593
RIM GP-DEMOUNTABLE	476	MOUNTING GP-REGISTRATION	594
SHAFT GP-DRIVE	479	PANEL GP-HOOD	595
SLIP JOINT GP	484	PANEL GP-SIDE	598
SPIDER & BEARING GP	486	PLATFORM GP-SERVICE	602
TIRE & RIM AR	487	PUMP & MTG GP-LUBRICATION	603
TORQUE CONVERTER &		PUMP GP-LUBRICATION	605
HOUSING GP	489	SHIELD GP-ENGINE	
TORQUE CONVERTER GP	491	COMPARTMENT	607
TRANSMISSION AR	493	STEP GP	611
UNIVERSAL JOINT GP	494	SUPPORT GP-AIR INLET	614
VALVE GP-MODULATING	495	SUPPORT GP-HOOD	615
VALVE GP-RELIEF	498	SUPPORT GP-VALVE & FILTER	616
VALVE GP-TIRE	500	SUPPRESSION AR-SOUND	618
FRAME AND BODY	501	SUPPRESSION GP-SOUND	619
ACTUATOR GP-POWER	501	TILT GP-HOOD	622
BLOCK GP-AXLE OSC LIMITER	502	VALVE & LINES GP-LUBRICATION	623
BOSS GP-LOADER FRAME	503	VALVE GP-LUBE DISTRIBUTION	625
BOSS GP-REAR FRAME	505	BRAKING SYSTEM	631
BOX GP-BATTERY	506	ACCUMULATOR GP-HYDRAULIC	631
CONVERSION GP-ROADING	507	ACTUATOR GP-PARKING BRAKE	633
		BRAKE GP-PARKING	634

TABLE OF CONTENTS

NAME	PAGE	NAME	PAGE
CONTROL GP-FOOT BRAKE.....	636	LINES GP-HYD FAN DR & OIL	
CONTROL GP-PARKING BRAKE.....	638	CLR.....	752
CONTROL GP-SERVICE BRAKE.....	640	LINES GP-HYDRAULIC.....	762
VALVE GP-BRAKE CONTROL.....	643	LINES GP-HYDRAULIC FAN.....	770
STEERING SYSTEM.....	646	LINES GP-LIFT CYLINDER.....	775
CYLINDER & MTG GP-STEERING.....	646	LINES GP-RIDE CONTROL.....	777
CYLINDER GP-STEERING.....	647	LINES GP-TILT CYLINDER.....	778
LINES GP-SECONDARY STEERING.....	649	MANIFOLD GP-CONTROL.....	782
LINES GP-STEERING.....	651	MANIFOLD GP-VALVE.....	787
MANIFOLD GP-CONTROL.....	669	MOUNTING GP-HYDRAULIC TANK.....	789
PUMP & MOTOR GP-SEC		PUMP & MOUNTING GP-AIR.....	790
STEERING.....	671	PUMP & MTG GP-BRAKE & HYD	
PUMP & MTG GP-METERING.....	672	FAN.....	792
PUMP & MTG GP-SECONDARY		PUMP GP-PISTON.....	794
STEER.....	674	ROTATING GP-PUMP.....	796
PUMP & MTG GP-STEERING.....	675	TANK GP-HYDRAULIC.....	797
PUMP GP-PISTON.....	676	VALVE & MTG GP-HYDRAULIC.....	799
ROTATING GP-PUMP.....	683	VALVE & MTG GP-LOG LOADER.....	801
SCREEN GP-CASE DRAIN.....	685	VALVE & MTG GP-MAIN	
STEERING AR.....	686	CONTROL.....	804
STEERING AR-SECONDARY.....	686	VALVE GP-BANK 2.....	819
STEERING COLUMN GP.....	687	VALVE GP-CHECK.....	820
STEERING COLUMN GP-		VALVE GP-CHECK & RELIEF.....	826
ADJUSTABLE.....	688	VALVE GP-CONTROL.....	827
STEERING WHEEL GP.....	689	VALVE GP-DIVERTER.....	848
VALVE GP-CHECK.....	691	VALVE GP-LOWERING CONTROL.....	850
VALVE GP-PILOT.....	694	VALVE GP-MAIN CONTROL.....	852
VALVE GP-PRESSURE REDUCING.....	696	VALVE GP-PUMP CONTROL.....	876
VALVE GP-PUMP CONTROL.....	697	VALVE GP-RELIEF.....	878
VALVE GP-RELIEF.....	700	VALVE GP-SHUTTLE.....	880
VALVE GP-SECONDARY		VALVE GP-SOLENOID.....	881
STEERING.....	702	VALVE GP-UNLOADING.....	885
VALVE GP-SHUTTLE.....	703	IMPLEMENTS.....	886
VALVE GP-STEERING.....	705	ARM AS-LIFT.....	886
VALVE GP-STEERING		ARM GP-LIFT.....	890
NEUTRALIZER.....	710	BOSS GP-LIFT ARM.....	893
HYDRAULIC SYSTEM.....	712	CONTROL GP-BUCKET.....	895
ACCUMULATOR GP-PILOT OIL.....	712	LINK AS-TILT.....	906
ACCUMULATOR GP-RIDE		LINK GP-TILT.....	907
CONTROL.....	714	LINKAGE GP-BUCKET.....	909
CONTROL AR-FAN.....	716	LOGGING AR.....	914
CONTROL AR-HIGH LIFT.....	718	OPERATOR STATION.....	915
CONTROL AR-RIDE.....	719	ADJUSTER GP-SEAT.....	915
CONVERSION GP-CONTROL		AIR CONDITIONER GP.....	917
VALVE.....	720	ARM GP-WINDOW WIPER.....	925
CYLINDER & SEAL GP-LIFT.....	722	ARMREST GP.....	926
CYLINDER & SEAL GP-TILT.....	724	CAB AR.....	927
CYLINDER GP-COUPLER.....	727	CAB AR-ENCLOSED ROPS.....	928
CYLINDER GP-LIFT.....	729	CAB GP-ENCLOSED ROPS.....	929
CYLINDER GP-TILT.....	731	COMPRESSOR GP-REFRIGERANT.....	939
FILTER GP-OIL.....	734	CONDENSER & MTG GP-	
GUARD GP-LIFT CYLINDER.....	735	REFRIGERANT.....	944
HYDRAULIC AR.....	738	CONTROL & MTG GP-ELHYD.....	948
LINES GP-COUPLER.....	739	CONTROL GP-HANDLE.....	964
LINES GP-FRONT.....	748	CONTROL GP-JOYSTICK.....	967

TABLE OF CONTENTS

NAME	PAGE	NAME	PAGE
CONTROL GP-STEERING.....	973	BUCKET AS-GENERAL PURPOSE.....	1112
CONTROL GP-TRANSMISSION.....	979	BUCKET AS-MATERIAL	
CONTROL GP-UNPRGMED		HANDLING.....	1128
MONITOR.....	981	BUCKET AS-ROCK.....	1139
DISPLAY GP-CAMERA.....	982	BUCKET AS-UTILITY.....	1146
DOOR GP-ACCESS.....	985	BUCKET GP-GENERAL PURPOSE.....	1147
DOOR GP-CAB.....	986	BUCKET GP-MATERIAL	
DUCT & FILTER GP-CAB AIR.....	988	HANDLING.....	1156
FLOOR GP-SOUND SUPPRESSION.....	990	BUCKET GP-ROCK.....	1163
GUARD GP-WINDOW.....	992	BUCKET GP-UTILITY.....	1167
HEATER & AIR CONDITIONER GP.....	994	CARRIAGE GP-FORK.....	1168
HORN GP-ELECTRIC.....	995	CONTROL AR-QUICK COUPLER.....	1172
INSTALLATION GP-CONTROLS.....	996	COUPLER GP-QUICK.....	1173
INSTALLATION GP-RADIO.....	998	EDGE AS-CUTTING.....	1175
KIT-SHOCK ABSORBER.....	1001	EDGE GP-CUTTING.....	1176
LATCH GP-CAB DOOR &		EDGE GP-SEGMENT.....	1179
WINDOW.....	1002	FORK GP-PALLET.....	1180
LINER GP-CAB.....	1004	PIN GP-FORK.....	1184
LINES GP-AIR CONDITIONER.....	1008	PROTECTOR GP-LINKAGE.....	1185
LINES GP-CAB HEATER.....	1014	PROTECTOR GP-SIDE BAR.....	1186
LITERATURE GP.....	1019	TINE GP.....	1187
MIRROR GP-REAR VIEW.....	1020	TIP GP-ABRASION.....	1191
MODULE GP-DISPLAY.....	1032	TIP GP-EXTRA-DUTY.....	1192
MONITOR & MOUNTING GP.....	1033	TIP GP-GENERAL PURPOSE.....	1194
MONITOR AR-PAYLOAD.....	1035	TIP GP-HEAVY PENETRATION.....	1195
MONITOR GP-PAYLOAD.....	1036	TIP GP-PENETRATION.....	1196
MOTOR GP-WINDOW WIPER.....	1044		
MOUNTING GP-CAB.....	1047	SERVICE EQUIPMENT AND	
MOUNTING GP-MONITOR.....	1052	SUPPLIES.....	1198
OPERATOR AR.....	1053	BOX GP-SERVICE CENTER.....	1198
OPERATOR GP.....	1054	BOX GP-TOOL.....	1202
PAN GP-SEAT.....	1055	CERTIFICATION AR.....	1204
PANEL GP-INSTRUMENT.....	1057	FILM GP.....	1205
BASE GP-FOOT BRAKE.....	1061	KIT-GASKET.....	1207
PEDAL GP-BRAKE.....	1062	LINES GP-DIAGNOSTIC.....	1210
PEDAL GP-GOVERNOR.....	1064	PLATE & FILM GP.....	1214
PLATFORM AR.....	1066		
PRINTER GP-COMPUTER.....	1067	PART NUMBER INDEX.....	B1
RADIO GP.....	1069		
SEALING GP-GLASS.....	1069		
SEAT GP.....	1070		
SEAT GP-SUSPENSION.....	1072		
SHROUD GP-CAB.....	1077		
SUPPRESSION AR-SOUND.....	1078		
SUPPRESSION GP-CAB SOUND.....	1079		
SUPPRESSION GP-SOUND.....	1082		
SUSPENSION GP-SEAT.....	1089		
TANK GP-WINDOW WASHER.....	1092		
VISOR GP-CAB.....	1093		
WASHER GP-WINDOW.....	1094		
WINDOW GP-CAB.....	1095		
WIPER GP-WINDOW.....	1104		
WORK TOOLS.....	1110		
ADAPTER GP-TIP.....	1110		
ARM GP-MATERIAL HANDLING.....	1111		

GENERAL INFORMATION

1. MACHINE IDENTIFICATION

Cat machines are identified by Product Identification Numbers (PIN). Some components included in a machine may be identified by Serial Numbers (S/N). Typical components that will be serialized include engines, transmissions, bulldozers, and rippers. The machine and engine are further identified by arrangement numbers and in some cases modification numbers. These numbers are shown on the product identification plate(s) and on the master plate in the operator's compartment.

Cat dealers need all of these numbers to determine accurate parts identification.

Effective First Quarter 2001 the Cat Product Identification Number (PIN) changed from 8 to 17 characters. In an effort to provide uniform equipment identification, Caterpillar and other construction equipment manufacturers are moving to comply with the latest version of the product identification numbering standard. Non-road machine PINs are defined by ISO 10261. The new PIN format will apply to all Cat machines and generator sets. The PIN plates and frame marking will display the 17 character PIN. The new format will look like the following:

*** C A T 0 7 8 9 B G 6 S L 1 2 3 4 5 ***

The diagram shows the PIN format: * C A T 0 7 8 9 B G 6 S L 1 2 3 4 5 *. Below the first four characters (C, A, T, 0), there are four circles containing the numbers 1, 2, 3, and 4 respectively. Vertical lines connect each circle to its corresponding character in the PIN above.

Where:

1. Caterpillar's World Manufacturing Code (characters 1-3)
2. Machine Descriptor (characters 4-8)
3. Check Character (character 9)
4. Machine Indicator Section (MIS) or Product Sequence Number (characters 10-17). These were previously referred to as the Serial Number.

Machines and generator sets produced before First Quarter 2001 will maintain their 8 character PIN format.

Components such as engines, transmissions, axles, etc. and work tools will continue to use an 8 character Serial Number (S/N).

2. ORDERING PARTS

WARNING

When replacement parts are required for this product Caterpillar recommends using Caterpillar replacement parts or parts with equivalent specifications including, but not limited to, physical dimensions, type, strength and material.

Failure to heed this warning can lead to premature failures, product damage, personal injury or death.

Quality Cat replacement parts are available from Cat dealers throughout the world. Their parts inventories are up to date and include all parts normally required to protect your investment in Cat machines. Dealers may offer repair kits or remanufactured parts to allow selection of the most effective repair alternative for a particular situation. When ordering parts, your order should specify the quantity, part number, part name, and the serial number/product identification number of the machine for which the parts are needed.

3. PARTS MANUAL ORGANIZATION

Product information in this manual is presented as "information elements" that represent all of the components for the specific model. Engine Arrangement and Seat Group are examples of information elements. The information elements are organized alphabetically by part name and secondarily by part number within each major section of the manual.

4. TABLE OF CONTENTS

A table of contents (TOC) is found at the beginning of the manual. The TOC lists each section of the manual with a complete list of all information elements organized as they appear in the manual. Page numbers are provided for quick reference to detailed parts identification illustrations and serviceable consist lists.

5. MAINTENANCE PARTS INDEX

The Maintenance Parts Index, located near the beginning of the manual, references most frequently used maintenance part numbers, providing description, quantity, usage and page number. This information is organized alphabetically by part description.

GENERAL INFORMATION

6. INDEX

The index located near the front of the manual is an alphabetical listing of all information elements included in the manual. Page numbers are provided for quick reference to detailed parts identification illustrations and serviceable consist lists.

7. PART NUMBER INDEX

A numerical index listing all part numbers and the corresponding page number(s) appears at the back of the manual.

8. CAPTIONS

Captions located at the beginning of each information element identify the part number and part name along with additional descriptive information. PIN and S/N information found in each caption should be used to select correct information for a specific machine. Field replacement options, identification of optional attachment components, and where used ("part of") information is also provided.

The first line of a caption is shown in larger type font to indicate the beginning of an information element. Captions for additional pages that may be required to illustrate an information element will be shown in standard type font and will include the term (*contd.*).

9. NON-SERVICED PARTS

In some instances it is necessary to display non-serviced parts that are a link to a lower level serviceable consist lists. These non-serviced part numbers are shown in *italic* type indicating that they are not available.

10. PARTS LIST REFERENCE NUMBERS

Numbers shown in the Ref No column correspond to numbers used in the associated graphic(s). An alphabetic suffix may be added to a reference number to identify lower level consist items. Numbers shown in the Graphic Ref column refer to the graphic number identifier displayed in the lower left corner of each illustration. The Graphic Ref number may be used in combination with the item Ref No to determine the correct part number. There may be intentional omission of a Ref No in a consist list as information is updated to reflect the latest serviceable part numbers.

11. INDENTED PART NAMES

When a part name is indented in a parts list, it is part of (included in) the group or assembly under which it is indented.

12. ILLUSTRATION REFERENCE LETTERS

When necessary, illustrations contain reference letters (A, B, C etc.) that are intended to track lines and harnesses from one point to another. They are also used to show where to reconnect illustrations that have been separated.

13. ABBREVIATIONS AND SYMBOLS

O.D. – Outside Diameter
I.D. – Inside Diameter
A – Not Part Of This Group
B – Use As Required
C – Change From Previous Type
D – Order By The Meter
E – Order By The Centimeter
F – Not Shown
G – Order By The Inch
I – Refer To Hydraulic Information System
M – Metric Part
R – Remfg Part May Be Available
Y – Separate Illustration
Z – Not Serviced Separately

14. DESCRIPTION OF TYPE CHANGES

Type - A type is defined as any configuration change that requires an additional Information Element for an Arrangement, Group, or Assembly. If serial number breaks for types are not available, a type # (Type 1, Type 2, etc.) will be displayed in the caption. These "type" changes are identified with a "C" note (change from previous type) in the Parts List. Only the "types" that apply to this Parts Manual will be included. Additional types may exist causing "C" notes to appear on an Information Element when no other types are shown.

15. <END>

This symbol indicates the end of an information element.

NOTE:

Continuing improvement and advancement of product design may cause changes to your machine which may not be included in this publication. Whenever a question arises regarding your Cat product or this publication, please consult your Cat dealer for the latest available information.

GENERAL INFORMATION

8E-3299 PLATFORM GP-CAB						
SMEG-7283 100090751						
REF NO	GRAPHIC REF	PART NUMBER	QTY	PART NAME	U.S. & #	PROD. LAYER
1		31-3963	1	PLATE AS		
2		88-3082	25	BOLT (3/8-18X.750IN)		
3		87-1078	41	WASHER-HAND (3MM THK)		
4		87-1044	2	SUPPORT BR FOOT		
5		87-8229	19	BOLT (1/2-13X1IN)		
6		87-8229	19	WASHER-HAND (4MM THK)		
7		88-8136	4	COVER AS-LH		
8		87-8278	4	NUT WELD (3/8-18 THD)		
9		17-8189	1	CLIP		
10		78-2411	4	COVER		
11		81-8889	18	SCREW-HEAD (3/8-18X.875IN)		
12		87-8278	1	COVER		
13		88-8978	1	GASKET		
14		88-3249	1	COVER		
15		88-3249	1	COVER		
16		31-3833	1	HANDHOLD		
17		88-8978	1	COVER AS		
18		87-8278	8	NUT WELD (3/8-18 THD)		
19		88-3249	1	GASKET		
20		77-0191	1	FLOORPLATE AS		
21		17-8748	4	NUT WELD (1/2-13 THD)		
22		77-8087	1	PLUG-BUTTON		
23		77-8190	1	PLATE AS		
24		87-8278	5	NUT WELD (3/8-18 THD)		
25		77-8086	1	COVER		
26		77-8270	1	GASKET		
27		81-3981	1	PLATE AS		
28		81-8284	4	BOLT (1/4-20X.825IN)		
29		81-8284	4	WASHER-HAND (2MM THK)		
30		88-3082	17	BOLT (3/8-18X.750IN)		
31		87-1078	41	WASHER-HAND (3MM THK)		
32		77-8190	1	PLATE AS		
33		77-8278	2	BOLT (3/4-10X5IN)		
34		77-0682	2	WASHER-HAND (8MM THK)		
35		31-3888	2	PLATE AS		
36		31-8890	1	PLATE AS		
37		78-8828	6	SPACER		
38		31-8891	1	SEAL		
39		78-8817	1	GASKET		
40		78-8816	1	COVER AS		
41		28-8378	2	WASHER		
42		87-8628	2	SCREW-DIMBLED		
43		87-8429	1	COVER		
44		88-8897	1	COVER		
45		88-3091	8	SCREW-SOCKET HEAD		
46		88-3144	8	MOUNTING		
47		88-8927	2	PLATE		
48		77-0390	2	BOLT (7/8-8X5IN)		
49		87-8672	2	WASHER-HAND		
50		87-8454	4	BOLT (3/8-18X1.0IN)		
51		31-8788	1	COVER		

8E-3299 PLATFORM GP-CAB (contd.)						
100090751						
NOTE	REF NO	GRAPHIC REF	PART NUMBER	QTY	PART NAME	SEE PAGE
	41	2	88-2818	1	COVER	
	42	2	77-0134	1	PLATE	
	43	2	77-0138	1	GASKET	
	44	2	78-8724	1	GASKET	
	45	2	78-8723	1	COVER	
	46	2	87-1260	2	PLUG-BUTTON	

M-METRIC PART

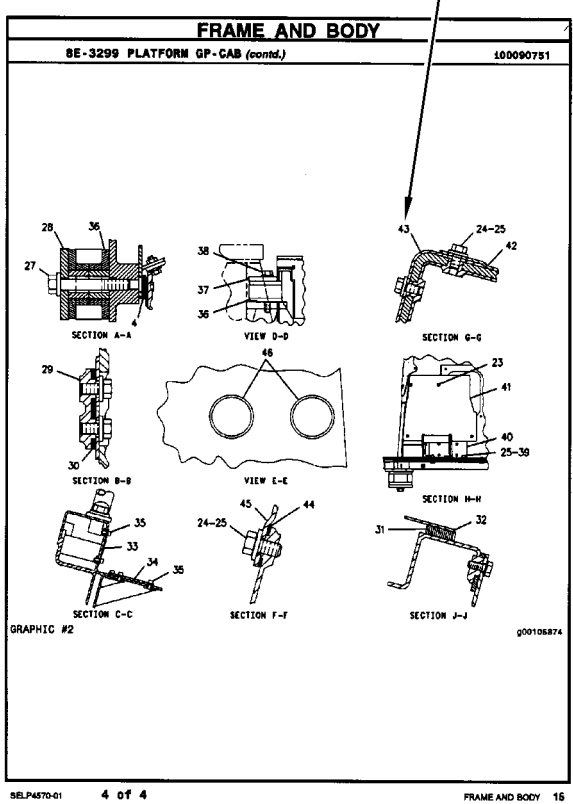
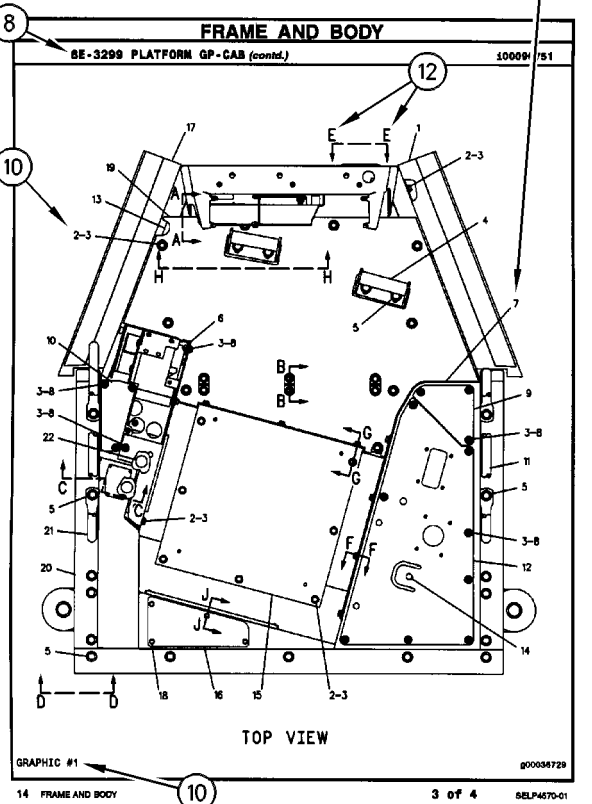

REPAIR ALTERNATIVES

REMANUFACTURED COMPONENTS

As an option when making repairs consider Cat Remanufactured Components. Components that are available through the Cat Remanufactured Program are identified three ways in the parts book:

- with the letter R in the note field of the parts list
- with an R* at the beginning of the first line of the caption
- with an *R at the end of the first line of the caption

Typical components included in the Remanufacturing Program include:

ALTERNATORS
CONNECTING RODS
CRANKSHAFTS - UNDERSIZE
CRANKSHAFTS - UPGRADE TO NEW
CYLINDER HEADS
ELECTRONIC CONTROL MODULES (ECM)
ELECTRONIC SENSORS
FUEL INJECTORS
FUEL NOZZLES
FUEL PUMPS
GOVERNORS
OIL PUMPS
PISTONS
SHORT BLOCKS
STARTERS
TURBOCHARGERS - COMPLETE
TURBOCHARGER CARTRIDGES
WATER PUMPS

Cat Remanufactured engines for many engine arrangements are also available.

SUPPLEMENTAL COOLANT ADDITIVES

CUSTOMER BENEFITS:

Protects against cavitation, foam, erosion, corrosion, and scale buildup in cooling systems.

- Provides measured coolant conditioner.

DESCRIPTION:

Additives deplete from the coolant with normal operation. For this reason, Supplemental Coolant Additives (SCA) must be added to all heavy duty coolants at regular intervals. In addition, when not using a fully formulated, pre-charged antifreeze, like Cat DEAC, an initial charge of SCA must be added to the cooling system. The amount of SCA added to the system is dependent on the capacity of the system.

The SCA for initial fill is provided as a liquid. SCA's for maintenance intervals are available in liquid form and as a spin-on element. (No Spin-on available for 3600 Family of Engines)

NOTE:

The amount of SCA added at initial fill is not the same as the amount added at maintenance intervals.

The coolant additive elements can be used with any ethylene or propylene glycol type antifreeze which meets ASTM D4985 or ASTM D5345 Specifications.

NOTE:

For use with standard heavy duty coolant only, not for use with Extended Life Coolant.

PARTS NEEDED:

Cooling System Capacity		Liquid SCA at Initial Fill	Liquid SCA at Maintenance*	Spin-on SCA Maintenance Element*
Liters	Gallons			
22-30	(6-8)	3P-2044 (1)	6V-3542 (1)	111-2370 (1)
30-38	(8-10)	3P-2044 (1) 6V-3542 (1)	111-2372 (1)	111-2369 (1)
38-49	(10-13)	3P-2044 (1) 8T-1589 (1)	111-2372 (1)	111-2369 (1)
49-64	(13-17)	3P-2044 (2)	8T-1589 (1)	9N-3368 (1)
64-83	(17-22)	3P-2044 (2) 8T-1589 (1)	111-2372 (1) 6V-3542 (1)	111-2371 (1)
83-114	(22-30)	3P-2044 (3) 8T-1589 (1)	3P-2044 (1)	9N-3718 (1)
114-163	(30-43)	3P-2044 (5)	3P-2044 (1) 6V-3542 (1)	111-2371 (2)
163-242	(43-64)	3P-2044 (8)	3P-2044 (2)	9N-3718 (2)

* Normal maintenance period is 250 hrs. See your Operation and Maintenance Manual for complete coolant maintenance instructions.

() Indicates quantity required.

MAINTENANCE PARTS

DESCRIPTION	PART NUMBER	QTY	WHERE USED	PAGE
AIR INLET AND EXHAUST SYSTEM				
FILTER ELEMENT AS-AIR (SECONDARY)	245-6376	1	AIR CLEANER GP	119
FILTER ELEMENT-AIR (PRIMARY)	245-6375	1	AIR CLEANER GP	119
BASIC ENGINE				
BELT-SERPENTINE	253-4531	1	DRIVE GP-ACCESSORY	41
BREATHER AS (CRANKCASE)	9Y-2988	1	COVER GP-VALVE MECHANISM	24
CAP AS-ENGINE OIL FILLER	227-4531	1	COVER GP-VALVE MECHANISM	24
GASKET (WATER REGULATOR HOUSING)	222-5915	1	KIT-CYLINDER HEAD GASKET	52
SEAL-VALVE COVER	272-0388	1	COVER GP-VALVE MECHANISM	24
		1	KIT-CYLINDER HEAD GASKET	52
BRAKING SYSTEM				
CAP (GAS VALVE)	224-5132	1	ACCUMULATOR GP-HYDRAULIC	631
		1	ACCUMULATOR GP-HYDRAULIC	632
COOLING SYSTEM				
CAP AS-RADIATOR (7-PSI)	032-1464	1	LINES GP-WATER	105
GASKET (TEMPERATURE REGULATOR HOUSING)	222-5915	1	LINES GP-WATER	99
REGULATOR-WATER TEMPERATURE (94-DEG C) (COOLANT)	119-3075	2	LINES GP-WATER	99
ELECTRICAL AND STARTING SYSTEM				
CIRCUIT BREAKER AS (20-AMPERE)	288-3687	1	PANEL GP-CIRCUIT BREAKER	263
		1	PANEL GP-CIRCUIT BREAKER	266
CIRCUIT BREAKER AS (30-AMPERE)	139-4724	1	PANEL GP-CIRCUIT BREAKER	263
		1	PANEL GP-CIRCUIT BREAKER	266
CIRCUIT BREAKER AS (50-AMPERE)	171-2206	1	PANEL GP-CIRCUIT BREAKER	263
CIRCUIT BREAKER AS (80-AMPERE)	171-2210	1	PANEL GP-CIRCUIT BREAKER	263
		1	PANEL GP-CIRCUIT BREAKER	266
CIRCUIT BREAKER AS (90-AMPERE)	171-2211	1	PANEL GP-CIRCUIT BREAKER	263
		1	PANEL GP-CIRCUIT BREAKER	266
CIRCUIT BREAKER GP (15-AMPERE)	248-3288	1	PANEL GP-CIRCUIT BREAKER	263
		1	PANEL GP-CIRCUIT BREAKER	266
ELEMENT AS-JACKET WATER HEATER (240-VOLT, 1000-WATT)	124-0687	1	HEATER GP-JACKET WATER	217
FILTER (ETHER START)	358-4889	1	VALVE GP-ETHER STARTING	323
FLASHER AS (24-VOLT)	217-8166	1	SWITCH GP-SIGNAL	318
		1	SWITCH GP-SIGNAL	320
FUSE (10-AMPERE)	9W-1442	24	WIRING GP-CAB	331
FUSE (15-AMPERE)	9W-1441	7	WIRING GP-CAB	331
FUSE (20-AMPERE)	9W-1446	1	WIRING GP-CAB	331
HOLD-DOWN-BATTERY	153-6281	1	BATTERY & WIRING GP	177

MAINTENANCE PARTS

DESCRIPTION	PART NUMBER	QTY	WHERE USED	PAGE
KEY (BATTERY DISCONNECT)	8H-5306	1	SWITCH GP-DISCONNECT	306
LAMP (24-VOLT, 21-WATT)	9X-4493	1	LAMP GP-STOP & TAIL	245
		1	LIGHTING GP-ROADING	257
LAMP (24-VOLT, 21-WATT) (STOP, TAIL)	9X-4493	1	LAMP GP-STOP & TAIL	244
LAMP (24-VOLT, 5-WATT)	130-3515	1	LAMP GP-FLOOD	231
		1	LAMP GP-FLOOD	233
		1	LAMP GP-HEAD & SIGNAL	241
		1	LAMP GP-HEAD & SIGNAL	242
LAMP (24-VOLT, 5-WATT) (FLOODLIGHT)	130-3515	1	LAMP GP-HEAD & SIGNAL	237
		1	LAMP GP-HEAD & SIGNAL	238
		1	LAMP GP-HEAD & SIGNAL	239
		1	LAMP GP-HEAD & SIGNAL	240
LAMP (24-VOLT, 5-WATT) (POSITION)	130-3515	1	LAMP GP-HEAD & SIGNAL	243
LAMP (24-VOLT, 75/70-WATT)	9X-3465	1	LAMP GP-HEAD & SIGNAL	241
		1	LAMP GP-HEAD & SIGNAL	242
LAMP (24-VOLT, 75/70-WATT) (HIGH, LOW BEAM)	9X-3465	1	LAMP GP-HEAD & SIGNAL	237
		1	LAMP GP-HEAD & SIGNAL	238
		1	LAMP GP-HEAD & SIGNAL	239
		1	LAMP GP-HEAD & SIGNAL	240
		1	LAMP GP-HEAD & SIGNAL	243
LAMP (24-VOLT, HID)	290-8160	1	LAMP GP-FLOOD	235
		1	LAMP GP-FLOOD	236
LAMP (24-VOLT) (DOME LIGHT)	7N-9943	1	LAMP GP-DOME	228
LAMP GP-FLOOD (24-VOLT)	219-6485	2	LIGHTING GP-FLOOD	248
LAMP-FLOOD (24-VOLT, 5-WATT)	9X-4492	1	LAMP GP-STOP & TAIL	245
		1	LIGHTING GP-ROADING	257
LAMP-FLOOD (24-VOLT, 5-WATT) (STOP, TAIL)	9X-4492	1	LAMP GP-STOP & TAIL	244
LAMP-HALOGEN (24-VOLT, 70-WATT)	351-9918	1	LAMP GP-FLOOD	229
		1	LAMP GP-FLOOD	230
		1	LAMP GP-FLOOD	234
	9X-3463	1	LAMP GP-FLOOD	231
		1	LAMP GP-FLOOD	233
LAMP-HALOGEN (24-VOLT, 70-WATT) (FLOODLIGHT)	351-9918	1	LAMP GP-FLOOD	232
LAMP-TURN SIGNAL (24-VOLT, 21- WATT)	242-0588	1	LAMP GP-FLOOD	231
		1	LAMP GP-FLOOD	232
		1	LAMP GP-FLOOD	233
		1	LAMP GP-FLOOD	234
		1	LAMP GP-HEAD & SIGNAL	241
		1	LAMP GP-HEAD & SIGNAL	242
LAMP-TURN SIGNAL (24-VOLT, 21- WATT) (TURN SIGNAL)	242-0588	1	LAMP GP-HEAD & SIGNAL	237
		1	LAMP GP-HEAD & SIGNAL	238
		1	LAMP GP-HEAD & SIGNAL	239
		1	LAMP GP-HEAD & SIGNAL	240
		1	LAMP GP-HEAD & SIGNAL	243
PLUG-SEAL	8T-8737	1	LAMP GP-HEAD & SIGNAL	243

MAINTENANCE PARTS

DESCRIPTION	PART NUMBER	QTY	WHERE USED	PAGE
RELAY (ALARM)	4Y-6135	1	LIGHTING GP-ROADING	257
FRAME AND BODY				
FILTER AS-GREASE	196-1062	1	PUMP GP-LUBRICATION	605
LAMP (24-VOLT, 5-WATT)	263-2541	1	MOUNTING GP-REGISTRATION	594
LAMP AS (24-VOLT, 5-WATT)	125-4439	2	MOUNTING GP-REGISTRATION	594
FUEL SYSTEM				
CAP AS-FUEL (DEBRIS BOOT)	338-0912	1	TANK GP-FUEL	171
CAP-FUEL	284-9039	1	TANK GP-FUEL	171
FILTER AS-WATER SEP & FUEL (PRIMARY)	326-1644	1	FILTER GP-WATER SEP & FUEL	145
FILTER-FUEL (ADVANCED EFFICIENCY)	1R-0749	2	BASE GP-FUEL FILTER	139
FILTER-FUEL (ADVANCED EFFICIENCY) (SECONDARY)	1R-0762	1	FILTER & LINES GP-FUEL	140
STRAINER-FUEL (FILLER NECK SCREEN)	180-3730	1	TANK GP-FUEL	171
HYDRAULIC SYSTEM				
BREATHER (AIR/HYDRAULIC CYLINDER)	4H-6112	1	LINES GP-HYDRAULIC FAN	772
BREATHER (HYDRAULIC TANK)	258-2829	1	LINES GP-HYDRAULIC	762
		1	LINES GP-HYDRAULIC	766
CAP-FILLER (HYDRAULIC OIL)	7H-1447	1	TANK GP-HYDRAULIC	797
FILTER-OIL (ULTRA HIGH EFFICIENCY)	126-1818	1	FILTER GP-OIL	734
KEY	155-9133	1	PUMP GP-PISTON	794
SCREEN	299-7997	1	TANK GP-HYDRAULIC	797
	6E-5066	1	MANIFOLD GP-CONTROL	782
SCREEN AS	376-9067	2	TANK GP-HYDRAULIC	797
SCREEN AS (HYDRAULIC)	382-1511	1	LINES GP-HYDRAULIC	762
		1	LINES GP-HYDRAULIC	766
STRAINER AS-OIL	5D-7927	1	TANK GP-HYDRAULIC	797
LUBRICATION SYSTEM				
BREATHER (CRANKCASE)	164-0210	1	BREATHER GP	76
CAP AS-FILLER (ENGINE OIL)	5L-2952	1	FILLER GP-ENGINE OIL	77
FILTER AS-ENGINE OIL (ADVANCED EFFICIENCY)	1R-1807	1	FILTER GP-ENGINE OIL	78
HOSE-FUMES DISPOSAL	369-9203	1	FUMES DISPOSAL GP	80
OPERATOR STATION				
BELT-SERPENTINE	253-4531	1	COMPRESSOR GP-REFRIGERANT	940
BLADE AS-WIPER (400-MM)	6V-5851	1	WIPER GP-WINDOW	1104
		1	WIPER GP-WINDOW	1107
BLADE AS-WIPER (700-MM)	6V-7419	1	WIPER GP-WINDOW	1104
		1	WIPER GP-WINDOW	1107
CAP-VENTED (VENTED)	388-9379	1	TANK GP-WINDOW WASHER	1092

MAINTENANCE PARTS

DESCRIPTION	PART NUMBER	QTY	WHERE USED	PAGE
DRYER AS-REFRIGERANT (IN-LINE)	257-3226	1	LINES GP-AIR CONDITIONER	1010
ELEMENT AS-HEATER	198-6571	1	OPERATOR GP	1054
FILTER ELEMENT-CAB AIR (STANDARD EFFICIENCY)	7X-6041	2	DUCT & FILTER GP-CAB AIR	988
FILTER ELEMENT-CAB AIR (ULTRA HIGH EFFICIENCY)	175-2834	2	DUCT & FILTER GP-CAB AIR	988
FUSE (15-AMPERE)	133-9012	1	AIR CONDITIONER GP	917
		1	AIR CONDITIONER GP	921
GASKET	107-4396	1	LINES GP-AIR CONDITIONER	1008
SEAT BELT (2-IN)	206-1749	1	SEAT GP-SUSPENSION	1072
 POWER TRAIN				
BELT-SERPENTINE	215-3015	1	PUMP & MTG GP-AXLE OIL COOLER	470
BREATHER AS	9G-5127	1	FILLER GP-POWER TRAIN OIL	406
BREATHER AS (POWER TRAIN OIL)	9G-5127	1	FILLER GP-POWER TRAIN OIL	408
CAP-DUST (TRANSMISSION OIL)	8C-3447	1	FILTER GP-OIL	411
CAP-FILLER (POWER TRAIN)	5K-1568	1	FILLER GP-POWER TRAIN OIL	406
		1	FILLER GP-POWER TRAIN OIL	408
FILTER ELEMENT-OIL (ADVANCED EFFICIENCY)	341-6643	1	FILTER GP-OIL	411
FILTER-MAGNETIC (AXLE OIL COOLER)	251-6351	2	LINES GP-AXLE OIL COOLER	447
		2	LINES GP-AXLE OIL COOLER	451
PLUG (TRANSMISSION OIL DRAIN)	138-1510	1	DRAIN GP-ECOLOGY	404
PLUG AS-MAGNETIC	165-4929	1	HOUSING GP-AXLE	429
		1	HOUSING GP-AXLE	432
		1	HOUSING GP-AXLE	434
		1	HOUSING GP-AXLE	437
		1	HOUSING GP-AXLE	439
		1	HOUSING GP-AXLE	441
PLUG-DRAIN	175-4966	1	DRAIN GP-ECOLOGY	405
PLUG-DRAIN (AXLE HOUSING)	175-4966	1	HOUSING GP-AXLE	429
		1	HOUSING GP-AXLE	432
		1	HOUSING GP-AXLE	434
		1	HOUSING GP-AXLE	437
		1	HOUSING GP-AXLE	439
		1	HOUSING GP-AXLE	441
PLUG-MAGNETIC	5P-4484	1	HOUSING GP-AXLE	429
		1	HOUSING GP-AXLE	432
		1	HOUSING GP-AXLE	434
		1	HOUSING GP-AXLE	437
		1	HOUSING GP-AXLE	439
		1	HOUSING GP-AXLE	441
		1	HOUSING GP-FIXED AXLE	443
		1	HOUSING GP-OSCILLATING AXLE	445
		1	LINES GP-AXLE OIL COOLER	452
SCREEN-SUCTION	4S-8598	1	GEAR GP-OUTPUT TRANSFER	420
		1	GEAR GP-OUTPUT TRANSFER	425

MAINTENANCE PARTS

DESCRIPTION	PART NUMBER	QTY	WHERE USED	PAGE
STEERING SYSTEM				
SCREEN	6E-5066	1	MANIFOLD GP-CONTROL	669
		2	SCREEN GP-CASE DRAIN	685

INDEX

NAME	PAGE	NAME	PAGE
BRAKE & PLANETARY GP	392	CAB AR-ENCLOSED ROPS	928
	394	CAB GP-ENCLOSED ROPS	929
BRAKE GP-PARKING	420		934
	425	CAMERA AR	181
	634		183
BREATHER (AIR/HYDRAULIC CYLINDER)	772	CAMERA GP (115-DEG, COLOR)	181
BREATHER (CRANKCASE)	76	CAMSHAFT GP	18
BREATHER (HYDRAULIC TANK)	762	CAP (GAS VALVE)	631
	766		632
BREATHER AS	406	CAP AS-ENGINE OIL FILLER	24
BREATHER AS (CRANKCASE)	24	CAP AS-FILLER (ENGINE OIL)	77
BREATHER AS (POWER TRAIN OIL)	408	CAP AS-FUEL (DEBRIS BOOT)	171
BREATHER GP	76	CAP AS-RADIATOR (7-PSI)	105
BUCKET AS-GENERAL PURPOSE	1112	CAP-DUST (TRANSMISSION OIL)	411
	1113	CAP-FILLER (HYDRAULIC OIL)	797
	1115	CAP-FILLER (POWER TRAIN)	406
	1117		408
	1119	CAP-FUEL	171
	1121	CAP-VENTED (VENTED)	1092
	1122	CARRIAGE GP-FORK-96-IN	1168
	1123		1169
	1125	CARRIAGE GP-FORK-HOOK-ON	1170
	1127	CARRIER GP-SEAL	19
BUCKET AS-MATERIAL HANDLING	1128	CERTIFICATION AR	1204
	1130	CHASSIS AR	1
	1132	CIRCUIT BREAKER AS (20-AMPERE)	263
	1134		266
	1135	CIRCUIT BREAKER AS (30-AMPERE)	263
	1137		266
	1138	CIRCUIT BREAKER AS (50-AMPERE)	263
BUCKET AS-ROCK	1139	CIRCUIT BREAKER AS (80-AMPERE)	263
	1140		266
	1142	CIRCUIT BREAKER AS (90-AMPERE)	263
	1144		266
BUCKET AS-UTILITY	1146	CIRCUIT BREAKER GP (15-AMPERE)	263
BUCKET GP-GENERAL PURPOSE	1147		266
	1148	CIRCUIT BREAKER GP-AUTOMATIC	
	1149	RESET	184
	1150	CLAMP	982
	1151		1033
	1152	CLUTCH GP-ELECTRIC (AXLE OIL COOLER	
	1153	PUMP)	470
	1154	COMMON AR	2
	1155	COMPRESSOR GP-REFRIGERANT	939
BUCKET GP-MATERIAL HANDLING	1156		940
	1157		941
	1158		942
	1159		943
	1160	CONDENSER & MTG GP-REFRIGERANT	944
	1161		946
	1162	CONFIGURATION AR	2
BUCKET GP-ROCK	1163		3
	1164	CONNECTOR GP-ELECTRONIC	983
	1165	CONTROL & MTG GP-ELHYD	948
	1166		950
BUCKET GP-UTILITY	1167		952
			954
			956
			962
		CONTROL & MTG GP-ELHYD-IMPLEMENT	958
			960
CAB AR	927		

C

INDEX

NAME	PAGE	NAME	PAGE
CONTROL & MTG GP-ENGINE ELEK	185	CONTROL GP-UNPROGRAMMED (PRODUCT LINK	
	186	522)	222
CONTROL AR-AUTODIG	187	CONTROL GP-UNPROGRAMMED-PRODUCT LINK	
	188	522	192
CONTROL AR-FAN	716		193
	717	CONVERSION AR-MACHINE	4
CONTROL AR-HIGH LIFT	718		5
	719		6
CONTROL AR-HIGH LIFT-2-VALVE			7
HYDRAULICS	718	CONVERSION GP-CONTROL VALVE	720
CONTROL AR-QUICK COUPLER	1172	CONVERSION GP-ROADING	507
CONTROL AR-RIDE	719	COOLANT HEATER LINES	1014
CONTROL GP-AUTODIG	190		1016
CONTROL GP-BUCKET	718		1018
	895	COOLER & MTG GP-TRANSMISSION	398
	901	COOLER AR-AXLE OIL	399
	903		400
CONTROL GP-BUCKET-HIGH LIFT		COOLER GP-ENGINE OIL	87
MACHINES	898	COOLING AR-HIGH AMBIENT TEMP	88
CONTROL GP-ENGINE ELECTRONIC	191	COOLING AR-HIGH AMBIENT TEMP-WITH ANTI-	
CONTROL GP-FOOT BRAKE	636	CORROSION PROTECTION	89
	637		91
CONTROL GP-HANDLE	965	COOLING GP-SUPPLEMENTAL	94
CONTROL GP-HANDLE (LIFT, TILT, AUX,		CORE AS-AFTERCOOLER	115
DOWNSHIFT SW)	971	CORE AS-AXLE OIL COOLER	460
CONTROL GP-HANDLE (LIFT, TILT, AUX, FNR,		CORE AS-CONDENSER	89
DNSFT)	969	CORE AS-CONDENSER (REFRIGERANT)	88
CONTROL GP-HANDLE (LIFT, TILT, FNR,			944
DOWNSHIFT)	967	CORE AS-ENGINE OIL COOLER	87
CONTROL GP-HANDLE (PILOT CONTROL)	348	CORE AS-HYDRAULIC OIL COOLER	89
CONTROL GP-HANDLE (PILOT CONTROL)	350	CORE AS-OIL COOLER	91
	720	CORE AS-OIL COOLER (HYDRAULIC)	88
CONTROL GP-HANDLE (PILOT CONTROL)	952		115
CONTROL GP-HANDLE (PILOT CONTROL)	954	CORE AS-OIL COOLER (WITH ANTI-CORROSION	
CONTROL GP-HANDLE-BUCKET	964	PROTECTION)	89
CONTROL GP-HANDLE-LIFT, TILT, AUXILIARY,		CORE AS-RADIATOR	89
DOWNSHIFT SWITCH	966		115
CONTROL GP-JOYSTICK	967	CORE AS-RADIATOR (COOLANT)	88
	969	CORE AS-RADIATOR (WITH ANTI-CORROSION	
	970	PROTECTION)	89
	971		91
CONTROL GP-PARKING BRAKE	638	COUNTERWEIGHT & MOUNTING GP	509
CONTROL GP-SERVICE BRAKE	640	COUNTERWEIGHT GP	510
	738		511
CONTROL GP-STEERING	977		512
CONTROL GP-STEERING-COMMAND CONTROL			513
STEERING	973	COUPLER GP-QUICK	1173
	975	COVER GP (LUBRICATION PUMP)	605
CONTROL GP-TRANSMISSION	979	COVER GP (LUBRICATION TANK)	605
	980	COVER GP-AIR INLET-STARTING AID	
CONTROL GP-TRANSMISSION HYD	396	HEATER	120
CONTROL GP-UNPRGMED MONITOR-			121
MESSENGER	981	COVER GP-CYLINDER BLOCK	20
CONTROL GP-UNPROGRAMMED	332	COVER GP-FRONT HOUSING	22
	1042		23
CONTROL GP-UNPROGRAMMED		COVER GP-STARTING MOTOR	194
(MACHINE)	1036	COVER GP-VALVE MECHANISM	24
	1039	CRANKSHAFT GP	25
CONTROL GP-UNPROGRAMMED (PRODUCT LINK		CYLINDER & MTG GP-STEERING	646
300)	195	CYLINDER & SEAL GP-LIFT (LH)	738

INDEX

NAME	PAGE	NAME	PAGE
FILLER GP-POWER TRAIN OIL	406	FILM-INFORMATION (INPUT/OUTPUT)	1057
	408	FILM-INFORMATION (JOYSTICK CONTROL) ...	956
	738	FILM-INFORMATION (PRODUCT LINK, READ	
FILM	962	OMM)	218
FILM GP	1205	FILM-INFORMATION (SECURITY SYSTEM)	226
	1206	FILM-INSTRUCTION (ALTERNATE EXIT, READ	
FILM-CONTROL	188	OMM)	1042
	958	FILM-INSTRUCTION (ENGINE START)	1057
	1059	FILM-INSTRUCTION (EXIT)	1004
	1060	FILM-INSTRUCTION (MACHINE SECURITY,	
FILM-CONTROL (JOYSTICK)	960	CONSOLE)	226
FILM-IDENTIFICATION (12-VOLT)	1054	FILM-INSTRUCTION (MAINTENANCE)	721
	1057		948
FILM-IDENTIFICATION (AUTODIG)	188		950
	190		952
FILM-IDENTIFICATION (AUXILIARY			954
HYDRAULIC)	721	FILM-INSTRUCTION (NO STEP)	10
	952		520
	954	FILM-INSTRUCTION (SEAT ADJUSTMENT) ...	1089
FILM-IDENTIFICATION (CAT)	193	FILM-WARNING (CRUSH HAZARD, STAY BACK,	
FILM-IDENTIFICATION (CATERPILLAR, REAR		U.S.)	1214
CAB)	521	FILM-WARNING (CRUSH HAZARD, STAY	
	523	BACK)	1111
FILM-IDENTIFICATION (DUMP, TILT BACK)	721	FILM-WARNING (DO NOT LIFT, READ	
	948	OMM)	1148
	950		1149
	952		1150
	954		1151
FILM-IDENTIFICATION (ENGINE			1152
SHUTDOWN)	1057		1153
FILM-IDENTIFICATION (FUSE PANEL)	263		1154
	266		1155
	1004		1159
FILM-IDENTIFICATION (HORN, TRANSMISSION			1160
DIRECTION)	721		1161
	948		1162
	950	FILM-WARNING (EXPLOSION, RADIO PRODUCT	
	952	LINK)	218
	954	FILM-WARNING (FLYING DEBRIS, STAY BACK,	
FILM-IDENTIFICATION (HORN)	962	INTL) (RH, LH)	716
FILM-IDENTIFICATION (HYDRAULIC			717
ACCUMULATOR)	712	FILM-WARNING (HAND CRUSH HAZARD, READ	
	713	OMM)	1173
FILM-IDENTIFICATION (IGNITION SWITCH)	226	FILM-WARNING (HIGH PRESSURE, READ OMM,	
FILM-IDENTIFICATION (LIFT, FLOAT,		INTL)	777
LOWER)	721	FILM-WARNING (HIGH PRESSURE, READ	
	948	OMM)	631
	950	FILM-WARNING (HOT FLUID UNDER PRESSURE,	
	952	U.S.)	1214
	954	FILM-WARNING (NO WELD, NO DRILL, READ	
FILM-IDENTIFICATION (LIGHTS)	1057	OMM)	1216
FILM-IDENTIFICATION (PAYLOAD STORE)	1036	FILM-WARNING (READ OMM)	1111
	1039	FILTER (ETHER START)	323
	1042	FILTER & LINES GP-FUEL	140
FILM-INFORMATION (24-VOLT HEATER)	922	FILTER & LINES GP-TRANSMISSION	410
FILM-INFORMATION (24-VOLT)	1215		738
FILM-INFORMATION (CONTROL PANEL)	190	FILTER AS-ENGINE OIL (ADVANCED	
FILM-INFORMATION (HYD ACCUMULATOR, READ		EFFICIENCY)	78
OMM)	714	FILTER AS-GREASE	605
	715		

INDEX

NAME	PAGE	NAME	PAGE
HARNESS AS-CHASSIS	202	HARNESS AS-SWITCH (LUBRICATION	
	204	PRESSURE)	325
	263		374
	342	HARNESS AS-SWITCH (TRANSMISSION	
	372	CONTROL).....	689
HARNESS AS-CHASSIS (VARIABLE PITCH		HARNESS AS-TRANSMISSION.....	396
FAN)	338	HARNESS AS-VALVE (SEAT AIR	
	340	COMPRESSOR).....	1089
	346	HARNESS AS-WIRING.....	214
HARNESS AS-CONTROL	206		215
	207		356
	222	HARNESS AS-WIRING (COMMUNICATION) ...	1067
HARNESS AS-CONTROL (AUTOMATIC		HARNESS AS-WIRING (FUEL PRESSURE)	
LUBRICATION)	605	(SENSOR)	140
HARNESS AS-CONTROL (HEATED		HARNESS AS-WIRING (PRINTER).....	1067
MIRRORS).....	1028	HEATER & AIR CONDITIONER GP.....	994
HARNESS AS-ENGINE	207	HEATER GP-JACKET WATER.....	216
	208		217
	209	HINGE GP-ROADING FENDER-LH	555
HARNESS AS-ENGINE (FUEL INJECTION).....	357	HINGE GP-ROADING FENDER-RH.....	556
HARNESS AS-FRONT	210	HITCH GP-ARTICULATING.....	557
HARNESS AS-HEATER & AIR COND	917	HOLD-DOWN-BATTERY.....	177
	921	HOOD & GUARD GP.....	559
HARNESS AS-LIGHTING.....	210	HORN GP-ELECTRIC.....	995
	211	HOSE-FUMES DISPOSAL.....	80
	212	HOUSING GP-AXLE	432
	246		439
	248		441
	251	HOUSING GP-AXLE-FRONT	429
	370		434
HARNESS AS-LIGHTING (CAB		HOUSING GP-AXLE-REAR.....	437
FLOODLIGHTS)	331	HOUSING GP-FIXED AXLE	443
HARNESS AS-LIGHTING (REAR).....	248	HOUSING GP-FLYWHEEL.....	49
HARNESS AS-LIGHTING (STOP, TAIL)	257	HOUSING GP-FRONT	50
HARNESS AS-LIGHTING (TURN SIGNAL).....	257	HOUSING GP-OSCILLATING AXLE	445
	318	HYDRAULIC AR.....	738
	320	HYDRAULIC AR-3-VALVE, LOGGING.....	738
HARNESS AS-LIGHTING (WARNING			
BEACON).....	261		
HARNESS AS-MONITOR.....	983		
HARNESS AS-PUMP (JUMPER).....	325		
	374		
HARNESS AS-PUMP (LUBRICATION, REAR			
FRAME)	325		
	374		
HARNESS AS-RADIO.....	212		
	213		
HARNESS AS-REAR LIGHTING (REGISTRATION			
PLATE).....	257		
HARNESS AS-SENSOR.....	381		
HARNESS AS-SENSOR (AXLE OIL COOLER			
TEMPERATURE)	327		
HARNESS AS-SENSOR (AXLE, REAR).....	327		
HARNESS AS-SOLENOID.....	213		
	352		
HARNESS AS-STARTING AID (ETHER).....	367		
HARNESS AS-STEERING (COLUMN,			
WHEEL)	689		
HARNESS AS-STEERING (SECONDARY).....	376		
HARNESS AS-SWITCH	214		
	355		

I

IDLER GP-BELT.....	51
INJECTOR GP-FUEL.....	146
	147
	148
INSTALLATION AR-COMMUNICATION	218
INSTALLATION AR-COMMUNICATION-PRODUCT	
LINK 321SR.....	218
INSTALLATION AR-ENGINE	17
INSTALLATION AR-SECURITY	219
INSTALLATION GP-COMMUNICATION	222
	224
INSTALLATION GP-COMMUNICATION-PRODUCT	
LINK.....	220
INSTALLATION GP-CONTROLS	996
INSTALLATION GP-RADIO	998
	999
INSTALLATION GP-SECURITY	226

INDEX

NAME	PAGE	NAME	PAGE
K			
KEY	794	LAMP GP-HEAD & SIGNAL (24-VOLT).....	257
KEY (BATTERY DISCONNECT)	306	LAMP GP-HEAD & SIGNAL-LH	239
KIT-CYLINDER HEAD GASKET.....	52		240
KIT-ENGINE GASKET.....	53	LAMP GP-HEAD & SIGNAL-RH.....	237
KIT-FRONT COVER GASKET	54		238
KIT-FUEL SYSTEM GASKET-SINGLE FUEL		LAMP GP-REAR.....	257
INJECTOR	149	LAMP GP-SIGNAL.....	257
KIT-GASKET	1207	LAMP GP-STOP & TAIL	244
KIT-GASKET-OIL COOLER, LINES	1209	LAMP GP-STOP & TAIL (24-VOLT).....	253
KIT-GASKET-TURBOCHARGER	1208	LAMP GP-STOP & TAIL-24-VOLT	245
KIT-REAR COVER GASKET.....	55	LAMP GP-WARNING BEACON	261
KIT-RECEPTACLE (2-PIN).....	226	LAMP-FLOOD (24-VOLT, 5-WATT).....	245
KIT-SHOCK ABSORBER	1001		257
L			
LADDER GP	563	LAMP-FLOOD (24-VOLT, 5-WATT) (STOP,	
	565	TAIL)	244
LADDER GP-REAR.....	567	LAMP-HALOGEN (24-VOLT, 70-WATT).....	229
LAMP (24-VOLT, 21-WATT)	245		230
	257		231
LAMP (24-VOLT, 21-WATT) (STOP, TAIL).....	244	LAMP-HALOGEN (24-VOLT, 70-WATT)	
LAMP (24-VOLT, 5-WATT)	231	(FLOODLIGHT)	232
	233	LAMP-TURN SIGNAL (24-VOLT, 21-WATT).....	231
	241		232
	242		233
	594		234
LAMP (24-VOLT, 5-WATT) (FLOODLIGHT)	237	LAMP-TURN SIGNAL (24-VOLT, 21-WATT) (TURN	
	238	SIGNAL)	237
	239		238
	240		239
	240		240
	243		243
LAMP (24-VOLT, 5-WATT) (POSITION).....	243	LATCH GP-CAB DOOR & WINDOW.....	1002
LAMP (24-VOLT, 75/70-WATT).....	241	LIFTER GP-VALVE	56
	242	LIFTING GP-ENGINE	57
LAMP (24-VOLT, 75/70-WATT) (HIGH, LOW		LIGHTER GP (12-VOLT)	1054
BEAM).....	237	LIGHTING GP-FLOOD	195
	238		250
	239		251
	240		253
	243		255
LAMP (24-VOLT, HID)	235	LIGHTING GP-FLOOD-CAB FRONT, REAR	248
	236	LIGHTING GP-FLOOD-HID, CAB FRONT,	
LAMP (24-VOLT) (DOME LIGHT)	228	REAR.....	246
LAMP AS (24-VOLT, 5-WATT).....	594	LIGHTING GP-ROADING.....	257
LAMP GP-BACKUP (REAR).....	257		260
LAMP GP-DOME	228	LIGHTING GP-WARNING BEACON	261
LAMP GP-FLOOD	229	LINER GP-CAB.....	1004
	230		1006
	231	LINES GP-AFTERCOOLER AIR.....	125
	232		126
	233	LINES GP-AIR	127
	234		128
LAMP GP-FLOOD (24-VOLT).....	248	LINES GP-AIR CONDITIONER.....	1
LAMP GP-FLOOD-24-VOLT, 35-WATT, HID	236		1008
LAMP GP-FLOOD-HID.....	235		1010
LAMP GP-HEAD & SIGNAL.....	241	LINES GP-AXLE OIL COOLER.....	399
	242		447
	243		451

INDEX

NAME	PAGE	NAME	PAGE
MOTOR GP-ELEC HYD PUMP (SECONDARY STEERING)	671	PANEL GP-INSTRUMENT	1057
MOTOR GP-GEAR-HYDRAULIC FAN	458		1059
MOTOR GP-WINDOW WIPER	1044	PANEL GP-SIDE	598
	1045		600
	1046	PEDAL GP-BRAKE-PEDAL, LH	1062
MOTOR GP-WINDOW WIPER (24-VOLT, 2-SPEED) (DOOR, RH)	1045	PEDAL GP-GOVERNOR	1064
MOUNTING GP-ALTERNATOR	58		1065
MOUNTING GP-AXLE	459	PIN GP-FORK-ANTI-SWING	1184
MOUNTING GP-AXLE OIL COOLER	460	PISTON & ROD GP	62
MOUNTING GP-BRACKET-GREASE GUN	593	PLANETARY GP-TRANSMISSION	462
MOUNTING GP-CAB	1047	PLATE & FILM GP	1214
	1048		1215
	1049		1217
	1050	PLATE & FILM GP (ENGINE INFORMATION)	1204
	1051	PLATE AS	525
MOUNTING GP-DISPLAY (WORK AREA VISUAL SYSTEM)	982	PLATE-IDENTIFICATION (CAT)	1128
	1033		1130
	1052		1140
MOUNTING GP-ENGINE & XMSN	59		1142
MOUNTING GP-HYDRAULIC TANK	789		1144
MOUNTING GP-LICENSE PLATE	594	PLATE-INSTRUCTION (HOOD TILT)	342
MOUNTING GP-MONITOR-PAYLOAD	1052	PLATE-SERIAL NUMBER (TRANSMISSION)	421
MOUNTING GP-MUFFLER	130		426
MOUNTING GP-REGISTRATION	594	PLATFORM AR	1066
MOUNTING GP-REGISTRATION (REGISTRATION PLATE)	257	PLATFORM GP-SERVICE	602
MOUNTING GP-RIM	461	PLUG (TRANSMISSION OIL DRAIN)	404
MOUNTING GP-STARTING MOTOR-24-VOLT, RH	60	PLUG AS-MAGNETIC	429
MUFFLER GP	132		432
	133		434
	134		437
			439
			441
		PLUG GP-CYLINDER BLOCK	63
		PLUG GP-ENGINE	64
		PLUG-DRAIN	405
		PLUG-DRAIN (AXLE HOUSING)	429
			432
			434
			437
			439
			441
			441
		PLUG-MAGNETIC	429
			432
			434
			437
			439
			441
			443
			445
			452
		PLUG-SEAL	243
		POTENTIOMETER AS (TEMPERATURE CONTROL)	332
		POWER TRAIN AR	469
		PRECLEANER GP	4
			135
			136
		PRINTER GP-COMPUTER	1067
		PROTECTION GP-WIRING	269

O

OPERATOR AR	1053
OPERATOR GP	1054
OPTION AR-CAB	8
OPTION AR-COLD WEATHER	8
OPTION AR-LIGHTING	9
OPTION AR-PRECLEANER	9
OPTION AR-REGIONAL	10
ORIFICE AS-AIR CONDITIONER	1010

P

PAN GP-OIL	61
PAN GP-SEAT	1055
	1070
PANEL GP-CIRCUIT BREAKER	263
	266
PANEL GP-HOOD-SIDE, LH	597
PANEL GP-HOOD-SIDE, RH	596
PANEL GP-HOOD-TOP	595

Thanks for your reading.

Please click here to download complete manual instantly.

And can also choose other manuals.

Feel free --->write to me with any questions.

Our service email:

manuals007@hotmail.com