

Parts Manual



See "General Information"
for New Parts Manual
Features.

430E Backhoe Loader Center Pivot

BYC1-Up (Machine)
EAT1-Up (Machine)
CRS1-Up (Engine)

Powered By 3054C Engine

This Parts Manual is also available in .PDF Format on Compact Disc (CD - ROM) - Caterpillar Form No. SERP3708.

Product and Dealer Information

Note: For product identification plate locations, see the section "Product Identification Information" in the Operation and Maintenance Manual.

Delivery Date: _____

Product Information

Model: _____

Product Identification Number: _____

Engine Serial Number: _____

Transmission Serial Number: _____

Generator Serial Number: _____

Attachment Serial Numbers: _____

Attachment Information: _____

Customer Equipment Number: _____

Dealer Equipment Number: _____

Dealer Information

Name: _____ Branch: _____

Address: _____

Dealer Contact

Phone Number

Hours

Sales: _____

Parts: _____

Service: _____

MEMORANDA

TABLE OF CONTENTS

Name	Page	Name	Page
GENERAL INFORMATION	A5	PUMP GP-WATER	69
REPAIR ALTERNATIVES	A8	RADIATOR & OIL COOLER GP	71
SUPPLEMENTAL COOLANT ADDITIVES	A9	TANK GP-EXPANSION	73
MAINTENANCE PARTS	A10	AIR INLET AND EXHAUST SYSTEM	74
INDEX	A14	AIR CLEANER GP	74
MACHINE ARRANGEMENT	1	EXTENSION GP-EXHAUST	78
BACKHOE AR-EXTENDABLE STICK	1	INDICATOR GP-AIR FILTER CHANGE	79
BACKHOE AR-STANDARD STICK	3	MUFFLER GP	80
CHASSIS AR	5	TURBOCHARGER GP	81
COMMON AR	6	FUEL SYSTEM	83
DRIVE AR-BACKHOE LOADER	6	CONTROL GP-GOVERNOR	83
LOADER AR	7	FILTER GP-WATER SEP & FUEL	86
ENGINE ARRANGEMENT	8	LINES GP-FUEL	87
ENGINE AR	8	LINES GP-FUEL FILTER	89
ENGINE AR-PRIMARY	10	PUMP GP-FUEL INJECTION	90
BASIC ENGINE	13	PUMP GP-FUEL PRM & PRIM FILTER	100
COVER GP-CYLINDER HEAD	13	TANK & MTG GP-FUEL	103
COVER GP-VALVE MECHANISM	14	TANK GP-FUEL	104
CRANKSHAFT GP	22	ELECTRICAL AND STARTING SYSTEM	106
CYLINDER BLOCK GP	25	ALTERNATOR GP-CHARGING	106
CYLINDER HEAD GP	28	BATTERY & WIRING GP	107
DRIVE GP-FAN	30	ELECTRONICS GP-	
FLYWHEEL GP	31	COMMUNICATION	114
HOUSING GP-FLYWHEEL	32	ELECTRONICS GP-MACHINE	114
HOUSING GP-FRONT	33	ELECTRONICS GP-MONITOR	116
LIFTING GP-ENGINE	35	GLOW PLUG GP	117
MOUNTING GP-ENGINE	36	GRADE CONTROL AR-LASER	119
MOUNTING GP-ENGINE & XMSN	37	HEATER GP-JACKET WATER	122
PAN GP-OIL	38	INSTALLATION GP-COMMUNICATION	123
PISTON & ROD GP	42	LAMP GP-FLOOD	127
PLUG GP-ENGINE	43	LAMP GP-WARNING BEACON	130
PULLEY GP-CRANKSHAFT	46	LIGHTING GP-FLOOD & SIGNAL	131
ROCKER ARM GP	47	LIGHTING GP-WARNING BEACON	135
VALVE MECHANISM GP	48	MAST GP	136
LUBRICATION SYSTEM	50	MOUNTING GP-SENSOR	137
BREATHER GP	50	PANEL GP-FUSE	138
GAUGE GP-OIL LEVEL & FILLER	52	RECEIVER GP-LASER	139
PUMP GP-ENGINE OIL	53	RELAY GP	140
COOLING SYSTEM	54	SENSOR GP-SPEED	143
CONNECTION GP-WATER	54	STARTING MOTOR GP-ELECTRIC	144
COOLER GP-ENGINE OIL	55	SWITCH GP-ALL WHEEL DRIVE	147
COOLER GP-FLTR BASE & ENG OIL	57	SWITCH GP-DIFFERENTIAL LOCK	148
FAN GP-SUCTION	59	SWITCH GP-DISCONNECT	149
LINES GP-TRANSMISSION COOLER	62	SWITCH GP-PRESSURE	150
MOUNTING & LINES GP-RADIATOR	66	WIRING GP-AIR CONDITIONER	151
MOUNTING GP-RAD & OIL COOLER	67	WIRING GP-CONSOLE	155
		WIRING GP-CONTROL	160
		WIRING GP-ENGINE	163
		WIRING GP-EXTENDABLE STICK	168
		WIRING GP-GRADE CONTROL	169
		WIRING GP-HEATER	173
		WIRING GP-KICKOUT & POSITIONER	175

TABLE OF CONTENTS

Name	Page	Name	Page
WIRING GP-PLATFORM	178	FRAME AND BODY	353
WIRING GP-POWER RECEPTACLE	196	BOX GP-BATTERY	353
WIRING GP-REAR	197	COUNTERWEIGHT GP	354
WIRING GP-RIDE CONTROL	201	DOOR GP-BATTERY	358
WIRING GP-STABILIZER	203	EXTENSION GP-FENDER	359
WIRING GP-TRANSMISSION		FENDER GP-FRONT	360
CONTROL	205	FENDER GP-REAR	361
		FLOORPLATE GP	363
POWER TRAIN	206	FRAME GP-LOADER	366
AXLE GP-DRIVE & STEERING	206	FRAME GP-SWING	368
AXLE GP-REAR	208	GRILL-RADIATOR	374
CASE AS-TRANSMISSION	211	GUARD GP-DRIVE SHAFT	375
CASE GP-TRANSMISSION	214	GUARD GP-RADIATOR	376
DIFFERENTIAL & BEVEL GEAR GP	219	HOOD & GUARD GP	377
DIFFERENTIAL GP	221	HOOD GP-ENGINE	381
DRIVE GP-FLEXIBLE COUPLING	223		
FILLER GP-POWER TRAIN OIL	224	HYDRAULIC SYSTEM	384
FLANGE GP-WHEEL	230	ACCUMULATOR GP-PILOT OIL	384
HOUSING & FLANGE GP-AXLE	232	ACCUMULATOR GP-RIDE CONTROL	386
HOUSING GP-AXLE	234	CONTROL AR-RIDE	387
KIT-WHEEL SPACER	238	CYLINDER & LINES GP-THUMB	388
LINES GP-POWER TRAIN OIL	239	CYLINDER GP-BACKHOE BUCKET	393
MOUNTING GP-AXLE	240	CYLINDER GP-BOOM	397
MOUNTING GP-TRANSMISSION	241	CYLINDER GP-EXTENDABLE STICK	401
PLANETARY GP-FINAL DRIVE	243	CYLINDER GP-LIFT	403
POWER TRAIN AR	245	CYLINDER GP-MULTIPURPOSE	
SHAFT GP-COUNTER	247	BUKT	404
SHAFT GP-DRIVE	249	CYLINDER GP-STABILIZER	405
SHAFT GP-IDLER	250	CYLINDER GP-STICK	409
SHAFT GP-INPUT	252	CYLINDER GP-SWING	413
SHAFT GP-OUTPUT	256	CYLINDER GP-THUMB	415
TRANSMISSION & MOUNTING GP	262	CYLINDER GP-TILT	416
TRANSMISSION AR-DIRECT DRIVE	263	DRIVE & MTG GP-PUMP	418
TRANSMISSION AR-POWER SHIFT	264	FASTENER GP-VALVE	419
TRANSMISSION GP-DIRECT DRIVE	265	FILTER GP-OIL	420
TRANSMISSION GP-POWER SHIFT	296	FITTING GP-HYDRAULIC	421
VALVE & LINES GP-DIFF LOCK	308	HYDRAULIC AR	422
VALVE & MTG GP-SOLENOID	310	INSTALLATION GP-RIDE CONTROL	423
VALVE GP-RELIEF	311	KICKOUT & POSITIONER GP	431
VALVE GP-TIRE	312	LINES GP-BACKHOE AUXILIARY	435
WHEEL & TIRE AR	313	LINES GP-BOOM	443
WHEEL & TIRE GP	316	LINES GP-BUCKET	447
		LINES GP-DRAIN	456
BRAKING SYSTEM	330	LINES GP-EXTENDABLE STICK	457
CONTROL GP-PARKING BRAKE	330	LINES GP-HYDRAULIC OIL COOLER	459
CONTROL GP-SERVICE BRAKE	332	LINES GP-LIFT CYLINDER	460
CYLINDER GP-BRAKE	338	LINES GP-LOADER AUXILIARY	462
LEVER GP-HAND CONTROL	340	LINES GP-MULTIPURPOSE BUCKET	464
		LINES GP-PILOT	468
STEERING SYSTEM	341	LINES GP-PUMP	474
AXLE GP-FRONT	341	LINES GP-RIDE CONTROL	476
KNOB GP-STEERING	343	LINES GP-STABILIZER	480
LINES GP-STEERING	344	LINES GP-STICK	498
PUMP GP-METERING	352	LINES GP-SWING	501
		LINES GP-TILT CYLINDER	503

TABLE OF CONTENTS

Name	Page	Name	Page
MANIFOLD & SOLENOID GP-CONTROL	505	COUPLER GP-QUICK	733
MANIFOLD GP-CONTROL	508	EDGE GP-CUTTING	739
MANIFOLD GP-RIDE CONTROL	510	EDGE-CUTTING	741
MOUNTING GP-BANK VALVE	511	FORK GP	742
MOUNTING GP-CYLINDER	512	GUARD GP-WORK TOOL	743
MOUNTING GP-LINES	516	MOUNTING GP-BUCKET	744
PUMP GP-PISTON	519	MOUNTING GP-MAST	745
ROTATING GP-PUMP	521	PIN GP-COUPLER	746
SHAFT GP-PUMP DRIVE	522	THUMB AR	748
TANK & MTG GP-HYDRAULIC	523	THUMB GP	784
VALVE & LINES GP-PILOT	527	TOOTH GP-UNI	786
VALVE AR-BANK 2	529	OPERATOR STATION	787
VALVE AR-BANK 3	529	AIR CONDITIONER & MOUNTING GP	787
VALVE AR-BANK 6	529	BRACKET GP-MOUNTING	790
VALVE AR-BANK 7	530	CAB AR-ENCLOSED ROPS	791
VALVE AR-BANK 8	530	CAB AS	794
VALVE GP-BANK 2	531	CAB GP-ENCLOSED ROPS	795
VALVE GP-BANK 3	532	CANOPY AR-OPEN ROPS	801
VALVE GP-BANK 6	533	CANOPY GP-OPEN ROPS	803
VALVE GP-BANK 7	534	COMPRESSOR & MTG GP-REFRIG	806
VALVE GP-BANK 8	535	COMPRESSOR GP-REFRIGERANT	810
VALVE GP-CONTROL	537	CONDENSER & MTG GP-REFRIGERANT	811
VALVE GP-PILOT	556	CONSOLE GP-OPERATOR	812
VALVE GP-PUMP CONTROL	559	CONTROL GP-HYDRAULIC HAND	818
VALVE GP-SOLENOID	560	CONTROL GP-JOYSTICK	823
IMPLEMENTS	561	CONTROL GP-STEERING	827
ARM GP-LIFT	561	CONTROL GP-TRANSMISSION	831
BOOM GP	563	COVER GP-CAB	833
BRACE GP-LIFT CYLINDER	564	COVER GP-WIPER MOTOR	834
GUARD GP-BOOM	565	DOOR GP-CAB	835
LINK GP-THUMB	567	FLOOR MAT GP	843
LINKAGE GP-BACKHOE BUCKET	568	HEATER GP-CAB	844
LINKAGE GP-LOADER BUCKET	570	INSTALLATION GP-MONITOR	854
LOCK GP-TRANSPORT	572	LATCH GP-CAB DOOR & WINDOW	856
PAD & GUARD GP-STABILIZER	577	LATCH GP-CONSOLE	858
PAD & MTG GP-STABILIZER	595	LEVER GP-GOVERNOR	859
PAD GP-STABILIZER	598	LINER GP-CAB	860
STABILIZER GP-BACKHOE	600	LINES GP-HEATER	864
STICK AS	601	LINES GP-HEATER & AIR COND	865
STICK GP-EXTENDABLE	602	MIRROR GP-REAR VIEW	867
STICK GP-HOE	606	MOTOR GP-WINDOW WIPER	869
WORK TOOLS	607	MOUNTING GP-BACKHOE CONTROL	870
BUCKET AR-GENERAL PURPOSE	607	MOUNTING GP-CAB	873
BUCKET AR-MULTIPURPOSE	607	MOUNTING GP-MONITOR	874
BUCKET AS-GENERAL PURPOSE	610	PEDAL GP-GOVERNOR	875
BUCKET AS-HOE	618	RADIO GP-COMMUNICATION	876
BUCKET GP-GENERAL PURPOSE	670	ROOF GP-CAB	877
BUCKET GP-HOE	677	SEAT BELT GP	878
BUCKET GP-MULTIPURPOSE	721	SEAT GP	880
BULLDOZER AS	726	SEAT GP-SUSPENSION	884
CLAM AS-MULTIPURPOSE BUCKET	730	SUSPENSION GP-SEAT	891
COUPLER AR-QUICK	732	TACHOMETER GP-ELECTRIC	897
		TRIM GP-CAB	898

TABLE OF CONTENTS

Name	Page	Name	Page
VISOR GP-CAB	900		
WASHER GP-WINDOW	902		
WINDOW GP-CAB	906		
WINDOW GP-DOOR	916		
WIPER & WASHER GP-WINDOW	918		
WIPER GP-WINDOW	922		
SERVICE EQUIPMENT AND SUPPLIES	924		
FILM GP	924		
LOCK GP-VANDALISM	925		
PLATE & FILM GP	925		
PROTECTION GP-VANDALISM	929		
TRANSPORT AR-MACHINE	930		
TRANSPORT GP-MACHINE	932		
PART NUMBER INDEX	B1		

GENERAL INFORMATION

1. MACHINE IDENTIFICATION

Caterpillar machines are identified by Product Identification Numbers (PIN). Some components included in a machine may be identified by Serial Numbers (S/N). Typical components that will be serialized include engines, transmissions, bulldozers, and rippers. The machine and engine are further identified by arrangement numbers and in some cases modification numbers. These numbers are shown on the product identification plate(s) and on the master plate in the operator's compartment.

Caterpillar dealers need all of these numbers to determine accurate parts identification.

New Feature

Effective First Quarter 2001 the Caterpillar Product Identification Number (PIN) changed from 8 to 17 characters. In an effort to provide uniform equipment identification, Caterpillar and other construction equipment manufacturers are moving to comply with the latest version of the product identification numbering standard. Non-road machine PINs are defined by ISO 10261. The new PIN format will apply to all Caterpillar machines and generator sets. The PIN plates and frame marking will display the 17 character PIN. The new format will look like the following:

CAT 0789BG 6SL12345

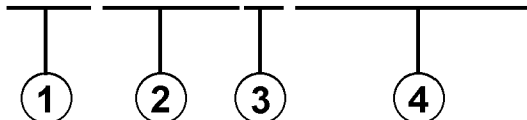

The diagram shows the PIN format: *CAT 0789BG 6SL12345*. Brackets are placed under the characters to group them into four sections. Below each bracket is a circled number: 1 under 'CAT', 2 under '0789BG', 3 under '6SL', and 4 under '12345'.

Where:

1. Caterpillar's World Manufacturing Code (characters 1-3)
2. Machine Descriptor (characters 4-8)
3. Check Character (character 9)
4. Machine Indicator Section (MIS) or Product Sequence Number (characters 10-17). These were previously referred to as the Serial Number.

Machines and generator sets produced before First Quarter 2001 will maintain their 8 character PIN format.

Components such as engines, transmissions, axles, etc. and work tools will continue to use an 8 character Serial Number (S/N).

2. ORDERING PARTS

WARNING

When replacement parts are required for this product Caterpillar recommends using Caterpillar replacement parts or parts with equivalent specifications including, but not limited to, physical dimensions, type, strength and material.

Failure to heed this warning can lead to premature failures, product damage, personal injury or death.

Quality Caterpillar replacement parts are available from Caterpillar dealers throughout the world. Their parts inventories are up to date and include all parts normally required to protect your investment in Caterpillar machines. Dealers may offer repair kits or remanufactured parts to allow selection of the most effective repair alternative for a particular situation. When ordering parts, your order should specify the quantity, part number, part name, and the serial number/product identification number of the machine for which the parts are needed.

3. PARTS MANUAL ORGANIZATION

Product information in this manual is presented as "information elements" that represent all of the components for the specific model. Engine Arrangement and Seat Group are examples of information elements. The information elements are organized alphabetically by part name and secondarily by part number within each major section of the manual.

4. TABLE OF CONTENTS

A table of contents (TOC) is found at the beginning of the manual. The TOC lists each section of the manual with a complete list of all information elements organized as they appear in the manual. Page numbers are provided for quick reference to detailed parts identification illustrations and serviceable consist lists.

5. MAINTENANCE PARTS INDEX

The Maintenance Parts Index, located near the beginning of the manual, references most frequently used maintenance part numbers, providing description, quantity, usage and page number. This information is organized alphabetically by part description.

GENERAL INFORMATION

6. INDEX

The index located near the front of the manual is an alphabetical listing of all information elements included in the manual. Page numbers are provided for quick reference to detailed parts identification illustrations and serviceable consist lists.

7. PART NUMBER INDEX

A numerical index listing all part numbers and the corresponding page number(s) appears at the back of the manual.

8. CAPTIONS

Captions located at the beginning of each information element identify the part number and part name along with additional descriptive information. PIN and S/N information found in each caption should be used to select correct information for a specific machine. Field replacement options, identification of optional attachment components, and where used ("part of") information is also provided.

The first line of a caption is shown in larger type font to indicate the beginning of an information element. Captions for additional pages that may be required to illustrate an information element will be shown in standard type font and will include the term (*contd.*) .

9. NON-SERVICED PARTS

In some instances it is necessary to display non-serviced parts that are a link to a lower level serviceable consist lists. These non-serviced part numbers are shown in *italic* type indicating that they are not available.

10. PARTS LIST REFERENCE NUMBERS

Numbers shown in the Ref No column correspond to numbers used in the associated graphic(s). An alphabetic suffix may be added to a reference number to identify lower level consist items. Numbers shown in the Graphic Ref column refer to the graphic number identifier displayed in the lower left corner of each illustration. The Graphic Ref number may be used in combination with the item Ref No to determine the correct part number. There may be intentional omission of a Ref No in a consist list as information is updated to reflect the latest serviceable part numbers.

11. INDENTED PART NAMES

When a part name is indented in a parts list, it is part of (included in) the group or assembly under which it is indented.

12. ILLUSTRATION REFERENCE LETTERS

When necessary, illustrations contain reference letters (A, B, C etc.) that are intended to track lines and harnesses from one point to another. They are also used to show where to reconnect illustrations that have been separated.

13. ABBREVIATIONS AND SYMBOLS

O.D. – Outside Diameter
I.D. – Inside Diameter
A – Not Part Of This Group
B – Use As Required
C – Change From Previous Type
D – Order By The Meter
E – Order By The Centimeter
F – Not Shown
G – Order By The Inch
I – Refer To Hydraulic Information System
M – Metric Part
R – Remfg Part May Be Available
Y – Separate Illustration
Z – Not Serviced Separately

 **New Feature**

14. DESCRIPTION OF TYPE CHANGES

Type - A type is defined as any configuration change that requires an additional Information Element for an Arrangement, Group, or Assembly. If serial number breaks for types are not available, a type # (Type 1, Type 2, etc.) will be displayed in the caption. These "type" changes are identified with a "C" note (change from previous type) in the Parts List. Only the "types" that apply to this Parts Manual will be included. Additional types may exist causing "C" notes to appear on an Information Element when no other types are shown.

15.<END>

This symbol indicates the end of an information element.

NOTE:

Continuing improvement and advancement of product design may cause changes to your machine which may not be included in this publication. Whenever a question arises regarding your caterpillar product or this publication, please consult your caterpillar dealer for the latest available information.

GENERAL INFORMATION

FRAME AND BODY					
8E-3299 PLATFORM GP-CAB					
PIN 3841-99999					
					100090751
NOTE	REF NO	GRAPHIC REF	PART NUMBER	QTY	PART NAME & PRODUCT LEVEL
			31-2982	1	PLATE AS
			6E-2986	25	BOLT (3/8-18X.750IN)
			6E-1076	41	WASHER-HARD (3MM THK)
			6E-1444	2	SUPPORT AS-FOOT
			7E-2229	19	BOLT (1/2-13X1IN)
			7E-2230	19	WASHER-HARD (4MM THK)
			6E-8126	1	COVER AS-LH
			6E-8272	6	NUT-WELD (3/8-16 THD)
			17-8189	1	CLIP
			7E-2411	4	COVER
			6E-0486	18	SCREW-HEAD (3/8-18X.875IN)
			7E-0474	1	COVER
			6E-0972	1	GASKET
			6E-2980	1	GASKET
			31-3496	1	HANDHOLD
			6E-8272	8	NUT-WELD (3/8-16 THD)
			6E-8272	1	GASKET
			71-0131	1	FLOORPLATE AS
			17-0748	4	NUT-WELD (1/2-13 THD)
			71-6087	1	PLUS-BUTTON
			71-0136	1	PLATE AS
			6E-8272	5	NUT-WELD (3/8-16 THD)
			71-6089	1	COVER
			71-0770	1	GASKET
			31-2981	1	PLATE AS
			81-8284	4	BOLT (1/4-20X.825IN)
			81-8285	4	WASHER-HARD (2MM THK)
			61-8484	1	FLOOR MAT
			6E-8846	1	MODULE AS-OPERATOR
			31-3494	1	HANDHOLD
			6E-8871	2	PLUS
			81-8284	4	BOLT (1/4-20X.825IN)
			81-8285	4	WASHER-HARD (2MM THK)
			6E-1076	21	WASHER-HARD (3MM THK)
			71-0136	1	SEAL
			7E-0278	2	BOLT (3/4-10X5IN)
			7E-0892	2	WASHER-HARD (5MM THK)
			31-3489	2	PLATE AS
			31-3390	1	PLATE AS
			7E-0888	8	SPACER
			31-6281	1	SEAL
			7E-8817	1	GASKET
			7E-8818	1	COVER AS
			2E-8272	2	WASHER
			6E-8928	2	SCREW-KOBBLED
			6E-3428	1	COVER
			6E-8887	1	COVER
			6E-2921	8	SCREW-BOCKET HEAD
			6E-3148	8	MOUNTING
			6E-0927	2	PLATE
			7E-0289	2	BOLT (1/2-8X5IN)
			7E-0872	2	WASHER-HARD
			4L-8484	4	BOLT (3/8-18X1.02IN)
			31-6783	1	COVER

12 FRAME AND BODY 1 of 4 SELP 170-01

FRAME AND BODY					
8E-3299 PLATFORM GP-CAB (contd.)					
					100090751
NOTE	REF NO	GRAPHIC REF	PART NUMBER	QTY	PART NAME & PRODUCT LEVEL
	41	2	6E-8816	1	COVER
	42	2	71-0134	1	PLATE
	43	2	71-0128	1	GASKET
	44	2	7E-8724	1	GASKET
	45	2	7E-8723	1	COVER
	46	2	6E-1069	2	PLUS-BUTTON

M-METRIC PART

SELPA670-01 2 of 4 FRAME AND BODY 13

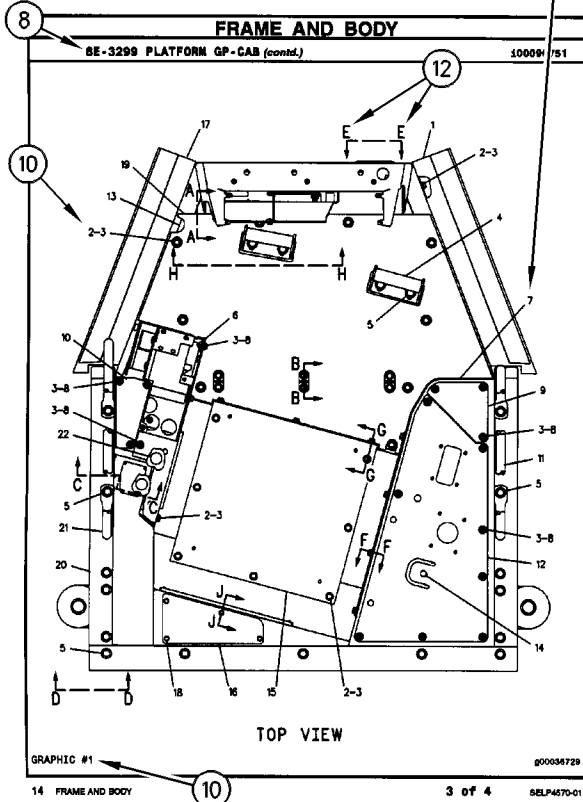

14 FRAME AND BODY 3 of 4 SELPA670-01

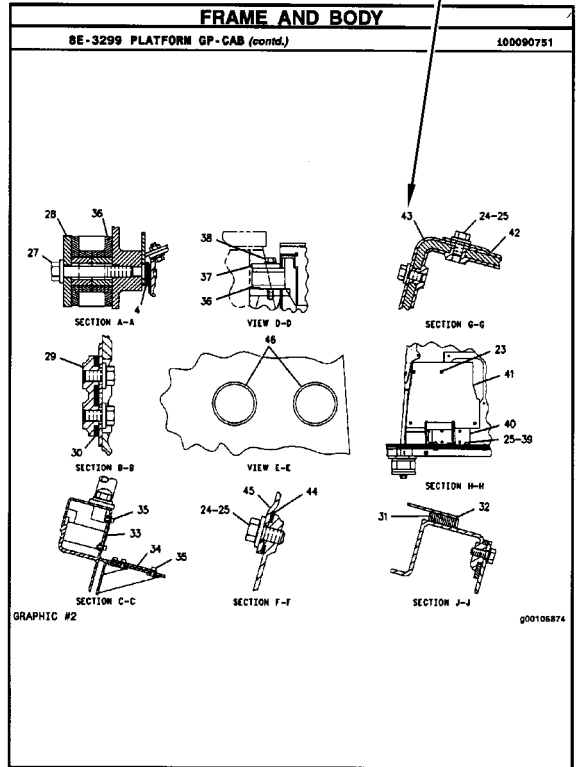

SELPA670-01 4 of 4 FRAME AND BODY 15

REPAIR ALTERNATIVES

REMANUFACTURED COMPONENTS

As an option when making repairs consider Caterpillar Remanufactured Components. Components that are available through the Caterpillar Remanufactured Program are identified three ways in the parts book:

- with the letter R in the note field of the parts list
- with an R* at the beginning of the first line of the caption
- with an *R at the end of the first line of the caption

Typical components included in the Remanufacturing Program include:

ALTERNATORS
CONNECTING RODS
CRANKSHAFTS - UNDERSIZE
CRANKSHAFTS - UPGRADE TO NEW
CYLINDER HEADS
ELECTRONIC CONTROL MODULES (ECM)
ELECTRONIC SENSORS
FUEL INJECTORS
FUEL NOZZLES
FUEL PUMPS
GOVERNORS
OIL PUMPS
PISTONS
SHORT BLOCKS
STARTERS
TURBOCHARGERS - COMPLETE
TURBOCHARGER CARTRIDGES
WATER PUMPS

Caterpillar Remanufactured engines for many engine arrangements are also available.

SUPPLEMENTAL COOLANT ADDITIVES

CUSTOMER BENEFITS:

Protects against cavitation, foam, erosion, corrosion, and scale buildup in cooling systems.

- Provides measured coolant conditioner.

DESCRIPTION:

Additives deplete from the coolant with normal operation. For this reason, Supplemental Coolant Additives (SCA) must be added to all heavy duty coolants at regular intervals. In addition, when not using a fully formulated, pre-charged antifreeze, like Caterpillar's DEAC, an initial charge of SCA must be added to the cooling system. The amount of SCA added to the system is dependent on the capacity of the system.

The SCA for initial fill is provided as a liquid. SCA's for maintenance intervals are available in liquid form and as a spin-on element. (No Spin-on available for 3600 Family of Engines)

NOTE:

The amount of SCA added at initial fill is not the same as the amount added at maintenance intervals.

The coolant additive elements can be used with any ethylene or propylene glycol type antifreeze which meets ASTM D4985 or ASTM D5345 Specifications.

NOTE:

For use with standard heavy duty coolant only, not for use with Extended Life Coolant.

PARTS NEEDED:

Cooling System Capacity		Liquid SCA at Initial Fill	Liquid SCA at Maintenance*	Spin-on SCA Maintenance Element*
Liters	Gallons			
22-30	(6-8)	3P-2044 (1)	6V-3542 (1)	111-2370 (1)
30-38	(8-10)	3P-2044 (1) 6V-3542 (1)	111-2372 (1)	111-2369 (1)
38-49	(10-13)	3P-2044 (1) 8T-1589 (1)	111-2372 (1)	111-2369 (1)
49-64	(13-17)	3P-2044 (2)	8T-1589 (1)	9N-3368 (1)
64-83	(17-22)	3P-2044 (2) 8T-1589 (1)	111-2372 (1) 6V-3542 (1)	111-2371 (1)
83-114	(22-30)	3P-2044 (3) 8T-1589 (1)	3P-2044 (1)	9N-3718 (1)
114-163	(30-43)	3P-2044 (5)	3P-2044 (1) 6V-3542 (1)	111-2371 (2)
163-242	(43-64)	3P-2044 (8)	3P-2044 (2)	9N-3718 (2)

* Normal maintenance period is 250 hrs. See your Operation and Maintenance Manual for complete coolant maintenance instructions.

() Indicates quantity required.

MAINTENANCE PARTS

DESCRIPTION	PART NUMBER	QTY	WHERE USED	PAGE
AIR INLET AND EXHAUST SYSTEM				
FILTER ELEMENT AS-AIR (PRIMARY)	227 - 7448	1	AIR CLEANER GP	76
FILTER ELEMENT-AIR (PRIMARY)	293 - 4053	1	AIR CLEANER GP	77
FILTER ELEMENT-AIR (SECONDARY)	227 - 7449	1	AIR CLEANER GP	76
		1	AIR CLEANER GP	77
BASIC ENGINE				
GASKET (VALVE COVER)	225 - 6451	1	COVER GP-VALVE MECHANISM	14
		1	COVER GP-VALVE MECHANISM	16
		1	COVER GP-VALVE MECHANISM	18
		1	COVER GP-VALVE MECHANISM	20
PLUG-DRAIN (ENGINE OIL)	7C - 0351	2	PAN GP-OIL	38
		2	PAN GP-OIL	40
COOLING SYSTEM				
CAP AS-COOLANT TANK	251 - 3227	1	TANK GP-EXPANSION	73
HOSE-RADIATOR (LOWER)	210 - 6139	1	MOUNTING GP-RAD & OIL COOLER	67
HOSE-RADIATOR (UPPER)	210 - 6141	1	MOUNTING GP-RAD & OIL COOLER	67
REGULATOR GP-TEMPERATURE (INCLUDES CONNECTOR) (WATER)	254 - 2267	1	CONNECTION GP-WATER	54
V-BELT (AIR CONDITIONER)	1W - 2934	1	FAN GP-SUCTION	59
	2P - 6818	1	FAN GP-SUCTION	60
V-BELT SET (INCLUDES 2-BELTS)	3S - 8447	1	FAN GP-SUCTION	59
		1	FAN GP-SUCTION	60
		1	FAN GP-SUCTION	61

MAINTENANCE PARTS

DESCRIPTION	PART NUMBER	QTY	WHERE USED	PAGE
ELECTRICAL AND STARTING SYSTEM				
BATTERY (12-VOLT, MAINTENANCE FREE)	230-6368	1	BATTERY & WIRING GP	107
		1	BATTERY & WIRING GP	109
		1	BATTERY & WIRING GP	110
		1	BATTERY & WIRING GP	112
BELT-DRIVE FLASHER AS (12-VOLT)	9X-8139	1	LAMP GP-WARNING BEACON	130
	7T-4848	1	WIRING GP-PLATFORM	178
		1	WIRING GP-PLATFORM	182
		1	WIRING GP-PLATFORM	186
FLASHER AS (12-VOLT) (HAZARD & TURN)	7T-4848	1	WIRING GP-PLATFORM	191
FUSE (10-AMPERE)	113-8490	11	PANEL GP-FUSE	138
	3K-8782	1	LAMP GP-WARNING BEACON	130
FUSE (15-AMPERE)	113-8491	13	PANEL GP-FUSE	138
FUSE (20-AMPERE)	113-8492	10	PANEL GP-FUSE	138
FUSE (40-AMPERE)	278-6377	1	RELAY GP	140
FUSE (60-AMPERE)	267-2701	2	RELAY GP	141
		1	RELAY GP	142
		1	WIRING GP-PLATFORM	178
		1	WIRING GP-PLATFORM	182
		1	WIRING GP-PLATFORM	186
		1	WIRING GP-PLATFORM	191
GLOW PLUG (12-VOLT)	232-6662	4	GLOW PLUG GP	117
		4	GLOW PLUG GP	118
KEY (BATTERY DISCONNECT)	8H-5306	1	SWITCH GP-DISCONNECT	149
LAMP (12-VOLT)	7X-9065	1	WIRING GP-CONSOLE	155
		1	WIRING GP-CONSOLE	158
LAMP (12-VOLT, 21-WATT)	3C-4883	1	LIGHTING GP-FLOOD & SIGNAL	131
		1	LIGHTING GP-FLOOD & SIGNAL	133
	9W-3326	1	LIGHTING GP-FLOOD & SIGNAL	131
		1	LIGHTING GP-FLOOD & SIGNAL	133
LAMP (12-VOLT, 5-WATT)	084-4348	1	LIGHTING GP-FLOOD & SIGNAL	131
		1	LIGHTING GP-FLOOD & SIGNAL	133
LAMP (12-VOLT, 55-WATT)	9W-0607	1	LAMP GP-FLOOD	128
		1	LAMP GP-FLOOD	129
	9X-8118	1	LAMP GP-WARNING BEACON	130
LAMP (12-VOLT, 55-WATT) (FLOODLIGHT)	9W-0607	1	LAMP GP-FLOOD	127
ENGINE ARRANGEMENT				
FILTER AS-ENGINE OIL	7W-2326	1	ENGINE AR-PRIMARY	10
FUEL SYSTEM				
CAP-FUEL	284-9039	1	TANK GP-FUEL	105
FILTER AS-WATER SEP & FUEL	228-9130	1	PUMP GP-FUEL PRM & PRIM FILTER	100
FILTER ELEMENT-FUEL (WATER SEPARATOR)	156-1200	1	FILTER GP-WATER SEP & FUEL	86
STRAINER-FUEL (FILLER NECK SCREEN)	180-3730	1	TANK GP-FUEL	105

MAINTENANCE PARTS

DESCRIPTION	PART NUMBER	QTY	WHERE USED	PAGE
HYDRAULIC SYSTEM				
CAP-FILL (HYDRAULIC OIL)	237-3797	1	TANK & MTG GP-HYDRAULIC	523
		1	TANK & MTG GP-HYDRAULIC	525
FILTER ELEMENT-BREATHER (HYDRAULIC TANK)	9R-9925	1	TANK & MTG GP-HYDRAULIC	523
		1	TANK & MTG GP-HYDRAULIC	525
FILTER ELEMENT-OIL (FLOW REGULATOR)	227-1197	1	MANIFOLD GP-CONTROL	508
FILTER-OIL (FIRE RESISTANT)	134-3014	1	FILTER GP-OIL	420
FILTER-OIL (ULTRA HIGH EFFICIENCY)	126-1817	1	FILTER GP-OIL	420
LUBRICATION SYSTEM				
FILTER AS-ENGINE OIL	7W-2326	1	GAUGE GP-OIL LEVEL & FILLER	52
OPERATOR STATION				
BLADE AS-WIPER (500-MM) (REAR)	5C-8811	1	WIPER GP-WINDOW	922
BLADE AS-WIPER (600-MM)	101-0745	1	WIPER & WASHER GP-WINDOW	920
BLADE AS-WIPER (600-MM) (FRONT)	101-0745	1	WIPER & WASHER GP-WINDOW	918
		1	WIPER GP-WINDOW	922
FILTER ELEMENT AS-AIR (CAB HEATER)	211-2661	1	AIR CONDITIONER & MOUNTING GP	787
		1	HEATER GP-CAB	844
FILTER ELEMENT-AIR (RECIRCULATION)	211-2660	1	HEATER GP-CAB	846
		1	HEATER GP-CAB	848
		1	HEATER GP-CAB	850
		1	HEATER GP-CAB	852
LAMP (12-VOLT)	122-7137	1	TACHOMETER GP-ELECTRIC	897
	210-8754	1	LINER GP-CAB	860
		1	LINER GP-CAB	862
SEAT BELT (2-IN)	206-1749	1	SEAT BELT GP	878
SEAT BELT GP	206-1750	1	SEAT BELT GP	879

MAINTENANCE PARTS

DESCRIPTION	PART NUMBER	QTY	WHERE USED	PAGE		
POWER TRAIN						
BREATHER (AXLE)	197-9155	1	AXLE GP-REAR	208		
BREATHER (FRONT AXLE)	253-5024	1	AXLE GP-DRIVE & STEERING	206		
BREATHER (TRANSMISSION)	7T-3251	1	TRANSMISSION GP-DIRECT DRIVE	265		
		1	TRANSMISSION GP-DIRECT DRIVE	270		
		1	TRANSMISSION GP-DIRECT DRIVE	276		
		1	TRANSMISSION GP-DIRECT DRIVE	281		
		1	TRANSMISSION GP-DIRECT DRIVE	286		
		1	TRANSMISSION GP-DIRECT DRIVE	291		
		1	TRANSMISSION GP-POWER SHIFT	296		
		1	TRANSMISSION GP-POWER SHIFT	302		
		BREATHER AS (SIDE)	293-2147	1	TRANSMISSION GP-DIRECT DRIVE	285
				1	TRANSMISSION GP-DIRECT DRIVE	290
BREATHER AS (TRANSMISSION)	293-2147	1	TRANSMISSION GP-DIRECT DRIVE	275		
		1	TRANSMISSION GP-DIRECT DRIVE	280		
FILTER-OIL (STANDARD EFFICIENCY) (HYDRAULIC)	294-9822	1	TRANSMISSION GP-DIRECT DRIVE	270		
	119-4740	1	POWER TRAIN AR	245		
PLUG AS-DRAIN (MAGNETIC)	152-6144	1	POWER TRAIN AR	246		
		4	AXLE GP-DRIVE & STEERING	206		
PLUG AS-DRAIN (MAGNETIC) (AXLE)	152-6144	1	DIFFERENTIAL & BEVEL GEAR GP	219		
		4	AXLE GP-REAR	208		
STRAINER (SUCTION)	7T-2651	1	CASE AS-TRANSMISSION	211		
		1	CASE GP-TRANSMISSION	214		
		1	CASE GP-TRANSMISSION	217		
		1	TRANSMISSION GP-POWER SHIFT	296		
		1	TRANSMISSION GP-POWER SHIFT	302		

INDEX

Name	Page	Name	Page
A			
ACCUMULATOR GP-PILOT OIL-CHARGED	384	BOX GP-BATTERY-WITH STORAGE	353
ACCUMULATOR GP-PILOT OIL- UNCHARGED	385	BRACE GP-LIFT CYLINDER	564
ACCUMULATOR GP-RIDE CONTROL- CHARGED	386	BRACKET AS	382
ACCUMULATOR GP-RIDE CONTROL- UNCHARGED	387	BRACKET GP-MOUNTING-MONITOR	790
ACCUMULATOR-REFRIGERANT (AIR CONDITIONER)	865	BRAKE GP-HYDRAULIC CALIPER	208
AIR CLEANER GP	74	BREATHER (AXLE)	208
	76	BREATHER (FRONT AXLE)	206
	77	BREATHER (TRANSMISSION)	265
AIR COMPRESSOR GP (SUSPENSION SEAT)	891		270
	893		276
AIR CONDITIONER & MOUNTING GP	787		281
ALTERNATOR GP-CHARGING- 120-AMPERE, WITH MOUNTING	106		286
ARM GP-LIFT	561		291
ARMREST AS (LH)	885		296
ARMREST AS (RH)	885		302
AXLE GP-DRIVE & STEERING-FRONT	206	BREATHER AS (SIDE)	285
AXLE GP-FRONT	341		290
AXLE GP-REAR	208	BREATHER AS (TRANSMISSION)	270
			275
			280
		BREATHER GP-TURBO	50
		BUCKET AR-GENERAL PURPOSE	607
		BUCKET AR-MULTIPURPOSE	607
			608
			609
		BUCKET AS-GENERAL PURPOSE	610
			612
			613
			615
			617
		BUCKET AS-HOE	618
			619
			620
			621
			622
			623
			624
			625
			626
			627
		BUCKET AS-HOE-CORAL	658
			659
			660
			661
		BUCKET AS-HOE-HEAVY-DUTY	628
			629
			630
			631
			632
			633
			634
			635
			636
			637
			638
			638
B			
BACKHOE AR-EXTENDABLE STICK	1		
BACKHOE AR-EXTENDABLE STICK- ACCUGRADE	2		
	3		
BACKHOE AR-STANDARD STICK	3		
BACKHOE AR-STANDARD STICK- ACCUGRADE	4		
	5		
BATTERY & WIRING GP	109		
BATTERY & WIRING GP-STANDARD	107		
	110		
	112		
BATTERY (12-VOLT, MAINTENANCE FREE)	107		
	109		
	110		
	112		
BELT-DRIVE	130		
BLADE AS-WIPER (500-MM) (REAR)	922		
BLADE AS-WIPER (600-MM)	920		
BLADE AS-WIPER (600-MM) (FRONT)	918		
	922		
BLOWER GP-CAB	852		
BLOWER GP-CAB (HEATER)	846		
	848		
	850		
BOOM GP	563		

INDEX

Name	Page	Name	Page
	639		707
BUCKET AS-HOE-HIGH CAPACITY	640		708
	641		709
	642		710
	643	BUCKET GP-HOE-HIGH CAPACITY	688
	644		689
	645		690
	646		691
	647		717
BUCKET AS-HOE-HIGH CAPACITY, PIN-LOCK	662	BUCKET GP-HOE-HIGH CAPACITY, PIN-LOCK	711
	663		712
	664		713
	665		714
	666		715
	667		716
	668		718
	669		719
BUCKET AS-HOE-ROCK	648		720
	649	BUCKET GP-HOE-ROCK	692
	650		693
	651		694
	652		695
	653		696
	654		703
	655	BUCKET GP-MULTIPURPOSE	721
	656		723
	657		724
BUCKET GP-GENERAL PURPOSE	670		725
	671	BULLDOZER AS	726
	672		727
	673		728
	674		729
	675		
	676		
BUCKET GP-HOE	677		
	678		
	679		
	680		
	681		
	701		
BUCKET GP-HOE-CORAL	697		
	698		
	699		
	700		
	704		
BUCKET GP-HOE-HEAVY DUTY	702		
BUCKET GP-HOE-HEAVY-DUTY	682		
	683		
	684		
	685		
	686		
	687		
BUCKET GP-HOE-HEAVY-DUTY, PIN-LOCK	705		
	706		

C

CAB AR-ENCLOSED ROPS	791
	792
	793
CAB AS	794
CAB GP-ENCLOSED ROPS	795
	798
CANOPY AR-OPEN ROPS	801
	802
CANOPY GP-OPEN ROPS- WITH FRONT WINDOW	805
CANOPY GP-OPEN ROPS- WITHOUT FRONT WINDOW	803
CAP AS-COOLANT TANK	73
CAP-FILL (HYDRAULIC OIL)	523
	525
CAP-FUEL	105
CARRIER AS-DIFFERENTIAL	219
CASE AS-TRANSMISSION-FRONT	211
CASE AS-TRANSMISSION-REAR	212

INDEX

Name	Page	Name	Page
CASE GP-TRANSMISSION-FRONT	214		
	217	COUPLER GP-QUICK-CAT, CASE	734
CASE GP-TRANSMISSION-REAR	215	COUPLER GP-QUICK-CAT, DEERE	736
CHASSIS AR	5	COUPLER GP-QUICK-PIN-LOCK	737
CLAM AS-MULTIPURPOSE BUCKET	730	COVER GP (OUTLET)	735
	731		531
COMMON AR	6		532
COMPRESSOR & MTG GP-REFRIG	806	COVER GP-CAB	833
	808	COVER GP-CYLINDER HEAD	13
COMPRESSOR GP-REFRIGERANT	810	COVER GP-VALVE MECHANISM	14
CONDENSER & MTG GP-REFRIGERANT	811		16
CONNECTION GP-WATER	54		18
CONSOLE GP-OPERATOR-FRONT	816		20
CONSOLE GP-OPERATOR-LH	814	COVER GP-WIPER MOTOR	834
CONSOLE GP-OPERATOR-RH	812	CRANKSHAFT GP	22
CONTROL AR-RIDE	387		24
CONTROL GP-GOVERNOR	83	CUSHION GP-SEAT	887
	84		888
CONTROL GP-HYDRAULIC HAND-LOADER	818	CYLINDER & LINES GP-THUMB	388
	820		389
CONTROL GP-JOYSTICK-LH	825	CYLINDER BLOCK GP	25
	826		27
CONTROL GP-JOYSTICK-RH	823	CYLINDER GP-BACKHOE BUCKET	393
	824		395
CONTROL GP-PARKING BRAKE	330	CYLINDER GP-BOOM	397
	331		399
CONTROL GP-SERVICE BRAKE- STANDARD SHIFT	332	CYLINDER GP-BRAKE	338
	335		339
CONTROL GP-STEERING-TILT	827	CYLINDER GP-EXTENDABLE STICK	401
	829		602
CONTROL GP-TRANSMISSION	831	CYLINDER GP-LIFT	403
CONTROL GP-TRANSMISSION (FORWARD, NEUTRAL, REVERSE)	205	CYLINDER GP-MULTIPURPOSE BUKT	404
	831	CYLINDER GP-STABILIZER-LH	405
CONTROL GP-UNPRGMED MONITOR (ADVISOR)	116	CYLINDER GP-STABILIZER-RH	407
CONTROL GP-UNPROGRAMMED (MACHINE)	114	CYLINDER GP-STEERING	206
	115		341
COOLER GP-ENGINE OIL	55	CYLINDER GP-STICK	409
	56		411
	57	CYLINDER GP-SWING	412
COOLER GP-FLTR BASE & ENG OIL	57		413
	58	CYLINDER GP-THUMB	415
CORE AS-OIL COOLER (HYDRAULIC)	71	CYLINDER GP-TILT	416
	72	CYLINDER HEAD GP	28
CORE AS-OIL COOLER (TRANSMISSION)	71		29
	72		
COUNTERWEIGHT GP	354		
	355		
	356		
	357		
COUPLER AR-QUICK-PIN-LOCK	732		
COUPLER GP-QUICK-BACKHOE	733		

D

DIAPHRAGM (CRANKCASE PRESSURE CONTACTOR)	14
	16
DIFFERENTIAL & BEVEL GEAR GP	219
DIFFERENTIAL GP	221
	222
DOOR GP-BATTERY	358
DOOR GP-CAB-LH	835

INDEX

Name	Page	Name	Page
	837	FILM-IDENTIFICATION (CAT)	382
DOOR GP-CAB-RH	839		383
	841	FILM-IDENTIFICATION (CATERPILLAR)	801
DRIVE & MTG GP-PUMP	418		846
DRIVE AR-BACKHOE LOADER-			848
2-WHEEL DRIVE, 2-WHEEL STEER	6		850
DRIVE AR-BACKHOE LOADER-			852
ALL WHEEL DRIVE, 2-WHEEL STEER	7	FILM-IDENTIFICATION	
DRIVE GP-FAN	30	(CATERPILLAR, FRONT)	791
DRIVE GP-FLEXIBLE COUPLING	223		792
			793
			802
		FILM-IDENTIFICATION (CONSOLE, RH)	155
			158
		FILM-IDENTIFICATION	
		(STABILIZER CONTROL)	791
			801
			802
		FILM-INSTRUCTION (BUCKET CONTROL)	529
		FILM-INSTRUCTION	
		(EXTENDABLE STICK PIN, READ OMM)	1
			2
			3
		FILM-INSTRUCTION (LINK)	568
		FILM-INSTRUCTION (NO STEP)	926
		FILM-INSTRUCTION (OIL FLOW DIRECTION)	435
		FILM-INSTRUCTION (UNLOCK)	381
		FILM-INSTRUCTION (WASHER FILL)	902
			904
			918
			920
		FILM-STRIPE (YELLOW)	377
			379
			382
		FILM-WARNING	
		(ACCUM, HIGH PRESS, READ OMM)	386
			470
		FILM-WARNING	
		(HIGH PRESS CYLINDER, READ OMM)	425
			428
			476
		FILM-WARNING	
		(HIGH PRESS CYLINDER, READ OMM)	
		(INTL)	478
		FILM-WARNING	
		(HIGH PRESS CYLINDER, READ OMM)	
		(U.S.)	478
		FILM-WARNING	
		(HIGH PRESSURE, READ OMM)	386
		FILM-WARNING	
		(HIGH PRESSURE, READ OMM, U.S.)	423
		FILM-WARNING	
		(HOT FLUID UND PRESS, READ OMM)	927
		FILM-WARNING	
		(HYD PRESS, READ OMM, INTL)	435

INDEX

Name	Page	Name	Page
H			182
HANDLE GP-MODULAR (LH)	825	HARNES AS-RIDE CONTROL	201
	826		423
HANDLE GP-MODULAR (RH)	823		425
	824		428
HARNES AS-AUXILIARY (HORN)	162		891
HARNES AS-AUXILIARY (REAR)	160		893
	161	HARNES AS-SENSOR	4
HARNES AS-CAB	178	HARNES AS-SENSOR (ACCUGRADE)	5
	182	HARNES AS-SENSOR (BACKHOE)	2
	186	HARNES AS-SENSOR	
	902	(BOOM, STICK, BUCKET)	169
	904		171
HARNES AS-CAB (WIPER MOTOR)	918	HARNES AS-SENSOR (SWING)	169
	920		171
HARNES AS-CONSOLE (FRONT)	157	HARNES AS-SENSOR (W/E-STICK)	3
HARNES AS-CONSOLE (SIDE)	155	HARNES AS-TRANSMISSION	205
	158	HARNES AS-WIRING	177
HARNES AS-CONTROL		HARNES AS-WIRING (AUTOSHIFT)	205
(ACCUGRADE, SITE REFERENCE)	854	HARNES AS-WIRING	
HARNES AS-CONTROL (PRODUCT LINK)	125	(DIFFERENTIAL LOCK)	148
HARNES AS-ENGINE	163	HARNES AS-WIRING	
	165	(EXTENDABLE STICK)	168
HARNES AS-FUEL TANK (FUEL SHUTOFF) ...	8	HARNES AS-WIRING	
HARNES AS-HEATER	850	(KICKOUT, POSITIONER)	175
	852		176
HARNES AS-HEATER & AIR COND	151		177
	846	HARNES AS-WIRING (MAST)	119
	848		121
HARNES AS-HEATER & AIR COND			136
(COMPRESSOR)	151	HARNES AS-WIRING (RESISTOR)	191
	153	HARNES AS-WIRING (RESISTOR)	
HARNES AS-HEATER & AIR COND		(LADDER)	179
(PLATFORM)	153		182
	173		186
HARNES AS-HEATER & AIR COND		HEATER GP-CAB	844
(POWER)	151		846
	153		848
HARNES AS-LIGHTING (ROOF)	131		850
	133		852
HARNES AS-PANEL		HEATER GP-JACKET WATER	122
(AUTOSHIFT, STAND SHIFT SWITCH)	205	HOOD & GUARD GP	377
HARNES AS-PLATFORM	191		379
HARNES AS-PLATFORM (DISPLAY)	169	HOOD GP-ENGINE	381
	171		382
HARNES AS-POWER (DISTRIBUTION)	178		383
	182	HOSE-RADIATOR (LOWER)	67
	186	HOSE-RADIATOR (UPPER)	67
	191	HOUSING & FLANGE GP-AXLE-LH	233
HARNES AS-RADIO (PRODUCT LINK)	123	HOUSING & FLANGE GP-AXLE-RH	232
	124	HOUSING GP-AXLE-LH	235
HARNES AS-REAR (PLATFORM)	197	HOUSING GP-AXLE-REAR	236
	199	HOUSING GP-AXLE-RH	234
HARNES AS-REAR (STABILIZER, AUTO UP) ...	178	HOUSING GP-FLYWHEEL	32

INDEX

Name	Page	Name	Page
HOUSING GP-FRONT	33		
HYDRAULIC AR	422	LAMP GP-FLOOD	862
			127
			128
			129
I		LAMP GP-HEAD & SIGNAL (DIRECTIONAL)	131
INDICATOR AS			133
(HIGH BEAM, TURN SIGNAL RH)	178	LAMP GP-SIGNAL (STOP, TAIL, TURN)	131
	182		133
	186	LAMP GP-WARNING BEACON-	
	191	AMBER, MAGNETIC MOUNT, ROTATING	130
INDICATOR AS (HYD OIL TEMP, FILTER)	167	LATCH GP-CAB DOOR & WINDOW	857
INDICATOR AS		LATCH GP-CAB DOOR & WINDOW-RH	856
(TURN SIGNAL LH, PARKING BRAKE)	178	LATCH GP-CONSOLE	858
	182	LEVER GP-GOVERNOR (HANDHELD)	83
	186		84
	191	LEVER GP-GOVERNOR-HANDHELD	859
INDICATOR GP-AIR FILTER CHANGE	79	LEVER GP-HAND CONTROL	340
INDICATOR-AIR FILTER SERVICE	79	LIFTING GP-ENGINE	35
INSTALLATION GP-COMMUNICATION-		LIGHTING GP-FLOOD & SIGNAL-	
PRODUCT LINK 121SR	123	NACD, OPTIONAL	131
	124		133
INSTALLATION GP-COMMUNICATION-		LIGHTING GP-WARNING BEACON-	
PRODUCT LINK 300	125	AMBER, MAGNETIC MOUNT, ROTATING	135
INSTALLATION GP-MONITOR-ADVISOR	854	LINER GP-CAB	860
INSTALLATION GP-RIDE CONTROL-			862
AUTOSHIFT	423	LINES GP-BACKHOE AUXILIARY	435
	425		437
	428		440
		LINES GP-BOOM	443
			445
		LINES GP-BUCKET	447
			449
K			451
KEY (BATTERY DISCONNECT)	149		454
KICKOUT & POSITIONER GP	431	LINES GP-DRAIN	456
	433	LINES GP-EXTENDABLE STICK	457
KIT-RECEPTACLE (2-PIN)	178		602
KIT-WHEEL SPACER	238		604
KNOB GP-STEERING	343	LINES GP-FUEL	87
	829	LINES GP-FUEL FILTER	89
		LINES GP-HEATER	864
		LINES GP-HEATER & AIR COND	865
		LINES GP-HYDRAULIC	445
			449
			454
			499
		LINES GP-HYDRAULIC OIL COOLER	459
		LINES GP-LIFT CYLINDER	460
		LINES GP-LOADER AUXILIARY	462
		LINES GP-MULTIPURPOSE BUCKET	464
			466
		LINES GP-PILOT-SIGNAL	468
		LINES GP-PILOT-STABILIZER	473
		LINES GP-PILOT-WITH ACCUMULATOR	470
L			
LAMP (12-VOLT)	155		
	158		
	860		
	862		
	897		
LAMP (12-VOLT, 21-WATT)	131		
	133		
LAMP (12-VOLT, 5-WATT)	131		
	133		
LAMP (12-VOLT, 55-WATT)	128		
	129		
	130		
LAMP (12-VOLT, 55-WATT) (FLOODLIGHT)	127		
LAMP GP-DOME (12-VOLT)	860		

INDEX

Name	Page	Name	Page
LINES GP-POWER TRAIN OIL- DIFFERENTIAL LOCK	239	MANIFOLD & SOLENOID GP-CONTROL- INLET	507
LINES GP-PUMP	474	MANIFOLD GP-CONTROL (INLET)	507
LINES GP-RIDE CONTROL	476	MANIFOLD GP-CONTROL-INLET	509
	478	MANIFOLD GP-CONTROL-OUTLET	508
LINES GP-STABILIZER	480	MANIFOLD GP-HYDRAULIC	537
	482		539
	484		548
LINES GP-STABILIZER-6-BANK	492		549
	494	MANIFOLD GP-RIDE CONTROL	510
	496	MAST GP-LASER RECEIVER	136
LINES GP-STABILIZER-7-BANK	486	MIRROR GP-REAR VIEW-INTERIOR	867
	488		868
	490	MODULE GP-WARNING INDICATOR (WITH ALARM, FUNCTION LIGHTS)	155
LINES GP-STEERING	344		158
	346	MOTOR GP-WINDOW WIPER (FRONT)	869
	348	MOTOR GP-WINDOW WIPER (REAR)	922
	350	MOTOR GP-WINDOW WIPER-FRONT	869
LINES GP-STICK	498	MOUNTING & LINES GP-RADIATOR- TRANSMISSION, HYDRAULIC OIL	66
	499		240
LINES GP-SWING	501	MOUNTING GP-AXLE	240
LINES GP-TILT CYLINDER	503	MOUNTING GP-BACKHOE CONTROL- PILOT	870
LINES GP-TRANSMISSION COOLER	62		511
	64	MOUNTING GP-BUCKET	744
LINK GP-THUMB	754	MOUNTING GP-CAB	873
	755	MOUNTING GP-CYLINDER- EXTENDABLE STICK	512
	756		513
	757	MOUNTING GP-CYLINDER-THUMB	515
	769		36
	770	MOUNTING GP-ENGINE	37
	771	MOUNTING GP-ENGINE & XMSN	516
	772	MOUNTING GP-LINES-BACKHOE	518
	773		745
	774	MOUNTING GP-MAST-GRADE CONTROL	874
	775	MOUNTING GP-MONITOR-ACCUGRADE	67
	776	MOUNTING GP-RAD & OIL COOLER- TRANSMISSION, HYDRAULIC OIL	137
	777		241
	778	MOUNTING GP-SENSOR-ANGLE	242
	779	MOUNTING GP-TRANSMISSION	322
	783		316
LINK GP-THUMB-ADJUSTABLE	567	MOUNTING GP-WHEEL	317
LINKAGE GP-BACKHOE BUCKET	568	MOUNTING GP-WHEEL (FRONT)	321
LINKAGE GP-LOADER BUCKET	570		323
LOADER AR	7		325
LOCK GP-TRANSPORT	572		327
	576		318
LOCK GP-TRANSPORT-BOOM	574	MOUNTING GP-WHEEL (REAR)	320
LOCK GP-TRANSPORT-STABILIZER	573		324
LOCK GP-VANDALISM	925		326
			328
		MUFFLER GP	80

M

INDEX

Name	Page	Name	Page
P			673
PAD & GUARD GP-STABILIZER	583		677
	585		678
	587		679
PAD & GUARD GP-STABILIZER-STREET	577		680
	579		681
	581		682
	589		683
	591		684
	593		685
PAD & MTG GP-STABILIZER	597		686
PAD & MTG GP-STABILIZER-STREET	595		687
	596		688
PAD GP-STABILIZER-STREET	598		689
	599		690
PADLOCK GP (VANDALISM GUARD)	925		691
PAN GP-OIL	38		692
	40		693
PANEL GP-FUSE-INCLUDES RELAY	138		694
PEDAL GP-GOVERNOR	875		695
PIN GP-COUPLER (PIN-LOCK)	732		696
PIN GP-COUPLER-MACHINE	746		697
PIN GP-COUPLER-PIN-LOCK	747		698
PISTON & ROD GP	42		699
PLANETARY GP-FINAL DRIVE	243		700
	244		717
PLATE & FILM GP	925		718
	928		719
PLATE-IDENTIFICATION (CAT)	618		720
	620	PLUG AS-DRAIN (MAGNETIC)	206
	622		219
	624	PLUG AS-DRAIN (MAGNETIC) (AXLE)	208
	626	PLUG GP-CONTROL MANIFOLD	508
	628	PLUG GP-CONTROL VALVE	537
	630		539
	632		541
	634		543
	636		545
	638		547
	640		550
	642	PLUG GP-ENGINE	43
	644		44
	646		45
	648	PLUG-DRAIN (ENGINE OIL)	38
	650		40
	652	POWER TRAIN AR-2-WHEEL DRIVE, 2-WHEEL	
	654	STEER, STD SHIFT	246
	656	POWER TRAIN AR-ALL WHEEL DRIVE,	
	658	2-WHEEL STEER, AUTOSHIFT	245
	659	POWER TRAIN AR-ALL WHEEL DRIVE,	
	660	2-WHEEL STEER, STD SHIFT	245
	661	PROTECTION GP-VANDALISM-	
	667	ROTATING GUARD	929
PLATE-IDENTIFICATION (WORK TOOL)	671	PULLEY GP-CRANKSHAFT	46
		PUMP GP-ENGINE OIL	53

INDEX

Name	Page	Name	Page
PUMP GP-FUEL INJECTION	90	RELAY AS (12-VOLT) (HORN)	178
	91		182
	92		186
	93		191
	94	RELAY AS (12-VOLT) (IMPLEMENT DISABLE) ...	178
	97		182
PUMP GP-FUEL PRM & PRIM FILTER- WITH MOUNTING	101		186
	102	RELAY AS (12-VOLT) (POSITION LAMP)	178
			182
PUMP GP-FUEL PRM & PRIM FILTER- WITH WATER SEPARATOR	100		186
PUMP GP-METERING-HMU	352		191
PUMP GP-PISTON	519	RELAY AS (12-VOLT) (RIDE CONTROL)	201
PUMP GP-TRANSMISSION	265		423
	270		425
	275		428
	280	RELAY AS (12-VOLT) (START)	163
	285		165
	290	RELAY AS (12-VOLT) (STARTING AID)	163
	296		165
	302	RELAY AS (12-VOLT) (TORQUE LIMITER)	178
PUMP GP-WATER	69		183
			187
			191
R			
RADIATOR & OIL COOLER GP- HYDRAULIC, TRANSMISSION	71	RELAY AS-TIMER (STABILIZER, AUTO UP, 12-VOLT)	203
	72		204
RADIATOR GP	71	RELAY GP-POWER DISTRIBUTION	140
	72	RELAY GP-POWER, 1	141
RADIO GP-COMMUNICATION- PRODUCT LINK 121SR	876	RELAY GP-POWER, 2	142
RECEIVER GP-LASER (LR400C)	119	ROCKER ARM GP	47
RECEIVER GP-LASER (LR410)	139	ROOF GP-CAB	877
RECEIVER GP-LASER-SINGLE	139	ROTATING GP-PUMP	521
REGULATOR GP-TEMPERATURE (INCLUDES CONNECTOR) (WATER)	54	S	
RELAY AS (12-VOLT) (ACCUGRADE)	121	SEAT BELT (2-IN)	878
RELAY AS (12-VOLT) (ACCUGRADE, MAST) ...	119	SEAT BELT GP	879
RELAY AS (12-VOLT) (AIR CONDITIONER)	151	SEAT BELT GP-RETRACTABLE, 2-IN	878
	153	SEAT BELT GP-RETRACTABLE, 3-IN	879
	173	SEAT GP-CLOTH	882
RELAY AS (12-VOLT) (ALL WHEEL DRIVE)	147	SEAT GP-VINYL	880
RELAY AS (12-VOLT) (BACKUP ALARM)	178	SEAT GP-SUSPENSION-CLOTH	885
	182		890
	186	SEAT GP-SUSPENSION-DELUXE, CLOTH	886
	191		887
RELAY AS (12-VOLT) (DIFFERENTIAL LOCK) ...	178		888
	182	SEAT GP-SUSPENSION-VINYL	884
	186		890
	191	SENDER AS-FUEL LEVEL	104
RELAY AS (12-VOLT) (FUEL PUMP)	163	SENDER AS-TEMPERATURE (12-VOLT)	265
	165		271
RELAY AS (12-VOLT) (HEATER, A/C POWER) ...	151		276
	153		281

INDEX

Name	Page	Name	Page
SENDER AS-TEMPERATURE (12-VOLT) (TRANSMISSION OIL).....	286	SHAFT GP-PUMP DRIVE	522
	291	SOFTWARE GP-COMMUNICATION (PRODUCT LINK 300).....	114
	296	SOFTWARE GP-MACHINE	114
	302	SOFTWARE GP-MONITOR.....	116
SENDER AS-TEMPERATURE (ENGINE COOLANT).....	163	SPRING AS-GAS (LH).....	381
	165	SPRING GP-GAS	835
SENSOR AS-POSITION (ANGLE)	854		837
SENSOR AS-POSITION (BOOM SWING).....	854		839
SENSOR GP-MOISTURE (WATER SEPARATOR).....	100		841
SENSOR GP-POSITION	393	SPRING GP-GAS (RH)	381
	399	SPRING-GAS	910
	401		912
SENSOR GP-POSITION (LINEAR).....	409	STABILIZER GP-BACKHOE	600
SENSOR GP-SPEED (TORQUE CONVERTER OUTPUT).....	265	STARTING MOTOR GP-ELECTRIC	144
	270	STARTING MOTOR GP-ELECTRIC-12-VOLT ...	146
	275	STEERING COLUMN GP (TILT).....	829
	280	STICK AS	601
	286	STICK GP-EXTENDABLE	602
	291		604
SENSOR GP-SPEED (TRANSMISSION OUTPUT).....	297	STICK GP-HOE	606
	303	STRAINER (SUCTION).....	211
SENSOR GP-SPEED-OUTPUT- TORQUE CONVERTER.....	143		214
SENSOR GP-TEMPERATURE (HYDRAULIC OIL).....	167		217
SERVICE GP-MACHINE	114		296
SERVICE GP-MONITOR	116		302
SHAFT GP-AXLE	206	STRAINER-FUEL (FILLER NECK SCREEN).....	105
SHAFT GP-COUNTER	247	SUN VISOR	900
	265		901
	270	SUSPENSION GP-SEAT	891
	275		893
	280	SWITCH AS (LOWER LIMIT).....	136
SHAFT GP-COUNTER (TRANSMISSION).....	285	SWITCH AS (PARKING BRAKE)	330
	290	SWITCH AS (PUSH BUTTON).....	818
SHAFT GP-DRIVE-FRONT	249		820
SHAFT GP-DRIVE-REAR	249	SWITCH AS (STARTING MOTOR)(12-VOLT)	144
SHAFT GP-IDLER	250	SWITCH AS (UPPER LIMIT)	136
	265	SWITCH AS-FOOT	
	270	(DIFFERENTIAL LOCK ON, OFF)	148
	275	SWITCH AS-LIMIT (BRAKE PEDAL)	332
	280		335
SHAFT GP-IDLER (TRANSMISSION).....	285	SWITCH AS-LIMIT (SUSPENSION SEAT)	891
	290	SWITCH AS-MULTIFUNCTION	
SHAFT GP-INPUT	252	(HD LIGHT, TURN SIG, WDO WIPER).....	178
	254		182
SHAFT GP-OUTPUT-FRONT	259		186
	261	SWITCH AS-FOOT	
SHAFT GP-OUTPUT-MAIN	256	(DIFFERENTIAL LOCK ON, OFF)	148
SHAFT GP-OUTPUT-REAR	258	SWITCH AS-LIMIT (BRAKE PEDAL)	332
			335
		SWITCH AS-LIMIT (SUSPENSION SEAT)	891
		SWITCH AS-MULTIFUNCTION	
		(HD LIGHT, TURN SIG, WDO WIPER).....	178
			182
			186
		SWITCH AS-FOOT	
		(DIFFERENTIAL LOCK ON, OFF)	148
		SWITCH AS-LIMIT (BRAKE PEDAL)	332
			335
		SWITCH AS-LIMIT (SUSPENSION SEAT)	891
		SWITCH AS-MULTIFUNCTION	
		(HD LIGHT, TURN SIG, WDO WIPER).....	178
			182
			186
		SWITCH AS-FOOT	
		(DIFFERENTIAL LOCK ON, OFF)	148
		SWITCH AS-LIMIT (BRAKE PEDAL)	332
			335
		SWITCH AS-LIMIT (SUSPENSION SEAT)	891
		SWITCH AS-MULTIFUNCTION	
		(HD LIGHT, TURN SIG, WDO WIPER).....	178
			182
			186
		SWITCH AS-FOOT	
		(DIFFERENTIAL LOCK ON, OFF)	148
		SWITCH AS-LIMIT (BRAKE PEDAL)	332
			335
		SWITCH AS-LIMIT (SUSPENSION SEAT)	891
		SWITCH AS-MULTIFUNCTION	
		(HD LIGHT, TURN SIG, WDO WIPER).....	178
			182
			186
		SWITCH AS-FOOT	
		(DIFFERENTIAL LOCK ON, OFF)	148
		SWITCH AS-LIMIT (BRAKE PEDAL)	332
			335
		SWITCH AS-LIMIT (SUSPENSION SEAT)	891
		SWITCH AS-MULTIFUNCTION	
		(HD LIGHT, TURN SIG, WDO WIPER).....	178
			182
			186
		SWITCH AS-FOOT	
		(DIFFERENTIAL LOCK ON, OFF)	148
		SWITCH AS-LIMIT (BRAKE PEDAL)	332
			335
		SWITCH AS-LIMIT (SUSPENSION SEAT)	891
		SWITCH AS-MULTIFUNCTION	
		(HD LIGHT, TURN SIG, WDO WIPER).....	178
			182
			186
		SWITCH AS-FOOT	
		(DIFFERENTIAL LOCK ON, OFF)	148
		SWITCH AS-LIMIT (BRAKE PEDAL)	332
			335
		SWITCH AS-LIMIT (SUSPENSION SEAT)	891
		SWITCH AS-MULTIFUNCTION	
		(HD LIGHT, TURN SIG, WDO WIPER).....	178
			182
			186
		SWITCH AS-FOOT	
		(DIFFERENTIAL LOCK ON, OFF)	148
		SWITCH AS-LIMIT (BRAKE PEDAL)	332
			335
		SWITCH AS-LIMIT (SUSPENSION SEAT)	891
		SWITCH AS-MULTIFUNCTION	
		(HD LIGHT, TURN SIG, WDO WIPER).....	178
			182
			186
		SWITCH AS-FOOT	
		(DIFFERENTIAL LOCK ON, OFF)	148
		SWITCH AS-LIMIT (BRAKE PEDAL)	332
			335
		SWITCH AS-LIMIT (SUSPENSION SEAT)	891
		SWITCH AS-MULTIFUNCTION	
		(HD LIGHT, TURN SIG, WDO WIPER).....	178
			182
			186
		SWITCH AS-FOOT	
		(DIFFERENTIAL LOCK ON, OFF)	148
		SWITCH AS-LIMIT (BRAKE PEDAL)	332
			335
		SWITCH AS-LIMIT (SUSPENSION SEAT)	891
		SWITCH AS-MULTIFUNCTION	
		(HD LIGHT, TURN SIG, WDO WIPER).....	178
			182
			186
		SWITCH AS-FOOT	
		(DIFFERENTIAL LOCK ON, OFF)	148
		SWITCH AS-LIMIT (BRAKE PEDAL)	332
			335
		SWITCH AS-LIMIT (SUSPENSION SEAT)	891
		SWITCH AS-MULTIFUNCTION	
		(HD LIGHT, TURN SIG, WDO WIPER).....	178
			182
			186
		SWITCH AS-FOOT	
		(DIFFERENTIAL LOCK ON, OFF)	148
		SWITCH AS-LIMIT (BRAKE PEDAL)	332
			335
		SWITCH AS-LIMIT (SUSPENSION SEAT)	891
		SWITCH AS-MULTIFUNCTION	
		(HD LIGHT, TURN SIG, WDO WIPER).....	178
			182
			186
		SWITCH AS-FOOT	
		(DIFFERENTIAL LOCK ON, OFF)	148
		SWITCH AS-LIMIT (BRAKE PEDAL)	332
			335
		SWITCH AS-LIMIT (SUSPENSION SEAT)	891
		SWITCH AS-MULTIFUNCTION	
		(HD LIGHT, TURN SIG, WDO WIPER).....	178
			182
			186
		SWITCH AS-FOOT	
		(DIFFERENTIAL LOCK ON, OFF)	148
		SWITCH AS-LIMIT (BRAKE PEDAL)	332
			335
		SWITCH AS-LIMIT (SUSPENSION SEAT)	891
		SWITCH AS-MULTIFUNCTION	
		(HD LIGHT, TURN SIG, WDO WIPER).....	178
			182
			186
		SWITCH AS-FOOT	
		(DIFFERENTIAL LOCK ON, OFF)	148
		SWITCH AS-LIMIT (BRAKE PEDAL)	332
			335
		SWITCH AS-LIMIT (SUSPENSION SEAT)	891
		SWITCH AS-MULTIFUNCTION	
		(HD LIGHT, TURN SIG, WDO WIPER).....	178
			182
			186
		SWITCH AS-FOOT	
		(DIFFERENTIAL LOCK ON, OFF)	148
		SWITCH AS-LIMIT (BRAKE PEDAL)	332
			335
		SWITCH AS-LIMIT (SUSPENSION SEAT)	891
		SWITCH AS-MULTIFUNCTION	
		(HD LIGHT, TURN SIG, WDO WIPER).....	178
			182
			186
		SWITCH AS-FOOT	
		(DIFFERENTIAL LOCK ON, OFF)	148
		SWITCH AS-LIMIT (BRAKE PEDAL)	332
			335
		SWITCH AS-LIMIT (SUSPENSION SEAT)	891
		SWITCH AS-MULTIFUNCTION	
		(HD LIGHT, TURN SIG, WDO WIPER).....	178
			182
			186
		SWITCH AS-FOOT	
		(DIFFERENTIAL LOCK ON, OFF)	148
		SWITCH AS-LIMIT (BRAKE PEDAL)	332
			335
		SWITCH AS-LIMIT (SUSPENSION SEAT)	891
		SWITCH AS-MULTIFUNCTION	
		(HD LIGHT, TURN SIG, WDO WIPER).....	178
			182
			186
		SWITCH AS-FOOT	
		(DIFFERENTIAL LOCK ON, OFF)	148
		SWITCH AS-LIMIT (BRAKE PEDAL)	332
			335
		SWITCH AS-LIMIT (SUSPENSION SEAT)	891
		SWITCH AS-MULTIFUNCTION	
		(HD LIGHT, TURN SIG, WDO WIPER).....	178
			182
			186
		SWITCH AS-FOOT	
		(DIFFERENTIAL LOCK ON, OFF)	148
		SWITCH AS-LIMIT (BRAKE PEDAL)	332
			335
		SWITCH AS-LIMIT (SUSPENSION SEAT)	891
		SWITCH AS-MULTIFUNCTION	
		(HD LIGHT, TURN SIG, WDO WIPER).....	178
			182
			186
		SWITCH AS-FOOT	
		(DIFFERENTIAL LOCK ON, OFF)	148
		SWITCH AS-LIMIT (BRAKE PEDAL)	332
			335
		SWITCH AS-LIMIT (SUSPENSION SEAT)	891
		SWITCH AS-MULTIFUNCTION	
		(HD LIGHT, TURN SIG, WDO WIPER).....	178
			182
			186
		SWITCH AS-FOOT	
		(DIFFERENTIAL LOCK ON, OFF)	148
		SWITCH AS-LIMIT (BRAKE PEDAL)	332
			335
		SWITCH AS-LIMIT (SUSPENSION SEAT)	891
		SWITCH AS-MULTIFUNCTION	
		(HD LIGHT, TURN SIG, WDO WIPER).....	178
			182
			186
		SWITCH AS-FOOT	

INDEX

Name	Page	Name	Page
	425	SWITCH GP-ALL WHEEL DRIVE-	
	428	INCLUDES RELAY	147
SWITCH AS-ROCKER (AIR CONDITIONER, HEATER SELECT)	151	SWITCH GP-DIFFERENTIAL LOCK-	
	153	CENTER PIVOT MACHINE	148
SWITCH AS-ROCKER (ALL WHEEL DRIVE)	147	SWITCH GP-DISCONNECT-BATTERY	149
SWITCH AS-ROCKER (AUTOSHIFT, STANDARD SHIFT)	205	SWITCH GP-PRESSURE	332
SWITCH AS-ROCKER (AUXILIARY HYDRAULIC FLOW)	530	SWITCH GP-PRESSURE (BRAKE)	335
SWITCH AS-ROCKER (BLOWER FAN SPEED)	151	SWITCH GP-PRESSURE-ENGINE OIL	150
	153	SWITCH GP-PUSH BUTTON (NEUTRALIZER, DOWNSHIFT)	818
	173		820
SWITCH AS-ROCKER (FLOODLIGHT, FRONT)	133		831
SWITCH AS-ROCKER (FLOODLIGHT, REAR) ...	133	SWITCH-TEMPERATURE (AIR CONDITIONER)	846
SWITCH AS-ROCKER (FLOODLIGHTS, FRONT)	131		848
SWITCH AS-ROCKER (FLOODLIGHTS, REAR)	131	SWITCH-TEMPERATURE (ENGINE COOLANT)	163
SWITCH AS-ROCKER (HAZARD WARNING LIGHTS)	178		165
	182	SWITCH-TEMPERATURE (FUEL)	94
	186		97
	191	SYNCHRONIZER GP	258
SWITCH AS-ROCKER (HEATER)	173		260
SWITCH AS-ROCKER (HORN)	829		
SWITCH AS-ROCKER (HYDRAULIC LOCKOUT)	158		
SWITCH AS-ROCKER (HYDRAULIC LOCKOUT) (IMPLEMENT DISABLE)	155		
SWITCH AS-ROCKER (MODE SELECT)	178		
	182		
	186		
	191		
SWITCH AS-ROCKER (RIDE CONTROL)	201		
	423		
	425		
	428		
SWITCH AS-ROCKER (STARTING AID)	155		
	158		
SWITCH AS-ROCKER (TRANSMISSION NEUTRAL LOCK)	157		
SWITCH AS-ROCKER (WARNING BEACON) ...	155		
	158		
SWITCH AS-ROCKER (WIPER, WASHER, REAR)	922		
SWITCH AS-ROLLER (KICKOUT, POSITIONER)	175		
	176		
	177		
SWITCH AS-START (KEY)	155		
	158		

T

TACHOMETER GP-ELECTRIC	897
TANK & MTG GP-FUEL-INCLUDES STEP	103
TANK & MTG GP-HYDRAULIC	523
	525
TANK GP-EXPANSION	73
TANK GP-EXPANSION-COOLANT	73
TANK GP-FUEL	104
	105
TANK GP-HYDRAULIC	523
	525
TANK GP-WINDOW WASHER	902
	904
	918
	920
THUMB AR-24-IN, HYD, HEAVY-DUTY	750
THUMB AR-24-IN, HYD, HEAVY-DUTY, WITH COUPLER	751
THUMB AR-24-IN, HYD, ROCK	752
THUMB AR- 24-IN, HYD, ROCK, WITH COUPLER	753
THUMB AR-24-IN, HYD, WITH COUPLER	758
THUMB AR-24-IN, MANUAL	748
THUMB AR-24-IN, MANUAL, HEAVY-DUTY	754
THUMB AR-24-IN, MANUAL, HEAVY-DUTY, WITH COUPLER	755
THUMB AR-24-IN, MANUAL, ROCK	756
THUMB AR- 24-IN, MANUAL, ROCK, WITH COUPLER	757
THUMB AR- 24-IN, MANUAL, WITH COUPLER	748

INDEX

Name	Page	Name	Page
	769		680
THUMB AR-24-IN, ROCK, MANUAL	748		681
THUMB AR-			682
24-IN, ROCK, MANUAL, WITH COUPLER	749		683
THUMB AR-30-IN, HYD, HEAVY-DUTY	761		684
THUMB AR-30-IN, HYD, HEAVY-DUTY, WITH			685
COUPLER	762		686
THUMB AR-30-IN, HYD, ROCK	763		687
THUMB AR-			688
30-IN, HYD, ROCK, WITH COUPLER	764		689
THUMB AR-30-IN, HYD, WITH COUPLER	759		690
THUMB AR-30-IN, MANUAL, HEAVY-DUTY	770		691
THUMB AR-30-IN, MANUAL, HEAVY-DUTY,			692
WITH COUPLER	772		693
THUMB AR-30-IN, MANUAL, ROCK	771		694
THUMB AR-			695
30-IN, MANUAL, ROCK, WITH COUPLER	773		696
THUMB AR-			705
30-IN, MANUAL, WITH COUPLER	774		706
THUMB AR-36-IN, HYD, HEAVY-DUTY	765		707
THUMB AR-36-IN, HYD, HEAVY-DUTY, WITH			708
COUPLER	766		709
THUMB AR-36-IN, HYD, ROCK	767		710
THUMB AR-			711
36-IN, HYD, ROCK, WITH COUPLER	768		712
THUMB AR-36-IN, HYD, WITH COUPLER	760		713
THUMB AR-36-IN, MANUAL, HEAVY-DUTY	775		714
THUMB AR-36-IN, MANUAL, HEAVY-DUTY,			715
WITH COUPLER	777		716
THUMB AR-36-IN, MANUAL, ROCK	776	TOOTH GP-UNI	786
THUMB AR-		TRANSMISSION & MOUNTING GP-	
36-IN, MANUAL, ROCK, WITH COUPLER	778	2-WHEEL DRIVE, STANDARD SHIFT	263
THUMB AR-		TRANSMISSION & MOUNTING GP-	
36-IN, MANUAL, WITH COUPLER	779	ALL WHEEL DRIVE, AUTOSHIFT	262
THUMB AR-BACKHOE	748	TRANSMISSION & MOUNTING GP-	
THUMB AR-		ALL WHEEL DRIVE, STANDARD SHIFT	263
BACKHOE, HYDRAULIC COMMON	780	TRANSMISSION AR-DIRECT DRIVE-	
	781	2-WHEEL DRIVE, STANDARD SHIFT	264
	782	TRANSMISSION AR-DIRECT DRIVE-	
THUMB AR-BACKHOE, MANUAL COMMON	783	ALL WHEEL DRIVE, STANDARD SHIFT	263
THUMB GP-BACKHOE	784	TRANSMISSION AR-POWER SHIFT-	
THUMB GP-BACKHOE, COMMON	785	ALL WHEEL DRIVE	264
TIE ROD GP	206	TRANSMISSION GP-DIRECT DRIVE	265
	341		270
TIP GP-BUCKET (SOIL)	717		275
	718		280
	719		285
	720		290
TIP GP-CHISEL	697	TRANSMISSION GP-POWER SHIFT	296
	698		302
	699	TRANSPORT AR-MACHINE	930
	700		931
TIP GP-PENETRATION	677	TRANSPORT GP-MACHINE	932
	678	TRIM GP-CAB	898
	679	TURBOCHARGER GP	81

Thanks for your reading.

Please click here to download complete manual instantly.

And can also choose other manuals.

Feel free --->write to me with any questions.

Our service email:

manuals007@hotmail.com