

Parts Manual



See "General Information"
for New Parts Manual
Features.

416E Backhoe Loader Single Tilt

LMS1-Up (Machine)
C4Z1-Up (Engine)

Powered By C4.4 Engine
This Parts Manual is also available in .pdf Format on Compact Disc (CD -
ROM) Caterpillar Form No. SERP5900.

Product and Dealer Information

Note: For product identification plate locations, see the section "Product Identification Information" in the Operation and Maintenance Manual.

Delivery Date: _____

Product Information

Model: _____

Product Identification Number: _____

Engine Serial Number: _____

Transmission Serial Number: _____

Generator Serial Number: _____

Attachment Serial Numbers: _____

Attachment Information: _____

Customer Equipment Number: _____

Dealer Equipment Number: _____

Dealer Information

Name: _____ Branch: _____

Address: _____

Dealer Contact

Phone Number

Hours

Sales: _____

Parts: _____

Service: _____

MEMORANDA

TABLE OF CONTENTS

Name	Page	Name	Page
GENERAL INFORMATION	A4	COOLER GP-ENGINE OIL	43
REPAIR ALTERNATIVES	A7	COOLER GP-FLTR BASE & ENG OIL	44
SUPPLEMENTAL COOLANT ADDITIVES	A8	FAN GP-SUCTION	45
MAINTENANCE PARTS	A9	LINES GP-POWER TRAIN COOLER	47
INDEX	A11	LINES GP-RADIATOR	49
MACHINE ARRANGEMENT	1	PUMP GP-WATER	51
BACKHOE AR-EXTENDABLE STICK	1	RADIATOR & HYD OIL COOLER GP	53
BACKHOE AR-STANDARD STICK	1	AIR INLET AND EXHAUST SYSTEM	55
CHASSIS AR	2	AIR CLEANER GP	55
COMMON AR	2	COVER GP-INLET MANIFOLD	58
DISTRIBUTION AR	2	EXTENSION GP-EXHAUST	60
DRIVE AR-BACKHOE LOADER	4	LINES GP-AIR	61
LOADER AR	4	MUFFLER GP	62
OPTION AR-BACKHOE	5	TURBOCHARGER GP	63
OPTION AR-CAB	6	FUEL SYSTEM	65
OPTION AR-MACHINE	7	CONTROL GP-GOVERNOR	65
ENGINE ARRANGEMENT	8	FILTER & LINES GP-FUEL	67
ENGINE AR	8	LINES GP-FUEL	69
ENGINE AR-PRIMARY	9	PUMP GP-FUEL INJECTION	71
BASIC ENGINE	10	PUMP GP-FUEL PRM & PRIM FILTER	75
CAMSHAFT GP	10	TANK GP-FUEL	76
COVER GP-VALVE MECHANISM	11	ELECTRICAL AND STARTING SYSTEM	78
CRANKSHAFT GP	13	ALTERNATOR GP-CHARGING	78
CYLINDER BLOCK GP	16	BATTERY & WIRING GP	79
CYLINDER HEAD GP	19	GLOW PLUG GP	83
DRIVE GP-FAN	21	HEATER GP-JACKET WATER	84
FLYWHEEL GP	22	INSTALLATION GP-COMMUNICATION	85
HOUSING GP-FLYWHEEL	23	LAMP GP-FLOOD	87
HOUSING GP-FRONT	24	LAMP GP-WARNING BEACON	90
LIFTING GP-ENGINE	26	LIGHTING GP-FLOOD & SIGNAL	91
MOUNTING GP-ENGINE	27	LIGHTING GP-WARNING BEACON	96
MOUNTING GP-ENGINE & XMSN	28	PANEL GP-FUSE	97
PAN GP-OIL	29	RELAY GP	98
PISTON & ROD GP	31	STARTING MOTOR GP-ELECTRIC	101
PLUG GP-CYLINDER HEAD	32	SWITCH GP-ALL WHEEL DRIVE	102
PLUG GP-ENGINE	33	SWITCH GP-DIFFERENTIAL LOCK	103
PULLEY GP-CRANKSHAFT	35	SWITCH GP-DISCONNECT	104
ROCKER ARM GP	36	SWITCH GP-PRESSURE	105
VALVE MECHANISM GP	37	WIRING GP-AIR CONDITIONER	106
LUBRICATION SYSTEM	38	WIRING GP-CONSOLE	109
BREATHER GP	38	WIRING GP-ENGINE	112
FILLER GP-ENGINE OIL	39	WIRING GP-HEATER	115
GAUGE GP-OIL LEVEL & FILLER	40	WIRING GP-KICKOUT & POSITIONER	117
PUMP GP-ENGINE OIL	41	WIRING GP-PLATFORM	119
COOLING SYSTEM	42	WIRING GP-REAR	124
CONNECTION GP-WATER	42	WIRING GP-RIDE CONTROL	125
		POWER TRAIN	127
		AXLE GP-DRIVE & STEERING	127
		AXLE GP-REAR	129
		CASE AS-TRANSMISSION	132
		CASE GP-TRANSMISSION	135

TABLE OF CONTENTS

Name	Page	Name	Page
DIFFERENTIAL & BEVEL GEAR GP	138	CONTROL AR-RIDE	238
DIFFERENTIAL GP	140	CONVERSION AR-CUSHION SWING	239
DRIVE GP-FLEXIBLE COUPLING	142	CONVERSION GP-HYD HAND	
FILLER GP-POWER TRAIN OIL	143	CONTROL	241
FLANGE GP-WHEEL	146	COOLER GP-HYD & XMSN OIL	243
HOUSING & FLANGE GP-AXLE	148	CYLINDER & LINES GP-THUMB	244
HOUSING GP-AXLE	150	CYLINDER GP-BACKHOE BUCKET	246
LINES GP-POWER TRAIN OIL	154	CYLINDER GP-BOOM	248
MOUNTING GP-AXLE	155	CYLINDER GP-HYDRAULIC	250
MOUNTING GP-TRANSMISSION	156	CYLINDER GP-LIFT	252
PLANETARY GP-FINAL DRIVE	157	CYLINDER GP-MULTIPURPOSE	
POWER TRAIN AR	159	BUKT	253
SHAFT GP-DRIVE	160	CYLINDER GP-STABILIZER	254
SHAFT GP-INPUT	161	CYLINDER GP-STICK	256
SHAFT GP-OUTPUT	165	CYLINDER GP-THUMB	258
TRANSMISSION & MOUNTING GP	168	CYLINDER GP-TILT	259
TRANSMISSION AR-DIRECT DRIVE	169	DRIVE & MTG GP-PUMP	261
TRANSMISSION GP-DIRECT DRIVE	170	FASTENER GP-VALVE	262
VALVE GP-RELIEF	180	FILTER GP-OIL	263
VALVE GP-TIRE	181	FITTING GP-HYDRAULIC	264
WHEEL & TIRE AR	182	HYDRAULIC AR	265
WHEEL & TIRE GP	183	KICKOUT & POSITIONER GP	266
BRAKING SYSTEM	190	KIT-RIDE CONTROL	268
CONTROL GP-PARKING BRAKE	190	LINES GP-BACKHOE AUXILIARY	271
CONTROL GP-SERVICE BRAKE	192	LINES GP-BOOM	288
CYLINDER GP-BRAKE	195	LINES GP-BUCKET	290
LEVER GP-HAND CONTROL	197	LINES GP-DRAIN	294
RESERVOIR GP-BRAKE	198	LINES GP-EXTENDABLE STICK	295
STEERING SYSTEM	200	LINES GP-HYDRAULIC OIL COOLER	297
AXLE GP-FRONT	200	LINES GP-LIFT CYLINDER	299
KNOB GP-STEERING	202	LINES GP-LOADER AUXILIARY	301
LINES GP-STEERING	203	LINES GP-MULTIPURPOSE BUCKET	303
PUMP GP-METERING	208	LINES GP-PILOT	307
STEERING COLUMN GP	209	LINES GP-PUMP	309
FRAME AND BODY	210	LINES GP-RIDE CONTROL	311
BOX GP-BATTERY	210	LINES GP-STABILIZER	313
COUNTERWEIGHT GP	211	LINES GP-STICK	317
EXTENSION GP-FENDER	215	LINES GP-SWING	319
FENDER GP-FRONT	216	LINES GP-TILT CYLINDER	320
FENDER GP-REAR	217	MANIFOLD GP-CONTROL	322
FLOORPLATE GP	219	MANIFOLD GP-RIDE CONTROL	324
FRAME AS-SWING	221	MOUNTING GP-BANK VALVE	325
FRAME GP-LOADER	222	MOUNTING GP-CYLINDER	327
FRAME GP-SWING	223	MOUNTING GP-LINES	328
GUARD GP-CYLINDER	225	PUMP GP-PISTON	329
GUARD GP-DRIVE SHAFT	231	SHAFT GP-PUMP DRIVE	332
GUARD GP-RADIATOR	232	TANK & MTG GP-HYDRAULIC	333
HOOD & GUARD GP	233	VALVE AR-BANK 2	335
HOOD GP-ENGINE	235	VALVE AR-BANK 3	335
HYDRAULIC SYSTEM	237	VALVE AR-BANK 6	335
ACCUMULATOR GP-RIDE CONTROL	237	VALVE AR-BANK 7	336
		VALVE AR-BANK 8	336
		VALVE GP-BANK 2	337
		VALVE GP-BANK 3	338
		VALVE GP-BANK 6	339

TABLE OF CONTENTS

Name	Page	Name	Page
VALVE GP-BANK 7	341	CONTROL GP-HYDRAULIC	
VALVE GP-BANK 8	343	LOCKOUT	531
VALVE GP-CONTROL	345	CONTROL GP-HYDRAULIC PEDAL	532
VALVE GP-PUMP CONTROL	360	CONTROL GP-STEERING	536
		CONTROL GP-TRANSMISSION	538
IMPLEMENTS	361	COVER GP-WIPER MOTOR	540
ARM GP-LIFT	361	DOOR GP-CAB	541
BOOM GP	363	FLOOR MAT GP	545
BRACE GP-LIFT CYLINDER	364	HEATER GP-CAB	547
GUARD GP-BOOM	365	KIT-CAB WINDOW	553
LINKAGE GP-BACKHOE BUCKET	366	LATCH GP-CAB DOOR & WINDOW	555
LINKAGE GP-LOADER BUCKET	368	LEVER GP-GOVERNOR	557
LOCK GP-TRANSPORT	369	LINER GP-CAB	558
MOUNTING GP-STICK	372	LINES GP-HEATER	560
PAD & GUARD GP-STABILIZER	373	LINES GP-HEATER & AIR COND	561
PAD & MTG GP-STABILIZER	378	MIRROR GP-REAR VIEW	563
PAD GP-STABILIZER	381	MOTOR GP-WINDOW WIPER	565
STABILIZER GP-BACKHOE	383	MOUNTING GP-CAB	567
STICK AS	385	PEDAL GP-GOVERNOR	568
STICK GP	386	RADIO GP-COMMUNICATION	569
STICK GP-HOE	389	ROOF GP-CAB	570
		SEAT BELT GP	573
		SEAT GP	575
WORK TOOLS	391	SEAT GP-SUSPENSION	578
BUCKET AR-MULTIPURPOSE	391	SUSPENSION GP-SEAT	580
BUCKET AS-GENERAL PURPOSE	392	TACHOMETER GP-ELECTRIC	583
BUCKET AS-HOE	394	TRIM GP-CAB	584
BUCKET GP-GENERAL PURPOSE	426	WASHER GP-WINDOW	586
BUCKET GP-HOE	428	WINDOW GP-CAB	588
BUCKET GP-MULTIPURPOSE	463	WINDOW GP-DOOR	598
BULLDOZER AS	465	WIPER & WASHER GP-WINDOW	600
CLAM AS-MULTIPURPOSE BUCKET	467	WIPER GP-WINDOW	602
COUPLER AR-QUICK	468		
COUPLER GP-QUICK	469	SERVICE EQUIPMENT AND SUPPLIES	604
EDGE GP-CUTTING	478	FILM GP	604
FORK GP	479	INSTALLATION AR-WHEEL CHOCK	605
MOUNTING GP-BUCKET	480	LINK GP-SHIPPING	606
PIN GP-COUPLER	481	LOCK GP-VANDALISM	607
THUMB AR	483	PLATE & FILM GP	608
THUMB GP	489	PROTECTION GP-VANDALISM	613
TOOTH GP-UNI	491	TRANSPORT AR-MACHINE	614
OPERATOR STATION	492	PART NUMBER INDEX	B1
AIR CONDITIONER & MOUNTING GP	492		
CAB AR-ENCLOSED ROPS	495		
CAB GP	497		
CANOPY AR-OPEN ROPS	499		
CANOPY GP-OPEN ROPS	500		
COMPARTMENT GP-LITERATURE	503		
COMPRESSOR GP-REFRIGERANT	504		
CONDENSER & MTG GP-			
REFRIGERANT	506		
CONSOLE GP-OPERATOR	507		
CONTROL & MTG GP-STABILIZER	513		
CONTROL GP-HYDRAULIC HAND	515		

GENERAL INFORMATION

1. MACHINE IDENTIFICATION

Caterpillar machines are identified by Product Identification Numbers (PIN). Some components included in a machine may be identified by Serial Numbers (S/N). Typical components that will be serialized include engines, transmissions, bulldozers, and rippers. The machine and engine are further identified by arrangement numbers and in some cases modification numbers. These numbers are shown on the product identification plate(s) and on the master plate in the operator's compartment.

Caterpillar dealers need all of these numbers to determine accurate parts identification.

New Feature

Effective First Quarter 2001 the Caterpillar Product Identification Number (PIN) changed from 8 to 17 characters. In an effort to provide uniform equipment identification, Caterpillar and other construction equipment manufacturers are moving to comply with the latest version of the product identification numbering standard. Non-road machine PINs are defined by ISO 10261. The new PIN format will apply to all Caterpillar machines and generator sets. The PIN plates and frame marking will display the 17 character PIN. The new format will look like the following:

CAT 0789BG 6SL12345

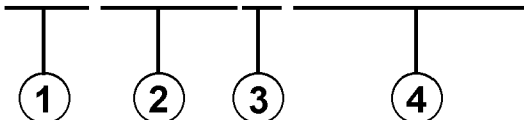

The diagram shows the PIN format: *CAT 0789BG 6SL12345*. Below the first four characters (C, A, T, 0), there are four vertical lines leading to circles containing the numbers 1, 2, 3, and 4 respectively.

Where:

1. Caterpillar's World Manufacturing Code (characters 1-3)
2. Machine Descriptor (characters 4-8)
3. Check Character (character 9)
4. Machine Indicator Section (MIS) or Product Sequence Number (characters 10-17). These were previously referred to as the Serial Number.

Machines and generator sets produced before First Quarter 2001 will maintain their 8 character PIN format.

Components such as engines, transmissions, axles, etc. and work tools will continue to use an 8 character Serial Number (S/N).

2. ORDERING PARTS

WARNING

When replacement parts are required for this product Caterpillar recommends using Caterpillar replacement parts or parts with equivalent specifications including, but not limited to, physical dimensions, type, strength and material.

Failure to heed this warning can lead to premature failures, product damage, personal injury or death.

Quality Caterpillar replacement parts are available from Caterpillar dealers throughout the world. Their parts inventories are up to date and include all parts normally required to protect your investment in Caterpillar machines. Dealers may offer repair kits or remanufactured parts to allow selection of the most effective repair alternative for a particular situation. When ordering parts, your order should specify the quantity, part number, part name, and the serial number/product identification number of the machine for which the parts are needed.

3. PARTS MANUAL ORGANIZATION

Product information in this manual is presented as "information elements" that represent all of the components for the specific model. Engine Arrangement and Seat Group are examples of information elements. The information elements are organized alphabetically by part name and secondarily by part number within each major section of the manual.

4. TABLE OF CONTENTS

A table of contents (TOC) is found at the beginning of the manual. The TOC lists each section of the manual with a complete list of all information elements organized as they appear in the manual. Page numbers are provided for quick reference to detailed parts identification illustrations and serviceable consist lists.

5. MAINTENANCE PARTS INDEX

The Maintenance Parts Index, located near the beginning of the manual, references most frequently used maintenance part numbers, providing description, quantity, usage and page number. This information is organized alphabetically by part description.

GENERAL INFORMATION

6. INDEX

The index located near the front of the manual is an alphabetical listing of all information elements included in the manual. Page numbers are provided for quick reference to detailed parts identification illustrations and serviceable consist lists.

7. PART NUMBER INDEX

A numerical index listing all part numbers and the corresponding page number(s) appears at the back of the manual.

8. CAPTIONS

Captions located at the beginning of each information element identify the part number and part name along with additional descriptive information. PIN and S/N information found in each caption should be used to select correct information for a specific machine. Field replacement options, identification of optional attachment components, and where used ("part of") information is also provided.

The first line of a caption is shown in larger type font to indicate the beginning of an information element. Captions for additional pages that may be required to illustrate an information element will be shown in standard type font and will include the term (*contd.*) .

9. NON-SERVICED PARTS

In some instances it is necessary to display non-serviced parts that are a link to a lower level serviceable consist lists. These non-serviced part numbers are shown in *italic* type indicating that they are not available.

10. PARTS LIST REFERENCE NUMBERS

Numbers shown in the Ref No column correspond to numbers used in the associated graphic(s). An alphabetic suffix may be added to a reference number to identify lower level consist items. Numbers shown in the Graphic Ref column refer to the graphic number identifier displayed in the lower left corner of each illustration. The Graphic Ref number may be used in combination with the item Ref No to determine the correct part number. There may be intentional omission of a Ref No in a consist list as information is updated to reflect the latest serviceable part numbers.

11. INDENTED PART NAMES

When a part name is indented in a parts list, it is part of (included in) the group or assembly under which it is indented.

12. ILLUSTRATION REFERENCE LETTERS

When necessary, illustrations contain reference letters (A, B, C etc.) that are intended to track lines and harnesses from one point to another. They are also used to show where to reconnect illustrations that have been separated.

13. ABBREVIATIONS AND SYMBOLS

O.D. – Outside Diameter
I.D. – Inside Diameter
A – Not Part Of This Group
B – Use As Required
C – Change From Previous Type
D – Order By The Meter
E – Order By The Centimeter
F – Not Shown
G – Order By The Inch
I – Refer To Hydraulic Information System
M – Metric Part
R – Remfg Part May Be Available
Y – Separate Illustration
Z – Not Serviced Separately

 **New Feature**

14. DESCRIPTION OF TYPE CHANGES

Type - A type is defined as any configuration change that requires an additional Information Element for an Arrangement, Group, or Assembly. If serial number breaks for types are not available, a type # (Type 1, Type 2, etc.) will be displayed in the caption. These "type" changes are identified with a "C" note (change from previous type) in the Parts List. Only the "types" that apply to this Parts Manual will be included. Additional types may exist causing "C" notes to appear on an Information Element when no other types are shown.

15.<END>

This symbol indicates the end of an information element.

NOTE:

Continuing improvement and advancement of product design may cause changes to your machine which may not be included in this publication. Whenever a question arises regarding your Caterpillar product or this publication, please consult your Caterpillar dealer for the latest available information.

GENERAL INFORMATION

FRAME AND BODY					
BE-3299 PLATFORM GP-CAB					
PIN 3841-99999					
					100090751
NOTE	REF NO	GRAPHIC REF	PART NUMBER	QTY	PART NAME & PRODUCT LEVEL
			31-2982	1	PLATE AS
			68-2092	25	BOLT (1/4-18X.750IN)
			68-1078	41	WASHER-HARD (3MM THK)
			68-1444	2	SUPPORT AS-FOOT
			77-2229	19	BOLT (1/2-13X1IN)
			77-2229	19	WASHER-HARD (4MM THK)
			68-8126	1	COVER AS-LH
			68-8278	6	NUT-WELD (3/8-16 THD)
			17-8189	1	CLIP
			78-2411	4	COVER
			64-0486	18	SCREW-HEAD (3/8-16X.875IN)
			77-0774	1	COVER
			68-0972	1	GASKET
			68-2468	1	GASKET
			68-2890	1	GASKET
			31-3492	1	HANDHOLD
			68-8278	1	COVER AS
			68-8278	8	NUT-WELD (3/8-16 THD)
			68-8278	1	GASKET
			77-0131	1	FLOORPLATE AS
			17-0742	4	NUT-WELD (1/2-13 THD)
			77-8087	1	PLUG-BUTTON
			77-0136	1	PLATE AS
			68-8278	5	NUT-WELD (3/8-16 THD)
			77-8089	1	COVER
			77-0770	1	GASKET
			31-2981	1	PLATE AS
			81-8484	4	BOLT (1/4-20X.825IN)
			81-8484	4	WASHER-HARD (2MM THK)
			61-8484	1	FLOOR MAT
			68-8484	1	MODULE AS-OPERATOR
			31-3534	1	HANDHOLD
			68-8271	2	PLUG
			81-8384	4	BOLT (1/4-20X.825IN)
			81-8384	4	WASHER-HARD (2MM THK)
			68-8282	17	BOLT (3/8-16X.750IN)
			68-1078	21	WASHER-HARD (3MM THK)
			77-0136	1	SEAL
			78-0278	2	BOLT (3/4-10X5IN)
			78-0282	2	WASHER-HARD (3MM THK)
			31-3482	2	PLATE
			31-6380	1	PLATE AS
			78-0282	8	SPACER
			31-5281	1	SEAL
			78-8817	1	GASKET
			78-8816	1	COVER AS
			28-8278	2	WASHER
			68-8228	2	SCREW-KNURLED
			68-3428	1	COVER
			68-8887	1	COVER
			68-2021	8	SCREW-ROCKET HEAD
			68-3142	8	MOUNTING
			68-0287	2	PLATE
			78-0289	2	BOLT (1/2-8X5IN)
			78-0272	2	WASHER-HARD
			41-6484	4	BOLT (3/8-18X1.02IN)
			31-6783	1	COVER

FRAME AND BODY					
BE-3299 PLATFORM GP-CAB (contd.)					
					100090751
NOTE	REF NO	GRAPHIC REF	PART NUMBER	QTY	PART NAME & PRODUCT LEVEL
	41	2	68-8816	1	COVER
	42	2	77-8124	1	PLATE
	43	2	77-8128	1	GASKET
	44	2	78-8724	1	GASKET
	45	2	78-8728	1	COVER
	48	2	68-1069	2	PLUG-BUTTON

M-METRIC PART

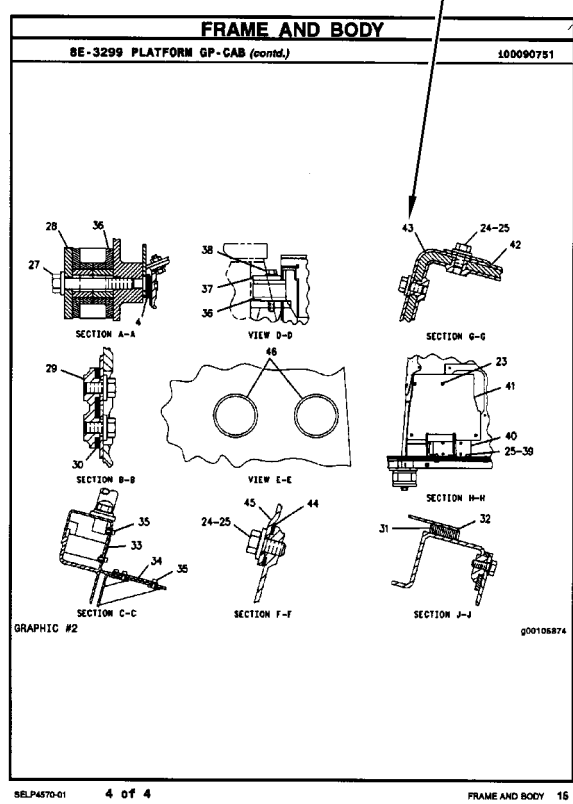
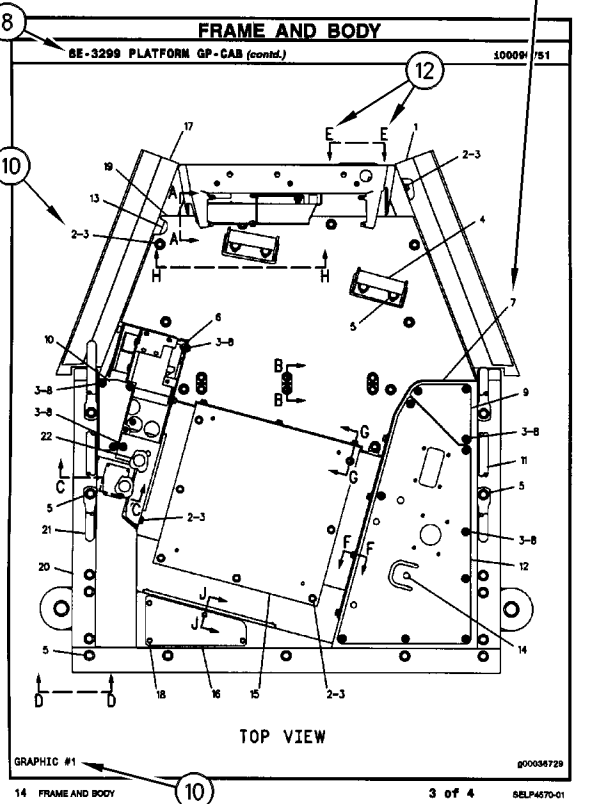

REPAIR ALTERNATIVES

REMANUFACTURED COMPONENTS

As an option when making repairs consider Caterpillar Remanufactured Components. Components that are available through the Caterpillar Remanufactured Program are identified three ways in the parts book:

- with the letter R in the note field of the parts list
- with an R* at the beginning of the first line of the caption
- with an *R at the end of the first line of the caption

Typical components included in the Remanufacturing Program include:

ALTERNATORS
CONNECTING RODS
CRANKSHAFTS - UNDERSIZE
CRANKSHAFTS - UPGRADE TO NEW
CYLINDER HEADS
ELECTRONIC CONTROL MODULES (ECM)
ELECTRONIC SENSORS
FUEL INJECTORS
FUEL NOZZLES
FUEL PUMPS
GOVERNORS
OIL PUMPS
PISTONS
SHORT BLOCKS
STARTERS
TURBOCHARGERS - COMPLETE
TURBOCHARGER CARTRIDGES
WATER PUMPS

Caterpillar Remanufactured engines for many engine arrangements are also available.

SUPPLEMENTAL COOLANT ADDITIVES

CUSTOMER BENEFITS:

Protects against cavitation, foam, erosion, corrosion, and scale buildup in cooling systems.

- Provides measured coolant conditioner.

DESCRIPTION:

Additives deplete from the coolant with normal operation. For this reason, Supplemental Coolant Additives (SCA) must be added to all heavy duty coolants at regular intervals. In addition, when not using a fully formulated, pre-charged antifreeze, like Caterpillar's DEAC, an initial charge of SCA must be added to the cooling system. The amount of SCA added to the system is dependent on the capacity of the system.

The SCA for initial fill is provided as a liquid. SCA's for maintenance intervals are available in liquid form and as a spin-on element. (No Spin-on available for 3600 Family of Engines)

NOTE:

The amount of SCA added at initial fill is not the same as the amount added at maintenance intervals.

The coolant additive elements can be used with any ethylene or propylene glycol type antifreeze which meets ASTM D4985 or ASTM D5345 Specifications.

NOTE:

For use with standard heavy duty coolant only, not for use with Extended Life Coolant.

PARTS NEEDED:

Cooling System Capacity		Liquid SCA at Initial Fill	Liquid SCA at Maintenance*	Spin-on SCA Maintenance Element*
Liters	Gallons			
22-30	(6-8)	3P-2044 (1)	6V-3542 (1)	111-2370 (1)
30-38	(8-10)	3P-2044 (1) 6V-3542 (1)	111-2372 (1)	111-2369 (1)
38-49	(10-13)	3P-2044 (1) 8T-1589 (1)	111-2372 (1)	111-2369 (1)
49-64	(13-17)	3P-2044 (2)	8T-1589 (1)	9N-3368 (1)
64-83	(17-22)	3P-2044 (2) 8T-1589 (1)	111-2372 (1) 6V-3542 (1)	111-2371 (1)
83-114	(22-30)	3P-2044 (3) 8T-1589 (1)	3P-2044 (1)	9N-3718 (1)
114-163	(30-43)	3P-2044 (5)	3P-2044 (1) 6V-3542 (1)	111-2371 (2)
163-242	(43-64)	3P-2044 (8)	3P-2044 (2)	9N-3718 (2)

* Normal maintenance period is 250 hrs. See your Operation and Maintenance Manual for complete coolant maintenance instructions.

() Indicates quantity required.

MAINTENANCE PARTS

DESCRIPTION	PART NUMBER	QTY	WHERE USED	PAGE
AIR INLET AND EXHAUST SYSTEM				
FILTER ELEMENT-AIR (PRIMARY)	293 - 4053	1	AIR CLEANER GP	55
FILTER ELEMENT-AIR (SECONDARY)	227 - 7449	1	AIR CLEANER GP	55
BASIC ENGINE				
GASKET (VALVE COVER)	225 - 6451	1	COVER GP-VALVE MECHANISM	11
PLUG-DRAIN (ENGINE OIL)	7C - 0351	2	PAN GP-OIL	29
COOLING SYSTEM				
BELT-SERPENTINE (FAN)	212 - 9353	1	FAN GP-SUCTION	45
	324 - 3408	1	FAN GP-SUCTION	46
CAP AS-COOLANT TANK	251 - 3227	1	LINES GP-RADIATOR	49
HOSE-RADIATOR (UPPER)	325 - 5855	1	LINES GP-RADIATOR	49
REGULATOR GP-TEMPERATURE (INCLUDES CONNECTOR) (WATER)	254 - 2267	1	CONNECTION GP-WATER	42
ELECTRICAL AND STARTING SYSTEM				
BATTERY (12-VOLT, MAINTENANCE FREE)	230 - 6368	1	BATTERY & WIRING GP	79
		1	BATTERY & WIRING GP	81
BELT-DRIVE	9X - 8139	1	LAMP GP-WARNING BEACON	90
FLASHER AS (12-VOLT) (HAZARD)	7T - 4848	1	WIRING GP-PLATFORM	119
FUSE (10-AMPERE)	113 - 8490	11	PANEL GP-FUSE	97
	3K - 8782	1	LAMP GP-WARNING BEACON	90
FUSE (15-AMPERE)	113 - 8491	13	PANEL GP-FUSE	97
FUSE (20-AMPERE)	113 - 8492	10	PANEL GP-FUSE	97
FUSE (40-AMPERE)	278 - 6377	1	RELAY GP	98
FUSE (40-AMPERE) (POWER, 2)	278 - 6377	1	RELAY GP	100
FUSE (60-AMPERE)	267 - 2701	2	RELAY GP	99
		1	WIRING GP-PLATFORM	119
FUSE (60-AMPERE) (POWER, 1)	267 - 2701	1	RELAY GP	100
GLOW PLUG (12-VOLT)	232 - 6662	4	GLOW PLUG GP	83
KEY (BATTERY DISCONNECT)	8H - 5306	1	SWITCH GP-DISCONNECT	104
LAMP (12-VOLT) (COOLANT TEMPERATURE)	7X - 9065	1	WIRING GP-CONSOLE	109
LAMP (12-VOLT) (FUEL LEVEL INDICATOR)	7X - 9065	1	WIRING GP-CONSOLE	109
LAMP (12-VOLT) (OIL TEMPERATURE)	7X - 9065	1	WIRING GP-CONSOLE	109
LAMP (12-VOLT, 21-WATT)	3C - 4883	1	LIGHTING GP-FLOOD & SIGNAL	91
		1	LIGHTING GP-FLOOD & SIGNAL	93
	9W - 3326	1	LIGHTING GP-FLOOD & SIGNAL	91
		1	LIGHTING GP-FLOOD & SIGNAL	93
LAMP (12-VOLT, 5-WATT)	084 - 4348	1	LIGHTING GP-FLOOD & SIGNAL	91
		1	LIGHTING GP-FLOOD & SIGNAL	93
LAMP (12-VOLT, 55-WATT)	9W - 0607	1	LAMP GP-FLOOD	87
		1	LAMP GP-FLOOD	88
		1	LAMP GP-FLOOD	89
	9X - 8118	1	LAMP GP-WARNING BEACON	90
LAMP GP (12-VOLT) (FAULT INDICATOR)	270 - 2728	1	WIRING GP-CONSOLE	109
LAMP GP-WARNING BEACON (MAGNETIC MOUNT)	185 - 7016	1	LAMP GP-WARNING BEACON	90

MAINTENANCE PARTS

DESCRIPTION	PART NUMBER	QTY	WHERE USED	PAGE
FUEL SYSTEM				
CAP-FUEL	284-9039	1	TANK GP-FUEL	77
FILTER AS-WATER SEP & FUEL	228-9130	1	PUMP GP-FUEL PRM & PRIM FILTER	75
FILTER ELEMENT-FUEL (WATER SEPARATOR)	156-1200	1	FILTER & LINES GP-FUEL	67
STRAINER-FUEL (FILLER NECK SCREEN)	180-3730	1	TANK GP-FUEL	77
HYDRAULIC SYSTEM				
CAP-FILL (HYDRAULIC OIL)	237-3797	1	TANK & MTG GP-HYDRAULIC	333
FILTER ELEMENT-BREATHER (HYDRAULIC TANK)	9R-9925	1	TANK & MTG GP-HYDRAULIC	333
FILTER-OIL (ULTRA HIGH EFFICIENCY)	126-1817	1	FILTER GP-OIL	263
LUBRICATION SYSTEM				
FILTER AS-ENGINE OIL	7W-2326	1	GAUGE GP-OIL LEVEL & FILLER	40
OPERATOR STATION				
BLADE AS-WIPER (500-MM) (REAR)	5C-8811	1	WIPER GP-WINDOW	602
BLADE AS-WIPER (600-MM) (FRONT)	101-0745	1	WIPER & WASHER GP-WINDOW	600
		1	WIPER GP-WINDOW	602
FILTER ELEMENT AS-AIR (CAB HEATER)	211-2661	1	AIR CONDITIONER & MOUNTING GP	492
		1	HEATER GP-CAB	547
FILTER ELEMENT-AIR (CAB HEATER, AIR CONDITIONER)	211-2660	1	HEATER GP-CAB	551
FILTER ELEMENT-AIR (RECIRCULATION)	211-2660	1	HEATER GP-CAB	549
LAMP (12-VOLT)	122-7137	1	TACHOMETER GP-ELECTRIC	583
	210-8754	1	LINER GP-CAB	558
RECEIVER-REFRIGERANT DRYER (AIR CONDITIONER)	283-4237	1	LINES GP-HEATER & AIR COND	561
SEAT BELT (2-IN)	206-1749	1	SEAT BELT GP	573
SEAT BELT (3-IN)	206-1750	1	SEAT BELT GP	574
POWER TRAIN				
BREATHER	7T-3251	1	TRANSMISSION GP-DIRECT DRIVE	170
BREATHER (AXLE, REAR)	197-9155	1	AXLE GP-REAR	129
BREATHER (FRONT AXLE)	253-5024	1	AXLE GP-DRIVE & STEERING	127
BREATHER (TRANSMISSION)	7T-3251	1	TRANSMISSION GP-DIRECT DRIVE	175
BREATHER AS (SIDE)	293-2147	1	TRANSMISSION GP-DIRECT DRIVE	176
FILTER-OIL (STANDARD EFFICIENCY)	119-4740	1	POWER TRAIN AR	159
PLUG AS-DRAIN (MAGNETIC) (AXLE)	152-6144	4	AXLE GP-DRIVE & STEERING	127
		1	DIFFERENTIAL & BEVEL GEAR GP	138
PLUG AS-DRAIN (MAGNETIC) (AXLE, REAR)	152-6144	4	AXLE GP-REAR	129
STRAINER (SUCTION)	7T-2651	1	CASE GP-TRANSMISSION	135
STRAINER (SUCTION) (TRANSMISSION)	7T-2651	1	CASE AS-TRANSMISSION	134

INDEX

Name	Page	Name	Page
A			
ACCUMULATOR GP-RIDE CONTROL- CHARGED	237		401
ACCUMULATOR GP-RIDE CONTROL- UNCHARGED	238	BUCKET AS-HOE-HEAVY-DUTY, PIN-LOCK	410
ACCUMULATOR-REFRIGERANT (AIR CONDITIONER)	561		411
AFTERCOOLER GP-AIR	53		412
AIR CLEANER GP	56		413
AIR CLEANER GP-BASIC	55		414
AIR COMPRESSOR GP (SUSPENSION SEAT)	580	BUCKET AS-HOE- HIGH CAPACITY, PIN-LOCK	415
AIR CONDITIONER & MOUNTING GP	492		416
ALTERNATOR GP-CHARGING	78		417
ARM GP-LIFT	361		418
AXLE GP-DRIVE & STEERING-FRONT	127		419
AXLE GP-FRONT	200		420
AXLE GP-REAR	129		421
B			422
BACKHOE AR-EXTENDABLE STICK	1		423
BACKHOE AR-STANDARD STICK	1		424
BATTERY & WIRING GP-DISCONNECT	81	BUCKET AS-HOE-ROCK	405
BATTERY & WIRING GP-HEAVY-DUTY	79		406
BATTERY (12-VOLT, MAINTENANCE FREE)	79		407
	81	BUCKET GP-GENERAL PURPOSE	426
BELT-DRIVE	90		427
BELT-SERPENTINE (FAN)	45	BUCKET GP-HOE	428
	46		429
BLADE AS-WIPER (500-MM) (REAR)	602		430
BLADE AS-WIPER (600-MM) (FRONT)	600		431
	602		432
BLOWER GP-CAB (HEATER)	549	BUCKET GP-HOE-HEAVY-DUTY	433
	551		434
BOOM GP	363		435
BOX GP-BATTERY-WITH STORAGE	210		436
BRACE GP-LIFT CYLINDER	364		437
BREATHER	170		438
BREATHER (AXLE, REAR)	129	BUCKET GP-HOE-HEAVY-DUTY, PIN-LOCK	447
BREATHER (FRONT AXLE)	127		448
BREATHER (TRANSMISSION)	175		449
BREATHER AS (SIDE)	176		450
BREATHER GP-CRANKCASE	38		451
BUCKET AR-MULTIPURPOSE	391	BUCKET GP-HOE- HIGH CAPACITY, PIN-LOCK	453
BUCKET AS-GENERAL PURPOSE	392		454
	393		455
BUCKET AS-HOE	394		456
	395		457
	396		458
	397		459
	398		
BUCKET AS-HOE-HEAVY-DUTY	399		
	400		

INDEX

Name	Page	Name	Page
	460	CONTROL GP-HYDRAULIC HAND-	
	461	KIT, BACKHOE	525
	462	CONTROL GP-HYDRAULIC HAND-LOADER . . .	515
BUCKET GP-HOE-ROCK	439		517
	440	CONTROL GP-HYDRAULIC HAND-	
	441	STABILIZER	524
	442	CONTROL GP-HYDRAULIC HAND-	
	443	STANDARD	520
	446	CONTROL GP-HYDRAULIC LOCKOUT	531
BUCKET GP-MULTIPURPOSE	463	CONTROL GP-HYDRAULIC PEDAL-	
	464	AUXILIARY	534
BULLDOZER AS	465	CONTROL GP-HYDRAULIC PEDAL-	
	466	EXTENDABLE STICK, AUXILIARY	535
		CONTROL GP-HYDRAULIC PEDAL-	
		SINGLE FUNCTION, LH	532
		CONTROL GP-HYDRAULIC PEDAL-	
		SINGLE FUNCTION, RH	533
		CONTROL GP-PARKING BRAKE	190
			191
		CONTROL GP-SERVICE BRAKE	192
		CONTROL GP-STEERING	536
		CONTROL GP-STEERING-TILT	537
		CONTROL GP-TRANSMISSION	538
		CONTROL GP-TRANSMISSION	
		(FORWARD, NEUTRAL, REVERSE)	538
		CONVERSION AR-CUSHION SWING-KIT	239
		CONVERSION GP-HYD HAND CONTROL-	
		KIT, 4-FUNCTION, EXCAVATOR	241
		COOLER GP-ENGINE OIL	43
		COOLER GP-FLTR BASE & ENG OIL	44
		COOLER GP-HYD & XMSN OIL	243
		CORE AS-CONDENSER	506
		CORE AS-OIL COOLER (11 PLATE)	243
		CORE AS-OIL COOLER (HYDRAULIC)	
		(18 PLATE)	243
		COUNTERWEIGHT GP	211
			212
			213
			214
		COUPLER AR-QUICK-PIN-LOCK	468
		COUPLER GP-QUICK-BACKHOE	469
			470
			471
			472
			477
		COUPLER GP-QUICK-CAT, CASE	474
		COUPLER GP-QUICK-CAT, DEERE	475
		COUPLER GP-QUICK-PIN-LOCK	473
		COVER GP-INLET MANIFOLD	58
		COVER GP-VALVE MECHANISM	11
		COVER GP-WIPER MOTOR	540
		CRANKSHAFT GP	13
			15
		CYLINDER & LINES GP-THUMB	244
		CYLINDER BLOCK GP	16

C

CAB AR-ENCLOSED ROPS-	
DOUBLE DOOR, WITH A/C	496
CAB AR-ENCLOSED ROPS-	
DOUBLE DOOR, WITHOUT A/C	495
CAB GP-DELUXE	497
CAMSHAFT GP	10
CANOPY AR-OPEN ROPS-	
WITH FRONT WINDOW	499
CANOPY GP-OPEN ROPS	500
	502
CANOPY GP-OPEN ROPS-	
WITHOUT FRONT WINDOW	501
CAP AS-COOLANT TANK	49
CAP-FILL (HYDRAULIC OIL)	333
CAP-FUEL	77
CASE AS-TRANSMISSION-FRONT	134
CASE AS-TRANSMISSION-REAR	132
CASE GP-TRANSMISSION-FRONT	135
CASE GP-TRANSMISSION-REAR	136
CHASSIS AR	2
CHOCK GP-WHEEL	605
CLAM AS-MULTIPURPOSE BUCKET	467
COMMON AR	2
COMPARTMENT GP-LITERATURE-	
STORAGE BOX	503
COMPRESSOR GP-REFRIGERANT	504
	505
CONDENSER & MTG GP-REFRIGERANT	506
CONNECTION GP-WATER	42
CONSOLE GP-OPERATOR-FRONT	511
CONSOLE GP-OPERATOR-LH	509
CONSOLE GP-OPERATOR-RH	507
CONTROL & MTG GP-STABILIZER	513
CONTROL AR-RIDE	238
CONTROL GP-GOVERNOR	65
CONTROL GP-HYDRAULIC HAND	527
	529
CONTROL GP-HYDRAULIC HAND-	
4-FUNCTION, EXCAVATOR	522

INDEX

Name	Page	Name	Page
	17	FILLER GP-POWER TRAIN OIL-	
CYLINDER GP-BACKHOE BUCKET	246	ALL WHEEL DRIVE, STANDARD SHIFT	143
CYLINDER GP-BOOM	248	FILM (TEMPERATURE CONTROL)	492
CYLINDER GP-BRAKE-LH	195		547
CYLINDER GP-BRAKE-RH	196	FILM GP	604
CYLINDER GP-HYDRAULIC-RH	250	FILM-CERTIFICATION (OPS, READ OMM)	501
CYLINDER GP-LIFT	252		502
CYLINDER GP-MULTIPURPOSE BUKT	253	FILM-IDENTIFICATION (CAT)	236
CYLINDER GP-STABILIZER-LH	254	FILM-IDENTIFICATION (CATERPILLAR)	500
CYLINDER GP-STABILIZER-RH	255	FILM-IDENTIFICATION	
CYLINDER GP-STEERING	127	(CATERPILLAR, FRONT)	495
	200		496
CYLINDER GP-STICK	256		499
CYLINDER GP-STICK-EXTENDABLE	257	FILM-IDENTIFICATION (FUSE, RELAY)	121
CYLINDER GP-THUMB	258	FILM-IDENTIFICATION	
CYLINDER GP-TILT	259	(GROUP NO., SEQUENCE NO.)	549
CYLINDER HEAD GP	19		551
	20	FILM-IDENTIFICATION (HYDRAULIC OIL)	192
		FILM-IDENTIFICATION	
		(STABILIZER CONTROL)	495
			496
			499
			500
		FILM-IDENTIFICATION	
		(START SWITCH, READ OMM)	609
			611
		FILM-INSTRUCTION (AUXILIARY)	532
			533
			534
			535
		FILM-INSTRUCTION (BACKHOE)	520
			525
			527
		FILM-INSTRUCTION (BUCKET CONTROL)	335
		FILM-INSTRUCTION	
		(EXCAVATOR CONTROL)	241
			522
			529
		FILM-INSTRUCTION	
		(EXTENDABLE STICK PIN, READ OMM)	1
		FILM-INSTRUCTION (EXTENDABLE STICK)	533
			535
		FILM-INSTRUCTION (LINK)	366
		FILM-INSTRUCTION (OIL FLOW DIRECTION)	271
			273
		FILM-INSTRUCTION (PRESSURE WASHER)	193
		FILM-INSTRUCTION (UNLOCK)	235
		FILM-INSTRUCTION (WASHER FILL)	586
			600
		FILM-WARNING	
		(ACCUM, HIGH PRESS, READ OMM)	237
		FILM-WARNING (ARM BRACE, READ OMM)	612
		FILM-WARNING	
		(CRUSH HAZARD, STAY BACK, INTL)	612

D

E

F

INDEX

Name	Page	Name	Page
FILM-WARNING (HIGH PRESSURE, READ OMM)	237	FLYWHEEL GP	22
FILM-WARNING (HIGH PRESSURE, READ OMM, INTL)	268 311	FORK GP	479
FILM-WARNING (HYD PRESS, READ OMM, INTL)	271 275 278	FRAME AS-SWING	221
FILM-WARNING (HYD PRESS, READ OMM, U.S.)	271 273 275 278 281 285	FRAME GP-LOADER-SINGLE TILT	222
FILM-WARNING (NO WELD, NO DRILL, READ OMM)	501 502 610 611	FRAME GP-SWING	223
FILM-WARNING (PRODUCT LINK 300, U.S.)	85	FUSE (10-AMPERE)	90 97
FILM-WARNING (READ OMM)	612	FUSE (15-AMPERE)	97
FILM-WARNING (SEAT BELT)	612	FUSE (20-AMPERE)	97
FILTER & LINES GP-FUEL	67	FUSE (40-AMPERE)	98
FILTER AS-ENGINE OIL	40	FUSE (40-AMPERE) (POWER, 2)	100
FILTER AS-WATER SEP & FUEL	75	FUSE (60-AMPERE)	99 119
FILTER BASE & ENG OIL COOLER	44	FUSE (60-AMPERE) (POWER, 1)	100
FILTER ELEMENT AS-AIR (CAB HEATER)	492 547	G	
FILTER ELEMENT-AIR (CAB HEATER, AIR CONDITIONER)	551	GASKET (VALVE COVER)	11
FILTER ELEMENT-AIR (PRIMARY)	55	GAUGE GP-COOLANT TEMPERATURE (ENGINE)	109
FILTER ELEMENT-AIR (RECIRCULATION)	549	GAUGE GP-FUEL LEVEL	109
FILTER ELEMENT-AIR (SECONDARY)	55	GAUGE GP-OIL LEVEL & FILLER	40
FILTER ELEMENT-BREATHING (HYDRAULIC TANK)	333	GAUGE GP-OIL TEMPERATURE (TORQUE CONVERTER)	109
FILTER ELEMENT-FUEL (WATER SEPARATOR)	67	GAUGE-OIL LEVEL (DIPSTICK)	144
FILTER GP-FUEL	67	GAUGE-OIL LEVEL (DIPSTICK) (ENGINE)	40 143
FILTER GP-OIL-HYDRAULIC	263	GAUGE-SIGHT (FLUID LEVEL)	333
FILTER-OIL (STANDARD EFFICIENCY)	159	GEAR GP-RING	148 149
FILTER-OIL (ULTRA HIGH EFFICIENCY)	263	GEAR GP-RING (REAR AXLE)	129
FINAL DRIVE GP	158	GLOW PLUG (12-VOLT)	83
FITTING GP-HYDRAULIC- QUICK DISCONNECT	264	GLOW PLUG GP	83
FLANGE GP-WHEEL	146 147	GUARD GP-BOOM	365
FLASHER AS (12-VOLT) (HAZARD)	119	GUARD GP-CYLINDER-STABILIZER	225 227 229
FLOOR MAT	545 546	GUARD GP-DRIVE SHAFT	231
FLOOR MAT GP	545 546	GUARD GP-RADIATOR	232
FLOORPLATE GP	219 220	H	
		HARNES AS-CONSOLE	109
		HARNES AS-ENGINE	112
		HARNES AS-FUEL TANK (FUEL SHUTOFF)	112
		HARNES AS-HEATER	551
		HARNES AS-HEATER & AIR COND	115 549
		HARNES AS-HEATER & AIR COND (COMPRESSOR)	106
		HARNES AS-HEATER & AIR COND (PLATFORM)	106
		HARNES AS-HEATER & AIR COND (POWER)	106
		HARNES AS-LIGHTING (ROOF)	91

INDEX

Name	Page	Name	Page
	93		
HARNES AS-PLATFORM	119		
HARNES AS-POWER (DISTRIBUTION)	119		
HARNES AS-RADIO (PRODUCT LINK)	85		
HARNES AS-REAR (BACKUP ALARM)	124		
HARNES AS-RIDE CONTROL	125		
	580		
HARNES AS-RIDE CONTROL (FRONT CONSOLE)	268		
HARNES AS-RIDE CONTROL (PLATFORM) ...	268		
HARNES AS-WIRING	117		
HARNES AS-WIRING (DIFFERENTIAL LOCK)	103		
HARNES AS-WIRING (KICKOUT, POSITIONER)	117		
HEATER GP-CAB	547		
	549		
	551		
HEATER GP-JACKET WATER	84		
HEATER GP-JACKET WATER-120-VOLT	84		
HOOD & GUARD GP	233		
HOOD GP-ENGINE	235		
	236		
HOSE GP-RADIATOR	49		
HOSE-RADIATOR (UPPER)	49		
HOUSING & FLANGE GP-AXLE-LH	149		
HOUSING & FLANGE GP-AXLE-RH	148		
HOUSING GP-AXLE-LH	151		
HOUSING GP-AXLE-REAR	152		
HOUSING GP-AXLE-RH	150		
HOUSING GP-FLYWHEEL	23		
HOUSING GP-FRONT	24		
HYDRAULIC AR	265		
I			
INDICATOR AS (BRAKE RESERVOIR)	198		
INDICATOR AS (LH TURN SIGNAL, PARKING BRAKE)	119		
INDICATOR AS (RH TURN SIGNAL, HIGH BEAM)	119		
INDICATOR GP-AIR FILTER CHANGE	56		
INSTALLATION AR-WHEEL CHOCK	605		
INSTALLATION GP-COMMUNICATION- PRODUCT LINK 121SR	85		
K			
KEY (BATTERY DISCONNECT)	104		
KICKOUT & POSITIONER GP	266		
KIT-CAB WINDOW-REAR	553		
KIT-HUB	147		
KIT-RIDE CONTROL	268		
KNOB GP-STEERING	202		
		L	
		LAMP (12-VOLT)	558
			583
		LAMP (12-VOLT) (COOLANT TEMPERATURE)	109
		LAMP (12-VOLT) (FUEL LEVEL INDICATOR) ...	109
		LAMP (12-VOLT) (OIL TEMPERATURE)	109
		LAMP (12-VOLT, 21-WATT)	91
			93
		LAMP (12-VOLT, 5-WATT)	91
			93
		LAMP (12-VOLT, 55-WATT)	87
			88
			89
			90
		LAMP GP (12-VOLT) (FAULT INDICATOR)	109
		LAMP GP-DOME (12-VOLT)	558
		LAMP GP-FLOOD	87
			88
			89
		LAMP GP-HEAD & SIGNAL (DIRECTIONAL) ...	91
			93
		LAMP GP-SIGNAL (STOP, TAIL, TURN)	91
			93
		LAMP GP-WARNING BEACON (MAGNETIC MOUNT)	90
		LAMP GP-WARNING BEACON- AMBER, MAGNETIC MOUNT, ROTATING ...	90
		LATCH GP-CAB DOOR & WINDOW	555
			556
		LEVER GP-CONTROL VALVE (STABILIZER) ...	358
		LEVER GP-GOVERNOR-HANDHELD	557
		LEVER GP-HAND CONTROL	197
		LIFTING GP-ENGINE	26
		LIGHTING GP-FLOOD & SIGNAL-NACD	91
		LIGHTING GP-FLOOD & SIGNAL- NACD, OPTIONAL	93
		LIGHTING GP-WARNING BEACON- AMBER, MAGNETIC MOUNT, ROTATING ...	96
		LINER GP-CAB	558
		LINES GP-AIR	61
		LINES GP-BACKHOE AUXILIARY	271
		LINES GP-BACKHOE AUXILIARY- EXTENDABLE STICK, 1-WAY	278
		LINES GP-BACKHOE AUXILIARY-KIT	273
			281
		LINES GP-BACKHOE AUXILIARY- KIT, EXTENDABLE STICK	285
		LINES GP-BACKHOE AUXILIARY- STANDARD STICK, 1-WAY	275
		LINES GP-BOOM	288
		LINES GP-BUCKET	1
		LINES GP-BUCKET-EXTENDABLE STICK ...	292
		LINES GP-BUCKET-STANDARD STICK	290

Thanks for your reading.

Please click here to download complete manual instantly.

And can also choose other manuals.

Feel free --->write to me with any questions.

Our service email:

manuals007@hotmail.com