



Parts Manual

236D Skid Steer Loader

MPW1-Up (Machine)
SEN1-Up (Machine)

Product and Dealer Information

Note: For product identification plate locations, see the section “Product Identification Information” in the Operation and Maintenance Manual.

Delivery Date: _____

Product Information

Model: _____

Product Identification Number: _____

Engine Serial Number: _____

Transmission Serial Number: _____

Generator Serial Number: _____

Attachment Serial Numbers: _____

Attachment Information: _____

Customer Equipment Number: _____

Dealer Equipment Number: _____

Dealer Information

Name: _____ Branch: _____

Address: _____

	<u>Dealer Contact</u>	<u>Phone Number</u>	<u>Hours</u>
Sales:	_____	_____	_____
Parts:	_____	_____	_____
Service:	_____	_____	_____

MEMORANDA

TABLE OF CONTENTS

NAME	PAGE	NAME	PAGE
GENERAL INFORMATION	A4	LINES GP-AIR.....	52
REPAIR ALTERNATIVES	A7	LINES GP-COOLING.....	54
SUPPLEMENTAL COOLANT		MANIFOLD GP-EXHAUST	55
ADDITIVES	A8	MANIFOLD GP-INLET.....	56
MAINTENANCE PARTS	A9	MUFFLER & MOUNTING GP.....	58
INDEX	A12	MUFFLER AS	59
MACHINE ARRANGEMENT	1	PRECLEANER GP.....	60
CHASSIS AR.....	1	TURBOCHARGER GP	62
COMMON AR	1	FUEL SYSTEM	65
CONFIGURATION AR.....	2	CONTROL GP-GOVERNOR	65
CONVERSION AR-MACHINE	3	FILTER GP-FUEL.....	67
ENGINE ARRANGEMENT	4	GOVERNOR GP.....	68
ENGINE AR-COMplete	4	HOUSING GP-FUEL PUMP.....	70
ENGINE AR-PRIMARY	5	LINES GP-FUEL.....	71
INSTALLATION AR-ENGINE	6	LINES GP-FUEL INJECTION	74
BASIC ENGINE	8	NOZZLE GP-UNIT INJECTOR	75
CAMSHAFT GP	8	PUMP AS-FUEL INJECTION.....	76
COVER GP-VALVE MECHANISM.....	9	PUMP GP-FUEL INJECTION	77
CRANKSHAFT GP.....	13	PUMP GP-FUEL TRANSFER	83
CYLINDER BLOCK AS.....	15	TANK & MTG GP-FUEL.....	84
CYLINDER BLOCK GP.....	16	TANK GP-FUEL	85
CYLINDER HEAD AS.....	17	ELECTRICAL AND STARTING	
CYLINDER HEAD GP.....	21	SYSTEM	86
DRAIN GP-ENGINE OIL.....	23	ALTERNATOR GP-CHARGING.....	86
FLYWHEEL GP.....	24	BATTERY & WIRING GP	87
GUARD GP-BELT.....	25	CAMERA GP.....	89
HOUSING GP-FRONT.....	26	CONVERSION GP-MACHINE	90
LIFTING GP-ENGINE.....	28	COVER GP-FUSE PANEL.....	91
MOUNTING GP-ENGINE	29	ELECTRONICS GP-MACHINE	92
PAN GP-OIL	30	ELECTRONICS GP-MONITOR	92
PISTON & ROD GP	31	GLOW PLUG GP.....	93
PULLEY GP.....	33	HARNESS AS-CAB	94
VALVE MECHANISM GP.....	34	HARNESS AS-CHASSIS.....	98
LUBRICATION SYSTEM	36	HARNESS AS-ENGINE.....	99
FILLER GP-ENGINE OIL	36	HARNESS AS-FRONT	100
GAUGE GP-OIL LEVEL (DIPSTICK).....	37	HARNESS AS-HEATER & AIR	
LINES GP-ENGINE OIL	38	COND	100
COOLING SYSTEM	39	HARNESS AS-LIGHTING.....	102
LINES GP-OIL COOLER	39	HARNESS AS-PANEL.....	103
LINES GP-WATER.....	41	HARNESS AS-PLATFORM	104
PUMP GP-WATER.....	43	HARNESS AS-QUICK COUPLER	106
RADIATOR & HYD OIL COOLER GP.....	44	HARNESS AS-RADIO.....	107
AIR INLET AND EXHAUST SYSTEM	46	HARNESS AS-REAR LIGHTING	107
AIR CLEANER GP.....	46	HARNESS AS-RIDE CONTROL.....	107
COOLER GP-EXHAUST.....	49	HARNESS AS-SENSOR.....	108
EXTENSION GP-EXHAUST.....	51	HARNESS AS-SOLENOID	108
		HARNESS AS-WIRING.....	109
		HARNESS AS-WORK TOOL.....	109
		HEATER GP-JACKET WATER.....	110
		INSTALLATION GP-	
		COMMUNICATION	111
		KIT-CAMERA	112
		KIT-WORK TOOL WIRING.....	113
		LAMP GP-FLOOD	115

TABLE OF CONTENTS

NAME	PAGE	NAME	PAGE
LAMP GP-HEAD & SIGNAL	117	CONTROL AR-HYDRAULIC.....	207
LAMP GP-ROADING	119	CYLINDER & MTG GP-ANGLE	
LAMP GP-STOP & TAIL	121	BLADE.....	208
LAMP GP-WARNING BEACON	122	CYLINDER & MTG GP-LIFT ARM	210
LIGHTING GP-FLOOD.....	123	CYLINDER GP-BUCKET.....	211
LIGHTING GP-ROADING	124	CYLINDER GP-GRAPPLE	212
LIGHTING GP-STOP & TAIL	126	CYLINDER GP-HYDRAULIC	214
RELAY GP.....	127	CYLINDER GP-LIFT.....	218
SENSOR GP-SPEED.....	129	CYLINDER GP-LIFT ARM	219
SOFTWARE GP-MACHINE	131	CYLINDER GP-TILT.....	220
STARTING MOTOR GP-ELECTRIC	132	HYDRAULIC AR	224
WIRING GP-AIR CONDITIONER	133	KIT-COVER	226
WIRING GP-CAB	135	LINES GP-AUXILIARY HYDRAULIC	227
WIRING GP-CAMERA	137	LINES GP-BUCKET	231
WIRING GP-ENGINE.....	138	LINES GP-CONNECTING.....	245
WIRING GP-FRONT.....	139	LINES GP-GRAPPLE.....	249
WIRING GP-HEATER	141	LINES GP-HYDRAULIC	255
WIRING GP-PLATFORM.....	142	LINES GP-LIFT CYLINDER.....	261
WIRING GP-QUICK COUPLER	144	LINES GP-PUMP	263
WIRING GP-RIDE CONTROL.....	145	LINES GP-TILT CYLINDER.....	268
WIRING GP-WORK TOOL.....	146	MANIFOLD & MTG GP-CONTROL	270
POWER TRAIN.....	150	MANIFOLD GP-CONTROL	271
AXLE GP	150	MANIFOLD GP-RIDE CONTROL	274
DRIVE GP-TANDEM	152	MOTOR & MTG GP-HYDRAULIC	
FILTER GP-OIL.....	153	FAN	275
LINES GP-HYDROSTATIC.....	155	MOTOR GP-GEAR.....	277
MOTOR & MTG GP-HYDROSTATIC	160	MOUNTING GP-CYLINDER.....	278
MOTOR GP-PISTON	162	PUMP & MTG GP-GEAR.....	282
MOUNTING GP-PUMP	165	PUMP & MTG GP-WORK TOOL.....	283
POWER TRAIN AR.....	166	PUMP GP-GEAR	284
PUMP & MTG GP-HYDROSTATIC	167	PUMP GP-PISTON.....	286
PUMP GP-PISTON.....	168	TANK & MTG GP-HYDRAULIC	287
TIRE & RIM GP	170	VALVE & MTG GP-CONTROL.....	289
WHEEL & TIRE AR.....	176	WORK TOOLS	290
FRAME AND BODY	183	ARM GP-MATERIAL HANDLING	290
CONVERSION AR-ROADING	183	BLADE AR.....	291
CONVERSION GP-ROADING	184	BLADE AS-ANGLING	298
COUNTERWEIGHT GP.....	185	BLADE GP-ANGLING	302
ENCLOSURE GP-ENGINE.....	186	BLADE GP-MULTIPURPOSE	
FRAME GP-LOADER.....	189	BUCKET	306
GRILL GP-RADIATOR.....	191	BLADE GP-SNOW.....	325
KIT-COUNTERWEIGHT.....	192	BUCKET AR-DIRT	326
KIT-GUARD	193	BUCKET AR-GENERAL PURPOSE	327
KIT-ROADING CONVERSION.....	194	BUCKET AR-GRAPPLE	328
LIFTING GP-MACHINE	197	BUCKET AR-LIGHT MATERIAL.....	335
MIRROR & MTG GP-REAR VIEW	198	BUCKET AR-MULTIPURPOSE	335
MOUNTING GP-REGISTRATION.....	199	BUCKET AR-UTILITY	344
MOUNTING GP-ROADING LIGHTS	200	BUCKET AS-DIRT	345
SPACER GP	202	BUCKET AS-GENERAL PURPOSE.....	354
HYDRAULIC SYSTEM.....	203	BUCKET AS-GRAPPLE	364
ACCUMULATOR GP-HYDRAULIC.....	203	BUCKET AS-LIGHT MATERIAL	372
ACCUMULATOR GP-RIDE		BUCKET AS-UTILITY	380
CONTROL.....	205	BUCKET GP-DIRT	383
		BUCKET GP-GENERAL PURPOSE	384
		BUCKET GP-GRAPPLE	385

TABLE OF CONTENTS

NAME	PAGE	NAME	PAGE
BUCKET GP-MULTIPURPOSE	392	CONTROL GP-HANDLE	488
BUCKET GP-UTILITY	401	CONTROL GP-JOYSTICK	492
CARRIAGE & FORK AR	404	COVER GP-CAB	497
CARRIAGE GP-FORK	405	COVER GP-CONSOLE	498
CLAM AS-MULTIPURPOSE		DOOR GP-CAB	500
BUCKET	406	GUARD GP-ROPS/FOPS	508
CONVERSION GP-WORK TOOL	411	HANDHOLD GP	509
COUPLER AR-QUICK	412	HANDLE GP	510
COUPLER AS	413	HEATER AR-CAB	511
COUPLER GP-QUICK	414	HEATER GP-CAB	512
COVER GP-LINES	418	INSTALLATION GP-RADIO	514
EDGE GP-BIT & CUTTING	419	KIT-AIR CONDITIONER BREATHER	515
EDGE GP-CUTTING	420	KIT-CAB DOOR & MOUNTING	516
FORK AR-GRAPPLE	428	KIT-CAB WINDOW	520
FORK GP-GRAPPLE	429	KIT-INSTRUMENT PANEL	521
FORK GP-PALLET	432	KIT-PEDAL	522
FORK GP-UTILITY	436	KIT-RADIO	523
FRAME GP-BLADE	442	LINER GP-CAB	525
FRAME GP-FORK	443	LINES GP-AIR CONDITIONER	527
GRAPPLE & CYLINDER GP-		LINES GP-HEATER	529
UTILITY	445	LITERATURE GP	530
GRAPPLE GP-UTILITY	446	MOTOR GP-WINDOW WIPER	531
KIT-ROADING PLATE &		MOUNTING GP-ARMREST	532
MOUNTING	447	MOUNTING GP-ROPS	534
LINK GP-COUPLER	448	PANEL GP-INSTRUMENT	536
LOCK GP-QUICK COUPLER	452	PEDAL GP-GOVERNOR	542
PLATE GP-SIDE	453	RADIO GP	543
PUMP GP-DIAPHRAGM	455	SEAT & ARMREST GP	545
SPRING GP-BLADE	456	SEAT & MOUNTING GP	547
STEP GP-MATERIAL HANDLING		SEAT AR-SUSPENSION	554
ARM	457	SEAT BELT GP	555
STOP GP-BUCKET	458	SEAT GP-SUSPENSION	557
STRAINER GP-WATER	459	SUSPENSION GP-SEAT	561
TANK & MTG GP-WATER	460	WINDOW GP-CAB	563
TANK GP-WATER	462		
TOOTH GP-UNI	463		
OPERATOR STATION	464	SERVICE EQUIPMENT AND	
ACCESSORY GP-CAB	464	SUPPLIES	567
ACCUMULATOR GP-REFRIGERANT	466	FILM GP	567
AIR CONDITIONER & MOUNTING		PLATE & FILM GP	573
GP	467		
AIR CONDITIONER AR	469	PART NUMBER INDEX	B1
ARMREST & MOUNTING GP	470		
ARMREST GP	472		
BLOWER GP-CAB	474		
CAB AR	475		
CAB AR-ENCLOSED ROPS	475		
CAB AR-OPEN ROPS	475		
CABLE GP-CONTROL	477		
COMPRESSOR GP-REFRIGERANT	478		
CONDENSER & MTG GP-			
REFRIGERANT	479		
CONTROL GP-AIR &			
TEMPERATURE	480		
CONTROL GP-			
ELECTROHYDRAULIC	482		

GENERAL INFORMATION

1. MACHINE IDENTIFICATION

Cat machines are identified by Product Identification Numbers (PIN). Some components included in a machine may be identified by Serial Numbers (S/N). Typical components that will be serialized include engines, transmissions, bulldozers, and rippers. The machine and engine are further identified by arrangement numbers and in some cases modification numbers. These numbers are shown on the product identification plate(s) and on the master plate in the operator's compartment.

Cat dealers need all of these numbers to determine accurate parts identification.

Effective First Quarter 2001 the Cat Product Identification Number (PIN) changed from 8 to 17 characters. In an effort to provide uniform equipment identification, Caterpillar and other construction equipment manufacturers are moving to comply with the latest version of the product identification numbering standard. Non-road machine PINs are defined by ISO 10261. The new PIN format will apply to all Cat machines and generator sets. The PIN plates and frame marking will display the 17 character PIN. The new format will look like the following:

CAT 0789BG 6SL12345

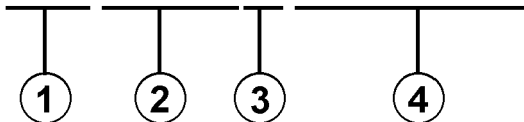

Where:

1. Caterpillar's World Manufacturing Code (characters 1-3)
2. Machine Descriptor (characters 4-8)
3. Check Character (character 9)
4. Machine Indicator Section (MIS) or Product Sequence Number (characters 10-17). These were previously referred to as the Serial Number.

Machines and generator sets produced before First Quarter 2001 will maintain their 8 character PIN format.

Components such as engines, transmissions, axles, etc. and work tools will continue to use an 8 character Serial Number (S/N).

2. ORDERING PARTS

WARNING

When replacement parts are required for this product Caterpillar recommends using Caterpillar replacement parts or parts with equivalent specifications including, but not limited to, physical dimensions, type, strength and material.

Failure to heed this warning can lead to premature failures, product damage, personal injury or death.

Quality Cat replacement parts are available from Cat dealers throughout the world. Their parts inventories are up to date and include all parts normally required to protect your investment in Cat machines. Dealers may offer repair kits or remanufactured parts to allow selection of the most effective repair alternative for a particular situation. When ordering parts, your order should specify the quantity, part number, part name, and the serial number/product identification number of the machine for which the parts are needed.

3. PARTS MANUAL ORGANIZATION

Product information in this manual is presented as "information elements" that represent all of the components for the specific model. Engine Arrangement and Seat Group are examples of information elements. The information elements are organized alphabetically by part name and secondarily by part number within each major section of the manual.

4. TABLE OF CONTENTS

A table of contents (TOC) is found at the beginning of the manual. The TOC lists each section of the manual with a complete list of all information elements organized as they appear in the manual. Page numbers are provided for quick reference to detailed parts identification illustrations and serviceable consist lists.

5. MAINTENANCE PARTS INDEX

The Maintenance Parts Index, located near the beginning of the manual, references most frequently used maintenance part numbers, providing description, quantity, usage and page number. This information is organized alphabetically by part description.

GENERAL INFORMATION

6. INDEX

The index located near the front of the manual is an alphabetical listing of all information elements included in the manual. Page numbers are provided for quick reference to detailed parts identification illustrations and serviceable consist lists.

7. PART NUMBER INDEX

A numerical index listing all part numbers and the corresponding page number(s) appears at the back of the manual.

8. CAPTIONS

Captions located at the beginning of each information element identify the part number and part name along with additional descriptive information. PIN and S/N information found in each caption should be used to select correct information for a specific machine. Field replacement options, identification of optional attachment components, and where used ("part of") information is also provided.

The first line of a caption is shown in larger type font to indicate the beginning of an information element. Captions for additional pages that may be required to illustrate an information element will be shown in standard type font and will include the term (*contd.*).

9. NON-SERVICED PARTS

In some instances it is necessary to display non-serviced parts that are a link to a lower level serviceable consist lists. These non-serviced part numbers are shown in *italic* type indicating that they are not available.

10. PARTS LIST REFERENCE NUMBERS

Numbers shown in the Ref No column correspond to numbers used in the associated graphic(s). An alphabetic suffix may be added to a reference number to identify lower level consist items. Numbers shown in the Graphic Ref column refer to the graphic number identifier displayed in the lower left corner of each illustration. The Graphic Ref number may be used in combination with the item Ref No to determine the correct part number. There may be intentional omission of a Ref No in a consist list as information is updated to reflect the latest serviceable part numbers.

11. INDENTED PART NAMES

When a part name is indented in a parts list, it is part of (included in) the group or assembly under which it is indented.

12. ILLUSTRATION REFERENCE LETTERS

When necessary, illustrations contain reference letters (A, B, C etc.) that are intended to track lines and harnesses from one point to another. They are also used to show where to reconnect illustrations that have been separated.

13. ABBREVIATIONS AND SYMBOLS

O.D. – Outside Diameter
I.D. – Inside Diameter
A – Not Part Of This Group
B – Use As Required
C – Change From Previous Type
D – Order By The Meter
E – Order By The Centimeter
F – Not Shown
G – Order By The Inch
I – Refer To Hydraulic Information System
M – Metric Part
R – Remfg Part May Be Available
Y – Separate Illustration
Z – Not Serviced Separately

14. DESCRIPTION OF TYPE CHANGES

Type - A type is defined as any configuration change that requires an additional Information Element for an Arrangement, Group, or Assembly. If serial number breaks for types are not available, a type # (Type 1, Type 2, etc.) will be displayed in the caption. These "type" changes are identified with a "C" note (change from previous type) in the Parts List. Only the "types" that apply to this Parts Manual will be included. Additional types may exist causing "C" notes to appear on an Information Element when no other types are shown.

15. <END>

This symbol indicates the end of an information element.

NOTE:

Continuing improvement and advancement of product design may cause changes to your machine which may not be included in this publication. Whenever a question arises regarding your Cat product or this publication, please consult your Cat dealer for the latest available information.

GENERAL INFORMATION

FRAME AND BODY						
8E-3299 PLATFORM GP-CAB						
P/N 38K1-00000						
ITEM NO.	REF ID	GRAPHIC REF	PART NUMBER	QTY	PART NAME	SEE PAGE
1			3T-3963	1	PLATE AS	
2			8E-3092	25	BOLT (3/8-18X.750IN)	
3			8E-1076	41	WASHER-HAND (3MM THK)	
4			8E-1044	2	SUPPORT BR-FOOT	
5			8E-2229	19	BOLT (1/2-13X1IN)	
6			8E-1136	1	WASHER-HAND (4MM THK)	
7			8E-8136	1	COVER AS-LH	
8			8E-8136	1	NUT-WELD (3/8-16 THD)	
9			1P-8189	1	CLIP	
10			7E-2411	4	COVER	
11			8E-3092	18	SCREW-HEAD (3/8-18X.875IN)	
12			8E-3092	1	COVER	
13			8E-8912	1	GASKET	
14			8E-3249	1	COVER	
15			8E-3249	1	COVER	
16			8E-3249	1	COVER	
17			8E-3249	1	COVER	
18			8E-3249	1	COVER	
19			8E-3249	1	COVER	
20			8E-3249	1	COVER	
21			8E-3249	1	COVER	
22			8E-3249	1	COVER	
23			8E-3249	1	COVER	
24			8E-3249	1	COVER	
25			8E-3249	1	COVER	
26			8E-3249	1	COVER	
27			8E-3249	1	COVER	
28			8E-3249	1	COVER	
29			8E-3249	1	COVER	
30			8E-3249	1	COVER	
31			8E-3249	1	COVER	
32			8E-3249	1	COVER	
33			8E-3249	1	COVER	
34			8E-3249	1	COVER	
35			8E-3249	1	COVER	
36			8E-3249	1	COVER	
37			8E-3249	1	COVER	
38			8E-3249	1	COVER	
39			8E-3249	1	COVER	
40			8E-3249	1	COVER	

FRAME AND BODY						
8E-3299 PLATFORM GP-CAB (contd.)						
100090751						
NOTE	REF ID	GRAPHIC REF	PART NUMBER	QTY	PART NAME	SEE PAGE
	41		8E-2515	1	COVER	
	42		7T-0134	1	PLATE	
	43		7T-0138	1	GASKET	
	44		7E-8724	1	GASKET	
	45		7E-8723	1	COVER	
	46		8V-1250	2	PLUG-BUTTON	

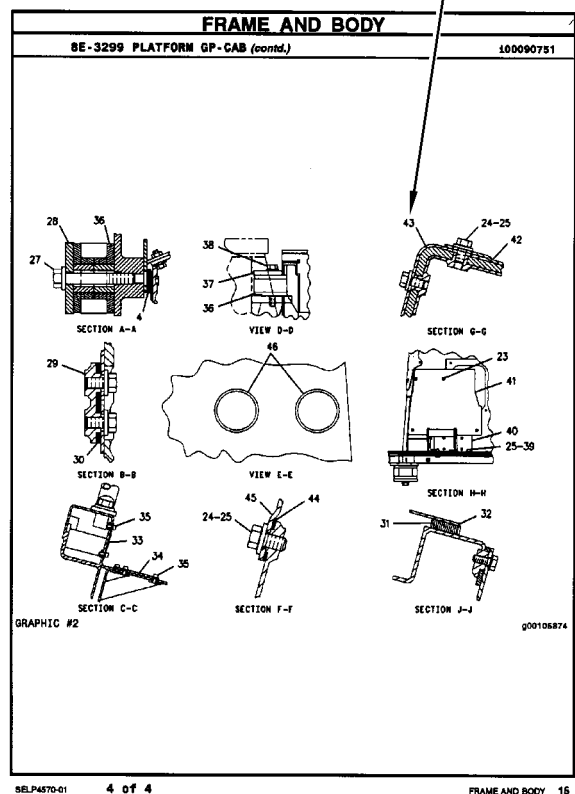
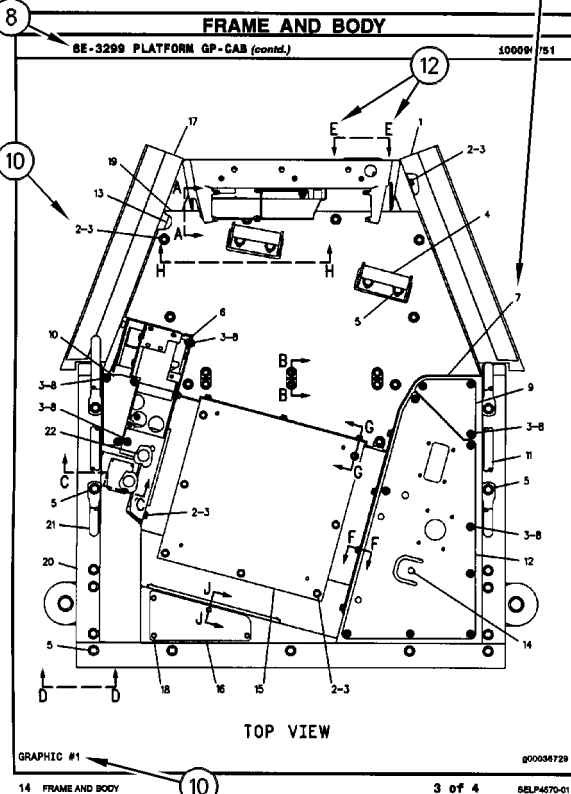
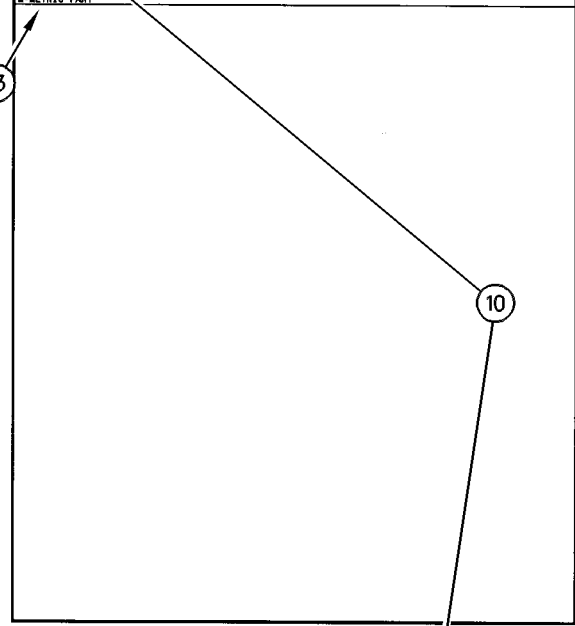

REPAIR ALTERNATIVES

REMANUFACTURED COMPONENTS

As an option when making repairs consider Cat Remanufactured Components. Components that are available through the Cat Remanufactured Program are identified three ways in the parts book:

- with the letter R in the note field of the parts list
- with an R* at the beginning of the first line of the caption
- with an *R at the end of the first line of the caption

Typical components included in the Remanufacturing Program include:

ALTERNATORS
CONNECTING RODS
CRANKSHAFTS - UNDERSIZE
CRANKSHAFTS - UPGRADE TO NEW
CYLINDER HEADS
ELECTRONIC CONTROL MODULES (ECM)
ELECTRONIC SENSORS
FUEL INJECTORS
FUEL NOZZLES
FUEL PUMPS
GOVERNORS
OIL PUMPS
PISTONS
SHORT BLOCKS
STARTERS
TURBOCHARGERS - COMPLETE
TURBOCHARGER CARTRIDGES
WATER PUMPS

Cat Remanufactured engines for many engine arrangements are also available.

SUPPLEMENTAL COOLANT ADDITIVES

CUSTOMER BENEFITS:

Protects against cavitation, foam, erosion, corrosion, and scale buildup in cooling systems.

- Provides measured coolant conditioner.

DESCRIPTION:

Additives deplete from the coolant with normal operation. For this reason, Supplemental Coolant Additives (SCA) must be added to all heavy duty coolants at regular intervals. In addition, when not using a fully formulated, pre-charged antifreeze, like Cat DEAC, an initial charge of SCA must be added to the cooling system. The amount of SCA added to the system is dependent on the capacity of the system.

The SCA for initial fill is provided as a liquid. SCA's for maintenance intervals are available in liquid form and as a spin-on element. (No Spin-on available for 3600 Family of Engines)

NOTE:

The amount of SCA added at initial fill is not the same as the amount added at maintenance intervals.

The coolant additive elements can be used with any ethylene or propylene glycol type antifreeze which meets ASTM D4985 or ASTM D5345 Specifications.

NOTE:

For use with standard heavy duty coolant only, not for use with Extended Life Coolant.

PARTS NEEDED:

Cooling System Capacity		Liquid SCA at Initial Fill	Liquid SCA at Maintenance*	Spin-on SCA Maintenance Element*
Liters	Gallons			
22-30	(6-8)	3P-2044 (1)	6V-3542 (1)	111-2370 (1)
30-38	(8-10)	3P-2044 (1) 6V-3542 (1)	111-2372 (1)	111-2369 (1)
38-49	(10-13)	3P-2044 (1) 8T-1589 (1)	111-2372 (1)	111-2369 (1)
49-64	(13-17)	3P-2044 (2)	8T-1589 (1)	9N-3368 (1)
64-83	(17-22)	3P-2044 (2) 8T-1589 (1)	111-2372 (1) 6V-3542 (1)	111-2371 (1)
83-114	(22-30)	3P-2044 (3) 8T-1589 (1)	3P-2044 (1)	9N-3718 (1)
114-163	(30-43)	3P-2044 (5)	3P-2044 (1) 6V-3542 (1)	111-2371 (2)
163-242	(43-64)	3P-2044 (8)	3P-2044 (2)	9N-3718 (2)

* Normal maintenance period is 250 hrs. See your Operation and Maintenance Manual for complete coolant maintenance instructions.

() Indicates quantity required.

MAINTENANCE PARTS

DESCRIPTION	PART NUMBER	QTY	WHERE USED	PAGE
AIR INLET AND EXHAUST SYSTEM				
CAP AS-VENTED (COOLANT RECOVERY)	229-3469	1	LINES GP-COOLING	54
FILTER ELEMENT AS-AIR (PRIMARY)	110-6326	1	AIR CLEANER GP	47
FILTER ELEMENT AS-AIR (SECONDARY)	110-6331	1	AIR CLEANER GP	47
		1	AIR CLEANER GP	48
BASIC ENGINE				
ELEMENT (BREATHING)	388-7488	4	COVER GP-VALVE MECHANISM	10
		4	COVER GP-VALVE MECHANISM	12
V-BELT (FAN DRIVE PULLEY)	437-2564	1	PULLEY GP	33
COOLING SYSTEM				
CAP AS-RADIATOR	036-1865	1	RADIATOR & HYD OIL COOLER GP	44
REGULATOR AS	389-5308	1	LINES GP-WATER	42
REGULATOR AS (WATER TEMPERATURE)	389-5308	1	LINES GP-WATER	41
ELECTRICAL AND STARTING SYSTEM				
BATTERY (12-VOLT, 880-CCA)	230-6368	1	BATTERY & WIRING GP	87
BELT-DRIVE (WARNING BEACON)	9X-8139	1	LAMP GP-WARNING BEACON	122
CIRCUIT BREAKER AS	373-1592	1	HARNESS AS-QUICK COUPLER	106
FLASHER AS (12-VOLT) (STOP LIGHT)	242-9000	1	LAMP GP-ROADING	119
		1	LIGHTING GP-ROADING	124
FUSE (10-AMPERE)	113-8490	6	HARNESS AS-CAB	95
	3K-8782	1	HARNESS AS-CHASSIS	98
FUSE (100-AMPERE)	378-1012	1	WIRING GP-PLATFORM	142
FUSE (15-AMPERE)	113-8491	10	HARNESS AS-CAB	95
	9W-1441	1	HARNESS AS-CAB	95
FUSE (20-AMPERE)	113-8492	4	HARNESS AS-CAB	95
	267-2680	2	COVER GP-FUSE PANEL	91
		1	RELAY GP	127
		1	RELAY GP	128
FUSE (30-AMPERE)	274-9872	1	RELAY GP	128
FUSE (50-AMPERE)	396-8366	1	WIRING GP-PLATFORM	142
FUSE (60-AMPERE)	267-2701	1	RELAY GP	127
FUSE AS (ROADING)	258-4134	1	LAMP GP-ROADING	119
		1	LIGHTING GP-ROADING	124
GLOW PLUG	387-9899	4	GLOW PLUG GP	93
LAMP (12-VOLT, 21-WATT) (AMBER)	226-4560	1	LAMP GP-HEAD & SIGNAL	117
		1	LAMP GP-HEAD & SIGNAL	118
LAMP (12-VOLT, 21-WATT) (TURN SIGNAL)	9W-3326	1	LAMP GP-ROADING	119
		1	LIGHTING GP-ROADING	124
LAMP (12-VOLT, 5-WATT) (CLEAR)	226-4561	1	LAMP GP-HEAD & SIGNAL	117

MAINTENANCE PARTS

DESCRIPTION	PART NUMBER	QTY	WHERE USED	PAGE
LAMP (12-VOLT, 5-WATT) (STOP, TAIL)	084-4348	1	LAMP GP-HEAD & SIGNAL	118
		1	LAMP GP-ROADING	119
		1	LIGHTING GP-ROADING	124
LAMP (12-VOLT, 55-WATT) (FLOODLIGHT)	9W-0607	1	LAMP GP-FLOOD	115
		1	LAMP GP-FLOOD	116
LAMP (12-VOLT, 55-WATT) (WARNING BEACON)	9X-8118	1	LAMP GP-WARNING BEACON	122
LAMP (12-VOLT) (STOP, TAIL)	9W-2471	1	LAMP GP-STOP & TAIL	121
LAMP-HEAD (12-VOLT, 60/55-WATT) (CLEAR)	9W-3324	1	LAMP GP-HEAD & SIGNAL	117
		1	LAMP GP-HEAD & SIGNAL	118
FRAME AND BODY				
LAMP (12-VOLT, 10-WATT)	195-9712	1	KIT-ROADING CONVERSION	196
PLUG-MAGNETIC (FRAME)	3S-9182	1	MOUNTING GP-REGISTRATION	199
		4	FRAME GP-LOADER	189
FUEL SYSTEM				
CAP-FUEL (FILLER)	304-3885	1	TANK GP-FUEL	85
FILTER AS-FUEL (FUEL TRANSFER PUMP)	363-5823	1	PUMP GP-FUEL TRANSFER	83
FILTER AS-WATER SEP & FUEL (FUEL, WATER SEPARATOR)	363-5819	1	FILTER GP-FUEL	67
KEY (FUEL INJECTION PUMP)	388-7517	1	PUMP GP-FUEL INJECTION	77
		1	PUMP GP-FUEL INJECTION	79
HYDRAULIC SYSTEM				
BREATHER (HYDRAULIC TANK)	258-2829	1	TANK & MTG GP-HYDRAULIC	287
CAP (GAS VALVE)	224-5132	1	ACCUMULATOR GP-RIDE CONTROL	205
		1	ACCUMULATOR GP-RIDE CONTROL	206
CAP AS-FILLER (HYDRAULIC TANK)	142-8937	1	TANK & MTG GP-HYDRAULIC	287
STRAINER AS (HYDRAULIC TANK)	262-5689	1	TANK & MTG GP-HYDRAULIC	287
LUBRICATION SYSTEM				
FILTER-ENGINE OIL	377-6969	1	LINES GP-ENGINE OIL	38
OPERATOR STATION				
BLADE AS-WIPER (500-MM)	146-6433	1	DOOR GP-CAB	504
		1	KIT-CAB DOOR & MOUNTING	518
BLADE AS-WIPER (500-MM) (FRONT)	146-6433	1	DOOR GP-CAB	500
		1	KIT-CAB DOOR & MOUNTING	516
CAP-VENTED (WASHER)	258-3296	1	KIT-CAB DOOR & MOUNTING	516
		1	KIT-CAB DOOR & MOUNTING	518
CAP-VENTED (WINDOW WASHER TANK)	258-3296	1	DOOR GP-CAB	502

MAINTENANCE PARTS

DESCRIPTION	PART NUMBER	QTY	WHERE USED	PAGE
		1	DOOR GP-CAB	506
FILTER ELEMENT-CAB AIR (FRESH AIR)	265-6619	1	AIR CONDITIONER & MOUNTING GP	467
FILTER ELEMENT-CAB AIR (RECIRCULATION)	265-6618	1	AIR CONDITIONER & MOUNTING GP	467
LAMP (12-VOLT)	210-8754	1	PANEL GP-INSTRUMENT	536
V-BELT	198-8354	1	COMPRESSOR GP-REFRIGERANT	478
POWER TRAIN				
FILTER ELEMENT AS-OIL (HYDRAULIC)	348-1862	1	FILTER GP-OIL	153
		1	FILTER GP-OIL	154
WORK TOOLS				
CAP AS (WATER TANK)	192-2606	1	TANK GP-WATER	462
SCREEN (WATER TANK)	119-1414	1	STRAINER GP-WATER	459

INDEX

NAME	PAGE	NAME	PAGE
A		BLADE GP-MULTIPURPOSE BUCKET	306
ACCESSORY GP-CAB	464		307
	465		308
ACCUMULATOR GP-HYDRAULIC-CHARGED...	203		309
ACCUMULATOR GP-HYDRAULIC-			310
UNCHARGED	204		311
ACCUMULATOR GP-REFRIGERANT-			312
CHARGED	466		313
ACCUMULATOR GP-RIDE CONTROL-			314
CHARGED	205		315
ACCUMULATOR GP-RIDE CONTROL-			316
UNCHARGED	206		317
ACTUATOR GP (GOVERNOR CONTROL).....	65		318
ACTUATOR GP (QUICK COUPLER).....	144		319
AIR CLEANER GP	46		320
	47		321
	48		322
AIR CONDITIONER & MOUNTING GP	467		323
AIR CONDITIONER AR-ENCLOSED CAB	469		324
ALTERNATOR GP-CHARGING	86		392
ARM GP-MATERIAL HANDLING	290	BLADE GP-SNOW	325
ARM GP-WINDOW WIPER (CAB DOOR)	500	BLOWER GP-CAB	474
	504	BREATHER (HYDRAULIC TANK)	287
	516	BUCKET AR-DIRT	326
	518	BUCKET AR-GENERAL PURPOSE	327
ARMREST & MOUNTING GP	470		328
	471	BUCKET AR-GRAPPLE	328
ARMREST GP-LH	473		329
ARMREST GP-RH	472		330
AXLE GP	150		332
	151		333
			334
B		BUCKET AR-GRAPPLE-INDUSTRIAL	329
BATTERY (12-VOLT, 880-CCA).....	87		331
BATTERY & WIRING GP	87	BUCKET AR-LIGHT MATERIAL	335
BELT-DRIVE (WARNING BEACON).....	122	BUCKET AR-MULTIPURPOSE	335
BLADE AR-ANGLING	291		336
	293		337
	296		338
	297		339
BLADE AR-SNOW	294		340
BLADE AR-STANDARD	292		341
	295		342
BLADE AS-ANGLING	298		343
	299		344
	300	BUCKET AR-UTILITY	344
	301	BUCKET AS-DIRT	345
BLADE AS-WIPER (500-MM)	504		346
	518		347
BLADE AS-WIPER (500-MM) (FRONT)	500		348
	516		349
BLADE GP-ANGLING	302		350
	303		351
	304		352
	305		353

INDEX

NAME	PAGE	NAME	PAGE
BUCKET AS-GENERAL PURPOSE	354	CABLE GP-CONTROL	477
	355	CAMERA GP (12-VOLT, 24-VOLT).....	137
	356	CAMERA GP (12-VOLT, 24-VOLT) (WORK AREA	
	357	VISUAL SYSTEM, REAR)	112
	358	CAMERA GP-WORK AREA VISUAL SYSTEM,	
	359	REAR.....	89
	360	CAMSHAFT GP	8
	361	CAP (GAS VALVE).....	205
BUCKET AS-GENERAL PURPOSE-HIGH			206
CAPACITY	362	CAP AS (WATER TANK)	462
	363	CAP AS-FILLER (HYDRAULIC TANK).....	287
BUCKET AS-GRAPPLE	364	CAP AS-RADIATOR	44
	365	CAP AS-VENTED (COOLANT RECOVERY)	54
	366	CAP-FUEL (FILLER)	85
	367	CAP-VENTED (WASHER)	516
	368		518
	369	CAP-VENTED (WINDOW WASHER TANK)	502
BUCKET AS-GRAPPLE-INDUSTRIAL	370		506
	371	CARRIAGE & FORK AR	404
BUCKET AS-LIGHT MATERIAL	372	CARRIAGE GP-FORK.....	405
	373	CHASSIS AR.....	1
	374	CIRCUIT BREAKER AS.....	106
	375	CLAM AS-MULTIPURPOSE BUCKET	406
	376		407
	377		408
	378		409
	379		410
BUCKET AS-UTILITY	380	COMMON AR	1
	381	COMPRESSOR GP-REFRIGERANT	478
	382	CONDENSER & MTG GP-REFRIGERANT	479
BUCKET GP-DIRT	383	CONFIGURATION AR.....	2
BUCKET GP-GENERAL PURPOSE	384	CONFIGURATION AR-RIDE CONTROL	2
BUCKET GP-GRAPPLE	386		3
	390	CONTROL AR-HYDRAULIC	207
	391	CONTROL GP-AIR & TEMPERATURE	480
BUCKET GP-GRAPPLE-INDUSTRIAL	385		481
	387	CONTROL GP-COMMUNICATION (PL421).....	111
	388	CONTROL GP-ELECTROHYDRAULIC.....	482
	389		483
BUCKET GP-MULTIPURPOSE.....	392	CONTROL GP-ELECTROHYDRAULIC-LH	487
	393	CONTROL GP-ELECTROHYDRAULIC-LH, HIGH	
	394	FLOW	486
	395	CONTROL GP-ELECTROHYDRAULIC-ON, OFF	
	396	AUXILIARY CONTROL	482
	397	CONTROL GP-ELECTROHYDRAULIC-RH	485
	398	CONTROL GP-ELECTROHYDRAULIC-RH, HIGH	
	399	FLOW	484
	400	CONTROL GP-GOVERNOR	65
BUCKET GP-UTILITY	401	CONTROL GP-HANDLE.....	491
	402	CONTROL GP-HANDLE (RH).....	492
	403	CONTROL GP-HANDLE-JOYSTICK	488
		CONTROL GP-HANDLE-LH	489
		CONTROL GP-HANDLE-RH-JOYSTICK	490
		CONTROL GP-JOYSTICK	494
		CONTROL GP-JOYSTICK-LH.....	496
		CONTROL GP-JOYSTICK-LH, HIGH FLOW	495
		CONTROL GP-JOYSTICK-RH	492
		CONTROL GP-JOYSTICK-RH, HIGH FLOW	493
		CONTROL GP-UNPRGMED MONITOR	
		(OPTIONAL).....	521

C

INDEX

NAME	PAGE	NAME	PAGE
CONTROL GP-UNPROGRAMMED (MACHINE)...	92	E	
CONTROL GP-UNPROGRAMMED (MONITOR)...	92	EDGE GP-BIT & CUTTING.....	419
CONVERSION AR-MACHINE	3		420
CONVERSION AR-MACHINE-NACD	3	EDGE GP-CUTTING	335
CONVERSION AR-ROADING	183		420
CONVERSION GP-MACHINE	90		421
CONVERSION GP-ROADING	184		422
CONVERSION GP-WORK TOOL	411		423
COOLER GP-EXHAUST	49		424
COOLER GP-NRS	49		425
COUNTERWEIGHT GP	185		426
COUPLER AR-QUICK	412		427
COUPLER AR-QUICK-ELECTRIC	412	ELECTRONICS GP-MACHINE	92
COUPLER AS	413	ELECTRONICS GP-MONITOR	92
COUPLER GP-QUICK	414	ELEMENT (BREATHING)	10
	417		12
COUPLER GP-QUICK-ELECTRIC	415	ENCLOSURE GP-ENGINE	186
COUPLER GP-QUICK-MANUAL	416	ENCLOSURE GP-ENGINE-SEAL	187
COVER GP-CAB	497	ENGINE AR-COMPLETE	4
COVER GP-CONSOLE	498	ENGINE AR-PRIMARY	5
COVER GP-CONSOLE-RH, LH	499		6
COVER GP-FUSE PANEL	91	EXTENSION GP-EXHAUST	51
COVER GP-LINES	418		
COVER GP-VALVE MECHANISM	9	F	
	10	FAN GP-BLOWER (RADIATOR, HYD OIL	
	11	COOLING)	44
	12	FILLER GP-ENGINE OIL	36
CRANKSHAFT GP	13	FILM (REFLECTIVE)	447
CYLINDER & MTG GP-ANGLE BLADE	208	FILM GP	295
	209		567
CYLINDER & MTG GP-LIFT ARM	210		568
CYLINDER BLOCK AS	15	FILM GP (BLADE)	294
CYLINDER BLOCK GP	16	FILM GP-2-SPEED	570
CYLINDER GP-BUCKET	211	FILM GP-HIGH FLOW	569
CYLINDER GP-GRAPPLE-INDUSTRIAL	213	FILM GP-RIDE CONTROL ANSI	571
CYLINDER GP-GRAPPLE-UTILITY	212	FILM GP-RIDE CONTROL ISO	572
CYLINDER GP-HYDRAULIC-ANGLE BLADE	214	FILM-FUSE/RELAY	91
	215	FILM-IDENTIFICATION (ALTERNATE EXIT, READ	
CYLINDER GP-HYDRAULIC-BUCKET	217	OMM)	502
CYLINDER GP-HYDRAULIC-TILT	216		506
CYLINDER GP-LIFT ARM	219		516
CYLINDER GP-LIFT-RH	218		518
CYLINDER GP-TILT-LH	222	FILM-IDENTIFICATION (HYDRAULIC OIL	
CYLINDER GP-TILT-RH	220	FILL)	582
CYLINDER HEAD AS	17		585
	19	FILM-IDENTIFICATION (POWER	
CYLINDER HEAD GP	21	DISTRIBUTION)	135
	22	FILM-IDENTIFICATION (POWER RECEPTACLE, 12-	
D		VOLT)	582
DOOR GP-CAB-BASIC-POLY	504		585
DOOR GP-CAB-GLASS	500		588
	502		591
DOOR GP-CAB-POLY	506	FILM-IDENTIFICATION (THROTTLE)	536
DRAIN GP-ENGINE OIL	23	FILM-INFORMATION (LIFT EYE LOCATION) ...	197
DRIVE GP-TANDEM	152		295
		FILM-INSTRUCTION (ALTERNATE EXIT)	563

INDEX

NAME	PAGE	NAME	PAGE
FILM-INSTRUCTION (EGRESS SYSTEM, READ OMM).....	500	FILTER ELEMENT-CAB AIR (RECIRCULATION).....	467
	504	FILTER GP-FUEL.....	67
	516	FILTER GP-OIL-HYDRAULIC.....	154
	518	FILTER GP-OIL-HYDRAULIC, TRANSMISSION.....	153
FILM-PANEL (BLOWER, TEMPERATURE CONTROL).....	480	FILTER-ENGINE OIL.....	38
FILM-STRIPE (REFLECTIVE, RED, WHITE)	447	FITTING GP-ELBOW.....	263
FILM-STRIPE (ROUND RED REFLECTIVE).....	126		265
FILM-WARNING (CRUSH HAZARD, STAY BACK).....	279	FITTING GP-HYDRAULIC (QUICK DISCONNECT, MALE).....	227
	392	FLASHER AS (12-VOLT) (STOP LIGHT)	119
	393		124
	394	FLOOR MAT.....	525
	395	FLYWHEEL GP	24
	396	FORK AR-GRAPPLE-INDUSTRIAL.....	428
	397	FORK AR-GRAPPLE-UTILITY	428
	398	FORK GP-GRAPPLE.....	429
	399	FORK GP-GRAPPLE-INDUSTRIAL.....	430
	400	FORK GP-GRAPPLE-UTILITY	431
	406	FORK GP-PALLET.....	432
	407		433
	408		434
	409	FORK GP-PALLET-KIT.....	435
	410	FORK GP-UTILITY.....	436
	446		437
	573		438
FILM-WARNING (CRUSH HAZARD).....	389		439
	430		440
	431		441
	437	FRAME GP-BLADE	304
	438		442
	441	FRAME GP-BLADE (WORK TOOL)	305
	443	FRAME GP-FORK-INDUSTRIAL	443
	444		444
FILM-WARNING (DIESEL FUEL).....	582	FRAME GP-LOADER	189
	585	FUSE (10-AMPERE)	95
FILM-WARNING (DO NOT OPERATE, READ OMM).....	573		98
FILM-WARNING (FOPS, READ OMM).....	508	FUSE (100-AMPERE)	142
FILM-WARNING (HIGH PRESSURE, READ OMM).....	205	FUSE (15-AMPERE)	95
	206	FUSE (20-AMPERE)	91
	206		95
	206		127
FILM-WARNING (IMPALED POINT)	439		128
	440	FUSE (30-AMPERE)	128
FILM-WARNING (NO WELD, NO DRILL, READ OMM).....	588	FUSE (50-AMPERE)	142
	591	FUSE (60-AMPERE)	127
FILM-WARNING (UNIVERSAL WARNING).....	582	FUSE AS (ROADING).....	119
	585		124
FILTER AS-FUEL (FUEL TRANSFER PUMP)....	83		
FILTER AS-WATER SEP & FUEL (FUEL, WATER SEPARATOR)	67		
FILTER ELEMENT AS-AIR (PRIMARY).....	47		
FILTER ELEMENT AS-AIR (SECONDARY)	47		
	48		
FILTER ELEMENT AS-OIL (HYDRAULIC)	153		
	154		
FILTER ELEMENT-CAB AIR (FRESH AIR)	467		

G

GAUGE GP-OIL LEVEL (DIPSTICK)	37
GAUGE-OIL LEVEL (DIPSTICK, ENGINE)	37
GAUGE-SIGHT (HYDRAULIC OIL)	44
GAUGE-SIGHT (HYDRAULIC TANK)	287
GLOW PLUG.....	93
GLOW PLUG GP.....	93
GOVERNOR GP.....	68
GRAPPLE & CYLINDER GP-UTILITY	445

Thanks for your reading.

Please click [here](#) to download complete manual instantly.

And can also choose other manuals.

Feel free ---> write to me with any questions.

Our service email:

manuals007@hotmail.com