

Document Title: <b>Position of components</b>	Function Group: <b>000</b>	Information Type: <b>Service Information</b>	Date: <b>2017/7/7 0</b>
Profile: <b>EC35 Volvo</b>			

## Position of components

Showing Selected Profile

Valid for serial numbers			
Model	Production site	Serial number start	Serial number stop
EC35 Volvo			

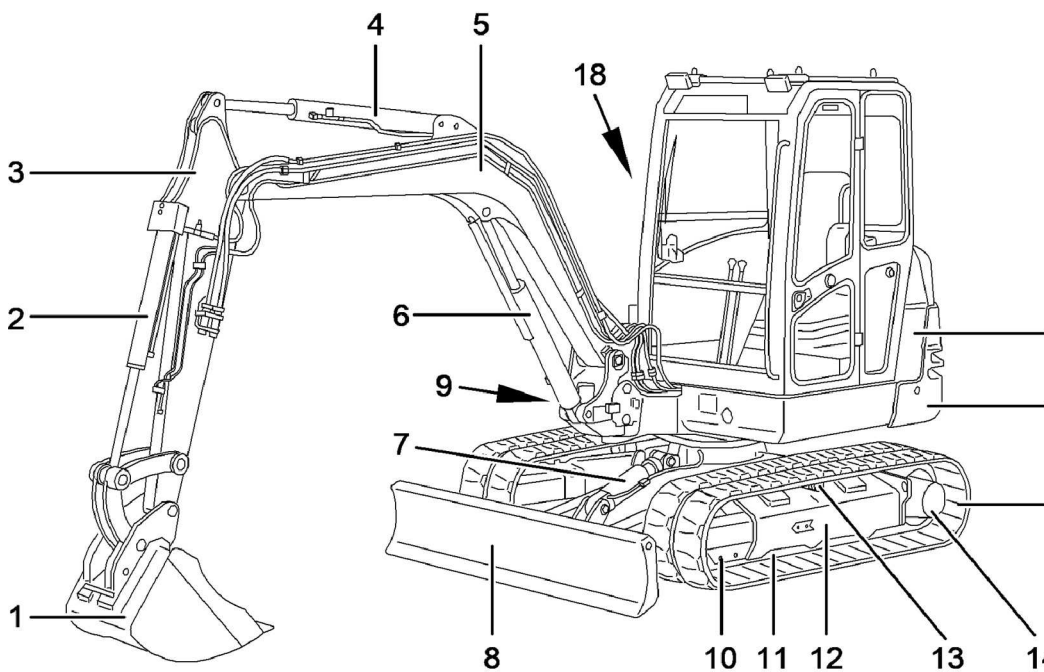

**Figure 1**  
**Position of components**

- |                            |                                       |
|----------------------------|---------------------------------------|
| 1 Bucket                   | 10 Tensioning wheel                   |
| 2 Bucket cylinder          | 11 Rollers                            |
| 3 Dipper, standard version | 12 Main chassis                       |
| 4 Dipper cylinder          | 13 Top roller                         |
| 5 Boom                     | 14 Track sprockets/travel gear motors |
| 6 Boom cylinder            | 15 Tracks                             |
| 7 Dozer blade cylinder     | 16 Slewing superstructure             |
| 8 Dozer blade              | 17 Engine cover                       |
| 9 Boom offset cylinder     | 18 Hydraulic compartment cover        |

Document Title: <b>Warning and information decals</b>	Function Group: <b>000</b>	Information Type: <b>Service Information</b>	Date: <b>2017/7/7 0</b>
Profile: <b>EC35 Volvo</b>			

## Warning and information decals

Showing Selected Profile

<b>Valid for serial numbers</b>			
<b>Model</b>	<b>Production site</b>	<b>Serial number start</b>	<b>Serial number stop</b>
EC35 Volvo			

**The driver must be acquainted with and observe all warning and information decals, which are attached to the machine.**

- Stickers and decals, which are missing or have been damaged, must be immediately replaced.
- Apart from that the decals must be kept in a legible, i.e. clean condition.
- The spare parts number (ordering number) is printed on the respective decal or can be found in the spare parts catalogue.

Document Title: <b>Caution sign - Operation and maintenance</b>	Function Group: <b>000</b>	Information Type: <b>Service Information</b>	Date: <b>2017/7/7 0</b>
Profile: <b>EC35 Volvo</b>			

## Caution sign - Operation and maintenance

Showing Selected Profile

Valid for serial numbers			
Model	Production site	Serial number start	Serial number stop
EC35 Volvo			

Before starting operation of the machine read the instructions and warnings in the operating instructions carefully. The technical documents can be found storage compartment under the driver's seat.

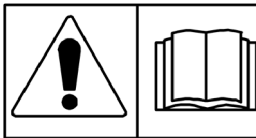
**Figure 1**

Document Title: <b>Warning sign - Open engine hood only with engine stopped</b>	Function Group: <b>000</b>	Information Type: <b>Service Information</b>	Date: <b>2017/7/7 0</b>
Profile: <b>EC35 Volvo</b>			

## Warning sign - Open engine hood only with engine stopped

Showing Selected Profile

Valid for serial numbers			
Model	Production site	Serial number start	Serial number stop
EC35 Volvo			

Due to the risk of injury by rotating parts it is dangerous to open the engine hood while the engine is running.

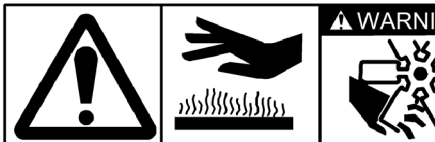

Figure 1

Document Title: <b>Warning sign - Safety distance from the work area</b>	Function Group: <b>000</b>	Information Type: <b>Service Information</b>	Date: <b>2017/7/7 0</b>
Profile: <b>EC35 Volvo</b>			

## Warning sign - Safety distance from the work area

Showing Selected Profile

Valid for serial numbers			
Model	Production site	Serial number start	Serial number stop
EC35 Volvo			

It indicates that a sufficient safety distance from the working area of the machine must be maintained, to avoid bodily injury.

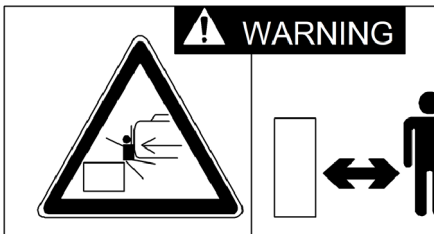

Figure 1

Document Title: <b>Caution sign - Track tension</b>	Function Group: <b>000</b>	Information Type: <b>Service Information</b>	Date: <b>2017/7/7 0</b>
Profile: <b>EC35 Volvo</b>			

## Caution sign - Track tension

Showing Selected Profile

Valid for serial numbers			
Model	Production site	Serial number start	Serial number stop
EC35 Volvo			

Sticker stuck to the roof inside the cab.  
It indicates that the tension of the tracks must be checked every day.

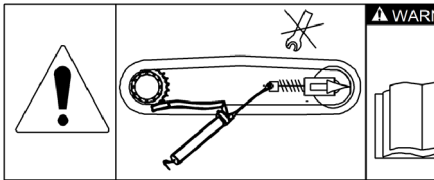

**Figure 1**

Document Title: <b>Caution sign - Diesel engine starting procedure</b>	Function Group: <b>000</b>	Information Type: <b>Service Information</b>	Date: <b>2017/7/7 0</b>
Profile: <b>EC35 Volvo</b>			

## Caution sign - Diesel engine starting procedure

Showing Selected Profile

Valid for serial numbers			
Model	Production site	Serial number start	Serial number stop
EC35 Volvo			

Sticker stuck to the roof inside the cab.  
It indicates the starting procedure for the diesel engine.

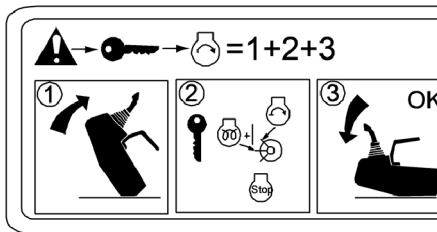

**Figure 1**

Document Title: <b>Caution sign - Lifting the machine</b>	Function Group: <b>000</b>	Information Type: <b>Service Information</b>	Date: <b>2017/7/7 0</b>
Profile: <b>EC35 Volvo</b>			

## Caution sign - Lifting the machine

Showing Selected Profile

Valid for serial numbers			
Model	Production site	Serial number start	Serial number stop
EC35 Volvo			

Sticker stuck to the roof inside the cab.

It indicates that only these specific lifting points must be used to lift the machine.



**Figure 1**



Document Title: <b>Caution sign - Lashing</b>	Function Group: <b>000</b>	Information Type: <b>Service Information</b>	Date: <b>2017/7/7 0</b>
Profile: <b>EC35 Volvo</b>			

## Caution sign - Lashing

Showing Selected Profile

Valid for serial numbers			
Model	Production site	Serial number start	Serial number stop
EC35 Volvo			

Sticker stuck to the roof inside the cab.  
It indicates that only these fastening points must be used.

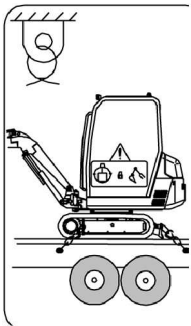

**Figure 1**

Document Title: <b>Caution sign - Emergency exit</b>	Function Group: <b>000</b>	Information Type: <b>Service Information</b>	Date: <b>2017/7/7 0</b>
Profile: <b>EC35 Volvo</b>			

## Caution sign - Emergency exit

Showing Selected Profile

Valid for serial numbers			
Model	Production site	Serial number start	Serial number stop
EC35 Volvo			

Sticker stuck to the rear windscreen of the cabin indicating the location of the emergency exit (the window must be smashed with the hammer provided for this purpose and stored inside a support on the rear cabin wall).



Figure 1

Document Title: <b>Machine identification</b>	Function Group: <b>000</b>	Information Type: <b>Service Information</b>	Date: <b>2017/7/7 0</b>
Profile: <b>EC35 Volvo</b>			

## Machine identification

Showing Selected Profile

Valid for serial numbers			
Model	Production site	Serial number start	Serial number stop
EC35 Volvo			

The following illustration and description shows which identification plates are on the machine.

When ordering spare parts or in case of enquiries by phone or in writing the model designation and the product identification number (PIN) must always be specified.

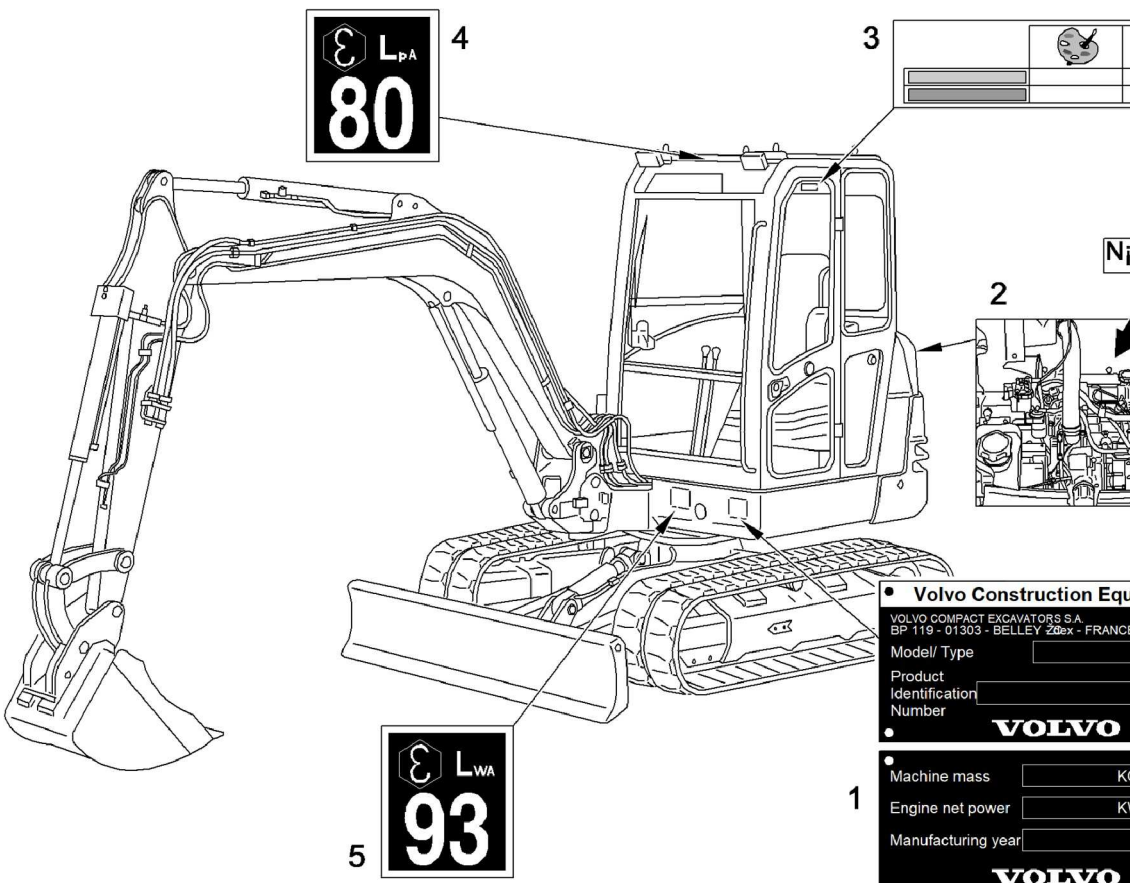

**Figure 1**  
**Machine identification**

1. Product plate with product identification number (PIN) for the complete machine, model designation, weight of machine, engine power and year of manufacture. The plate is located on the front of the rotating chassis.
2. The identification of the engine is inscribed on the rocker cover.
3. Paint finish, cabin type, type approval and serial number can be found on the rear roof beam of the cabin.
4. Sound pressure level in the cabin
5. Sound capacity of nthe machine

Document Title: <b>Identification of the engine EC 35, EC 45</b>	Function Group: <b>000</b>	Information Type: <b>Service Information</b>	Date: <b>2017/7/7 0</b>
Profile: <b>EC35 Volvo</b>			

## Identification of the engine EC 35, EC 45

Showing Selected Profile

Valid for serial numbers			
Model	Production site	Serial number start	Serial number stop
EC35 Volvo			

The identification of the engine is stamped on the right hand side of the engine block near the injection pump mounting bracket.

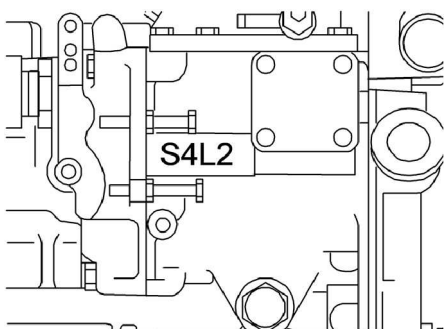

**Figure 1**

The serial number is stamped on the engine block near the injection pump mounting bracket.

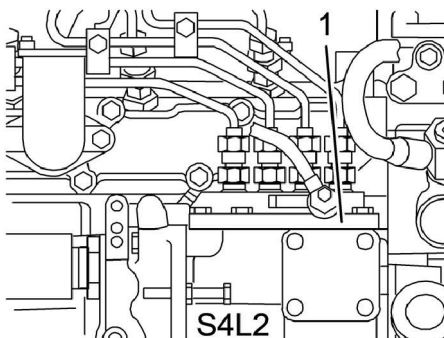

**Figure 2**

Document Title: <b>Identification of the engine, from serial nr. EC 35: #283 18 963, EC 45: 284 17 799</b>	Function Group: <b>000</b>	Information Type: <b>Service Information</b>	Date: <b>2017/7/7 0</b>
Profile: <b>EC35 Volvo</b>			

## Identification of the engine, from serial nr. EC 35: #283 18 963, EC 45: 284 17 799

Showing Selected Profile

Valid for serial numbers			
Model	Production site	Serial number start	Serial number stop
EC35 Volvo			

The identification of the engine is stamped on the engine name plate, on the top of the rocker arm cover.

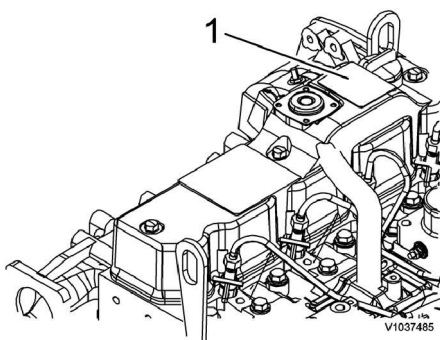

**Figure 1**  
**Engine, identification**

1. Engine name plate

Document Title: <b>Main dimensions EC 35</b>	Function Group: <b>030</b>	Information Type: <b>Service Information</b>	Date: <b>2017/7/7 0</b>
Profile: <b>EC35 Volvo</b>			

## Main dimensions EC 35

Showing Selected Profile

Valid for serial numbers			
Model	Production site	Serial number start	Serial number stop
EC35 Volvo			

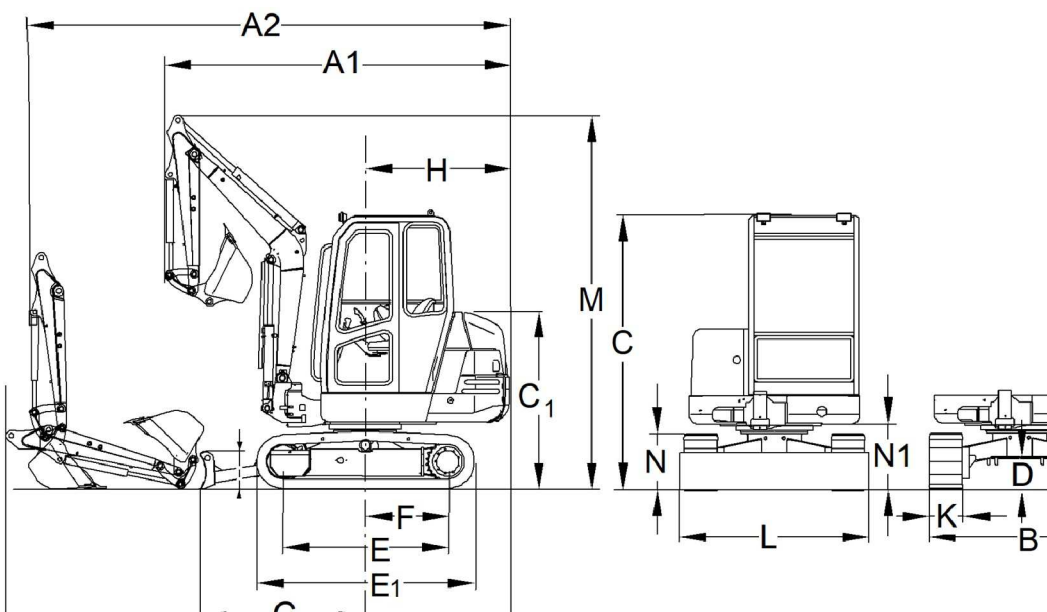

**Figure 1**  
**Dimensions of the machine**

Type				EC35	
		Symbol	Unit	Arm: 1400	Arm: 1700
Overall height	Dozer blade	I	mm	370	370
	Boom	M	mm	3690	3690
	Driver's cabin	C	mm	2490	2490
	Engine cover	C1	mm	1550	1550
Ground clearance	Lower frame	D	mm	290	290
	Superstructure	N1	mm	600	600
Overall length		A	mm	5025	5055
Distance between chain sprockets		E	mm	1600	1600
Overall width	Boom raised	A1	mm	3400	3430
	Boom on Bucket	A2	mm	4750	4590
	Rotation point end of cabin	H	mm	1360	1360

Type	<b>EC35</b>
------	-------------

		<b>Symbol</b>	<b>Unit</b>	<b>Arm: 1400</b>	<b>Arm: 1700</b>
Lower frame	Width of bottom plate	K	mm	300	300
	Width of dozer blade	L	mm	1650	1650
	Overall width	B	mm	1620	1620
	Length of track	E1	mm	2070	2070
	Width of bottom plate	N	mm	510	510
	Rotation point - dozer blade	G	mm	1620	1620
	Rotation point - centre of sprocket	F	mm	800	800

Document Title: <b>Load capacity tables EC 35</b>	Function Group: <b>030</b>	Information Type: <b>Service Information</b>	Date: <b>2017/7/7 0</b>
Profile: <b>EC35 Volvo</b>			

## Load capacity tables EC 35

Showing Selected Profile

Valid for serial numbers			
Model	Production site	Serial number start	Serial number stop
EC35 Volvo			

- Rated handling loads in kg, i.e. 75% of the tipping load or 87% of the hydraulic limit. (\* = hydraulic limit)  
These loads apply for the complete height concerned (Z.), for the specified reach. Increase by 3% for steel tracks, except the values marked with \* (hydraulic limits).

### The specified values are valid for a machine:

- without attachment and without quick coupling.  
If handling is accomplished in lifting gear operation with an assembled tool and/or assembled standard connecting system, the weight of these attachments must be subtracted from the values stated in the table.
- On level, compact ground.
- With full rotation of the superstructure.
- On rubber tracks.  
Equipment parallel to the axis of the superstructure.
- With a 75 kg driver in the cab.

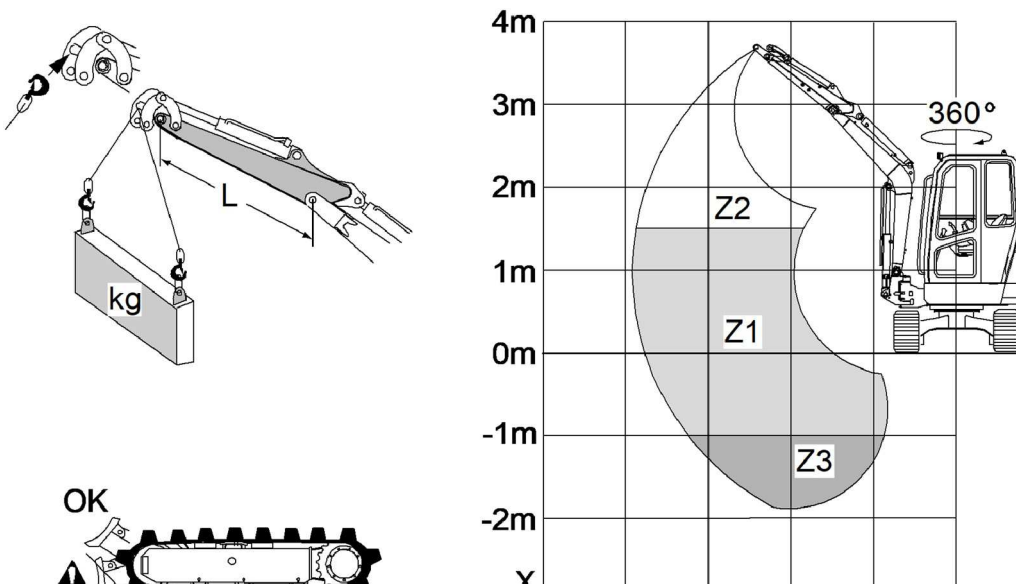

Figure 1











Document Title: <b>Load capacity tables EC 35</b>	Function Group: <b>030</b>	Information Type: <b>Service Information</b>	Date: <b>2017/7/7 0</b>
Profile: <b>EC35 Volvo</b>			

## Load capacity tables EC 35

Showing Selected Profile

Valid for serial numbers			
Model	Production site	Serial number start	Serial number stop
EC35 Volvo			

		 E250611A	 E250611A	 E250611A	 E250611A	 E250611A	 E250611A	 E250611A	 E250611A
X(m)	>	1,5	2	2,5	3	3,5	4	4,5	4,8
L: 1,4 m	Z2			955	720	570	465		
	Z1	1555*	1190	845	655	530	445	380	
	Z3	2040*	1215	855	660	535			
L: 1,7 m	Z2				730	575	465	385	
	Z1	1395*	1175	835	645	520	435	370	340
	Z3	1945*	1190	840	645	520	435		

(\*) hydraulic limit

- Rated handling loads in kg, i.e. 75 % of the tipping load or 87 % of the hydraulic limit (\* = hydraulic limit). These loads apply for the complete height concerned (Z.), for the specified reach. Increase by 3 % for steel tracks, except the values marked with \* (hydraulic limits).

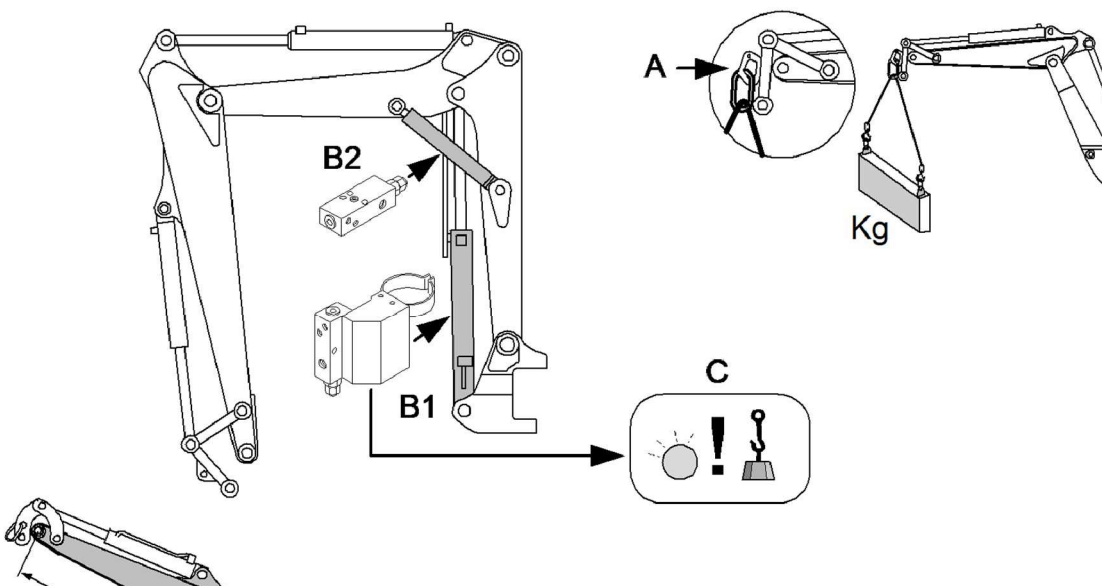
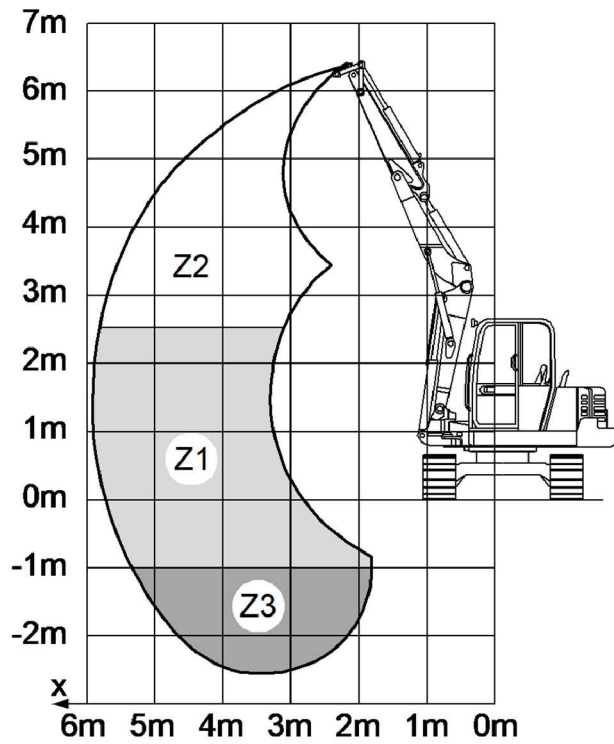

**Figure 1**

The machine used in lifting gear operation must be equipped as follows:

- load lifting equipment (A).
- a safety valve on boom (B1) and boom tip cylinders (B2).
- a load safety device (C).
- a table stating the nominal loads for lifting gear operation ( ) inside the operator's stand. Kit with 'safety devices', which is available under "accessories".

Document Title: <b>Reach of the working attachment EC 35</b>	Function Group: <b>030</b>	Information Type: <b>Service Information</b>	Date: <b>2017/7/7 0</b>
Profile: <b>EC35 Volvo</b>			

## Reach of the working attachment EC 35

Showing Selected Profile

Valid for serial numbers			
Model	Production site	Serial number start	Serial number stop
EC35 Volvo			

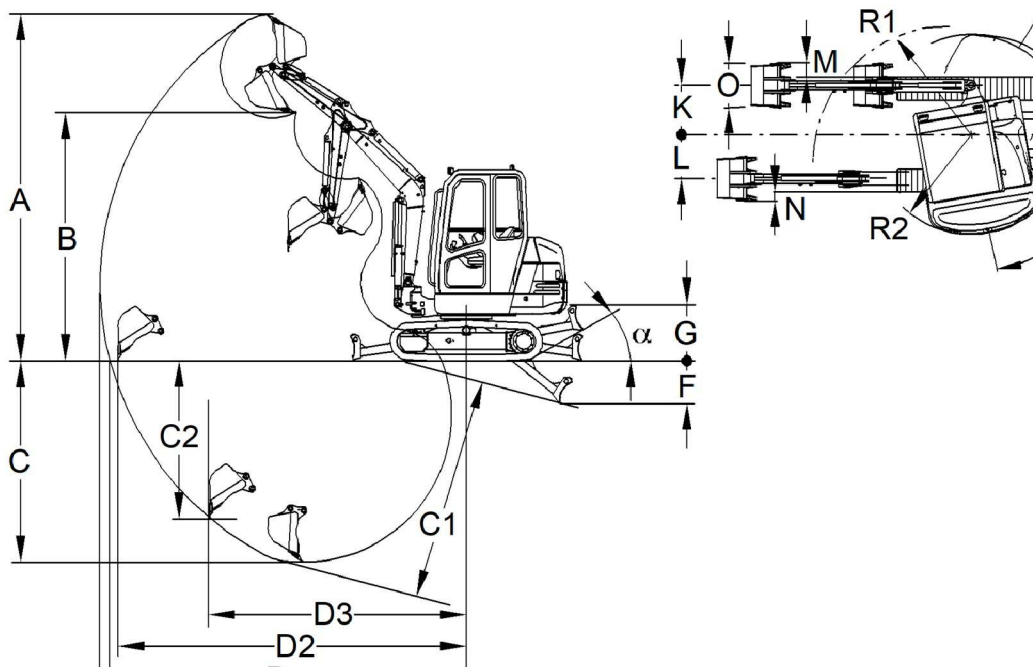

**Figure 1**  
**Bucket configuration**

Document Title: <b>Reach EC 35</b>	Function Group: <b>030</b>	Information Type: <b>Service Information</b>	Date: <b>2017/7/7 0</b>
Profile: <b>EC35 Volvo</b>			

## Reach EC 35

Showing Selected Profile

Valid for serial numbers			
Model	Production site	Serial number start	Serial number stop
EC35 Volvo			

Type	EC35		
Excavator equipment	Unit	Arm: 1400	Arm: 1700
A..	mm	4840	5020
B..	mm	3530	3720
C..	mm	3170	3470
C1	mm	3420	3710
C2	mm	2200	2500
D..	mm	5130	5420
D1	mm	5240	5530
D2	mm	5090	5380
D3	mm	3800	3900
F..	mm	510	510
G..	mm	710	710
G1	mm	390	390
J..	mm	1650	1650
K..	mm	700	700

### Reach

Type	EC35		
Excavator equipment	Unit	Arm: 1400	Arm: 1700
L..	mm	500	500
M..	mm	190	190
N..	mm	10	10
O..	mm	600	600
R1	mm	1575	1600
R2	mm	1380	1380









### Slewing range

Type	EC35	
Boom offset angle	a1 = 55°	a2 = 75°
Total slewing range	360°	

### Bucket performances

**Please Click Here To Download The Complete Manual**  
**Download Other Manuals**  
**If Having Any Questions Feel Free To Contact us**

**[admin@servicemanualbit.com](mailto:admin@servicemanualbit.com)**

- 
-  0 General
  -  1 Standard Parts , Service
  -  2 Engine with Mounting and Equipment
  -  3 Elec. System, Warning System, Information System, Instruments
  -  4 Power Transmission
  -  7 Frame and Track Unit
  -  8 Machinery House, Cab, Exterior Trim Parts Anywhere
  -  9 Hydraulic System, Digging, Handling, Grading Equipment, Misc Equipment