

Document Title: Main dimensions	Function Group: 000	Information Type: Service Information	Date: 2017/7/7 0
Profile:			

Main dimensions

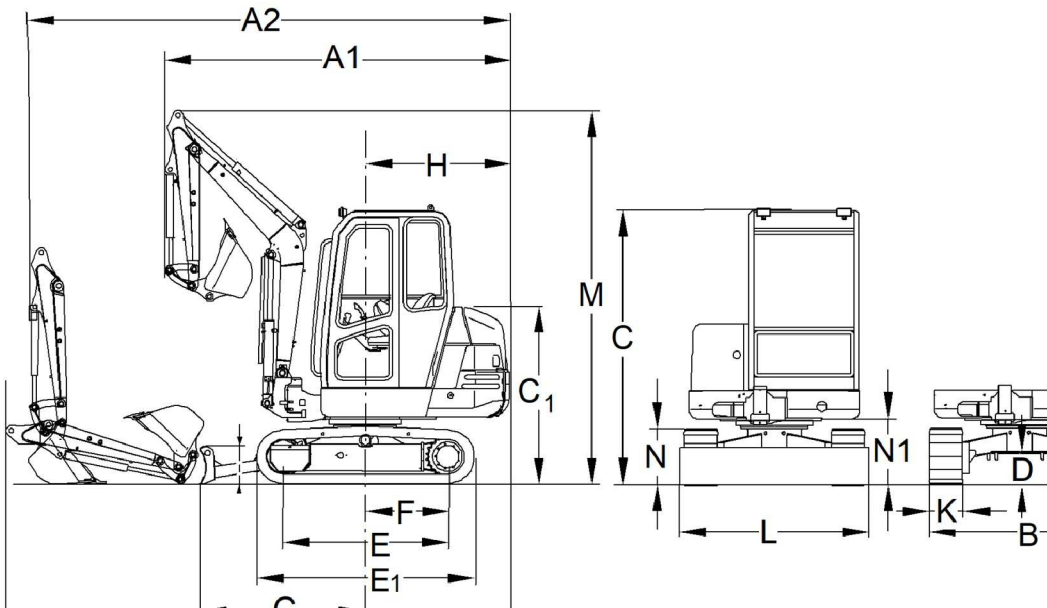

Figure 1
Dimensions of the machine

		Symbol	Unit	Arm: 1200	Arm: 1500
Overall height	Dozer blade	I	mm	340	340
	Boom	M	mm	3290	3290
	Driver's cabin	C	mm	2450	2450
	Engine cover	C1	mm	1550	1550
Ground clearance	Lower frame	D	mm	280	280
	Superstructure	N1	mm	570	570
Overall length		A	mm	4470	4470
Distance between chain sprockets		E	mm	1440	1440
Overall width	Boom raised	A1	mm	3100	3100
	Boom on bucket	A2	mm	4210	4210
	Rotation point end of cabin	H	mm	1260	1260

		Symbol	Unit	Arm: 1200	Arm: 1500
Lower frame	Width of bottom plate	K	mm	300	300
	Width of dozer blade	L	mm	1530	1530
	Overall width	B	mm	1480	1480
	Length of track	E1	mm	1910	1910

Width of bottom plate	N	mm	510	510
Rotation point - dozer blade	G	mm	1440	1440
Rotation point - centre of sprocket	F	mm	720	720

Document Title: Position of components	Function Group: 000	Information Type: Service Information	Date: 2017/7/7 0
Profile:			

Position of components

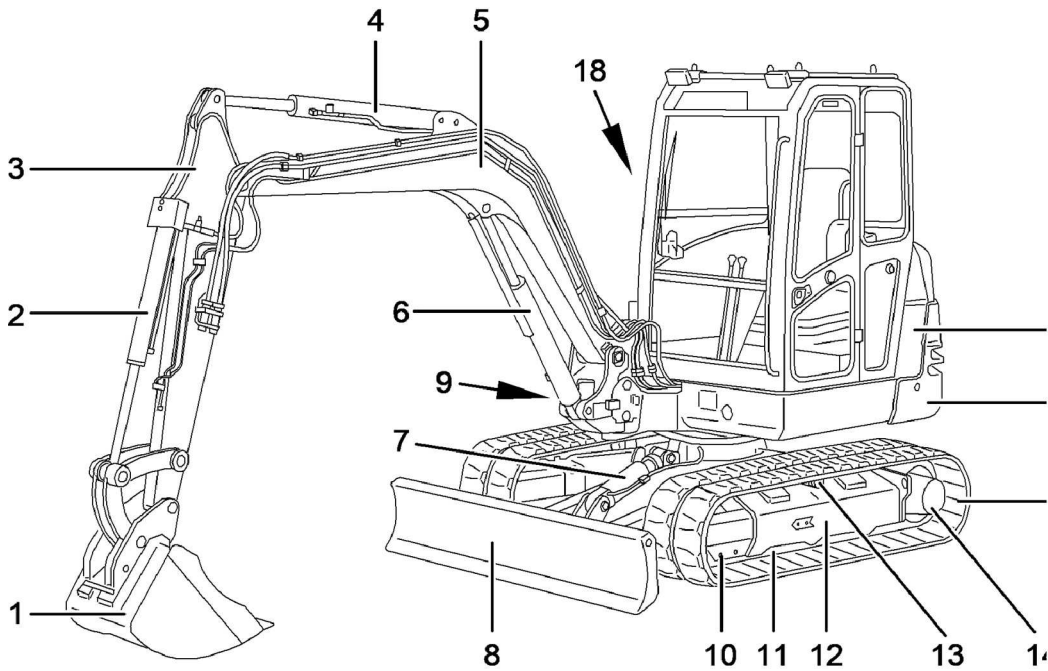

Figure 1
Position of components

- | | |
|----------------------------|---------------------------------------|
| 1 Bucket | 10 Tensioning wheel |
| 2 Bucket cylinder | 11 Rollers |
| 3 Dipper, standard version | 12 Main chassis |
| 4 Dipper cylinder | 13 Top roller |
| 5 Boom | 14 Track sprockets/travel gear motors |
| 6 Boom cylinder | 15 Tracks |
| 7 Dozer blade cylinder | 16 Slewing superstructure |
| 8 Dozer blade | 17 Engine cover |
| 9 Boom offset cylinder | 18 Hydraulic compartment cover |

Document Title: Caution sign - Diesel engine starting procedure	Function Group: 020	Information Type: Service Information	Date: 2017/7/7 0
Profile:			

Caution sign - Diesel engine starting procedure

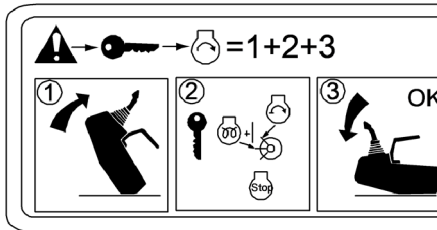

Figure 1

Sticker stuck to the cabin roof inside the cab.
It indicates the starting procedure for the diesel engine.

Document Title: Caution sign - Emergency exit	Function Group: 020	Information Type: Service Information	Date: 2017/7/7 0
Profile:			

Caution sign - Emergency exit

Sticker stuck to the rear windscreen of the cabin indicating the location of the emergency exit (the window must be smashed with the hammer provided for this purpose and stored inside a support on the rear cabin wall).

Document Title: Caution sign - Lashing	Function Group: 020	Information Type: Service Information	Date: 2017/7/7 0
Profile:			

Caution sign - Lashing

Sticker stuck to the cabin roof inside the cab.
It indicates that only these fastening points must be used.



Figure 1

Document Title: Caution sign - Lifting the machine	Function Group: 020	Information Type: Service Information	Date: 2017/7/7 0
Profile:			

Caution sign - Lifting the machine

Sticker stuck to the cabin roof inside the cab.

It indicates that only these specific lifting points must be used to lift the machine.

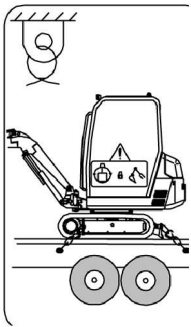

Figure 1

Document Title: Caution sign - Operation and maintenance	Function Group: 020	Information Type: Service Information	Date: 2017/7/7 0
Profile:			

Caution sign - Operation and maintenance

Before starting operation of the machine read the instructions and warnings in the operating instructions carefully. The technical documents can be found storage compartment under the driver's seat.

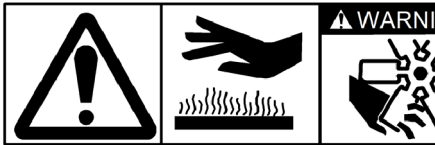

Figure 1

Document Title: Caution sign - Track tension	Function Group: 020	Information Type: Service Information	Date: 2017/7/7 0
Profile:			

Caution sign - Track tension

Sticker stuck to the cabin roof inside the cab.

It indicates that the tension of the tracks must be checked every day.

Document Title: Identification of the engine	Function Group: 020	Information Type: Service Information	Date: 2017/7/7 0
Profile:			

Identification of the engine

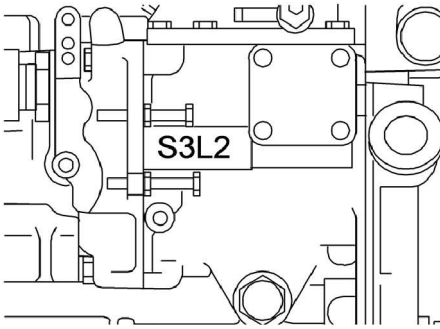

Figure 1

The identification of the engine is stamped on the right hand side of the engine block near the injection pump mounting bracket.

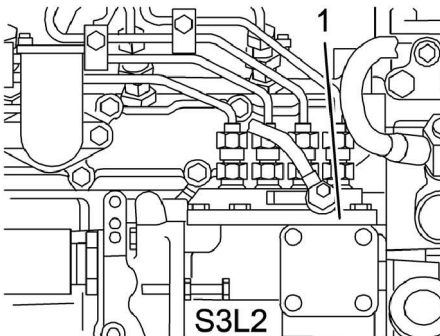









Figure 2

1. Serial number

The serial number is stamped on the engine block near the injection pump mounting bracket.

Document Title: Load capacity tables	Function Group: 020	Information Type: Service Information	Date: 2017/7/7 0
Profile:			

Load capacity tables

			 E260641A	 E260641A	 E260641A	 E260641A	 E260641A	 E260641A	 E260641A	 E260641A
	X(m)	>	1.5	2	2.5	3	3.5	3.9	4	4.2
A	L: 1.2 m	Z2		975	710*	540	430			
		Z1	1470	905	655	515	420	360		
		Z3	1490	925	665	520				
	L: 1.5 m	Z2		885*	710	470*	430		350	
		Z1	1015*	900	650	505	410		345	325
		Z3	1465	910	655	510	415			
B	L: 1.2 m	Z2		915	656	505	400			
		Z1	1380	850	615	480	390	335		
		Z3	1395	865	620	485				
	L: 1.5 m	Z2		885*	665	470*	400		330	
		Z1	1015*	845	610	470	385		320	300
		Z3	1375	850	610	475	390			
										[T1] ⓘ

[T1](*) hydraulic limit

- Rated handling loads in kg, i.e. 75 % of the tipping load or 87 % of the hydraulic limit (* = hydraulic limit). These loads apply for the complete height concerned (Z.), for the specified reach. Increase by 3 % for steel tracks, except the values marked with * (hydraulic limits).



Transport of objects in lifting gear operation is not permitted when the machine: – is supported by the dozer blade.

Document Title: Load capacity tables	Function Group: 020	Information Type: Service Information	Date: 2017/7/7 0
Profile:			

Load capacity tables

- Rated handling loads in kg, i.e. 75% of the tipping load or 87% of the hydraulic limit. (* = hydraulic limit)
These loads apply for the complete height concerned (Z.), for the specified reach. Increase by 3% for steel tracks, except the values marked with * (hydraulic limits).

! WARNING

Transport of objects in lifting tackle operation is not permitted when the machine is supported by the dozer blade.

The specified values are valid for a machine:

- without attachment and without quick coupling.
If handling is accomplished in lifting gear operation with an assembled tool and/or assembled standard connecting system, the weight of these attachments must be subtracted from the values stated in the table.
- On level, compact ground.
- With full rotation of the superstructure.
- On rubber tracks.
- Equipment parallel to the axis of the superstructure.
- With a 75 kg driver in the cab.

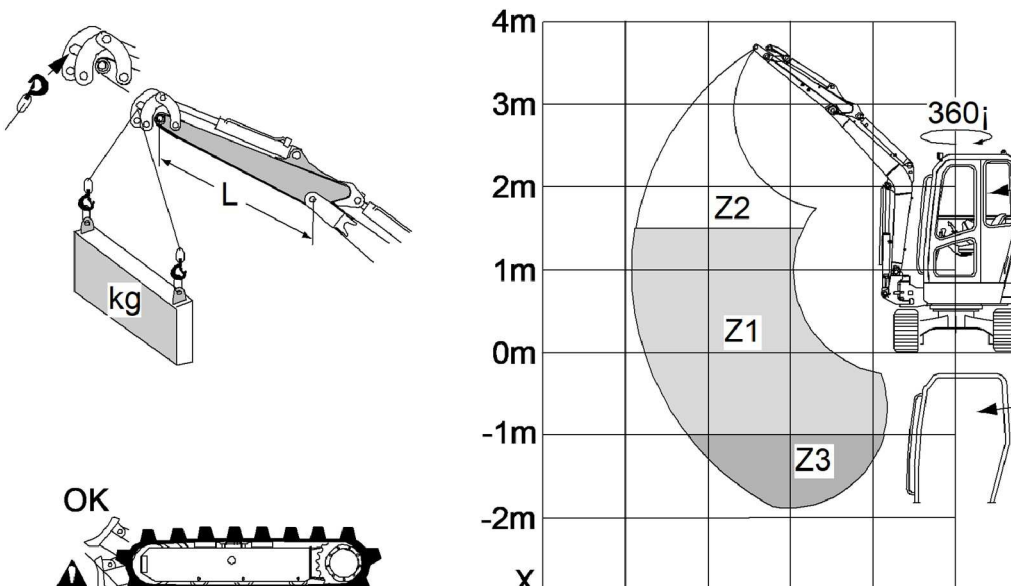

Figure 1

Document Title: Machine identification	Function Group: 020	Information Type: Service Information	Date: 2017/7/7 0
Profile:			

Machine identification

The following illustration and description shows which identification plates are on the machine.

When ordering spare parts or in case of enquiries by phone or in writing the model designation and the product identification number (PIN) must always be specified.

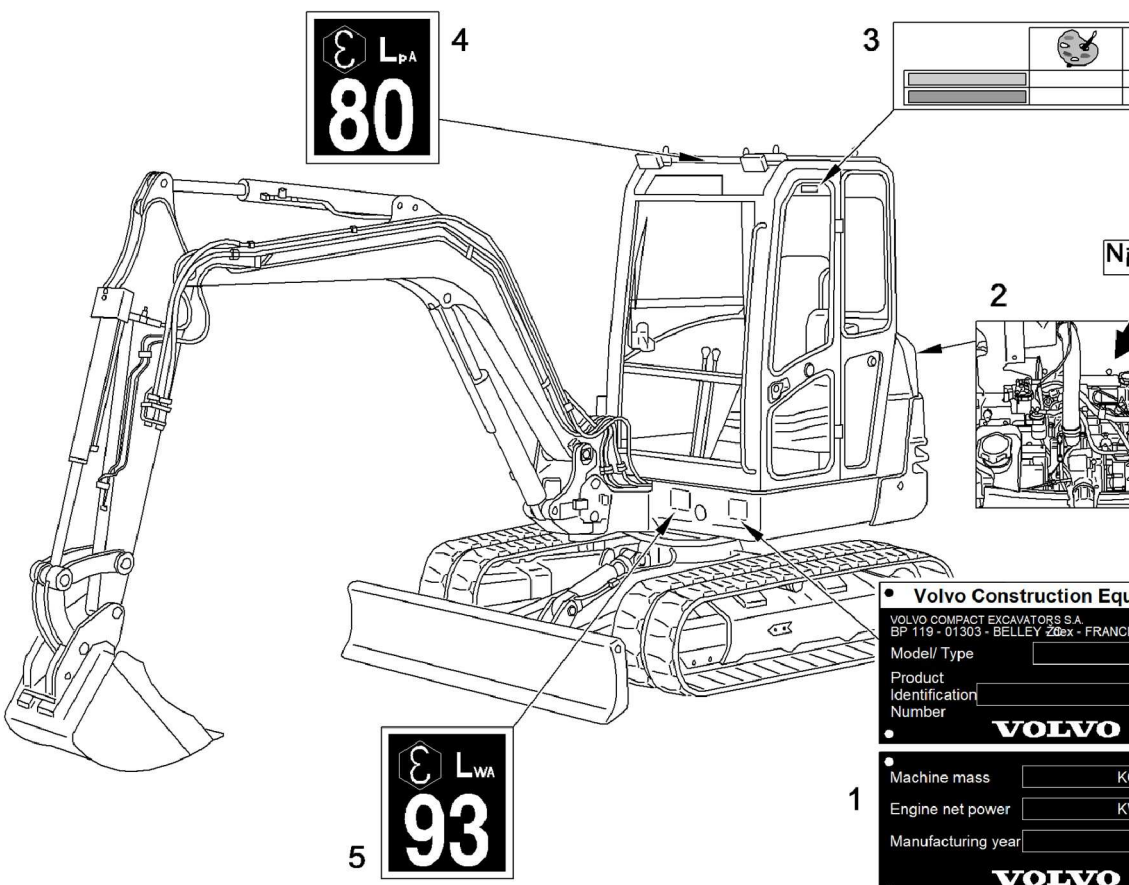

Figure 1
Machine identification

1. Product plate with product identification number (PIN) for the complete machine, model designation, weight of machine, engine power and year of manufacture. The plate is located on the front of the rotating chassis.
2. The identification of the engine is inscribed on the rocker cover.
3. Paint finish, cabin type, type approval and serial number can be found on the rear roof beam of the cabin.
4. Sound pressure level in the cabin.
5. Sound capacity of nthe machine

Document Title: Reach of the working attachment	Function Group: 020	Information Type: Service Information	Date: 2017/7/7 0
Profile:			

Reach of the working attachment

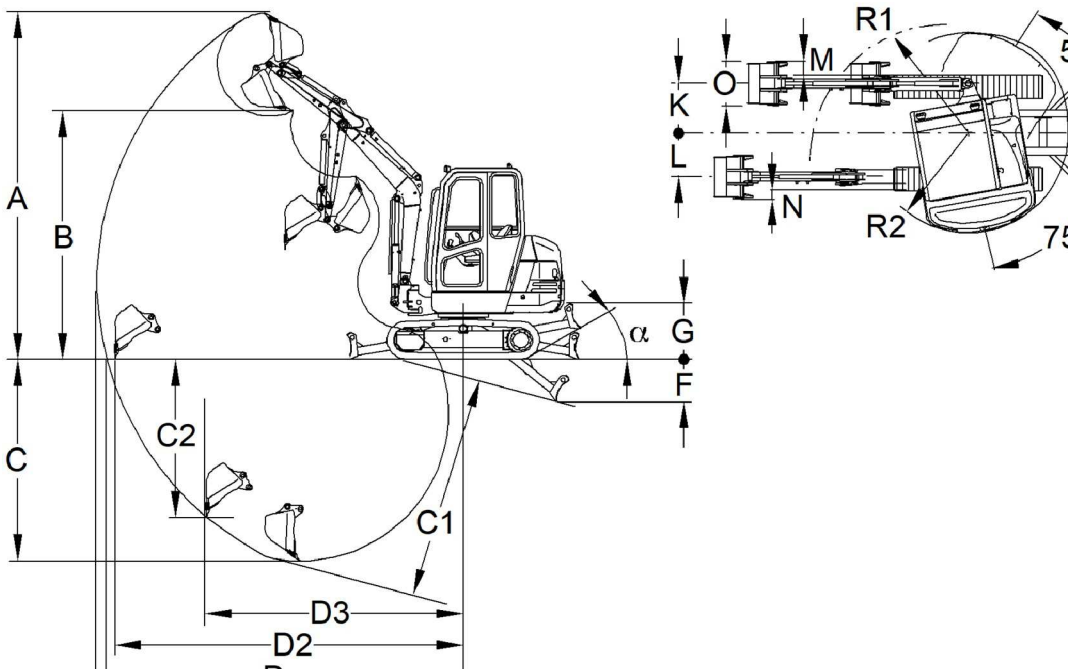

Figure 1
Bucket configuration

Document Title: Reach, unit: mm	Function Group: 020	Information Type: Service Information	Date: 2017/7/7 0
Profile:			

Reach, unit: mm

Excavator equipment	Arm: 1200	Arm: 1500
A..	4330	4420
B..	3130	3320
C..	2520	2820
C1	2840	3140
C2	2000	2290
D..	4460	4750
D1	4580	4870
D2	4430	4720
D3	3100	3170
F..	520	520
G..	700	700
G1	390	390
J..	1530	1530
K..	630	630

Reach, unit: mm

Excavator equipment	Arm: 1200	Arm: 1500
L..	450	445
M..	140	140
N..	40	40
O..	500	500
R1	1450	1450
R2	1270	1270

Slewing range

Boom offset angle	a1 = 55°	a2 = 75°
Total slewing range	360°	

Bucket performances

Digging force	2180 daN
Tear-out force	1490 daN

Document Title: Warning and information decals	Function Group: 020	Information Type: Service Information	Date: 2017/7/7 0
Profile:			

Warning and information decals

The driver must be acquainted with and observe all warning and information decals, which are attached to the machine.

- Stickers and decals, which are missing or have been damaged, must be immediately replaced.
- Apart from that the decals must be kept in a legible, i.e. clean condition.
- The spare parts number (ordering number) is printed on the respective decal or can be found in the spare parts catalogue.

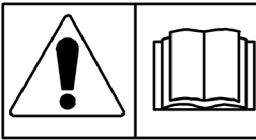

Figure 1

Document Title: Warning sign - Open engine hood only with engine stopped	Function Group: 020	Information Type: Service Information	Date: 2017/7/7 0
Profile:			

Warning sign - Open engine hood only with engine stopped

Due to the risk of injury by rotating parts it is dangerous to open the engine hood while the engine is running.

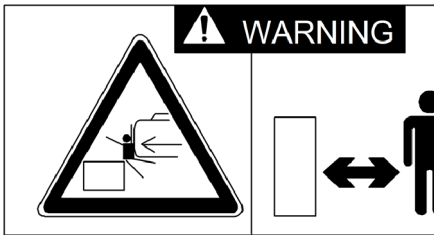

Figure 1

Document Title: Warning sign - Safety distance from the movement area	Function Group: 020	Information Type: Service Information	Date: 2017/7/7 0
Profile:			

Warning sign - Safety distance from the movement area

This sticker indicates that a sufficient distance to the movement area of the wheel loader arm must be maintained, to avoid bodily injury.

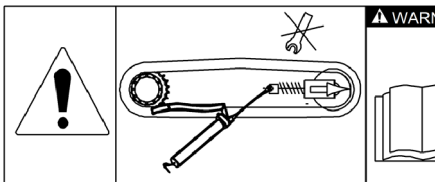

Figure 1

Document Title: Warning sign - Safety distance from the work area	Function Group: 020	Information Type: Service Information	Date: 2017/7/7 0
Profile:			

Warning sign - Safety distance from the work area

It indicates that a sufficient safety distance from the working area of the machine must be maintained, to avoid bodily injury.



Figure 1

Document Title: Chapter 2 Engine	Function Group: 030	Information Type: Service Information	Date: 2017/7/7 0
Profile:			

Chapter 2 Engine

Engine	S3L - 61A	S3L2 - 61
Type	Four stroke inline diesel engine, water cooled	
Firing sequence (injection sequence)	1 - 3 - 2	
Compression	22 : 1	
Type of combustion chamber	Swirl chamber	
Weight, kg	125	
Number of cylinders	3	
Bore x stroke, mm	78 x 78.5	78 x 92
Displacement, litres	1.125	1.318
Compression pressure	32 bar	
Max. permissible pressure deviation between cylinders	3 bar	
Idle speed	900 + 100 rpm	
Full speed	2400 + 20 rpm	
Installed net power (ISO 9249)	17.1 kW at 2200 rpm	
Maximum torque	77 kW at 1600 rpm	
Cooling	Centrifugal water pump with temperature control	
Air filter	Dry	

Valve system	
Valve clearance (warm or cold engine)	
Intake valve	0.25 mm
Exhaust valve	0.25 mm

Lubrication system	
Type	Forced feed (by cycloidal pump)
Oil pressure	3.45 ± 0.5 bar
Oil filter	Paper element (full-flow)

Fuel lift pump	
Type	Electrical (diaphragm)
Power at 220 °C and a terminal voltage of 12 V DC	300 cm ³ /min minimum or 400 cm ³ /min maximum

Chapter 2 Engine

Injection pump	
Type	Series injection pump
Manufacturer	Bosch M

Please Click Here To Download The Complete Manual
Download Other Manuals
If Having Any Questions Feel Free To Contact us

admin@servicemanualbit.com