

# **PARTS MANUAL**

---

## **YARDMASTER**

**HR45-25, HR45-31, HR45-40LS,  
HR45-40S, HR45-36L, HR45H  
(A227)**

CUSTOMER EDITION

---

# ***HYSTER***



**SECTIONS**

<b>1</b>	<b>FRAME</b>
<b>2</b>	<b>L/LS FRAME</b>
<b>3</b>	<b>SINGLE FIXED CABIN</b>
<b>4</b>	<b>SINGLE SLIDING CABIN</b>
<b>5</b>	<b>DEMARAIS CABIN</b>
<b>6</b>	<b>DENIZET CABIN</b>
<b>7</b>	<b>ENGINE(S)</b>
<b>8</b>	<b>ELECTRICAL SYSTEM</b>
<b>9</b>	<b>TRANSMISSION</b>
<b>10</b>	<b>DRIVE AXLE</b>
<b>11</b>	<b>STEERING SYSTEM</b>
<b>12</b>	<b>BRAKE SYSTEM</b>
<b>13</b>	<b>HYDRAULIC SYSTEM</b>
<b>14</b>	<b>BOOM</b>
<b>15</b>	<b>L/LS BOOM</b>
<b>16</b>	<b>WINCH</b>
<b>17</b>	<b>CONTAINER HANDLER B665</b>
<b>18</b>	<b>CONTAINER HANDLER A672</b>
<b>19</b>	<b>STABILIZER</b>

This Parts Manual is divided into 22 major sections which are listed above. Quick reference to these sections can be made by placing the right thumb on the tab of the desired section, bending the book back and thumbing the pages to the corresponding tab.



<b>20</b>	<b>LOAD MOMENT LIMITER</b>	
<b>21</b>	<b>OPTIONS</b>	
<b>22</b>	<b>NUMERICAL INDEX</b>	

This Parts Manual is divided into 22 major sections which are listed above. Quick reference to these sections can be made by placing the right thumb on the tab of the desired section, bending the book back and thumbing the pages to the corresponding tab.



**TABLE OF CONTENTS**

DESCRIPTION	PAGE
<b>A</b>	
ACCELERATOR CONTROL VALVE	
FIXED CABIN	
HR45-25, HR45-31, HR45-40S.....	7-18
SLIDING CAB	
HR45-36L, HR45-40LS .....	7-19
ACCUMULATOR	
HR45-25, HR45-31, HR45-40S .....	12-12
HR45-36L, HR45-40LS .....	12-14
AIR CONDITIONER	
WIDE CAB	
S/N A227J-1514⇒ .....	6-16
AIR CONDITIONING	
SINGLE FIXED AND MOVING CAB	
D/B 09/2001⇒.....	3-14
AIR FILTER.....	7-2
ALARM ASSEMBLY .....	8-21
AMPLIFIER	
SLIDING CAB .....	4-28
ANTI ROCKING CONTROL VALVE	
5H 8 FT. 6 IN.	
HR45-36L, HR45-40LS .....	15-30
HR45-25, HR45-31, HR45-40S .....	14-40
ANTI TIPPING SWITCH.....	11-4
<b>B</b>	
BASE ELECTRO VALVE .....	13-49
BATTERY.....	8-19
BOOM	
5H 8 FT. 6 IN. JIB SECTION P1-P2	
HR45-36L, HR45-40LS .....	15-6
8 FT. 6 IN. JIB SECTION P1-P2-P3	
HR45-25, HR45-31, HR45-40S.....	14-6
9 FT. 6 IN. JIB SECTION P1-P2-P3.....	14-4
BOOM CIRCUIT	
H45-36L, HR45-40LS .....	13-18
HR45-25, HR45-31, HR45-40S .....	13-16
BOOM EXTEND AND RETRACT VALVE.....	13-64
BOOM HEAD	
5H 8 FT. 6 IN.	
HR45-36L, HR45-40LS .....	15-8
HR45-25, HR45-31, HR45-40S .....	14-8
BOOM HOIST VALVE	
SHEET 1 OF 2.....	13-60
SHEET 2 OF 2.....	13-62
BOOM PIVOT BEARING	
5H 8 FT. 6 IN.	
HR45-36L, HR45-40LS .....	15-9
HR45-25, HR45-31, HR45-40S .....	14-9
BRAKE	
S/N A227J-1547⇒ .....	18-18
BRAKE CIRCUIT	

## TABLE OF CONTENTS (Continued)

DESCRIPTION	PAGE
<b>B (continued)</b>	
HR45-25, HR45-31, HR45-40S .....	12-2
HR45-36L, HR45-40LS .....	12-3
BRAKE CONTROL CIRCUIT	
SLIDING CAB .....	4-12
HR45-36L, HR45-40LS .....	12-24
BRAKE OIL RESERVOIR.....	12-16
BUMPERS	
B665.....	17-8
<b>C</b>	
CAB CONNECTING CIRCUIT	
SLIDING CAB .....	4-22
CAB DOOR	
LEFT HAND .....	1-8
RIGHT HAND.....	1-10
SLIDING GLASS	
LEFT HAND .....	5-8
RIGHT HAND .....	5-6
CAB RAILS	
SLIDING CAB .....	4-2
HR45-36L, HR45-40LS .....	2-6
CAB SUPPORT .....	6-12
DEMARAIS CABIN .....	5-5
FIXED .....	3-2
CABIN GLASS.....	3-6
WIDE CAB .....	5-11
CABIN GLASS AND WIPERS	
WIDE CAB	
S/N A227J-1514⇒ .....	6-14
CABLE AND DECALS	
HR45H .....	16-20
CABLE GUIDE	
HR45H .....	16-8
CABLE SUPPORT	
5H 8 FT. 6 IN.	
HR45-36L, HR45-40LS .....	15-10
BOOM 8 FT. 6 IN.	
HR45-25, HR45-31, HR45-40S.....	14-11
BOOM 9 FT. 6 IN.	
HR45-25, HR45-31, HR45-40S.....	14-10
CABLE WINDER .....	20-3
CHARGE PUMP AND REGULATOR .....	9-20
CHARGE PUMP FLANGE	
HR45-25, HR45-31, HR45-40S .....	9-27
CHASSIS BOX	
LEFT HAND	
HR45-25, HR45-31, HR45-40S.....	1-4
HR45-36L, HR45-40LS .....	2-4
CLUTCH	



**TABLE OF CONTENTS (Continued)**

DESCRIPTION	PAGE
<b>C (continued)</b>	
FORWARD.....	9-10
FOURTH SPEED.....	9-18
LOW SPEED.....	9-16
REVERSE AND 2ND SHAFT .....	9-14
THIRD SPEED.....	9-12
COLD CLIMATE KIT.....	21-36
CONSOLE.....	5-27 3-10
CONTROL BOX.....	18-47
CONTROL BOX MOUNTING .....	18-48
CONTROL CIRCUIT	
HR45H.....	16-2
CONTROL SWITCH	
HR45H.....	16-21
CONTROL SWITCHES.....	8-24
CONTROL VALVE ASSEMBLY .....	13-58
HR45H.....	16-18
CONTROL VALVE ATTACHING PARTS	
H45-36L, H45-40LS.....	13-40
HR45-25, HR45-31, HR45-40S .....	13-38
CONTROL VALVE RELIEF SECTION .....	13-68
CONTROLLER	
APC 100.....	8-18
CONVERTOR HOUSING ASSEMBLY .....	9-2
COOLING CIRCUIT DRIVE AXLE	
H45-36L, HR45-40LS.....	10-20
HR45-25, HR45-31, HR45-40S .....	10-18
COUNTERWEIGHT .....	1-3
CYLINDER POWER PILE SLOPE .....	18-62
<b>D</b>	
DAMPENING	
5H 8 FT. 6 IN.	
HR45-36L, HR45-40LS .....	15-20
HR45-25, HR45-31, HR45-40S .....	14-24
DAMPING CYLINDER	
5H 8 FT. 6 IN.	
HR45-36L, HR45-40LS .....	15-21
HR45-25, HR45-31, HR45-40S .....	14-25
DERRICKING	
5H 8 FT. 6 IN.	
HR45-36L, HR45-40LS .....	15-18
HR45-25, HR45-31, HR45-40S .....	14-22
DERRICKING CYLINDER	
5H 8 FT. 6 IN.	
HR45-36L, HR45-40LS .....	15-22
HR45-25, HR45-31, HR45-40S .....	14-26
DERRICKING CYLINDER CONNECTIONS	
H45-36L, HR45-40LS .....	15-16
DIFFERENTIAL AND PARK BRAKE	

## TABLE OF CONTENTS (Continued)

DESCRIPTION	PAGE
<b>D</b> (continued)	
S/N A227J-1501↔S/N A227J-1516 .....	10-2
S/N A227J-1517⇒ .....	10-6
DIRECTIONAL VALVE	
WITHOUT POWER PILE SLOPE .....	18-66
DISPLAY AND PRINTER .....	20-4
DOORS AND STORAGE COVERS	
WIDE CAB	
S/N A227J-1514⇒ .....	6-10
DRIVE AXLE AND END DRIVE	
S/N A227J-1501↔S/N A227J-1516 .....	10-10
S/N A227J-1517⇒ .....	10-12
DRIVE AXLE CONNECTIONS .....	10-14
DRIVE AXLE U-JOINT .....	10-15
H45-36L, HR45-40LS .....	10-16
DRIVE TIRE AND WHEEL	
18 X 25 BRIDESTONE	
HR45-36L, HR45-40LS .....	21-13
18 X 25 GOODYEAR	
HR45-25, HR45-31, HR45-40S .....	21-5
18 X 25 MICHELIN	
HR45-25, HR45-31, HR45-40S .....	21-7
18 X 25 PLAIN	
HR45-25, HR45-31, HR45-40S .....	21-11
18 X 33 BRIDESTONE	
HR45-36L, HR45-40LS .....	21-6
18 X 33 GOODYEAR	
HR45-36L, HR45-40LS	
S/N A227J-1538⇒ .....	21-9
18 X 33 MICHELIN	
HR45-36L, HR45-40LS .....	21-8
21 X 25 BRIDESTONE .....	21-4
21 X 25 GOOD YEAR .....	21-3
<b>E</b>	
ELECTRIC CONTROL VALVE	
ELECTRONIC INCHING .....	9-22
ELECTRICAL	
5H 8 FT. 6 IN.	
HR45-36L, HR45-40LS .....	15-28
HR45-25, HR45-31, HR45-40S .....	14-39
WIDE CAB	
S/N A227J-1514⇒ .....	6-28
ELECTRICAL SYSTEM	
POWER PILE SLOPE .....	17-28
WITHOUT POWER PILE SLOPE .....	17-26
END BEAMS .....	18-30
ENGINE COMPONENTS .....	7-8
ENGINE CONNECTIONS .....	7-7
ENGINE COOLING SYSTEM .....	7-12

**TABLE OF CONTENTS (Continued)**

DESCRIPTION	PAGE
<b>E (continued)</b>	
ENGINE MOUNTING .....	7-4
EXHAUST .....	7-3
EXTENSION CABLE SUPPORT .....	18-40
EXTENSION CYLINDER ASSEMBLY .....	17-22
<b>F</b>	
FAN MOTOR .....	7-16
FILTER BRAKE RETURN .....	12-21
FILTER PUMP CIRCUIT HR45-36L, HR45-40LS .....	9-28
FILTER TRANSMISSION OIL HR45-25, HR45-31, HR45-40S .....	9-26
FIREWALL PLATE .....	5-26 3-22
FITTINGS	
BOOM AND ATTACHMENT	
B665 .....	17-9
FLANGE	
INTERMEDIATE S/N A227J-1547⇒ .....	18-16
FLANGE COUPLING S/N A227J-1547⇒ .....	18-24
FLOOR PLATES AND COVERS .....	5-2
FIXED .....	3-4
SLIDING CAB	
WIDE S/N A227J--1514⇒ .....	6-6
WIDE FIXED CAB S/N A227J-1514⇒ .....	6-2
FRAME	
HR45-25, HR45-31, HR45-40S .....	1-2
HR45-36L, HR45-40LS .....	2-2
FUEL HEATER S/N A227J-1547⇒ .....	21-38
FUSE BOX .....	7-10
FUSE PLATE .....	8-22
<b>G</b>	
GEAR HOUSING S/N A227J-1547⇒ .....	18-14
GEAR SHAFT HOUSING S/N A227J-1547⇒ .....	18-22
GENERAL RETURN CIRCUIT HR45-25, HR45-31, HR45-40S .....	13-23
SLIDING CAB .....	4-14
HR45-36L, HR45-40LS .....	13-24

## TABLE OF CONTENTS (Continued)

DESCRIPTION	PAGE
<b>H</b>	
HOOD	
HR45-25, HR45-31, HR45-40S .....	1-6
HYDRAULIC CIRCUIT	
CEC .....	20-2
MAIN .....	18-50
ROTATOR.....	18-52
SIDE-SHIFT .....	18-58
TWISTLOCKS.....	18-56
HYDRAULIC CIRCUIT STABILIZER	
HR45-40LS .....	19-10
HR45-40S .....	19-11
HYDRAULIC CONTROL CIRCUIT	
HR45-40LS .....	19-2
HR45-40S .....	19-4
HYDRAULIC CONTROL VALVE	
HYDRAULIC INCHING .....	9-24
HYDRAULIC COOLING SYSTEM	
BRAKE OIL .....	13-53
HYDRAULIC OIL .....	13-52
SHEET 1 OF 2	
⇒S/N A227-1511 .....	13-4
SHEET 2 OF 2	
S/N A227-1512⇒ .....	13-6
HYDRAULIC FILTER.....	13-56
HYDRAULIC LIFTING JACK .....	21-34
HYDRAULIC MOTOR SUPPORT	
HR45-36L, HR45-40LS.....	2-12
HYDRAULIC PENDULAR CYLINDER	
WITH POWER PILE SLOPE .....	17-39
HYDRAULIC RADIATOR.....	13-8
HYDRAULIC STOP KIT	
B665	
OPTIONAL .....	17-4
HYDRAULIC SUPPLY CIRCUIT	
HR45-40LS .....	19-12
HR45-40S .....	19-13
HYDRAULIC SYSTEM	
PILE SLOPE .....	18-57
TELESCOPING .....	18-54
WITH POWER PILE SLOPE .....	17-32
WITHOUT POWER PILE SLOPE.....	17-30
HYDRAULIC TUBING	
5H 8 FT. 6 IN.	
HR45-36L, HR45-40LS .....	15-4
BOOM 8 FT. 6 IN.	
HR45-25, HR45-31, HR45-40S.....	14-36
BOOM 9 FT. 6 IN.	
HR45-25, HR45-31, HR45-40S.....	14-32
HYDRAULIC TUBING TELESCOPING	
BOOM 9 FT. 6 IN.	
HR45-25, HR45-31, HR45-40S.....	14-16

**TABLE OF CONTENTS (Continued)**

DESCRIPTION	PAGE
<b>H (continued)</b>	
HYDRAULIC VALVE	
5H 8 FT. 6 IN.	
HR45-36L, HR45-40LS .....	15-32
HR45-25, HR45-31, HR45-40S .....	14-42
<b>I</b>	
INSTRUMENT PANEL.....	8-14
WIDE CAB	
S/N A227J-1514⇒ .....	6-24
<b>J</b>	
JUNCTION BLOCK	
BOOM AND ATTACHMENT.....	13-48
JOYSTICK.....	13-46
<b>L</b>	
LABELS.....	1-14
LEAK OIL CIRCUIT	
HR45-25, HR45-31, HR45-40S .....	13-26
HR45-36L, HR45-40LS.....	13-28
SLIDING CAB .....	4-16
LIGHTS	
5H 8 FT. 6 IN.	
HR45-36L, HR45-40LS .....	15-35
HR45-25, HR45-31, HR45-40S .....	14-48-10
HR45-36L, HR45-40LS.....	8-12
LIMIT SWITCH	
27 DEGREES	
HR45-31, HR45-40S .....	1-16
HR45-25, HR45-31, HR45-40S .....	1-12
HR45-36L, HR45-40LS.....	2-14
SLIDING CAB .....	4-26
LIMIT SWITCH MOUNTING	
HR45-40LS .....	19-14
HR45-40S.....	19-16
LOAD SENSING CIRCUIT	
HR45-25, HR45-31, HR45-40S .....	13-32
HR45-36L, HR45-40LS.....	13-33
SLIDING CAB .....	4-20
LOAD SENSING SWITCH .....	13-45
LOWER LIMIT SWITCH	
HR45H .....	16-16
<b>M</b>	
MAIN PUMP .....	13-71
MAIN PUMP ATTACHING PARTS.....	13-42
MAIN PUMP CIRCUIT.....	13-9
MAIN PUMP CONTROL VALVE.....	13-70
MAIN VALVE	

## TABLE OF CONTENTS (Continued)

DESCRIPTION	PAGE
<b>M</b> (continued)	
SPREADER TYPE.....	17-16
MAINFRAME	
B665.....	17-2
<b>O</b>	
OIL COOLER SOLENOID VALVE.....	13-54
OIL RETURN MANIFOLD .....	13-14
<b>P</b>	
PARK BRAKE	
⇒S/N A227J-1526.....	12-8
S/N A227J-1527⇒.....	12-10
PARK BRAKE CIRCUIT	
SLIDING CAB	
HR45-36L, HR45-40LS .....	12-22
OPTION.....	4-11
PARK BRAKE CONTROL VALVE	
HR45-36L, HR45-40LS.....	12-20
SLIDING CAB.....	4-34
PARK BRAKE SOLENOID VALVE .....	12-17-30
PEDAL ARRANGEMENT .....	3-16
FIXED CAB	
HR45-25, HR45-31, HR45-40S.....	5-22
SLIDING CAB	
HR45-36L, HR45-40LS .....	5-24
WIDE	
S/N A227J-1514⇒.....	6-22
WIDE FIXED CAB	
S/N A227J-1514⇒ .....	6-20
PILOT CIRCUIT	
HR45-25, HR45-31, HR45-40S .....	13-21
HR45-36L, HR45-40LS.....	13-22
SLIDING CAB .....	4-18
PILOT LINES	
SLIDING CAB	
HR45-36L, HR45-40LS .....	13-34
PRESSURE SWITCH	
H45-36L, HR45-40LS .....	13-20
PULLEY BLOCK	
HR45H .....	16-6
PUMP DRIVE AND SHAFT.....	9-6
PUMP DRIVE SHAFT .....	13-44
<b>R</b>	
RADIATOR	
S/N A227J-1501↔S/N A227J-1511 .....	7-14
S/N A227J-1512⇒.....	7-15
REDUCER	
S/N A227J-1547⇒.....	18-20

**TABLE OF CONTENTS (Continued)**

DESCRIPTION	PAGE
<b>R (continued)</b>	
RELAY	
IC 5 .....	8-26
RELAY AND PRINTED CIRCUIT	
IC 4, IC 2 .....	8-27
RESERVOIRS .....	5-30 3-24
ROOF COWLING .....	8-16
ROTATION VALVE ASSEMBLY	
DUAL SPEED .....	17-14
ROTATOR ASSEMBLY	
⇒S/N A227J-1546 .....	18-4
S/N A227J-1547⇒ .....	18-6
WITH POWER PILE SLOPE .....	17-20
WITHOUT POWER PILE SLOPE .....	17-18
ROTATOR BRAKE RELEASE VALVE .....	18-61
ROTATOR FRAME .....	18-3
ROTATOR MOTOR AND TRANSMISSION ASSEMBLY	
B665 .....	17-10
ROTATOR MOTOR TRANSMISSION	
⇒S/N A227J-1546 .....	18-8
S/N A227J-1547⇒ .....	18-12
ROTATOR VALVE .....	18-60
ROTATOR VALVE ASSEMBLY	
WITH POWER PILE SLOPE .....	17-40
<b>S</b>	
SEAT .....	6:13 3-18
DEMARAIS CABIN .....	5-10
SERVICE BRAKE	
OIL COOLED BRAKE	
⇒S/N A227J-1526 .....	12-4
S/N A227J-1527⇒ .....	12-6
SERVICE BRAKE CONTROL VALVE	
HR45-36L, HR45-40LS .....	12-19
SLIDING CAB .....	4-32
SIDE-SHIFT CABLE SUPPORT	
⇒S/N A227J-1546 .....	18-41
S/N A227J-1547⇒ .....	18-42
SIDE-SHIFT CYLINDER .....	18-59-12
SIDE-SHIFT CYLINDER VALVE .....	18-68
SLIDING BLOCKS	
5H 8 FT. 6 IN.	
HR45-36L, HR45-40LS	
⇒S/N A227J-1546 .....	15-24
S/N A227J-1547⇒ .....	15-26
HR45-25, HR45-31, HR45-40S	
⇒S/N A227J-1546 .....	14-28
S/N A227J-1547⇒ .....	14-30
SLIDING CAB CIRCUIT	
HR45-36L, HR45-40LS .....	13-36

## TABLE OF CONTENTS (Continued)

DESCRIPTION	PAGE
<b>S</b> (continued)	
SLIDING FRAME.....	4-4
HR45-36L, HR45-40LS.....	2-10
SOLENOID VALVE	
SLIDING CAB.....	13-51-29
SOLENOID VALVE BANK	
HR45-40LS.....	19-6
HR45-40S.....	19-8
SOLENOID VALVE GROUP	
HR45H.....	16-17
SOUND REDUCTION.....	21-32
SPEED CONTROL.....	7-11
SPREADER CONTROL VALVE.....	18-64
SPREADER FRAME	
WITH POWER PILE SLOPE.....	18-28
WITHOUT POWER PILE SLOPE.....	18-29
SPREADER LIGHTS.....	18-46
SPREADER VALVE.....	13-66
STABILIZER CYLINDER.....	19-18
STABILIZER MOUNTING.....	19-17
STEER AXLE	
HR45-25.....	11-10
HR45-31, HR45-36L, HR45-40LS, HR45-40S.....	11-12
STEER AXLE ASSEMBLY	
HR45-25.....	11-6
HR45-31, HR45-36L, HR45-40LS, HR45-40S.....	11-8
STEER TIRE AND WHEEL	
18 X 25 BRIDGESTONE	
HR45-25, HR45-31, HR45-40S	
S/N A227J-1538⇒.....	21-30
18 X 25 BRIDGESTONE	
HR45-25, HR45-31, HR45-40S	
⇒S/N A227J-1537.....	21-29
18 X 25 GOOD YEAR	
HR45-25, HR45-31, HR45-40S	
⇒S/N A227J-1537.....	21-18
S/N A227J-1538⇒.....	21-19
18 X 25 LISSE	
S/N A227J-1538⇒.....	21-28
18 X 25 MICHELIN	
HR45-24, HR45-31, HR45-40S	
S/N A227J-1538⇒.....	21-23
HR45-25, HR45-31, HR45-40S	
⇒S/N A227J-1537.....	21-22
18 X 25 PLAIN	
HR45-25, HR45-31, HR45-40S.....	21-27
18 X 33 BRIDGESTONE	
HR45-36L, HR45-40LS	
S/N A227J-1538⇒.....	21-21
18 X 33 BRIDGESTONE	
HR45-36L, HR45-40LS	



**TABLE OF CONTENTS (Continued)**

DESCRIPTION	PAGE
<b>S (continued)</b>	
⇒S/N A227J-1537.....	21-20
18 X 33 GOODYEAR HR45-36L, HR45-40LS S/N A227J-1538⇒.....	21-26
18 X 33 MICHELIN HR45-36L, HR45-40LS ⇒S/N A227J-1537.....	21-24
S/N A227J-1538⇒.....	21-25
21 X 25 BRIDGESTONE ⇒S/N A227J-1537.....	21-16
S/N A227J-1538⇒.....	21-17
21 X 25 GOOD YEAR ⇒S/N A227J-1537.....	21-14
S/N A227J-1538⇒.....	21-15
STEERING CIRCUIT H45-36L, HR45-40LS.....	13-12
HR45-25, HR45-31, HR45-40S.....	13-10
SLIDING CAB.....	4-24
STEERING COLUMN.....	11-2
STORAGE COVERS.....	5-4
D/B 09/2001⇒.....	3-20
⇒D/B 09/2001.....	3-19
SUPPORT SLIDING FRAME.....	4-6
HR45-36L, HR45-40LS.....	2-8
SUPPORT SLIDING MOTOR.....	4-8
<b>T</b>	
TELESCOPING 5H 8 FT. 6 IN. HR45-36L, HR45-40LS ⇒S/N A227J-1546.....	15-11
S/N A227J-1547⇒.....	15-12
BOOM 9 FT. 6 IN. HR45-25, HR45-31, HR45-40S ⇒S/N A227J-1546.....	14-12
S/N A227J-1547⇒.....	14-13
TELESCOPING CIRCUIT HR45-25, HR45-31, HR45-40S.....	13-30
HR45-36L, HR45-40LS.....	13-31
THROTTLE CONTROL VALVES.....	7-17
TOOL KIT.....	21-40
TORQUE CONVERTOR AND DRIVE PLATE.....	9-8
TRANSMISSION CASE AND REAR COVER.....	9-4
TRANSMISSION TELESCOPING MOTOR.....	18-32
TUBING TELESCOPIC CYLINDER 5H 8 FT. 6 IN. HR45-36L, HR45-40LS.....	15-14
BOOM 8 FT. 6 IN. HR45-24, HR45-31, HR45-40S	

## TABLE OF CONTENTS (Continued)

DESCRIPTION	PAGE
<b>T (continued)</b>	
S/N A227J-1547⇒	14-19
HR45-25, HR45-31, HR45-40S	14-21
⇒S/N A227J-1546	14-18
TWIST LOCK ARRANGEMENT	17-34
TWIST LOCK ASSEMBLY	18-37-36
TWIST LOCK CYLINDER	17-38
TWIST LOCK INDICATOR LIGHTS	
5H 8 FT. 6 IN.	
HR45-36L, HR45-40LS	15-34
HR45-25, HR45-31, HR45-40S	14-43
<b>V</b>	
VENTILATION	
SINGLE FIXED AND MOVING CAB	
⇒D/B 09/2001	3-12
SLIDING CAB	
HR45-36L, HR45-40LS	5-20
WIDE FIXED CAB	
HR45-25, HR45-31, HR45-40S	
⇒S/N A227J-1512	5-16
S/N A227J-1513⇒	5-18
<b>W</b>	
WEAR PADS	
B665	17-6
⇒S/N A227J-1546	18-34
S/N A227J-1547⇒	18-36
WINCH	
HR45H	16-12
WINCH ATTACHING PARTS	
HR45H	
⇒S/N A227J-1546	16-9
S/N A227J-1547⇒	16-10
WINCH CIRCUIT	
HR45H	16-4
WINCH REDUCTION GEAR	
HR45H	16-14
WINDSHIELD WIPERS	
FIXED CAB	
HR45-25, HR45-31, HR45-40S	5-12
SLIDING CAB	
HR45-36L, HR45-40LS	5-14
WIRE HARNESS	
CAB	
HR45-25, HR45-31, HR45-40S	8-4
ENGINE	8-6
MAIN	18-44
MAIN FRAME	
HR45-25, HR45-31, HR45-40S	8-2

---

**TABLE OF CONTENTS (Continued)**

---

<b>DESCRIPTION</b>	<b>PAGE</b>
<b>W</b> (continued)	
HR45-36L, HR45-40LS .....	8-3
SENSORS .....	18-45
SLIDING CAB .....	4-10
TRANSMISSION.....	8-8

**ABBREVIATIONS QUICK REFERENCE SHEET**

Listed below are abbreviations used in parts manuals to denote the following expressions:

<b>TERM</b>	<b>DEFINITION</b>	<b>TERM</b>	<b>DEFINITION</b>
Amp	Amperes	FRE	Freezer Environment
AR	As Required	in.	inches
BDI	Battery Discharge Indicators	LPG	Liquefied Petroleum Gas
BWI	Brush Wear Indicator	MAP	Manifold Absolute Pressure
CE	Communicator End	mm	millimeters
CRE	Corrosive Environment	MSTS	Microprocessor Spark Timing System
D/B	Date Break	NPT	National Pipe Threads
dbA	Decibel "A" Scale	O/S	Oversize
DE	Drive End	PTO	Power Take Off
ECH	Empty Container Handler	RPM	Revolutions per Minute
ECH-3	Empty Container Handler - 3 High Stacking	S/N	Serial Number
ECH-4	Empty Container Handler - 4 High Stacking	TMM	Truck Management Module
ECH-5	Empty Container Handler - 5 High Stacking	UL Type D	Diesel-Powered Safety Rating
ECH-6	Empty Container Handler - 6 High Stacking	UL Type DS	Diesel-Powered Safety Rating
ECH-7	Empty Container Handler - 7 High Stacking	UL Type E	Battery-Powered Safety Rating
ECM	Electronic Control Module	UL Type EE	Battery-Powered Safety Rating
ECN	Engineering Change Notice	UL Type ES	Battery-Powered Safety Rating
EEPROM	Electrically Erasable Programmable Read Only Memory	UL Type G	Gasoline-Powered Safety Rating
EPROM	Electrically Programmable Read Only Memory	UL Type GS	Gasoline-Powered Safety Rating
		UL Type LP	Gas-Powered Safety Rating
		UL Type LPS	LP Gas-Powered Safety Rating
		U/S	Undersize
		UL	Underwriters Laboratory
		V	Volts

## HOW TO USE THE ILLUSTRATED PARTS MANUAL

This parts manual describes and illustrates assemblies, subassemblies, and detail parts needed for service replacement.

The different constructions are indicated by keys and footnotes. The callouts correspond to descriptions found on the next page.

The image shows a composite of several pages from a Hyster parts manual, illustrating its layout and navigation. Callouts 1 through 10 point to specific features:

- 1:** Points to the 'SECTIONS' table in the lower-left page.
- 2:** Points to the 'MAST-TWO STAGE LIMITED SLIP' section in the 'SECTIONS' table.
- 3:** Points to the 'TABLE OF CONTENTS' page at the top.
- 4:** Points to the 'DESCRIPTION' and 'PAGE' columns in the 'TABLE OF CONTENTS'.
- 5:** Points to the 'SECTION 11 NUMERICAL INDEX' table.
- 6:** Points to the 'ITEM' column in the 'TRANSMISSION HOUSING' table.
- 7:** Points to the 'TRANSMISSION HOUSING' title and key.
- 8:** Points to the 'DESCRIPTION' column in the 'TRANSMISSION HOUSING' table.
- 9:** Points to the 'QTY' column in the 'TRANSMISSION HOUSING' table.
- 10:** Points to the 'KEY' section of the 'TRANSMISSION HOUSING' table.

**TABLE OF CONTENTS**

DESCRIPTION	PAGE
ACCELERATOR/MONOTROL PEDAL	5-2
BACKUP ALARM	
BATTERY CONNECTOR	
BATTERY ROLLER AN	
BRAKE ASSEMBLY	
BRAKE MASTER CYLIND	
BRAKE PEDAL LINKAGE	
CARRIAGE	
THREE STAGE FULL	
TWO STAGE FULL FR	
TWO STAGE LIMITED	
CONTROL VALVE	
COUNTERWEIGHT	
DASH DISPLAY	
DC-DC CONVERTER	

**SECTION 11 NUMERICAL INDEX**

PART NO.	PG	ITEM	PART NO.	PG	ITEM	PART NO.	PG	ITEM	PART NO.	PG	ITEM	
138	5-9	31	5-17	42	8	16481	6-25	3	16882	6-7	28	
139	5-9	32	7-13	8			6-25	4	16883	9-7	8	
12921	3-12	10	1-3	6			6-25	53	16883	6-25	5	
14269	5-5	8	15176	1-3	6		6-26	65	16982	7-5	25	
			1-4	45			10-3	16		8-5	24	
			5-9	16			6-26	48		9-5	19	
			5-13	23			6-11	3	16989	6-25	10	
			5-13	23			16484	6-11	9	17051	7-5	19
			5-13	23			6-11	9		8-5	13	
			5-13	23			6-13	101		9-5	13	
			5-13	23			34	6-25	7	17081	6-25	6
			5-13	23			10	6-25	8	17151	3-9	24
			5-13	23			11	6-25	11	17151	3-11	26
			5-13	23			21	6-25	20	17775	6-25	22
			5-13	23			27	9-7	7			

**TRANSMISSION HOUSING (S/N G160-2628)**

ITEM	PART NO.	DESCRIPTION	A	B	QTY
1	2022547	Transmission	1	1	1
2	2023329	Transmission	2	2	2
3	2094270	Case	4	4	4
4	2023418	Bearing Cap	1	1	1
5	206426	Washer	2	2	2
6	293692	Capscrew	4	4	4
7	2021390	Cover	2	2	2
8	1371856	Colter Pin	4	4	4
9	2021329	O-Ring	1	1	1
10	2021915	Plug	4	4	4
11	2021675	Housing	22	22	22
12	2021336	Pin	39	39	39
13	287880	Capscrew	1	1	1
14	292692	Lockwasher	1	1	1
15	2021345	Hydraulic Pump (w/ Figure 6-6)	8	8	8
16	214364	Gasket	8	8	8
17	285418	Capscrew	1	1	1
18	2021388	Washer	1	1	1
19	2021389	Temperature Switch	9	9	9
20	2021383	Breather	9	9	9
21	292515	Dipstick	2	2	2
22	139692	Capscrew	3	3	3
23	232527	Nut	3	2	2
24	292531	Capscrew	4	4	4
25	292683	Lockwasher	4	4	4
26	293637	Capscrew	1	1	1
	296420	Washer	1	1	1
	996403	Transmission Kit (Include Item 7)			
	996405	Transmission Kit (Include Item 14)			

**SECTIONS**

1	ELEC
2	ST
3	ST
4	BRAKE/ACCEL
5	HYD
6	MAST-TWO STAGE LI
7	MAST-THREE STAGE
8	MAST-TWO STAGE
9	MAST-TWO STAGE
10	NI
11	NI

This Parts Manual is divided into 11 major sections which are listed above. Quick reference can be made by placing the right thumb on the tab of the desired section, bending the book pages to the corresponding tab.

©2001 HYSTER COMPANY  
See Service Manual for service procedures  
3-15

HP990135

## HOW TO FIND THE DESIRED PART NUMBER

### WHEN THE PART NUMBER AND THE NEXT HIGHER ASSEMBLY IS NOT KNOWN:

1. Determine the function and application of the part required. Turn to the Sections Page. Choose the general area of reference most likely to include the part.
2. Turn to the section you chose. Use the Section Table of Contents to determine the assembly which would normally contain the part required. Then locate the part on the assembly breakdown page.

### WHEN THE PART NUMBER IS NOT KNOWN AND THE NEXT HIGHER ASSEMBLY IS KNOWN:

3. Determine the assembly the required part is used on. Turn to the Table of Contents on Page i.
4. Locate the assembly the required part is used on and turn to the page indicated for that assembly. Then locate the part on the assembly breakdown page.

### WHEN THE PART NUMBER IS KNOWN:

5. Use the Numerical Index on Page 22-1 to find the part number. Turn to the page listed and locate the part as indicated by the item number.

### GENERAL:

The assembly breakdowns include part numbers, descriptions, quantities required, keys and footnotes to help in selecting correct parts.

6. Five periods in the PART NO. column (. . . . .) indicate that the part is either *Not Serviced Separately* or there is a reference to another figure. A figure reference is denoted by a pointing hand followed by a figure number in the DESCRIPTION column (☞ Figure 10)
7. Keys are used to show two or more similar assemblies, RH and LH assembly parts, etc. Select the appropriate key, "A", "B", "C", "D", or "E" and the corresponding quantity column to find the required parts. Two periods in the QTY column (..) indicate that the part is not used for that assembly.
8. Indented descriptions under the DESCRIPTION column are used to indicate assemblies and subparts of assemblies. In the example on the

previous page, *BEARING CAP* (Item 2) is a subpart of the major assembly *CASE*.

9. Quantities shown are for one assembly. The quantities of the subpart *BEARING CAP* are indicated as two and two. This means two per *CASE* assembly.
10. Serial number breaks identify the most current parts information and are shown as follows:
  - ⇒ **S/N D001H-2628**  
Indicates last serial number affected.
  - S/N D001H-2629** ⇒  
Indicates the first serial number affected.
  - S/N D001H-1553** ⇔ **S/N D001H-3291**  
Indicates a range of serial numbers affected.

ECN numbers for pending serial numbers are shown to allow for the inclusion of the most current parts information and are identified as follows:

- ⇒ **S/N Pending Per ECN 63243**  
Indicates a pending serial number for last unit affected.
- S/N Pending Per ECN 63243** ⇒  
Indicates a pending serial number for first unit affected.

Date breaks are used to indicate when a change occurred but a subsequent serial number break was not recorded. This is an arbitrary date usually based on the ECN release and are identified as follows:

- ⇒ **D/B 3/00**  
Indicates that a change occurred sometime within that month for the item affected.
- D/B 3/00** ⇒  
Indicates that a change occurred sometime within that month for the item affected.
- D/B 3/00** ⇔ **D/B 4/00**  
Indicates a range of production dates of the item affected.

Contact your local dealer for Hyster lift trucks for serial number information for items with a ECN or a date break.

### ORDERING PARTS:

When ordering replacement parts, give the unit serial number, part number, name of part and quantity required.

For any further information on parts, service, or ordering, consult your local dealer for Hyster lift trucks.

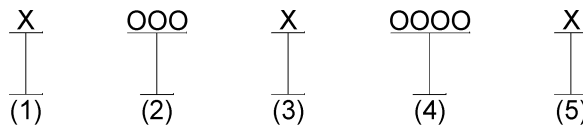
**IDENTIFICATION OF TRUCK SERIAL NUMBERS**

- (1) and (2) The first letter and three numbers indicate the truck unit code.
- (3) The second letter indicates the plant of manufacture.
- (4) The four or five digit number indicates the production sequence number of the truck.
- (5) The final letter indicates the year of manufacture starting with "A" in 1957 and 1980. The letters "I", "O", and "Q" will not be used.

For pending serial numbers contact your local dealer for Hyster lift trucks.

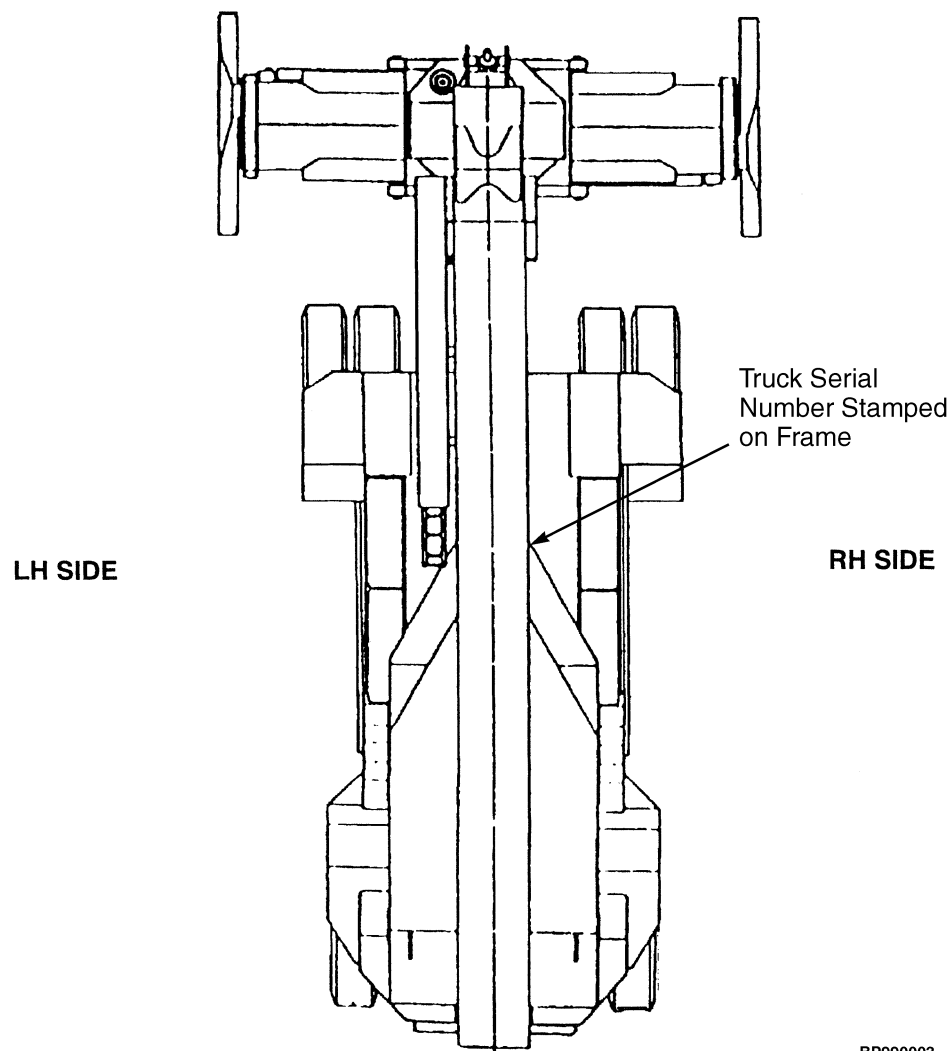

BP990003

Parts referred to in this book as right or left hand parts are in accordance with the illustration above.

---

**PUBLICATIONS**

Every new lift truck is provided with an OPERATING MANUAL. This manual has information that the operator must know for inspection and operation of the lift truck.

SERVICE MAINTENANCE MANUALS, which provide service and overhaul procedures, and PARTS MANUALS with complete replacement part identification, are available at a nominal fee from your Hyster dealer to assist users in effectively maintaining Hyster lift trucks in a safe, useful condition. See the list below for information on ordering specific publications for this model lift truck.

---

<b>PUBLICATION</b>	<b>HYSTER PART NUMBER</b>
<b>Operating Manual</b> .....	1470228
<b>Service Manual (Complete)</b> .....	1470227
<b>Parts Manual</b> .....	1470226



**1**

**FRAME**



**SECTION 1**  
**FRAME**

DESCRIPTION	PAGE
CAB DOOR	
LEFT HAND .....	1-8
RIGHT HAND.....	1-10
CHASSIS BOX	
LEFT HAND	
HR45-25, HR45-31, HR45-40S.....	1-4
COUNTERWEIGHT .....	1-3
FRAME	
HR45-25, HR45-31, HR45-40S .....	1-2
HOOD	
HR45-25, HR45-31, HR45-40S .....	1-6
LABELS.....	1-14
LIMIT SWITCH	
27 DEGREES	
HR45-31, HR45-40S .....	1-16
HR45-25, HR45-31, HR45-40S .....	1-12

## FRAME (Figure 1-1) HR45-25, HR45-31, HR45-40S

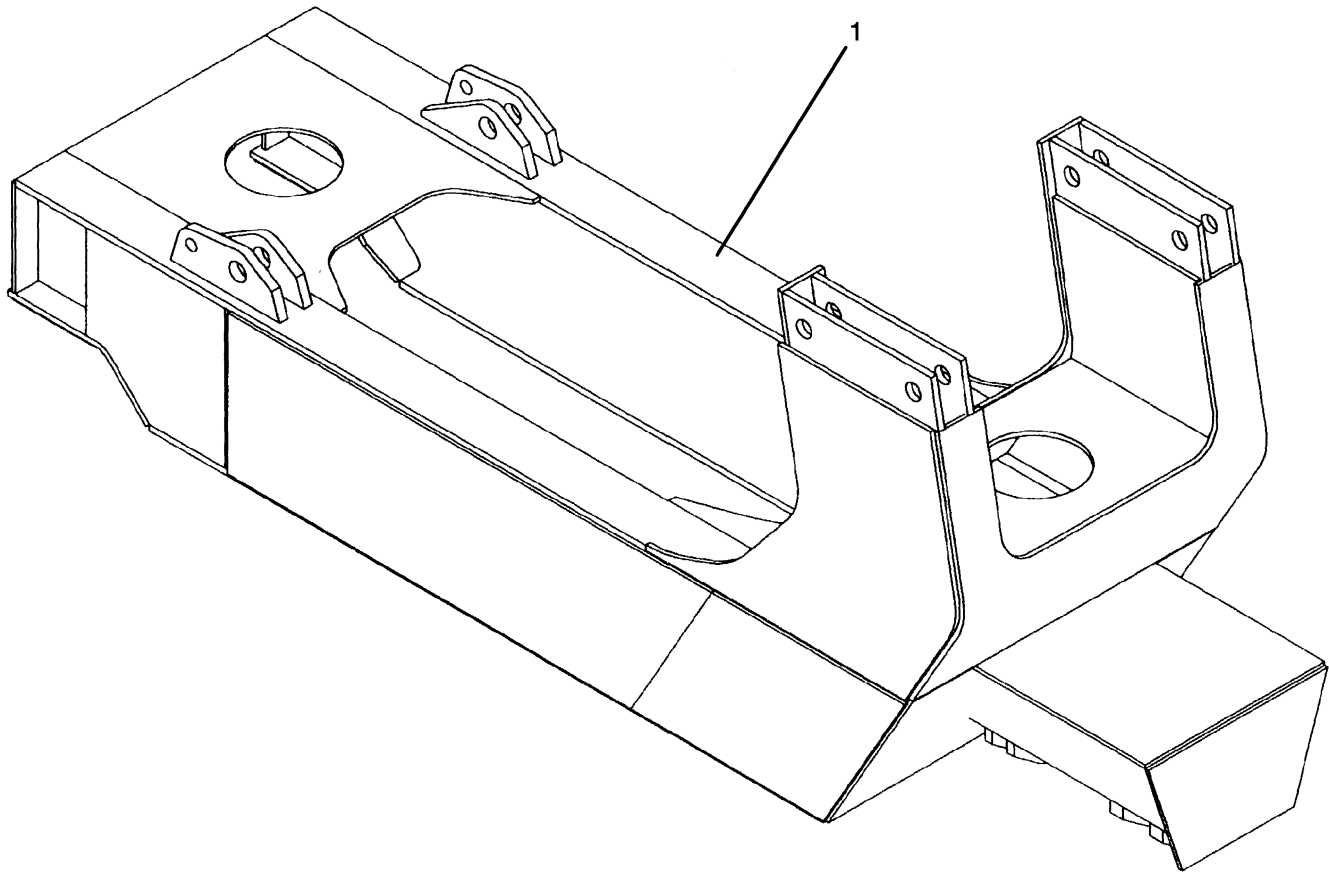

HP120599

ITEM	PART NO.	DESCRIPTION	QTY
1	1468878	Frame .....	1
1	1488109	Frame (RS) .....	1

**COUNTERWEIGHT (Figure 1-2)**

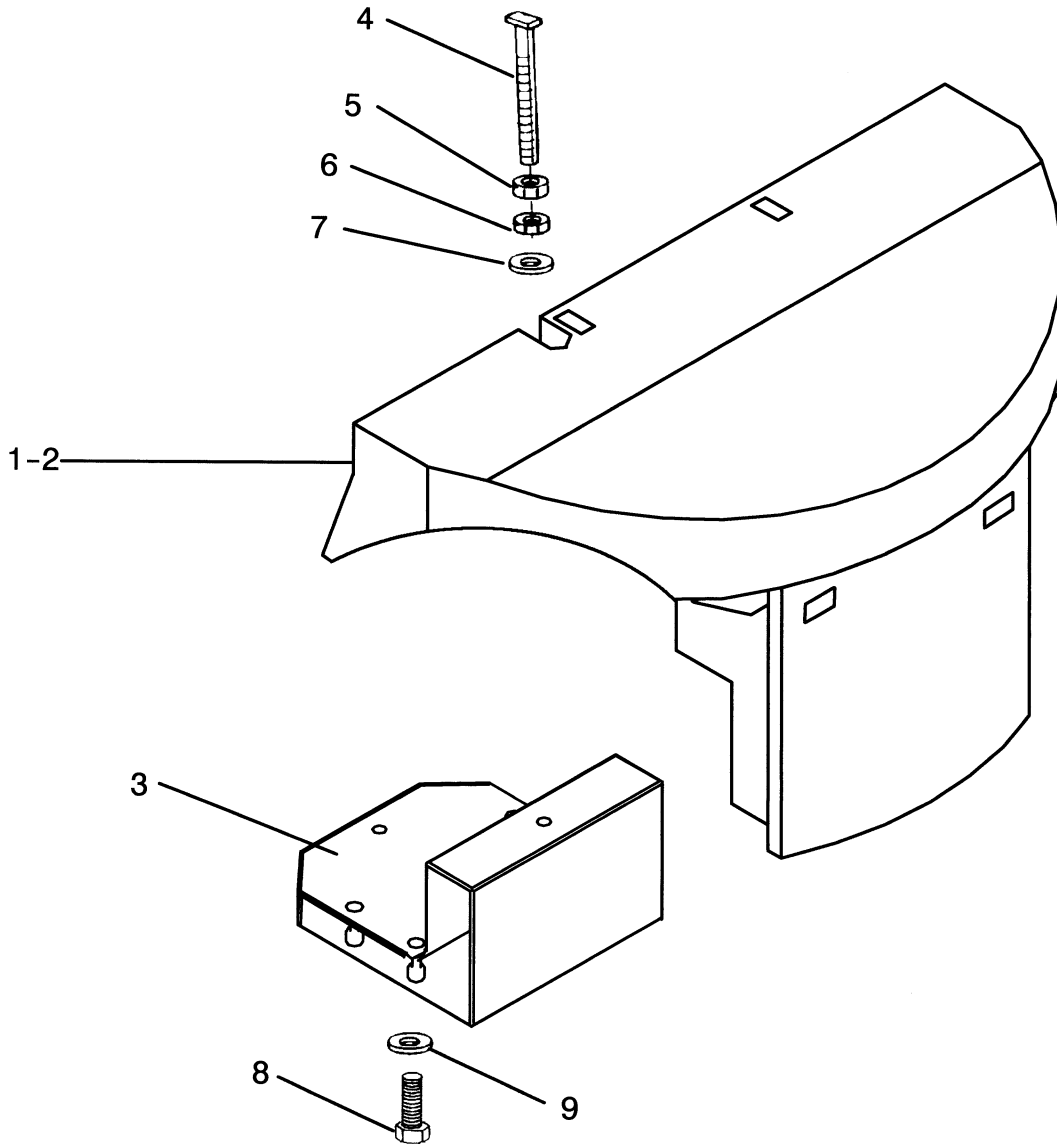

HP120600

ITEM	PART NO.	DESCRIPTION	QTY
1	1468953	Counterweight (HR45-25).....	1
1	1471912	Counterweight (HR45-31, HR45-36L, HR45-40LS).....	1
2	1471913	Counterweight (HR45-40S) .....	1
3	1468954	Counterweight (HR45H) .....	1
4	1468955	Bolt .....	4
5	1468956	Nut .....	4
6	1468957	Nut .....	4
7	1468958	Washer .....	4
8	1468959	Capscrew.....	4
9	1468960	Washer .....	4

## CHASSIS BOX (Figure 1-3) LEFT HAND HR45-25, HR45-31, HR45-40S

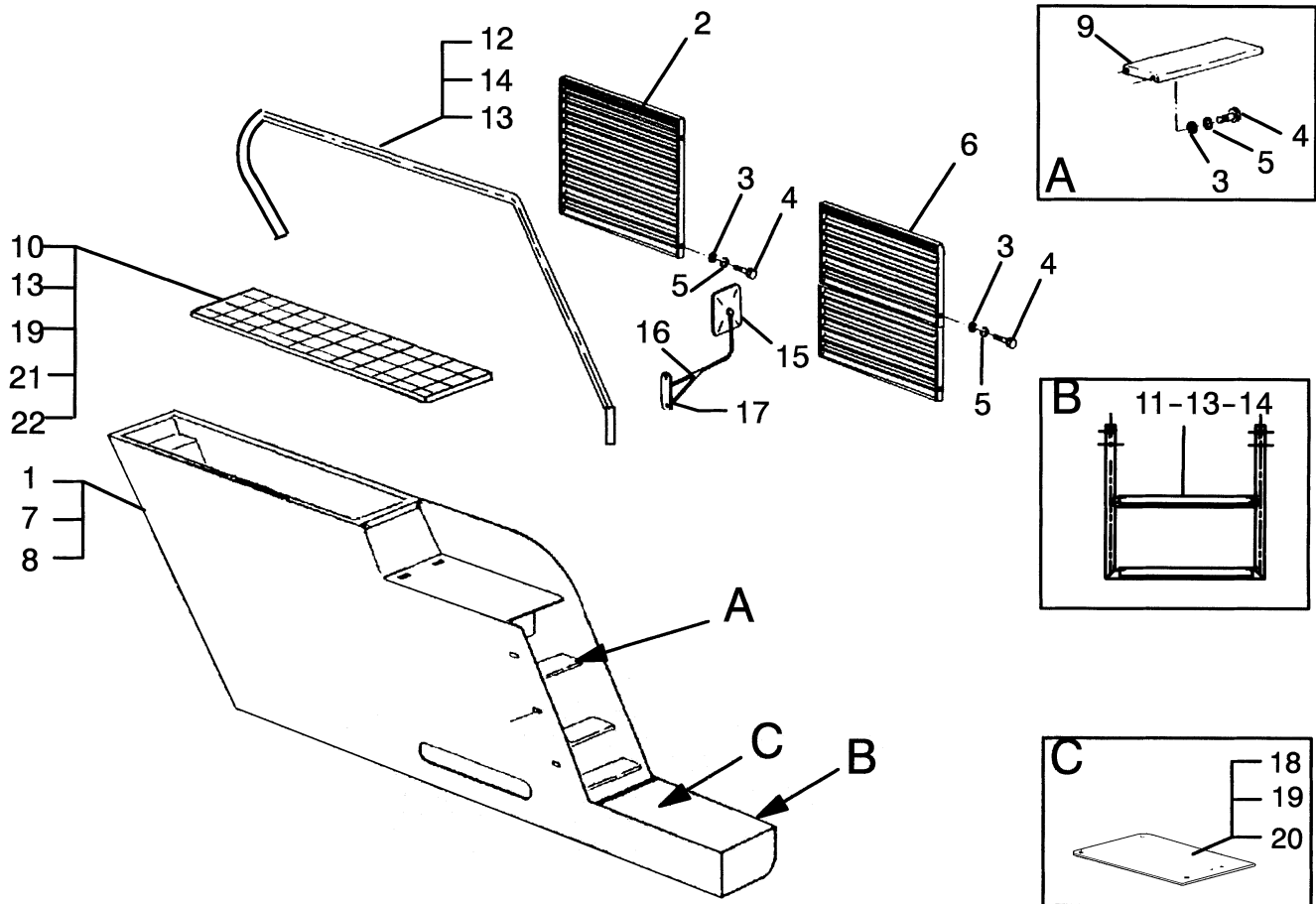

HP120601

**Please Click Here To Download The Complete Manual**  
**Download Other Manuals**  
**If Having Any Questions Feel Free To Contact us**

**[admin@servicemanualbit.com](mailto:admin@servicemanualbit.com)**