

PARTS MANUAL

**SPACESAVER
S40-50-60XL
(C187)**

CUSTOMER EDITION

HYSTER

ILLUSTRATED CONTENTS

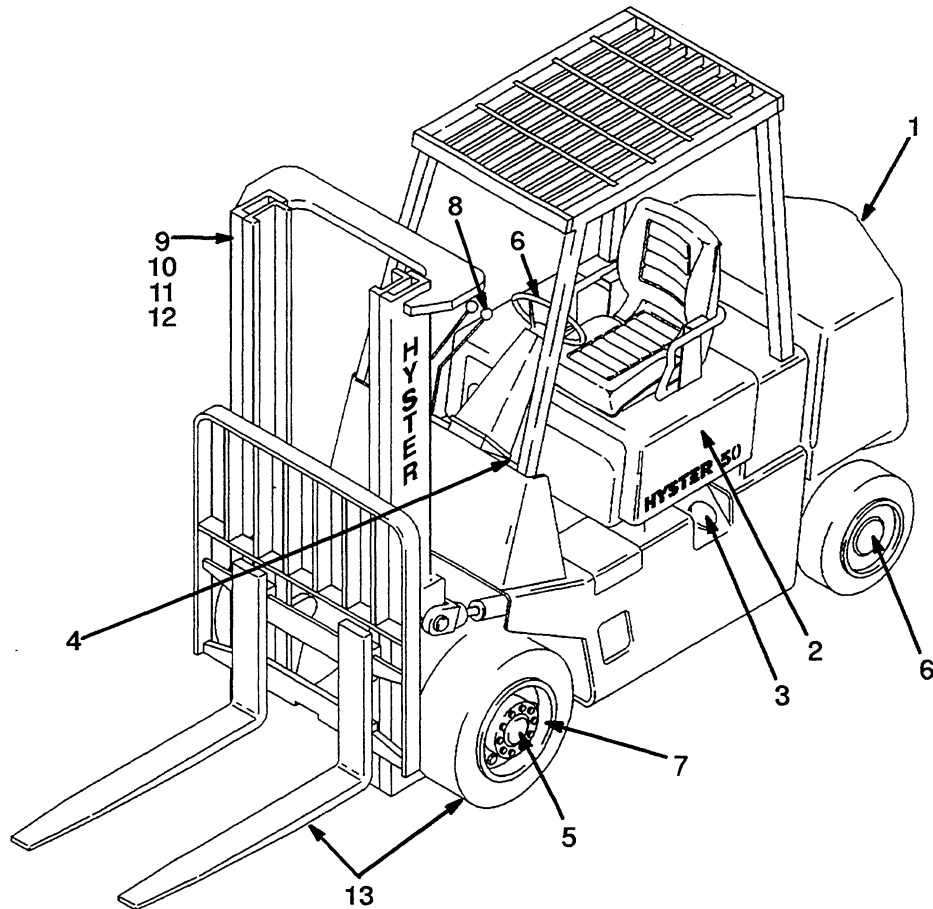

REF	SECTION	PAGE
1	Frame	3
2	Engine	15
3	Fuel	79
4	Electrical	113
5	Transmission	149
6	Steering	167
7	Brake	175
8	Hydraulic	185
9	Mast-Vista Two-Stage Limited Free Lift	213
9	Mast-Global Two-Stage Limited Free Lift	231
10	Mast-Vista Three-Stage Full Free Lift	253
10	Mast-Global Three-Stage Full Free Lift	277
11	Mast-Vista Two-Stage Full Free Lift	303
11	Mast-Global Two-Stage Full Free Lift	325
12	Mast-Vista Four-Stage Full Free Lift	351
13	Optional	369
14	Numerical Index	389

TABLE OF CONTENTS

<u>DESCRIPTION</u>	<u>PAGE</u>
A	
AIR FILTER (Figure 53) GAS & LPG M4-121G, DIESEL 2.4L	Page 98
AIR FILTER (Figure 54) GASOLINE & LPG 4-181	Page 99
ALTERNATOR (Figure 73) GASOLINE & LPG M4-121G	Page 130
ALTERNATOR (Figure 74) DIESEL 2.4L	Page 131
ALTERNATOR (Figure 75) DIESEL 2.4L, GASOLINE & LPG M4-121G GS, LPS & DS	Page 132
ALTERNATOR (Figure 76) GASOLINE & LPG 4-181	Page 134
ALTERNATOR (Figure 77) GS & LPS 4-181	Page 136
AUXILIARY TUBE EXTENSION KIT (Figure 230)	Page 386
B	
BACK-UP ALARM (Figure 229)	Page 384
BRAKE (Figure 100)	Page 178
BRAKE LINKAGE (Figure 102)	Page 182
C	
CAMSHAFT & OIL PAN (Figure 42) GASOLINE & LPG 3.0L 1996 SERIES ENGINE	Page 76
CAMSHAFT & VALVES (Figure 15) DIESEL 2.4L	Page 29
CAMSHAFT & VALVES (Figure 27) GAS & LPG M4-121G	Page 48
CARBURETOR (Figure 46) GASOLINE M4-121G	Page 86
CARBURETOR (Figure 47) LPG	Page 88
CARBURETOR (Figure 50) GASOLINE 4-181	Page 92
CARBURETOR (Figure 51) LPG 4-181	Page 94

TABLE OF CONTENTS

DESCRIPTION	PAGE
C (Continued)	
CARBURETOR (Figure 52) LPG 4-181	Page 96
CARRIAGE (Figure 123) VISTA 2-STG LFL	Page 222
CARRIAGE (Figure 138) FOUR ROLLER GLOBAL 2-STG LFL	Page 246
CARRIAGE (Figure 139) SIX ROLLER GLOBAL 2-STG LFL	Page 247
CARRIAGE (Figure 152) VISTA 3-STG FFL	Page 268
CARRIAGE (Figure 170) SIX ROLLER GLOBAL 3-STG FFL	Page 296
CARRIAGE (Figure 182) VISTA 2-STG FFL	Page 316
CARRIAGE (Figure 200) FOUR ROLLER GLOBAL 2-STG FFL	Page 344
CARRIAGE (Figure 201) SIX ROLLER GLOBAL 2-STG FFL	Page 345
CARRIAGE (Figure 213) VISTA 4-STG FFL	Page 362
CONTROL CHOKE (Figure 49) GASOLINE 4-181	Page 91
CONTROL VALVE (Figure 114) TWO FUNCTION	Page 202
CONTROL VALVE (Figure 116) THREE FUNCTION	Page 206
CONTROL VALVE (Figure 118) FOUR FUNCTION	Page 210
CONTROL VALVE (Figure 92) TRANSMISSION FORWARD & REVERSE SHIFT LEVER	Page 160
CONTROL VALVE (Figure 93) TRANSMISSION MONOTROL	Page 162
COOLING (Figure 11) DIESEL 2.4L	Page 22

TABLE OF CONTENTS

<u>DESCRIPTION</u>	<u>PAGE</u>
C (Continued)	
COOLING (Figure 22) GAS & LPG M4-121G	Page 38
COOLING (Figure 31) GASOLINE & LPG 4-181	Page 52
COOLING (Figure 41) GASOLINE & LPG 3.0L 1996 SERIES ENGINE	Page 74
COUNTERWEIGHT (Figure 4)	Page 7
COWL & FLOOR PLATES (Figure 2)	Page 4
CRANKCASE & OIL PAN (Figure 14) DIESEL 2.4L	Page 28
CRANKCASE & OIL PAN (Figure 26) GAS & LPG M4-121G	Page 46
CRANKSHAFT & PISTON (Figure 38) GASOLINE & LPG 3.0L 1996 SERIES ENGINE	Page 68
CRANKSHAFT, PISTON & FLYWHEEL (Figure 16) DIESEL 2.4L	Page 30
CRANKSHAFT, PISTON & FLYWHEEL (Figure 25) GAS & LPG M4-121G	Page 44
CYLINDER BLOCK (Figure 12) DIESEL 2.4L	Page 24
CYLINDER BLOCK (Figure 23) GAS & LPG M4-121G	Page 40
CYLINDER BLOCK (Figure 32) GASOLINE & LPG 4-181	Page 54
CYLINDER BLOCK (Figure 33) GASOLINE & LPG 4-181	Page 58
CYLINDER (Figure 136) S40-50XL (S2.00-2.50XL) GLOBAL 2-STG LFL	Page 242
CYLINDER (Figure 137) S60XL (S3.00XL) GLOBAL 2-STG LFL	Page 244
CYLINDER HEAD (Figure 13) DIESEL 2.4L	Page 26
CYLINDER HEAD (Figure 24) GAS & LPG M4-121G	Page 42
CYLINDER HEAD (Figure 35) GASOLINE & LPG 4-181	Page 62

TABLE OF CONTENTS

<u>DESCRIPTION</u>	<u>PAGE</u>
C (Continued)	
CYLINDER HEAD (Figure 36) GASOLINE & LPG 4-181	Page 64
CYLINDER HEAD (Figure 39) GASOLINE & LPG 3.0L 1996 SERIES ENGINE	Page 70
D	
DIFFERENTIAL (Figure 91)	Page 158
DISTRIBUTOR (Figure 70) HIGH ENERGY IGNITION M4-121G	Page 126
DISTRIBUTOR (Figure 71) GASOLINE & LPG 4-181	Page 128
DISTRIBUTOR (Figure 72) GASOLINE & LPG 3.0L 1996 SERIES ENGINE	Page 129
DRIVE AXLE (Figure 94)	Page 164
E	
ELECTRICAL CONNECTORS (Figure 85) LESS TERMINALS	Page 148
ELECTRICAL (Figure 40) GASOLINE & LPG 3.0L 1996 SERIES ENGINE	Page 72
ELECTRICAL (Figure 69) GASOLINE LPG 4-181 GS & LPS	Page 124
ELECTRICAL SYSTEM (Figure 64) GASOLINE & LPG M4-121G	Page 114
ELECTRICAL SYSTEM (Figure 65) GASOLINE & LPG M4-121G GS & LPS	Page 116
ELECTRICAL SYSTEM (Figure 66) DIESEL	Page 118
ELECTRICAL SYSTEM (Figure 67) DIESEL DS	Page 120
ELECTRICAL SYSTEM (Figure 68) GASOLINE LPG 4-181	Page 122
ENGINE MOUNT (Figure 10) GAS & LPG 4-181	Page 21
ENGINE MOUNT (Figure 9) GAS & LPG M4-121G, DIESEL 2.4L	Page 20

TABLE OF CONTENTS

<u>DESCRIPTION</u>	<u>PAGE</u>
E (Continued)	
EXHAUST SYSTEM (Figure 8)	Page 18
F	
FILTER LOCK OFF (Figure 58) LPG	Page 104
FIRE EXTINGUISHER (Figure 228)	Page 383
FLOW VALVE (Figure 108)	Page 194
FLOW VALVE (Figure 111)	Page 197
FLYWHEEL & DRIVE PUMP (Figure 34) GASOLINE & LPG 4.181	Page 61
FORK (Figure 128) S40-50XL VISTA 2-STG LFL	Page 228
FORK (Figure 142) S40-50XL (S2.00-2.50XL) GLOBAL 2-STG LFL	Page 250
FORK (Figure 157) S40-50XL (S2.00-2.50XL) VISTA 3-STG FFL	Page 274
FORK (Figure 173) S40-50XL (S2.00-2.50XL) GLOBAL 3-STG FFL	Page 299
FORK (Figure 187) S40-50XL (S2.00-2.50XL) VISTA 2-STG FFL	Page 322
FORK (Figure 204) S40-50XL (S2.00-2.50XL) GLOBAL 2-STG FFL	Page 348
FORK (Figure 218) S40-60XL (S2.00-2.50XL) VISTA 4-STG FFL	Page 367
FORKS (Figure 127) S40-50XL (S2.00-2.50XL) VISTA 2-STG LFL	Page 227
FORKS (Figure 129) S60XL (S3.00XL) VISTA 2-STG LFL	Page 229
FORKS (Figure 130) S60XL (S3.00XL) VISTA 2-STG LFL	Page 230
FORKS (Figure 141) S40-50XL (S2.00-2.50XL) GLOBAL 2-STG LFL	Page 249

TABLE OF CONTENTS

DESCRIPTION	PAGE
F (Continued)	
FORKS (Figure 143) S60XL (S3.00XL) GLOBAL 2-STG LFL	Page 251
FORKS (Figure 144) S60XL (S3.00XL) GLOBAL 2-STG LFL	Page 252
FORKS (Figure 156) S40-50XL (S2.00-2.50XL) VISTA 3-STG FFL	Page 273
FORKS (Figure 158) S60XL (S3.00XL) VISTA 3-STG FFL	Page 275
FORKS (Figure 159) S60XL (S3.00XL) VISTA 3-STG FFL	Page 276
FORKS (Figure 172) S40-50XL (S2.00-2.50XL) GLOBAL 3-STG FFL	Page 298
FORKS (Figure 174) S60XL (S3.00XL) GLOBAL 3-STG FFL	Page 300
FORKS (Figure 175) S60XL (S3.00XL) GLOBAL 3-STG FFL	Page 301
FORKS (Figure 186) S40-50XL (S2.00-2.50XL) VISTA 2-STG FFL	Page 321
FORKS (Figure 188) S60XL (S3.00XL) VISTA 2-STG FFL	Page 323
FORKS (Figure 189) S60XL (S3.00XL) VISTA 2-STG FFL	Page 324
FORKS (Figure 203) S40-50XL (S2.00-2.50XL) GLOBAL 2-STG FFL	Page 347
FORKS (Figure 205) S60XL (S3.00XL) GLOBAL 2-STG FFL	Page 349
FORKS (Figure 206) S60XL (S3.00XL) GLOBAL 2-STG FFL	Page 350
FORKS (Figure 217) S40-60XL (S2.00-2.50XL) VISTA 4-STG FFL	Page 366

TABLE OF CONTENTS

<u>DESCRIPTION</u>	<u>PAGE</u>
F (Continued)	
FORWARD & REVERSE CLUTCH (Figure 90)	Page 156
FORWARD & REVERSE LINKAGE (Figure 86)	Page 150
FORWARD & REVERSE SWITCH (Figure 87)	Page 152
FREE LIFT CYLINDER (Figure 151) VISTA 3-STG FFL	Page 266
FREE LIFT CYLINDER (Figure 181) VISTA 2-STG FFL	Page 314
FREE LIFT CYLINDER (Figure 198) S40-50XL (S2.00-2.50XL) GLOBAL 2-STG FFL	Page 342
FREE LIFT CYLINDER (Figure 199) S60XL (S3.00XL) GLOBAL 2-STG FFL	Page 343
FREE LIFT CYLINDER (Figure 212) VISTA 4-STG FFL	Page 361
FREE LIFT (Figure 164) GLOBAL 3-STG FFL	Page 286
FREE LIFT (Figure 179) VISTA 2-STG FFL	Page 310
FREE LIFT (Figure 193) GLOBAL 2-STG FFL	Page 332
FREE LIFT (Figure 210) VISTA 4-STG FFL	Page 358
FREE-LIFT CYLINDER (Figure 168) S40-50XL (S2.00-2.50XL) GLOBAL 3-STG FFL	Page 294
FREE-LIFT CYLINDER (Figure 169) S60XL (S3.00XL) GLOBAL 3-STG FFL	Page 295
FUEL FILTER (Figure 55) DIESEL	Page 100
FUEL INJECTION (Figure 57) DIESEL 2.4L	Page 102
FUEL PUMP (Figure 56) GASOLINE M4-121G	Page 101
FUEL SYSTEM (Figure 43) LPG M4-121G	Page 80
FUEL SYSTEM (Figure 44) LPG 4-181	Page 82

TABLE OF CONTENTS

DESCRIPTION	PAGE
F (Continued)	
FUEL SYSTEM (Figure 45) GASOLINE & DIESEL	Page 84
G	
GAUGE CLUSTER (Figure 79)	Page 140
GOVERNOR (Figure 48) GASOLINE & LPG M4-121G	Page 90
H	
HAND PUMP (Figure 97)	Page 172
HEADER HOSE (Figure 184) VISTA 2-STG FFL	Page 318
HEADER HOSE (Figure 125) VISTA 2-STG LFL	Page 224
HEADER HOSE (Figure 135) GLOBAL 2-STG LFL	Page 240
HEADER HOSE (Figure 154) VISTA 3-STG FFL	Page 270
HEADER HOSE (Figure 166) GLOBAL 3-STG FFL	Page 290
HEADER HOSE (Figure 195) GLOBAL 2-STG FFL	Page 336
HEADER HOSE (Figure 214) VISTA 4-STG FFL	Page 363
HOOD & LINKAGE (Figure 3)	Page 5
HYDRAULIC PUMP (Figure 107) GAS & LPG M4-121G, DIESEL 2.4L	Page 192
HYDRAULIC PUMP (Figure 109) GAS & LPG 4-181 LAST USED ON S/N C187V-14091	Page 195
HYDRAULIC PUMP (Figure 110) GAS & LPG 4-181 FIRST USED ON S/N C187V-14092	Page 196
HYDRAULIC SYSTEM (Figure 104) DIESEL 2.4L	Page 186
HYDRAULIC SYSTEM (Figure 105) GASOLINE & LPG M4-121G	Page 188
HYDRAULIC SYSTEM (Figure 106) GASOLINE & LPG 4-181	Page 190

TABLE OF CONTENTS

<u>DESCRIPTION</u>	<u>PAGE</u>
I	
INNER MAST (Figure 132) GLOBAL 2-STG LFL	Page 234
INNER MAST (Figure 120) VISTA 2-STG LFL	Page 216
INNER MAST (Figure 147) VISTA 3-STG FFL	Page 258
INNER MAST (Figure 162) GLOBAL 3-STG FFL	Page 282
INNER MAST (Figure 177) VISTA 2-STG FFL	Page 306
INNER MAST (Figure 191) GLOBAL 2-STG FFL	Page 328
INSTRUMENT PANEL (Figure 78)	Page 138
INTERMEDIATE MAST (Figure 146) VISTA 3-STG FFL	Page 256
INTERMEDIATE MAST (Figure 161) GLOBAL 3-STG FFL	Page 280
L	
LABELS & PAINT (Figure 7)	Page 12
LIFT (Figure 133) GLOBAL 2-STG LFL	Page 236
LIFT CYLINDER (Figure 122) VISTA 2-STG LFL	Page 220
LIFT CYLINDER (Figure 150) MAIN VISTA 3-STG FFL	Page 264
LIFT (Figure 121) VISTA 2-STG LFL	Page 218
LIFT (Figure 148) MAIN VISTA 3-STG FFL	Page 260
LIFT (Figure 149) FREE LIFT VISTA 3-STG FFL	Page 262
LIGHTS (Figure 223) LAST USED ON S/N C187V-2992	Page 374
LIGHTS (Figure 224) FIRST USED ON S/N C187V-2993	Page 376

TABLE OF CONTENTS

<u>DESCRIPTION</u>	<u>PAGE</u>
L (Continued)	
LOAD BACKREST EXTENSION (Figure 126) VISTA 2-STG LFL	Page 226
LOAD BACKREST EXTENSION (Figure 140) GLOBAL 2-STG LFL	Page 248
LOAD BACKREST EXTENSION (Figure 155) VISTA 3-STG FFL	Page 272
LOAD BACKREST EXTENSION (Figure 171) GLOBAL 3-STG FFL	Page 297
LOAD BACKREST EXTENSION (Figure 185) VISTA 2-STG FFL	Page 320
LOAD BACKREST EXTENSION (Figure 202) GLOBAL 2-STG FFL	Page 346
LOAD BACKREST EXTENSION (Figure 216) VISTA 4-STG FFL	Page 365
LO-RIDER SUSPENSION (Figure 6)	Page 10
LPG CONVERTER (Figure 59) GASOLINE M4-121G	Page 105
LPG CONVERTER (Figure 60) GASOLINE 4-181	Page 106
M	
MAIN CYLINDER (Figure 197) RIGHT HAND GLOBAL 2-STG FFL	Page 340
MAIN CYLINDER (Figure 167) GLOBAL 3-STG FFL	Page 292
MAIN CYLINDER (Figure 196) LEFT HAND GLOBAL 2-STG FFL	Page 338
MAIN LIFT CYLINDER (Figure 180) VISTA 2-STG FFL	Page 312
MAIN LIFT CYLINDER (Figure 211) VISTA 4-STG FFL	Page 360
MAIN LIFT (Figure 163) GLOBAL 3-STG FFL	Page 284
MAIN LIFT (Figure 178) VISTA 2-STG FFL	Page 308
MAIN LIFT (Figure 192) GLOBAL 2-STG FFL	Page 330

TABLE OF CONTENTS

<u>DESCRIPTION</u>	<u>PAGE</u>
M (Continued)	
MAIN LIFT (Figure 209) VISTA 4-STG FFL	Page 356
MANIFOLD (Figure 18) DIESEL 2.4L	Page 33
MANIFOLD (Figure 28) GAS & LPG M4-121G	Page 49
MAST (Figure 207) OUTER & NUMBER TWO VISTA 4-STG FFL	Page 352
MAST (Figure 208) INNER & NUMBER THREE VISTA 4-STG FFL	Page 354
MAST INSTALLATION (Figure 153) VISTA 3-STG FFL	Page 269
MAST INSTALLATION (Figure 124) VISTA 2-STG LFL	Page 223
MAST INSTALLATION (Figure 134) GLOBAL 2-STG LFL	Page 239
MAST INSTALLATION (Figure 165) GLOBAL 3-STG FFL	Page 289
MAST INSTALLATION (Figure 183) VISTA 2-STG FFL	Page 317
MAST INSTALLATION (Figure 194) GLOBAL 2-STG FFL	Page 335
MAST INSTALLATION (Figure 215) VISTA 4-STG FFL	Page 364
MASTER CYLINDER (Figure 103)	Page 183
MONOTROL PEDAL (Figure 63)	Page 112
O	
OIL FILTER (Figure 20) DIESEL 2.4L	Page 35
OIL PUMP & FILTER (Figure 29) GAS & LPG M4-121G	Page 50
OIL PUMP (Figure 21) DIESEL 2.4L	Page 36
OIL PUMP (Figure 37) GASOLINE & LPG 4-181	Page 66
OUTER MAST (Figure 160) GLOBAL 3-STG FFL	Page 278

TABLE OF CONTENTS

<u>DESCRIPTION</u>	<u>PAGE</u>
O (Continued)	
OUTER MAST (Figure 119) VISTA 2-STG LFL	Page 214
OUTER MAST (Figure 131) GLOBAL 2-STG LFL	Page 232
OUTER MAST (Figure 145) VISTA 3-STG FFL	Page 254
OUTER MAST (Figure 176) VISTA 2-STG FFL	Page 304
OUTER MAST (Figure 190) GLOBAL 2-STG FFL	Page 326
P	
PARK BRAKE (Figure 101)	Page 180
PEDAL & LINKAGE (Figure 99)	Page 176
PUBLICATIONS (Figure 1)	Page 1
S	
SEAT (Figure 5)	Page 8
SIDESHIFT CARRIAGE (Figure 219)	Page 370
SIDESHIFT CARRIAGE (Figure 220)	Page 371
SIDESHIFT CYLINDER (Figure 221)	Page 372
SIDESHIFT CYLINDER (Figure 222)	Page 373
STARTER (Figure 80) GASOLINE & LPG M4-121G	Page 141
STARTER (Figure 81) DIESEL	Page 142
STARTER (Figure 82) GASOLINE & LPG 4-181 LAST USED ON S/N C187V15344	Page 143
STARTER (Figure 83) GASOLINE & LPG FIRST USED ON S/N C187V15345	Page 144
STARTER Figure 84 GASOLINE & LPG	Page 146
STEERING AXLE (Figure 96)	Page 170

TABLE OF CONTENTS

<u>DESCRIPTION</u>	<u>PAGE</u>
S (Continued)	
STEERING CYLINDER (Figure 98)	Page 174
STEERING SYSTEM (Figure 95)	Page 168
STROBE LIGHT (Figure 225) MEDIUM INTENSITY	Page 378
STROBE LIGHT (Figure 226) HIGH INTENSITY	Page 380
T	
THROTTLE LINKAGE (Figure 61) FORWARD & REVERSE SHIFT LEVER	Page 108
THROTTLE LINKAGE (Figure 62) MONOTROL	Page 110
TILT CYLINDER (Figure 112)	Page 198
TIMING GEAR (Figure 17) DIESEL 2.4L	Page 32
TIRE & WHEEL (Figure 227)	Page 382
TORQUE CONVERTER (Figure 88)	Page 153
TRANSMISSION (Figure 89)	Page 154
V	
VALVE & ATTACHING PARTS (Figure 113) TWO FUNCTION	Page 200
VALVE & ATTACHING PARTS (Figure 115) THREE FUNCTION	Page 204
VALVE & ATTACHING PARTS (Figure 117) FOUR FUNCTION	Page 208
W	
WATER PUMP (Figure 19) DIESEL 2.4L	Page 34
WATER PUMP (Figure 30) GAS & LPG M4-121G	Page 51

HOW TO USE THE ILLUSTRATED PARTS MANUAL

This Parts Manual describes and illustrates assemblies, subassemblies and detail parts needed for service replacement.

It also includes all parts peculiar to trucks built in overseas plants. These parts are indicated by keys, symbols and footnotes.

INDEX-MASTER

ACTUATOR	2C08	HYDRAULIC	2E03-2E04
ALTERNATOR	1F12	INDEX-NUMERICAL	702
AXLE-DRIVE	2B04	INDEX-NUMERICAL	1E06
AXLE-STEERING	2D05	INJECTION-FUEL DIESEL	1B07
BLOCK-CYLINDER DIESEL	1C01		
BLOCK-CYLINDER GASOLINE LPG	1B04		
BRAKE	2C07		
BRAKE-PARK	2C03		
CAR	3003-3004		
CRANKSHAFT/CRANKSHAFT/PAN-OIL GASOLINE LPG			

INDEX-NUMERICAL

PART NO	PAGE NO	REF NO	PART NO	PAGE NO	REF NO	PART NO	PAGE NO	REF NO	PART NO	PAGE NO	REF NO	PART NO	PAGE NO	REF NO
128	1D12	3	1906A	1E03	28	15127	1D08	9	15154	1E03	29	15283	1412	5
138	2A08	14		1E04	6		1F08	2		1E04	24	15290	1D12	4
	2B01	12		1D07	25		1F08	30		1E04	21		1D13	10
	2E01	28		1E04	1	15132	1E04	22		1E04	02		1D14	5
	2E06	33		1E04	27	15134	1E04	41		1E07	15		1E04	21
139	2A08	12		1F12	45		1F04	14		1E09	16		2C03	12
	2B01	13	15007	1E08	5	15135	2B07	33		1E09	17		2F09	7
	2B03	25		1E08	4	15152	1B06	19		1D07	25		2E12	7
	2C04	30	15008	2A04	28		1F04	22		1E04	1		2F02	7
142	1D14	17	19010	1B14	20		1F08	20		1E04	5	15231	2A08	13
	1E01	4	15015	2A10	12		1F10	11		1E04	27		2B01	16
			15006	1D12	18		2B07	7		1E04	29		2B01	26
							1B12	0		1E04	02		2C04	31
										1E04	32	15212	1A08	16
													1D12	11

INDEX-ILLUSTRATED

1. Forklift body/frame
2. Engine compartment

MOTOR

9. Motor housing
10. Motor shaft
11. Motor fan
12. Motor terminal box
13. Motor mounting bracket
14. Motor fan guard
15. Motor fan nut

KEY

KEY	NO	VOL
9-12	WOL	
10-12	WOL	
C-24	WOL	

HYSTER CO PARTS OVER

REP NO	HYSTER PART NO	NAME OF PART	QTY	UNIT	REF NO	PART NO
	313402	MOTOR	1		1	313402
	313403	MOTOR	1		1	313403
	294785	MOTOR	1		1	294785
	317803	HEAD	1		10	317803
1	314876	SET-SPRING	1		12	314876
2	116406	SET-SPRING	1		13	116406
2	116405	SET-SPRING	1		13	116405
3	317934	HOLDER	1		13	317934
3	317714	RETAINER	1		14	317714
4	*****	BEARING	1		14	*****
5	116405	SET-BAUSH	1		14	116405
6	116402	SET-BAUSH	1		14	116402
	208144	SET-BAUSH	1		14	208144

ITEM PAGE

1	FRAME/BODY	1A06
2	ENGINE	1B02
3	FUEL	1D02
4	ELECTRICAL	1D02
5	TRANSMISSION	1E07
6	STEERING	1F02
7	BRAKE	2A04
8	HYDRAULIC	2B07
9	UPRIGHT-VISTA TWO-STAGE	2E02
10	UPRIGHT-VISTA THREE-STAGE	2D02
11	UPRIGHT-VISTA FREE-LIFT	2E02
12	OPTIONAL	2F02
13	INDEX-NUMERICAL	3A04

USE HYSTER APPROVED PARTS... it pays

© 1986 HYSTER COMPANY

WHEN THE PART NUMBER AND THE NEXT HIGHER ASSEMBLY IS NOT KNOWN:

1. Determine the function and application of the part required. Turn to the Illustrated Index page immediately behind the front cover, and select the most appropriate area.
2. Use the Division Index to determine the assembly which would normally contain the part required. Proceed then to locate the part on the assembly breakdown page.

WHEN THE PART NUMBER IS NOT KNOWN AND THE NEXT HIGHER ASSEMBLY IS KNOWN;

3. Determine the assembly the required part is used on. Turn to the Table of contents page immediately following the Illustrated Index.
4. Locate the assembly the required part is used on and turn to the page indicated for that assembly. Proceed then to locate the part on the assembly breakdown page.

WHEN THE PART NUMBER IS KNOWN;

5. Use the Numerical Index to find the part number. Turn to the figure listed and locate the part as indicated by the reference number.

GENERAL:

The Assembly Breakdowns include part numbers, description, quantities required, keys and footnotes to help in selecting the correct parts.

6. Keys are used to show effective serial numbers for two or more similar assemblies, RH and LH assembly parts, etc. Select the appropriate key, "A", "B", "C", or "D" and the corresponding quantity column to find the required parts.
7. Indented descriptions under "Name of Part" are used to indicate subparts of assemblies. A major assembly is not indented. Parts under the first, second, or third indent are sub-parts of the major assembly shown above them.
8. Quantities shown are for one assembly. Note that two assemblies are shown, but the quantities of the subparts are indicated as three and three. This means three per assembly.
9. Engineering Change Notice (ECN) numbers for pending serial numbers are shown to allow for the inclusion of the most current parts information. Contact your local Dealer for Hyster Lift Trucks for serial number information listed by ECN number.

ORDERING PARTS:

When ordering replacement parts, give the unit serial number, part number, name of part and quantity required.

For any further information on parts, service, or ordering, consult your local Dealer for Hyster Lift Trucks.

IDENTIFICATION-UNIT UNIT S/N

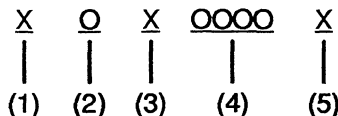

- (1) & (2) The first letter and number denote the design series and model of the unit
- (3) The second letter denotes the Plant at which the unit was manufactured
- (4) The number series denotes the serial number of the unit
- (5) The final letter denotes the year of manufacture starting with "A" in 1957 and 1980 The letters "I", "O", and "Q" will not be used

For pending serial numbers contact your local Hyster Dealer

Parts referred to in this book as right or left hand parts are in accordance with the illustration below

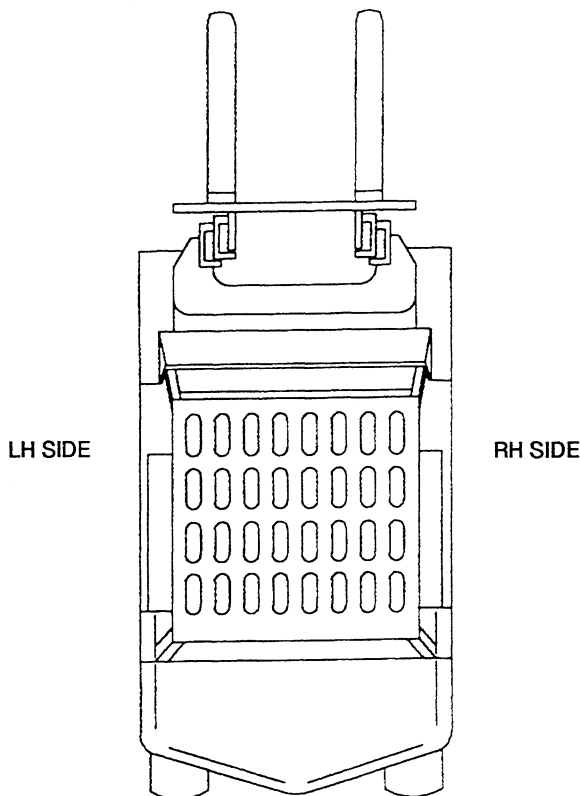

LIFT EQUIPMENT IDENTIFICATION

1. Mast group numbers and total lift heights are stamped on the right hand outer mast approximately four feet from the bottom of the fork. The group numbers include the inner and outer masts, lift cylinder, lift chain and bleeder hoses or pipes.
2. The carriage and tilt cylinder numbers are located as shown. Lift cylinder numbers are stamped on the cylinder shell near the bleeder screw or on the chain anchor. Fork part number, capacity rating, plant code letter and date of manufacture are stamped approximately six inches below the top RH side of forks. Always refer to these group and part numbers when ordering service parts.

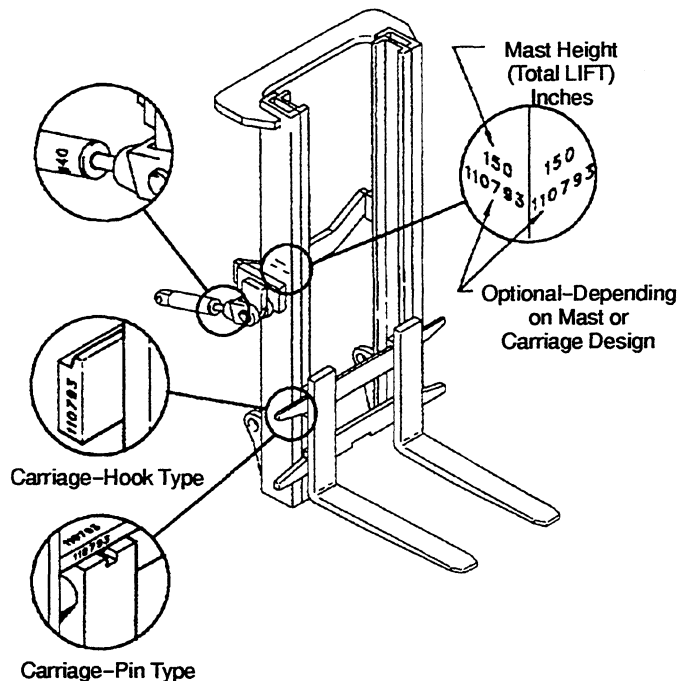

PUBLICATIONS (Figure 1)

Every new lift truck is provided with at least three publications. These publications are the PARTS MANUAL, the OPERATING MANUAL, and the section of the SERVICE MANUAL called Periodic Maintenance.

The OPERATING MANUAL must always be available on every lift truck. This manual has information that the operator must know for inspection and operation of the lift truck. The section Periodic Maintenance

has a recommended schedule of service intervals and the procedures for servicing the lift truck.

These manuals, other publications and programs are available from your Dealer for Hyster Lift Trucks to help you operate and maintain your lift truck professionally. See the list that follows for reference to items for lift trucks in this PARTS MANUAL.

PUBLICATION

HYSTER PART NUMBER

Operating Manual

English (U.S.)	897413
English (Non-U.S.)	897147
Spanish	853441
French	853428
German	853440
Dutch	853427
Swedish	853493
Danish	853617
Italian	853616
Portuguese	853618
Service Manual (complete)	599915
The Frame (100 SRM 254)	910461
The Isuzu C240 Engine (600 SRM 70)	899768
The Mazda M4-121G Engine (600 SRM 66)	899767
The Gm Engine (600 SRM 3)	899766
The Rochester Carburetor (900 SRM 11)	910057
The Gasoline Carburetor (900 SRM 129)	910168
The LPG System (900 SRM 15)	899772
The Single-Speed Powershift Transmission	
Description and Operation (1300 SRM 255)	899323
Repairs (1300 SRM 256)	899324
The Drive Axle (1400 SRM 85)	910171
The Steering System (1600 SRM 459)	897407
The Steering Control Unit (1600 SRM 257)	910458
The Steering Axle (1600 SRM 258)	910460
The Brake System (1800 SRM 458)	897405
The Brake System (1800 SRM 157)	910174
The Hydraulic System and Gear Pump Assembly (1900 SRM 130)	899780
The Hydraulic Pump Drive Assembly (1900 SRM 339)	897121
The Main Control Valve (2000 SRM 77)	899782
The Tilt Cylinders (2100 SRM 103)	910102
The Electrical System, Mazda (2200 SRM 132)	899791
The Electrical System, Isuzu (2200 SRM 134)	899792
Microprocessor Spark Timing System (2200 SRM 463)	897412
The Alternator (2200 SRM 2)	899784
The Starter (2200 SRM 106)	910107
The High Energy Ignition System (2200 SRM 107)	899788
Electrical Gauges, Meters and Senders (2200 SRM 143)	910110
Electrical Warning Devices (2200 SRM 144)	910111
Vista Masts - Description (4000 SRM 222)	899237
Vista Masts - Repair (4000 SRM 223)	910435

Please Click Here To Download The Complete Manual
Download Other Manuals
If Having Any Questions Feel Free To Contact us

admin@servicemanualbit.com