

PARTS MANUAL

**SPACESAVER
S40-50-60XL
S2.00-2.50-3.00XL
(B187)**



CUSTOMER EDITION

ILLUSTRATED CONTENTS

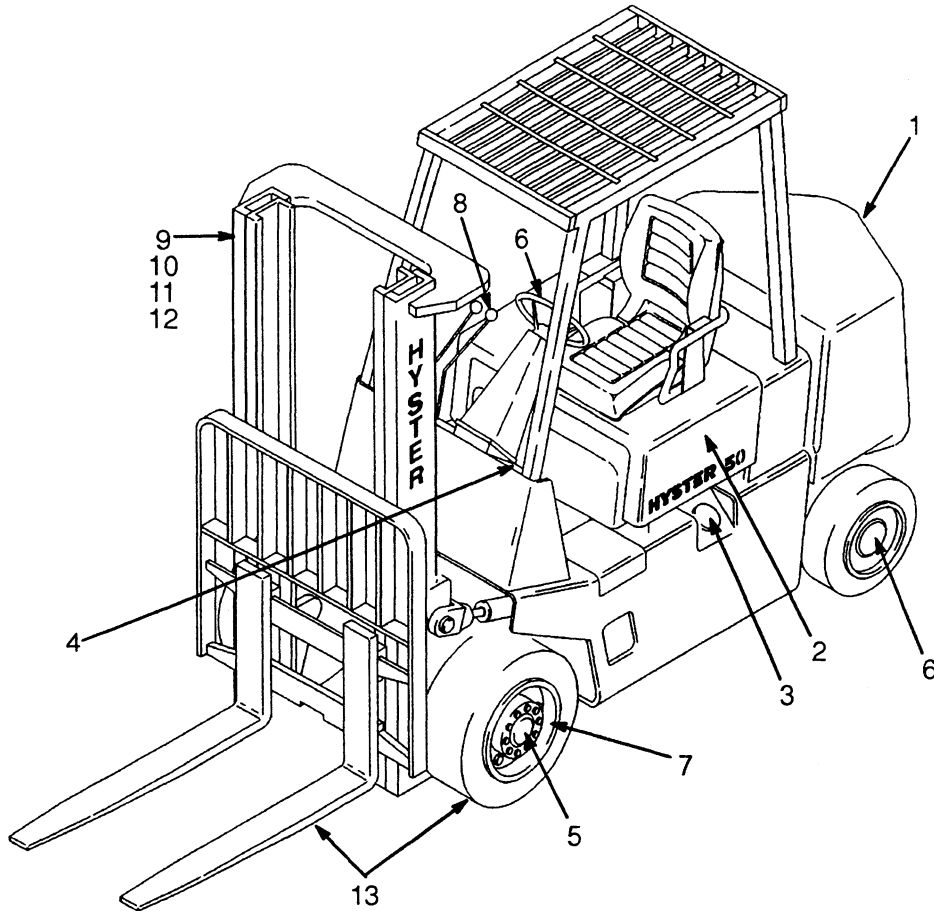

REF	SECTION	PAGE
1	Frame	7
2	Engine	19
3	Fuel	63
4	Electrical	93
5	Transmission	127
6	Steering	147
7	Brake	157
8	Hydraulic	167
9	Mast-Vista Two-Stage Limited Free Lift	195
10	Mast-Vista Three-Stage Full Free Lift	205
11	Mast-Vista Two-Stage Full Free Lift	221
12	Mast-Vista Four-Stage Full Free Lift	235
13	Optional	247
14	Index-Numerical	269



TABLE OF CONTENTS

DESCRIPTION	PAGE
Alternator	110-117
Axle-Drive	144-145
Axle-Steering	152-153
Block-Cylinder Diesel	26-27
Block-Cylinder Gasoline LPG	42-43 & 56-57
Brake	160-161
Brake-Park	162-163
Camshaft/Valves Diesel	31
Camshaft/Valves Gasoline LPG	50
Carburetor Gasoline	70-71 & 76-77
Carburetor LPG	72 & 78-79
Carriage Side-Shift	250
Carriage Vista Four-Stage	246
Carriage Vista Free-Lift	234
Carriage Vista Three-Stage	220
Carriage Vista Two-Stage	204
Clutch-Forward/Reverse	136-137
Control-Choke	73
Converter LPG	89
Converter-Torque	133
Cooling Diesel	24-25
Cooling Gasoline LPG	40-41 & 54-55
Counterweight	10
Cowl/Plates-Floor	8
Crankcase/Pan-Oil Diesel	30
Crankcase/Pan-Oil Gasoline LPG	48-49
Crankshaft/Piston/Flywheel Diesel	32-33
Crankshaft/Piston/Flywheel Gasoline LPG	46-47
Cylinder-Lift Vista Four-Stage	244-245
Cylinder-Lift Vista Free-Lift	230-235
Cylinder-Lift Vista Three-Stage	216-219
Cylinder-Lift Vista Two-Stage	202-203
Cylinder-Master	164
Cylinder Side-Shift	251
Cylinder-Steering	156
Cylinder-Tilt	180-181
Differential	138-139
Distributor	106-108
Electrical	94-105
Exhaust Gasoline LPG Diesel	20-21
Extension-Load Backrest	11
Extinguisher-Fire	267
Filter-Air	80-81
Filter-Fuel	82
Filter-Lock-Off	86
Filter-Oil Diesel	37
Filter-Oil Gasoline LPG	52
Flywheel Diesel 2.4L	32-33
Flywheel Gasoline LPG M4-121G	46-47
Flywheel/Drive-Pump Gasoline LPG 4-181	61
Fork	248-249
Fuel Diesel Gasoline	68-69
Fuel LPG (M4-121)	64-65
Fuel LPG (4-181)	66-67
Gear-Timing	34
Governor	74-75
Head-Cylinder Diesel	28-29
Head-Cylinder Gasoline LPG	44-45 & 58-59
Hood/Linkage	9



TABLE OF CONTENTS

DESCRIPTION	PAGE
Hose-Header	252-259
Hydraulic	168-173
Index-Numerical	269
Injection-Fuel	84-85
Labels/Paint	14-15
Lift Vista Four-Stage	240-243
Lift Vista Free-Lift	226-229
Lift Vista Three-Stage	212-215
Lift Vista Two-Stage	200-201
Light-Strobe	262-265
Lights	260-261
Linkage-Brake	165
Linkage-Forward/Reverse	128-131
Linkage Hood	9
Linkage Pedal	158-159
Linkage-Throttle	88-91
Manifold Diesel	35
Manifold Gasoline LPG	51
Mast-Vista Four-Stage Full Free Lift (4-STG FFL)	236-239
Mast-Vista Two-Stage Full Free Lift (2-STG FFL)	222-225
Mast-Vista Three-Stage Full Free Lift (3-STG FFL)	206-211
Mast-Vista Two-Stage Limited Free Lift (2-STG LFL)	196-199
Mount-Engine	22-23
Paint	14-15
Pan-Oil Diesel	30
Pan-Oil Gasoline LPG	48-49
Panel-Instrument	118-121
Pedal/Linkage	158-159
Pedal-Monotrol	92
Piston Diesel	32-33
Piston Gasoline LPG	46-47
Plates-Floor	8
Publications	16-17
Pump-Fuel M4-121G	83
Pump-Hand	154-155
Pump-Hydraulic	174-176
Pump-Oil Diesel	38
Pump-Oil/Filter-Oil Gasoline LPG	52, 60
Pump-Water Diesel	36
Pump-Water Gasoline LPG	53
Seat	12-13
Starter	122-125
Steering	148-151
Switch-Forward/Reverse	132
Tire/Wheel	266
Transmission	134-135
Valve Transmission	140-143
Valve-Flow	177-178
Valve Four Function	192-193
Valve Three Function	188-189
Valve Two Function	184-185
Valve/Attaching Parts Four Function	190-191
Valve/Attaching Parts Three Function	186-187
Valve/Attaching Parts Two Function	182-183
Valves Diesel	31
Valves Gasoline LPG	50
Wheel	266

HOW TO USE THE ILLUSTRATED PARTS MANUAL

This Parts Manual describes and illustrates assemblies, subassemblies and detail parts needed for service replacement.

It also includes all parts peculiar to trucks built in overseas plants. These parts are indicated by keys, symbols and footnotes.

INDEX-MASTER

ACTUATOR 2C08 HYDRAULIC 2E03-2E04
 ALTERNATOR 1P12 INDEX-NUMERICAL F02
 AXLE-DRIVE 2E04 INDEX-NUMERICAL 1E06
 AXLE-STEERING 2E05 INJECTOR-FUEL DIESEL 2E07
 BALANCE-CYLINDER DIESEL LC01 JD
 BALANCE-CYLINDER GASOLINE LPG 1E09 L
 BRAKE 2C07 L
 BRAKE-DRIVE 2C03 L
 CAR CAM-SHAFT/CRANK-SHAFT/PAN-OIL GASOLINE L 3003-3004 L
 COMPRESSOR 2C03 L

INDEX-NUMERICAL

PART NO	PAGE NO	REF NO	PART NO	PAGE NO	REF NO	PART NO	PAGE NO	REF NO	PART NO	PAGE NO	REF NO	PART NO	PAGE NO	REF NO
126	1012	3	15004	1C03	29	15127	1C08	9	19156	1C03	29	15183	1A12	5
138	2A08	14	2801	1C09	6	1F08	30	1F08	30	1C04	24	19200	1012	4
			2801	1C09	1	15132	1E04	22	1C04	21	1C04	21	1014	5
			2C06	33	1E04	27	15134	1E04	41	1C09	15	1E04	21	
139	2A08	12	2801	1P12	45	1F06	16	1C09	14	2C03	12	2E08	7	
			2801	1C08	6	15135	2E07	33	1C09	17	2E08	7	2E12	7
			2C04	30	13008	2A06	28	19152	1906	15	1007	25	2E12	7
142	1014	12	19010	1B14	20	1F08	20	1E04	1	2F02	7	2E08	24	
			1C03	4	19013	2A10	12	1E10	27	2E01	16	2E08	24	
					1012	18	1007	7	1E04	29	2E08	24	2E08	24
								1812	6	1C04	5	19212	1000	16
										1C04	32	19212	1012	11

MOTOR

LAST USED ON PENDING S/M PER ECH 40020 (SEE PAGE A031)

HYSTER COMPANY PARTS ONLY

REF NO	HYSTER PART NO	NAME OF PART	REF NO	HYSTER PART NO
1	318402	MOTOR	1	318402
2	318403	MOTOR	2	318403
3	318404	MOTOR	3	318404
4	318405	HEAD	4	318405
5	318406	SET-SPRING	5	318406
6	318407	SET-SPRING	6	318407
7	318408	HOLDER	7	318408
8	318409	HOLDER	8	318409
9	318410	BEARING	9	318410
10	318411	BEARING	10	318411
11	318412	SET-DRUM	11	318412
12	318413	SET-DRUM	12	318413

INDEX-ILLUSTRATED

REF	ITEM	PAGE
1	FRAME/BODY	1404
2	ENGINE	1E02
3	FUEL	1E02
4	ELECTRICAL	1002
5	TRANSMISSION	1E02
6	STEERING	1F02
7	BRAKE	2A04
8	HYDRAULIC	2E02
9	UPRIGHT-VISTA TWO-STAGE	2E02
10	UPRIGHT-VISTA THREE-STAGE	2E02
11	UPRIGHT-VISTA PREE-LIFT	2F02
12	OPTIONAL	3A04
13	INDEX-NUMERICAL	F02

USE HYSTER *Approved* PARTS... it pays

© 1991 HYSTER COMPANY

See Service Manual for service procedures

HYSTER COMPANY
©1991 HYSTER COMPANY

12/24/91

WHEN THE PART NUMBER AND THE NEXT HIGHER ASSEMBLY IS NOT KNOWN:

1. USE: Determine the function and application of the part required. Turn to the Illustrated Index page immediately behind the front cover, and select the most appropriate area.
2. Use the Division Index to determine the assembly which would normally contain the part required. Proceed then to locate the part on the assembly breakdown page.

WHEN THE PART NUMBER IS NOT KNOWN AND THE NEXT HIGHER ASSEMBLY IS KNOWN;

3. Determine the assembly the required part is used on. Turn to the Master Index page immediately following the Illustrated Index.
4. Locate the assembly the required part is used on and turn to the page indicated for that assembly. Proceed then to locate the part on the assembly breakdown page.

WHEN THE PART NUMBER IS KNOWN;

5. Use the Numerical Index to find the part number. Turn to the page listed and locate the part as indicated by the reference number.

GENERAL:

The Assembly Breakdowns include part numbers, description, quantities required, keys and footnotes to help in selecting the correct parts.

6. Keys are used to show effective serial numbers for two or more similar assemblies, RH and LH assembly parts, etc. Select the appropriate key, "A", "B", "C", or "D" and the corresponding quantity column to find the required parts.
7. Indented descriptions under "Name of Part" are used to indicate subparts of assemblies. A major assembly is not indented. Parts under the first, second, or third indent are sub-parts of the major assembly shown above them.
8. Quantities shown are for one assembly. Note that two assemblies are shown, but the quantities of the subparts are indicated as three and three. This means three per assembly.
9. Engineering Change Notice (ECN) numbers for pending serial numbers are shown to allow for the inclusion of the most current parts information. Contact your local Dealer for Hyster Lift Trucks for serial number information listed by ECN number.

ORDERING PARTS:

When ordering replacement parts, give the unit serial number, part number, name of part and quantity required.

For any further information on parts, service, or ordering, consult your local Dealer for Hyster Lift Trucks.



FRAME

Counterweight	10
Cowl/Plates-Floor	8
Extension-Load Backrest	11
Hood/Linkage	9
Labels/Paint	14-15
Publications	16-17
Seat	12-13

HOOD/LINKAGE

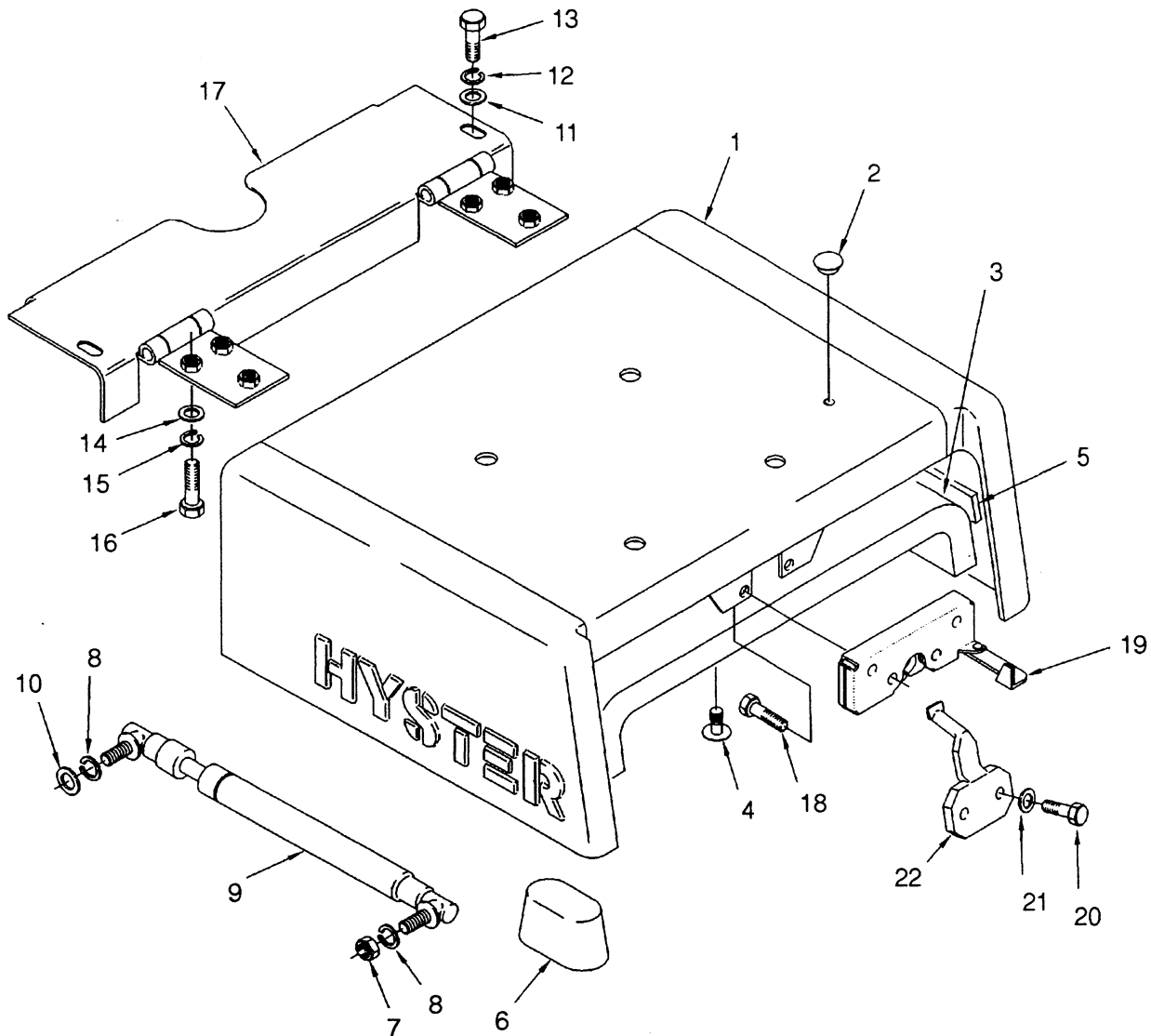

FIGURE 2

REF	PART NO.	NAME OF PART	QTY	REF	PART NO.	NAME OF PART	QTY
1	1320653	Hood	1	14	1300117	Washer	6
2	1307737	Fastener	4	15	292681	Lockwasher	6
3	%*1327870	Liner	1	16	136681	Capscrew-Metric	6
4	%*1304971	Fastener	13	17	1344097	Hinge	1
5	%* 353191	Tape Per Foot	AR	18	199563	Capscrew	4
6	1320610	Bumper	2	19	364857	Latch	1
7	303117	Nut	1	20	302334	Capscrew	2
8	292681	Lockwasher	2	21	320160	Washer	2
9	353021	Spring-Gas	1	22	364861	Striker	1
10	320157	Washer	2				
11	292682	Lockwasher	2				
12	320159	Washer	2				
13	287854	Capscrew	2				

* W/Low Noise
% Mazda And Isuzu

Please Click Here To Download The Complete Manual
Download Other Manuals
If Having Any Questions Feel Free To Contact us

admin@servicemanualbit.com