

PARTS MANUAL

**SPACESAVER
S70XL, S80XL, S100XL,
S120XLS, S120XL**

**S3.50XL, S4.00XL,
S4.50XL, S5.50XLS,
S5.50XL**

(D004)

CUSTOMER EDITION

HYSTER

ILLUSTRATED CONTENTS

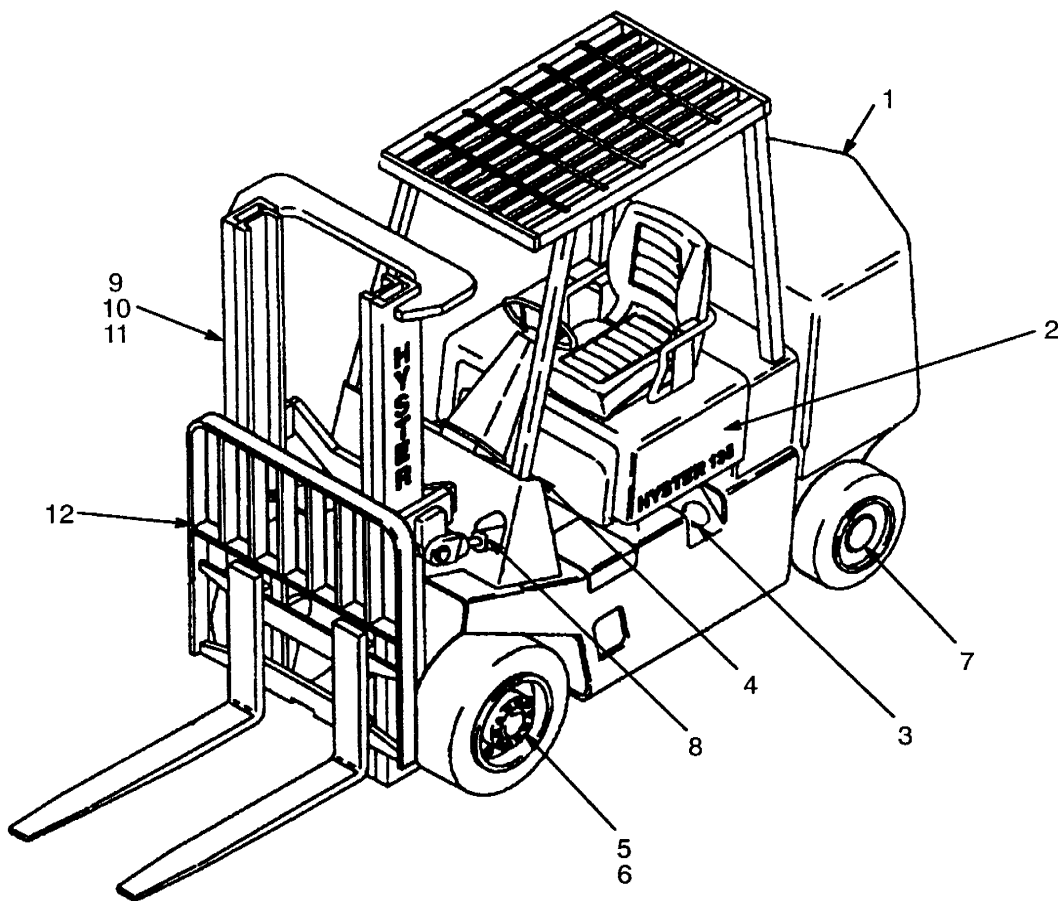

REF	SECTION	PAGE
1	FRAME	1
2	ENGINE	21
3	FUEL	127
4	ELECTRICAL	185
5	TRANSMISSION	303
6	BRAKE	343
7	STEERING	355
8	HYDRAULICS	375
9	TWO-STAGE LIMITED FREE LIFT MAST (A510)	401
10	THREE-STAGE FULL FREE LIFT MAST (A511)	421
11	TWO-STAGE FULL FREE LIFT MAST (A512)	447
12	OPTIONAL EQUIPMENT	477
13	NUMERICAL INDEX	531

TABLE OF CONTENTS

DESCRIPTION	PAGE NO.
A	
ACCELERATOR PEDAL (Figure 87) FORWARD AND REVERSE	Page 168
ACCELERATOR PEDAL (Figure 88) MONOTROL	Page 169
AIR FILTER (Figure 90) LAST USED ON S/N D4V-5018	Page 171
AIR FILTER (Figure 91) USED ON S/N D4V-5019 THRU S/N D4V-10568, FIRST USED ON S/N D4D-1501	Page 172
ALTERNATOR (DELCO) (Figure 129) LAST USED ON S/N: (70-80) (FWD/REV) D4D-4055 (LPG), D4D-4059 (GASOLINE), D4D-4106 (DIESEL) LAST USED ON S/N: (70-80) (MONOTROL) D4D-4223 (LPG), D4D-4257 (GASOLINE), D4D-4219 (DIESEL) LAST USED ON S/N: (100-120) (FWD/REV) D4D-4202 (LPG), D4D-4054 (GASOLINE), D4D-4092 (DIESEL) LAST USED ON S/N: (100-120) (MONOTROL) D4D-4232 (LPG), D4D-4175 (GASOLINE), D4D-4623 (DIESEL)	Page 252
ALTERNATOR (Figure 130) FIRST USED ON S/N: (70-80) (FWD/REV) D4D-4056 (LPG), D4D-4060 (GASOLINE), D4D-4107 (DIESEL) FIRST USED ON S/N: (70-80) (MONOTROL) D4D-4224 (LPG), D4D-4258 (GASOLINE), D4D-4220 (DIESEL) FIRST USED ON S/N: (100-120) (FWD/REV) D4D-4203 (LPG), D4D-4055 (GASOLINE), D4D-4093 (DIESEL) FIRST USED ON S/N: (100-120) (MONOTROL) D4D-4233 (LPG), D4D-4176 (GASOLINE), D4D-4624 (DIESEL) ...	Page 256
ALTERNATOR (Figure 133) TYPES GS, LPS AND DS	Page 262
ALTERNATOR MOUNTING (Figure 134) DIESEL (WITH LOW EMISSIONS)	Page 266
ALTERNATOR (PRESTOLITE) (Figure 131)	Page 258
ALTERNATOR (PRESTOLITE) (Figure 132) GS, LPS, DS	Page 261

TABLE OF CONTENTS

<u>DESCRIPTION</u>	<u>PAGE NO.</u>
B	
BACKUP ALARM (Figure 228)	Page 480
BLOCK FORKS (Figure 236) 48 IN CARRIAGE	Page 493
BLOCK FORKS (Figure 237) 62 IN CARRIAGE	Page 494
BRAKE BOOSTER (Figure 175)	Page 354
BRAKE (Figure 172) LAST USED ON S/N D4V-5227	Page 348
BRAKE (Figure 173) USED ON S/N D4V-5228 THRU S/N D4V-10568, FIRST USED ON S/N D4D-1501	Page 350
BRAKE LINKAGE (Figure 170) LAST USED ON TRANSMISSION S/N: T90M-1400 (70-80) (FWD/REV) T90M-1425 (70-80) (MONOTROL) T90M-1463 (100-120) (FWD/REV) T90M-1506 (100-120) (MONOTROL)	Page 344
BRAKE LINKAGE (Figure 171) FIRST USED ON TRANSMISSION S/N: T90M-1401 (70-80) (FWD/REV) T90M-1426 (70-80) (MONOTROL) T90M-1464 (100-120) (FWD/REV) T90M-1507 (100-120) (MONOTROL)	Page 346
C	
CAMSHAFT AND OIL PAN (Figure 36) GASOLINE AND LPG LAST USED ON S/N D4V-5018	Page 74
CAMSHAFT AND OIL PAN (Figure 37) GASOLINE AND LPG FIRST USED ON S/N D4V-5019	Page 78
CAMSHAFT AND OIL PAN (Figure 38) GASOLINE AND LPG 4LM 1994 SERIES ENGINE	Page 80
CAMSHAFT AND OIL PAN (Figure 39) GASOLINE AND LPG 5LM 1995 SERIES ENGINE	Page 82

TABLE OF CONTENTS

DESCRIPTION	PAGE NO.
C (Continued)	
CAMSHAFT AND OIL PAN (Figure 40) GASOLINE AND LPG	Page 84
CAMSHAFT AND OIL PAN (Figure 41) GASOLINE AND LPG 2000 SERIES ENGINE	Page 86
CARBURETOR (Figure 77) LPG LAST USED ON S/N D4D-1838	Page 154
CARBURETOR (Figure 78) LPG FIRST USED ON S/N D4D-1839	Page 156
CARBURETOR (Figure 80) GASOLINE LAST USED ON S/N D4V-5018	Page 159
CARRIAGE (Figure 205) TWO-STAGE LIMITED FREE-LIFT	Page 418
CARRIAGE (Figure 206) S100XL (S4.50XL) ATTACHMENT TWO-STAGE LIMITED FREE-LIFT	Page 419
CARRIAGE (Figure 216) THREE-STAGE FULL FREE-LIFT	Page 444
CARRIAGE (Figure 217) S100XL (S4.50XL) ATTACHMENT THREE-STAGE FULL FREE-LIFT	Page 445
CARRIAGE (Figure 226) TWO-STAGE FULL FREE-LIFT	Page 474
CARRIAGE (Figure 227) S100XL (S4.50XL) ATTACHMENT TWO-STAGE FULL FREE-LIFT	Page 475
CHOKE (Figure 128) ELECTRIC	Page 250
CLUTCH PACK (Figure 161) LAST USED ON S/N: D4D-6891 (LPG) (70-80) (FWD/REV) D4D-6886 (LPG) (70-80) (MONOTROL) D4D-7135 (GASOLINE) (70-80) (FWD/REV) D4D-7287 (GASOLINE) (70-80) (MONOTROL) D4D-6914 (DIESEL) (70-80) (FWD/REV) PENDING PER ECN 75830 (DIESEL) (70-80) (MONOTROL) SHEET 1 OF 2	Page 324

TABLE OF CONTENTS

<u>DESCRIPTION</u>	<u>PAGE NO.</u>
C (Continued)	
CLUTCH PACK (Figure 162) LAST USED ON S/N: D4D-6892 (LPG) (100-120) (FWD/REV) D4D-6910 (LPG) (100-120) (MONOTROL) D4D-6905 (GASOLINE) (100-120) (FWD/REV) PENDING PER ECN 75830 (GASOLINE) (100-120) (MONOTROL) D4D-6934 (DIESEL) (100-120) (FWD/REV) PENDING PER ECN 75830 (DIESEL) (100-120) (MONOTROL) SHEET 2 OF 2	Page 326
CLUTCH PACK (Figure 163) FIRST USED ON S/N: D4D-6892 (LPG) (70-80) (FWD/REV) D4D-6887 (LPG) (70-80) (MONOTROL) D4D-7136 (GASOLINE) (70-80) (FWD/REV) D4D-7288 (GASOLINE) (70-80) (MONOTROL) D4D-6915 (DIESEL) (70-80) (FWD/REV) PENDING PER ECN 75830 (DIESEL) (70-80) (MONOTROL) SHEET 1 OF 2	Page 328
CLUTCH PACK (Figure 164) FIRST USED ON S/N: D4D-6893 (LPG) (100-120) (FWD/REV) D4D-6911 (LPG) (100-120) (MONOTROL) D4D-6906 (GASOLINE) (100-120) (FWD/REV) PENDING PER ECN 75830 (GASOLINE) (100-120) (MONOTROL) D4D-6935 (DIESEL) (100-120) (FWD/REV) PENDING PER ECN 75830 (DIESEL) (100-120) (MONOTROL) SHEET 2 OF 2	Page 330
CONTROL LEVER LINKAGE (Figure 168) FORWARD AND REVERSE LEVER	Page 338
CONTROL VALVE (Figure 191) TWO FUNCTION	Page 386
CONTROL VALVE (Figure 193) THREE FUNCTION	Page 390
CONTROL VALVE (Figure 195) FOUR FUNCTION	Page 394
CONTROL VALVE (Figure 197) FIVE FUNCTION	Page 398
CONVERTER (Figure 83) LPG LAST USED ON S/N D4V-7314	Page 163
CONVERTER (Figure 84) LPG USED ON S/N D4V-7315 THRU S/N D4V-10568 USED ON S/N D4D-1501 THRU S/N D4D-4656 (70-80) (FWD/REV) USED ON S/N D4D-1501 THRU S/N D4D-4649 (70-80) (MONOTROL) USED ON S/N D4D-1501 THRU S/N D4D-4659 (100-120) (FWD/REV) USED ON S/N D4D-1501 THRU S/N D4D-4648 (100-120) (MONOTROL)	Page 164

TABLE OF CONTENTS

DESCRIPTION	PAGE NO.
C (Continued)	
COOLING (Figure 12)	Page 26
COOLING (Figure 13) DIESEL (WITH LOW EMISSIONS) FIRST USED ON S/N D4D-6084 (70-80) (FWD/REV) FIRST USED ON S/N D4D-6350 (70-80) (MONOTROL) FIRST USED ON S/N D4D-6752 (100-120) (FWD/REV) FIRST USED ON S/N D4D-6538 (100-120) (MONOTROL)	Page 30
COUNTERWEIGHT (Figure 6)	Page 10
CRANKSHAFT AND PISTONS (Figure 46) DIESEL (WITHOUT LOW EMISSIONS) LAST USED ON S/N D4D-6083 (70-80) (FWD/REV) LAST USED ON S/N D4D-6349 (70-80) (MONOTROL) LAST USED ON S/N D4D-6751 (100-120) (FWD/REV) LAST USED ON S/N D4D-6537 (100-120) (MONOTROL)	Page 94
CRANKSHAFT AND PISTONS (Figure 59) DIESEL (WITH LOW EMISSIONS) FIRST USED ON S/N D4D-6084 (70-80) (FWD/REV) FIRST USED ON S/N D4D-6350 (70-80) (MONOTROL) FIRST USED ON S/N D4D-6752 (100-120) (FWD/REV) FIRST USED ON S/N D4D-6538 (100-120) (MONOTROL)	Page 118
CYLINDER BLOCK (Figure 20) GASOLINE LPG LAST USED ON S/N D4V-5018	Page 44
CYLINDER BLOCK (Figure 21) GASOLINE AND LPG FIRST USED ON S/N D4V-5019	Page 46
CYLINDER BLOCK (Figure 22) GASOLINE AND LPG 4LM 1994 SERIES ENGINE	Page 48
CYLINDER BLOCK (Figure 23) GASOLINE AND LPG 5LM 1995 SERIES ENGINE	Page 50
CYLINDER BLOCK (Figure 24) PETROL AND LPG	Page 52
CYLINDER BLOCK (Figure 25) GASOLINE AND LPG 2000 SERIES ENGINE	Page 54
CYLINDER BLOCK (Figure 45) DIESEL (WITHOUT LOW EMISSIONS) LAST USED ON S/N D4D-6083 (70-80) (FWD/REV) LAST USED ON S/N D4D-6349 (70-80) (MONOTROL) LAST USED ON S/N D4D-6751 (100-120) (FWD/REV) LAST USED ON S/N D4D-6537 (100-120) (MONOTROL)	Page 92

TABLE OF CONTENTS

DESCRIPTION	PAGE NO.
C (Continued)	
CYLINDER BLOCK (Figure 57) DIESEL (WITH LOW EMISSIONS) FIRST USED ON S/N D4D-6084 (70-80) (FWD/REV) FIRST USED ON S/N D4D-6350 (70-80) (MONOTROL) FIRST USED ON S/N D4D-6752 (100-120) (FWD/REV) FIRST USED ON S/N D4D-6538 (100-120) (MONOTROL)	Page 114
CYLINDER HEAD (Figure 26) GASOLINE AND LPG LAST USED ON S/N D4V-5018	Page 56
CYLINDER HEAD (Figure 27) GASOLINE AND LPG FIRST USED ON S/N D4V-5019	Page 58
CYLINDER HEAD (Figure 28) GASOLINE AND LPG 4LM 1994 SERIES ENGINE	Page 60
CYLINDER HEAD (Figure 29) GASOLINE AND LPG 5LM 1995 SERIES ENGINE	Page 61
CYLINDER HEAD (Figure 30) GASOLINE AND LPG	Page 62
CYLINDER HEAD (Figure 31) GASOLINE AND LPG 2000 SERIES ENGINE	Page 64
CYLINDER HEAD (Figure 47) DIESEL (WITHOUT LOW EMISSIONS) LAST USED ON S/N D4D-6083 (70-80) (FWD/REV) LAST USED ON S/N D4D-6349 (70-80) (MONOTROL) LAST USED ON S/N D4D-6751 (100-120) (FWD/REV) LAST USED ON S/N D4D-6537 (100-120) (MONOTROL)	Page 96
CYLINDER HEAD (Figure 58) DIESEL (WITH LOW EMISSIONS) FIRST USED ON S/N D4D-6084 (70-80) (FWD/REV) FIRST USED ON S/N D4D-6350 (70-80) (MONOTROL) FIRST USED ON S/N D4D-6752 (100-120) (FWD/REV) FIRST USED ON S/N D4D-6538 (100-120) (MONOTROL)	Page 116

TABLE OF CONTENTS

<u>DESCRIPTION</u>	<u>PAGE NO.</u>
D	
DIFFERENTIAL (Figure 165)	Page 332
DISTRIBUTOR (Figure 140) LAST USED ON S/N D4V-5018	Page 278
DISTRIBUTOR (Figure 141)	Page 279
DISTRIBUTOR (Figure 142)	Page 280
DRIVE AXLE (Figure 166)	Page 334
E	
ELECTRICAL CONTROL (Figure 101) GASOLINE AND LPG USED ON S/N D4V-5019 THRU S/N D4V-10568, USED ON S/N D4D-1501 THRU S/N D4D-1838	Page 196
ELECTRICAL CONTROLS (Figure 105) LPG USED ON S/N D4D-6328 THRU DATE BREAK 12/99 (MONOTROL) (S70-80), USED ON D4D-6263 THRU DATE BREAK 12/99 (FWD/REV) (S70-80), USED ON D4D-6270 THRU DATE BREAK 12/99 (MONOTROL) (S100-120), USED ON D4D-6274 THRU DATE BREAK 12/99 (FWD/REV) (S100-120) SHEET 1 OF 2	Page 206
ELECTRICAL CONTROLS (Figure 106) LPG USED ON S/N D4V-5019 THRU S/N D4V-10568, USED ON S/N D4D-1501 THRU DATE BREAK 12/99 SHEET 2 OF 2	Page 208
ELECTRICAL CONTROLS (Figure 107) GASOLINE USED ON DATE BREAK 3/99 THRU S/N PENDING PER ECN 73189 SHEET 1 OF 2	Page 210
ELECTRICAL CONTROLS (Figure 108) GASOLINE USED ON S/N D4D-1839 THRU S/N PENDING PER ECN 73189 SHEET 2 OF 2	Page 212
ELECTRICAL CONTROLS (Figure 109) GASOLINE USED ON S/N PENDING PER ECN 73189 THRU DATE BREAK 12/99 SHEET 1 OF 2	Page 214

TABLE OF CONTENTS

<u>DESCRIPTION</u>	<u>PAGE NO.</u>
E (Continued)	
ELECTRICAL CONTROLS (Figure 110) GASOLINE USED ON S/N PENDING PER ECN 73189 THRU DATE BREAK 12/99 SHEET 2 OF 2	Page 216
ELECTRICAL CONTROLS (Figure 113) GASOLINE FIRST USED ON DATE BREAK 12/99	Page 222
ELECTRICAL CONTROLS (Figure 116) LPG FIRST USED ON DATE BREAK 12/99	Page 228
ELECTRICAL SYSTEM (Figure 100) GASOLINE AND LPG USED ON S/N D4V-5019 THRU S/N D4V-10568, USED ON S/N D4D-1501 THRU S/N D4D-1838	Page 192
ELECTRICAL SYSTEM (Figure 102) GASOLINE AND LPG USED ON S/N D4D-1839 THRU S/N D4D-6327 (MONOTROL) (70-80) (LPG) USED ON S/N D4D-1839 THRU S/N D4D-6262 (FWD/REV) (70-80) (LPG) USED ON S/N D4D-1839 THRU S/N D4D-6269 (MONOTROL) (100-120) (LPG) USED ON S/N D4D-1839 THRU S/N D4D-6273 (FWD/REV) (100-120) (LPG) USED ON S/N D4D-1839 THRU DATE BREAK 3/99 (GASOLINE)	Page 198
ELECTRICAL SYSTEM (Figure 103) GASOLINE AND LPG USED ON S/N D4D-6328 THRU DATE BREAK 12/99 (MONOTROL) (70-80) (LPG) USED ON S/N D4D-6263 THRU DATE BREAK 12/99 (FWD/REV) (70-80) (LPG) USED ON S/N D4D-6270 THRU DATE BREAK 12/99 (MONOTROL) (100-120) (LPG) USED ON S/N D4D-6274 THRU DATE BREAK 12/99 (FWD/REV) (100-120) (LPG) USED ON DATE BREAK 3/99 THRU DATE BREAK 12/99 (GASOLINE)	Page 202
ELECTRICAL SYSTEM (Figure 104) GASOLINE AND LPG BATTERY DISCONNECT USED ON S/N D4D-1677 THRU DATE BREAK 12/99	Page 204
ELECTRICAL SYSTEM (Figure 111) GASOLINE FIRST USED ON DATE BREAK 12/99	Page 218
ELECTRICAL SYSTEM (Figure 112) GS FIRST USED ON DATE BREAK 12/99	Page 220

TABLE OF CONTENTS

DESCRIPTION	PAGE NO.
E (Continued)	
ELECTRICAL SYSTEM (Figure 114) LPG FIRST USED ON DATE BREAK 12/99	Page 224
ELECTRICAL SYSTEM (Figure 115) LS FIRST USED ON DATE BREAK 12/99	Page 226
ELECTRICAL SYSTEM (Figure 117) DIESEL LAST USED ON DATE BREAK 12/99	Page 230
ELECTRICAL SYSTEM (Figure 118) TYPE DS LAST USED ON DATE BREAK 12/99	Page 232
ELECTRICAL SYSTEM (Figure 119) DIESEL FIRST USED ON DATE BREAK 12/99	Page 234
ELECTRICAL SYSTEM (Figure 120) TYPE DS FIRST USED ON DATE BREAK 12/99	Page 236
ELECTRICAL SYSTEM (Figure 99) GASOLINE AND LPG LAST USED ON S/N D4V-5018	Page 190
ENGINE MOUNTS (Figure 18)	Page 40
EXHAUST (Figure 16) COUNTERWEIGHT	Page 36
EXHAUST (Figure 17) OVERHEAD	Page 38
F	
FILTER AND LOCK-OFF (Figure 82) LPG	Page 162
FIRE EXTINGUISHER (Figure 230)	Page 483
FLOORPLATES (Figure 3) LAST USED ON DATE BREAK 7/99	Page 6
FLOORPLATES (Figure 4) FIRST USED ON DATE BREAK 7/99	Page 8

TABLE OF CONTENTS

<u>DESCRIPTION</u>	<u>PAGE NO.</u>
F (Continued)	
FLYWHEEL HOUSING (Figure 19)	Page 42
FORKS (Figure 235) HOOK TYPE	Page 492
FORWARD AND REVERSE SWITCH (Figure 169)	Page 340
FREE-LIFT CYLINDER (Figure 215) THREE-STAGE FULL FREE-LIFT	Page 442
FREE-LIFT (Figure 213) THREE-STAGE FULL FREE-LIFT	Page 434
FREE-LIFT (Figure 221) TWO-STAGE FULL FREE-LIFT	Page 458
FUEL (Figure 63) GASOLINE LAST USED ON S/N D4V-5018	Page 130
FUEL (Figure 64) GASOLINE USED ON S/N D4V-5019 THRU S/N D4V-10568 FIRST USED ON S/N D4D-1501	Page 132
FUEL (Figure 65) DIESEL	Page 134
FUEL (Figure 66) LPG LAST USED ON S/N D4V-2449	Page 136
FUEL (Figure 67) LPG USED ON S/N D4V-2450 THRU S/N D4V-4459	Page 138
FUEL (Figure 68) LPG USED ON S/N D4V-4460 THRU S/N D4V-5018	Page 140
FUEL (Figure 69) LPG USED ON S/N D4V-5019 THRU S/N D4V-10568, USED ON S/N D4D-1501 THRU S/N D4D-1838	Page 142
FUEL (Figure 70) LPG FIRST USED ON S/N D4D-1839	Page 144

TABLE OF CONTENTS

<u>DESCRIPTION</u>	<u>PAGE NO.</u>
F (Continued)	
FUEL TANK BRACKET (Figure 76) LPG UK AND EUROPE USED ON S/N D4V-10565 THRU S/N D4V-10568, FIRST USED ON S/N D4D-1501	Page 153
FUEL TANK (Figure 71) GASOLINE: LAST USED ON S/N D4V-5018 DIESEL: ALL TRUCKS	Page 146
FUEL TANK (Figure 72) GASOLINE USED ON S/N D4V-5019 THRU S/N D4V-10568, FIRST USED ON S/N D4D-1501	Page 148
FUEL TANK (Figure 73) LPG U.S.	Page 150
G	
GAUGE CLUSTER, LH (Figure 127)	Page 249
GAUGE CLUSTER, RH (Figure 126)	Page 248
GOVERNOR (Figure 79) FIRST USED ON S/N D4D-1839	Page 158
H	
HEADER HOSE (Figure 249) THREE AND FOUR FUNCTION CONTROL VALVE TWO-STAGE LIMITED FREE-LIFT	Page 514
HEADER HOSE (Figure 250) FIVE FUNCTION CONTROL VALVE S70-120XL (S3.50-5.50XL) WIDE TWO-STAGE LIMITED FREE-LIFT	Page 516
HEADER HOSE (Figure 251) THREE AND FOUR FUNCTION CONTROL VALVE THREE-STAGE FULL FREE-LIFT	Page 520
HEADER HOSE (Figure 252) FIVE FUNCTION CONTROL VALVE THREE-STAGE FULL FREE-LIFT	Page 522
HEADER HOSE (Figure 253) THREE AND FOUR FUNCTION CONTROL VALVE TWO-STAGE FULL FREE-LIFT	Page 526

TABLE OF CONTENTS

<u>DESCRIPTION</u>	<u>PAGE NO.</u>
H (Continued)	
HEADER HOSE (Figure 254) FIVE FUNCTION CONTROL VALVE TWO-STAGE FULL FREE-LIFT	Page 528
HIGH PRESSURE FUEL INJECTION (Figure 92) DIESEL (WITHOUT LOW EMISSIONS) LAST USED ON S/N D4D-6083 (70-80) (FWD/REV) LAST USED ON S/N D4D-6349 (70-80) (MONOTROL) LAST USED ON S/N D4D-6751 (100-120) (FWD/REV) LAST USED ON S/N D4D-6537 (100-120) (MONOTROL)	Page 174
HIGH PRESSURE FUEL INJECTION (Figure 93) DIESEL (WITH LOW EMISSIONS) FIRST USED ON S/N D4D-6084 (70-80) (FWD/REV) FIRST USED ON S/N D4D-6350 (70-80) (MONOTROL) FIRST USED ON S/N D4D-6752 (100-120) (FWD/REV) FIRST USED ON S/N D4D-6538 (100-120) (MONOTROL)	Page 176
HOOD (Figure 2)	Page 4
HYDRAULIC (Figure 186) LAST USED ON S/N D4V-4504	Page 376
HYDRAULIC (Figure 187) USED ON S/N D4V-4505 THRU S/N D4V-10568, FIRST USED ON S/N D4D-1501	Page 378
HYDRAULIC PUMP (Figure 188)	Page 380
I	
INNER MAST (Figure 201) TWO-STAGE LIMITED FREE-LIFT	Page 408
INNER MAST (Figure 211) THREE-STAGE FULL FREE-LIFT	Page 430
INNER MAST (Figure 219) TWO-STAGE FULL FREE-LIFT	Page 452
INSTRUMENT PANEL (Figure 122) LAST USED ON S/N D4V-3999	Page 240
INSTRUMENT PANEL (Figure 123) USED ON S/N D4V-4000 THRU S/N D4V-5018	Page 242
INSTRUMENT PANEL (Figure 124) USED ON S/N D4V-5019 THRU S/N D4V-5645	Page 244

TABLE OF CONTENTS

DESCRIPTION	PAGE NO.
I (Continued)	
INSTRUMENT PANEL (Figure 125) USED ON S/N D4V-5646 THRU S/N D4V-10568, FIRST USED ON S/N D4D-1501	Page 246
INTERMEDIATE MAST (Figure 210) THREE-STAGE FULL FREE-LIFT	Page 428
L	
LABELS (Figure 1)	Page 2
LIFT CYLINDER (Figure 203) S70-80XL (S3.50-4.00XL) TWO-STAGE LIMITED FREE-LIFT	Page 414
LIFT CYLINDER (Figure 204) S100-120XL (S4.50-5.50XL) TWO-STAGE LIMITED FREE-LIFT	Page 416
LIFT CYLINDER (Figure 225) FREE-LIFT TWO-STAGE FULL FREE-LIFT	Page 472
LIFT (Figure 202) TWO-STAGE LIMITED FREE-LIFT	Page 410
LIFT PUMP (Figure 97) DIESEL (WITHOUT LOW EMISSIONS) LAST USED ON S/N D4D-6083 (70-80) (FWD/REV) LAST USED ON S/N D4D-6349 (70-80) (MONOTROL) LAST USED ON S/N D4D-6751 (100-120) (FWD/REV) LAST USED ON S/N D4D-6537 (100-120) (MONOTROL)	Page 183
LIFT PUMP (Figure 98) DIESEL (WITH LOW EMISSIONS) FIRST USED ON S/N D4D-6084 (70-80) (FWD/REV) FIRST USED ON S/N D4D-6350 (70-80) (MONOTROL) FIRST USED ON S/N D4D-6752 (100-120) (FWD/REV) FIRST USED ON S/N D4D-6538 (100-120) (MONOTROL)	Page 184
LIFTING EYE (Figure 233)	Page 488
LIGHTS (Figure 234)	Page 490
LOAD BACKREST EXTENSION (Figure 11)	Page 20
LOW PRESSURE FUEL INJECTION (Figure 94) DIESEL (WITHOUT LOW EMISSIONS) LAST USED ON S/N D4D-6083 (70-80) (FWD/REV) LAST USED ON S/N D4D-6349 (70-80) (MONOTROL) LAST USED ON S/N D4D-6751 (100-120) (FWD/REV) LAST USED ON S/N D4D-6537 (100-120) (MONOTROL)	Page 178

TABLE OF CONTENTS

<u>DESCRIPTION</u>	<u>PAGE NO.</u>
L (Continued)	
LOW PRESSURE FUEL INJECTION (Figure 95) DIESEL (WITH LOW EMISSIONS) FIRST USED ON S/N D4D-6084 (70-80) (FWD/REV) FIRST USED ON S/N D4D-6350 (70-80) (MONOTROL) FIRST USED ON S/N D4D-6752 (100-120) (FWD/REV) FIRST USED ON S/N D4D-6538 (100-120) (MONOTROL)	Page 180
LPG CONVERTER (Figure 85) FIRST USED ON S/N D4D-4657 (70-80) (FWD/REV) FIRST USED ON S/N D4D-4650 (70-80) (MONOTROL) FIRST USED ON S/N D4D-4660 (100-120) (FWD/REV) FIRST USED ON S/N D4D-4649 (100-120) (MONOTROL)	Page 165
LPG TANK MOUNTING (Figure 74) U.S.	Page 151
LPG TANK MOUNTING (Figure 75) BOXCAR SPECIAL	Page 152
M	
MAIN LIFT CYLINDER (Figure 214) THREE-STAGE FULL FREE-LIFT	Page 438
MAIN LIFT CYLINDER (Figure 222) LAST USED ON S/N A512D-1645, A512D -1659, A512D-1666 AND A512E-1950 TWO-STAGE FULL FREE-LIFT	Page 462
MAIN LIFT CYLINDER (Figure 223) USED ON S/N A512D-1660 (108.5 IN) THRU S/N PENDING PER ECN 85020-76, USED ON S/N A512D-1646 (119.0 IN) THRU S/N PENDING PER ECN 85020-76, USED ON S/N A512E-1951 (133.5 IN) THRU S/N PENDING PER ECN 85020-76, USED ON S/N A512D-1667 (143.5 IN) THRU S/N PENDING PER ECN 85020-76 TWO-STAGE FULL FREE-LIFT	Page 464
MAIN LIFT CYLINDER (Figure 224) FIRST USED ON S/N PENDING PER ECN 85020-76 TWO-STAGE FULL FREE-LIFT	Page 468
MAIN LIFT (Figure 212) THREE-STAGE FULL FREE-LIFT	Page 432
MAIN LIFT (Figure 220) TWO-STAGE FULL FREE-LIFT	Page 454
MANIFOLDS (Figure 52) DIESEL (WITHOUT LOW EMISSIONS) LAST USED ON S/N D4D-6083 (70-80) (FWD/REV) LAST USED ON S/N D4D-6349 (70-80) (MONOTROL) LAST USED ON S/N D4D-6751 (100-120) (FWD/REV) LAST USED ON S/N D4D-6537 (100-120) (MONOTROL)	Page 105

TABLE OF CONTENTS

DESCRIPTION	PAGE NO.
M (Continued)	
MANIFOLDS (Figure 53) DIESEL (WITH LOW EMISSIONS) FIRST USED ON S/N D4D-6084 (70-80) (FWD/REV) FIRST USED ON S/N D4D-6350 (70-80) (MONOTROL) FIRST USED ON S/N D4D-6752 (100-120) (FWD/REV) FIRST USED ON S/N D4D-6538 (100-120) (MONOTROL)	Page 106
MONOTROL PEDAL (Figure 89)	Page 170
O	
OIL FILTER (Figure 51) DIESEL (WITHOUT LOW EMISSIONS) LAST USED ON S/N D4D-6083 (70-80) (FWD/REV) LAST USED ON S/N D4D-6349 (70-80) (MONOTROL) LAST USED ON S/N D4D-6751 (100-120) (FWD/REV) LAST USED ON S/N D4D-6537 (100-120) (MONOTROL)	Page 104
OIL PAN AND PUMP (Figure 61) DIESEL (WITH LOW EMISSIONS) FIRST USED ON S/N D4D-6084 (70-80) (FWD/REV) FIRST USED ON S/N D4D-6350 (70-80) (MONOTROL) FIRST USED ON S/N D4D-6752 (100-120) (FWD/REV) FIRST USED ON S/N D4D-6538 (100-120) (MONOTROL)	Page 122
OIL PAN (Figure 49) DIESEL (WITHOUT LOW EMISSIONS) LAST USED ON S/N D4D-6083 (70-80) (FWD/REV) LAST USED ON S/N D4D-6349 (70-80) (MONOTROL) LAST USED ON S/N D4D-6751 (100-120) (FWD/REV) LAST USED ON S/N D4D-6537 (100-120) (MONOTROL)	Page 100
OIL PUMP (Figure 42) GASOLINE AND LPG LAST USED ON S/N D4V-5018	Page 88
OIL PUMP (Figure 43) GASOLINE AND LPG FIRST USED ON S/N D4V-5019	Page 89
OIL PUMP (Figure 44) GASOLINE AND LPG 1994-2000 SERIES ENGINE	Page 90
OUTER MAST (Figure 198) LAST USED ON DATE BREAK 9/89 TWO-STAGE LIMITED FREE-LIFT	Page 402
OUTER MAST (Figure 199) USED ON DATE BREAK 9/89 THRU DATE BREAK 11/98 TWO-STAGE LIMITED FREE-LIFT	Page 404

TABLE OF CONTENTS

DESCRIPTION	PAGE NO.
O (Continued)	
OUTER MAST (Figure 200) FIRST USED IN DATE BREAK 11/98 TWO-STAGE LIMITED FREE-LIFT	Page 406
OUTER MAST (Figure 207) LAST USED ON S/N A511D-2136 (70-80) LAST USED ON S/N A511D-2142 (100-120) THREE-STAGE FULL FREE-LIFT	Page 422
OUTER MAST (Figure 208) USED ON S/N A511D-2137 THRU S/N A511D-2659 (70-80) USED ON S/N A511D-2143 THRU S/N A511D-2659 (100-120) THREE-STAGE FULL FREE-LIFT	Page 424
OUTER MAST (Figure 209) FIRST USED ON S/N A511D-2660 THREE-STAGE FULL FREE-LIFT	Page 426
OUTER MAST (Figure 218) TWO-STAGE FULL FREE-LIFT	Page 448
OVERHEAD GUARD (Figure 5)	Page 9
P	
PARK BRAKE (Figure 174)	Page 352
S	
SEAT (Figure 10) WITH OPERATOR RESTRAINT LPG AND BOXCAR SPECIAL	Page 18
SEAT (Figure 7) WITHOUT OPERATOR RESTRAINT GASOLINE AND DIESEL	Page 12
SEAT (Figure 8) WITHOUT OPERATOR RESTRAINT LPG AND BOXCAR SPECIAL	Page 14
SEAT (Figure 9) WITH OPERATOR RESTRAINT GASOLINE AND DIESEL	Page 16
SERPENTINE BELT DRIVE (Figure 14) GASOLINE AND LPG USED ON S/N D4V-8505 EXCEPT 8543,8546,8557,8571,8578,8591, 8606,8618 THRU S/N D4V-10568, USED ON S/N D4D-1501 THRU S/N D4D-1838	Page 32

TABLE OF CONTENTS

DESCRIPTION	PAGE NO.
S (Continued)	
SERPENTINE BELT DRIVE (Figure 15) GASOLINE AND LPG FIRST USED ON S/N D4D-1839	Page 34
SIDESHIFT CARRIAGE (Figure 238) 131900 SERIES HOOK TYPE TWO-STAGE LIMITED FREE-LIFT	Page 496
SIDESHIFT CARRIAGE (Figure 239) 131900 SERIES HOOK TYPE THREE-STAGE FULL FREE-LIFT	Page 498
SIDESHIFT CARRIAGE (Figure 240) 131900 SERIES HOOK TYPE TWO-STAGE FULL FREE-LIFT	Page 500
SIDESHIFT CARRIAGE (Figure 241) 1356000 SERIES	Page 502
SIDESHIFT CARRIAGE (Figure 244) PIN TYPE S70-80XL (S3.50-4.00XL) TWO-STAGE LIMITED FREE-LIFT	Page 506
SIDESHIFT CARRIAGE (Figure 245) PIN TYPE S70-80XL (S3.50-4.00XL) THREE-STAGE FULL FREE-LIFT AND TWO-STAGE FULL FREE-LIFT	Page 508
SIDESHIFT CARRIAGE (Figure 246) PIN TYPE S100-120XL (S4.50XL- 5.50XL)	Page 510
SIDESHIFT CYLINDER (Figure 242) 1319000 SERIES	Page 504
SIDESHIFT CYLINDER (Figure 243) 1356000 SERIES	Page 505
SIDESHIFT CYLINDER (Figure 247) PIN TYPE IDENTIFY BY PART NUMBER	Page 512
SIDESHIFT CYLINDER (Figure 248) PIN TYPE IDENTIFY BY PART NUMBER	Page 513

TABLE OF CONTENTS

<u>DESCRIPTION</u>	<u>PAGE NO.</u>
S (Continued)	
SPARK PLUG WIRES (Figure 121)	Page 238
STARTER (Figure 135) GASOLINE AND LPG LAST USED ON S/N D4V-10291	Page 268
STARTER (Figure 136) GASOLINE AND LPG USED ON S/N D4V-10292 THRU S/N D4V-10568, USED ON S/N D4D-1501 THRU S/N D4D-1838	Page 270
STARTER (Figure 137) GASOLINE AND LPG FIRST USED ON S/N D4D-1839	Page 272
STARTER (Figure 138) DIESEL	Page 274
STARTER (Figure 139) DIESEL OPTIONAL	Page 276
STEERING AXLE (Figure 185)	Page 372
STEERING COLUMN (Figure 180) USED ON S/N D4V-5646 THRU S/N D4V-10568, FIRST USED ON S/N D4D-1501	Page 364
STEERING CONTROL UNIT (Figure 182) LAST USED ON S/N D4V-2948 INCLUDING 2958, EXCEPT 2929 USED ON S/N D4V-5101 THRU S/N D4V-10568, FIRST USED ON S/N D4D-1501	Page 367
STEERING CONTROL UNIT (Figure 183) USED ON S/N D4V-2949 INCLUDING 2929, EXCEPT 2958 THRU S/N D4V-5100	Page 368
STEERING CYLINDER (Figure 184)	Page 370
STEERING (Figure 179) LAST USED ON S/N D4V-5645	Page 362
STEERING (Figure 181) USED ON S/N D4V-2949 EXCEPT 2958 THRU S/N D4V-5100	Page 366
STEERING HYDRAULIC (Figure 176) LAST USED ON S/N D4V-2948	Page 356

TABLE OF CONTENTS

DESCRIPTION	PAGE NO.
S (Continued)	
STEERING HYDRAULIC (Figure 177) USED ON S/N D4V-2949 THRU S/N D4V-5100	Page 358
STEERING HYDRAULIC (Figure 178) USED ON S/N D4V-5101 THRU S/N D4V-10568, FIRST USED ON S/N D4D-1501	Page 360
STROBE LIGHT (Figure 231) MEDIUM INTENSITY	Page 484
STROBE LIGHT (Figure 232) HIGH INTENSITY	Page 486
T	
THROTTLE BODY INJECTOR (Figure 81) USED ON S/N D4V-5019 THRU S/N D4V-10568, FIRST USED ON S/N D4D-1501	Page 160
THROTTLE LINKAGE (Figure 86)	Page 166
TILT CYLINDER (Figure 189)	Page 382
TIMING GEAR (Figure 48) DIESEL (WITHOUT LOW EMISSIONS) LAST USED ON S/N D4D-6083 (70-80) (FWD/REV) LAST USED ON S/N D4D-6349 (70-80) (MONOTROL) LAST USED ON S/N D4D-6751 (100-120) (FWD/REV) LAST USED ON S/N D4D-6537 (100-120) (MONOTROL)	Page 98
TIMING GEAR (Figure 60) DIESEL (WITH LOW EMISSIONS) FIRST USED ON S/N D4D-6084 (70-80) (FWD/REV) FIRST USED ON S/N D4D-6350 (70-80) (MONOTROL) FIRST USED ON S/N D4D-6752 (100-120) (FWD/REV) FIRST USED ON S/N D4D-6538 (100-120) (MONOTROL)	Page 120
TIRE AND WHEEL (Figure 229)	Page 482
TORQUE CONVERTER (Figure 167)	Page 336
TRANSMISSION CONTROL VALVE (Figure 155) LAST USED ON TRANSMISSION S/N T90M-1400 (70-80) (FWD/REV) LAST USED ON TRANSMISSION S/N T90M-1425 (70-80) (MONOTROL) LAST USED ON TRANSMISSION S/N T90M-1463 (100-120) (FWD/REV) LAST USED ON TRANSMISSION S/N T90M-1506 (100-120) (MONOTROL)	Page 310

TABLE OF CONTENTS

<u>DESCRIPTION</u>	<u>PAGE NO.</u>
T (Continued)	
TRANSMISSION CONTROL VALVE (Figure 156) FIRST USED ON TRANSMISSION S/N T90M-1401 (70-80) (FWD/REV) FIRST USED ON TRANSMISSION S/N T90M-1426 (70-80) (MONOTROL) FIRST USED ON TRANSMISSION S/N T90M-1464 (100-120) (FWD/REV) FIRST USED ON TRANSMISSION S/N T90M-1507 (100-120) (MONOTROL) SHEET 1 OF 2	Page 314
TRANSMISSION CONTROL VALVE (Figure 157) FIRST USED ON TRANSMISSION S/N T90M-1401 (70-80) (FWD/REV) FIRST USED ON TRANSMISSION S/N T90M-1426 (70-80) (MONOTROL) FIRST USED ON TRANSMISSION S/N T90M-1464 (100-120) (FWD/REV) FIRST USED ON TRANSMISSION S/N T90M-1507 (100-120) (MONOTROL) SHEET 2 OF 2	Page 316
TRANSMISSION (Figure 153) LAST USED ON TRANSMISSION S/N T90M-1400 (70-80) (FWD/REV) LAST USED ON TRANSMISSION S/N T90M-1425 (70-80) (MONOTROL) LAST USED ON TRANSMISSION S/N T90M-1463 (100-120) (FWD/REV) LAST USED ON TRANSMISSION S/N T90M-1506 (100-120) (MONOTROL)	Page 306
TRANSMISSION (Figure 154) FIRST USED ON TRANSMISSION S/N T90M-1401 (70-80) (FWD/REV) FIRST USED ON TRANSMISSION S/N T90M-1426 (70-80) (MONOTROL) FIRST USED ON TRANSMISSION S/N T90M-1464 (100-120) (FWD/REV) FIRST USED ON TRANSMISSION S/N T90M-1507 (100-120) (MONOTROL)	Page 308
TRANSMISSION HYDRAULIC LINES (Figure 158) LAST USED ON S/N D4V-3956	Page 318
TRANSMISSION HYDRAULIC LINES (Figure 159) USED ON S/N D4V-3957 THRU S/N D4V-10568, USED ON S/N D4D-1501 THRU TRANSMISSION S/N: T90M-1400 (70-80) (FWD/REV) T90M-1425 (70-80) (MONOTROL) T90M-1463 (100-120) (FWD/REV) T90M-1506 (100-120) (MONOTROL)	Page 320

TABLE OF CONTENTS

DESCRIPTION	PAGE NO.
T (Continued)	
TRANSMISSION HYDRAULIC LINES (Figure 160) FIRST USED ON TRANSMISSION S/N T90M-1401 (70-80) (FWD/REV) FIRST USED ON TRANSMISSION S/N T90M-1426 (70-80) (MONOTROL) FIRST USED ON TRANSMISSION S/N T90M-1464 (100-120) (FWD/REV) FIRST USED ON TRANSMISSION S/N T90M-1507 (100-120) (MONOTROL)	Page 322
V	
VALVE AND ATTACHING PARTS (Figure 190) TWO FUNCTION	Page 384
VALVE AND ATTACHING PARTS (Figure 192) THREE FUNCTION	Page 388
VALVE AND ATTACHING PARTS (Figure 194) FOUR FUNCTION	Page 392
VALVE AND ATTACHING PARTS (Figure 196) FIVE FUNCTION	Page 396
VALVE COVER AND INLET MANIFOLD (Figure 34) GASOLINE AND LPG	Page 70
VALVE COVER AND INLET MANIFOLD (Figure 35) GASOLINE AND LPG 2000 SERIES ENGINE	Page 72
VALVE COVER AND ROCKER SHAFT (Figure 62) DIESEL (WITH LOW EMISSIONS) FIRST USED ON S/N D4D-6084 (70-80) (FWD/REV) FIRST USED ON S/N D4D-6350 (70-80) (MONOTROL) FIRST USED ON S/N D4D-6752 (100-120) (FWD/REV) FIRST USED ON S/N D4D-6538 (100-120) (MONOTROL)	Page 124
VALVE COVER (Figure 50) DIESEL (WITHOUT LOW EMISSIONS) LAST USED ON S/N D4D-6083 (70-80) (FWD/REV) LAST USED ON S/N D4D-6349 (70-80) (MONOTROL) LAST USED ON S/N D4D-6751 (100-120) (FWD/REV) LAST USED ON S/N D4D-6537 (100-120) (MONOTROL)	Page 102
VALVE COVERS AND INLET MANIFOLD (Figure 32) GASOLINE AND LPG 4LM 1994 SERIES ENGINE	Page 66
VALVE COVERS AND INLET MANIFOLD (Figure 33) GASOLINE AND LPG 5LM 1995 SERIES ENGINE	Page 68

TABLE OF CONTENTS

<u>DESCRIPTION</u>	<u>PAGE NO.</u>
W	
WATER PUMP (Figure 54) DIESEL (WITHOUT LOW EMISSIONS) LAST USED ON S/N D4D-6083 (70-80) (FWD/REV) LAST USED ON S/N D4D-6349 (70-80) (MONOTROL) LAST USED ON S/N D4D-6751 (100-120) (FWD/REV) LAST USED ON S/N D4D-6537 (100-120) (MONOTROL)	Page 108
WATER PUMP (Figure 55) DIESEL (WITH LOW EMISSIONS) USED ON S/N D4D-6084 (70-80) (FWD/REV) THRU ENGINE S/N U892125D USED ON S/N D4D-6350 (70-80) (MONOTROL) THRU ENGINE S/N U892125D USED ON S/N D4D-6752 (100-120) (FWD/REV) THRU ENGINE S/N U892125D USED ON S/N D4D-6538 (100-120) (MONOTROL) THRU ENGINE S/N U892125D	Page 110
WATER PUMP (Figure 56) DIESEL (WITH LOW EMISSIONS) FIRST USED ON ENGINE S/N U892126D	Page 112
WATER SEPARATOR FILTER (Figure 96) DIESEL	Page 182
WIRE HARNESS (ENGINE) (Figure 143) LPG USED ON S/N D4V-5019 THRU S/N D4V-10568, USED ON S/N D4D-1501 THRU S/N D4D-1838	Page 282
WIRE HARNESS (ENGINE) (Figure 144) LPG FIRST USED ON S/N D4D-1839	Page 284
WIRE HARNESS (ENGINE) (Figure 151) GASOLINE USED ON S/N D4V-5019 THRU S/N D4V-10568, USED ON S/N D4D-1501 THRU S/N PENDING PER ECN 73189	Page 296
WIRE HARNESS (ENGINE) (Figure 152) GASOLINE FIRST USED ON S/N PENDING PER ECN 73189	Page 300
WIRE HARNESS (GOVERNOR) (Figure 150) USED ON D4V-5019 THRU S/N D4V-10568, FIRST USED ON S/N D4D-1501	Page 294
WIRE HARNESS (MAIN INSTRUMENT) (Figure 148) GASOLINE AND LPG USED ON S/N D4V-5019 THRU S/N D4V-10568, FIRST USED ON S/N D4D-1501	Page 290

TABLE OF CONTENTS

DESCRIPTION	PAGE NO.
W (Continued)	
WIRE HARNESS (MAIN INSTRUMENT) (Figure 149) DIESEL FIRST USED ON S/N D4D-8197	Page 292
WIRE HARNESS (NEUTRAL START) (Figure 146) MONOTROL USED ON S/N D4V-5019 THRU S/N D4V-10568, FIRST USED ON S/N D4D-1501	Page 287
WIRE HARNESS (NEUTRAL START) (Figure 147) FORWARD AND REVERSE USED ON S/N D4V-5019 THRU S/N D4V-10568, FIRST USED ON S/N D4D-1501	Page 288
WIRE HARNESS (OIL CLUTCH) (Figure 145) USED ON S/N D4V-5019 THRU S/N D4V-10568, FIRST USED ON S/N D4D-1501	Page 286

HOW TO USE THE ILLUSTRATED PARTS MANUAL

This parts manual describes and illustrates assemblies, subassemblies, and detail parts needed for service replacement.

The different constructions are indicated by keys, symbols and footnotes.

HYSTER SERIAL CODE D177-U.S.

3 → DESCRIPTION → **TABLE OF CONTENTS**

→ PAGE NO.

STEERING CONTROL UNIT (Figure 173) → A → 4 → Page 316
LAST USED ON S/N PENDING PER ECN 59650-27

STEERING CONTROL UNIT (Figure 173) → 5

HYSTER SERIAL CODE D177

NUMERICAL INDEX

PART NO	PAGE NO	REF NO	PART NO	PAGE NO	REF NO	PART NO	PAGE NO	REF NO	PART NO	PAGE NO	REF NO	PART NO	PAGE NO
126	171	14	14386	209	39	149	43	303	15	8	311	19	16187
142	175	17						15223	367	9	15225	305	203
								15227	305	29	15236	305	207
								327	14	16192	327	14	209
								351	3	135	351	3	71
								352	3	137	352	3	2
								381	3	16374	381	3	59
								497	3	16379	497	3	31
										18480			57
													37
													333
													28

SERIAL CODE D177-U.S.

HYSTER

1 → ILLUSTRATED CONTENTS

9 10 11

6

4

12

5

2

REF	SECTION
1	Frame
2	Engine
3	Fuel System
4	Electrical System
5	Transmission
6	Steering System
7	Brake System
8	Hydraulic System
9	Two Stage Limited
10	Three Stage Full Fr
11	Two Stage Full Fre
12	Optional
13	Numerical Index

©1997 HYSTER COMPANY

Page 441
SERIAL CODE D177-U.S.

HYSTER

9 → LAST USED ON S/N PENDING PER ECN 98765

CARRIAGE (Figure 233)
TWO STAGE FFL
SIX ROLLER

2 5 3

4

2 3

10 8 9

4 2 3

6

REF.	PART NO.	NAME OF PART	QTY
a		Carriage Assy	1
1	1345239	Carriage	1
1	1345240	Carriage	1
1	1345264	Subshaft	1
2 b	1345218	Load Roller	6
2 c	1395172	Load Roller ("A" Standard)	4
2	1345219	Load Roller ("B" 0.76 mm)	6
2	1345220	Load Roller ("C" 1.52 mm)	6
3	12961	Snap Ring	6
4	1345263	Shim	6

REF.	PART NO.	NAME OF PART	QTY
5	366116	Spacer	2
6	1369345	Chain Anchor	2
6	1369344	Chain Anchor	2
7	317735	Pin	2
8	131958	Snap Ring	2
9	323161	Pin	4
10	15200	Cotter Pin	2

KEY:
A: H45-850M
B: H60-850M

a c Table Above
b Last Used On S/N Pending ECN 72449
c First Used On S/N Pending ECN 72449

ARAR

©1997 HYSTER COMPANY

See Service Manual for service procedures

1Q/2Q/1997

HOW TO FIND THE DESIRED PART NUMBER

WHEN THE PART NUMBER AND THE NEXT HIGHER ASSEMBLY IS NOT KNOWN:

1. Determine the function and application of the part required. Turn to the illustrated index page immediately behind the front cover. Choose the general area of reference most likely to include the part.
2. Find the page number for the reference number you choose and turn to that page. Use the division index to determine the assembly which would normally contain the part required. Then locate the part on the assembly breakdown page.

WHEN THE PART NUMBER IS NOT KNOWN AND THE NEXT HIGHER ASSEMBLY IS KNOWN:

3. Determine the assembly the required part is used on. Turn to the Master Index immediately following the Illustrated Index.
4. Locate the assembly the required part is used on and turn to the page indicated for that assembly. Then locate the part on the assembly breakdown page.

WHEN THE PART NUMBER IS KNOWN:

5. Use the numerical index at the back of the manual to find the part number. Turn to the figure listed and locate the part as indicated by the reference number.

GENERAL:

The assembly breakdowns include part numbers, description, quantities required, keys and footnotes to help in selecting the correct parts.

6. Keys are used to show effective serial numbers for two or more similar assemblies, RH and LH assembly parts, etc. Select the appropriate key, "A", "B", "C" or "D" and the corresponding quantity column to find the required parts.
7. Indented descriptions under "Name of Part" are used to indicate assemblies and sub-parts of assemblies. In the example, *LOAD ROLLER* (Item 2) is a subpart of the major assembly *CARRIAGE*.
8. Quantities shown are for one assembly. The quantities of the subpart *LOAD ROLLER* are indicated as six and six. This means six per *CARRIAGE* assembly.
9. Engineering change notice (ECN) numbers for pending serial numbers are shown to allow for the inclusion of the most current parts information. Contact your local dealer for Hyster lift trucks for serial number information listed by ECN number.
10. Additional fork lengths are available. Contact your dealer for Hyster lift trucks.

ORDERING PARTS:

When ordering replacement parts, give the unit serial number, part number, name of part and quantity required.

For any further information on parts, service, or ordering, consult your local dealer for Hyster lift trucks.

IDENTIFICATION OF TRUCK SERIAL NUMBERS

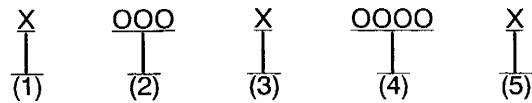

- (1) & (2) The first letter and three numbers indicate the truck model code.
- (3) The second letter indicates the plant of manufacture.
- (4) The four or five digit number series indicates the serial number of the truck.
- (5) The final letter indicates the year of manufacture starting with "A" in 1957 and 1980. The letters "I", "O", and "Q" will not be used.

For pending serial numbers contact your local dealer for Hyster lift trucks.

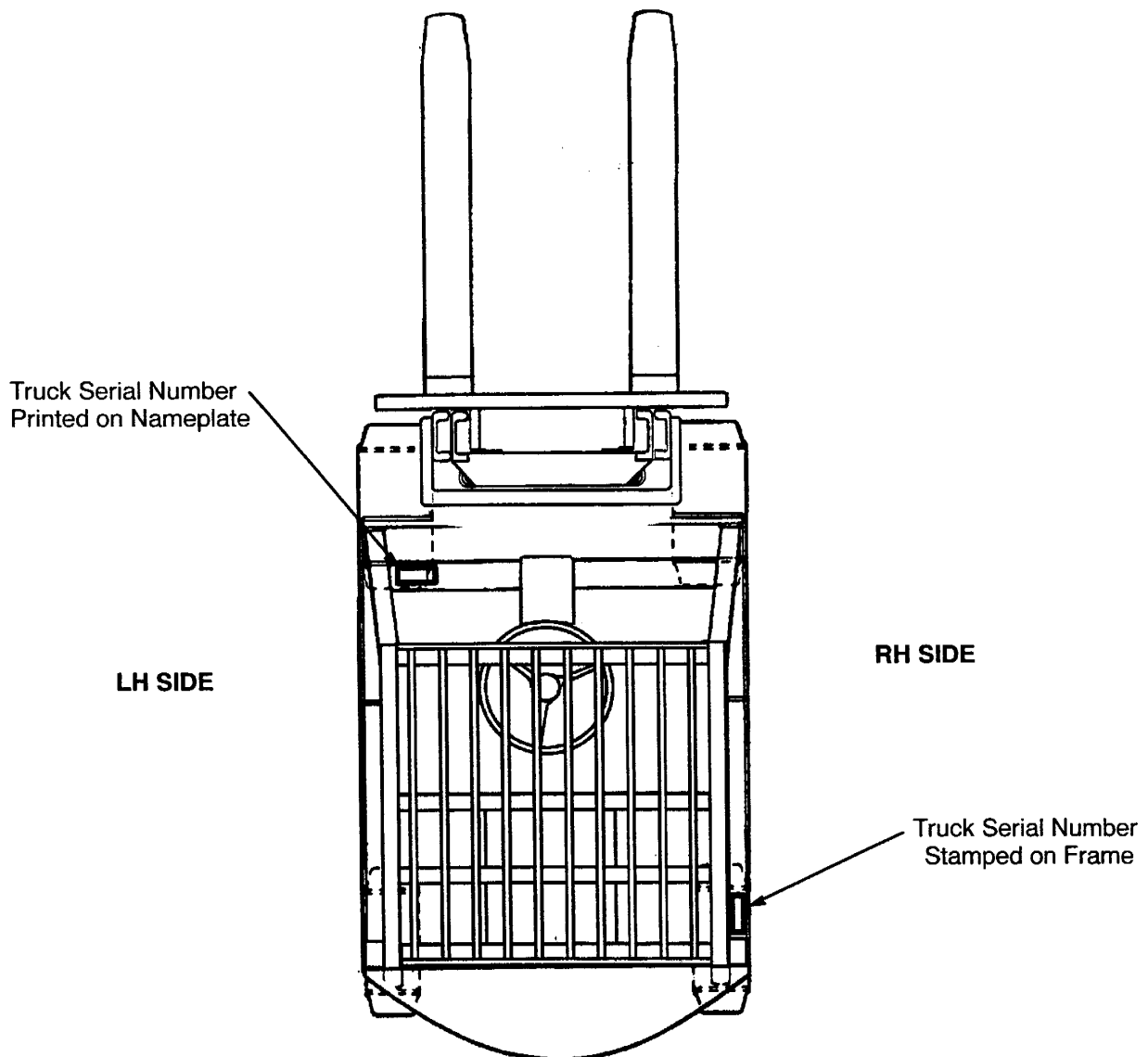

Parts referred to in this book as right or left hand parts are in accordance with the illustration above.

IDENTIFICATION OF MAST SERIAL NUMBERS (UP TO 1993)

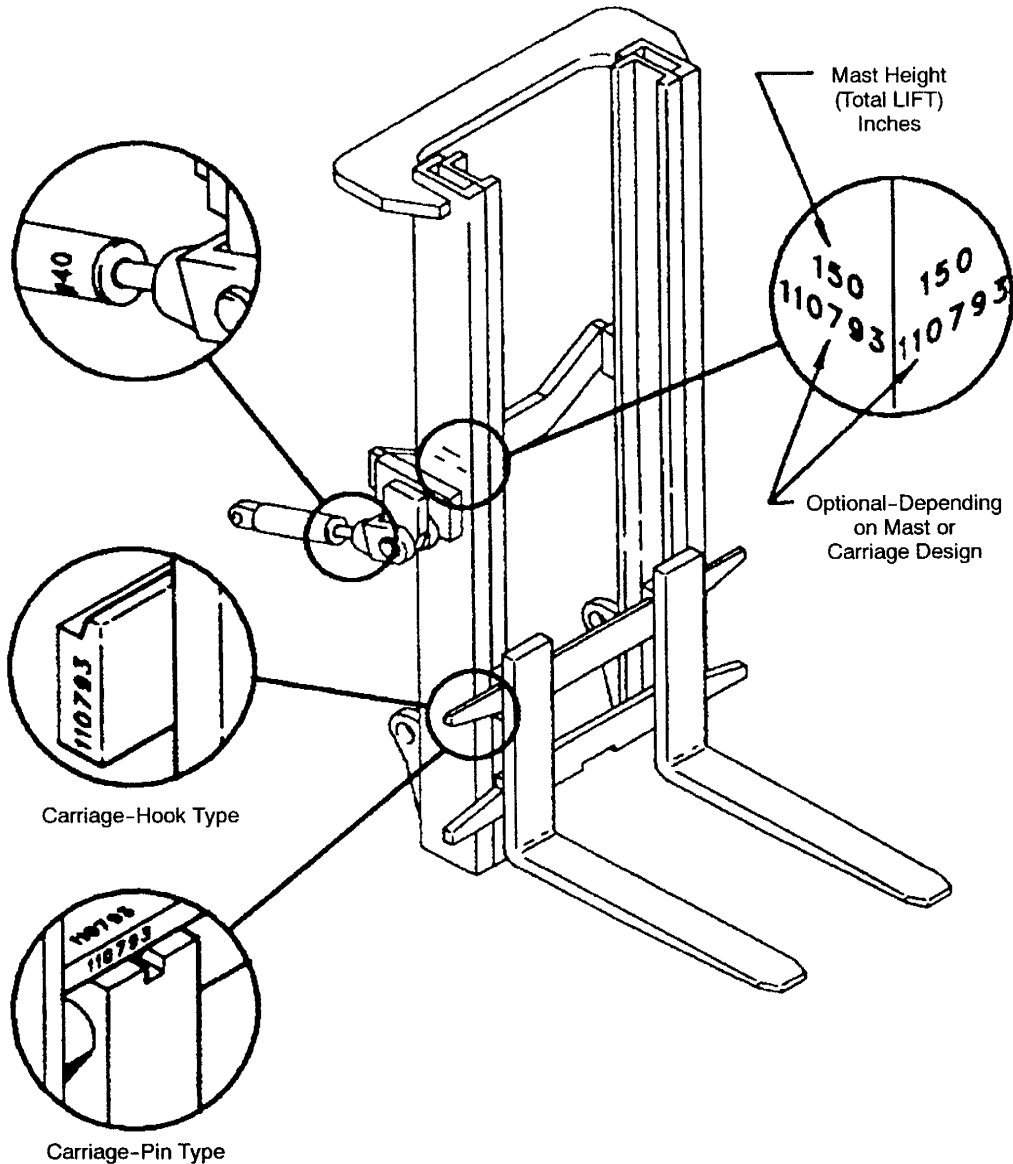

LIFT EQUIPMENT IDENTIFICATION

1. Mast group numbers and total lift heights are stamped on the right hand outer mast approximately four feet from the bottom of the load arm. The group numbers include the inner and outer masts, lift cylinder, lift chain and bleeder hoses or pipes.
2. The carriage and tilt cylinder numbers are located as shown. Lift cylinder numbers are stamped on the cylinder shell near the bleeder screw or on the chain anchor. Load arm part number, capacity rating, plant code letter and date of manufacture are stamped approximately six inches below the top RH side of load arms. Always refer to these group and part numbers when ordering service parts.

IDENTIFICATION OF MAST SERIAL NUMBERS (1994 AND UP)

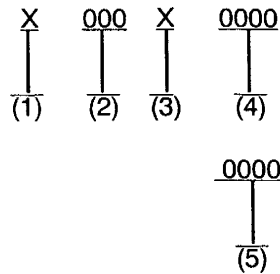

- (1) & (2) The first letter and number indicates the mast model code.
- (3) The second letter indicates the plant of manufacture.
- (4) The four or five digit number series indicates the serial number of the mast.
- (5) Lift Height in Millimeters stamped just below the serial number

Mast Group Identification consists of mast unit code (1) & (2) plus lift height (5).

For pending serial numbers contact your local dealer for Hyster lift trucks.

LIFT EQUIPMENT IDENTIFICATION

1. Fork part number, capacity rating, plant code letter and date of manufacture are stamped approximately six inches below the top of most forks.
2. The carriage group number is stamped on the right hand side of the top crossmember (pin type) or on the back of the right hand end of the bottom crossmember (hook type). A date code has two letters in line with or below the carriage group number.
3. The mast identification number has a model code, a letter indicating the plant of manufacture, and a serial number. Underneath the serial number is a four digit number that indicates the total lift height for the mast in millimeters.
4. Tilt and lift cylinder group numbers are stamped on the cylinder shell.

Always refer to the group, serial or part number when ordering service parts.

Modification of masts and carriages by SPED (Special Products Engineering Department) are identified by a model prefix code beginning with the letter "S". Contact your dealer for Hyster lift trucks for information on these assemblies.

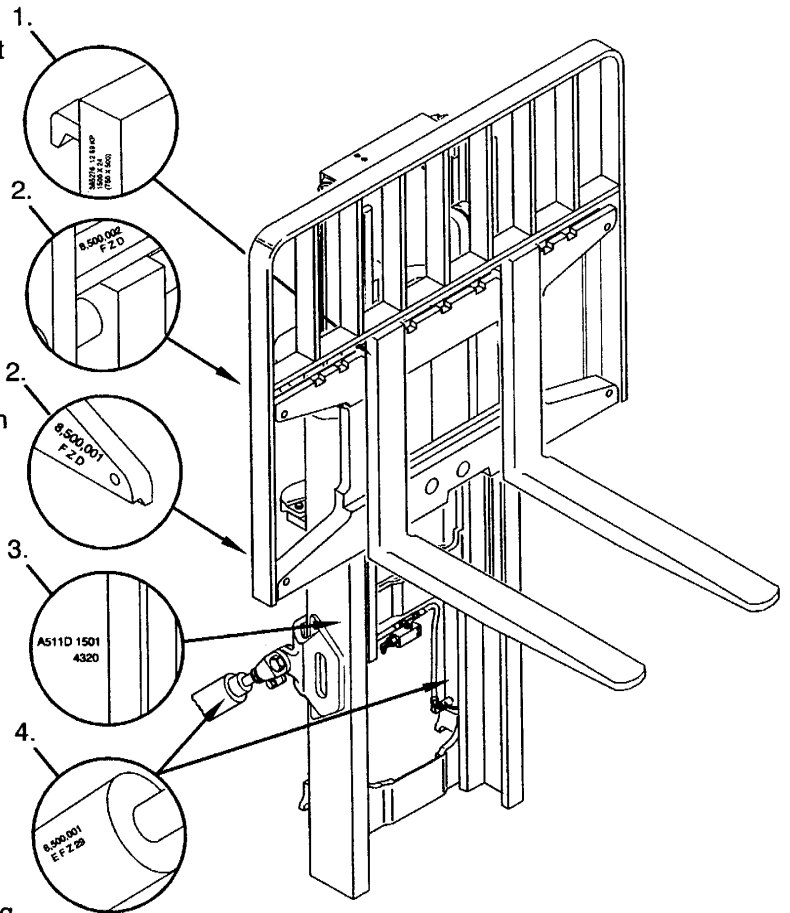

Please Click Here To Download The Complete Manual
Download Other Manuals
If Having Any Questions Feel Free To Contact us

admin@servicemanualbit.com