

PARTS MANUAL

CHALLENGER

H300XL, H330XL, H360XL

H330XL-EC

H360XL-EC

(D19)

CUSTOMER EDITION

HYSTER

ILLUSTRATED CONTENTS

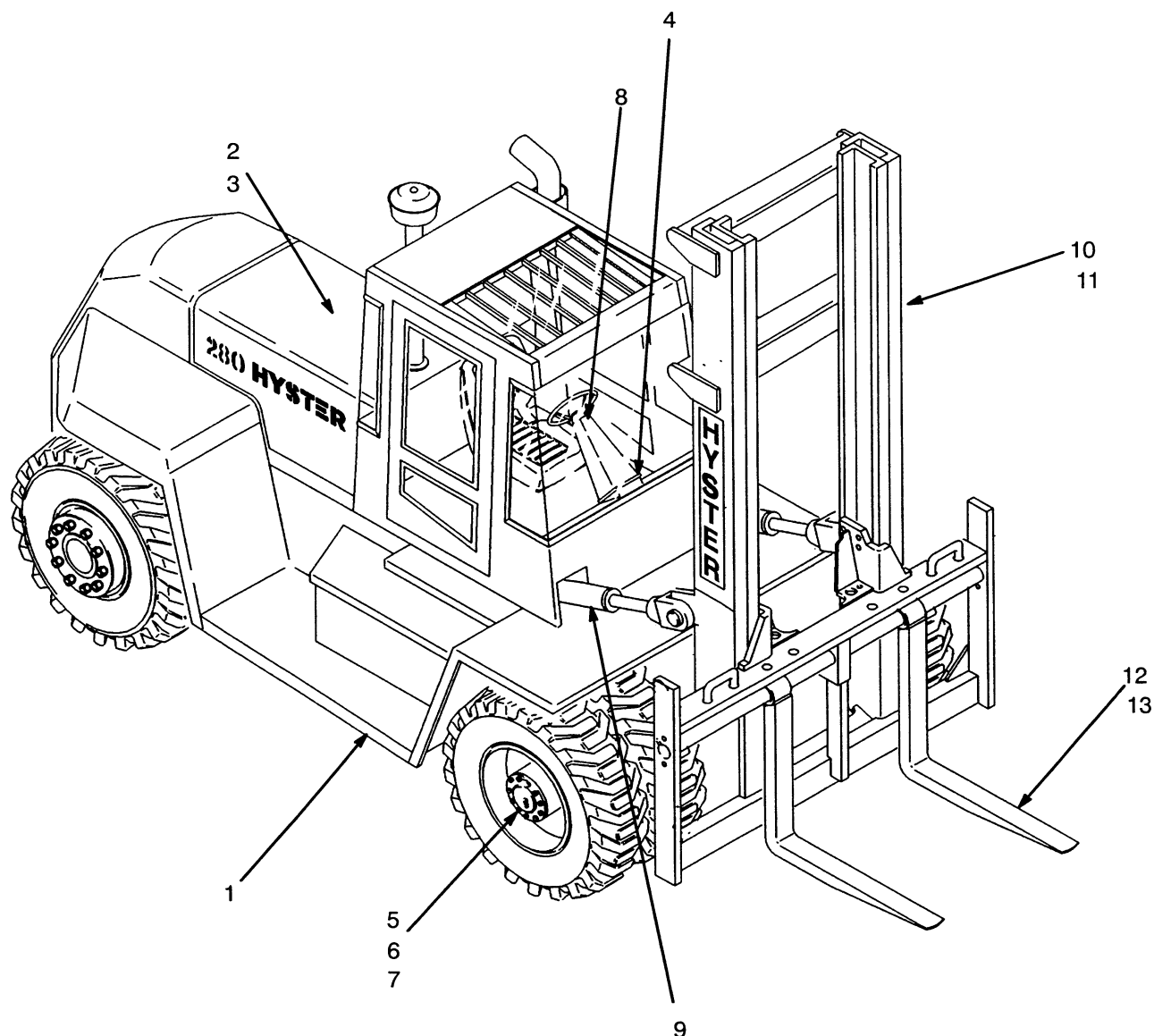

1	FRAME	Page 1
2	ENGINE	Page 35
3	FUEL	Page 119
4	ELECTRICAL	Page 175
5	BRAKE	Page 213
6	TRANSMISSION	Page 251
8	STEERING	Page 295
9	HYDRAULIC	Page 303
10	VISTA 2-STG NFL MAST	Page 341
11	A781 3-STG FFL MAST	Page 359
12	OPTIONAL	Page 385
13	EMPTY CONTAINER HANDLER	Page 413
14	NUMERICAL INDEX	Page 433

TABLE OF CONTENTS

<u>DESCRIPTION</u>	<u>PAGE</u>
A	
AIR COMPRESSOR (Figure 119) LAST USED ON ENGINE S/N U563738X	Page 226
AIR COMPRESSOR (Figure 120) USED ON ENGINE S/N U563739X UP TO UNIT S/N D19D-1756 INCLUDING 1758 EXCEPT 1753	Page 228
AIR COMPRESSOR (Figure 121) UP TO ENGINE S/N U593028 UNIT S/N D19D-1757 INCLUDING 1753 EXCEPT 1758	Page 230
AIR COMPRESSOR (Figure 122) USED ON ENGINE S/N U593029 THRU U607097	Page 232
AIR COMPRESSOR (Figure 123) FIRST USED ON ENGINE S/N U607098 AND UNIT S/N D19D-2377	Page 234
AIR COMPRESSOR (Figure 124) 366 LPG ENGINE	Page 236
AIR DUCTS (Figure 56) DIESEL TURBO	Page 104
AIR FILTER (Figure 75) LPG	Page 144
AIR FILTER (Figure 81) DIESEL TURBO WITHOUT LOW EMISSIONS	Page 156
AIR FILTER (Figure 82) DIESEL TURBO WITH LOW EMISSIONS FIRST USED ON S/N D19D-2377	Page 158
AIR FILTER (Figure 74) DIESEL NON-TURBO	Page 142
AIR SYSTEM (Figure 219)	Page 422
AIR TANK (Figure 114) LAST USED ON S/N D19D-1521	Page 220
AIR TANK (Figure 115) FIRST USED ON S/N D19D-1522	Page 221

TABLE OF CONTENTS

<u>DESCRIPTION</u>	<u>PAGE</u>
A (Continued)	
AIR TANK (Figure 116) WITH AUTOSHIFT FIRST USED ON S/N D19D-12439	Page 222
ALTERNATOR (Figure 100) DIESEL-LAST USED ON S/N D19D-1796	Page 194
ALTERNATOR (Figure 101) LPG DIESEL-FIRST USED ON S/N D19D-1797	Page 196
ALTERNATOR (Figure 99) DIESEL-LAST USED ON S/N D19D-1796	Page 192
ALTERNATOR MOUNTING (Figure 102) DIESEL WITHOUT LOW EMISSIONS	Page 198
ALTERNATOR MOUNTING (Figure 103) DIESEL WITH LOW EMISSIONS FIRST USED ON S/N D19D-2377	Page 200
ALTERNATOR MOUNTING (Figure 104) LPG	Page 202
ATTACHING PARTS (Figure 127) PARK BRAKE LAST USED ON S/N D19D-1521	Page 241
ATTACHING PARTS (Figure 128) PARK BRAKE FIRST USED ON S/N D19D-1522	Page 242
AUXILIARY DRIVE GEAR (Figure 35) DIESEL LAST USED ON S/N D19D-1756 ALSO 1758 EXCEPT 1753	Page 70
AUXILIARY DRIVE GEAR (Figure 36) DIESEL FIRST USED ON S/N D19D-1757 ALSO 1753 EXCEPT 1758	Page 72

B

BACK-UP ALARM (Figure 214)	Page 412
BRAKE CHAMBER (Figure 130)	Page 246

TABLE OF CONTENTS

<u>DESCRIPTION</u>	<u>PAGE</u>
B (Continued)	
BRAKE LINE WITH AUTOSHIFT (Figure 117) FIRST USED ON S/N D19D-12439	Page 223
BRAKE LINES (Figure 112) LAST USED ON S/N D19D-1521	Page 216
BRAKE LINES (Figure 113) LPG DIESEL-FIRST USED ON S/N D19D-1522	Page 218
BRAKE SYSTEM (Figure 129)	Page 244
C	
CARBURETOR LPG (Figure 71)	Page 138
CARRIAGE (Figure 183)	Page 354
CARRIAGE (Figure 192) 3 STG FFL WITH SIDESHIFT AND FORK POSITIONER	Page 374
CARRIAGE HYDRAULICS (Figure 193) 3 STG FFL WITH SIDESHIFT AND FORK POSITIONER	Page 376
CHARGE PUMP (Figure 147)	Page 278
CLUTCH (Figure 142) FORWARD AND LOW	Page 270
CLUTCH (Figure 143) REVERSE AND SECOND	Page 272
CLUTCH (Figure 144) THIRD	Page 274
COMPRESSOR MOUNTING (Figure 125) LPG	Page 238
CONTAINER HANDLING ATTACHMENT (Figure 215)	Page 414

TABLE OF CONTENTS

<u>DESCRIPTION</u>	<u>PAGE</u>
C (Continued)	
CONTROL VALVE (Figure 149)	Page 282
CONTROL VALVE (Figure 165) TWO FUNCTION	Page 314
CONTROL VALVE (Figure 168) THREE FUNCTION	Page 320
CONTROL VALVE (Figure 170) FOUR FUNCTION	Page 324
CONTROL VALVE (Figure 172) FIVE FUNCTION	Page 330
COOLING (Figure 21) DIESEL TURBO AND NON-TURBO	Page 44
COOLING (Figure 22) LPG	Page 46
COUNTERWEIGHT (Figure 14)	Page 28
CRANKSHAFT & PISTON (Figure 28) DIESEL NON-TURBO	Page 56
CRANKSHAFT & PISTON (Figure 29) DIESEL TURBO WITH AND WITHOUT LOW EMISSIONS	Page 58
CYLINDER BLOCK (Figure 58) LPG	Page 108
CYLINDER BLOCK (Figure 25) DIESEL NON TURBO	Page 50
CYLINDER BLOCK (Figure 26) DIESEL TURBO WITHOUT LOW EMISSIONS	Page 52
CYLINDER BLOCK (Figure 27) DIESEL TURBO WITH LOW EMISSIONS FIRST USED ON S/N D19D-2377	Page 54
CYLINDER HEAD AND VALVES (Figure 59) LPG	Page 110

TABLE OF CONTENTS

<u>DESCRIPTION</u>	<u>PAGE</u>
C (Continued)	
CYLINDER HEAD (Figure 30) DIESEL NON-TURBO	Page 60
CYLINDER HEAD (Figure 31) DIESEL TURBO WITHOUT LOW EMISSIONS	Page 62
CYLINDER HEAD (Figure 32) DIESEL TURBO WITH EMISSIONS FIRST USED ON S/N D19D-2377	Page 64

D

DIFFERENTIAL (Figure 152) LAST USED ON S/N D19D-1619-NON-EC AND EC-3 LAST USED ON S/N D19D-1965-EC4	Page 288
DIFFERENTIAL (Figure 154) FIRST USED ON S/N D19D-1620-NON EC AND EC-3 FIRST USED ON S/N D19D-1966-EC 4	Page 292
DISTRIBUTOR (Figure 98) LPG	Page 190
DRIVE AXLE (Figure 151)	Page 286
DRIVE AXLE (Figure 153) EMPTY CONTAINER HANDLER - 4 FIRST USED ON S/N D19D-1966	Page 290

E

ELECTRICAL CONTROLS (Figure 221)	Page 426
ELECTRICAL (Figure 93) DIESEL WITH AUTOSHIFT FIRST USED ON S/N D19D-12439	Page 180
ELECTRICAL SYSTEM (Figure 222)	Page 428

TABLE OF CONTENTS

DESCRIPTION **PAGE**

E (Continued)

ELECTRICAL SYSTEM (Figure 92)
DIESEL WITHOUT AUTOSHIFT Page 178

ELECTRICAL SYSTEM (Figure 95)
LPG WITHOUT AUTOSHIFT Page 184

ENDBEAM (Figure 216) Page 416

EXHAUST (Figure 18)
DIESEL NON-TURBO Page 39

EXHAUST (Figure 19)
DIESEL TURBO Page 40

EXHAUST (Figure 20)
LPG Page 42

EXTENSION (Figure 220) Page 424

F

FAN (Figure 15) Page 30

FIRE EXTINGUISHER (Figure 213) Page 411

FLOODLIGHTS (Figure 212) Page 410

FLOORPLATES AND COVERS (Figure 7) Page 14

FLYWHEEL (Figure 23)
DIESEL Page 48

FLYWHEEL (Figure 24)
LPG Page 49

FORK (Figure 204) Page 396

FORK (Figure 206)
HOOK TYPE QUICK DISCONNECT Page 398

TABLE OF CONTENTS

<u>DESCRIPTION</u>	<u>PAGE</u>
F (Continued)	
FORK POSITIONER CYLINDER (Figure 194)	Page 378
FORK POSITIONER VALVE (Figure 196)	Page 380
FREE-LIFT CYLINDER (Figure 191) THREE-STAGE FULL FREE-LIFT MAST	Page 372
FREE-LIFT (Figure 190) THREE-STAGE FULL FREE-LIFT MAST	Page 370
FUEL FILTER (Figure 80) DIESEL TURBO WITH LOW EMISSIONS FIRST USED ON S/N D19D-2377	Page 154
FUEL INJECTION (Figure 76) DIESEL TURBO WITHOUT LOW EMISSIONS	Page 146
FUEL INJECTION (Figure 77) DIESEL TURBO WITH LOW EMISSIONS FIRST USED ON S/N D19D-2377	Page 148
FUEL INJECTION (Figure 65) DIESEL WITHOUT LOW EMISSIONS	Page 126
FUEL INTAKE (Figure 63) DIESEL	Page 122
FUEL PRE-FILTER (Figure 64) DIESEL	Page 124
FUEL TANK (Figure 69) LPG	Page 134
H	
HEADER HOSE (Figure 184)	Page 356
HEADER HOSE (Figure 197) (THREE AND FOUR FUNCTION) THREE-STAGE FULL FREE-LIFT MAST	Page 382
HEADER HOSE (Figure 208) (FIVE FUNCTION) DUAL FUNCTION SIDE SHIFT FORK POSITIONER	Page 402

TABLE OF CONTENTS

DESCRIPTION	PAGE
H (Continued)	
HEATER CONTROL (Figure 8)	Page 16
HEATER (Figure 5) DIESEL	Page 10
HEATER (Figure 6) LPG	Page 12
HOOD (Figure 12) WITHOUT LOW EMISSIONS	Page 24
HOOD (Figure 13) WITH LOW EMISSIONS FIRST USED ON S/N D19D-2377	Page 26
HYDRAULIC CYLINDER (Figure 202) DUAL FUNCTION PIN TYPE OR QUICK DISCONNECT FIRST USED ON S/N PENDING PER ECN 63257	Page 394
HYDRAULIC HOSES (Figure 217)	Page 418
HYDRAULIC PUMP (Figure 163)	Page 310
HYDRAULIC SYSTEM (Figure 160) DIESEL AND LPG NON-EC	Page 304
HYDRAULIC SYSTEM (Figure 161) EMPTY CONTAINER HANDLER	Page 306
HYDRAULIC SYSTEM (Figure 218)	Page 420
HYDRAULIC TANK (Figure 162)	Page 308
I	
IDLER SHAFT (Figure 145)	Page 276
INNER MAST (Figure 178)	Page 344
INNER MAST (Figure 187) THREE-STAGE FULL FREE-LIFT MAST	Page 364

TABLE OF CONTENTS

<u>DESCRIPTION</u>	<u>PAGE</u>
I (Continued)	
INSTRUMENT PANEL (Figure 94) DIESEL	Page 182
INSTRUMENT PANEL (Figure 97) LPG	Page 188
INTAKE MANIFOLD (Figure 60) LPG	Page 112
INTERMEDIATE MAST (Figure 186) THREE-STAGE FULL FREE-LIFT MAST	Page 362
L	
LABELS (Figure 11)	Page 22
LIFT CYLINDER (Figure 180) LAST USED ON S/N D19D-2025	Page 348
LIFT CYLINDER (Figure 181) NON-EC FIRST USED ON S/N D19D-2026	Page 350
LIFT CYLINDER (Figure 182) EMPTY CONTAINER HANDLER 3 AND 4	Page 352
LIFT (Figure 179)	Page 346
LIFT PUMP (Figure 67)	Page 130
LIGHTS (Figure 211)	Page 408
LIGHTS (Figure 224)	Page 432
LOW PRESSURE SYSTEM (Figure 78) DIESEL TURBO WITHOUT LOW EMISSIONS	Page 150
LOW PRESSURE SYSTEM (Figure 79) DIESEL TURBO WITH LOW EMISSIONS FIRST USED ON S/N D19D-2377	Page 152

TABLE OF CONTENTS

DESCRIPTION	PAGE
L (Continued)	
LOW PRESSURE SYSTEM (Figure 66) DIESEL WITHOUT LOW EMISSIONS	Page 128
LPG CONVERTER (Figure 73)	Page 141
LPG FUEL SYSTEM (Figure 70)	Page 136
LPG LOCK-OFF FILTER (Figure 72)	Page 140
LPG TANK MOUNTING (Figure 68)	Page 132
LUBRICANT SYSTEM (Figure 57) DIESEL TURBO	Page 106

M

MAIN LIFT CYLINDER (Figure 189) THREE-STAGE FULL FREE-LIFT MAST	Page 368
MAIN LIFT (Figure 188) THREE-STAGE FULL FREE-LIFT MAST	Page 366
MANIFOLDS (Figure 48) DIESEL NON-TURBO	Page 91
MANIFOLDS (Figure 49) DIESEL TURBO WITHOUT LOW EMISSIONS	Page 92
MANIFOLDS (Figure 50) DIESEL TURBO WITH EMISSIONS	Page 93
MODULATOR VALVE (Figure 148)	Page 280
MONOTROL PEDAL (Figure 150)	Page 284

TABLE OF CONTENTS

<u>DESCRIPTION</u>	<u>PAGE</u>
0	
OIL FILTER (Figure 43) DIESEL NON-TURBO LAST USED ON S/N D19D-1756 INCLUDING 1758 EXCEPT 1753	Page 86
OIL FILTER (Figure 44) DIESEL NON-TURBO FIRST USED ON S/N D19D-1757 INCLUDING 1753 EXCEPT 1758 . . .	Page 87
OIL FILTER (Figure 45) DIESEL TURBO WITHOUT LOW EMISSIONS UP TO ENGINE S/N U647451C	Page 88
OIL FILTER (Figure 46) DIESEL TURBO WITHOUT LOW EMISSIONS ENGINE S/N U647452C AND UP	Page 89
OIL FILTER (Figure 47) DIESEL TURBO WITH LOW EMISSIONS	Page 90
OIL PAN (Figure 38) DIESEL TURBO WITHOUT LOW EMISSIONS	Page 76
OIL PAN (Figure 39) DIESEL TURBO WITH LOW EMISSIONS	Page 78
OIL PAN (Figure 37) DIESEL NON-TURBO	Page 74
OIL PUMP AND PAN (Figure 61) LPG	Page 114
OPERATOR COMPARTMENT (Figure 1) WITHOUT CAB	Page 2
OPERATOR COMPARTMENT (Figure 2) WITH CAB	Page 4
OPERATOR COMPARTMENT (Figure 3) WITH CAB	Page 6
OPERATOR COMPARTMENT (Figure 4) WITH CAB	Page 8
OUTER MAST (Figure 177)	Page 342

TABLE OF CONTENTS

DESCRIPTION **PAGE**

O (Continued)

OUTER MAST (Figure 185)
THREE-STAGE FULL FREE-LIFT MAST Page 360

OUTPUT GEAR (Figure 146) Page 277

P

PARK BRAKE VALVE (Figure 132)
LAST USED ON S/N D19D-1521 Page 248

PARK BRAKE VALVE (Figure 133)
FIRST USED ON S/N D19D-1522 Page 249

PIN FORK (Figure 205) Page 397

PNEUMATIC SOLENOID VALVE (Figure 118)
FIRST USED ON S/N D19D-12439 Page 224

POWERTRAIN MOUNT (Figure 17) Page 38

PUMP DRIVE GEARS (Figure 141) Page 268

R

RANGE CONTROL (Figure 135)
WITHOUT AUTOSHIFT Page 256

RANGE CONTROL (Figure 136)
WITH AUTOSHIFT
TRANSMISSION S/N T050M-6089
USED ON S/N D19D-2439 THROUGH S/N D19D-2720 Page 258

RANGE CONTROL (Figure 137)
WITH AUTOSHIFT
TRANSMISSION S/N T050M-6089
USED ON S/N D19D-2721 THRU S/N PENDING PER ECN 63481 Page 260

RANGE CONTROL (Figure 138)
WITH AUTOSHIFT
FIRST USED ON S/N PENDING PER ECN 63481 Page 262

TABLE OF CONTENTS

DESCRIPTION	PAGE
R (Continued)	
ROTATING BEACON (Figure 210)	Page 405
S	
SELECTOR VALVE (Figure 203) FIRST USED ON S/N PENDING PER ECN 63257	Page 395
SEMI-SUSPENSION SEAT (Figure 10)	Page 20
SIDESHIFT CARRIAGE (Figure 198) 2 STAGE NFL	Page 386
SIDESHIFT CARRIAGE (Figure 199) 3 STAGE FFL	Page 388
SIDESHIFT CARRIAGE (Figure 201) DUAL FUNCTION PIN TYPE OR QUICK DISCONNECT FIRST USED ON S/N PENDING PER ECN 63257	Page 392
SIDESHIFT CYLINDER (Figure 195)	Page 379
SIDESHIFT CYLINDER (Figure 200)	Page 390
SIDESHIFT CYLINDER (Figure 223)	Page 430
STARTER (Figure 105) DIESEL	Page 204
STARTER (Figure 96) FIRST USED ON S/N D19E-2654	Page 186
STEERING AXLE (Figure 158)	Page 300
STEERING CONTROL UNIT (Figure 156)	Page 298
STEERING CYLINDER (Figure 159)	Page 302
STEERING (Figure 155)	Page 296

TABLE OF CONTENTS

<u>DESCRIPTION</u>	<u>PAGE</u>
S (Continued)	
STROBE LIGHT (Figure 209)	Page 404
SUSPENSION SEAT (Figure 9)	Page 18
T	
THROTTLE LINKAGE (Figure 83) DIESEL-NON EMISSIONS	Page 160
THROTTLE LINKAGE (Figure 84) DIESEL-WITH LOW EMISSIONS FIRST USED ON S/N D19D-2377	Page 161
THROTTLE LINKAGE (Figure 85) NON-EMISSION DIESEL AND LPG WITH AUTOSHIFT FIRST USED ON S/N D19D-12439	Page 162
THROTTLE LINKAGE (Figure 86) LOW-EMISSION DIESEL WITH AUTOSHIFT FIRST USED ON S/N D19D-12439	Page 164
THROTTLE LINKAGE (Figure 87) LPG	Page 166
THROTTLE PEDAL (Figure 88) FORWARD/REVERSE LEVER	Page 167
THROTTLE PEDAL (Figure 89) MONOTROL PEDAL	Page 168
THROTTLE PEDAL (Figure 90) MONOTROL PEDAL WITH AUTOSHIFT FIRST USED ON S/N D19D-12439	Page 170
THROTTLE PEDAL (Figure 91) FORWARD/REVERSE LEVER WITH AUTOSHIFT FIRST USED ON S/N D19D-12439	Page 172
TILT CYLINDER ATTACHING PARTS (Figure 173)	Page 332
TILT CYLINDER (Figure 174) TWO STAGE NFL	Page 334

TABLE OF CONTENTS

<u>DESCRIPTION</u>	<u>PAGE</u>
T (Continued)	
TILT CYLINDER (Figure 175) THREE STAGE FFL	Page 338
TILT LOCK VALVE (Figure 176)	Page 340
TIMING GEAR (Figure 33) DIESEL NON TURBO	Page 66
TIMING GEAR (Figure 34) DIESEL TURBO WITH AND WITHOUT LOW EMISSIONS	Page 68
TIRE & WHEEL (Figure 207)	Page 400
TRANSMISSION (Figure 140) FIRST USED ON S/N D19D-2439 TRANSMISSION S/N T050M-6089	Page 266
TRANSMISSION ATTACHING PARTS (Figure 134)	Page 254
TRANSMISSION (Figure 139) LAST USED ON TRANSMISSION S/N T050M-6088 LAST USED ON S/N D19D-2438	Page 264
TREADLE VALVE (Figure 126)	Page 240
TREADLE VALVE (Figure 131)	Page 247
TURBOCHARGER (Figure 54) DIESEL TUBO	Page 100
TURBOCHARGER (Figure 55) DIESEL TURBO FIRST USED ON S/N D19D-2377	Page 102
V	
VALVE ATTACHING PARTS (Figure 166) THREE FUNCTION	Page 316
VALVE ATTACHING PARTS (Figure 167) DUAL FUNCTION SIDESHIFT FIRST USED ON S/N PENDING PER ECN 63257	Page 318

TABLE OF CONTENTS

DESCRIPTION **PAGE**

V (Continued)

VALVE ATTACHING PARTS (Figure 169)
FOUR FUNCTION Page 322

VALVE ATTACHING PARTS (Figure 171)
FIVE FUNCTION Page 328

VALVE ATTACHING PARTS(Figure 164)
TWO FUNCTION Page 312

VALVE BLOCK (Figure 157) Page 299

VALVE COVER (Figure 40)
DIESEL NON-TURBO Page 80

VALVE COVER (Figure 41)
DIESEL TURBO WITHOUT LOW EMISSION Page 82

VALVE COVER (Figure 42)
DIESEL TURBO WITH EMISSIONS
FIRST USED ON S/N D19D-2377 Page 84

W

WATER PUMP (Figure 51)
DIESEL
LAST USED ON S/N D19D-1756 ALSO 1758 EXCEPT 1753 Page 94

WATER PUMP (Figure 52)
DIESEL
FIRST USED ON S/N D19D-1757 ALSO 1753 EXCEPT 1758 Page 96

WATER PUMP (Figure 53)
DIESEL TURBO WITH LOW EMISSIONS
FIRST USED ON S/N D19D-2377 Page 98

WATER PUMP (Figure 62)
LPG Page 116

WINDSHIELD WASHER (Figure 16) Page 32

WIRE HARNESS (Figure 106)
CONTROL PANEL
FIRST USED ON S/N PENDING PER ECN 63257 Page 205

TABLE OF CONTENTS

<u>DESCRIPTION</u>	<u>PAGE</u>
W (Continued)	
WIRE HARNESS (Figure 107) ENGINE COMPARTMENT FIRST USED ON S/N D19D-12439	Page 206
WIRE HARNESS (Figure 108) CONTROLLER AUTOSHIFT FIRST USED ON S/N D19D-12439	Page 207
WIRE HARNESS (Figure 109) SHIFTER AUTOSHIFT FIRST USED ON S/N D19D-12439	Page 208
WIRE HARNESS (Figure 110) MONOTROL FIRST USED ON S/N D19D-12439	Page 209
WIRE HARNESS (Figure 111) OPERATOR COMPARTMENT WITH OPTIONAL ROTATING BEACON	Page 210

HOW TO USE THE ILLUSTRATED PARTS MANUAL

This parts manual describes and illustrates assemblies, subassemblies, and detail parts needed for service replacement.

The different constructions are indicated by keys, symbols and footnotes.

HYSTER SERIAL CODE D177-U.S.

3 → **DESCRIPTION** → **TABLE OF CONTENTS** → **PAGE NO.**

STEERING CONTROL UNIT (Figure 173)
LAST USED ON S/N PENDING PER ECN 59650-27 Page 316

STEERING CONTROL UNIT (Figure 173)
LAST USED ON S/N PENDING PER ECN 59650-27 Page 316

HYSTER 496 SERIAL CODE D177

NUMERICAL INDEX

PART NO	PAGE NO	REF NO	PART NO	REF NO	PART NO	REF NO	PART NO	REF NO	PART NO	REF NO
126	171	14	14386	209	39	149	43	8	303	15
142	175	17					97	15223	367	19
							31	15225	305	29
							35	15227	305	39
							34	15236	327	14
							13		351	3
							0		352	3
							1		381	3
							4		407	3
									16187	213
									16182	203
										207
										209
										71
										135
										2
										2
										137
										59
										31
										57
										37
										28

HYSTER SERIAL CODE D177-U.S.

1 → **ILLUSTRATED CONTENTS**

REF	SECTION
1	Frame
2	Engine
3	Fuel System
4	Electrical System
5	Transmission
6	Steering System
7	Brake System
8	Hydraulic System
9	Two Stage Limited
10	Three Stage Full FFL
11	Two Stage Full Fre
12	Optional
13	Numerical Index

©1987 HYSTER COMPANY

Page 441
SERIAL CODE D177-U.S.

HYSTER

9 → **CARRIAGE (Figure 233)**
TWO STAGE FFL
SIX ROLLER

LAST USED ON S/N PENDING PER ECN 98765

KEY:
A: H48-810M
B: H60-810M

REF	PART NO.	NAME OF PART	QTY
a		Carrriage Assy	1
1	1345239	Carrriage	1
1	1345240	Carrriage	1
1	1345264	Shaft	1
2 b	1345218	Load Roller	6
2 c	1395172	Load Roller ("A" Standard)	4
2	1345219	Load Roller ("B" 0.76 mm)	6
2	1345220	Load Roller ("C" 1.52 mm)	6
3	12961	Snap Ring	6
4	1345263	Shim	6
		ARAR	

REF	PART NO.	NAME OF PART	QTY
5	366116	Spacer	2
6	1369345	Chain Anchor	2
6	1369344	Chain Anchor	2
7	317735	Pin	2
8	131358	Snap Ring	2
9	323161	Pin	4
10	15200	Cotter Pin	2

a or Table Above
b Last Used On S/N Pending ECN 72449
c First Used On S/N Pending ECN 72449

©1987 HYSTER COMPANY
See Service Manual for service procedures
10/20/1987

HOW TO FIND THE DESIRED PART NUMBER

WHEN THE PART NUMBER AND THE NEXT HIGHER ASSEMBLY IS NOT KNOWN:

1. Determine the function and application of the part required. Turn to the illustrated index page immediately behind the front cover. Choose the general area of reference most likely to include the part.
2. Find the page number for the reference number you choose and turn to that page. Use the division index to determine the assembly which would normally contain the part required. Then locate the part on the assembly breakdown page.

WHEN THE PART NUMBER IS NOT KNOWN AND THE NEXT HIGHER ASSEMBLY IS KNOWN:

3. Determine the assembly the required part is used on. Turn to the Master Index immediately following the Illustrated Index.
4. Locate the assembly the required part is used on and turn to the page indicated for that assembly. Then locate the part on the assembly breakdown page.

WHEN THE PART NUMBER IS KNOWN:

5. Use the numerical index at the back of the manual to find the part number. Turn to the figure listed and locate the part as indicated by the reference number.

GENERAL:

The assembly breakdowns include part numbers, description, quantities required, keys and footnotes to help in selecting the correct parts.

6. Keys are used to show effective serial numbers for two or more similar assemblies, RH and LH assembly parts, etc. Select the appropriate key, "A", "B", "C" or "D" and the corresponding quantity column to find the required parts.
7. Indented descriptions under "Name of Part" are used to indicate assemblies and sub-parts of assemblies. In the example, *LOAD ROLLER* (Item 2) is a subpart of the major assembly *CARRIAGE*.
8. Quantities shown are for one assembly. The quantities of the subpart *LOAD ROLLER* are indicated as six and six. This means six per *CARRIAGE* assembly.
9. Engineering change notice (ECN) numbers for pending serial numbers are shown to allow for the inclusion of the most current parts information. Contact your local dealer for Hyster lift trucks for serial number information listed by ECN number.
10. Additional fork lengths are available. Contact your dealer for Hyster lift trucks.

ORDERING PARTS:

When ordering replacement parts, give the unit serial number, part number, name of part and quantity required.

For any further information on parts, service, or ordering, consult your local dealer for Hyster lift trucks.

IDENTIFICATION OF TRUCK SERIAL NUMBERS

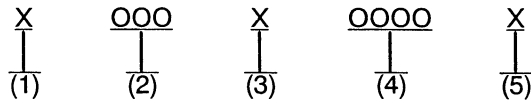

- (1) & (2) The first letter and three numbers indicate the truck model code.
- (3) The second letter indicates the plant of manufacture.
- (4) The four or five digit number series indicates the serial number of the truck.
- (5) The final letter indicates the year of manufacture starting with "A" in 1957 and 1980. The letters "I", "O", and "Q" will not be used.

For pending serial numbers contact your local dealer for Hyster lift trucks.

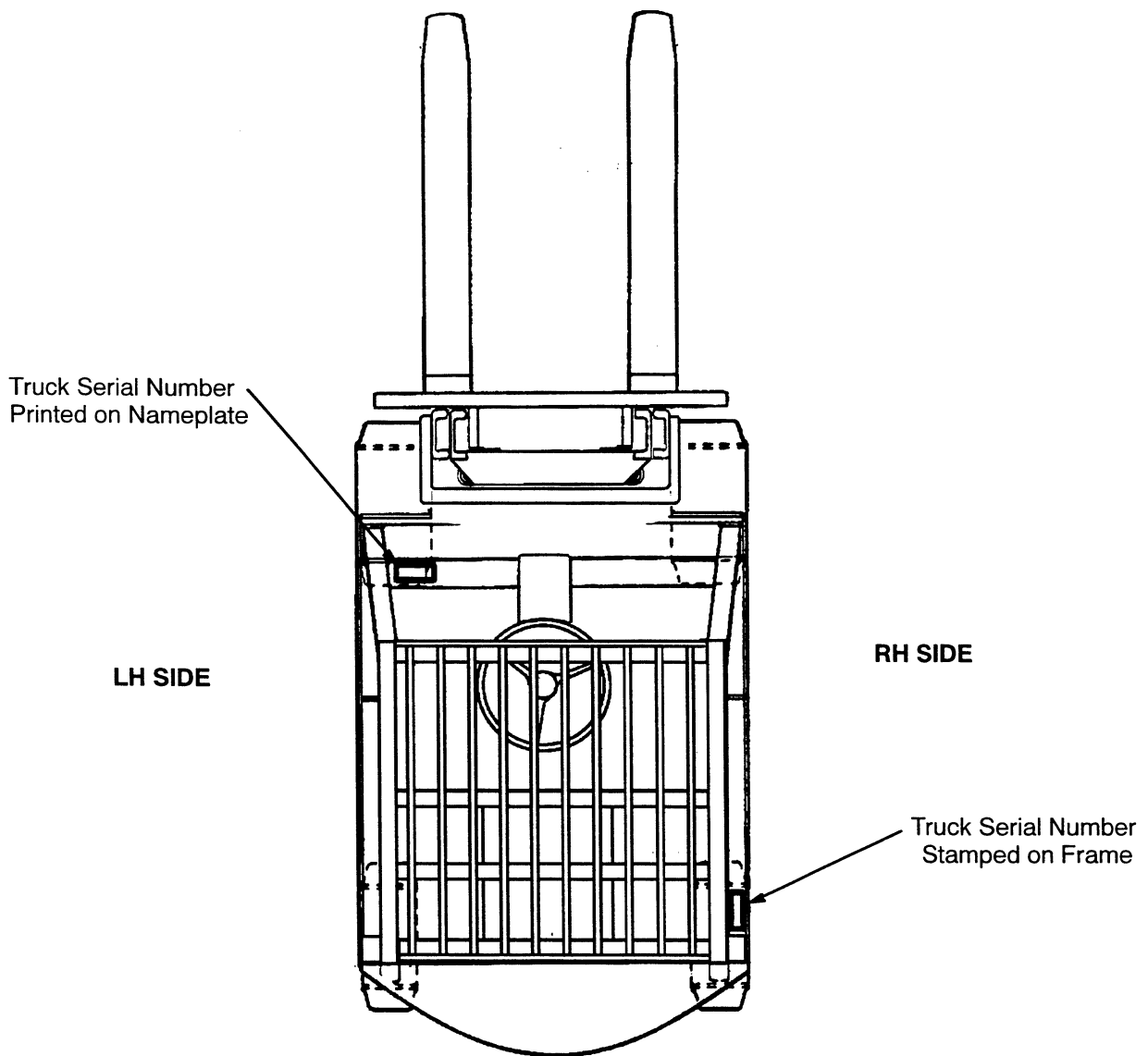

Parts referred to in this book as right or left hand parts are in accordance with the illustration above.

IDENTIFICATION OF MAST SERIAL NUMBERS (UP TO 1993)

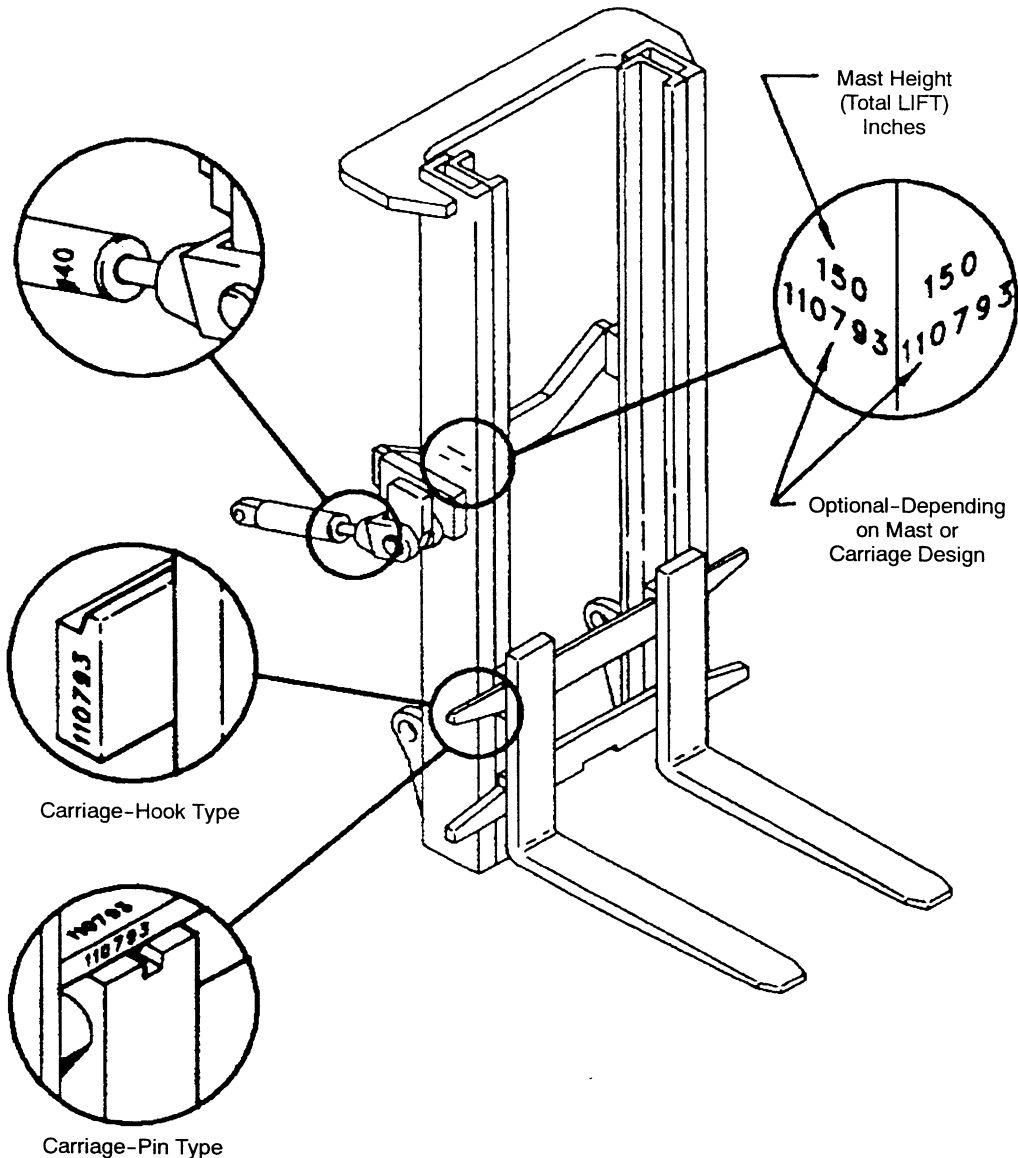

LIFT EQUIPMENT IDENTIFICATION

1. Mast group numbers and total lift heights are stamped on the right hand outer mast approximately four feet from the bottom of the load arm. The group numbers include the inner and outer masts, lift cylinder, lift chain and bleeder hoses or pipes.
2. The carriage and tilt cylinder numbers are located as shown. Lift cylinder numbers are stamped on the cylinder shell near the bleeder screw or on the chain anchor. Load arm part number, capacity rating, plant code letter and date of manufacture are stamped approximately six inches below the top RH side of load arms. Always refer to these group and part numbers when ordering service parts.

IDENTIFICATION OF MAST SERIAL NUMBERS (1994 AND UP)

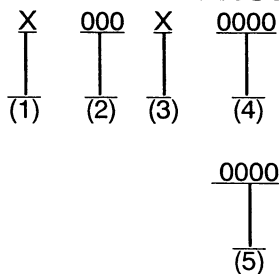

- (1) & (2) The first letter and number indicates the mast model code.
- (3) The second letter indicates the plant of manufacture.
- (4) The four or five digit number series indicates the serial number of the mast.
- (5) Lift Height in Millimeters stamped just below the serial number

Mast Group Identification consists of mast unit code (1) & (2) plus lift height (5).

For pending serial numbers contact your local dealer for Hyster lift trucks.

LIFT EQUIPMENT IDENTIFICATION

1. Fork part number, capacity rating, plant code letter and date of manufacture are stamped approximately six inches below the top of most forks.
2. The carriage group number is stamped on the right hand side of the top crossmember (pin type) or on the back of the right hand end of the bottom crossmember (hook type). A date code has two letters in line with or below the carriage group number.
3. The mast identification number has a model code, a letter indicating the plant of manufacture, and a serial number. Underneath the serial number is a four digit number that indicates the total lift height for the mast in millimeters.
4. Tilt and lift cylinder group numbers are stamped on the cylinder shell.

Always refer to the group, serial or part number when ordering service parts.

Modification of masts and carriages by SPED (Special Products Engineering Department) are identified by a model prefix code beginning with the letter "S". Contact your dealer for Hyster lift trucks for information on these assemblies.

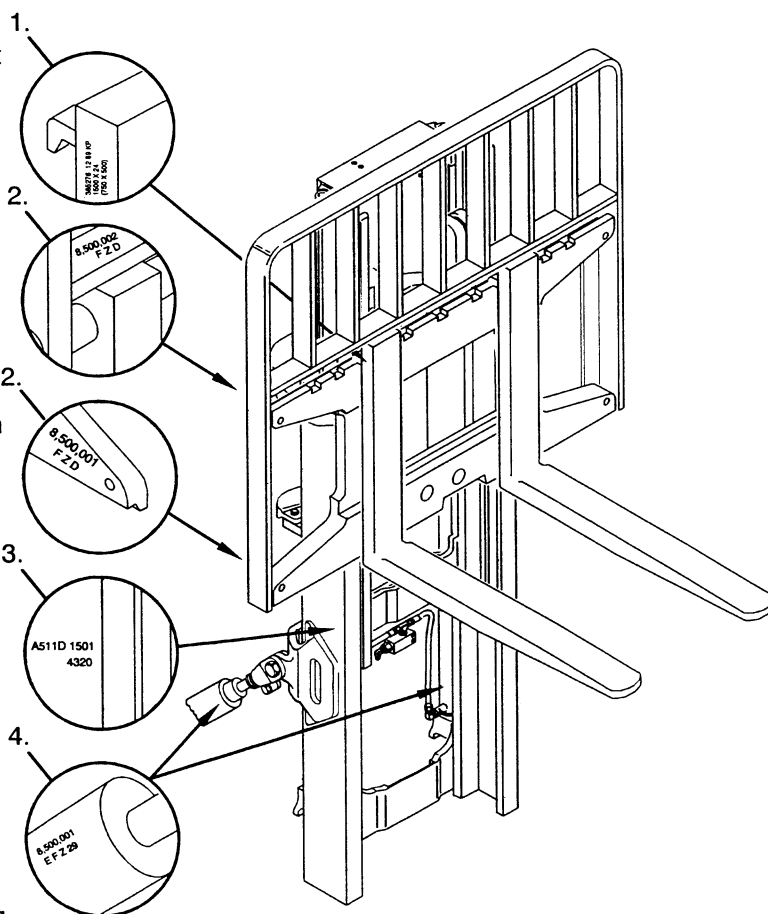

IDENTIFICATION OF ATTACHMENT AND SIDE-SHIFT CARRIAGE SERIAL NUMBERS

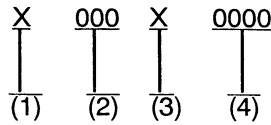

- (1) & (2) The first letter and three numbers indicate the attachment model code.
- (3) The second letter indicates the plant of manufacture.
- (4) The four or five digit number series indicates the serial number.

For pending serial numbers contact your local dealer for Hyster lift trucks.

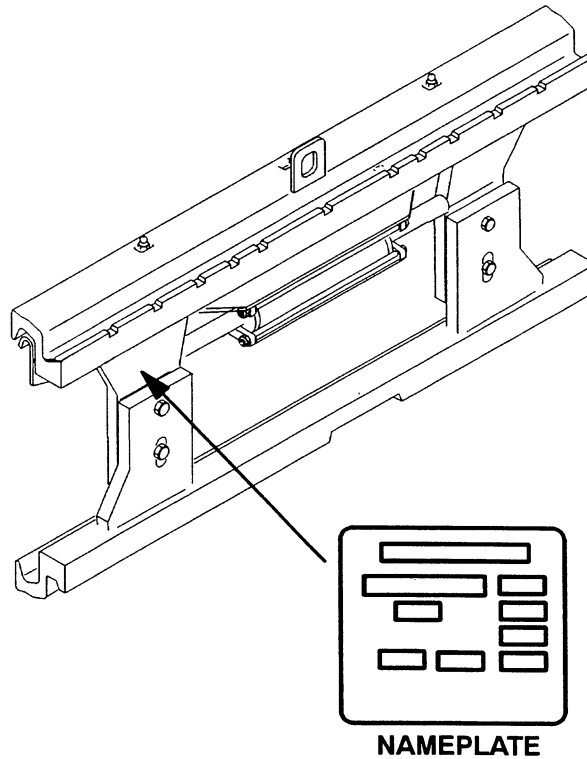

NAMEPLATE

Side-Shift Carriages and Attachments have nameplates. Use the serial number found on the nameplate to identify the attachment.

Always refer to the group, serial or part number when ordering service parts.

Modifications of attachments and side-shift carriages by SPED (Special Products Engineering Department) are identified by a model prefix code beginning with the letter "S". Contact your dealer for Hyster lift trucks for information on these assemblies.

Please Click Here To Download The Complete Manual
Download Other Manuals
If Having Any Questions Feel Free To Contact us

admin@servicemanualbit.com