

PARTS MANUAL

CHALLENGER

H360-370-400-420-460-
470-510-520-550-580-
620-650-700C

H17.00-19.00-21.50-
23.50-26.00-28.00-
32.00C

(C8)

CUSTOMER EDITION

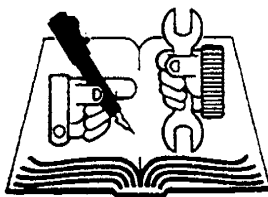

Hyster Easy Language Program

ILLUSTRATED CONTENTS

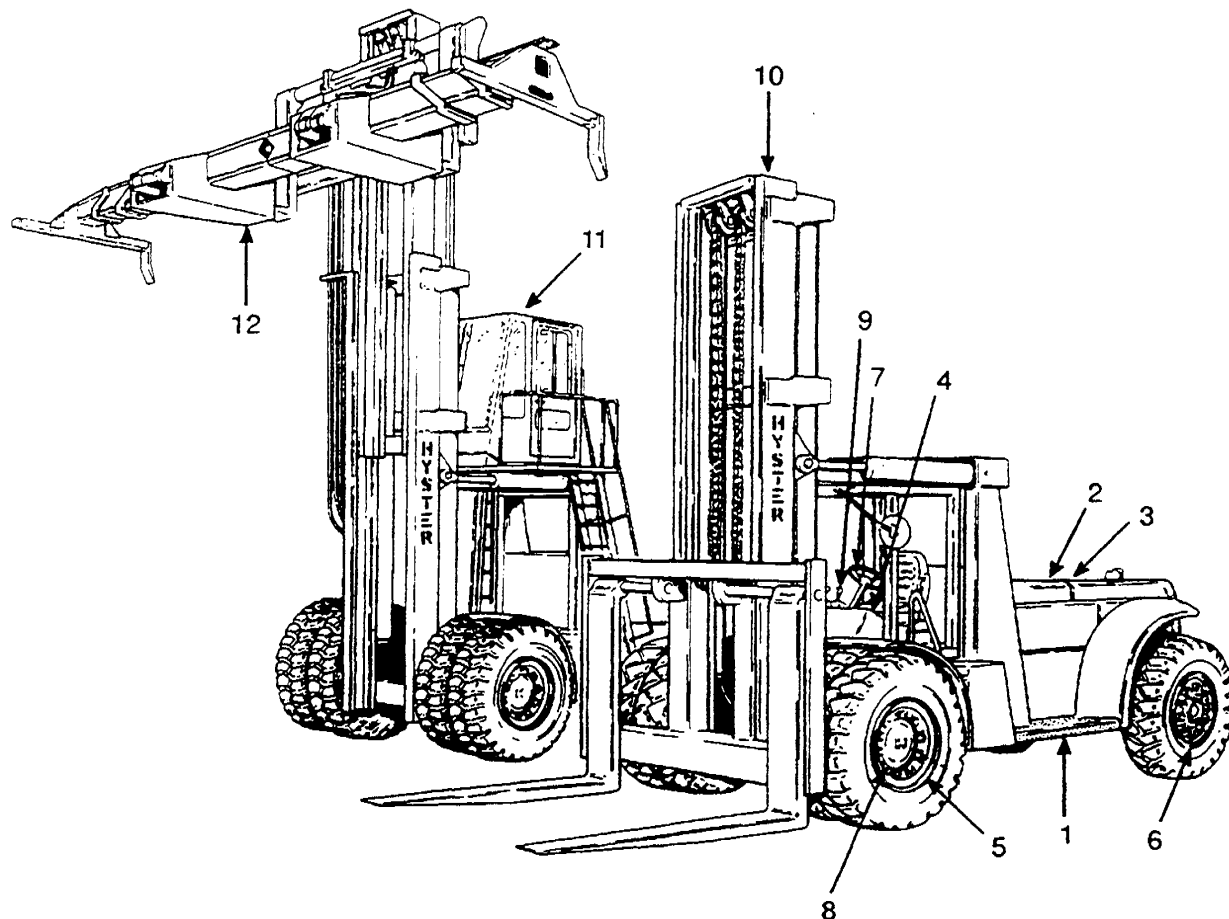

REF	SECTION	PAGE
1	FRAME	Page 3
2	ENGINE	Page 23
3	FUEL SYSTEM	Page 65
4	ELECTRICAL SYSTEM	Page 85
5	TRANSMISSION	Page 105
6	BRAKE SYSTEM	Page 155
7	STEERING	Page 203
8	DRIVE AXLE	Page 215
9	HYDRAULIC SYSTEM	Page 227
10	TWO-STAGE NO FREE LIFT MAST	Page 281
11	OPTIONAL	Page 305
12	CONTAINER ATTACHMENT	Page 333
13	NUMERICAL INDEX	Page 361



TABLE OF CONTENTS

DESCRIPTION	PAGE NO.
A	
AIR COMPRESSOR CYLINDER (Figure 93) TV8-540	Page 174
AIR COMPRESSOR (Figure 92) TV8-540	Page 172
AIR FILTER (Figure 37) U.S.	Page 74
AIR FILTER (Figure 38) NON-U.S.	Page 76
AIR TANK (Figure 101) H17.00-23.50C (H360-520C)	Page 186
AIR TANK (Figure 102) H26.00-32.00C (H550-700C)	Page 188
ALTERNATOR ATTACHING PARTS (Figure 47) PERKINS DIESEL ENGINE	Page 96
ALTERNATOR (Figure 48) PERKINS DIESEL ENGINE LAST USED ON S/N C8E-1555	Page 98
ALTERNATOR (Figure 49) PERKINS DIESEL ENGINE: FIRST USED ON S/N C8E-1556, C8D-1501 DETROIT DIESEL ENGINE: FIRST USED ON S/N C8E-1539	Page 100
ALTERNATOR (Figure 50) PERKINS DIESEL WITHOUT LIGHTS FIRST USED ON S/N C8E-1556, C8D-1501	Page 102
ALTERNATOR (Figure 51) DETROIT DIESEL WITHOUT LIGHTS (OPTIONAL) First Used On S/N C8E-1539, C8D-1521, C8S-1505	Page 103
AUXILIARY VALVE ATTACHING PARTS (Figure 133) LAST USED ON S/N C8E-1680	Page 248
AUXILIARY VALVE ATTACHING PARTS (Figure 134) FIRST USED ON S/N C8E-1681	Page 250
AUXILIARY VALVE (Figure 130) LAST USED ON S/N C8E-1680	Page 242
AUXILIARY VALVE (Figure 131) USED ON S/N C8E-1681 TO C8E-1797, LAST USED ON S/N C8D-1583 ..	Page 244
AUXILIARY VALVE (Figure 132) FIRST USED ON S/N C8D-1584, C8E-1798	Page 246



TABLE OF CONTENTS

DESCRIPTION	PAGE NO.
B	
BRAKE ACTUATOR (Figure 110)	Page 200
BRAKE CALIPER (Figure 94) H21.50-32.00C (H550-700C)	Page 176
BRAKE CHAMBER (Figure 89) H17.00-23.00C (H360-510C)	Page 166
BRAKE CHAMBER (Figure 97) PARK BRAKE H21.50-32.00C (H550-700C) LAST USED ON S/N C8E-1677 (EXCEPT 1631-1652)	Page 180
BRAKE LINES (Figure 84) LAST USED ON S/N C8E-1677 (EXCEPT 1631-1652)	Page 158
BRAKE LINES (Figure 85) H17.00-23.50C (H360-520C) FIRST USED ON S/N C8E-1678 (ALSO 1631-1652)	Page 160
BRAKE LINES (Figure 86) H26.00-32.00C (H550-700C) FIRST USED ON S/N C8E-1678 (ALSO 1631-1652)	Page 162
C	
CAB (Figure 160)	Page 306
CARRIAGE (Figure 159)	Page 302
CHARGE PUMP (Figure 58) LAST USED ON S/N C8D-1543, C8E-1555 (ALSO C8E-1557, 1571, 1590, 1591, 1598)	Page 117
CHARGE PUMP/OIL FILTER (Figure 76) FIRST USED ON S/N C8D-1544, C8E-1556 (EXCEPT C8E-1557, 1571, 1590, 1591, 1598)	Page 138
CLUTCH (Figure 77) LOW SPEED FIRST USED ON S/N C8D-1544, C8E-1556 (EXCEPT C8E-1557, 1571, 1590, 1591, 1598)	Page 140
CLUTCH (Figure 78) REVERSE/SECOND FIRST USED ON S/N C8D-1544, C8E-1556 (EXCEPT C8E-1557, 1571, 1590, 1591, 1598)	Page 142
CLUTCH (Figure 79) FORWARD/THIRD FIRST USED ON S/N C8D-1544, C8E-1556 (EXCEPT C8E-1557, 1571, 1590, 1591, 1598)	Page 144
CLUTCH-FIRST STAGE (Figure 59) LAST USED ON S/N C8D-1543, C8E-1555 (ALSO C8E-1557, 1571, 1590, 1591, 1598)	Page 118



TABLE OF CONTENTS

DESCRIPTION	PAGE NO.
C (CONTINUED)	
CLUTCH-SECOND STAGE (Figure 60) LAST USED ON S/N C8D-1543, C8E-1555 (ALSO C8E-1557, 1571, 1590, 1591, 1598)	Page 119
CLUTCH-THIRD STAGE (Figure 61) LAST USED ON S/N C8D-1543, C8E-1555 (ALSO C8E-1557, 1571, 1590, 1591, 1598)	Page 120
COMPRESSOR ATTACHING PARTS (Figure 90) DETROIT ENGINE	Page 168
COMPRESSOR ATTACHING PARTS (Figure 91) TV8-540	Page 170
CONTAINER ATTACHMENT (Figure 178) 20-40 FOOT EXTENDABLE	Page 334
CONTAINER ATTACHMENT (Figure 179) 20-40 FOOT FIXED ATTACHMENT	Page 336
CONTROL PEDAL (Figure 71)	Page 130
CONTROL VALVE ATTACHING PARTS (Figure 147)	Page 268
CONTROL VALVE (Figure 146)	Page 266
CONTROL VALVE (Figure 62) LAST USED ON S/N C8D-1543, C8E-1555 (ALSO C8E-1557, 1571, 1590, 1591, 1598)	Page 121
CONTROL VALVE (Figure 80) FIRST USED ON S/N C8D-1544, C8E-1556 (EXCEPT C8E-1557, 1571, 1590, 1591, 1598)	Page 146
CONVERTER HOUSING (Figure 74) FIRST USED ON S/N C8D-1544, C8E-1556 (EXCEPT C8E-1557, 1571, 1590, 1591, 1598)	Page 134
COOLING (Figure 13) DETROIT DIESEL	Page 26
COOLING (Figure 14) PERKINS DIESEL	Page 28
COUNTERWEIGHT (Figure 5)	Page 10
CRANKSHAFT/PISTONS/FLYWHEEL (Figure 19) TV8-540	Page 36
CYLINDER BLOCK (Figure 18) TV8-540	Page 34
CYLINDER (Figure 182) SLEWING	Page 342
CYLINDER (Figure 183) CONTAINER ATTACHMENT	Page 343



TABLE OF CONTENTS

DESCRIPTION	PAGE NO.
C (CONTINUED)	
CYLINDER (Figure 54)	Page 111
CYLINDER HEAD (Figure 20) TV8-540	Page 38
D	
DIFFERENTIAL & CARRIER (Figure 121) H17.00-23.50C (H360-520C)	Page 222
DIFFERENTIAL & CARRIER (Figure 122) H26.00-32.00C (H550-700C)	Page 224
DOUBLE CHECK VALVE (Figure 107)	Page 196
DRIVE AXLE (Figure 118) H17.00-32.00C (H360-520C)	Page 216
DRIVE AXLE (Figure 119) H550-700C LAST USED ON S/N C8E-1677 (EXCEPT 1631-1652)	Page 218
DRIVE AXLE (Figure 120) H26.00-32.00C FIRST USED ON S/N C8E-1678 (ALSO 1631-1652)	Page 220
DRIVE PLATE (Figure 53) LAST USED ON S/N C8D-1543, C8E-1555 (ALSO C8E-1557, 1571, 1590, 1591, 1598)	Page 110
DRIVE SHAFT (Figure 66)	Page 125
E	
ELECTRICAL (Figure 186) EXTENDABLE CONTAINER ATTACHMENT	Page 348
ELECTRICAL (Figure 187) FIXED ATTACHMENT	Page 350
ELECTRICAL (Figure 42) DETROIT DIESEL	Page 86
ELECTRICAL (Figure 43) PERKINS DIESEL	Page 88
ENGINE & TRANSMISSION MOUNT (Figure 12) PERKINS DIESEL	Page 25
ENGINE & TRANSMISSION MOUNTS (Figure 11) DETROIT DIESEL	Page 24
EXHAUST (Figure 15) DETROIT DIESEL	Page 30
EXHAUST (Figure 16) PERKINS DIESEL	Page 31



TABLE OF CONTENTS

DESCRIPTION	PAGE NO.
E (CONTINUED)	
EXHAUST (Figure 17) HIGH MOUNT OPERATOR COMPARTMENT	Page 32
F	
FIRE EXTINGUISHER (Figure 174)	Page 328
FLOORPLATES (Figure 2)	Page 4
FLOW REGULATOR (Figure 153)	Page 279
FORK POSITIONER (Figure 170) STANDARD CARRIAGE	Page 322
FORK POSITIONER (Figure 171) SIDESHIFT CARRIAGE	Page 324
FORK POSITIONING CYLINDER (Figure 172)	Page 326
FORKS (Figure 167)	Page 317
FRONT COVER (Figure 56) LAST USED ON S/N C8D-1543, C8E-1555 (ALSO C8E-1557, 1571, 1590, 1591, 1598)	Page 114
FUEL (Figure 35) DETROIT DIESEL	Page 70
FUEL (Figure 36) PERKINS DIESEL	Page 72
FUEL INJECTION (Figure 39)	Page 78
G	
GLASS (Figure 168)	Page 318
GOVERNOR (Figure 108)	Page 197
H	
HEADER HOSES (Figure 169)	Page 320
HEATER (Figure 161)	Page 308
HOOD LINKAGE (Figure 4)	Page 8
HUB (Figure 193)	Page 358
HYDRAULIC CONNTECTORS (Figure 180) EXTENDABLE ATTACHMENT	Page 338
HYDRAULIC (Figure 184) FIXED ATTACHMENT FOUR FUNCTION CONTROL VALVE	Page 344



TABLE OF CONTENTS

DESCRIPTION	PAGE NO.
H (CONTINUED)	
HYDRAULIC (Figure 185) FIXED ATTACHMENT SIX FUNCTION CONTROL VALVE	Page 346
HYDRAULIC LINES (Figure 181) EXTENDABLE ATTACHMENT	Page 340
HYDRAULIC PUMP (Figure 135)	Page 252
HYDRAULIC PUMP (Figure 136)	Page 253
HYDRAULIC PUMP (Figure 137)	Page 254
HYDRAULIC SYSTEM (Figure 123) LAST USED ON S/N C8D-1543, C8E-1555	Page 230
HYDRAULIC SYSTEM (Figure 124) FIRST USED ON S/N C8D-1544, C8E-1556	Page 232
HYDRAULIC TANK (Figure 151)	Page 276
I	
IDENTIFICATION BAND (Figure 127)	Page 238
INCHING CLUTCH (Figure 63) LAST USED ON S/N C8D-1543, C8E-1555 (ALSO C8E-1557, 1571, 1590, 1591, 1598)	Page 122
INCHING CONTROL VALVE (Figure 65) LAST USED ON S/N C8D-1543, C8E-1555 (ALSO C8E-1557, 1571, 1590, 1591, 1598)	Page 124
INSTRUMENT PANEL (Figure 44)	Page 90
INTERLOCK VALVE (Figure 194)	Page 359
L	
LABELS & PAINT (Figure 9)	Page 18
LADDER (Figure 10)	Page 20
LIFT CYLINDER (Figure 157) H17.00-23.50C (H360-520C)	Page 294
LIFT CYLINDER (Figure 158) H26.00-32.00C (H550-700C)	Page 298
LIFT (Figure 156)	Page 290
LIGHTS (Figure 176)	Page 330
LOW PRESSURE FUEL SYSTEM (Figure 40) LAST USED ON S/N C8D-1543 & C8E-1555	Page 80



TABLE OF CONTENTS

DESCRIPTION	PAGE NO.
L (CONTINUED)	
LOW PRESSURE FUEL SYSTEM (Figure 41) FIRST USED ON S/N C8D-1544 & C8E-1556	Page 82
M	
MAIN CASE (Figure 57) LAST USED ON S/N C8D-1543, C8E-1555 (ALSO C8E-1557, 1571, 1590, 1591, 1598)	Page 116
MANIFOLDS (Figure 25) TV8-540	Page 48
MAST (Figure 154) 331000, 366000, 368000 SERIES MAST	Page 282
MAST (Figure 155) 387000, 388000 SERIES MAST	Page 286
MIRRORS (Figure 175)	Page 329
MODULATOR VALVE (Figure 81) FIRST USED ON S/N C8D-1544, C8E-1556 (EXCEPT C8E-1557, 1571, 1590, 1591, 1598)	Page 148
O	
OIL COOLER (Figure 32) TV8-540	Page 62
OIL COOLER (Figure 69) 135-155 INCH WHEEL BASE	Page 128
OIL COOLER (Figure 70) 170-190 INCH WHEEL BASE	Page 129
OIL FILL SYSTEM (Figure 29) TV8-540	Page 56
OIL FILTER (Figure 28) TV8-540	Page 54
OIL FILTER (Figure 67)	Page 126
OIL PAN (Figure 23) TV8-540	Page 44
OIL PUMP (Figure 22) TV8-540	Page 42
OVERHEAD GUARD (Figure 3)	Page 6



TABLE OF CONTENTS

DESCRIPTION	PAGE NO.
P	
PARK BRAKE DISC (Figure 100) H21.50-32.00C (H550-700C)	Page 185
PARK BRAKE (Figure 95) H21.50-32.00C (H550-700C) LAST USED ON S/N C8E-1677 (EXCEPT 1631-1652)	Page 178
PARK BRAKE (Figure 96) H26.00-32.00C (H580-700C) FIRST USED ON S/N C8E-1678 (ALSO 1631-1652)	Page 179
PARK BRAKE SPRING ACTUATOR (Figure 111) H26.00-32.00C (H550-700C) FIRST USED ON S/N C8E-1678 (ALSO 1631-1652)	Page 202
PARK BRAKE VALVE (Figure 106)	Page 195
PILOT LINES (LOWER) (Figure 126)	Page 236
PILOT LINES (UPPER) (Figure 125)	Page 234
PILOT VALVE ATTACHING PARTS (Figure 152)	Page 278
PILOT VALVE (Figure 138) LAST USED ON S/N C8E-1675, C8D-1549	Page 256
PILOT VALVE (Figure 139) FIRST USED ON S/N C8E-1676, C8D-1550	Page 258
POWER BOOSTER (Figure 87) H21.50-23.50C (H460-700C)	Page 164
POWER BOOSTER (Figure 88)	Page 165
PRESSURE REDUCING VALVE ATTACHING PARTS (Figure 128) (FOR PRESSURE REDUCING VALVE 284768)	Page 239
PRESSURE REDUCING VALVE ATTACHING PARTS (Figure 129) (FOR PRESSURE REDUCING VALVE 343674)	Page 240
PRESSURE REDUCING VALVE (Figure 141)	Page 261
PRESSURE REDUCING VALVE (Figure 142)	Page 262
PUBLICATIONS (Figure 1)	Page 1
R	
RATIO VALVE (Figure 105)	Page 194
RELIEF VALVE (Figure 144)	Page 264
RELIEF VALVE (Figure 191)	Page 356
RELIEF VALVE (Figure 192)	Page 357



TABLE OF CONTENTS

DESCRIPTION	PAGE NO.
R (CONTINUED)	
REMANUFACTURED GOVERNOR (Figure 109)	Page 198
ROCKER SHAFT (Figure 21) TV8-540	Page 40
S	
SEAT (Figure 6) NON-ADJUSTABLE SUSPENSION WITHOUT OPERATOR RESTRAINT: LAST USED ON S/N C8D-1545, C8E-1588	Page 12
SERVICE BRAKE (Figure 98) LAST USED ON S/N C8E-1677 (EXCEPT 1631-1652)	Page 182
SERVICE DISC BRAKE (Figure 99) H26.00-32.00C (H550-700C) FIRST USED ON S/N C8D-1501, C8E-1678 (ALSO 1631-1652) ...	Page 184
SHIFT CONTROL (Figure 72)	Page 131
SHIFT LINKAGE (Figure 68)	Page 127
SIDESHIFT CARRIAGE (Figure 165)	Page 314
SIDESHIFT CYLINDER (Figure 166)	Page 316
SOLENOID VALVE ATTACHING PARTS (Figure 143) SIX AND SEVEN FUNCTION VALVES	Page 263
SOLENOID VALVE (Figure 145)	Page 265
STARTER (Figure 45) PERKINS DIESEL	Page 92
STEERING AXLE (Figure 112)	Page 204
STEERING CYLINDER (Figure 114) H360-700C LAST USED ON S/N C8E-1630	Page 208
STEERING CYLINDER (Figure 115) H17.00-32.00C FIRST USED ON S/N C8E-1631	Page 209
STEERING GEAR (Figure 117)	Page 212
STEERING HAND PUMP (Figure 116)	Page 210
STEERING LINES (Figure 113)	Page 206
STROBE LIGHT (Figure 177) HIGH INTENSITY	Page 332
SUSPENSION SEAT (Figure 7) SEARS	Page 14



TABLE OF CONTENTS

DESCRIPTION	PAGE NO.
S (CONTINUED)	
SUSPENSION SEAT (Figure 8) KAB: EUROPEAN OPTION	Page 16
T	
THERMOSTAT (Figure 30) TV8-540	Page 58
THROTTLE CONTROL (Figure 31) TV8-540	Page 60
THROTTLE LINKAGE (Figure 33) DETROIT DIESEL	Page 66
THROTTLE LINKAGE (Figure 34) PERKINS DIESEL	Page 68
TILT CYLINDER (Figure 148) LAST USED ON S/N C8D-1540, C8E-1531 (WITH CONTAINER ATTACHMENT)	Page 270
TILT CYLINDER (Figure 149) OPTIONAL: LAST USED ON S/N C8D-1540, C8E-1531 WITH CONTAINER ATTACHMENT, C8E-1595 WITHOUT CONTAINER ATTACHMENT	Page 272
TILT CYLINDER (Figure 150) FIRST USED ON S/N C8D-1541, C8E-1532 WITH CONTAINER ATTACHMENT, C8E-1596 WITHOUT CONTAINER ATTACHMENT	Page 274
TILT INDICATOR (Figure 173)	Page 327
TILT LOCK VALVE (Figure 140)	Page 260
TIMING GEAR (Figure 26) TV8-540	Page 50
TIRE & WHEEL (Figure 163) H17.00-23.50C (H360-520C)	Page 312
TIRE & WHEEL (Figure 164) H26.00-32.00C (H550-700C)	Page 313
TORQUE CONVERTER (Figure 55) LAST USED ON S/N C8D-1543, C8E-1555 (ALSO C8E-1557, 1571, 1590, 1591, 1598)	Page 112
TORQUE CONVERTER (Figure 75) FIRST USED ON S/N C8D-1544, C8E-1556 (EXCEPT C8E-1557, 1571, 1590, 1591, 1598)	Page 136
TRANSMISSION ATTACHING PARTS (Figure 83)	Page 152
TRANSMISSION (Figure 52) LAST USED ON S/N C8D-1543, C8E-1555 (ALSO C8E-1557, 1571, 1590, 1591, 1598)	Page 108



TABLE OF CONTENTS

DESCRIPTION	PAGE NO.
T (CONTINUED)	
TRANSMISSION (Figure 73) FIRST USED ON S/N C8D-1544, C8E-1556 (EXCEPT C8E-1557, 1571, 1590, 1591, 1598)	Page 132
TRANSMISSION LINES (Figure 82) FIRST USED ON S/N C8D-1544, C8E-1556 (EXCEPT C8E-1557, 1571, 1590, 1591, 1598)	Page 150
TREADLE VALVE (Figure 103)	Page 190
TREADLE VALVE (Figure 104) H26.00-32.00C (H550-700C) FIRST USED ON S/N C8E-1678 (ALSO 1631-1652)	Page 192
TURBOCHARGER (Figure 24) TV8-540	Page 46
TWIST LOCK CYLINDER (Figure 190)	Page 355
TWIST LOCK (Figure 188)	Page 352
TWIST LOCK INDICATOR (Figure 189)	Page 354
V	
VOLTAGE REGULATOR (Figure 46) PERKINS DIESEL MOTOR LAST USED ON S/N C8E-1555, C8D-1501	Page 94
W	
WATER PUMP (Figure 27) TV8-540	Page 52
WEAR PLATES (Figure 195) 20-40 FOOT EXTENDABLE ATTACHMENT	Page 360
WIPER MOTOR (Figure 162)	Page 310
Y	
YOKE (Figure 64) LAST USED ON S/N C8D-1543, C8E-1555 (ALSO C8E-1557, 1571, 1590, 1591, 1598)	Page 123

HOW TO USE ILLUSTRATED PARTS MANUAL

THIS PARTS MANUAL DESCRIBES AND ILLUSTRATES ASSEMBLIES, SUBASSEMBLIES, AND DETAIL PARTS NEEDED FOR SERVICE REPLACEMENT.

IT ALSO INCLUDES ALL PARTS PECULIAR TO TRUCKS BUILT IN OVERSEAS PLANTS. THESE PARTS ARE INDICATED BY KEYS, SYMBOLS AND FOOTNOTES.

INDEX-MASTER

INDEX-NUMERICAL

PART NO.	REF. NO.	PAGE NO.	PART NO.	REF. NO.	PAGE NO.	PART NO.	REF. NO.	PAGE NO.	PART NO.	REF. NO.	PAGE NO.	
147	10L2	2	1300N	10C1	24	13177	1008	4	13174	1008	4	
158	2008	14	10C4	4	1988	7	15846	1004	28	19183	1012	4
	2001	12	10C7	25	1988	90	1004	21	19200	1012	10	
	2001	18	10C4	11	19137	1004	22	1004	42	1914	9	
	2006	22	14C4	21	19134	1904	41	1004	15	1006	21	
134	2006	12	1112	3	1904	10	1000	10	2003	12	2003	12
	2001	23	1900P	1000	4	19125	20C1	23	1004	17	2004	7
	2001	13	1004	4	19144	1004	15	1004	24	2012	7	
142	10C4	11	1900P	2004	24	1901	22	1004	5	2002	7	
	10C4	11	1900P	1011	27	1904	20	1004	5	19111	2004	14
	10C4	4	1900P	2019	12	1904	11	1004	27	2001	26	
			10C4	2012	18	1907	1	1004	20	2002	20	
						10C4	4	1004	42	2004	21	
						10C4	4	1004	15	19212	10	
						10C4	4	1004	15	1912	11	

INDEX-ILLUSTRATED

MOTOR

LAST USED ON FORKING L/P PER FORK PARTS (SEE PAGE 421)

HYSTER COMPANY PARTS DEPARTMENT

USE HYSTER APPROVED PARTS... It pays



WHEN THE PART NUMBER AND THE NEXT HIGHER ASSEMBLY IS NOT KNOWN:

1. Determine the function and application of the part required. Turn to the illustrated index page immediately behind the front cover. Choose the general area of reference most likely to include the part.
2. Find the page number for the reference number you choose and turn to that page. Use the division index to determine the assembly which would normally contain the part required. Then locate the part on the assembly breakdown page.

WHEN THE PART NUMBER IS NOT KNOWN AND THE NEXT HIGHER ASSEMBLY IS KNOWN:

3. Determine the assembly the required part is used on. Turn to the Master Index immediately following the Illustrated Index.
4. Locate the assembly the required part is used on and turn to the page indicated for that assembly. Then locate the part on the assembly breakdown page.

WHEN THE PART NUMBER IS KNOWN:

5. Use the numerical index at the back of the manual to find the part number. Turn to the figure listed and locate the part as indicated by the reference number.

GENERAL:

The assembly breakdowns include part numbers, description, quantities required, keys and footnotes to help in selecting the correct parts.

6. Keys are used to show effective serial numbers for two or more similar assemblies, RH and LH assembly parts, etc. select the appropriate key, "A", "B", "C" or "D" and the corresponding quantity column to find the required parts.
7. Indented descriptions under "Name of Part" are used to indicate assemblies and sub-parts of assemblies. In the example (Item 7), *HEAD* is a sub-part of the major assembly *MOTOR* and *SET-SPRING* is one of several sub-parts of the assembly *HEAD*.
8. Quantities shown are for one assembly. Note that two assemblies are shown, but the quantities of the subparts are indicated as three and three. This means three per assembly.
9. Engineering change notice (ECN) numbers for pending serial numbers are shown to allow for the inclusion of the most current parts information. Contact your local dealer for Hyster lift trucks for serial number information listed by ECN number.

ORDERING PARTS:

When ordering replacement parts, give the unit serial number, part number, name of part and quantity required.

For any further information on parts, service, or ordering, consult your local dealer for Hyster lift trucks.

UNIT IDENTIFICATION UNIT S/N

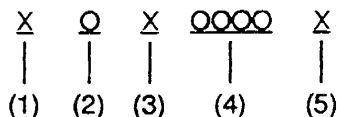

- (1) & (2) The first letter and number denote the design series and model of the unit
- (3) The second letter denotes the Plant at which the unit was manufactured
- (4) The number series denotes the serial number of the unit
- (5) The final letter denotes the year of manufacture starting with "A" in 1957 and 1980 The letters "I", "O", and "Q" will not be used

For pending serial numbers contact your local Hyster Dealer

Parts referred to in this book as right or left hand parts are in accordance with the illustration below

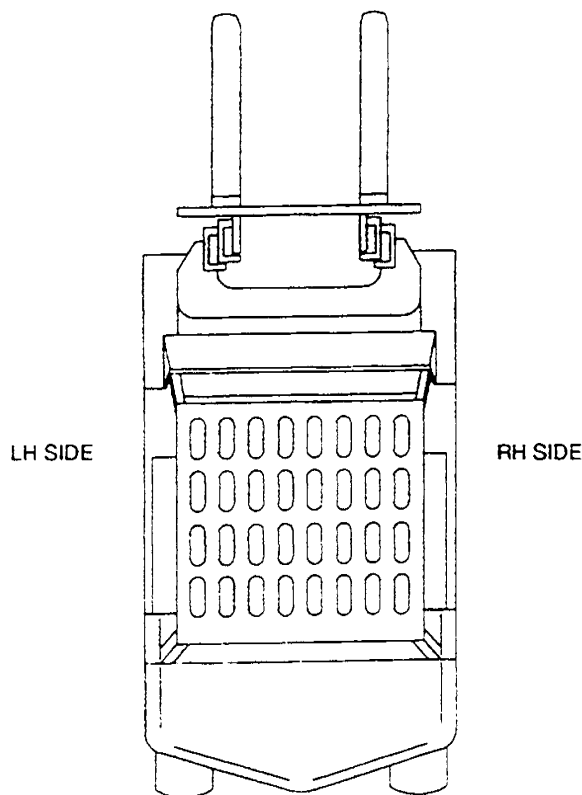

LIFT EQUIPMENT IDENTIFICATION

1. Mast group numbers and total lift heights are stamped on the right hand outer mast approximately four feet from the bottom of the fork. The group numbers include the inner and outer masts, lift cylinder, lift chain and bleeder hoses or pipes.
2. The carriage and tilt cylinder numbers are located as shown. Lift cylinder numbers are stamped on the cylinder shell near the bleeder screw or on the chain anchor. Fork part number, capacity rating, plant code letter and date of manufacture are stamped approximately six inches below the top RH side of forks. Always refer to these group and part numbers when ordering service parts.

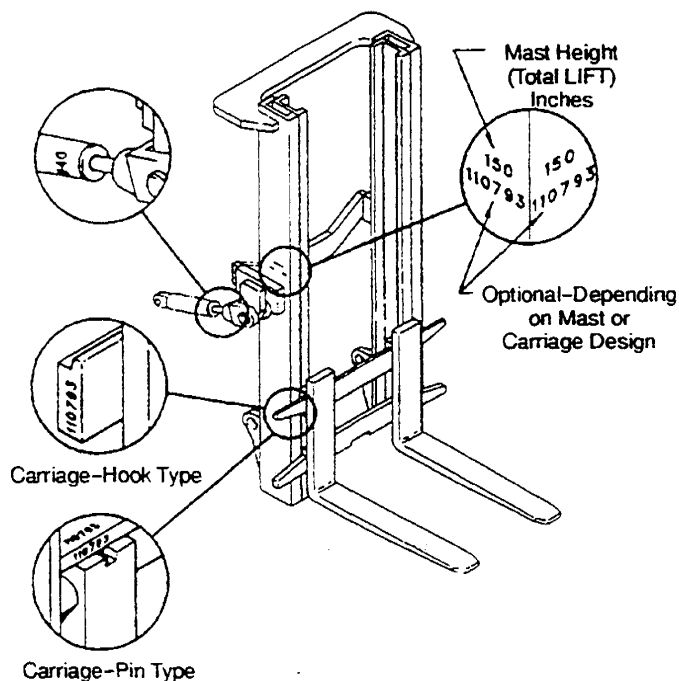



NOTES



PUBLICATIONS (Figure 1)

Every new lift truck is provided with at least three publications. These publications are the PARTS MANUAL, the OPERATING MANUAL, and the section of the SERVICE MANUAL called Periodic Maintenance.

The OPERATING MANUAL must always be available on every lift truck. This manual has information that the operator must know for inspection and operation of the lift truck. The section Periodic Maintenance

has a recommended schedule of service intervals and the procedures for servicing the lift truck.

These manuals, other publications and programs are available from your Dealer for Hyster Lift Trucks to help you operate and maintain your lift truck professionally. See the list that follows for reference to items for lift trucks in this PARTS MANUAL.

OPERATING MANUAL	
English (US) Last Used On S/N C8D-1549	599972
English (US) First Used On S/N C8D-1550	897374
English (Non-US)	897203
French	910416
German	910392
Spanish	910479
Dutch	910475
SERVICE MANUAL (COMPLETE)	
599974	
The Frame (100 SRM 267)	910467
The Perkins T8.540, TV8.640 Engines (600 SRM 269)	910760
The Three Speed Transmission (Hyster)	
Description And Operation (1300 SRM 17)	910188
Repairs (1300 SRM 171)	910015
The Three Speed Transmission (Clark)	
Description And Operation (1300 SRM 375)	897240
Repairs (1300 SRM 376)	897241
The Differential (1400 SRM 46)	910072
The Planetary Gear Axle (1400 SRM 47)	910030
The Steering Control Unit (1600 SRM 58)	899776
The Steering Axle (1600 SRM 71)	910031
The Brake System (Drum Brakes) (1800 SRM 273)	910755
The Brake System (Disc Brakes) (1800 SRM 425)	897359
The Hydraulic System (1900 SRM 253)	910462
Hydraulic Gear Pumps (1900 SRM 97)	910091
The Main Control Valve (2000 SRM 250)	910451
The Attachment Control Valve (2000 SRM 251)	910452
The Remote Control Valve (2000 SRM 249)	910450
The Flow Control Valve (2000 SRM 252)	910463
The Tilt Control Valve (2100 SRM 102)	910101
The Tilt Cylinders (2100 SRM 103)	910102
The Alternator (2200 SRM 2)	899784
The Starter (2200 SRM 106)	910107
The Mast (4000 SRM 268)	910468
The Fixed Container Attachment (5000 SRM 266)	910466
The Extendable Container Attachment (5000 SRM 265)	910457
Periodic Maintenance (Early Models) (8000 SRM 271)	910752
Periodic Maintenance (Late Models) (8000 SRM 440)	897381
Capacities & Specifications (Early Model) (8000 SRM)	910758
Capacities & Specifications (Late Models) (8000 SRM)	897387
Diagrams (8000 SRM 276)	910751
Inch (SAE) And Metric Fasteners (8000 SRM 231)	910442
PARTS MANUAL	599971
OPERATOR TRAINING PROGRAM	
Operator Training Kit-Complete	
Slide Format With Carry Case	599628
1/2" VHS Format With Carry Case	852800
"Safety Is An Attitude" (1/2" VHS)	852690
"Safety Rules" Playing Cards	852695
SOLD ALONE CATALOG	852505



FRAME

COUNTERWEIGHT (Figure 5)	Page 10
FLOORPLATES (Figure 2)	Page 4
HOOD LINKAGE (Figure 4)	Page 8
LABELS & PAINT (Figure 9)	Page 18
LADDER (Figure 10)	Page 20
OVERHEAD GUARD (Figure 3)	Page 6
PUBLICATIONS (Figure 1)	Page 1
SEAT (Figure 6) NON-ADJUSTABLE SUSPENSION WITHOUT OPERATOR RESTRAINT: LAST USED ON S/N C8D-1545, C8E-1588	Page 12
SUSPENSION SEAT (Figure 7) SEARS	Page 14
SUSPENSION SEAT (Figure 8) KAB: EUROPEAN OPTION	Page 16

FLOORPLATES (Figure 2)

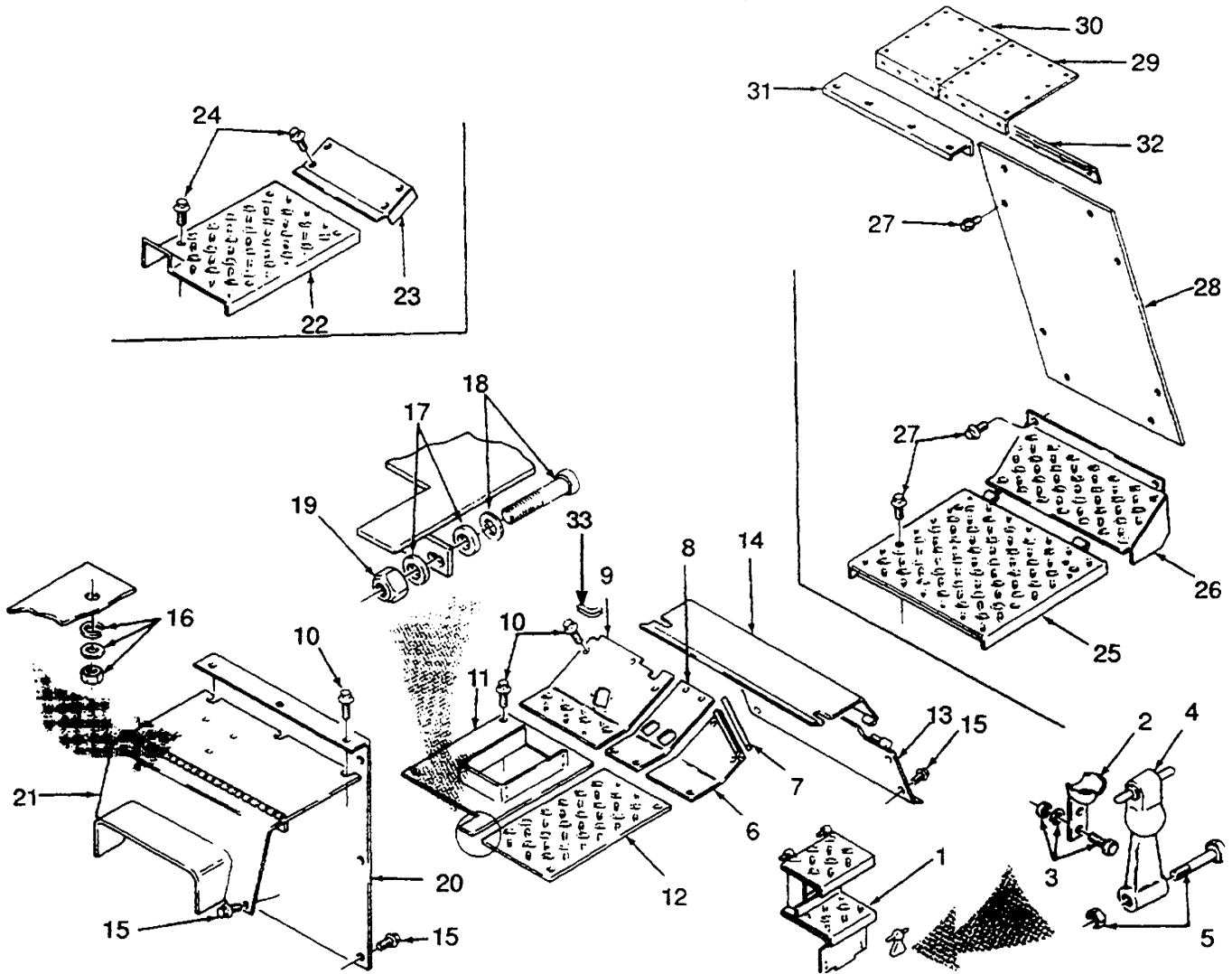

Please Click Here To Download The Complete Manual
Download Other Manuals
If Having Any Questions Feel Free To Contact us

admin@servicemanualbit.com