

# **PARTS MANUAL**

**CHALLENGER**

**H30-60H**

**(D003)**

**CUSTOMER EDITION**

# ***HYSTER***

## ILLUSTRATED CONTENTS

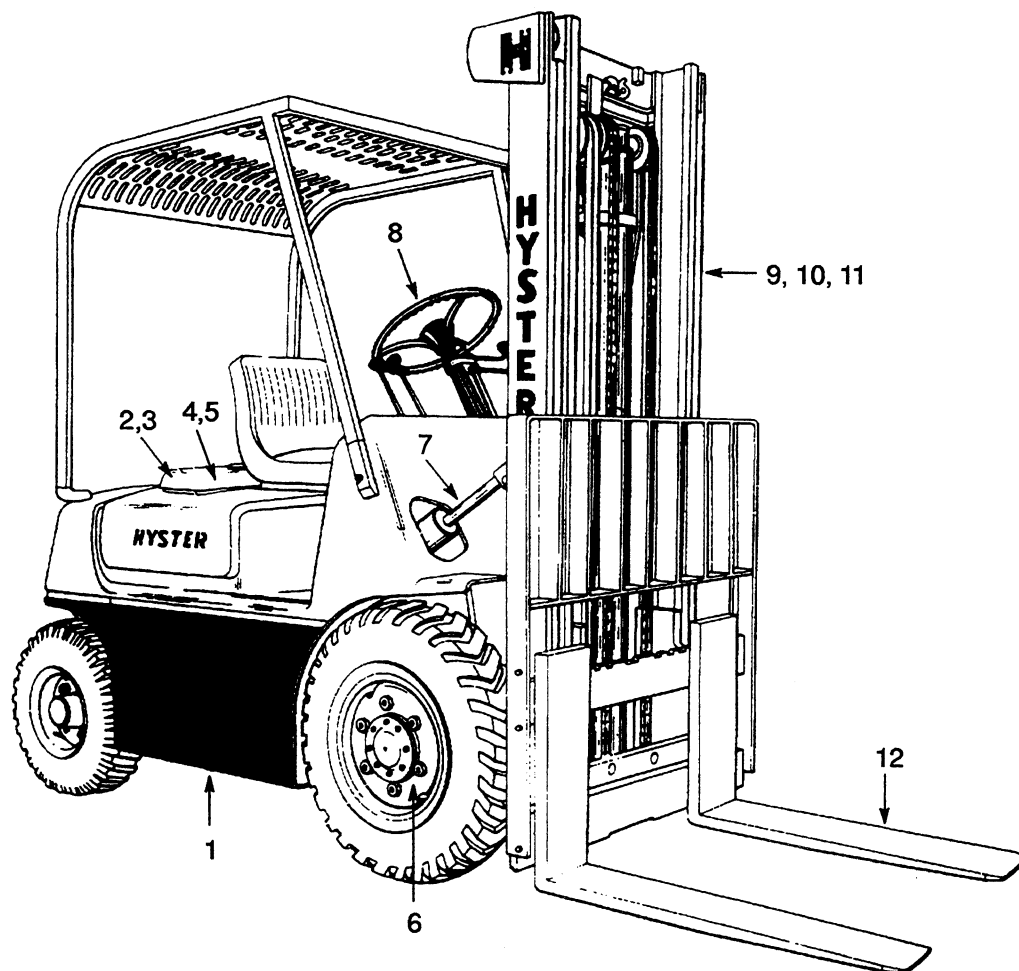

REF	SECTION	PAGE
1	FRAME .....	Page 3
2	ENGINE .....	Page 15
3	FUEL SYSTEM .....	Page 63
4	ELECTRICAL SYSTEM .....	Page 91
5	TRANSMISSION AND CLUTCH .....	Page 107
6	BRAKE .....	Page 131
7	HYDRAULIC SYSTEM .....	Page 141
8	STEERING SYSTEM .....	Page 161
9	FULL FREE-LIFT MAST .....	Page 181
10	INTERMEDIATE FREE-LIFT MAST .....	Page 169
11	THREE STAGE MAST .....	Page 195
12	OPTIONAL .....	Page 213
..	NUMERIC INDEX .....	Page 235

## TABLE OF CONTENTS

<u>DESCRIPTION</u>	<u>PAGE</u>
<b>A</b>	
AIR FILTER (Figure 44) 4-172 AND 4-192 GASOLINE AND LPG ENGINES .....	Page 86
AIR FILTER (Figure 45) 4.203 AND 4.203.2 DIESEL ENGINES .....	Page 87
ALTERNATOR (Figure 51) LAST USED ON S/N D3D-6004, D3A-5305, D3H-3404, D3E-3510, D3S-2535, D3T-2011 .....	Page 102
ALTERNATOR (Figure 52) .....	Page 104
<b>B</b>	
BLOCK HANDLER (Figure 104) .....	Page 214
BRAKE LINKAGE (Figure 67) OIL CLUTCH .....	Page 133
BRAKE LINKAGE (Figure 68) POWERSHIFT .....	Page 134
BRAKES (Figure 70) .....	Page 138
<b>C</b>	
CARBURETOR (Figure 35) 4-172 AND 4-192 GASOLINE ENGINE .....	Page 68
CARBURETOR (Figure 36) LPG .....	Page 70
CARRIAGE (Figure 103) .....	Page 212
CARRIAGE (Figure 90) INTERMEDIATE FREE-LIFT .....	Page 179
CARRIAGE (Figure 95) FULL FREE LIFT .....	Page 194
CLUTCH (Figure 56) .....	Page 112
CLUTCH PEDAL (Figure 57) .....	Page 114
CONTROL KNOBS (Figure 116) .....	Page 234

## TABLE OF CONTENTS

<u>DESCRIPTION</u>	<u>PAGE</u>
<b>C (Continued)</b>	
CONTROL VALVE (Figure 62) POWERSHIFT .....	Page 124
CONTROL VALVE (Figure 74) TWO FUNCTION .....	Page 150
CONTROL VALVE (Figure 75) THREE FUNCTION .....	Page 152
CONTROL VALVE (Figure 76) FOUR FUNCTION .....	Page 154
CONTROL VALVE LINKAGE (Figure 72) .....	Page 146
CONTROL VALVE LINKAGE (Figure 73) .....	Page 148
COOLING (Figure 11) .....	Page 27
COUNTERWEIGHT (Figure 3) .....	Page 8
COWL AND FLOORPLATES (Figure 1) .....	Page 4
CRANKSHAFT (Figure 18) 4.203 DIESEL ENGINE .....	Page 38
CRANKSHAFT (Figure 19) 4.203.2 DIESEL ENGINE .....	Page 40
CRANKSHAFT, PISTONS AND FLYWHEEL (Figure 8) GASOLINE 4-172 AND 4-192 .....	Page 22
CYLINDER BLOCK (Figure 16) 4.203 DIESEL ENGINE .....	Page 34
CYLINDER BLOCK (Figure 17) 4.203.2 DIESEL ENGINE .....	Page 36
CYLINDER (Figure 110) SIDESHIFT .....	Page 222
CYLINDER HEAD AND EXHAUST MANIFOLD (Figure 20) 4.203 DIESEL ENGINE .....	Page 42
CYLINDER HEAD AND EXHAUST MANIFOLD (Figure 21) 4.203.2 DIESEL ENGINE .....	Page 44

## TABLE OF CONTENTS

<u>DESCRIPTION</u>	<u>PAGE</u>
<b>D</b>	
DIFFERENTIAL (Figure 64) OIL CLUTCH AND POWERSHIFT .....	Page 126
DISTRIBUTOR (Figure 53) .....	Page 106
DRIVE AXLE (Figure 65) .....	Page 128
<b>E</b>	
ELECTRICAL (Figure 49) 4.203 AND 4.203.2 DIESEL ENGINES .....	Page 96
ELECTRICAL SYSTEM (Figure 48) 4-172 AND 4-192 GASOLINE ENGINES .....	Page 92
ENGINE (Figure 7) GASOLINE 4-172 AND 4-192 .....	Page 18
ENGINE MOUNT (Figure 31) 4.203 AND 4.203.2 DIESEL ENGINE .....	Page 60
ENGINE MOUNT (Figure 9) GASOLINE ENGINES 4-172 AND 4-192 .....	Page 25
EXHAUST (Figure 12) .....	Page 28
EXHAUST (Figure 13) STEVEDORING .....	Page 29
EXHAUST (Figure 14) GS LPS AND DS ENGINES .....	Page 30
<b>F</b>	
FORK EXTENSION (Figure 107) .....	Page 217
FORKS (Figure 105) .....	Page 215
FORWARD AND REVERSE LEVER (Figure 112) .....	Page 226
FREE LIFT (Figure 98) H30-50H (H1.50-2.50H) .....	Page 202
FREE LIFT (Figure 99) H60H (H3.00H) .....	Page 204

## TABLE OF CONTENTS

<u>DESCRIPTION</u>	<u>PAGE</u>
<b>F (Continued)</b>	
FUEL (Figure 33) GASOLINE AND DIESEL .....	Page 64
FUEL (Figure 34) LPG .....	Page 66
FUEL FILTER AND LINES (Figure 40) 4.203 DIESEL ENGINE .....	Page 78
FUEL FILTER AND LINES (Figure 41) 4.203.2 DIESEL ENGINE .....	Page 80
FUEL FILTER (Figure 47) LPG .....	Page 89
FUEL INJECTION (Figure 43) 4.203.2 DIESEL ENGINE .....	Page 84
FUEL INJECTION (Figure 42) 4.203 DIESEL ENGINE .....	Page 82
<b>H</b>	
HAND PUMP (Figure 82) .....	Page 164
HEADER HOSES (Figure 102) THREE STAGE .....	Page 210
HEADER HOSES (Figure 89) INTERMEDIATE FREE-LIFT .....	Page 176
HEADER HOSES (Figure 94) FULL FREE-LIFT MAST .....	Page 192
HOOD AND LINKAGE (Figure 2) .....	Page 6
HYDRAULIC DRIVE PUMP (Figure 26) 4.203 AND 4.203.2 DIESEL ENGINE .....	Page 53
HYDRAULIC FILTER (Figure 78) .....	Page 157
HYDRAULIC PUMP (Figure 77) .....	Page 156
HYDRAULIC SYSTEM (Figure 71) .....	Page 142

## TABLE OF CONTENTS

<u>DESCRIPTION</u>	<u>PAGE</u>
<b>I</b>	
INNER AND OUTER MASTS (Figure 91) FULL FREE-LIFT .....	Page 182
INTAKE MANIFOLD AND THERMOSTAT (Figure 29) 4.203 AND 4.203.2 DIESEL ENGINE .....	Page 56
<b>L</b>	
LABELS AND PAINT (Figure 5) .....	Page 10
LIFT CYLINDER (Figure 100) MAIN THREE STAGE .....	Page 206
LIFT CYLINDER (Figure 101) FREE LIFT THREE STAGE .....	Page 208
LIFT CYLINDER (Figure 88) .....	Page 174
LIFT CYLINDER (Figure 93) FULL FREE LIFT .....	Page 188
LIFT (Figure 87) INTERMEDIATE FREE-LIFT .....	Page 172
LIFT (Figure 92) FULL FREE-LIFT .....	Page 186
LIFT (Figure 97) MAIN THREE STAGE .....	Page 200
LIGHTS (Figure 111) .....	Page 224
LOAD EXTENSION (Figure 106) .....	Page 216
LPG CONVERTER (Figure 37) .....	Page 72
<b>M</b>	
MAGNETIC VALVE LOCK-OFF (Figure 46) .....	Page 88
MAST (Figure 96) THREE STAGE .....	Page 196

## TABLE OF CONTENTS

<u>DESCRIPTION</u>	<u>PAGE</u>
<b>M (Continued)</b>	
MASTER CYLINDER (Figure 69) .....	Page 136
MONOTROL PEDAL (Figure 63) POWERSHIFT .....	Page 125
<b>O</b>	
OIL FILTER (Figure 27) 4.203 DIESEL ENGINE LAST USED ON ENGINE 203U-70864 .....	Page 54
OIL FILTER (Figure 28) 4.203 AND 4.203.2 DIESEL ENGINE FIRST USED ON ENGINE 203U-70865 .....	Page 55
OIL PIPES (Figure 25) 4.203 AND 4.203 DIESEL ENGINE .....	Page 52
OIL PUMP AND OIL PAN (Figure 24) 4.203 AND 4.203.2 DIESEL ENGINE .....	Page 50
OIL PUMP (Figure 10) GASOLINE ENGINES 4-172 AND 4-192 .....	Page 26
OUTER AND INNER MASTS (Figure 86) INTERMEDIATE FREE-LIFT .....	Page 170
OVERHEAD EXHAUST (Figure 15) NON-STEVEDORING .....	Page 32
OVERHEAD GUARD (Figure 4) .....	Page 9
<b>P</b>	
PARK BRAKE (Figure 66) .....	Page 132
POWERSHIFT TRANSMISSION (Figure 61) .....	Page 122
PUBLICATIONS .....	Page 1
<b>R</b>	
RELIEF VALVE (Figure 80) .....	Page 160



## TABLE OF CONTENTS

<u>DESCRIPTION</u>	<u>PAGE</u>
<b>S</b>	
SEAT (Figure 6) .....	Page 12
SHIFT LINKAGE (Figure 58) OIL CLUTCH .....	Page 116
SIDESHIFT CARRIAGE (Figure 108) INTERMEDIATE FREE-LIFT .....	Page 218
SIDESHIFT CARRIAGE (Figure 109) THREE STAGE AND FULL FREE-LIFT .....	Page 220
STARTER MOTOR (Figure 50) .....	Page 100
STEERING AXLE (Figure 84) .....	Page 166
STEERING CONTROL (Figure 81) .....	Page 162
STEERING CONTROL VALVE (Figure 83) .....	Page 165
STEERING CYLINDER (Figure 85) .....	Page 168
<b>T</b>	
THROTTLE LINKAGE (Figure 38) GASOLINE ENGINE .....	Page 74
THROTTLE LINKAGE (Figure 39) 4.203 AND 4.203.2 DIESEL ENGINE .....	Page 76
TILT CYLINDER (Figure 79) .....	Page 158
TIMING GEARS (Figure 30) 4.203 AND 4.203.2 DIESEL ENGINE .....	Page 58
TIRES AND WHEELS (Figure 113) SINGLE DRIVE WHEELS .....	Page 228
TIRES AND WHEELS (Figure 114) DUAL DRIVE WHEELS .....	Page 230
TIRES AND WHEELS (Figure 115) STEERING .....	Page 232
TRANSMISSION CONTROL PIPES (Figure 59) POWERSHIFT .....	Page 118

## TABLE OF CONTENTS

<u>DESCRIPTION</u>	<u>PAGE</u>
<b>T (Continued)</b>	
TRANSMISSION GEARS (Figure 55) OIL CLUTCH .....	Page 110
TRANSMISSION HOUSING AND TORQUE CONVERTER (Figure 60) .....	Page 120
TRANSMISSION HOUSING (Figure 54) OIL CLUTCH .....	Page 108
<b>V</b>	
VALVE GEAR AND COVER (Figure 22) 4.203 DIESEL ENGINE .....	Page 46
VALVE GEAR AND COVER (Figure 23) 4.203.2 DIESEL ENGINE .....	Page 48
<b>W</b>	
WATER PUMP (Figure 32) 4.203 AND 4.203.2 DIESEL ENGINE .....	Page 61

## HOW TO USE ILLUSTRATED PARTS MANUAL

This parts manual describes and illustrates assemblies, subassemblies, and detail parts needed for service replacement.

The different constructions are indicated by keys, symbols and footnotes.



SERIAL CODE C187

3

4

TABLE OF CONTENTS

DESCRIPTION

CARRIAGE (Figure 107) VISTA 2-STG LFL ..... Page 192

CARRIAGE (Figure 136) VISTA 3-STG FFL .....

CARRIAGE (Figure 166) VISTA 2-STG FFL .....

CARRIAGE (Figure 197) VISTA 4-STG FFL .....

CARRIAGE (Figure 203) SIDE-SHIFT .....

CARRIAGE (Figure 204) SIDE-SHIFT .....

CLUTCH-FORWARD AN .....



SERIAL CODE C187

360

SERIAL CODE C187

INDEX—NUMERICAL

PART NO	REF FIGURE NO	PART NO	REF FIGURE NO	PART NO	REF FIGURE NO	PART NO	REF FIGURE NO	PART NO	REF FIGURE NO
126	51 28	90	13	97	19	33	20	129	14
		99	18	99	18	35	10	181	11
		101	19	101	19	36	16	15212	2



SERIAL CODE C108

1

5

ILLUSTRATED CONTENTS

Page 234

SERIAL CODE C108

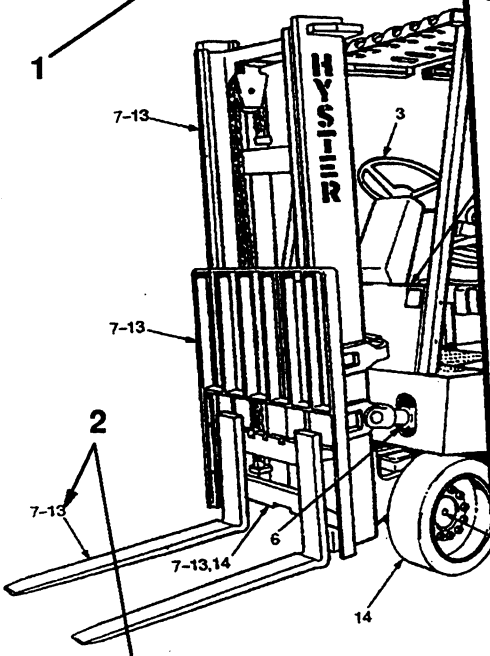

CARRIAGE (Figure 123)

LAST USED ON S/N PENDING PER ECN 98765

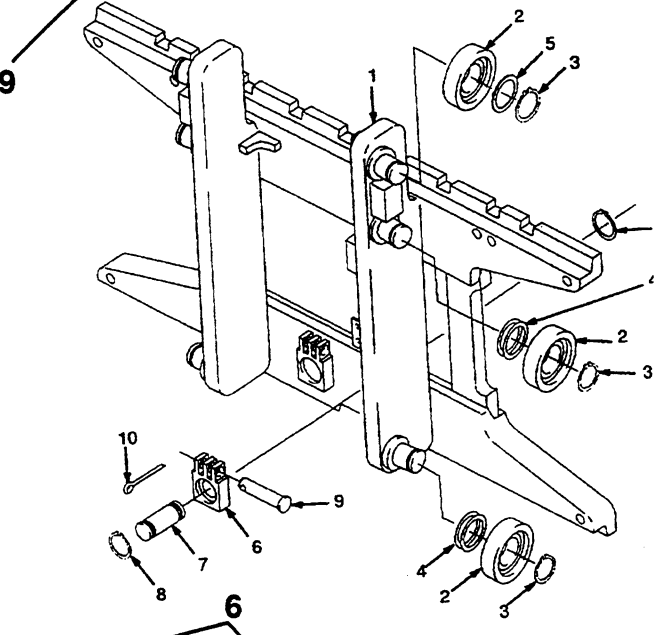

KEY

A: E40-50XL

B: E60XL

REF	PART NO.	NAME OF PART	QTY	REF	PART NO.	NAME OF PART
	1371660	Carriage	1	4	1345263	Shim
	1371661	Carriage	1	5	366116	Spacer
	1359245	Frame	1	6	1369345	Chain Anchor
1	1359246	Frame	1	6	1369344	Chain Anchor
1	1345218	Load Roller ("A" Standard)	6	7	317735	Pin
2	1345219	Load Roller ("B" 0.03 in.)	6	8	131358	Snap Ring
2	1345220	Load Roller ("C" 0.06 in.)	6	9	323161	Pin
3	12891	Snap Ring	6	10	15200	Cotter Pin

REF	DIVISION
1	Frame
2	Drive Axle
3	Steering
4	Brake/Accelerator
5	Electrical
6	Hydraulic
7	Mast-Vista Two-Stage Limited Free Lift
8	Mast-Global Two-Stage Limited Free Lift
9	Mast-Vista Three-Stage Full Free Lift
10	Mast-Global Three-Stage Full Free Lift
11	Mast-Vista Two-Stage Full Free Lift
12	Mast-Global Two-Stage Full Free Lift
13	Mast-Vista Four-Stage Full Free Lift
14	Optional Equipment

©1996 HYSTER COMPANY

See Service Manual  
for service procedures

10/14/96

## HOW TO FIND THE DESIRED PART NUMBER

### WHEN THE PART NUMBER AND THE NEXT HIGHER ASSEMBLY IS NOT KNOWN:

1. Determine the function and application of the part required. Turn to the illustrated index page immediately behind the front cover. Choose the general area of reference most likely to include the part.
2. Find the page number for the reference number you choose and turn to that page. Use the division index to determine the assembly which would normally contain the part required. Then locate the part on the assembly breakdown page.

### WHEN THE PART NUMBER IS NOT KNOWN AND THE NEXT HIGHER ASSEMBLY IS KNOWN:

3. Determine the assembly the required part is used on. Turn to the Master Index immediately following the Illustrated Index.
4. Locate the assembly the required part is used on and turn to the page indicated for that assembly. Then locate the part on the assembly breakdown page.

### WHEN THE PART NUMBER IS KNOWN:

5. Use the numerical index at the back of the manual to find the part number. Turn to the figure listed and locate the part as indicated by the reference number.

### GENERAL:

- The assembly breakdowns include part numbers, description, quantities required, keys and footnotes to help in selecting the correct parts.
6. Keys are used to show effective serial numbers for two or more similar assemblies, RH and LH assembly parts, etc. Select the appropriate key, "A", "B", "C" or "D" and the corresponding quantity column to find the required parts.
  7. Indented descriptions under "Name of Part" are used to indicate assemblies and sub-parts of assemblies. In the example, *LOAD ROLLER* (Item 2) is a subpart of the major assembly *CARRIAGE*.
  8. Quantities shown are for one assembly. The quantities of the subpart *LOAD ROLLER* are indicated as six and six. This means six per *CARRIAGE* assembly.
  9. Engineering change notice (ECN) numbers for pending serial numbers are shown to allow for the inclusion of the most current parts information. Contact your local dealer for Hyster lift trucks for serial number information listed by ECN number.
  10. Additional fork lengths are available. Contact your dealer for Hyster lift trucks.

### ORDERING PARTS:

When ordering replacement parts, give the unit serial number, part number, name of part and quantity required.

For any further information on parts, service, or ordering, consult your local dealer for Hyster lift trucks.

## IDENTIFICATION OF TRUCK SERIAL NUMBERS

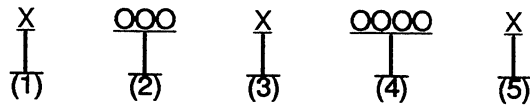

- (1) & (2) The first letter and three numbers indicates the truck model code.
- (3) The second letter indicates the plant of manufacture.
- (4) The four or five digit number series indicates the serial number of the truck.
- (5) The final letter indicates the year of manufacture starting with "A" in 1957 and 1980. The letters "I", "O", and "Q" will not be used.

For pending serial numbers contact your local dealer for Hyster lift trucks.

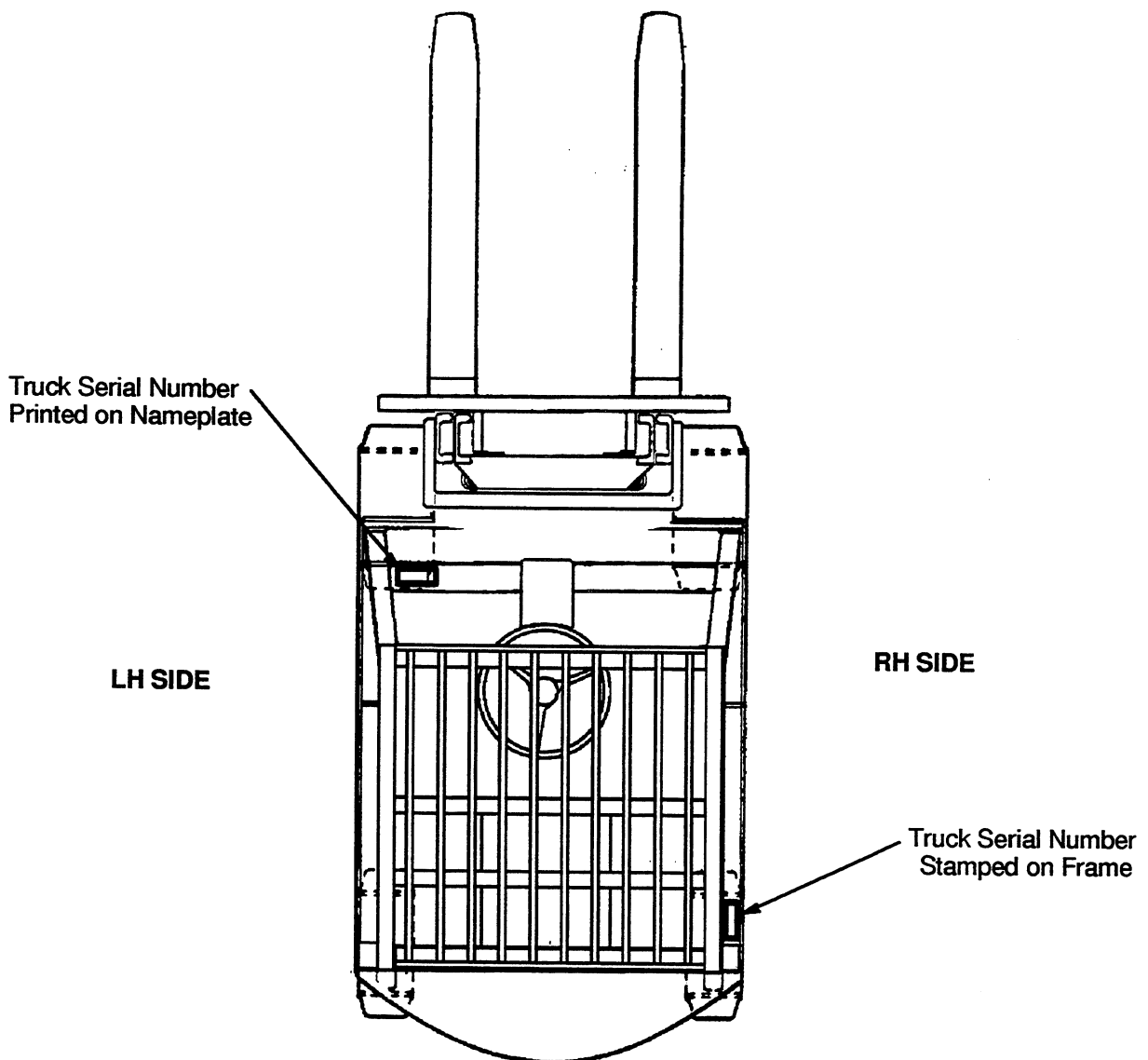

Parts referred to in this book as right or left hand parts are in accordance with the illustration above.

## IDENTIFICATION OF MASTS NUMBERS

### LIFT EQUIPMENT IDENTIFICATION

1. Mast group numbers and total lift heights are stamped on the right hand outer mast approximately four feet from the bottom of the fork. The group numbers include the inner and outer masts, lift cylinder, lift chain and bleeder hoses or pipes.
2. The carriage and tilt cylinder numbers are located as shown. Lift cylinder numbers are stamped on the cylinder shell near the bleeder screw or on the chain anchor. Fork part number, capacity rating, plant code letter and date of manufacture are stamped approximately six inches below the top RH side of forks. Always refer to these group and part numbers when ordering service parts.

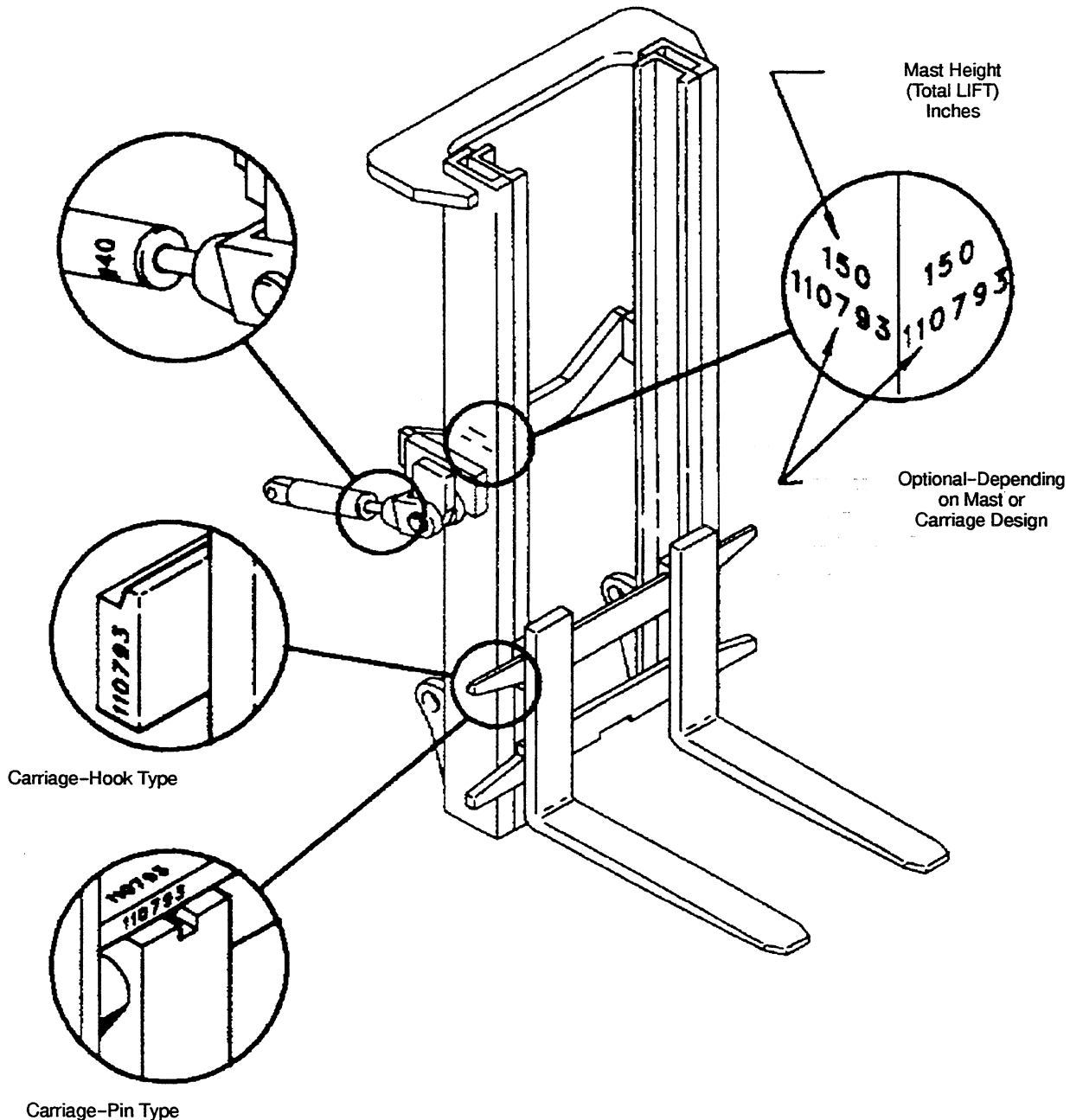



## PUBLICATIONS

Every new lift truck is provided with at least three publications. These publications are the PARTS MANUAL, the OPERATING MANUAL, and the section of the SERVICE MANUAL called Periodic Maintenance.

The OPERATING MANUAL must always be available on every lift truck. This manual has information that the operator must know for inspection and operation of the lift truck. The section Periodic

Maintenance has a recommended schedule of service intervals and the procedures for servicing the lift truck.

These manuals, other publications and programs are available from your Dealer for Hyster Lift Trucks to help you operate and maintain your lift truck professionally. See the list that follows for reference to items for lift trucks in this PARTS MANUAL.

<u>PUBLICATION</u>	<u>PART NUMBER</u>
Service Manual .....	599351
Operating Manual .....	897152
Parts Manual .....	599276





---

**FRAME**

COUNTERWEIGHT (Figure 3) ..... Page 8

COWL AND FLOORPLATES (Figure 1) ..... Page 4

HOOD AND LINKAGE (Figure 2) ..... Page 6

LABELS AND PAINT (Figure 5) ..... Page 10

OVERHEAD GUARD (Figure 4) ..... Page 9

SEAT (Figure 6) ..... Page 12

## COWL AND FLOORPLATES (Figure 1)

PARTS SERVICE GRAM	
ITEM	GRAM
8, 9	D-C-3

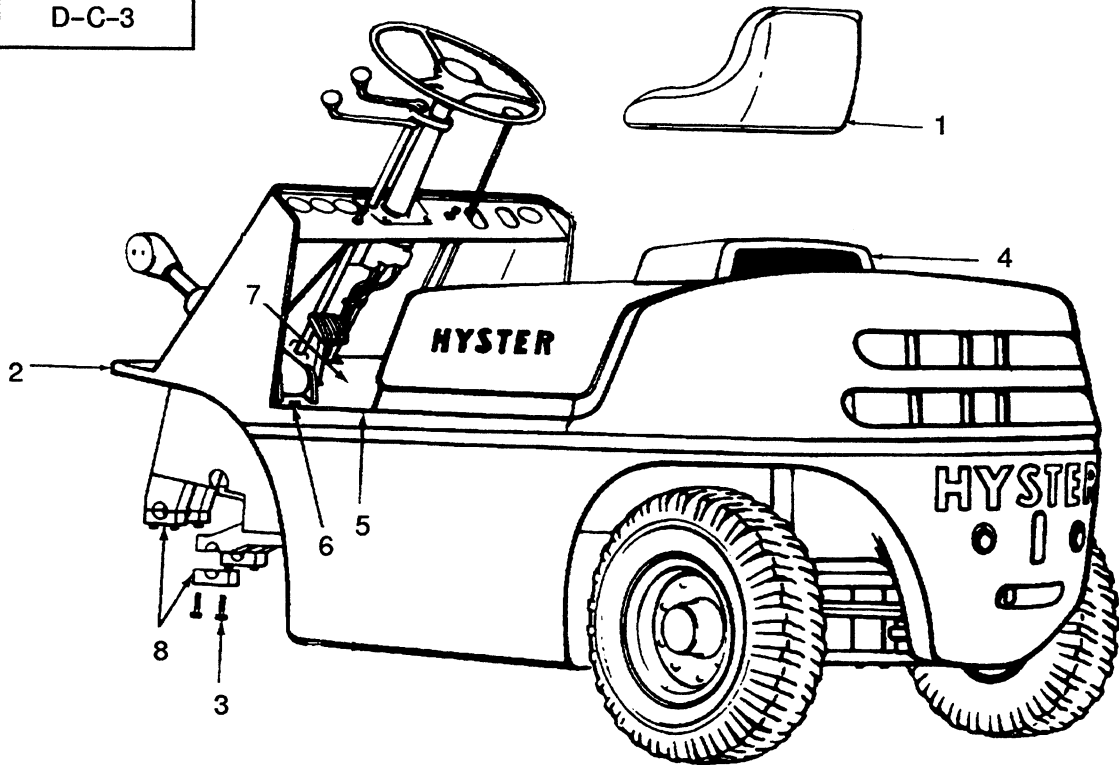

REF	PART NO.	NAME OF PART	A	B
1	.....	Seat	1	1
		☞ Figure 6		
2	137002	Plate	1	1
2	df 141710	Plate	1	1
2	ef 141711	Plate	..	..
2	g 144103	Plate (LH)	1	1
2	g 144104	Plate (RH)	1	1
3	16824	Capscrew	16	16
3	129263	Washer	16	16
3	15158	Lockwasher	16	16
4	.....	Hood	1	1
		☞ Figure 2		
5	ab 185773	Floor Plate	1	..
5	ab 218118	Floor Plate	1	..

REF	PART NO.	NAME OF PART	A	B
6	174413	Capscrew	6	6
6	121485	Bumper	3	3
7	ac 139164	Plate (OC)	..	1
7	ac 139168	Plate (PS)	1	..
8	137011	Cap	8	8
a	Also For GS And DS Trucks			
b	Rear			
c	Front			
d	Left Hand			
e	Right Hand			
f	Dual Wheel			
g	8.15 x 15 Tires			



## HOOD AND LINKAGE (Figure 2)

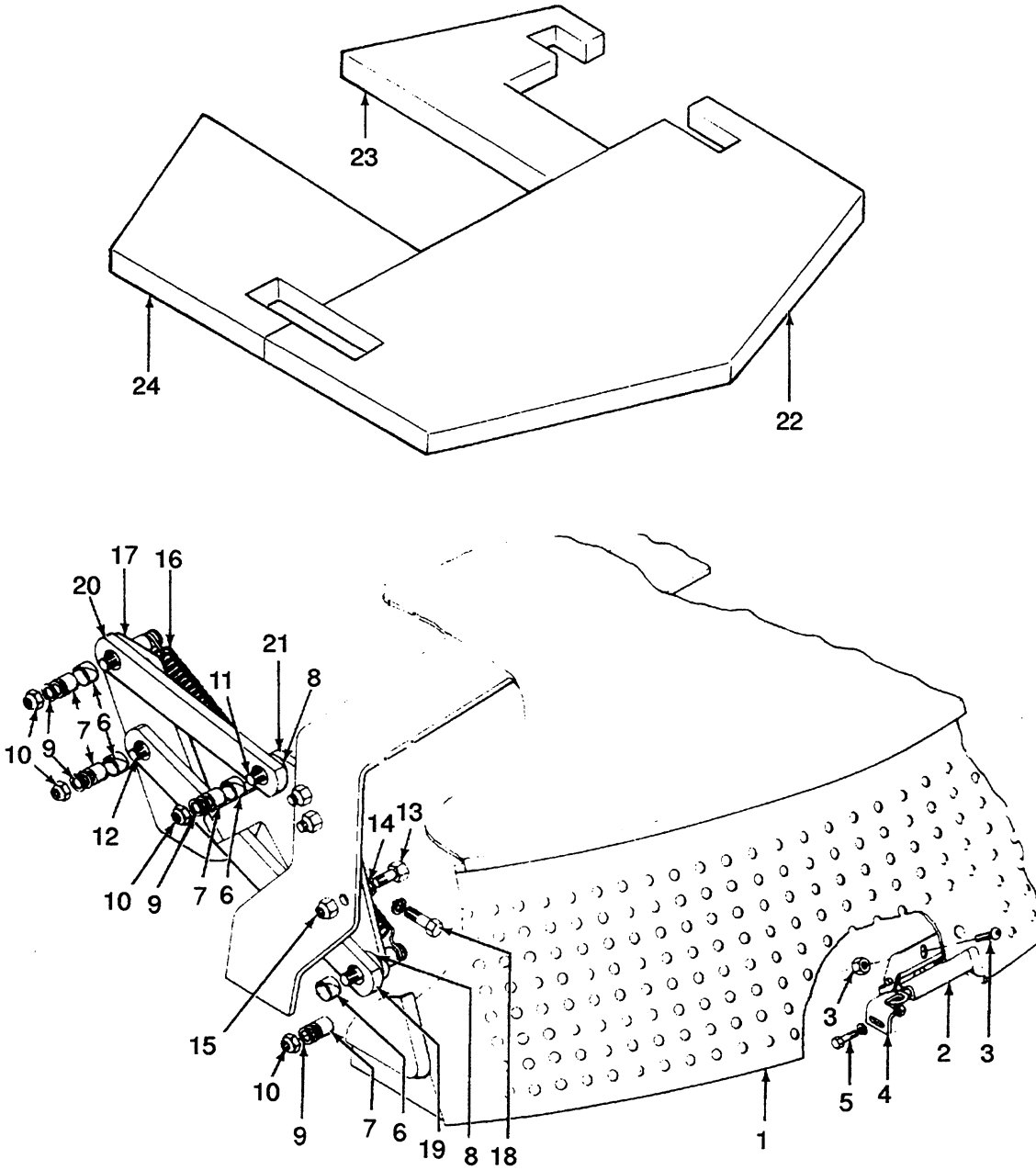

**Please Click Here To Download The Complete Manual**  
**Download Other Manuals**  
**If Having Any Questions Feel Free To Contact us**

**[admin@servicemanualbit.com](mailto:admin@servicemanualbit.com)**