

PARTS MANUAL

CHALLENGER

**H36.00-40.00-44.00C,
H48.00CH**

(H800-880-970C, 1050CH)

(C117)

CUSTOMER EDITION

HYSTER

ILLUSTRATED CONTENTS

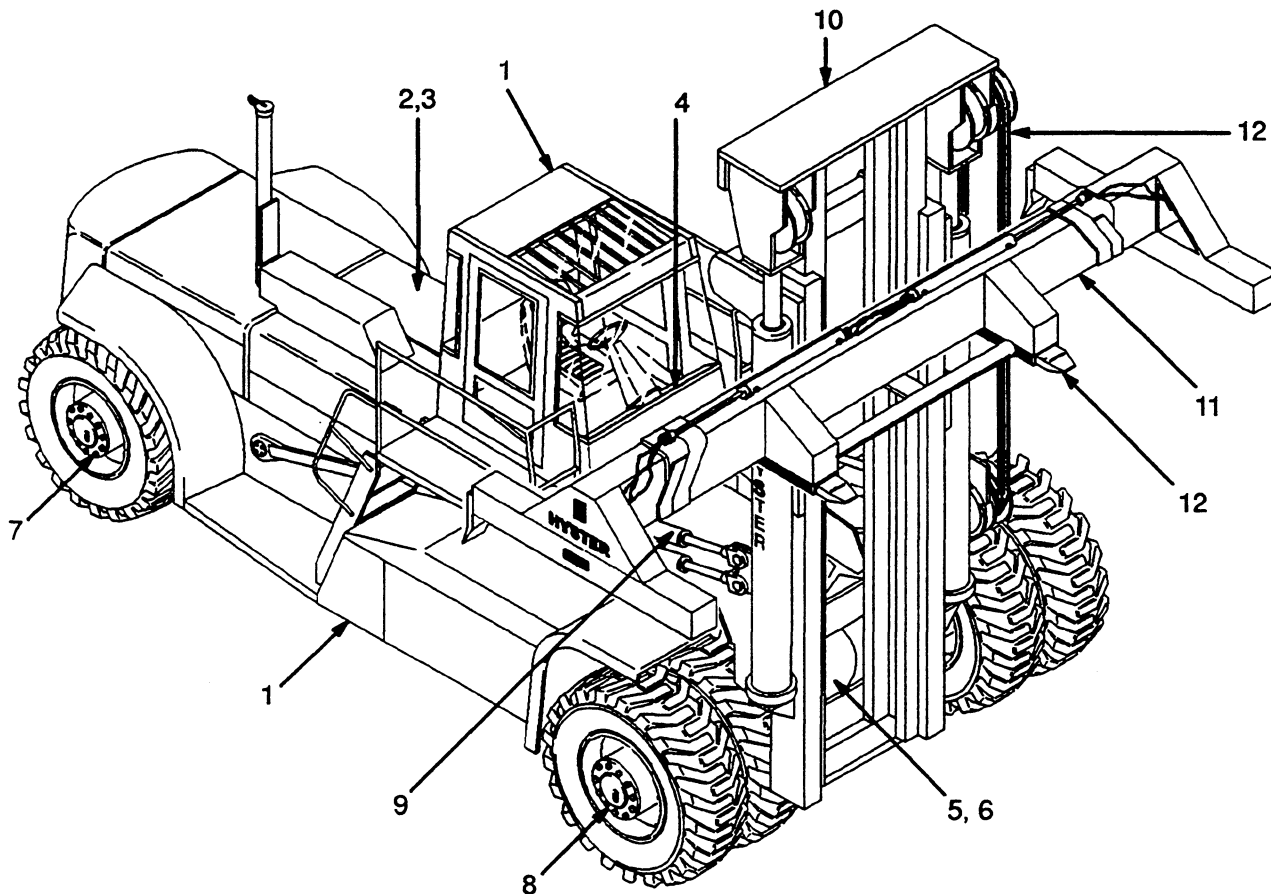

REF	SECTION	PAGE
1	Frame	5
2	Engine	29
3	Fuel	73
4	Electrical	89
5	Drive Axle	113
6	Transmission	125
7	Steering	157
8	Brakes	177
9	Hydraulic	215
10	Mast	327
11	Container Attachments	345
12	Optional Equipment	393
13	Numerical Index	417

TABLE OF CONTENTS

<u>DESCRIPTION</u>	<u>PAGE NO.</u>
A	
Accumulator Charge Valve Attaching Parts First Used On S/N C117E-1665	Page 232
Accumulator Charge Valve Attaching Parts Used On S/N C117E-1587 ⇒ C117E-1664	Page 230
Accumulator Charge Valve First Used On S/N C117E-1587	Page 234
Accumulator First Used On S/N C117E-1727	Page 240
Accumulator Piston Type	Page 241
Accumulator Used On S/N C117E-1587 ⇒ C117E-1638	Page 236
Accumulator Used On S/N C117E-1639 ⇒ C117E-1726	Page 238
Actuator Brake Last Used On S/N C117E-1586	Page 196
Actuator Park Brake Last Used On S/N C117E-1586	Page 206
Air Compressor Attaching Parts Last Used On S/N C117E-1586	Page 66
Air Compressor Last Used On S/N C117E-1586	Page 68
Air Tank First Used On S/N C117E-1518	Page 192
Air Tank Last Used On S/N C117E-1517	Page 190
Alternator Attaching Parts	Page 101
Alternator	Page 102
Attaching Parts Shut-Off Cock And Sequence Valve First Used On S/N Pending Per ECN 70150	Page 292
Attachment Control Valve Attaching Parts Last Used On S/N C117E-1664	Page 250
Attachment Control Valve Attaching Parts First Used On S/N C117E-1665	Page 252

TABLE OF CONTENTS

<u>DESCRIPTION</u>	<u>PAGE NO.</u>
A (Continued)	
Attachment Control Valve	Page 318
B	
Barrier	Page 24
Block Valve Attaching Parts Extendable Attachment With Dedicated Carriage	Page 368
Brake Lines Air Brake System First Used On S/N C117E-1529	Page 182
Brake Lines Air Brake System Last Used On S/N C117E-1528	Page 180
Brake Lines Hydraulic Brake System (1 Of 3) First Used On S/N C117E-1587	Page 184
Brake Lines Hydraulic Brake System (2 Of 3) Used On S/N C117E-1587 ⇒ C117E-1664	Page 186
Brake Lines Hydraulic Brake System (3 Of 3) First Used On S/N C117E-1665	Page 188
C	
Camshaft And Timing Gear	Page 50
Check Valve Used On S/N C117E-1550 ⇒ C117E-1586 (Except C117E-1554, 1555)	Page 211
Control Lever Transmission	Page 152
Control Valve Attaching Parts - One Function First Used On S/N Pending Per ECN 70150	Page 286
Control Valve Attaching Parts - One Function Last Used On S/N Pending Per ECN 70150	Page 284
Control Valve Attaching Parts - Two Function First Used On S/N Pending Per ECN 70150	Page 290
Control Valve Attaching Parts - Two Function Last Used On S/N Pending Per ECN 70150	Page 288
Control Valve Attaching Parts Last Used On S/N C117E-1664	Page 282

TABLE OF CONTENTS

DESCRIPTION	PAGE NO.
C (Continued)	
Control Valve Attaching Parts	Page 140
Control Valve First Used On S/N Pending Per ECN 70150	Page 298
Control Valve Last Used On S/N C117E-1664	Page 295
Control Valve Used On S/N C117E-1665 ⇒ S/N Pending Per ECN 70150	Page 296
Control Valve	Page 142
Control Lift And Tilt First Used On S/N C117E-1665	Page 270
Control Lift And Tilt Last Used On S/N C117E-1664	Page 268
Coolant Pump	Page 54
Cooling	Page 34
Counterweight	Page 19
Crankcase	Page 38
Crankshaft And Piston	Page 40
Cylinder Head Assembly	Page 44
Cylinder Extendable Attachment	Page 377
Cylinder Fixed Attachment Without Slewing	Page 376
Cylinder Fork Positioner	Page 409
Cylinder Twist Lock	Page 379
D	
Dedicated Carriage	Page 412
Differential 1 Of 2 First Used On S/N C117E-1587	Page 118
Differential 2 Of 2 First Used On S/N C117E-1587	Page 120

TABLE OF CONTENTS

<u>DESCRIPTION</u>	<u>PAGE NO.</u>
D (Continued)	
Differential Last Used On S/N C117E-1586	Page 116
Drive Axle	Page 114
Drive Shaft Transmission Input	Page 123
Drive Shaft	Page 122
E	
Electrical Connectors less terminals	Page 112
Electrical Container Handling Attachment	Page 364
Electrical Dedicated Carriage	Page 362
Electrical Extendable Container Attachment	Page 367
Electrical Sideshift Carriage	Page 402
Electrical Standard Carriage	Page 342
Electrical	Page 90
Engine Mounts	Page 30
Exhaust	Page 33
Extendable Attachment	Page 350
F	
Fan Belt	Page 36
Fire Extinguisher	Page 411
Fixed Attachment	Page 348
Floorplates And Covers	Page 16
Flow Amplifier Attaching Parts First Used On S/N C117E-1665	Page 172
Flow Amplifier Attaching Parts Last Used On S/N C117E-1664	Page 170
Flow Amplifier	Page 174

TABLE OF CONTENTS

DESCRIPTION	PAGE NO.
F (Continued)	
Flow Regulator Attaching Parts Last Used On S/N C117E-1586	Page 266
Flow Valve Extendable Attachment	Page 385
Flywheel	Page 42
Fork Positioner	Page 407
Forks	Page 408
Fuel Filter	Page 82
Fuel Injection Low Pressure System	Page 77
Fuel Injection	Page 78
Fuel System	Page 74
G	
Gear Assy	Page 150
H	
Harness Adapter	Page 111
Harness Park Brake	Page 110
Header Hose	Page 396
Heater Control	Page 18
Heater	Page 12
Hood	Page 22
Hose Sheave Extendable Attachment	Page 381
Housing Torque Converter	Page 132
Hydraulic Lines	Page 224
Hydraulic Lines Junction Block And Two-Speed Valve First Used On S/N C117E-1665	Page 226
Hydraulic Pump Main	Page 320

TABLE OF CONTENTS

DESCRIPTION	PAGE NO.
H (Continued)	
Hydraulic Pump Steering	Page 322
Hydraulic Supply And Return First Used On S/N C117E-1665	Page 222
Hydraulic Supply And Return Last Used On S/N C117E-1664	Page 220
Hydraulic Tank	Page 264
Hydraulic Extendable Attachment With Dedicated Carriage	Page 356
Hydraulic Extendable Attachment With Sideshift Carriage	Page 354
Hydraulic Fixed Attachment	Page 360
Hydraulic Sideshift Carriage	Page 404
Hydraulic Standard Carriage	Page 340
I	
Inching Valve First Used On S/N C117E-1587	Page 212
Indicator Twist Lock	Page 380
Injection Pump Mount	Page 76
Injector	Page 80
Instrument Panel 1 Of 2	Page 94
Instrument Panel 2 Of 2	Page 98
Intake	Page 84
Interlock Valve Twist Lock	Page 382
J	
Junction Block Used On S/N C117E-1665 ⇒ C117E-1695	Page 254
L	
Labels And Paint	Page 26

TABLE OF CONTENTS

DESCRIPTION	PAGE NO.
L (Continued)	
Lift Cylinder First Used On Mast S/N Pending Per ECN 99524	Page 336
Lift Cylinder Last Used On Mast S/N Pending Per ECN 99524	Page 334
Lift	Page 332
Lights First Used On S/N C117E-1537	Page 106
M	
Maintenance Parts Quick Reference List	Page 1
Manifold Attaching Parts First Used On S/N C117E-1665	Page 260
Manifold Attaching Parts Used On S/N C117E-1587 ⇒ C117E-1664	Page 258
Manifold	Page 56
Mast	Page 328
Mount Transmission	Page 138
O	
Oil Cooler	Page 61
Oil Filler	Page 48
Oil Filter	Page 156
Oil Filter	Page 58
Oil Pump First Used On S/N C117E-1647	Page 64
Oil Pump Last Used On S/N C117E-1646	Page 62
Oil Sump	Page 46
Operator Compartment 1 Of 3	Page 6
Operator Compartment 2 Of 3	Page 8
Operator Compartment 3 Of 3	Page 10

TABLE OF CONTENTS

<u>DESCRIPTION</u>	<u>PAGE NO.</u>
O (Continued)	
Output Housing Torque Converter	Page 136
P	
Park Brake Pilot Valve Attaching Parts Last Used On S/N Pending Per ECN 59846	Page 302
Park Brake Pilot Valve Used On S/N C117E-1587 ⇒ S/N Pending Per ECN 59846	Page 304
Park Brake Switch First Used On S/N Pending Per ECN 59846	Page 109
Park Brake Valve Last Used On S/N C117E-1586	Page 203
Park Brake Valve Used On S/N C117E-1587 ⇒ S/N Pending Per ECN 59846	Page 204
Pilot Valve	Page 272
Pressure Check Lines First Used On S/N C117E-1665	Page 228
Pressure Reducing And Pilot Valves Attaching Parts Used On S/N C117E-1587 ⇒ C117E-1664	Page 246
Pressure Reducing Valve Attaching Parts First Used On S/N C117E-1665	Page 248
Pressure Reducing Valve Attaching Parts Last Used On S/N C117E-1586	Page 242
Pressure Reducing Valve Attaching Parts Used On S/N C117E-1587 ⇒ C117E-1664	Page 244
Pressure Reducing Valve Last Used On S/N C117E-1586	Page 274
Pressure Reducing Valve Park Brake First Used On S/N C117E-1587	Page 277
Pressure Reducing Valve Pilot Circuits First Used On S/N C117E-1587	Page 276
Pressure Switch First Used On S/N C117E-1587	Page 108
Publications	Page 2

TABLE OF CONTENTS

<u>DESCRIPTION</u>	<u>PAGE NO.</u>
P (Continued)	
Pump Drive	Page 139
R	
Relief Valve Attaching Parts First Used On S/N C117E-1701	Page 280
Relief Valve Attaching Parts Used On S/N C117E-1665 ⇒ C117E-1700	Page 278
Relief Valve Extendable Attachment	Page 383
Relief Valve First Used On S/N C117E-1587	Page 308
Relief Valve Last Used On S/N C117E-1664	Page 307
Relief Valve Sideshift Cylinder Extendable Attachment With Dedicated Carriage	Page 387
Relief Valve Slewing Cylinder	Page 386
Relief Valve Twist Locks And Extendable Attachment Cylinders	Page 384
Return Manifold First Used On S/N C117E-1665	Page 262
Reverse Gear	Page 144
S	
Seat	Page 20
Sequence And Shuttle Valve Attaching Parts	Page 300
Sequence Valve First Used On S/N C117E-1662	Page 311
Sequence Valve Used On S/N C117E-1642 ⇒ C117E-1661	Page 309
Service Brake	Page 178
Shuttle Valve First Used On S/N C117E-1587	Page 210
Sideshift Carriage 1 Of 2	Page 398

TABLE OF CONTENTS

DESCRIPTION	PAGE NO.
S (Continued)	
Sideshift Carriage 2 Of 2	Page 400
Sideshift Cylinder With Dedicated Carriage	Page 378
Sideshift Cylinder	Page 406
Slewing Cylinder And Attaching Parts	Page 374
Solenoid Valve Carriage	Page 324
Solenoid Valve Park Brake Attaching Parts	Page 306
Solenoid Valve Park Brake First Used On S/N Pending Per ECN 59846	Page 305
Solenoid Fuel Shut-Off	Page 81
Standard Carriage	Page 338
Starter Motor	Page 104
Steering Control Valve	Page 168
Steering Cylinder	Page 166
Steering First Used On S/N C117E-1665	Page 164
Steering Last Used On S/N C117E-1664	Page 162
Strobe Light	Page 414
Switch Assy Transmission Control	Page 154
T	
Thermostat	Page 52
Throttle Linkage	Page 86
Tilt Control Valve Last Used On S/N C117E-1664	Page 273
Tilt Cylinder	Page 317
Tilt Relief Valve First Used On S/N C117E-1665	Page 316

TABLE OF CONTENTS

<u>DESCRIPTION</u>	<u>PAGE NO.</u>
T (Continued)	
Tilt Hydraulic First Used On S/N C117E-1665	Page 314
Tilt Hydraulic Last Used On S/N C117E-1664	Page 312
Torque Converter Attaching Parts	Page 130
Torque Converter	Page 134
Trail Axle	Page 158
Transmission Housing	Page 129
Transmission Attaching Parts	Page 126
Treadle Valve First Used On S/N C117E-1587	Page 200
Treadle Valve Inching Last Used On S/N C117E-1586	Page 198
Treadle Valve Service Brake Last Used On S/N C117E-1586	Page 199
Turbocharger	Page 70
Twist Lock First Used On S/N C117E-1629	Page 372
Twist Lock Last Used On S/N C117E-1628	Page 370
Two-Speed Valve First Used On S/N C117E-1696	Page 256
Tyre And Wheel	Page 394
U	
Unloader Valve Last Used On S/N C117E-1586	Page 194
V	
Valve Inching First Used On S/N C117E-1587 Last Used On Transmission S/N 6685 (Also 6687, 6689, 6690-91)	Page 147
Valve Inching First Used On Transmission S/N 6686 (Except 6687, 6689, 6690-91)	Page 149

TABLE OF CONTENTS

DESCRIPTION	PAGE NO.
V (Continued)	
Valve Inching Last Used On S/N C117E-1586	Page 146
Valve Relay First Used On S/N C117E-1587	Page 208
W	
Wear Plate Extendable Attachment First Used On S/N A660E-1542	Page 390
Wear Plate Extendable Attachment Last Used On S/N A660E-1541	Page 388
Windscreen Washer	Page 14

HOW TO USE THE ILLUSTRATED PARTS MANUAL

This parts manual describes and illustrates assemblies, subassemblies, and detail parts needed for service replacement.

The different constructions are indicated by keys, symbols and footnotes.

HYSTER
SERIAL CODE E7

3 → **TABLE OF CONTENTS** → **4** → **PAGE**

DESCRIPTION	PAGE
Cylinder Block Turbo	Page 48
Cylinder Block	
Cylinder Head Turbo	
Cylinder Head	
Differential First Used on E7E-1585	

NUMERICAL INDEX

PART NO	FIGURE NO	REF	PART NO	FIGURE NO	REF	PART NO	FIGURE NO	REF	PART NO	FIGURE NO	REF
						1374582	87	38			28
						1374583	87	39			31
						1374584	87	39			32
						1374598	87	38			34
						1374598	87	38			36
						1374599	87	38			38
						1374750	10	20			41
							11	24			47
						1374880	34	25			48
							35	25			

HYSTER
SERIAL CODE E7

1 → **ILLUSTRATED CONTENTS**

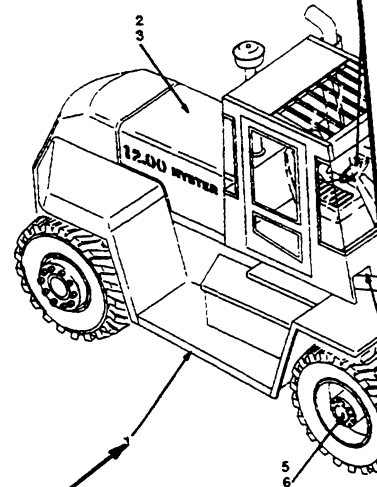

REF	SECTION
1	FRAME
2	ENGINE
3	FUEL
4	ELECTRICAL
5	BRAKE
6	TRANSMISSION
7	DRIVE AXLE
8	STEERING
9	HYDRAULIC
10	TWO-STAGE FFL
11	OPTIONAL
	...NUMERICAL INDEX

HYSTER
SERIAL CODE D177-EUR

9 → **CARRIAGE TWO-STAGE LFL SIX ROLLER**
LAST USED ON S/N PENDING PER ECN 98765 (Figure 163)

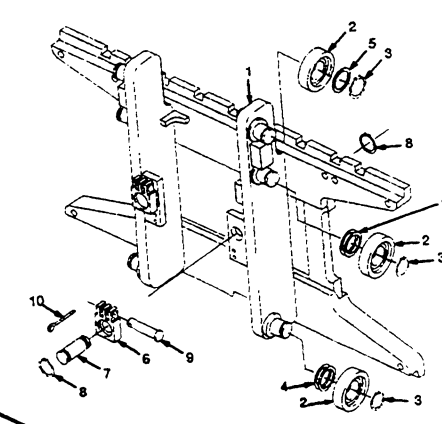

6 → **KEY**

A: H2.00-2.75X1M
B: H8.00-3.20X1M

REF	PART NO.	NAME OF PART	QTY
			A B
	5	386116 Spacer	2 2
	6	1369345 Chain Anchor	2 2
	6	1369344 Chain Anchor	2 2
	7	1345352 Pin	4 4
	8	131358 Circlip	2 2
	9	323161 Pin	2 2
	10	15200 Split Pin	2 2

7 → **KEY**

REF	PART NO.	NAME OF PART	QTY
			A B
	1	1343846 Carriage Assy	1
	1	1343847 Carriage Assy	1
	1	1338616 Frame	1
	1	1338618 Frame	1
	1	1345216 Subshaft	6 6
	2	1345218 Load Roller ("A" Standard)	6 6
	2	1345218 Load Roller ("B" 0,76 mm)	6 6
	2	1345218 Load Roller ("C" 1,52 mm)	6 6
	3	1289 Circlip	6 6
	4	1345253 Shim	ARAR

8 → **Table**

HOW TO FIND THE DESIRED PART NUMBER

WHEN THE PART NUMBER AND THE NEXT HIGHER ASSEMBLY IS NOT KNOWN:

1. Determine the function and application of the part required. Turn to the illustrated index page immediately behind the front cover. Choose the general area of reference most likely to include the part.
2. Find the page number for the reference number you choose and turn to that page. Use the division index to determine the assembly which would normally contain the part required. Then locate the part on the assembly breakdown page.

WHEN THE PART NUMBER IS NOT KNOWN AND THE NEXT HIGHER ASSEMBLY IS KNOWN:

3. Determine the assembly the required part is used on. Turn to the Master Index immediately following the Illustrated Index.
4. Locate the assembly the required part is used on and turn to the page indicated for that assembly. Then locate the part on the assembly breakdown page.

WHEN THE PART NUMBER IS KNOWN:

5. Use the numerical index at the back of the manual to find the part number. Turn to the figure listed and locate the part as indicated by the reference number.

GENERAL:

The assembly breakdowns include part numbers, description, quantities required, keys and footnotes to help in selecting the correct parts.

6. Keys are used to show effective serial numbers for two or more similar assemblies, RH and LH assembly parts, etc. Select the appropriate key, "A", "B", "C" or "D" and the corresponding quantity column to find the required parts.
7. Indented descriptions under "Name of Part" are used to indicate assemblies and sub-parts of assemblies. In the example, *LOAD ROLLER* (Item 7) is a subpart of the major assembly *CARRIAGE*.
8. Quantities shown are for one assembly. The quantities of the subpart *LOAD ROLLER* are indicated as six and six. This means six per *CARRIAGE* assembly.
9. Engineering change notice (ECN) numbers for pending serial numbers are shown to allow for the inclusion of the most current parts information. Contact your local dealer for Hyster lift trucks for serial number information listed by ECN number.
10. Additional fork lengths are available. Contact your dealer for Hyster lift trucks.

ORDERING PARTS:

When ordering replacement parts, give the unit serial number, part number, name of part and quantity required.

For any further information on parts, service, or ordering, consult your local dealer for Hyster lift trucks.

IDENTIFICATION OF TRUCK SERIAL NUMBERS

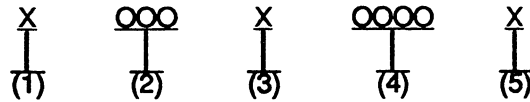

- (1) & (2) The first letter and three numbers indicate the truck model code.
- (3) The second letter indicates the plant of manufacture.
- (4) The four or five digit number series indicates the serial number of the truck.
- (5) The final letter indicates the year of manufacture starting with "A" in 1957 and 1980. The letters "I", "O", and "Q" will not be used.

For pending serial numbers contact your local dealer for Hyster lift trucks.

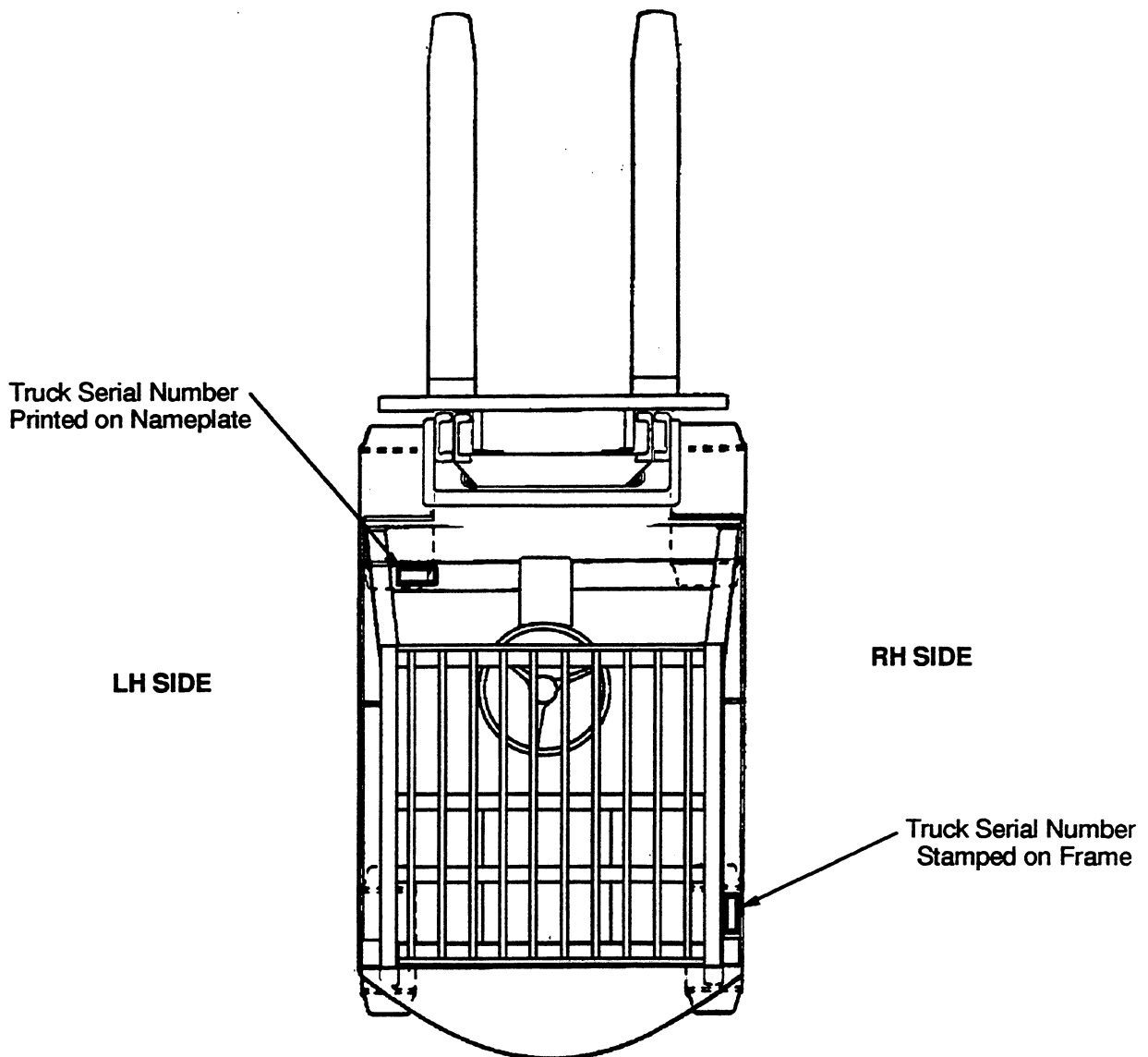

Parts referred to in this book as right or left hand parts are in accordance with the illustration above.

IDENTIFICATION OF MAST SERIAL NUMBERS

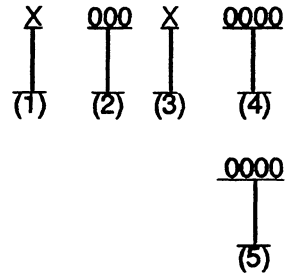

- (1) & (2) The first letter and number indicates the mast model code.
- (3) The second letter indicates the plant of manufacture.
- (4) The four or five digit number series indicates the serial number of the mast.
- (5) Lift Height in millimetres stamped just below the serial number

Mast Group Identification consists of mast unit code (1) & (2) plus lift height (5).

For pending serial numbers contact your local dealer for Hyster lift trucks.

LIFT EQUIPMENT IDENTIFICATION

1. Fork part number, capacity rating, plant code letter and date of manufacture are stamped approximately six inches below the top of most forks.
2. The carriage group number is stamped on the right hand side of the top crossmember (pin type) or on the back of the right hand end of the bottom crossmember (hook type). A date code has two letters in line with or below the carriage group number.
3. The mast identification number has a model code, a letter indicating the plant of manufacture, and a serial number. Underneath the serial number is a four digit number that indicates the total lift height for the mast in millimetres.
4. Tilt and lift cylinder group numbers are stamped on the cylinder shell.

Always refer to the group, serial or part number when ordering service parts.

Modification of masts and carriages by SPED (Special Products Engineering Department) are identified by a model prefix code beginning with the letter "S". Contact your dealer for Hyster lift trucks for information on these assemblies.

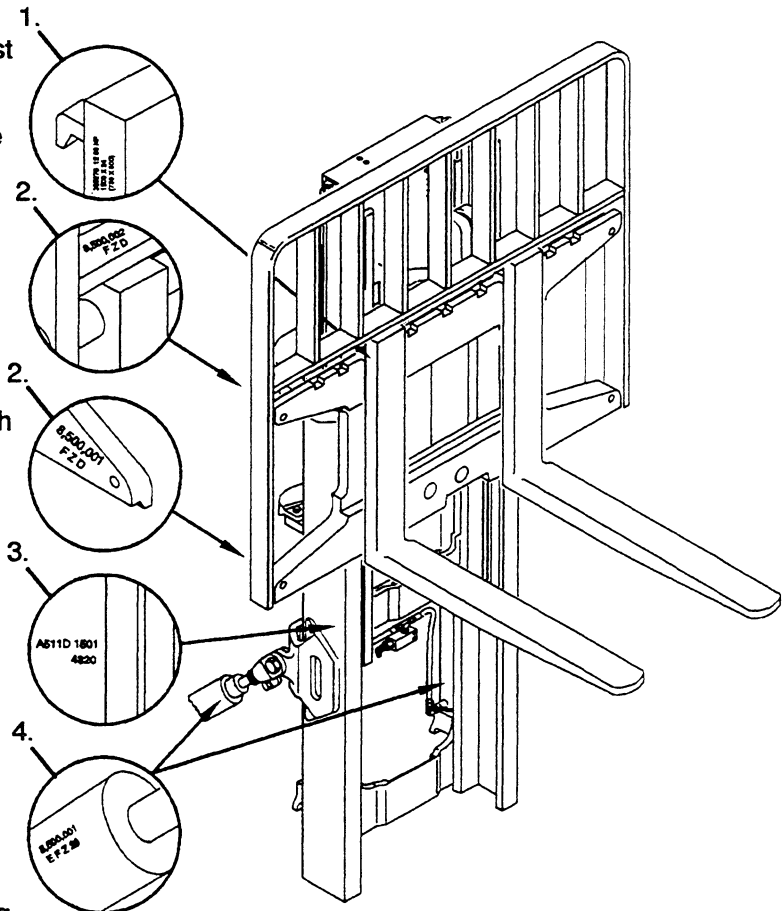

IDENTIFICATION OF ATTACHMENT AND SIDE-SHIFT CARRIAGE SERIAL NUMBERS

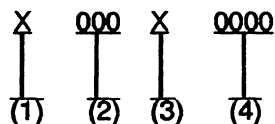

- (1) & (2) The first letter and three numbers indicate the attachment model code.
- (3) The second letter indicates the plant of manufacture.
- (4) The four or five digit number series indicates the serial number.

For pending serial numbers contact your local dealer for Hyster lift trucks.

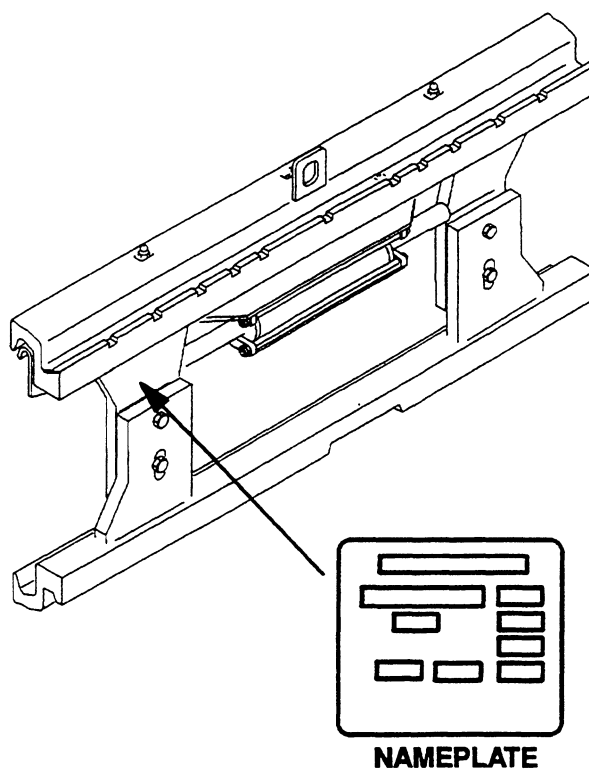

Side-Shift Carriages and Attachments have nameplates. Use the serial number found on the nameplate to identify the attachment.

Always refer to the group, serial or part number when ordering service parts.

Modifications of attachments and side-shift carriages by SPED (Special Products Engineering Department) are identified by a model prefix code beginning with the letter "S". Contact your dealer for Hyster lift trucks for information on these assemblies.

**MAINTENANCE PARTS QUICK REFERENCE LIST
 (Figure 1)**

H36.00-48.00C (H800C-1050CH)

DESCRIPTION	PART NUMBER
Periodic Maintenance	
Engine Oil Filter Cartridge	1313454
Air Filter Element	1312208
Primary Fuel Filter Kit	1315323
Main Fuel Filter Cartridge	1313488
Hydraulic Oil Filter Element	256226
Transmission Oil Filter Element Kit	288913
Accessories	
Door Key	1360777
Cooling	
Thermostat	1314987
Thermostat Gasket	1353850
Antifreeze 25L (26.4 gal.)	3061325
Antifreeze 3.8L (1 gal.)	3002338
Belts	
Alternator Belt	156320
Fan Belt	79853
Electrical System	
Ignition Key	1337197
Fuse, 5 Amp	370646
Fuse, 10 Amp	370647
Fuse, 15 Amp	1310630
Fuse, 20 Amp	370648
Lubricants And Paint	
Chain And Cable Lubricant	171350
Packing Lubricant	186061
Yellow Paint (16 oz. aerosol)	317225

When ordering: Always provide the serial numbers of all lift trucks involved.

Please Click Here To Download The Complete Manual
Download Other Manuals
If Having Any Questions Feel Free To Contact us

admin@servicemanualbit.com