

Parts Manual



See "General Information"
for New Parts Manual
Features.

320D & 320D L Excavators

FAL1-Up (Machine)
KGF1-Up (Machine)
GDC1-Up (Engine)

Powered By C6.4 Engine

Product and Dealer Information

Note: For product identification plate locations, see the section "Product Identification Information" in the Operation and Maintenance Manual.

Delivery Date: _____

Product Information

Model: _____

Product Identification Number: _____

Engine Serial Number: _____

Transmission Serial Number: _____

Generator Serial Number: _____

Attachment Serial Numbers: _____

Attachment Information: _____

Customer Equipment Number: _____

Dealer Equipment Number: _____

Dealer Information

Name: _____ Branch: _____

Address: _____

Dealer Contact

Phone Number

Hours

Sales: _____

Parts: _____

Service: _____

MEMORANDA

TABLE OF CONTENTS

Name	Page	Name	Page
GENERAL INFORMATION	A6	PULLEY GP-FAN	123
REPAIR ALTERNATIVES	A9	PULLEY GP-IDLER	127
SUPPLEMENTAL COOLANT ADDITIVES	A10	VALVE MECHANISM GP	130
MAINTENANCE PARTS	A11	LUBRICATION SYSTEM	134
INDEX	A17	ADAPTER GP-REMOTE OIL FILTER	134
MACHINE ARRANGEMENT	1	BREATHER GP	136
CHASSIS AR	1	FILTER & MTG GP-ENGINE OIL	137
CONVERSION AR-MACHINE	2	KIT-HIGH SPEED OIL CHANGE	139
DISTRIBUTION AR	4	LINES GP-ENGINE OIL	143
GENERAL AR	28	LINES GP-ENGINE OIL DRAIN	144
MACHINE AR	29	LINES GP-TURBOCHARGER OIL	146
OPTION AR-CAB	30	COOLING SYSTEM	147
OPTION AR-COLD WEATHER	32	COOLER GP-ENGINE OIL	147
OPTION AR-COUPLER	34	COOLING AR-HIGH AMBIENT TEMP	148
OPTION AR-ELECTRICAL	35	FAN GP-SUCTION	151
OPTION AR-GUARD	35	HOUSING & REGULATOR GP	158
OPTION AR-HYDRAULIC	36	PUMP GP-WATER	159
OPTION AR-CONTROL	36	RADIATOR & HYD OIL COOLER GP	161
OPTION AR-HYDRAULIC	37	AIR INLET AND EXHAUST SYSTEM	202
OPTION AR-VALVE	38	AIR CLEANER & MOUNTING GP	202
OPTION AR-LIGHTING	39	AIR CLEANER AR	204
OPTION AR-LINKAGE	40	AIR CLEANER GP	205
OPTION AR-REGIONAL	42	CARTRIDGE AS-TURBOCHARGER	214
OPTION AR-CONFIGURATION	43	EXTENSION GP-EXHAUST	215
OPTION AR-REGIONAL	43	LINES GP-AIR	216
SPECIAL AR	46	LINES GP-MUFFLER DRAIN	220
ENGINE ARRANGEMENT	50	MANIFOLD GP-EXHAUST	221
ENGINE AR	50	MANIFOLD GP-INLET	223
ENGINE AR-COMPLETE	60	MUFFLER GP	227
INSTALLATION AR-ENGINE	78	TURBOCHARGER GP	233
BASIC ENGINE	79	FUEL SYSTEM	236
CAMSHAFT GP	79	CAP GP-FUEL FILLER	236
COVER GP-VALVE MECHANISM	81	FILTER GP-FUEL	237
CRANKSHAFT GP	83	FILTER GP-WATER SEP & FUEL	242
CYLINDER BLOCK GP	84	INJECTOR GP-FUEL	243
CYLINDER HEAD AS	88	LINES GP-FUEL	247
CYLINDER HEAD GP	89	MOUNTING GP-FUEL FILTER	257
FLYWHEEL GP	90	MOUNTING GP-PUMP	262
GEAR GP-FRONT	91	PUMP & MOTOR GP-REFUELING	263
HOUSING GP-FLYWHEEL	92	PUMP AR-FUEL TRANSFER	264
HOUSING GP-FRONT	93	PUMP GP-FUEL	265
MOUNTING GP-ALTERNATOR	96	PUMP GP-REFUELING	266
MOUNTING GP-ENGINE	97	STRAINER GP-FUEL	270
MOUNTING GP-FAN DRIVE	98	TANK & MTG GP-FUEL	271
MOUNTING GP-STARTING MOTOR	99	TANK GP-FUEL	275
PAN GP-OIL	100	VALVE GP-FUEL SHUTOFF	303
PISTON & ROD GP	104	ELECTRICAL AND STARTING SYSTEM	304
PULLEY GP-ENGINE	106	ALARM GP	304
		ALARM GP-TRAVEL	305
		ALTERNATOR GP-CHARGING	306

TABLE OF CONTENTS

Name	Page	Name	Page
BATTERY & WIRING GP	308	WIRING GP-CHASSIS	455
BLOCK GP-JUNCTION	333	WIRING GP-COMBINED FLOW	457
CAMERA & MOUNTING GP	334	WIRING GP-COMMUNICATION	460
CAMERA AR	337	WIRING GP-CONSOLE	470
CAMERA GP	338	WIRING GP-CONVERTER	474
CONTROL & MTG GP-COMMUNICATION	339	WIRING GP-ELECTRONIC CONTROL	478
CONTROL & MTG GP-ENGINE ELEK	343	WIRING GP-ENGINE	480
CONTROL & MTG GP-MACHINE	344	WIRING GP-FAN	482
CONTROL GP-UNPROGRAMMED	345	WIRING GP-FINE SWING	488
ELECTRONICS GP- COMMUNICATION	346	WIRING GP-GRADE CONTROL	489
ELECTRONICS GP-MACHINE	346	WIRING GP-HEATER	491
ELECTRONICS GP-MONITOR	347	WIRING GP-HYDRAULIC CONTROL	494
FASTENER GP-WIRING HARNESS	348	WIRING GP-MEDIUM PRESSURE	496
GRADE CONTROL AR	355	WIRING GP-OVERLOAD WARNING	497
GRADE CONTROL AR-LASER	355	WIRING GP-PLATFORM	499
GRADE CONTROL AR-SATELLITE	356	WIRING GP-QUICK COUPLER	501
GRADE CONTROL GP-LASER	357	WIRING GP-RADIO	505
INSTALLATION AR-COMMUNICATION	357	WIRING GP-REFUELING PUMP	507
INSTALLATION GP-COMMUNICATION	359	POWER TRAIN	511
INSTALLATION GP-SECURITY	360	DRIVE GP-FINAL	511
KIT-BRACKET	362	FINAL DRIVE GP	513
LAMP GP-FLOOD	363	DRIVE GP-FINAL	515
LIGHTING GP-CHASSIS	366	GEAR GP-RING	518
LIGHTING GP-FLOOD	367	GEAR GP-TRANSFER	521
MAST GP	381	POWER TRAIN AR	521
MOUNTING GP-MAST	382	SPROCKET GP	522
MOUNTING GP-RECEIVER	383	FRAME AND BODY	523
MOUNTING GP-SENSOR	384	BOX & MTG GP-STORAGE	523
MOUNTING GP-WIRING	385	BOX GP-STORAGE	524
PANEL & MTG GP-CIRCUIT BREAKER	386	BUMPER GP	526
PANEL GP-CIRCUIT BREAKER	389	COUNTERWEIGHT & MOUNTING GP	527
PANEL GP-SWITCH	397	COUNTERWEIGHT AR	539
RECEIVER GP-SATELLITE	405	COUNTERWEIGHT GP	540
SENSOR & MOUNTING GP	405	COVER AS-ACCESS	553
SENSOR GP-ENGINE	407	COVER AS-SOUND SUPPRESSION	557
SENSOR GP-LIQUID LEVEL	408	COVER GP-HOOD	558
STARTING AR-COLD WEATHER	410	DOOR GP-ACCESS	559
STARTING MOTOR GP-ELECTRIC	411	FENDER & COVER GP	566
SWITCH GP-DISCONNECT	415	FRAME GP-UPPER	568
SWITCH GP-MAGNETIC	416	GEAR & BEARING GP-SWING	570
SWITCH GP-POSITION	419	GUARD AR	573
SWITCH GP-PUSH BUTTON	420	GUARD GP-BOTTOM	574
SWITCH GP-REFUELING	422	GUARD GP-SWIVEL	577
SWITCH GP-ROTARY	423	HANDRAIL GP	579
SWITCH GP-START	425	HOOD & GUARD GP	580
SWITCH GP-TOGGLE	426	HOOD GP	631
SWITCH GP-WIPER	429	HOOD GP-ENGINE	632
TARGET GP-LASER	430	SHEET AS-SOUND SUPPRESSION	637
WARNING AR-OVERLOAD	430	STEP GP	648
WARNING GP-OVERLOAD	430	STORAGE GP-VANDALISM GUARD	650
WIRING GP-AUXILIARY CONTROL	431	SUPPORT AS-ENCLOSURE	651
WIRING GP-CAB	438		
WIRING GP-CAMERA	454		

TABLE OF CONTENTS

Name	Page	Name	Page
UNDERCARRIAGE	657	LINES GP-RETURN & FILTER	1112
FRAME AR-UNDERCARRIAGE	657	LINES GP-SENSOR	1116
FRAME AS-UNDERCARRIAGE	658	LINES GP-STICK CYLINDER	1117
GUARD GP-TRACK GUIDE	660	LINES GP-TRAVEL MOTOR	1122
GUARD GP-TRAVEL MOTOR	666	MANIFOLD GP-CONTROL	1127
IDLER GP-FRONT	668	MOTOR & MTG GP-SWING	1130
LINK AS-TRACK	672	MOTOR & MTG GP-TRAVEL	1134
ROLLER AR-TRACK & CARRIER	674	MOTOR GP-PISTON	1135
ROLLER GP-TRACK CARRIER	678	MOTOR GP-SWING	1145
ROLLER GP-TRACK-DOUBLE		MOTOR GP-TRAVEL	1151
FLANGE	679	MOUNTING GP-MAIN CONTROL	
ROLLER GP-TRACK-SINGLE FLANGE	680	VALVE	1154
TRACK ADJUSTER & RECOIL GP	681	PLUG GP-CONTROL VALVE	1155
TRACK AR	685	PUMP & MTG GP-AUXILIARY	1157
TRACK GP	686	PUMP & MTG GP-MAIN HYDRAULIC	1159
HYDRAULIC SYSTEM	691	PUMP GP-GEAR	1160
ACCUMULATOR GP-HYDRAULIC	691	PUMP GP-MAIN HYDRAULIC	1162
BASE GP-OIL FILTER	698	SCREEN GP-HYDRAULIC	1167
CONTROL AR-AUXILIARY	699	SWIVEL GP	1168
CONTROL AR-COUPLER	705	TANK & FILTER GP-HYDRAULIC	1170
COUPLING GP-FLEXIBLE	706	TANK & MTG GP-HYDRAULIC	1172
COUPLING GP-PUMP	707	VALVE & LINES GP-HEAVY LIFT	1173
CYLINDER & LINES GP-BOOM	708	VALVE & MTG GP-CONTROL	1174
CYLINDER & LINES GP-BUCKET	709	VALVE AR-ALT PATTERN CONTROL	1176
CYLINDER & LINES GP-STICK	711	VALVE AR-CHECK & RELIEF	1176
CYLINDER & SEAL GP-BOOM	714	VALVE AR-LOAD CONTROL	1177
CYLINDER & SEAL GP-BUCKET	720	VALVE AR-SWING	1177
CYLINDER & SEAL GP-STICK	734	VALVE AS-MANUAL	1178
CYLINDER AR-HYDRAULIC	751	VALVE GP-CHECK	1179
CYLINDER GP-BUCKET	752	VALVE GP-CONTROL	1186
CYLINDER GP-COUPLER	756	VALVE GP-FLOW CONTROL & RELIEF	1229
CYLINDER GP-HYDRAULIC	757	VALVE GP-LOAD CONTROL	1231
DRIVE GP-AUXILIARY PUMP	759	VALVE GP-MAIN CONTROL	1240
DRIVE GP-PUMP	761	VALVE GP-MANUAL	1242
DRIVE GP-SWING	762	VALVE GP-PILOT	1243
FASTENER GP-SWING & FINAL DR	767	VALVE GP-PILOT RELIEF	1264
FILTER & VALVE GP-PILOT	769	VALVE GP-PRESSURE REDUCING	1266
FILTER AR-HYDRAULIC	770	VALVE GP-PRIORITY	1269
FILTER GP-OIL	771	VALVE GP-RELIEF	1271
FITTING GP-HYDRAULIC	777	VALVE GP-SELECTOR	1293
GAUGE GP-SIGHT	779	VALVE GP-SHUTTLE	1295
HEAD GP-PUMP	780	VALVE GP-SOLENOID	1303
HOSE GP-HYDRAULIC	803	VALVE GP-SOLENOID & MANIFOLD	1313
HYDRAULIC AR	812	VALVE GP-SOLENOID & RELIEF	1315
LINES GP-AUXILIARY HYDRAULIC	813	VALVE GP-SWING CUSHION	1323
LINES GP-BOOM	838	VALVE GP-TRAVEL	
LINES GP-BOOM CYLINDER	851	COUNTERBALANCE	1328
LINES GP-BUCKET CYLINDER	862	IMPLEMENTS	1329
LINES GP-COUPLER	874	BOOM AR	1329
LINES GP-FRONT	888	BOOM AR-1 PIECE LONG	1329
LINES GP-HYDRAULIC OIL COOLER	971	BOOM AR-1 PIECE SHORT	1331
LINES GP-PILOT	978	BOOM GP	1332
LINES GP-PUMP	1095	CONVERSION GP-LINKAGE	1342
LINES GP-RETURN	1103	LINES GP-GREASE	1343

TABLE OF CONTENTS

Name	Page	Name	Page
LINKAGE AR-BUCKET	1351	BRACKET GP-MIRROR	1485
LINKAGE AR-FRONT	1353	BRACKET GP-MOUNTING	1487
LINKAGE GP-BUCKET	1354	CAB GP	1488
LOCK GP-TRANSPORT	1362	COIL GP-EVAPORATOR	1535
PIN GP	1363	COMPRESSOR GP-REFRIGERANT	1539
STICK AR	1364	CONDENSER & LINES GP-RFGT	1544
STICK AR-HOE	1364	CONDENSER & MTG GP- REFRIGERANT	1545
STICK GP-HOE	1368	CONDENSER GP-REFRIGERANT	1550
WORK TOOLS	1387	CONSOLE GP-OPERATOR	1551
ADJUSTER GP-BUCKET	1387	CONTROL & MTG GP-JOYSTICK	1561
BUCKET & ADJUSTER GP	1389	CONTROL & MTG GP-PEDAL	1569
BUCKET AR-EXCAVATION	1398	CONTROL GP-FOOT	1571
BUCKET AR-EXTREME EXCAVATION	1401	CONTROL GP-HANDLE	1574
BUCKET AR-GENERAL PURPOSE	1403	CONTROL GP-HEAT & AIR COND	1582
BUCKET AR-HEAVY DUTY	1403	CONTROL GP-HYDRAULIC PEDAL	1583
BUCKET AR-HEAVY DUTY ROCK	1404	CONTROL GP-JOYSTICK	1587
BUCKET AS-DITCH CLEANING	1405	CONTROL GP-PEDAL	1601
BUCKET AS-EXCAVATION	1407	CONTROL GP-PILOT OPERATED HYD	1603
BUCKET AS-GENERAL PURPOSE	1409	COVER GP-CAB	1604
BUCKET AS-HEAVY DUTY	1412	COVER GP-STORAGE	1605
BUCKET AS-HEAVY DUTY ROCK	1419	DISPLAY GP-MONITOR	1606
BUCKET GP-DITCH CLEANING	1420	DOOR & MTG GP-CAB	1607
BUCKET GP-EXCAVATION	1421	DOOR GP-CAB	1611
BUCKET GP-EXTREME EXCAVATION	1423	DUCT GP-CAB AIR	1623
BUCKET GP-GENERAL PURPOSE	1425	FLOOR MAT	1624
BUCKET GP-HEAVY DUTY	1426	FLOOR MAT GP	1631
BUCKET GP-HEAVY DUTY ROCK	1428	GUARD AR-OVERHEAD	1632
COUPLER AR-QUICK	1428	GUARD AR-VANDALISM	1632
COUPLER GP-QUICK	1431	GUARD GP-FRONT WINDOW	1633
EDGE GP-CUTTING	1436	GUARD GP-OVERHEAD	1640
PIN GP-BUCKET	1437	GUARD GP-VANDALISM	1642
PIN GP-COUPLER	1437	HATCH GP-ROOF	1644
PROTECTOR GP-SIDE BAR	1438	HEADREST AS-SEAT	1647
SIDECUTTER GP	1440	HEATER & MTG GP-CAB	1650
TIP GP-ABRASION	1443	HEATER AR-CAB	1656
TIP GP-DOUBLE SPIKE	1444	HORN GP-ELECTRIC	1657
TIP GP-EXTRA-DUTY	1445	INSTALLATION AR	1659
TIP GP-GENERAL PURPOSE	1447	INSTALLATION GP-RADIO	1660
TIP GP-LONG	1448	KIT-CONSOLE ADJUSTMENT	1662
TIP GP-PENETRATION	1451	KIT-SEAT	1663
TIP GP-PENETRATION PLUS	1454	KIT-SEAT SUPPORT	1665
TIP GP-SHARP	1457	KIT-SEAT SUSPENSION	1667
TIP GP-SHORT	1458	KIT-SEAT TILT	1668
TIP GP-SPIKE	1459	LATCH GP-FRONT WINDOW	1669
TIP GP-WIDE	1460	LEVER GP-CAB DOOR	1670
TIP-LEVELING EDGE	1462	LINES GP-AIR CONDITIONER	1671
OPERATOR STATION	1463	LINES GP-HEATER	1678
ACCESSORY GP-CAB	1463	LITERATURE GP	1683
ADJUSTER GP-SEAT	1466	MIRROR GP-DOWN VIEW	1684
AIR CONDITIONER & MOUNTING GP	1468	MIRROR GP-REAR VIEW	1685
AIR CONDITIONER AR	1474	MONITOR & MTG GP-OPERATOR	1690
AIR CONDITIONER GP	1475	MONITOR GP-OPERATOR	1691
ARMREST GP	1483	MOUNTING GP-ANTENNA	1693

TABLE OF CONTENTS

Name	Page	Name	Page
MOUNTING GP-MONITOR	1699		
MOUNTING GP-PLATFORM	1700		
OPERATOR AR	1702		
PEDAL AR-AUXILIARY	1702		
PLATFORM GP-OPERATOR	1704		
RADIO GP	1705		
RADIO GP-COMMUNICATION	1706		
SCREEN GP-SUN	1707		
SEAT & MOUNTING GP	1708		
SEAT BELT GP	1725		
SEAT GP	1731		
SEAT GP-SUSPENSION	1740		
SUPPORT GP-SEAT	1752		
SUSPENSION GP-SEAT	1754		
VISOR GP-CAB	1765		
VISOR GP-PROTECTION	1766		
WASHER GP-WINDOW	1767		
WINDOW AS-FRONT	1770		
WINDOW GP-CAB	1771		
WINDOW GP-DOOR	1779		
WINDOW GP-FRONT	1781		
WIPER & WASHER GP-WINDOW	1783		
WIPER AR-WINDOW	1785		
WIPER GP-WINDOW	1786		
SERVICE EQUIPMENT AND SUPPLIES	1788		
CASE GP-CARRYING	1788		
FILM GP	1789		
PLATE & FILM GP	1813		
PART NUMBER INDEX	B1		

GENERAL INFORMATION

1. MACHINE IDENTIFICATION

Caterpillar machines are identified by Product Identification Numbers (PIN). Some components included in a machine may be identified by Serial Numbers (S/N). Typical components that will be serialized include engines, transmissions, bulldozers, and rippers. The machine and engine are further identified by arrangement numbers and in some cases modification numbers. These numbers are shown on the product identification plate(s) and on the master plate in the operator's compartment.

Caterpillar dealers need all of these numbers to determine accurate parts identification.

New Feature

Effective First Quarter 2001 the Caterpillar Product Identification Number (PIN) changed from 8 to 17 characters. In an effort to provide uniform equipment identification, Caterpillar and other construction equipment manufacturers are moving to comply with the latest version of the product identification numbering standard. Non-road machine PINs are defined by ISO 10261. The new PIN format will apply to all Caterpillar machines and generator sets. The PIN plates and frame marking will display the 17 character PIN. The new format will look like the following:

CAT0789BG 6SL12345

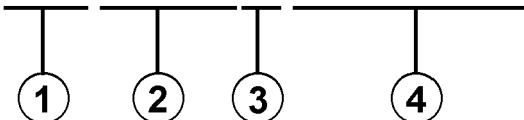

The diagram shows the PIN format: *CAT0789BG 6SL12345*. Below the first four characters (C, A, T, 0), there are four vertical lines leading to circles containing the numbers 1, 2, 3, and 4 respectively.

Where:

1. Caterpillar's World Manufacturing Code (characters 1-3)
2. Machine Descriptor (characters 4-8)
3. Check Character (character 9)
4. Machine Indicator Section (MIS) or Product Sequence Number (characters 10-17). These were previously referred to as the Serial Number.

Machines and generator sets produced before First Quarter 2001 will maintain their 8 character PIN format.

Components such as engines, transmissions, axles, etc. and work tools will continue to use an 8 character Serial Number (S/N).

2. ORDERING PARTS

WARNING

When replacement parts are required for this product Caterpillar recommends using Caterpillar replacement parts or parts with equivalent specifications including, but not limited to, physical dimensions, type, strength and material.

Failure to heed this warning can lead to premature failures, product damage, personal injury or death.

Quality Caterpillar replacement parts are available from Caterpillar dealers throughout the world. Their parts inventories are up to date and include all parts normally required to protect your investment in Caterpillar machines. Dealers may offer repair kits or remanufactured parts to allow selection of the most effective repair alternative for a particular situation. When ordering parts, your order should specify the quantity, part number, part name, and the serial number/product identification number of the machine for which the parts are needed.

3. PARTS MANUAL ORGANIZATION

Product information in this manual is presented as "information elements" that represent all of the components for the specific model. Engine Arrangement and Seat Group are examples of information elements. The information elements are organized alphabetically by part name and secondarily by part number within each major section of the manual.

4. TABLE OF CONTENTS

A table of contents (TOC) is found at the beginning of the manual. The TOC lists each section of the manual with a complete list of all information elements organized as they appear in the manual. Page numbers are provided for quick reference to detailed parts identification illustrations and serviceable consist lists.

5. MAINTENANCE PARTS INDEX

The Maintenance Parts Index, located near the beginning of the manual, references most frequently used maintenance part numbers, providing description, quantity, usage and page number. This information is organized alphabetically by part description.

GENERAL INFORMATION

6. INDEX

The index located near the front of the manual is an alphabetical listing of all information elements included in the manual. Page numbers are provided for quick reference to detailed parts identification illustrations and serviceable consist lists.

7. PART NUMBER INDEX

A numerical index listing all part numbers and the corresponding page number(s) appears at the back of the manual.

8. CAPTIONS

Captions located at the beginning of each information element identify the part number and part name along with additional descriptive information. PIN and S/N information found in each caption should be used to select correct information for a specific machine. Field replacement options, identification of optional attachment components, and where used ("part of") information is also provided.

The first line of a caption is shown in larger type font to indicate the beginning of an information element. Captions for additional pages that may be required to illustrate an information element will be shown in standard type font and will include the term (*contd.*) .

9. NON-SERVICED PARTS

In some instances it is necessary to display non-serviced parts that are a link to a lower level serviceable consist lists. These non-serviced part numbers are shown in *italic* type indicating that they are not available.

10. PARTS LIST REFERENCE NUMBERS

Numbers shown in the Ref No column correspond to numbers used in the associated graphic(s). An alphabetic suffix may be added to a reference number to identify lower level consist items. Numbers shown in the Graphic Ref column refer to the graphic number identifier displayed in the lower left corner of each illustration. The Graphic Ref number may be used in combination with the item Ref No to determine the correct part number. There may be intentional omission of a Ref No in a consist list as information is updated to reflect the latest serviceable part numbers.

11. INDENTED PART NAMES

When a part name is indented in a parts list, it is part of (included in) the group or assembly under which it is indented.

12. ILLUSTRATION REFERENCE LETTERS

When necessary, illustrations contain reference letters (A, B, C etc.) that are intended to track lines and harnesses from one point to another. They are also used to show where to reconnect illustrations that have been separated.

13. ABBREVIATIONS AND SYMBOLS

O.D. – Outside Diameter
I.D. – Inside Diameter
A – Not Part Of This Group
B – Use As Required
C – Change From Previous Type
D – Order By The Meter
E – Order By The Centimeter
F – Not Shown
G – Order By The Inch
I – Refer To Hydraulic Information System
M – Metric Part
R – Remfg Part May Be Available
Y – Separate Illustration
Z – Not Serviced Separately

 **New Feature**

14. DESCRIPTION OF TYPE CHANGES

Type - A type is defined as any configuration change that requires an additional Information Element for an Arrangement, Group, or Assembly. If serial number breaks for types are not available, a type # (Type 1, Type 2, etc.) will be displayed in the caption. These "type" changes are identified with a "C" note (change from previous type) in the Parts List. Only the "types" that apply to this Parts Manual will be included. Additional types may exist causing "C" notes to appear on an Information Element when no other types are shown.

15.<END>

This symbol indicates the end of an information element.

NOTE:

Continuing improvement and advancement of product design may cause changes to your machine which may not be included in this publication. Whenever a question arises regarding your Caterpillar product or this publication, please consult your Caterpillar dealer for the latest available information.

GENERAL INFORMATION

FRAME AND BODY					
8E-3299 PLATFORM GP-CAB					
PIN 3841-99999					
					100090751
NOTE	REF NO	GRAPHIC REF	PART NUMBER	QTY	PART NAME & PRODUCT LEVEL
	1		31-2983	1	PLATE AS
	2		8E-2986	25	BOLT (1/4-18X.750IN)
	3		8E-1078	41	WASHER-HARD (3MM THK)
	4		8E-1444	2	SUPPORT AS-FOOT
	5		77-2229	19	BOLT (1/2-13X1IN)
	6		8E-8156	1	COVER AS-LH
	7		8E-8278	6	NUT-WELD (3/8-16 THD)
	8		17-8189	1	CLIP
	9		78-2411	4	COVER
	10		84-8488	18	SCREW-HEAD (3/8-18X.875IN)
	11		77-0774	1	COVER
	12		8E-8277	1	GASKET
	13		8E-2980	1	GASKET
	14		31-3493	1	HANDHOLD
	15		8E-8278	1	COVER AS
	16		8E-8278	8	NUT-WELD (3/8-16 THD)
	17		8E-8278	1	GASKET
	18		77-0131	1	FLOORPLATE AS
	19		17-0750	4	NUT-WELD (1/2-13 THD)
	20		77-8087	1	PLUG-BUTTON
	21		77-0136	1	PLATE AS
	22		8E-8278	5	NUT-WELD (3/8-16 THD)
	23		77-8089	1	COVER
	24		77-0770	1	GASKET
	25		31-2981	1	PLATE AS
	26		81-8484	4	BOLT (1/4-20X.825IN)
	27		81-8486	4	WASHER-HARD (2MM THK)
	28		81-8484	1	FLOOR MAT
	29		8E-8446	1	MODULE AS-OPERATOR
	30		31-3534	1	HANDHOLD
	31		8E-8271	2	PLUG
	32		81-8384	4	BOLT (1/4-20X.825IN)
	33		8E-8282	17	WASHER-HARD (2MM THK)
	34		8E-1078	21	WASHER-HARD (3MM THK)
	35		77-0136	1	SEAL
	36		78-0378	2	BOLT (3/4-10X5IN)
	37		78-0892	2	WASHER-HARD (5MM THK)
	38		31-3482	2	PLATE
	39		31-3390	1	PLATE AS
	40		78-0888	8	SPACER
	41		31-3381	1	SEAL
	42		78-8817	1	GASKET
	43		78-8816	1	COVER AS
	44		8E-8278	2	WASHER
	45		8E-8228	2	SCREW-KNURLED
	46		8E-3428	1	COVER
	47		8E-8887	1	COVER
	48		8E-2051	8	SCREW-ROCKET HEAD
	49		8E-3142	8	MOUNTING
	50		8E-0027	2	PLATE
	51		78-0380	2	BOLT (1/2-8X5IN)
	52		78-0872	2	WASHER-HARD
	53		4L-8484	4	BOLT (3/8-18X1.02IN)
	54		31-6783	1	COVER

12 FRAME AND BODY 1 of 4 SELP 170-01

FRAME AND BODY					
8E-3299 PLATFORM GP-CAB (contd.)					
					100090751
NOTE	REF NO	GRAPHIC REF	PART NUMBER	QTY	PART NAME & PRODUCT LEVEL
	41		8E-8816	1	COVER
	42		77-8124	1	PLATE
	43		77-8128	1	GASKET
	44		78-8724	1	GASKET
	45		78-8723	1	COVER
	46		8E-1069	2	PLUG-BUTTON

M-METRIC PART

SELPA470-01 2 of 4 FRAME AND BODY 13

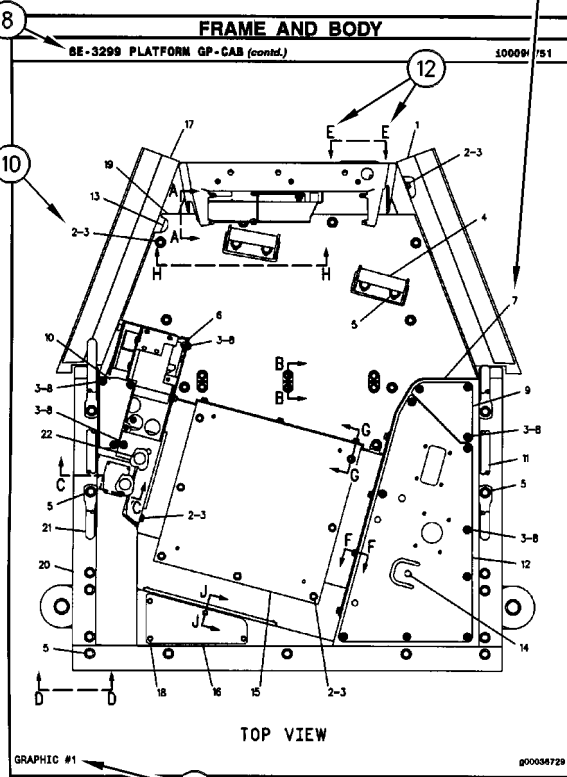

14 FRAME AND BODY 3 of 4 SELPA470-01

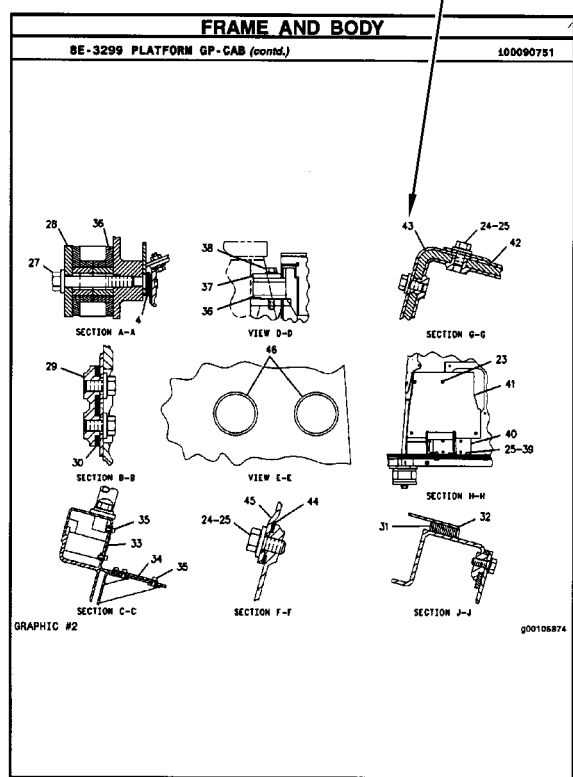

SELPA470-01 4 of 4 FRAME AND BODY 15

REPAIR ALTERNATIVES

REMANUFACTURED COMPONENTS

As an option when making repairs consider Caterpillar Remanufactured Components. Components that are available through the Caterpillar Remanufactured Program are identified three ways in the parts book:

- with the letter R in the note field of the parts list
- with an R* at the beginning of the first line of the caption
- with an *R at the end of the first line of the caption

Typical components included in the Remanufacturing Program include:

ALTERNATORS
CONNECTING RODS
CRANKSHAFTS - UNDERSIZE
CRANKSHAFTS - UPGRADE TO NEW
CYLINDER HEADS
ELECTRONIC CONTROL MODULES (ECM)
ELECTRONIC SENSORS
FUEL INJECTORS
FUEL NOZZLES
FUEL PUMPS
GOVERNORS
OIL PUMPS
PISTONS
SHORT BLOCKS
STARTERS
TURBOCHARGERS - COMPLETE
TURBOCHARGER CARTRIDGES
WATER PUMPS

Caterpillar Remanufactured engines for many engine arrangements are also available.

SUPPLEMENTAL COOLANT ADDITIVES

CUSTOMER BENEFITS:

Protects against cavitation, foam, erosion, corrosion, and scale buildup in cooling systems.

- Provides measured coolant conditioner.

DESCRIPTION:

Additives deplete from the coolant with normal operation. For this reason, Supplemental Coolant Additives (SCA) must be added to all heavy duty coolants at regular intervals. In addition, when not using a fully formulated, pre-charged antifreeze, like Caterpillar's DEAC, an initial charge of SCA must be added to the cooling system. The amount of SCA added to the system is dependent on the capacity of the system.

The SCA for initial fill is provided as a liquid. SCA's for maintenance intervals are available in liquid form and as a spin-on element. (No Spin-on available for 3600 Family of Engines)

NOTE:

The amount of SCA added at initial fill is not the same as the amount added at maintenance intervals.

The coolant additive elements can be used with any ethylene or propylene glycol type antifreeze which meets ASTM D4985 or ASTM D5345 Specifications.

NOTE:

For use with standard heavy duty coolant only, not for use with Extended Life Coolant.

PARTS NEEDED:

Cooling System Capacity		Liquid SCA at Initial Fill	Liquid SCA at Maintenance*	Spin-on SCA Maintenance Element*
Liters	Gallons			
22-30	(6-8)	3P-2044 (1)	6V-3542 (1)	111-2370 (1)
30-38	(8-10)	3P-2044 (1) 6V-3542 (1)	111-2372 (1)	111-2369 (1)
38-49	(10-13)	3P-2044 (1) 8T-1589 (1)	111-2372 (1)	111-2369 (1)
49-64	(13-17)	3P-2044 (2)	8T-1589 (1)	9N-3368 (1)
64-83	(17-22)	3P-2044 (2) 8T-1589 (1)	111-2372 (1) 6V-3542 (1)	111-2371 (1)
83-114	(22-30)	3P-2044 (3) 8T-1589 (1)	3P-2044 (1)	9N-3718 (1)
114-163	(30-43)	3P-2044 (5)	3P-2044 (1) 6V-3542 (1)	111-2371 (2)
163-242	(43-64)	3P-2044 (8)	3P-2044 (2)	9N-3718 (2)

* Normal maintenance period is 250 hrs. See your Operation and Maintenance Manual for complete coolant maintenance instructions.

() Indicates quantity required.

MAINTENANCE PARTS

DESCRIPTION	PART NUMBER	QTY	WHERE USED	PAGE
AIR INLET AND EXHAUST SYSTEM				
FILTER ELEMENT AS-AIR (PRIMARY)	131 - 8822	1	AIR CLEANER GP	205
		1	AIR CLEANER GP	212
FILTER ELEMENT AS-AIR (PRIMARY, STANDARD EFFICIENCY)	6I - 2501	1	AIR CLEANER GP	206
		1	AIR CLEANER GP	213
FILTER ELEMENT AS-AIR (PRIMARY, ULTRA HIGH EFFICIENCY)	128 - 2686	1	AIR CLEANER GP	213
FILTER ELEMENT AS-AIR (SECONDARY)	131 - 8821	1	AIR CLEANER GP	205
		1	AIR CLEANER GP	212
	6I - 2502	1	AIR CLEANER GP	206
		1	AIR CLEANER GP	213
FILTER ELEMENT AS-AIR (ULTRA HIGH EFFICIENCY) (PRIMARY)	134 - 0685	1	AIR CLEANER GP	212
BASIC ENGINE				
BELT-SERPENTINE	212 - 8585	1	PULLEY GP-ENGINE	106
		1	PULLEY GP-ENGINE	115
		1	PULLEY GP-ENGINE	117
	294 - 1781	1	PULLEY GP-ENGINE	109
		1	PULLEY GP-ENGINE	121
	297 - 7825	1	PULLEY GP-ENGINE	111
		1	PULLEY GP-ENGINE	113
CAP (ENGINE OIL FILLER)	294 - 1708	1	COVER GP-VALVE MECHANISM	81
GASKET (VALVE COVER)	294 - 1706	1	COVER GP-VALVE MECHANISM	81

MAINTENANCE PARTS

DESCRIPTION	PART NUMBER	QTY	WHERE USED	PAGE
COOLING SYSTEM				
CAP AS (COOLANT RECOVERY)	171 - 3369	1	RADIATOR & HYD OIL COOLER GP	161
		1	RADIATOR & HYD OIL COOLER GP	163
		1	RADIATOR & HYD OIL COOLER GP	165
		1	RADIATOR & HYD OIL COOLER GP	167
		1	RADIATOR & HYD OIL COOLER GP	169
		1	RADIATOR & HYD OIL COOLER GP	173
		1	RADIATOR & HYD OIL COOLER GP	176
		1	RADIATOR & HYD OIL COOLER GP	178
CAP AS-PRESSURE (RADIATOR)	245 - 9212	1	RADIATOR & HYD OIL COOLER GP	171
		1	RADIATOR & HYD OIL COOLER GP	180
		1	RADIATOR & HYD OIL COOLER GP	183
		1	RADIATOR & HYD OIL COOLER GP	185
		1	RADIATOR & HYD OIL COOLER GP	190
		1	RADIATOR & HYD OIL COOLER GP	192
		1	RADIATOR & HYD OIL COOLER GP	195
		1	RADIATOR & HYD OIL COOLER GP	198
CAP-RADIATOR	341 - 2143	1	RADIATOR & HYD OIL COOLER GP	200
GASKET (WATER TEMPERATURE REGULATOR)	294 - 1780	1	HOUSING & REGULATOR GP	158
	5I - 7735	1	HOUSING & REGULATOR GP	158
HOSE-RADIATOR (LOWER)	245 - 9178	1	RADIATOR & HYD OIL COOLER GP	161
		1	RADIATOR & HYD OIL COOLER GP	163
		1	RADIATOR & HYD OIL COOLER GP	165
		1	RADIATOR & HYD OIL COOLER GP	167
		1	RADIATOR & HYD OIL COOLER GP	169
		1	RADIATOR & HYD OIL COOLER GP	173
		1	RADIATOR & HYD OIL COOLER GP	176
		1	RADIATOR & HYD OIL COOLER GP	178
HOSE-RADIATOR (UPPER)	265 - 3602	1	RADIATOR & HYD OIL COOLER GP	161
		1	RADIATOR & HYD OIL COOLER GP	163
		1	RADIATOR & HYD OIL COOLER GP	165
		1	RADIATOR & HYD OIL COOLER GP	167
		1	RADIATOR & HYD OIL COOLER GP	169
		1	RADIATOR & HYD OIL COOLER GP	173
		1	RADIATOR & HYD OIL COOLER GP	176
		1	RADIATOR & HYD OIL COOLER GP	178

MAINTENANCE PARTS

DESCRIPTION	PART NUMBER	QTY	WHERE USED	PAGE
ELECTRICAL AND STARTING SYSTEM				
BATTERY (12-VOLT, MAINTENANCE FREE)	263-9574	4	BATTERY & WIRING GP	331
BATTERY (12-VOLT, MAINTENANCE FREE, WET)	3T-5760	2	BATTERY & WIRING GP	308
		2	BATTERY & WIRING GP	310
		2	BATTERY & WIRING GP	317
		2	BATTERY & WIRING GP	324
CAP AS-FILLER (BATTERY)	123-1373	6	BATTERY & WIRING GP	324
CIRCUIT BREAKER AS (120-AMPERE) (HEATER)	216-4970	1	PANEL GP-CIRCUIT BREAKER	389
		1	PANEL GP-CIRCUIT BREAKER	391
		1	PANEL GP-CIRCUIT BREAKER	394
CIRCUIT BREAKER AS (60-AMPERE) (ALTERNATOR)	171-2208	1	PANEL GP-CIRCUIT BREAKER	389
		1	PANEL GP-CIRCUIT BREAKER	391
		1	PANEL GP-CIRCUIT BREAKER	394
CIRCUIT BREAKER AS (80-AMPERE) (MAIN)	171-2210	1	PANEL GP-CIRCUIT BREAKER	389
		1	PANEL GP-CIRCUIT BREAKER	391
		1	PANEL GP-CIRCUIT BREAKER	394
FUSE (10-AMPERE)	113-8490	20	WIRING GP-CAB	442
FUSE (15-AMPERE)	113-8491	5	WIRING GP-CAB	442
		1	WIRING GP-CAB	450
		1	WIRING GP-CAB	451
		1	WIRING GP-CAB	452
FUSE (20-AMPERE)	113-8492	3	WIRING GP-CAB	442
FUSE (25-AMPERE)	113-8493	3	WIRING GP-CAB	442
FUSE (30-AMPERE)	124-3548	2	WIRING GP-CAB	442
FUSE (5-AMPERE)	141-2759	1	PANEL GP-CIRCUIT BREAKER	394
		7	WIRING GP-CAB	442
KEY (BATTERY DISCONNECT)	8H-5306	1	SWITCH GP-DISCONNECT	415
LAMP AS (24-VOLT, 3-WATT)	170-9324	1	PANEL GP-SWITCH	397
		1	PANEL GP-SWITCH	399
LAMP-HALOGEN (24-VOLT, 70-WATT)	9X-3463	1	LAMP GP-FLOOD	363
		1	LAMP GP-FLOOD	364
		1	LAMP GP-FLOOD	365
		1	LIGHTING GP-FLOOD	369
		1	LIGHTING GP-FLOOD	372
ENGINE ARRANGEMENT				
FILTER AS-ENGINE OIL (STANDARD EFFICIENCY)	1R-0739	1	ENGINE AR-COMPLETE	60

MAINTENANCE PARTS

DESCRIPTION	PART NUMBER	QTY	WHERE USED	PAGE
FUEL SYSTEM				
CAP GP-FUEL FILLER (EXTREME SERVICE, LOCKABLE)	164-4858	1	TANK GP-FUEL	276
		1	TANK GP-FUEL	277
		1	TANK GP-FUEL	279
		1	TANK GP-FUEL	280
		1	TANK GP-FUEL	283
		1	TANK GP-FUEL	285
		1	TANK GP-FUEL	287
		1	TANK GP-FUEL	289
		1	TANK GP-FUEL	292
		1	TANK GP-FUEL	294
		1	TANK GP-FUEL	297
		1	TANK GP-FUEL	299
		1	TANK GP-FUEL	301
COVER AS-FILTER	190-9775	1	CAP GP-FUEL FILLER	236
FILTER AS-WATER SEP & FUEL	326-1643	1	LINES GP-FUEL	251
		1	LINES GP-FUEL	254
FILTER AS-WATER SEP & FUEL (PRIMARY)	326-1644	1	FILTER GP-WATER SEP & FUEL	242
FILTER-FUEL (ADVANCED EFFICIENCY)	1R-0751	3	FILTER GP-FUEL	240
FILTER-FUEL (ADVANCED EFFICIENCY) (FUEL)	1R-0751	2	FILTER GP-FUEL	237
GASKET (FUEL PRIMING PUMP)	294-1820	1	FILTER GP-FUEL	237
	9Y-8389	2	LINES GP-FUEL	251
		2	LINES GP-FUEL	254
STRAINER AS-FUEL	229-1860	1	PUMP GP-REFUELING	266
		1	PUMP GP-REFUELING	268
STRAINER AS-FUEL (FLOAT GAUGE)	303-9933	1	TANK GP-FUEL	277
		1	TANK GP-FUEL	280
		1	TANK GP-FUEL	285
		1	TANK GP-FUEL	289
		1	TANK GP-FUEL	292
		1	TANK GP-FUEL	294
		1	TANK GP-FUEL	297
		1	TANK GP-FUEL	299
		1	TANK GP-FUEL	301

MAINTENANCE PARTS

DESCRIPTION	PART NUMBER	QTY	WHERE USED	PAGE
HYDRAULIC SYSTEM				
BREATHER (HYDRAULIC TANK)	227-0590	1	TANK & FILTER GP-HYDRAULIC	1170
BREATHER (SWING DRIVE)	4H-6112	1	DRIVE GP-SWING	764
		1	DRIVE GP-SWING	765
BREATHER AS (SWING DRIVE)	227-6221	1	DRIVE GP-SWING	764
		1	DRIVE GP-SWING	765
FILTER ELEMENT AS-OIL (HYDRAULIC)	216-6676	1	FILTER GP-OIL	775
FILTER ELEMENT AS-OIL (ULTRA HIGH EFFICIENCY) (HYDRAULIC RETURN)	179-9806	1	FILTER GP-OIL	773
FILTER-OIL (ADVANCED EFFICIENCY) (HYDRAULIC, CASE DRAIN)	093-7521	1	FILTER GP-OIL	776
FILTER-OIL (ADVANCED EFFICIENCY) (HYDRAULIC, PILOT)	5I-8670	1	FILTER & VALVE GP-PILOT	769
PLUG-DRAIN (HYDRAULIC OIL)	4B-7739	1	TANK & FILTER GP-HYDRAULIC	1170
SCREEN	119-5398	1	VALVE GP-RELIEF	1289
		1	VALVE GP-RELIEF	1290
SCREEN AS (HYDRAULIC TANK)	209-6000	1	SCREEN GP-HYDRAULIC	1167
LUBRICATION SYSTEM				
BREATHER (CRANKCASE)	5I-7725	1	BREATHER GP	136
FILTER AS-ENGINE OIL (STANDARD EFFICIENCY)	1R-0739	1	FILTER & MTG GP-ENGINE OIL	137
MACHINE ARRANGEMENT				
SEAT BELT GP (RETRACTABLE, 43-MM)	305-0467	1	DISTRIBUTION AR	4
		1	DISTRIBUTION AR	5
		1	DISTRIBUTION AR	10
		1	DISTRIBUTION AR	13
		1	DISTRIBUTION AR	17
		1	DISTRIBUTION AR	18
		1	DISTRIBUTION AR	25
		1	OPTION AR-CAB	30
		1	OPTION AR-CAB	31
		1	OPTION AR-COLD WEATHER	32
		1	OPTION AR-COLD WEATHER	33
		1	OPTION AR-COLD WEATHER	34
		1	OPTION AR-REGIONAL	42
		1	OPTION AR-REGIONAL	44
		1	OPTION AR-REGIONAL	46
SEAT BELT GP (RETRACTABLE, 76-MM)	305-0466	1	OPTION AR-CAB	30
		1	OPTION AR-CAB	31

MAINTENANCE PARTS

DESCRIPTION	PART NUMBER	QTY	WHERE USED	PAGE
OPERATOR STATION				
BLADE AS-WIPER (275-MM) (LOWER)	4I - 5021	1	WIPER & WASHER GP-WINDOW	1783
BLADE AS-WIPER (600-MM) (UPPER)	161 - 3670	1	WIPER GP-WINDOW	1786
CAP AS (WINDOW WASHER)	178 - 5431	1	WASHER GP-WINDOW	1767
DRYER-REFRIGERANT (RECEIVER)	176 - 1902	1	LINES GP-AIR CONDITIONER	1671
		1	LINES GP-AIR CONDITIONER	1675
FILTER ELEMENT AS-CAB AIR	305 - 0329	1	DUCT GP-CAB AIR	1623
FILTER ELEMENT-CAB AIR	245 - 7823	1	AIR CONDITIONER GP	1475
		1	AIR CONDITIONER GP	1478
		1	AIR CONDITIONER GP	1481
	293 - 1184	1	DUCT GP-CAB AIR	1623
FILTER GP-AIR (AIR CONDITIONER)	293 - 1137	1	AIR CONDITIONER GP	1481
LAMP (24-VOLT, 10-WATT)	201 - 4417	1	ACCESSORY GP-CAB	1463
LAMP (24-VOLT, 10-WATT) (DOME)	201 - 4417	1	CAB GP	1506
		1	CAB GP	1510
SEAT BELT GP	327 - 6540	1	SEAT BELT GP	1729
	327 - 6541	1	SEAT BELT GP	1730
SEAT BELT GP (RETRACTABLE, 3-IN)	235 - 9020	1	SEAT BELT GP	1727
SEAT BELT GP (RETRACTABLE, 46-MM)	273 - 5446	1	SEAT BELT GP	1726
V-BELT	255 - 2927	1	COMPRESSOR GP-REFRIGERANT	1539
(AIR CONDITIONER COMPRESSOR)		1	COMPRESSOR GP-REFRIGERANT	1541

Please Click Here To Download The Complete Manual
Download Other Manuals
If Having Any Questions Feel Free To Contact us

admin@servicemanualbit.com