

JCB 8250 Fastrac

[Section 1 - General Information](#)

[Section 2 - Care and Safety](#)

[Section 3 - Maintenance](#)

[Section A - Optional Equipment](#)

[Section B - Body and Framework](#)

[Section C - Electrics](#)

[Section D - Controls](#)

[Section E - Hydraulics](#)

[Section F - Transmission](#)

[Section G - Brakes](#)

[Section H - Steering](#)

[Section S - Suspension](#)

[Section T - Engine](#)



Publication No.
9803/8040-6



Copyright © 2004 JCB SERVICE. All rights reserved. No part of this publication may be reproduced, stored in a retrieval system, or transmitted in any form or by any other means, electronic, mechanical, photocopying or otherwise, without prior permission from JCB SERVICE.

Issued by JCB Technical Publications, JCB Service, World Parts Centre, Beamhurst, Uttoxeter, Staffordshire, ST14 5PA, England. Tel +44 1889 590312 Fax +44 1889 593377

World Class
Customer Support

General Information

[Section 1 - General Information](#)

[Section 2 - Care and Safety](#)

[Section 3 - Maintenance](#)

[Section A - Optional Equipment](#)

[Section B - Body and Framework](#)

[Section C - Electrics](#)

[Section D - Controls](#)

[Section E - Hydraulics](#)

[Section F - Transmission](#)

[Section G - Brakes](#)

[Section H - Steering](#)

[Section S - Suspension](#)

[Section T - Engine](#)



Publication No.
9803/8040-2



Copyright © 2004 JCB SERVICE. All rights reserved. No part of this publication may be reproduced, stored in a retrieval system, or transmitted in any form or by any other means, electronic, mechanical, photocopying or otherwise, without prior permission from JCB SERVICE.

Issued by JCB Technical Publications, JCB Service, World Parts Centre, Beamhurst, Uttoxeter, Staffordshire, ST14 5PA, England. Tel +44 1889 590312 Fax +44 1889 593377

World Class
Customer Support





Section 1 - General Information

Contents	Page No.
Identifying the Machine	
Serial Numbers	1 - 1
Serial Number Plate	1 - 1
Standard Torque Settings	
Zinc Plated Fasteners and Dacromet Fasteners	1 - 3
Introduction	1 - 3
Zinc Plated Fasteners (golden finish)	1 - 4
Dacromet Fasteners (mottled silver finish)	1 - 5
Hydraulic Connections	1 - 6
'O' Ring Face Seal System	1 - 6
'Torque Stop' Hose System	1 - 9
Service Consumables	
Sealing and Retaining Compounds	1 - 10



Section 1 - General Information

Contents

Page No.

Identifying the Machine

Serial Numbers

Serial Number Plate

Each machine has a serial number plate located at **X**. The 17 digit Vehicle Identification Number (VIN), and the serial numbers of the engine and transmission are stamped on the plate.

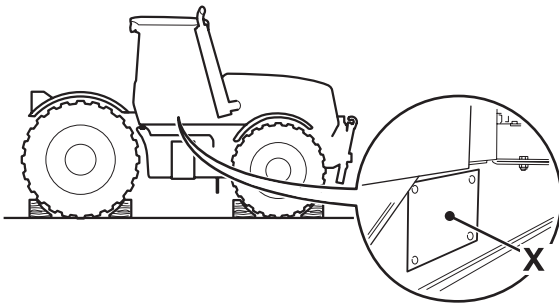

Fig 1.

Typical Vehicle Identification No. (VIN)

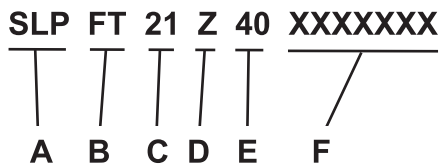

Fig 2.

- A Manufacturing code**
- B Machine range**
FT = Fastrac
- C Engine type**
- D Transmission type** (gearbox & axle combination)
- E Vehicle max. speed**
40 = 40 kph
50 = 50 kph
65 = 65 kph
- F Serial number**

Unit Identification

The serial number of each major unit is also stamped on the unit itself as shown below. If a major unit is replaced by a new one, the serial number on the plate will be wrong. Either stamp the new number of the unit on the identification plate, or simply stamp out the old number. This will prevent the wrong unit number being quoted when replacement parts are ordered.

Engine	M
Gearbox	N
Front axle	P
Rear axle	R

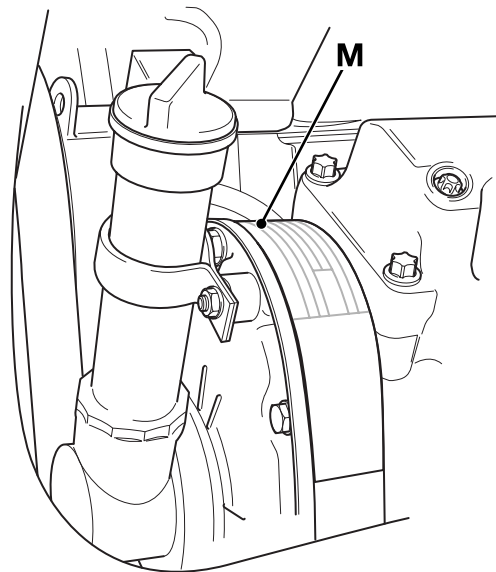

Fig 3.

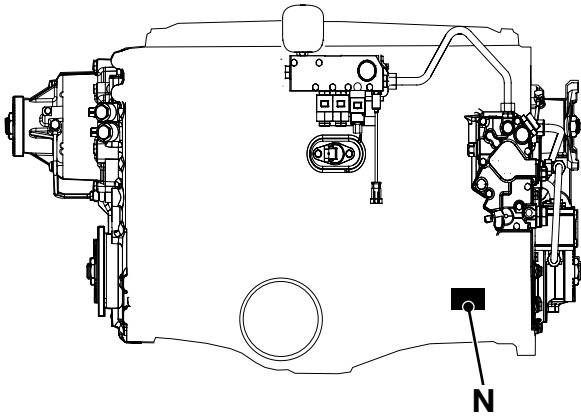

Fig 4.

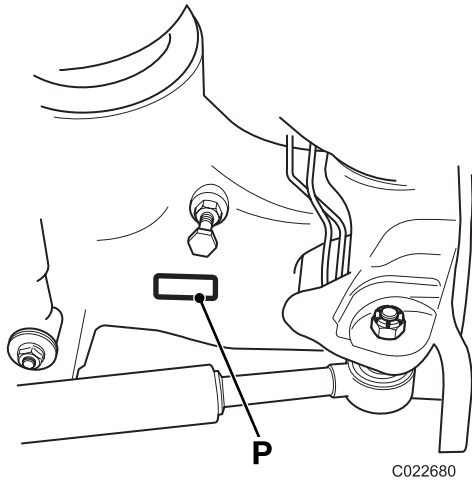

Fig 5.

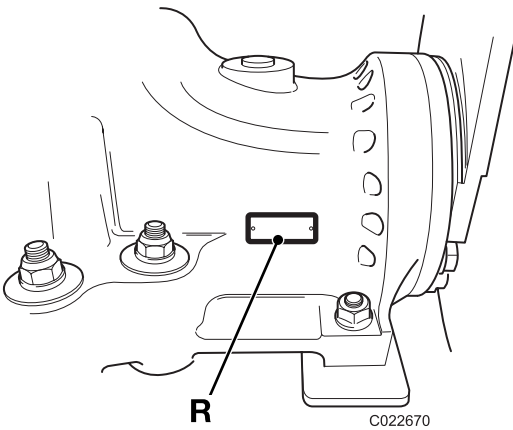

Fig 6.

Please Click Here To Download The Complete Manual
Download Other Manuals
If Having Any Questions Feel Free To Contact us

admin@servicemanualbit.com